



## Washburn

Map Lot 011-121

Account 202

Location 13 SCHOOL STREET

Card 1

Of 1

9/04/2024

Building Style	<b>4 Cape Cod</b>		SF Bsmt Living	<b>0</b>		Layout	<b>1 Typical</b>							
1.Conv.	5.Garrison	9.Gambrel	Fin Bsmt Grade	<b>0 0</b>		1.Typical	4.	7.						
2.Ranch	6.Salt Box	10.Other	OPEN 5 OPTIONAL	<b>0</b>		2.Inadeq	5.	8.						
3.R Ranch	7.Contemp	11.Split	Heat Type	<b>100% 5 Forced Warm Air</b>		3.Poor	6.	9.						
4.Cape	8.Log	12.	1.HWB	5.FWA	9.No Heat	Attic	<b>9 None</b>							
Dwelling Units	<b>1</b>		2.HWCI	6.GravWA	10.	1.1/4 Fin	4.Full Fin	7.						
Other Units	<b>0</b>		3.H Pump	7.Electric	11.	2.1/2 Fin	5.FI/Stair	8.						
Stories	<b>4 One &amp; 1/2 Story</b>		4.Steam	8.FI/Wall	12.	3.3/4 Fin	6.	9.None						
1.1	4.1.5	7.	Cool Type	<b>0% 9 None</b>		Insulation	<b>1 Full</b>							
2.2	5.1.75	8.	1.Refrig	4.W&C Air	7.	1.Full	4.Minimal	7.						
3.3	6.2.5	9.	2.Evapor	5.	8.	2.Heavy	5.Partial	8.						
Exterior Walls	<b>1 Wood Siding</b>		3.H Pump	6.	9.None	3.Capped	6.	9.None						
1.Wood	5.Stucco	9.T-111	Kitchen Style	<b>2 Typical</b>		Unfinished %	<b>0%</b>							
2.Vin/Al	6.Brick	10.Other	1.Modern	4.Obsolete	7.	Grade & Factor	<b>2 Fair 110%</b>							
3.Compos.	7.Stone	11.	2.Typical	5.	8.	1.E Grade	4.B Grade	7.						
4.Asbestos	8.Concrete	12.	3.Old Type	6.	9.None	2.D Grade	5.A Grade	8.SC Grade						
Roof Surface	<b>1 Asphalt Shingles</b>		Bath(s) Style	<b>2 Typical Bath(s)</b>		3.C Grade	6.AA Grade	9.Same						
1.Asphalt	4.Composit	7.	1.Modern	4.Obsolete	7.	SQFT (Footprint)	<b>729</b>							
2.Slate	5.Wood	8.	2.Typical	5.	8.	Condition	<b>6 Good</b>							
3.Metal	6.Other	9.	3.Old Type	6.	9.None	1.Poor	4.Avg	7.V G						
SF Masonry Trim	<b>0</b>		# Rooms	<b>6</b>		2.Fair	5.Avg+	8.Exc						
OPEN-3-CUSTOM	<b>0</b>		# Bedrooms	<b>3</b>		3.Avg-	6.Good	9.Same						
OPEN-4-CUSTOM	<b>0</b>		# Full Baths	<b>2</b>		Phys. % Good	<b>0%</b>							
Year Built	<b>1950</b>		# Half Baths	<b>0</b>		Funct. % Good	<b>100%</b>							
Year Remodeled	<b>0</b>		# Addn Fixtures	<b>0</b>		Functional Code	<b>9 None</b>							
Foundation	<b>1 Concrete</b>		# Fireplaces	<b>0</b>		1.Incomp	4.Delap	7.No Power						
1.Concrete	4.Wood	7.							2.O-Built	5.Bsmt	8.LongTerm			
2.C Block	5.Slab	8.							Econ. % Good	<b>100%</b>		Economic Code	<b>None</b>	
3.Br/Stone	6.Piers	9.							0.None	3.No Power	7.	1.Location	4.Generate	8.
Basement	<b>4 Full Basement</b>								Entrance Code	<b>5 Estimated</b>		2.Encroach	9.None	9.
1.1/4 Bmt	4.Full Bmt	7.							1.Interior	4.Vacant	7.	Information Code	<b>5 Estimate</b>	
2.1/2 Bmt	5.None	8.							2.Refusal	5.Estimate	8.	1.Owner	4.Agent	7.
3.3/4 Bmt	6.	9.None							3.Informed	6.Reviewed	9.	2.Relative	5.Estimate	8.
Bsmt Gar # Cars	<b>0</b>								Information Code	<b>5 Estimate</b>		3.Tenant	6.Other	9.
Wet Basement	<b>1 Dry Basement</b>								1.One Story Fram					
1.Dry	4.	7.							2.Two Story Fram					
2.Damp	5.	8.	3.Three Story Fr											
3.Wet	6.	9.	4.1 & 1/2 Story											

Date Inspected 10/16/2018

### Additions, Outbuildings & Improvements

Type	Year	Units	Grade	Cond	Phys.	Funct.	Sound Value
21 Open Frame	1965	132	2 110	5	0 %	100 %	
15 1.75 Story/Bsmt	1950	252	9 100	9	0 %	100 %	
22 Encl Frame Porch	1965	54	2 110	4	0 %	100 %	
21 Open Frame	1965	54	2 115	4	0 %	100 %	
68 Wood Deck	1980	144	2 100	3	0 %	100 %	
83 1.75 S-Gar	1965	576	3 95	5	0 %	100 %	
					%	%	
					%	%	
					%	%	
					%	%	
					%	%	

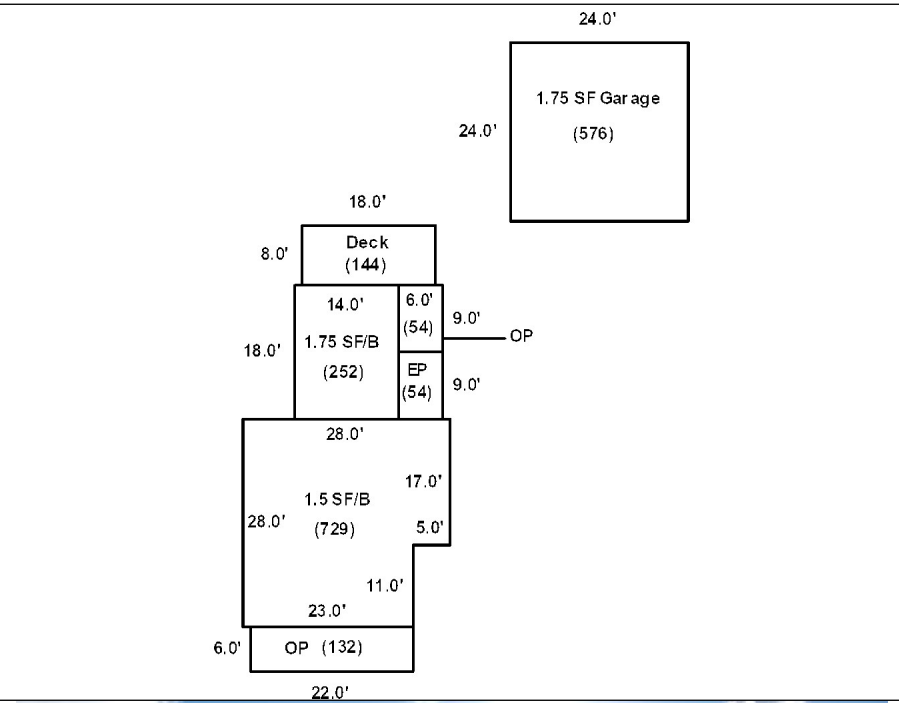



## Washburn

Map Lot 011-122

Account 905

Location 11 School Street

Card 1

Of 1

9/04/2024

Building Style <b>1 Conventional</b>	SF Bsmt Living <b>0</b>	Layout <b>1 Typical</b>
1.Conv. 5.Garrison 9.Gambrel	Fin Bsmt Grade <b>0 0</b>	1.Typical 4. 7.
2.Ranch 6.Salt Box 10.Other	OPEN 5 OPTIONAL <b>0</b>	2.Inadeq 5. 8.
3.R Ranch 7.Contemp 11.Split	Heat Type <b>100% 1 Hot Water BB</b>	3.Poor 6. 9.
4.Cape 8.Log 12.	1.HWBB 5.FWA 9.No Heat	Attic <b>9 None</b>
Dwelling Units <b>1</b>	2.HWCI 6.GravWA 10.	1.1/4 Fin 4.Full Fin 7.
Other Units <b>0</b>	3.H Pump 7.Electric 11.	2.1/2 Fin 5.FI/Stair 8.
Stories <b>6 Two &amp; 1/2 Story</b>	4.Steam 8.FI/Wall 12.	3.3/4 Fin 6. 9.None
1.1 4.1.5 7.	Cool Type <b>50% 3 Heat Pump</b>	Insulation <b>1 Full</b>
2.2 5.1.75 8.	1.Refrig 4.W&C Air 7.	1.Full 4.Minimal 7.
3.3 6.2.5 9.	2.Evapor 5. 8.	2.Heavy 5.Partial 8.
Exterior Walls <b>2 Vinyl/Aluminum</b>	3.H Pump 6. 9.None	3.Capped 6. 9.None
1.Wood 5.Stucco 9.T-111	Kitchen Style <b>2 Typical</b>	Unfinished % <b>0%</b>
2.Vin/Al 6.Brick 10.Other	1.Modern 4.Obsolete 7.	Grade & Factor <b>3 Average 90%</b>
3.Compos. 7.Stone 11.	2.Typical 5. 8.	1.E Grade 4.B Grade 7.
4.Asbestos 8.Concrete 12.	3.Old Type 6. 9.None	2.D Grade 5.A Grade 8.SC Grade
Roof Surface <b>1 Asphalt Shingles</b>	Bath(s) Style <b>2 Typical Bath(s)</b>	3.C Grade 6.AA Grade 9.Same
1.Asphalt 4.Composit 7.	1.Modern 4.Obsolete 7.	SQFT (Footprint) <b>816</b>
2.Slate 5.Wood 8.	2.Typical 5. 8.	Condition <b>6 Good</b>
3.Metal 6.Other 9.	3.Old Type 6. 9.None	1.Poor 4.Avg 7.V G
SF Masonry Trim <b>0</b>	# Rooms <b>10</b>	2.Fair 5.Avg+ 8.Exc
OPEN-3-CUSTOM <b>0</b>	# Bedrooms <b>6</b>	3.Avg- 6.Good 9.Same
OPEN-4-CUSTOM <b>0</b>	# Full Baths <b>1</b>	Phys. % Good <b>0%</b>
Year Built <b>1910</b>	# Half Baths <b>1</b>	Funct. % Good <b>100%</b>
Year Remodeled <b>0</b>	# Addn Fixtures <b>0</b>	Functional Code <b>9 None</b>
Foundation <b>1 Concrete</b>	# Fireplaces <b>0</b>	1.Incomp 4.Delap 7.No Power
1.Concrete 4.Wood 7.		2.O-Built 5.Bsmt 8.LongTerm
2.C Block 5.Slab 8.		3.Damage 6.Common 9.None
3.Br/Stone 6.Piers 9.		Econ. % Good <b>100%</b>
Basement <b>4 Full Basement</b>		Economic Code <b>None</b>
1.1/4 Bmt 4.Full Bmt 7.		0.None 3.No Power 7.
2.1/2 Bmt 5.None 8.		1.Location 4.Generate 8.
3.3/4 Bmt 6. 9.None		2.Encroach 9.None 9.
Bsmt Gar # Cars <b>0</b>		Entrance Code <b>1 Interior Inspect</b>
Wet Basement <b>1 Dry Basement</b>		1.Interior 4.Vacant 7.
1.Dry 4. 7.		2.Refusal 5.Estimate 8.
2.Damp 5. 8.	3.Informed 6.Reviewed 9.	
3.Wet 6. 9.	Information Code <b>1 Owner</b>	
	1.Owner 4.Agent 7.	
	2.Relative 5.Estimate 8.	
	3.Tenant 6.Other 9.	

Date Inspected 10/16/2018

### Additions, Outbuildings & Improvements

Type	Year	Units	Grade	Cond	Phys.	Funct.	Sound Value
21 Open Frame	1980	176	2 115	4	0 %	100 %	
1 One Story Frame	1910	30	9 100	9	0 %	100 %	
25 Frame Bay	1910	24	9 100	9	0 %	100 %	
21 Open Frame	1980	176	2 115	4	0 %	100 %	
62 Patio	1990	352	3 100	4	0 %	100 %	
82 1.5 S-Gar	2010	728	3 100	4	0 %	100 %	
23 Frame Garage	1965	360	2 110	3	0 %	100 %	
24 Frame Shed	0					%	600
24 Frame Shed	0					%	600
						%	%

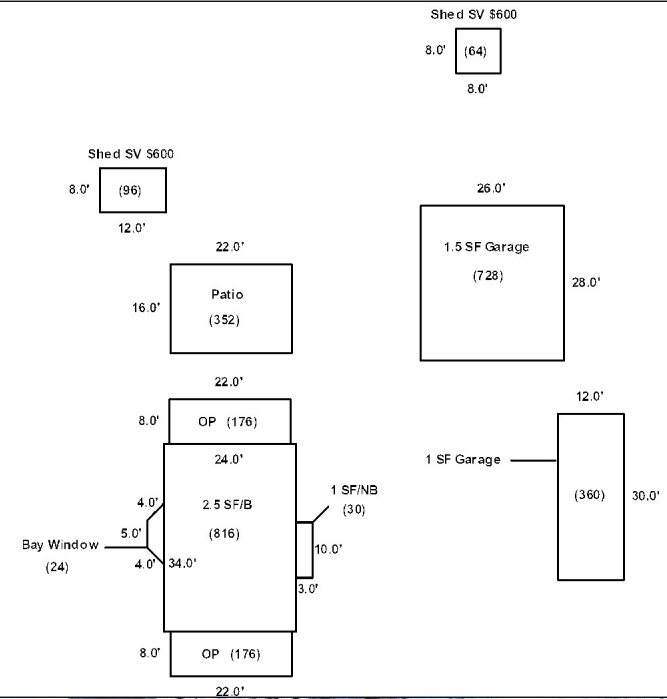

Town of Washburn  
1287 MAIN STREET  
WASHBURN ME 04786

			Property Data			Assessment Record																																																																																																																																																																																																																		
			Neighborhood	1 Neighborhood One		Year	Land	Buildings	Exempt	Total																																																																																																																																																																																																														
			Tree Growth Year 0			2012	5,900	249,900	255,800	0																																																																																																																																																																																																														
			1ST MORTGAGE 0			2013	7,700	249,900	257,600	0																																																																																																																																																																																																														
			2ND MORTGAGE 0			2015	7,700	249,900	257,600	0																																																																																																																																																																																																														
			Zone/Land Use 1 Residential			2018	7,700	249,900	257,600	0																																																																																																																																																																																																														
			Secondary Zone			2019	16,300	306,700	323,000	0																																																																																																																																																																																																														
			Topography 1 Level			2020	16,300	306,700	323,000	0																																																																																																																																																																																																														
			1.Level 4.Below St 7.LevelBog			2021	16,300	306,700	323,000	0																																																																																																																																																																																																														
			2.Rolling 5.Low 8.			2022	16,300	322,100	338,400	0																																																																																																																																																																																																														
			3.Above St 6.Swampy 9.			2023	20,100	383,400	403,500	0																																																																																																																																																																																																														
			Utilities 2 Public Water 3 Public Sewer			2024	20,100	383,400	403,500	0																																																																																																																																																																																																														
			1.Public 4.Dr Well 7.Cesspool																																																																																																																																																																																																																					
			2.Water 5.Dug Well 8.																																																																																																																																																																																																																					
			3.Sewer 6.Septic 9.None																																																																																																																																																																																																																					
			Street 1 Paved																																																																																																																																																																																																																					
			1.Paved 4.Proposed 7.			<table border="1"> <thead> <tr> <th colspan="6">Land Data</th> </tr> <tr> <th rowspan="2">Front Foot</th> <th rowspan="2">Type</th> <th colspan="2">Effective</th> <th colspan="2">Influence</th> <th rowspan="2">Influence Codes</th> </tr> <tr> <th>Frontage</th> <th>Depth</th> <th>Factor</th> <th>Code</th> </tr> </thead> <tbody> <tr> <td>11.Regular Lot</td> <td></td> <td></td> <td></td> <td>%</td> <td></td> <td>1.Unimproved</td> </tr> <tr> <td>12.Delta Triangle</td> <td></td> <td></td> <td></td> <td>%</td> <td></td> <td>2.Excess Frtg</td> </tr> <tr> <td>13.Nabla Triangle</td> <td></td> <td></td> <td></td> <td>%</td> <td></td> <td>3.Topography</td> </tr> <tr> <td>14.Rear Land</td> <td></td> <td></td> <td></td> <td>%</td> <td></td> <td>4.Size/Shape</td> </tr> <tr> <td>15.Class I Road</td> <td></td> <td></td> <td></td> <td>%</td> <td></td> <td>5.Access</td> </tr> <tr> <td></td> <td></td> <td></td> <td></td> <td>%</td> <td></td> <td>6.Restriction</td> </tr> <tr> <td></td> <td></td> <td></td> <td></td> <td>%</td> <td></td> <td>7.Open Space</td> </tr> <tr> <td></td> <td></td> <td></td> <td></td> <td>%</td> <td></td> <td>8.View/Environ</td> </tr> <tr> <td></td> <td></td> <td></td> <td></td> <td>%</td> <td></td> <td>9.Fract Share</td> </tr> <tr> <td></td> <td></td> <td></td> <td></td> <td>%</td> <td></td> <td><b>Acres</b></td> </tr> <tr> <td></td> <td></td> <td></td> <td></td> <td>%</td> <td></td> <td>30.Utility R O W</td> </tr> <tr> <td></td> <td></td> <td></td> <td></td> <td>%</td> <td></td> <td>31.Tillable</td> </tr> <tr> <td></td> <td></td> <td></td> <td></td> <td>%</td> <td></td> <td>32.Pasture</td> </tr> <tr> <td></td> <td></td> <td></td> <td></td> <td>%</td> <td></td> <td>33.Orchard</td> </tr> <tr> <td></td> <td></td> <td></td> <td></td> <td>%</td> <td></td> <td>34.Softwood F&amp;O</td> </tr> <tr> <td></td> <td></td> <td></td> <td></td> <td>%</td> <td></td> <td>35.Mixed Wood F&amp;O</td> </tr> <tr> <td></td> <td></td> <td></td> <td></td> <td>%</td> <td></td> <td>36.Hardwood F&amp;O</td> </tr> <tr> <td></td> <td></td> <td></td> <td></td> <td>%</td> <td></td> <td>37.Softwood TG</td> </tr> <tr> <td></td> <td></td> <td></td> <td></td> <td>%</td> <td></td> <td>38.Mixed Wood TG</td> </tr> <tr> <td></td> <td></td> <td></td> <td></td> <td>%</td> <td></td> <td>39.Hardwood TG</td> </tr> <tr> <td></td> <td></td> <td></td> <td></td> <td>%</td> <td></td> <td>40.Wasteland</td> </tr> <tr> <td></td> <td></td> <td></td> <td></td> <td>%</td> <td></td> <td>41.Open Space</td> </tr> <tr> <td></td> <td></td> <td></td> <td></td> <td>%</td> <td></td> <td>42.Mobile Home Si</td> </tr> <tr> <td></td> <td></td> <td></td> <td></td> <td>%</td> <td></td> <td>43.Condo Site</td> </tr> <tr> <td></td> <td></td> <td></td> <td></td> <td>%</td> <td></td> <td>44.Lot Improvemen</td> </tr> <tr> <td></td> <td></td> <td></td> <td></td> <td>%</td> <td></td> <td>45.Subdivision Lo</td> </tr> <tr> <td></td> <td></td> <td></td> <td></td> <td>%</td> <td></td> <td>46.Heavy Ind Sit</td> </tr> </tbody> </table>					Land Data						Front Foot	Type	Effective		Influence		Influence Codes	Frontage	Depth	Factor	Code	11.Regular Lot				%		1.Unimproved	12.Delta Triangle				%		2.Excess Frtg	13.Nabla Triangle				%		3.Topography	14.Rear Land				%		4.Size/Shape	15.Class I Road				%		5.Access					%		6.Restriction					%		7.Open Space					%		8.View/Environ					%		9.Fract Share					%		<b>Acres</b>					%		30.Utility R O W					%		31.Tillable					%		32.Pasture					%		33.Orchard					%		34.Softwood F&O					%		35.Mixed Wood F&O					%		36.Hardwood F&O					%		37.Softwood TG					%		38.Mixed Wood TG					%		39.Hardwood TG					%		40.Wasteland					%		41.Open Space					%		42.Mobile Home Si					%		43.Condo Site					%		44.Lot Improvemen					%		45.Subdivision Lo					%		46.Heavy Ind Sit
			Land Data																																																																																																																																																																																																																					
Front Foot	Type	Effective		Influence		Influence Codes																																																																																																																																																																																																																		
		Frontage	Depth	Factor	Code																																																																																																																																																																																																																			
11.Regular Lot				%		1.Unimproved																																																																																																																																																																																																																		
12.Delta Triangle				%		2.Excess Frtg																																																																																																																																																																																																																		
13.Nabla Triangle				%		3.Topography																																																																																																																																																																																																																		
14.Rear Land				%		4.Size/Shape																																																																																																																																																																																																																		
15.Class I Road				%		5.Access																																																																																																																																																																																																																		
				%		6.Restriction																																																																																																																																																																																																																		
				%		7.Open Space																																																																																																																																																																																																																		
				%		8.View/Environ																																																																																																																																																																																																																		
				%		9.Fract Share																																																																																																																																																																																																																		
				%		<b>Acres</b>																																																																																																																																																																																																																		
				%		30.Utility R O W																																																																																																																																																																																																																		
				%		31.Tillable																																																																																																																																																																																																																		
				%		32.Pasture																																																																																																																																																																																																																		
				%		33.Orchard																																																																																																																																																																																																																		
				%		34.Softwood F&O																																																																																																																																																																																																																		
				%		35.Mixed Wood F&O																																																																																																																																																																																																																		
				%		36.Hardwood F&O																																																																																																																																																																																																																		
				%		37.Softwood TG																																																																																																																																																																																																																		
				%		38.Mixed Wood TG																																																																																																																																																																																																																		
				%		39.Hardwood TG																																																																																																																																																																																																																		
				%		40.Wasteland																																																																																																																																																																																																																		
				%		41.Open Space																																																																																																																																																																																																																		
				%		42.Mobile Home Si																																																																																																																																																																																																																		
				%		43.Condo Site																																																																																																																																																																																																																		
				%		44.Lot Improvemen																																																																																																																																																																																																																		
				%		45.Subdivision Lo																																																																																																																																																																																																																		
				%		46.Heavy Ind Sit																																																																																																																																																																																																																		
			1.Paved 4.Proposed 7.			Square Foot																																																																																																																																																																																																																		
			2.Semi Imp 5.R/O/W 8.			29	4,000	50	%	0																																																																																																																																																																																																														
			3.Gravel 6. 9.None			Square Feet																																																																																																																																																																																																																		
			TG PLAN YEAR 0																																																																																																																																																																																																																					
			Tif District # 0			Fract. Acre																																																																																																																																																																																																																		
			Sale Data			21		0.47		100 % 0																																																																																																																																																																																																														
			Sale Date			Acres																																																																																																																																																																																																																		
			Price			24.Undev Gravel (		25.Comm Base Pave																																																																																																																																																																																																																
			Sale Type			26.Comm Base Grav																																																																																																																																																																																																																		
			1.Land 4.Mobile 7.C/I L&B			27.Backlot		28.Rear Land																																																																																																																																																																																																																
			2.L & B 5.Other 8.			29.Pavement																																																																																																																																																																																																																		
			3.Building 6.C/I Land 9.																																																																																																																																																																																																																					
			Financing																																																																																																																																																																																																																					
			1.Convent 4.Seller 7.																																																																																																																																																																																																																					
			2.FHA/VA 5.Private 8.																																																																																																																																																																																																																					
			3.Assumed 6.Cash 9.Unknown																																																																																																																																																																																																																					
			Validity																																																																																																																																																																																																																					
			1.Valid 4.Split 7.Renovate																																																																																																																																																																																																																					
			2.Related 5.Partial 8.Other																																																																																																																																																																																																																					
			3.Distress 6.Exempt 9.																																																																																																																																																																																																																					
			Verified																																																																																																																																																																																																																					
			1.Buyer 4.Agent 7.Family																																																																																																																																																																																																																					
			2.Seller 5.Pub Rec 8.Other																																																																																																																																																																																																																					
			3.Lender 6.MLS 9.																																																																																																																																																																																																																					
						<b>Total Acreage</b>		0.47																																																																																																																																																																																																																

Inspection Witnessed By:

X	Date	Date Insp.
No./Date	Description	Date Insp.

Notes:  
\*2-8-2019 -20% for attached garage, -15% for size obs. on garage.

## Washburn

Map Lot 011-123

Account 966

Location 1287 Main Street - Town Office

Card 1 Of 1

9/04/2024

Building Style <b>0</b>	SF Bsmt Living <b>0</b>	Layout <b>0</b>
1.Conv. 5.Garrison 9.Gambrel	Fin Bsmt Grade <b>0 0</b>	1.Typical 4. 7.
2.Ranch 6.Salt Box 10.Other	OPEN 5 OPTIONAL <b>0</b>	2.Inadeq 5. 8.
3.R Ranch 7.Contemp 11.Split	Heat Type <b>100% 0</b>	3.Poor 6. 9.
4.Cape 8.Log 12.	1.HWBB 5.FWA 9.No Heat	Attic <b>0</b>
Dwelling Units <b>0</b>	2.HWCI 6.GravWA 10.	1.1/4 Fin 4.Full Fin 7.
Other Units <b>0</b>	3.H Pump 7.Electric 11.	2.1/2 Fin 5.FI/Stair 8.
Stories <b>0</b>	4.Steam 8.FI/Wall 12.	3.3/4 Fin 6. 9.None
1.1 4.1.5 7.	Cool Type <b>0% 9 None</b>	Insulation <b>0</b>
2.2 5.1.75 8.	1.Refrig 4.W&C Air 7.	1.Full 4.Minimal 7.
3.3 6.2.5 9.	2.Evapor 5. 8.	2.Heavy 5.Partial 8.
Exterior Walls <b>0</b>	3.H Pump 6. 9.None	3.Capped 6. 9.None
1.Wood 5.Stucco 9.T-111	Kitchen Style <b>0</b>	Unfinished % <b>0%</b>
2.Vin/Al 6.Brick 10.Other	1.Modern 4.Obsolete 7.	Grade & Factor <b>0 0%</b>
3.Compos. 7.Stone 11.	2.Typical 5. 8.	1.E Grade 4.B Grade 7.
4.Asbestos 8.Concrete 12.	3.Old Type 6. 9.None	2.D Grade 5.A Grade 8.SC Grade
Roof Surface <b>0</b>	Bath(s) Style <b>0</b>	3.C Grade 6.AA Grade 9.Same
1.Asphalt 4.Composit 7.	1.Modern 4.Obsolete 7.	SQFT (Footprint) <b>0</b>
2.Slate 5.Wood 8.	2.Typical 5. 8.	Condition <b>0</b>
3.Metal 6.Other 9.	3.Old Type 6. 9.None	1.Poor 4.Avg 7.V G
SF Masonry Trim <b>0</b>	# Rooms <b>0</b>	2.Fair 5.Avg+ 8.Exc
OPEN-3-CUSTOM <b>0</b>	# Bedrooms <b>0</b>	3.Avg- 6.Good 9.Same
OPEN-4-CUSTOM <b>0</b>	# Full Baths <b>0</b>	Phys. % Good <b>0%</b>
Year Built <b>0</b>	# Half Baths <b>0</b>	Funct. % Good <b>100%</b>
Year Remodeled <b>0</b>	# Addn Fixtures <b>0</b>	Functional Code <b>9 None</b>
Foundation <b>0</b>	# Fireplaces <b>0</b>	1.Incomp 4.Delap 7.No Power
1.Concrete 4.Wood 7.	 <p><b>TRIO</b> Software A Division of Harris Computer Systems</p>	2.O-Built 5.Bsmt 8.LongTerm
2.C Block 5.Slab 8.		3.Damage 6.Common 9.None
3.Br/Stone 6.Piers 9.		Econ. % Good <b>100%</b>
Basement <b>0</b>		Economic Code <b>None</b>
1.1/4 Bmt 4.Full Bmt 7.		0.None 3.No Power 7.
2.1/2 Bmt 5.None 8.		1.Location 4.Generate 8.
3.3/4 Bmt 6. 9.None		2.Encroach 9.None 9.
Bsmt Gar # Cars <b>0</b>		Entrance Code <b>1 Interior Inspect</b>
Wet Basement <b>0</b>		1.Interior 4.Vacant 7.
1.Dry 4. 7.		2.Refusal 5.Estimate 8.
2.Damp 5. 8.	3.Informed 6.Reviewed 9.	
3.Wet 6. 9.	Information Code <b>1 Owner</b>	
	1.Owner 4.Agent 7.	
	2.Relative 5.Estimate 8.	
	3.Tenant 6.Other 9.	

Date Inspected 10/16/2018

### Additions, Outbuildings & Improvements

Type	Year	Units	Grade	Cond	Phys.	Funct.	Sound Value
220 1S-Office	1880	3720	3 105	5	0 %	85 %	
68 Wood Deck	1980	210	2 110	4	0 %	100 %	
40 Basement Entry	1900	100	3 100	4	0 %	100 %	
232 Fire Station	1880	4960	3 100	5	0 %	65 %	
					%	%	
					%	%	
					%	%	
					%	%	
					%	%	
					%	%	

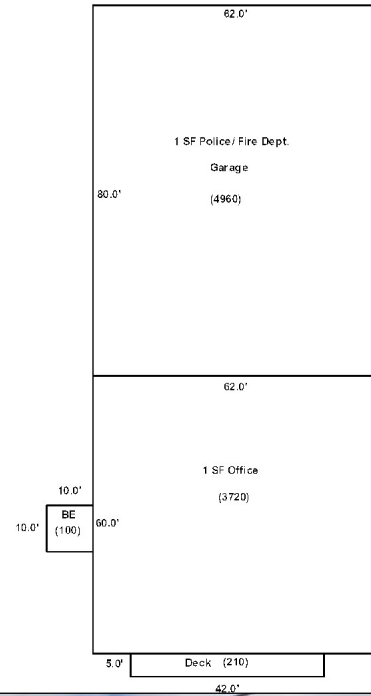

1281 MAIN STREET, LLC  
c/o ANTHONY FASOLAS  
SANWOOD NJ 07023

B5165P146

Previous Owner  
Smith, Todd  
Vaughan, Wayne  
4002 Broad Street  
Brooksville FL 34601  
Sale Date: 3/23/2013

Previous Owner  
The Bank of Maine  
P.O. Box 190

Gardiner ME 04345  
Sale Date: 12/06/2011

Previous Owner  
Spinney, Albert  
Spinney, Madeline  
44 Garden Circle  
Caribou ME 04736  
Sale Date: 9/22/2009

Inspection Witnessed By:

X	Date
No./Date	Description
	Date Insp.

Notes:

Washburn

Property Data			Assessment Record						
Neighborhood <b>1 Neighborhood One</b>			Year	Land	Buildings	Exempt	Total		
Tree Growth Year <b>0</b>			2012	8,300	41,700	0	50,000		
1ST MORTGAGE <b>0</b>			2013	10,800	41,700	0	52,500		
2ND MORTGAGE <b>0</b>			2015	10,800	41,700	0	52,500		
Zone/Land Use <b>1 Residential</b>			2018	10,800	41,700	0	52,500		
Secondary Zone			2019	12,000	55,900	0	67,900		
Topography <b>1 Level</b>			2020	12,000	55,900	0	67,900		
1.Level 4.Below St 7.LevelBog			2021	12,000	55,900	0	67,900		
2.Rolling 5.Low 8.			2022	12,000	58,700	0	70,700		
3.Above St 6.Swampy 9.			2023	14,800	69,900	0	84,700		
Utilities <b>2 Public Water 3 Public Sewer</b>			2024	14,800	69,900	0	84,700		
1.Public 4.Dr Well 7.Cesspool									
2.Water 5.Dug Well 8.									
3.Sewer 6.Septic 9.None									
Street <b>1 Paved</b>									
1.Paved 4.Proposed 7.									
2.Semi Imp 5.R/O/W 8.									
3.Gravel 6. 9.None									
TG PLAN YEAR <b>0</b>									
Tif District # <b>0</b>									
Sale Data			<b>Land Data</b>						
Sale Date <b>3/28/2013</b>			<b>Front Foot</b>	<b>Type</b>	<b>Effective</b>		<b>Influence</b>		<b>Influence Codes</b>
Price <b>40,000</b>					Frontage	Depth	Factor	Code	
Sale Type <b>2 Land &amp; Buildings</b>			11.Regular Lot					1.Unimproved	
1.Land 4.Mobile 7.C/I L&B			12.Delta Triangle			%		2.Excess Frtg	
2.L & B 5.Other 8.			13.Nabla Triangle			%		3.Topography	
3.Building 6.C/I Land 9.			14.Rear Land			%		4.Size/Shape	
Financing			15.Class I Road			%		5.Access	
1.Convent 4.Seller 7.						%		6.Restriction	
2.FHA/VA 5.Private 8.						%		7.Open Space	
3.Assumed 6.Cash 9.Unknown						%		8.View/Environ	
Validity <b>1 Arms Length Sale</b>			<b>Square Foot</b>	<b>Square Feet</b>				9.Fract Share	
1.Valid 4.Split 7.Renovate			16.Class II Road	29	2,000	75	%	0	
2.Related 5.Partial 8.Other			17.Municipal Rese				%		
3.Distress 6.Exempt 9.			18.Munic Sep Lago				%		
Verified <b>5 Public Record</b>			19.Gravel Pit				%		
1.Buyer 4.Agent 7.Family			20.Industrial Bas				%		
2.Seller 5.Pub Rec 8.Other			<b>Fract. Acre</b>	<b>Acres/Sites</b>					
3.Lender 6.MLS 9.			21.Developed Pave	21	0.25	100	%	0	
			22.Undev Paved (F				%		
			23.Developed Grav				%		
			<b>Acres</b>				%		
			24.Undev Gravel (				%		
			25.Comm Base Pave				%		
			26.Comm Base Grav				%		
			27.Backlot				%		
			28.Rear Land				%		
			29.Pavement				%		
			<b>Total Acreage</b>		<b>0.25</b>				
								30.Utility R O W	
								31.Tillable	
								32.Pasture	
								33.Orchard	
								34.Softwood F&O	
								35.Mixed Wood F&O	
								36.Hardwood F&O	
								37.Softwood TG	
								38.Mixed Wood TG	
								39.Hardwood TG	
								40.Wasteland	
								41.Open Space	
								42.Mobile Home Si	
								43.Condo Site	
								44.Lot Improvemen	
								45.Subdivision Lo	
								46.Heavy Ind Sit	

**Washburn**

Map Lot 011-124

Account 867

Location 1281 Main Street

Card 1 Of 1 9/04/2024

Building Style <b>1 Conventional</b>	SF Bsmt Living <b>0</b>	Layout <b>1 Typical</b>
1.Conv. 5.Garrison 9.Gambrel	Fin Bsmt Grade <b>0 0</b>	1.Typical 4. 7.
2.Ranch 6.Salt Box 10.Other	OPEN 5 OPTIONAL <b>0</b>	2.Inadeq 5. 8.
3.R Ranch 7.Contemp 11.Split	Heat Type <b>100% 1 Hot Water BB</b>	3.Poor 6. 9.
4.Cape 8.Log 12.	1.HWB 5.FWA 9.No Heat	Attic <b>9 None</b>
Dwelling Units <b>4</b>	2.HWCI 6.GravWA 10.	1.1/4 Fin 4.Full Fin 7.
Other Units <b>0</b>	3.H Pump 7.Electric 11.	2.1/2 Fin 5.F/Stair 8.
Stories <b>2 Two Story</b>	4.Steam 8.F/Wall 12.	3.3/4 Fin 6. 9.None
1.1 4.1.5 7.	Cool Type <b>0% 9 None</b>	Insulation <b>1 Full</b>
2.2 5.1.75 8.	1.Refrig 4.W&C Air 7.	1.Full 4.Minimal 7.
3.3 6.2.5 9.	2.Evapor 5. 8.	2.Heavy 5.Partial 8.
Exterior Walls <b>1 Wood Siding</b>	3.H Pump 6. 9.None	3.Capped 6. 9.None
1.Wood 5.Stucco 9.T-111	Kitchen Style <b>2 Typical</b>	Unfinished % <b>0%</b>
2.Vin/Al 6.Brick 10.Other	1.Modern 4.Obsolete 7.	Grade & Factor <b>2 Fair 105%</b>
3.Compos. 7.Stone 11.	2.Typical 5. 8.	1.E Grade 4.B Grade 7.
4.Asbestos 8.Concrete 12.	3.Old Type 6. 9.None	2.D Grade 5.A Grade 8.SC Grade
Roof Surface <b>3 Sheet Metal</b>	Bath(s) Style <b>2 Typical Bath(s)</b>	3.C Grade 6.AA Grade 9.Same
1.Asphalt 4.Composit 7.	1.Modern 4.Obsolete 7.	SQFT (Footprint) <b>1328</b>
2.Slate 5.Wood 8.	2.Typical 5. 8.	Condition <b>4 Average</b>
3.Metal 6.Other 9.	3.Old Type 6. 9.None	1.Poor 4.Avg 7.V G
SF Masonry Trim <b>0</b>	# Rooms <b>11</b>	2.Fair 5.Avg+ 8.Exc
OPEN-3-CUSTOM <b>0</b>	# Bedrooms <b>4</b>	3.Avg- 6.Good 9.Same
OPEN-4-CUSTOM <b>0</b>	# Full Baths <b>4</b>	Phys. % Good <b>0%</b>
Year Built <b>1890</b>	# Half Baths <b>0</b>	Funct. % Good <b>100%</b>
Year Remodeled <b>0</b>	# Addn Fixtures <b>0</b>	Functional Code <b>9 None</b>
Foundation <b>1 Concrete</b>	# Fireplaces <b>0</b>	1.Incomp 4.Delap 7.No Power
1.Concrete 4.Wood 7.		2.O-Built 5.Bsmt 8.LongTerm
2.C Block 5.Slab 8.		3.Damage 6.Common 9.None
3.Br/Stone 6.Piers 9.		Econ. % Good <b>100%</b>
Basement <b>9 No Basement</b>		Economic Code <b>None</b>
1.1/4 Bmt 4.Full Bmt 7.		0.None 3.No Power 7.
2.1/2 Bmt 5.None 8.		1.Location 4.Generate 8.
3.3/4 Bmt 6. 9.None		2.Encroach 9.None 9.
Bsmt Gar # Cars <b>0</b>		Entrance Code <b>3 Information Only</b>
Wet Basement <b>9 No Basement</b>		1.Interior 4.Vacant 7.
1.Dry 4. 7.		2.Refusal 5.Estimate 8.
2.Damp 5. 8.		3.Informed 6.Reviewed 9.
3.Wet 6. 9.		Information Code <b>1 Owner</b>
		1.Owner 4.Agent 7.
		2.Relative 5.Estimate 8.
		3.Tenant 6.Other 9.



Date Inspected 10/16/2018

**Additions, Outbuildings & Improvements**

Type	Year	Units	Grade	Cond	Phys.	Funct.	Sound Value
41 2S Open Fr Porch	1920	192	2 105	4	0 %	100 %	
					%	%	
					%	%	
					%	%	
					%	%	
					%	%	
					%	%	
					%	%	
					%	%	
					%	%	
					%	%	

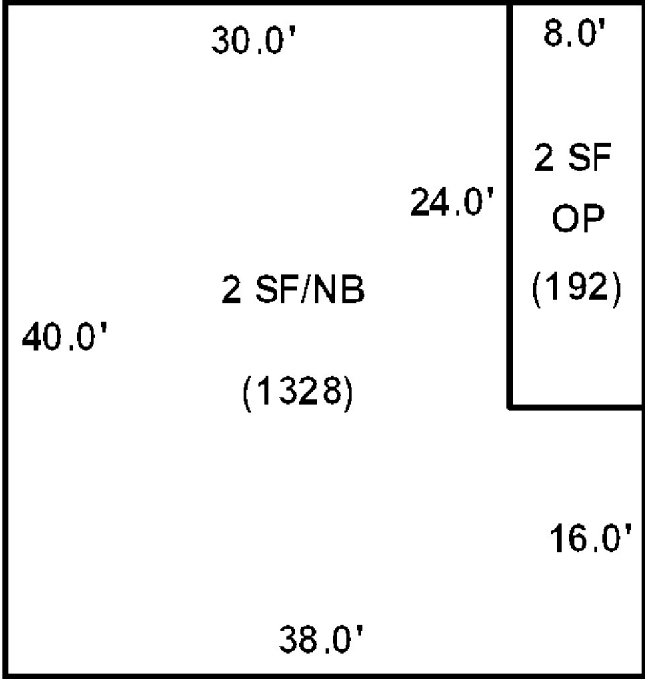

- 1.One Story Fram
- 2.Two Story Fram
- 3.Three Story Fr
- 4.1 & 1/2 Story
- 5.1 & 3/4 Story
- 6.2 & 1/2 Story
- 21.Open Frame Por
- 22.Encl Frame Por
- 23.Frame Garage
- 24.Frame Shed
- 25.Frame Bay Wind
- 26.1SFr Overhang
- 27.Unfin Basement
- 28.Unfinished Att
- 29.Finished Attic







Town of Washburn  
1287 MAIN STREET  
WASHBURN ME 04786

B2667P224

Inspection Witnessed By:

No./Date	Description	Date Insp.
X		

Notes:

Washburn

Property Data			Assessment Record							
Neighborhood <b>1 Neighborhood One</b>			Year	Land	Buildings	Exempt	Total			
Tree Growth Year <b>0</b>			2012	4,200	0	4,200	0			
1ST MORTGAGE <b>0</b>			2013	5,400	0	5,400	0			
2ND MORTGAGE <b>0</b>			2015	5,400	0	5,400	0			
Zone/Land Use <b>1 Residential</b>			2018	5,400	0	5,400	0			
Secondary Zone			2019	3,200	0	3,200	0			
Topography <b>1 Level</b>			2020	3,200	0	3,200	0			
1.Level 4.Below St 7.LevelBog			2021	3,200	0	3,200	0			
2.Rolling 5.Low 8.			2022	3,200	0	3,200	0			
3.Above St 6.Swampy 9.			2023	4,000	0	4,000	0			
Utilities			2024	4,000	0	4,000	0			
1.Public 4.Dr Well 7.Cesspool										
2.Water 5.Dug Well 8.										
3.Sewer 6.Septic 9.None										
Street <b>1 Paved</b>										
1.Paved 4.Proposed 7.										
2.Semi Imp 5.R/O/W 8.										
3.Gravel 6. 9.None										
TG PLAN YEAR <b>0</b>										
Tif District # <b>0</b>										
Sale Data			<b>Land Data</b>							
Sale Date			<b>Front Foot</b>	<b>Type</b>	<b>Effective</b>		<b>Influence</b>		<b>Influence Codes</b>	
Price					Frontage	Depth	Factor	Code		
Sale Type					11.Regular Lot					1.Unimproved
1.Land 4.Mobile 7.C/I L&B					12.Delta Triangle					2.Excess Frtg
2.L & B 5.Other 8.					13.Nabla Triangle					3.Topography
3.Building 6.C/I Land 9.			14.Rear Land				4.Size/Shape			
Financing			15.Class I Road				5.Access			
1.Convent 4.Seller 7.							6.Restriction			
2.FHA/VA 5.Private 8.							7.Open Space			
3.Assumed 6.Cash 9.Unknown							8.View/Environ			
Validity							9.Fract Share			
1.Valid 4.Split 7.Renovate			<b>Square Foot</b>	<b>Square Feet</b>				<b>Acres</b>		
2.Related 5.Partial 8.Other			16.Class II Road					30.Utility R O W		
3.Distress 6.Exempt 9.			17.Municipal Rese					31.Tillable		
Verified			18.Munic Sep Lago					32.Pasture		
1.Buyer 4.Agent 7.Family			19.Gravel Pit					33.Orchard		
2.Seller 5.Pub Rec 8.Other			20.Industrial Bas					34.Softwood F&O		
3.Lender 6.MLS 9.			<b>Fract. Acre</b>	<b>Acreege/Sites</b>				35.Mixed Wood F&O		
			21.Developed Pave	22	0.13	100	%	0	36.Hardwood F&O	
			22.Undev Paved (F				%		37.Softwood TG	
			23.Developed Grav				%		38.Mixed Wood TG	
			<b>Acres</b>				%		39.Hardwood TG	
			24.Undev Gravel (				%		40.Wasteland	
			25.Comm Base Pave				%		41.Open Space	
			26.Comm Base Grav				%		42.Mobile Home Si	
			27.Backlot				%		43.Condo Site	
			28.Rear Land	<b>Total Acreege</b>		0.13			44.Lot Improvemen	
			29.Pavement						45.Subdivision Lo	
									46.Heavy Ind Sit	

**Washburn**

Map Lot 011-126

Account 924

Location 1274 Main Street/Jardine Street

Card 1 Of 1 9/04/2024

Building Style <b>0</b>	SF Bsmt Living <b>0</b>	Layout <b>0</b>
1.Conv. 5.Garrison 9.Gambrel	Fin Bsmt Grade <b>0 0</b>	1.Typical 4. 7.
2.Ranch 6.Salt Box 10.Other	OPEN 5 OPTIONAL <b>0</b>	2.Inadeq 5. 8.
3.R Ranch 7.Contemp 11.Split	Heat Type <b>100% 0</b>	3.Poor 6. 9.
4.Cape 8.Log 12.	1.HWBB 5.FWA 9.No Heat	Attic <b>0</b>
Dwelling Units <b>0</b>	2.HWCI 6.GravWA 10.	1.1/4 Fin 4.Full Fin 7.
Other Units <b>0</b>	3.H Pump 7.Electric 11.	2.1/2 Fin 5.F/Stair 8.
Stories <b>0</b>	4.Steam 8.F/Wall 12.	3.3/4 Fin 6. 9.None
1.1 4.1.5 7.	Cool Type <b>0% 9 None</b>	Insulation <b>0</b>
2.2 5.1.75 8.	1.Refrig 4.W&C Air 7.	1.Full 4.Minimal 7.
3.3 6.2.5 9.	2.Evapor 5. 8.	2.Heavy 5.Partial 8.
Exterior Walls <b>0</b>	3.H Pump 6. 9.None	3.Capped 6. 9.None
1.Wood 5.Stucco 9.T-111	Kitchen Style <b>0</b>	Unfinished % <b>0%</b>
2.Vin/Al 6.Brick 10.Other	1.Modern 4.Obsolete 7.	Grade & Factor <b>0 0%</b>
3.Compos. 7.Stone 11.	2.Typical 5. 8.	1.E Grade 4.B Grade 7.
4.Asbestos 8.Concrete 12.	3.Old Type 6. 9.None	2.D Grade 5.A Grade 8.SC Grade
Roof Surface <b>0</b>	Bath(s) Style <b>0</b>	3.C Grade 6.AA Grade 9.Same
1.Asphalt 4.Composit 7.	1.Modern 4.Obsolete 7.	SQFT (Footprint) <b>0</b>
2.Slate 5.Wood 8.	2.Typical 5. 8.	Condition <b>0</b>
3.Metal 6.Other 9.	3.Old Type 6. 9.None	1.Poor 4.Avg 7.V G
SF Masonry Trim <b>0</b>	# Rooms <b>0</b>	2.Fair 5.Avg+ 8.Exc
OPEN-3-CUSTOM <b>0</b>	# Bedrooms <b>0</b>	3.Avg- 6.Good 9.Same
OPEN-4-CUSTOM <b>0</b>	# Full Baths <b>0</b>	Phys. % Good <b>0%</b>
Year Built <b>0</b>	# Half Baths <b>0</b>	Funct. % Good <b>100%</b>
Year Remodeled <b>0</b>	# Addn Fixtures <b>0</b>	Functional Code <b>9 None</b>
Foundation <b>0</b>	# Fireplaces <b>0</b>	1.Incomp 4.Delap 7.No Power
1.Concrete 4.Wood 7.		2.O-Built 5.Bsmt 8.LongTerm
2.C Block 5.Slab 8.		3.Damage 6.Common 9.None
3.Br/Stone 6.Piers 9.		Econ. % Good <b>100%</b>
Basement <b>0</b>		Economic Code <b>None</b>
1.1/4 Bmt 4.Full Bmt 7.		0.None 3.No Power 7.
2.1/2 Bmt 5.None 8.		1.Location 4.Generate 8.
3.3/4 Bmt 6. 9.None		2.Encroach 9.None 9.
Bsmt Gar # Cars <b>0</b>		Entrance Code <b>0</b>
Wet Basement <b>0</b>		1.Interior 4.Vacant 7.
1.Dry 4. 7.		2.Refusal 5.Estimate 8.
2.Damp 5. 8.	3.Informed 6.Reviewed 9.	
3.Wet 6. 9.	Information Code <b>0</b>	
		1.Owner 4.Agent 7.
		2.Relative 5.Estimate 8.
		3.Tenant 6.Other 9.

Date Inspected

**Additions, Outbuildings & Improvements**

Type	Year	Units	Grade	Cond	Phys.	Funct.	Sound Value
					%	%	1.One Story Fram
					%	%	2.Two Story Fram
					%	%	3.Three Story Fr
					%	%	4.1 & 1/2 Story
					%	%	5.1 & 3/4 Story
					%	%	6.2 & 1/2 Story
					%	%	21.Open Frame Por
					%	%	22.Encl Frame Por
					%	%	23.Frame Garage
					%	%	24.Frame Shed
					%	%	25.Frame Bay Wind
					%	%	26.1SFr Overhang
					%	%	27.Unfin Basement
					%	%	28.Unfinished Att
					%	%	29.Finished Attic



## Washburn

Map Lot 011-127

Account 369

Location 8 JARDINE STREET

Card 1 Of 1 9/04/2024

Building Style <b>1 Conventional</b>	SF Bsmt Living <b>0</b>	Layout <b>1 Typical</b>
1.Conv. 5.Garrison 9.Gambrel	Fin Bsmt Grade <b>0 0</b>	1.Typical 4. 7.
2.Ranch 6.Salt Box 10.Other	OPEN 5 OPTIONAL <b>0</b>	2.Inadeq 5. 8.
3.R Ranch 7.Contemp 11.Split	Heat Type <b>100% 5 Forced Warm Air</b>	3.Pool 6. 9.
4.Cape 8.Log 12.	1.HWBB 5.FWA 9.No Heat	Attic <b>9 None</b>
Dwelling Units <b>1</b>	2.HWCI 6.GravWA 10.	1.1/4 Fin 4.Full Fin 7.
Other Units <b>0</b>	3.H Pump 7.Electric 11.	2.1/2 Fin 5.FI/Stair 8.
Stories <b>2 Two Story</b>	4.Steam 8.FI/Wall 12.	3.3/4 Fin 6. 9.None
1.1 4.1.5 7.	Cool Type <b>0% 9 None</b>	Insulation <b>1 Full</b>
2.2 5.1.75 8.	1.Refrig 4.W&C Air 7.	1.Full 4.Minimal 7.
3.3 6.2.5 9.	2.Evapor 5. 8.	2.Heavy 5.Partial 8.
Exterior Walls <b>2 Vinyl/Aluminum</b>	3.H Pump 6. 9.None	3.Capped 6. 9.None
1.Wood 5.Stucco 9.T-111	Kitchen Style <b>2 Typical</b>	Unfinished % <b>0%</b>
2.Vin/Al 6.Brick 10.Other	1.Modern 4.Obsolete 7.	Grade & Factor <b>2 Fair 110%</b>
3.Compos. 7.Stone 11.	2.Typical 5. 8.	1.E Grade 4.B Grade 7.
4.Asbestos 8.Concrete 12.	3.Old Type 6. 9.None	2.D Grade 5.A Grade 8.SC Grade
Roof Surface <b>3 Sheet Metal</b>	Bath(s) Style <b>2 Typical Bath(s)</b>	3.C Grade 6.AA Grade 9.Same
1.Asphalt 4.Composit 7.	1.Modern 4.Obsolete 7.	SQFT (Footprint) <b>816</b>
2.Slate 5.Wood 8.	2.Typical 5. 8.	Condition <b>5 Above Average</b>
3.Metal 6.Other 9.	3.Old Type 6. 9.None	1.Poor 4.Avg 7.V G
SF Masonry Trim <b>0</b>	# Rooms <b>12</b>	2.Fair 5.Avg+ 8.Exc
OPEN-3-CUSTOM <b>0</b>	# Bedrooms <b>6</b>	3.Avg- 6.Good 9.Same
OPEN-4-CUSTOM <b>0</b>	# Full Baths <b>3</b>	Phys. % Good <b>0%</b>
Year Built <b>1956</b>	# Half Baths <b>0</b>	Funct. % Good <b>100%</b>
Year Remodeled <b>0</b>	# Addn Fixtures <b>0</b>	Functional Code <b>9 None</b>
Foundation <b>1 Concrete</b>	# Fireplaces <b>0</b>	1.Incomp 4.Delap 7.No Power
1.Concrete 4.Wood 7.	 <p><b>TRIO</b> Software <i>A Division of Harris Computer Systems</i></p>	2.O-Built 5.Bsmt 8.LongTerm
2.C Block 5.Slab 8.		3.Damage 6.Common 9.None
3.Br/Stone 6.Piers 9.		Econ. % Good <b>100%</b>
Basement <b>4 Full Basement</b>		Economic Code <b>None</b>
1.1/4 Bmt 4.Full Bmt 7.		0.None 3.No Power 7.
2.1/2 Bmt 5.None 8.		1.Location 4.Generate 8.
3.3/4 Bmt 6. 9.None		2.Encroach 9.None 9.
Bsmt Gar # Cars <b>0</b>		Entrance Code <b>3 Information Only</b>
Wet Basement <b>2 Damp Basement</b>		1.Interior 4.Vacant 7.
1.Dry 4. 7.		2.Refusal 5.Estimate 8.
2.Damp 5. 8.	3.Informed 6.Reviewed 9.	
3.Wet 6. 9.	Information Code <b>1 Owner</b>	
	1.Owner 4.Agent 7.	
	2.Relative 5.Estimate 8.	
	3.Tenant 6.Other 9.	

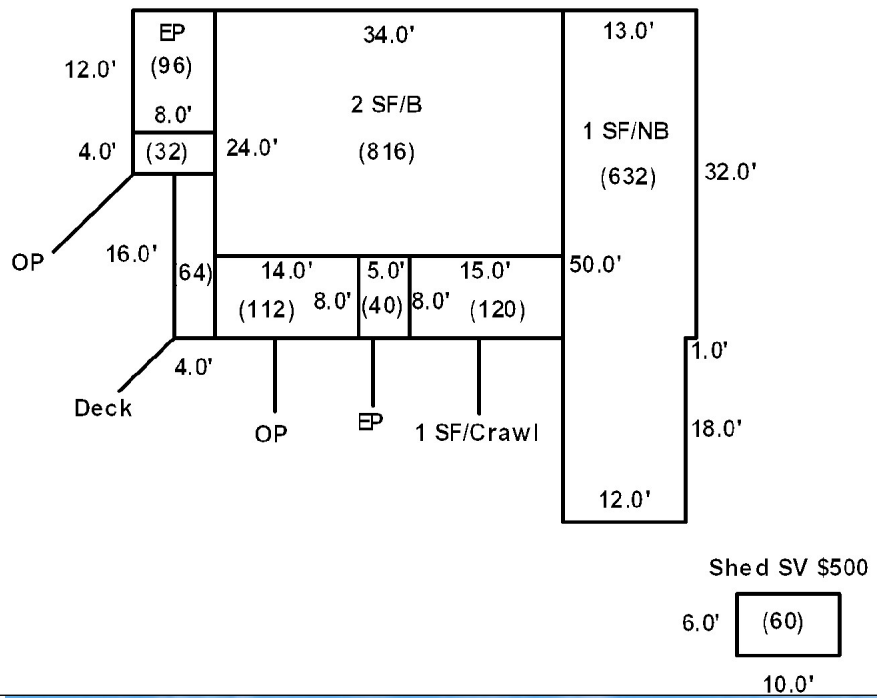

Date Inspected 10/16/2018

### Additions, Outbuildings & Improvements

Type	Year	Units	Grade	Cond	Phys.	Funct.	Sound Value
22 Encl Frame Porch	1960	96	2 110	4	0 %	100 %	
21 Open Frame	1960	32	2 100	4	0 %	100 %	
68 Wood Deck	1980	64	3 95	4	0 %	100 %	
21 Open Frame	1980	112	3 95	4	0 %	100 %	
22 Encl Frame Porch	1956	40	2 110	4	0 %	100 %	
1 One Story Frame	1956	120	3 90	5	0 %	100 %	
1 One Story Frame	1975	632	2 115	4	0 %	100 %	
24 Frame Shed	0						500



SILVER, TRICIA N  
PO BOX 313  
WASHBURN ME 04786

B4044P127 B5242P105

Inspection Witnessed By:

No./Date	Description	Date Insp.
X		

Notes:

Washburn

Property Data			Assessment Record							
Neighborhood <b>1 Neighborhood One</b>			Year	Land	Buildings	Exempt	Total			
Tree Growth Year <b>0</b>			2012	5,300	49,600	8,800	46,100			
1ST MORTGAGE <b>0</b>			2013	6,900	49,600	8,800	47,700			
2ND MORTGAGE <b>0</b>			2015	6,900	49,600	9,000	47,500			
Zone/Land Use <b>1 Residential</b>			2018	6,900	49,600	18,400	38,100			
Secondary Zone			2019	9,900	60,100	20,000	50,000			
Topography <b>1 Level</b>			2020	9,900	59,400	25,000	44,300			
1.Level 4.Below St 7.LevelBog			2021	9,900	60,100	25,000	45,000			
2.Rolling 5.Low 8.			2022	9,900	63,100	25,000	48,000			
3.Above St 6.Swampy 9.			2023	13,200	75,000	25,000	63,200			
Utilities <b>2 Public Water 3 Public Sewer</b>			2024	13,200	75,000	25,000	63,200			
1.Public 4.Dr Well 7.Cesspool										
2.Water 5.Dug Well 8.										
3.Sewer 6.Septic 9.None										
Street <b>1 Paved</b>										
1.Paved 4.Proposed 7.										
2.Semi Imp 5.R/O/W 8.										
3.Gravel 6. 9.None										
TG PLAN YEAR <b>0</b>										
Tif District # <b>0</b>										
Sale Data			<b>Land Data</b>							
Sale Date <b>10/27/2004</b>			<b>Front Foot</b>	<b>Type</b>	<b>Effective</b>		<b>Influence</b>		<b>Influence Codes</b>	
Price					<b>Frontage</b>	<b>Depth</b>	<b>Factor</b>	<b>Code</b>		
Sale Type <b>2 Land &amp; Buildings</b>				11.Regular Lot			%			1.Unimproved
1.Land 4.Mobile 7.C/I L&B				12.Delta Triangle			%			2.Excess Frtg
2.L & B 5.Other 8.				13.Nabla Triangle			%			3.Topography
3.Building 6.C/I Land 9.			14.Rear Land			%		4.Size/Shape		
Financing <b>1 Conventional</b>			15.Class I Road			%		5.Access		
1.Convent 4.Seller 7.						%		6.Restriction		
2.FHA/VA 5.Private 8.						%		7.Open Space		
3.Assumed 6.Cash 9.Unknown						%		8.View/Environ		
Validity <b>1 Arms Length Sale</b>						%		9.Fract Share		
1.Valid 4.Split 7.Renovate			<b>Square Foot</b>	<b>Square Feet</b>				<b>Acres</b>		
2.Related 5.Partial 8.Other			16.Class II Road			%		30.Utility R O W		
3.Distress 6.Exempt 9.			17.Municipal Rese			%		31.Tillable		
Verified <b>5 Public Record</b>			18.Munic Sep Lago			%		32.Pasture		
1.Buyer 4.Agent 7.Family			19.Gravel Pit			%		33.Orchard		
2.Seller 5.Pub Rec 8.Other			20.Industrial Bas			%		34.Softwood F&O		
3.Lender 6.MLS 9.			<b>Fract. Acre</b>	<b>Acreege/Sites</b>				35.Mixed Wood F&O		
			21.Developed Pave	21	0.36	100	%	0	36.Hardwood F&O	
			22.Undev Paved (F				%		37.Softwood TG	
			23.Developed Grav				%		38.Mixed Wood TG	
			<b>Acres</b>				%		39.Hardwood TG	
			24.Undev Gravel (				%		40.Wasteland	
			25.Comm Base Pave				%		41.Open Space	
			26.Comm Base Grav				%		42.Mobile Home Si	
			27.Backlot				%		43.Condo Site	
			28.Rear Land				%		44.Lot Improvemen	
			29.Pavement				%		45.Subdivision Lo	
				<b>Total Acreage</b>		0.36			46.Heavy Ind Sit	

## Washburn

Map Lot 011-128

Account 324

Location 12 JARDINE STREET

Card 1 Of 1 9/04/2024

Building Style	<b>2 Ranch</b>		SF Bsmt Living	<b>0</b>		Layout	<b>1 Typical</b>							
1.Conv.	5.Garrison	9.Gambrel	Fin Bsmt Grade	<b>0 0</b>		1.Typical	4.	7.						
2.Ranch	6.Salt Box	10.Other	OPEN 5 OPTIONAL	<b>0</b>		2.Inadeq	5.	8.						
3.R Ranch	7.Contemp	11.Split	Heat Type	<b>100% 1 Hot Water BB</b>		3.Poor	6.	9.						
4.Cape	8.Log	12.	1.HWBB	5.FWA	9.No Heat	Attic	<b>9 None</b>							
Dwelling Units	<b>1</b>		2.HWCI	6.GravWA	10.	1.1/4 Fin	4.Full Fin	7.						
Other Units	<b>0</b>		3.H Pump	7.Electric	11.	2.1/2 Fin	5.FI/Stair	8.						
Stories	<b>1 One Story</b>		4.Steam	8.FI/Wall	12.	3.3/4 Fin	6.	9.None						
1.1	4.1.5	7.	Cool Type	<b>0% 9 None</b>		Insulation	<b>1 Full</b>							
2.2	5.1.75	8.	1.Refrig	4.W&C Air	7.	1.Full	4.Minimal	7.						
3.3	6.2.5	9.	2.Evapor	5.	8.	2.Heavy	5.Partial	8.						
Exterior Walls	<b>2 Vinyl/Aluminum</b>		3.H Pump	6.	9.None	3.Capped	6.	9.None						
1.Wood	5.Stucco	9.T-111	Kitchen Style	<b>2 Typical</b>		Unfinished %	<b>0%</b>							
2.Vin/Al	6.Brick	10.Other	1.Modern	4.Obsolete	7.	Grade & Factor	<b>3 Average 105%</b>							
3.Compos.	7.Stone	11.	2.Typical	5.	8.	1.E Grade	4.B Grade	7.						
4.Asbestos	8.Concrete	12.	3.Old Type	6.	9.None	2.D Grade	5.A Grade	8.SC Grade						
Roof Surface	<b>1 Asphalt Shingles</b>		Bath(s) Style	<b>2 Typical Bath(s)</b>		3.C Grade	6.AA Grade	9.Same						
1.Asphalt	4.Composit	7.	1.Modern	4.Obsolete	7.	SQFT (Footprint)	<b>972</b>							
2.Slate	5.Wood	8.	2.Typical	5.	8.	Condition	<b>5 Above Average</b>							
3.Metal	6.Other	9.	3.Old Type	6.	9.None	1.Poor	4.Avg	7.V G						
SF Masonry Trim	<b>0</b>		# Rooms	<b>5</b>		2.Fair	5.Avg+	8.Exc						
OPEN-3-CUSTOM	<b>0</b>		# Bedrooms	<b>2</b>		3.Avg-	6.Good	9.Same						
OPEN-4-CUSTOM	<b>0</b>		# Full Baths	<b>1</b>		Phys. % Good	<b>0%</b>							
Year Built	<b>1960</b>		# Half Baths	<b>0</b>		Funct. % Good	<b>100%</b>							
Year Remodeled	<b>0</b>		# Addn Fixtures	<b>0</b>		Functional Code	<b>9 None</b>							
Foundation	<b>1 Concrete</b>		# Fireplaces	<b>0</b>		1.Incomp	4.Delap	7.No Power						
1.Concrete	4.Wood	7.							2.O-Built	5.Bsmt	8.LongTerm			
2.C Block	5.Slab	8.							Econ. % Good	<b>100%</b>		3.Damage	6.Common	9.None
3.Br/Stone	6.Piers	9.							Economic Code	<b>None</b>		0.None	3.No Power	7.
Basement	<b>4 Full Basement</b>								Entrance Code	<b>5 Estimated</b>		1.Location	4.Generate	8.
1.1/4 Bmt	4.Full Bmt	7.							1.Interior	4.Vacant	7.	2.Encroach	9.None	9.
2.1/2 Bmt	5.None	8.							2.Refusal	5.Estimate	8.	Information Code	<b>5 Estimate</b>	
3.3/4 Bmt	6.	9.None							3.Informed	6.Reviewed	9.	1.Owner	4.Agent	7.
Bsmt Gar # Cars	<b>0</b>								2.Relative	5.Estimate	8.	2.Relative	5.Estimate	8.
Wet Basement	<b>1 Dry Basement</b>								3.Tenant	6.Other	9.	3.Tenant	6.Other	9.
1.Dry	4.	7.												
2.Damp	5.	8.												
3.Wet	6.	9.												

Date Inspected 10/16/2018

### Additions, Outbuildings & Improvements

Type	Year	Units	Grade	Cond	Phys.	Funct.	Sound Value
20 1 Story/Bsmt	1975	160	9 100	9	0 %	100 %	
22 Encl Frame Porch	1980	150	2 115	4	0 %	100 %	
68 Wood Deck	1990	40	3 90	4	0 %	100 %	
24 Frame Shed	0				%	%	600
					%	%	
					%	%	
					%	%	
					%	%	
					%	%	
					%	%	
					%	%	

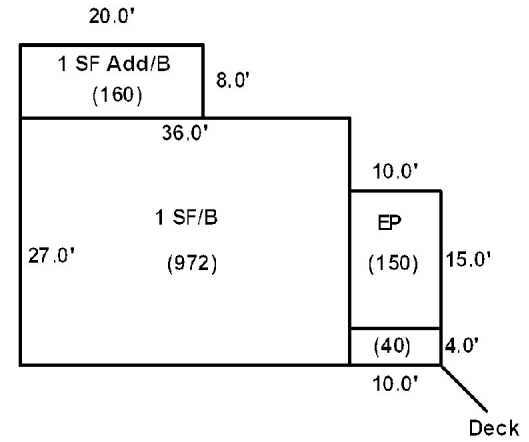

Shed SV \$600

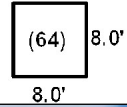



LEARNARD, HAROLD H M  
LEARNARD, DEBRA  
P.O. BOX 333  
WASHBURN ME 04786

B5514P129 B5514P132

Previous Owner  
LEARNARD, LOIS M.  
c/o MAVIS CHURCHILL  
52 BOG ROAD  
LIMESTONE ME 04750  
Sale Date: 2/03/2016

Previous Owner  
Learnard, Harold H.M.  
P.O. Box 333

Washburn ME 04786  
Sale Date: 9/19/2014

Previous Owner  
Learnard, Lois  
6 Dewberry Drive  
Apt. 241C  
Presque Isle ME 04769  
Sale Date: 7/12/2010

Inspection Witnessed By:

X Date

No./Date	Description	Date Insp.

Notes:

Washburn

Property Data			Assessment Record							
Neighborhood <b>1 Neighborhood One</b>			Year	Land	Buildings	Exempt	Total			
Tree Growth Year <b>0</b>			2012	4,300	57,900	8,800	53,400			
1ST MORTGAGE <b>0</b>			2013	5,600	57,900	8,800	54,700			
2ND MORTGAGE <b>0</b>			2015	5,600	57,900	0	63,500			
Zone/Land Use <b>1 Residential</b>			2018	5,600	57,900	18,400	45,100			
Secondary Zone			2019	9,800	61,600	20,000	51,400			
Topography <b>1 Level</b>			2020	9,800	61,600	25,000	46,400			
1.Level 4.Below St 7.LevelBog			2021	9,800	61,600	25,000	46,400			
2.Rolling 5.Low 8.			2022	9,800	64,700	25,000	49,500			
3.Above St 6.Swampy 9.			2023	12,500	76,800	25,000	64,300			
Utilities <b>2 Public Water 3 Public Sewer</b>			2024	12,500	76,800	25,000	64,300			
1.Public 4.Dr Well 7.Cesspool										
2.Water 5.Dug Well 8.										
3.Sewer 6.Septic 9.None										
Street <b>1 Paved</b>										
1.Paved 4.Proposed 7.										
2.Semi Imp 5.R/O/W 8.										
3.Gravel 6. 9.None										
TG PLAN YEAR <b>0</b>										
Tif District # <b>0</b>										
Sale Data			<b>Land Data</b>							
Sale Date <b>2/03/2016</b>			<b>Front Foot</b>	<b>Type</b>	<b>Effective</b>		<b>Influence</b>		<b>Influence Codes</b>	
Price <b>43,162</b>					Frontage	Depth	Factor	Code		
Sale Type <b>2 Land &amp; Buildings</b>				11.Regular Lot						1.Unimproved
1.Land 4.Mobile 7.C/I L&B				12.Delta Triangle						2.Excess Frtg
2.L & B 5.Other 8.				13.Nabla Triangle						3.Topography
3.Building 6.C/I Land 9.			14.Rear Land					4.Size/Shape		
Financing <b>1 Conventional</b>			15.Class I Road					5.Access		
1.Convent 4.Seller 7.			<b>Square Foot</b>	<b>Square Feet</b>				6.Restriction		
2.FHA/VA 5.Private 8.				29	600	100	%	0	7.Open Space	
3.Assumed 6.Cash 9.Unknown									8.View/Environ	
Validity <b>2 Related Parties</b>									9.Fract Share	
1.Valid 4.Split 7.Renovate									<b>Acres</b>	
2.Related 5.Partial 8.Other			16.Class II Road					30.Utility R O W		
3.Distress 6.Exempt 9.			17.Municipal Rese					31.Tillable		
Verified <b>5 Public Record</b>			18.Munic Sep Lago					32.Pasture		
1.Buyer 4.Agent 7.Family			19.Gravel Pit					33.Orchard		
2.Seller 5.Pub Rec 8.Other			20.Industrial Bas					34.Softwood F&O		
3.Lender 6.MLS 9.			<b>Fract. Acre</b>	<b>Acres/Sites</b>				35.Mixed Wood F&O		
				21	0.25	100	%	0	36.Hardwood F&O	
									37.Softwood TG	
									38.Mixed Wood TG	
									39.Hardwood TG	
			<b>Acres</b>					40.Wasteland		
				24.Undev Gravel (					41.Open Space	
				25.Comm Base Pave					42.Mobile Home Si	
				26.Comm Base Grav					43.Condo Site	
				27.Backlot					44.Lot Improvemen	
			28.Rear Land	<b>Total Acreage</b>		<b>0.25</b>		45.Subdivision Lo		
			29.Pavement					46.Heavy Ind Sit		



TOWN OF WASHBURN  
1287 MAIN STREET  
WASHBURN ME 04786

B4690P170

Previous Owner  
Pahl, Linda R. Zambri-

31 Wason Road  
Hudson NH 03051  
Sale Date: 1/01/2017

Previous Owner  
Ginn, Twaila Jo  
c/o Linda Pahn

Hudson NH 04732  
Sale Date: 4/21/2009

Previous Owner  
Lyons, Charles  
Twaila Jo Ginn  
P.O. Box 66  
Washburn ME 04781  
Sale Date: 5/05/2007

Inspection Witnessed By:

X	Date
No./Date	Description
	Date Insp.

Notes:  
\*2-14-2019 Dwelling was assessed as no value at time of reval due to delap. -20% for attached garage and -15% for delap.

Washburn

Property Data			Assessment Record						
Neighborhood <b>1 Neighborhood One</b>			Year	Land	Buildings	Exempt	Total		
Tree Growth Year <b>0</b>			2012	4,500	19,900	0	24,400		
1ST MORTGAGE <b>0</b>			2013	5,800	19,700	0	25,500		
2ND MORTGAGE <b>0</b>			2015	5,800	19,700	0	25,500		
Zone/Land Use <b>1 Residential</b>			2018	5,800	19,700	25,500	0		
Secondary Zone			2019	6,200	1,500	7,700	0		
Topography <b>1 Level</b>			2020	6,200	1,500	7,700	0		
1.Level 4.Below St 7.LevelBog			2021	6,200	0	6,200	0		
2.Rolling 5.Low 8.			2022	6,200	0	6,200	0		
3.Above St 6.Swampy 9.			2023	8,200	0	8,200	0		
Utilities <b>2 Public Water 3 Public Sewer</b>			2024	8,200	0	8,200	0		
1.Public 4.Dr Well 7.Cesspool									
2.Water 5.Dug Well 8.									
3.Sewer 6.Septic 9.None									
Street <b>1 Paved</b>									
1.Paved 4.Proposed 7.									
2.Semi Imp 5.R/O/W 8.									
3.Gravel 6. 9.None									
TG PLAN YEAR <b>0</b>									
Tif District # <b>0</b>									
Sale Data			<b>Land Data</b>						
Sale Date <b>1/01/2017</b>			<b>Front Foot</b>	<b>Type</b>	<b>Effective</b>		<b>Influence</b>		<b>Influence Codes</b>
Price					<b>Frontage</b>	<b>Depth</b>	<b>Factor</b>	<b>Code</b>	
Sale Type <b>2 Land &amp; Buildings</b>			11.Regular Lot					1.Unimproved	
1.Land 4.Mobile 7.C/I L&B			12.Delta Triangle			%		2.Excess Frtg	
2.L & B 5.Other 8.			13.Nabla Triangle			%		3.Topography	
3.Building 6.C/I Land 9.			14.Rear Land			%		4.Size/Shape	
Financing			15.Class I Road			%		5.Access	
1.Convent 4.Seller 7.						%		6.Restriction	
2.FHA/VA 5.Private 8.						%		7.Open Space	
3.Assumed 6.Cash 9.Unknown						%		8.View/Environ	
Validity						%		9.Fract Share	
1.Valid 4.Split 7.Renovate			<b>Square Foot</b>	<b>Square Feet</b>				30.Utility R O W	
2.Related 5.Partial 8.Other			16.Class II Road			%		31.Tillable	
3.Distress 6.Exempt 9.			17.Municipal Rese			%		32.Pasture	
Verified			18.Munic Sep Lago			%		33.Orchard	
1.Buyer 4.Agent 7.Family			19.Gravel Pit			%		34.Softwood F&O	
2.Seller 5.Pub Rec 8.Other			20.Industrial Bas			%		35.Mixed Wood F&O	
3.Lender 6.MLS 9.			<b>Fract. Acre</b>			%		36.Hardwood F&O	
			21.Developed Pave	21	0.14	100	%	0	
			22.Undev Paved (F			%		37.Softwood TG	
			23.Developed Grav			%		38.Mixed Wood TG	
			<b>Acres</b>			%		39.Hardwood TG	
			24.Undev Gravel (			%		40.Wasteland	
			25.Comm Base Pave			%		41.Open Space	
			26.Comm Base Grav			%		42.Mobile Home Si	
			27.Backlot			%		43.Condo Site	
			28.Rear Land			%		44.Lot Improvemen	
			29.Pavement			%		45.Subdivision Lo	
			<b>Total Acreage</b> 0.14						46.Heavy Ind Sit



1271 & 1273 MAIN ST, LLC  
c/o ANTHONY FASOLAS  
SANWOOD NJ 07023

B5084P232

Previous Owner  
SMITH, TODD  
4002 BROAD STREET

BROOKSVILLE FL 34604  
Sale Date: 7/19/2012

Previous Owner  
VAUGHAN, WAYNE E  
SMITH, TODD  
1500 SUNSET VILLAGE BLVD  
CLERMONT FL 34711  
Sale Date: 7/16/2012

Previous Owner  
Learnard, Harold H.  
P.O. Box 333

Washburn ME 04786  
Sale Date: 12/12/2011

Inspection Witnessed By:

X	Date
No./Date	Description
	Date Insp.

Notes:  
\*2-14-2019 50% functional on dwelling due to delap.

Washburn

Property Data			Assessment Record						
Neighborhood <b>1 Neighborhood One</b>			Year	Land	Buildings	Exempt	Total		
Tree Growth Year <b>0</b>			2012	5,800	25,100	0	30,900		
1ST MORTGAGE <b>0</b>			2013	7,500	25,100	0	32,600		
2ND MORTGAGE <b>0</b>			2015	7,500	25,100	0	32,600		
Zone/Land Use <b>1 Residential</b>			2018	7,500	15,900	0	23,400		
Secondary Zone			2019	7,600	20,100	0	27,700		
Topography <b>1 Level</b>			2020	7,600	20,100	0	27,700		
1.Level 4.Below St 7.LevelBog			2021	7,600	20,100	0	27,700		
2.Rolling 5.Low 8.			2022	7,600	21,200	0	28,800		
3.Above St 6.Swampy 9.			2023	10,000	25,200	0	35,200		
Utilities <b>2 Public Water 3 Public Sewer</b>			2024	10,000	25,200	0	35,200		
1.Public 4.Dr Well 7.Cesspool									
2.Water 5.Dug Well 8.									
3.Sewer 6.Septic 9.None									
Street <b>1 Paved</b>									
1.Paved 4.Proposed 7.									
2.Semi Imp 5.R/O/W 8.									
3.Gravel 6. 9.None									
TG PLAN YEAR <b>0</b>									
Tif District # <b>0</b>									
Sale Data			<b>Land Data</b>						
Sale Date <b>7/19/2012</b>			<b>Front Foot</b>	<b>Type</b>	<b>Effective</b>		<b>Influence</b>		<b>Influence Codes</b>
Price <b>28,000</b>					Frontage	Depth	Factor	Code	
Sale Type <b>2 Land &amp; Buildings</b>			11.Regular Lot					1.Unimproved	
1.Land 4.Mobile 7.C/I L&B			12.Delta Triangle					2.Excess Frtg	
2.L & B 5.Other 8.			13.Nabla Triangle					3.Topography	
3.Building 6.C/I Land 9.			14.Rear Land					4.Size/Shape	
Financing			15.Class I Road					5.Access	
1.Convent 4.Seller 7.								6.Restriction	
2.FHA/VA 5.Private 8.								7.Open Space	
3.Assumed 6.Cash 9.Unknown								8.View/Environ	
Validity <b>2 Related Parties</b>								9.Fract Share	
1.Valid 4.Split 7.Renovate			<b>Square Foot</b>	<b>Square Feet</b>				<b>Acres</b>	
2.Related 5.Partial 8.Other			16.Class II Road	29	500	50	%	0	
3.Distress 6.Exempt 9.			17.Municipal Rese						
Verified <b>5 Public Record</b>			18.Munic Sep Lago						
1.Buyer 4.Agent 7.Family			19.Gravel Pit						
2.Seller 5.Pub Rec 8.Other			20.Industrial Bas						
3.Lender 6.MLS 9.									
			<b>Fract. Acre</b>	<b>Acreege/Sites</b>					
			21.Developed Pave	21	0.18	100	%	0	
			22.Undev Paved (F						
			23.Developed Grav						
			<b>Acres</b>						
			24.Undev Gravel (						
			25.Comm Base Pave						
			26.Comm Base Grav						
			27.Backlot						
			28.Rear Land						
			29.Pavement						
			<b>Total Acreage</b>		<b>0.18</b>				
								44.Lot Improvemen	
								45.Subdivision Lo	
								46.Heavy Ind Sit	















**Washburn**

Map Lot 011-132

Account 873

Location ATV Trail

Card 1 Of 1 9/04/2024

Building Style <b>0</b>	SF Bsmt Living <b>0</b>	Layout <b>0</b>
1.Conv. 5.Garrison 9.Gambrel	Fin Bsmt Grade <b>0 0</b>	1.Typical 4. 7.
2.Ranch 6.Salt Box 10.Other	OPEN 5 OPTIONAL <b>0</b>	2.Inadeq 5. 8.
3.R Ranch 7.Contemp 11.Split	Heat Type <b>100% 0</b>	3.Poor 6. 9.
4.Cape 8.Log 12.	1.HWBB 5.FWA 9.No Heat	Attic <b>0</b>
Dwelling Units <b>0</b>	2.HWCI 6.GravWA 10.	1.1/4 Fin 4.Full Fin 7.
Other Units <b>0</b>	3.H Pump 7.Electric 11.	2.1/2 Fin 5.FI/Stair 8.
Stories <b>0</b>	4.Steam 8.FI/Wall 12.	3.3/4 Fin 6. 9.None
1.1 4.1.5 7.	Cool Type <b>0% 9 None</b>	Insulation <b>0</b>
2.2 5.1.75 8.	1.Refrig 4.W&C Air 7.	1.Full 4.Minimal 7.
3.3 6.2.5 9.	2.Evapor 5. 8.	2.Heavy 5.Partial 8.
Exterior Walls <b>0</b>	3.H Pump 6. 9.None	3.Capped 6. 9.None
1.Wood 5.Stucco 9.T-111	Kitchen Style <b>0</b>	Unfinished % <b>0%</b>
2.Vin/Al 6.Brick 10.Other	1.Modern 4.Obsolete 7.	Grade & Factor <b>0 0%</b>
3.Compos. 7.Stone 11.	2.Typical 5. 8.	1.E Grade 4.B Grade 7.
4.Asbestos 8.Concrete 12.	3.Old Type 6. 9.None	2.D Grade 5.A Grade 8.SC Grade
Roof Surface <b>0</b>	Bath(s) Style <b>0</b>	3.C Grade 6.AA Grade 9.Same
1.Asphalt 4.Composit 7.	1.Modern 4.Obsolete 7.	SQFT (Footprint) <b>0</b>
2.Slate 5.Wood 8.	2.Typical 5. 8.	Condition <b>0</b>
3.Metal 6.Other 9.	3.Old Type 6. 9.None	1.Poor 4.Avg 7.V G
SF Masonry Trim <b>0</b>	# Rooms <b>0</b>	2.Fair 5.Avg+ 8.Exc
OPEN-3-CUSTOM <b>0</b>	# Bedrooms <b>0</b>	3.Avg- 6.Good 9.Same
OPEN-4-CUSTOM <b>0</b>	# Full Baths <b>0</b>	Phys. % Good <b>0%</b>
Year Built <b>0</b>	# Half Baths <b>0</b>	Funct. % Good <b>100%</b>
Year Remodeled <b>0</b>	# Addn Fixtures <b>0</b>	Functional Code <b>9 None</b>
Foundation <b>0</b>	# Fireplaces <b>0</b>	1.Incomp 4.Delap 7.No Power
1.Concrete 4.Wood 7.		2.O-Built 5.Bsmt 8.LongTerm
2.C Block 5.Slab 8.		3.Damage 6.Common 9.None
3.Br/Stone 6.Piers 9.		Econ. % Good <b>100%</b>
Basement <b>0</b>		Economic Code <b>None</b>
1.1/4 Bmt 4.Full Bmt 7.		0.None 3.No Power 7.
2.1/2 Bmt 5.None 8.		1.Location 4.Generate 8.
3.3/4 Bmt 6. 9.None		2.Encroach 9.None 9.
Bsmt Gar # Cars <b>0</b>		Entrance Code <b>0</b>
Wet Basement <b>0</b>		1.Interior 4.Vacant 7.
1.Dry 4. 7.		2.Refusal 5.Estimate 8.
2.Damp 5. 8.	3.Informed 6.Reviewed 9.	
3.Wet 6. 9.	Information Code <b>0</b>	
		1.Owner 4.Agent 7.
		2.Relative 5.Estimate 8.
		3.Tenant 6.Other 9.

Date Inspected

Additions, Outbuildings & Improvements								1.One Story Fram
Type	Year	Units	Grade	Cond	Phys.	Funct.	Sound Value	2.Two Story Fram
					%	%		3.Three Story Fr
					%	%		4.1 & 1/2 Story
					%	%		5.1 & 3/4 Story
					%	%		6.2 & 1/2 Story
					%	%		21.Open Frame Por
					%	%		22.Encl Frame Por
					%	%		23.Frame Garage
					%	%		24.Frame Shed
					%	%		25.Frame Bay Wind
					%	%		26.1SFr Overhang
					%	%		27.Unfin Basement
					%	%		28.Unfinished Att
					%	%		29.Finished Attic

State of Maine  
Parks & Recreation Bureau  
Augusta ME

B2512P37

Inspection Witnessed By:

No./Date	Description	Date Insp.
X		

Notes:

Washburn

Property Data			Assessment Record						
Neighborhood <b>1 Neighborhood One</b>			Year	Land	Buildings	Exempt	Total		
Tree Growth Year <b>0</b>			2012	10,700	0	10,700	0		
1ST MORTGAGE <b>0</b>			2013	13,900	0	13,900	0		
2ND MORTGAGE <b>0</b>			2015	13,900	0	13,900	0		
Zone/Land Use <b>1 Residential</b>			2018	13,900	0	13,900	0		
Secondary Zone			2019	12,900	0	12,900	0		
Topography <b>2 Rolling</b>			2020	12,900	0	12,900	0		
1.Level 4.Below St 7.LevelBog			2021	12,900	0	12,900	0		
2.Rolling 5.Low 8.			2022	12,900	0	12,900	0		
3.Above St 6.Swampy 9.			2023	15,000	0	15,000	0		
Utilities			2024	15,000	0	15,000	0		
1.Public 4.Dr Well 7.Cesspool									
2.Water 5.Dug Well 8.									
3.Sewer 6.Septic 9.None									
Street									
1.Paved 4.Proposed 7.									
2.Semi Imp 5.R/O/W 8.									
3.Gravel 6. 9.None									
TG PLAN YEAR <b>0</b>									
Tif District # <b>0</b>									
Sale Data			<b>Land Data</b>						
Sale Date <b>10/30/1992</b>			<b>Front Foot</b>	<b>Type</b>	<b>Effective</b>		<b>Influence</b>		<b>Influence Codes</b>
Price					Frontage	Depth	Factor	Code	
Sale Type <b>1 Land Only</b>			11.Regular Lot					1.Unimproved	
1.Land 4.Mobile 7.C/I L&B			12.Delta Triangle			%		2.Excess Frtg	
2.L & B 5.Other 8.			13.Nabla Triangle			%		3.Topography	
3.Building 6.C/I Land 9.			14.Rear Land			%		4.Size/Shape	
Financing			15.Class I Road			%		5.Access	
1.Convent 4.Seller 7.						%		6.Restriction	
2.FHA/VA 5.Private 8.						%		7.Open Space	
3.Assumed 6.Cash 9.Unknown						%		8.View/Environ	
Validity						%		9.Fract Share	
1.Valid 4.Split 7.Renovate			<b>Square Foot</b>	<b>Square Feet</b>				<b>Acres</b>	
2.Related 5.Partial 8.Other			16.Class II Road			%		30.Utility R O W	
3.Distress 6.Exempt 9.			17.Municipal Rese			%		31.Tillable	
Verified <b>5 Public Record</b>			18.Munic Sep Lago			%		32.Pasture	
1.Buyer 4.Agent 7.Family			19.Gravel Pit			%		33.Orchard	
2.Seller 5.Pub Rec 8.Other			20.Industrial Bas			%		34.Softwood F&O	
3.Lender 6.MLS 9.			<b>Fract. Acre</b>	<b>Acreege/Sites</b>				35.Mixed Wood F&O	
			21.Developed Pave	28	25.78	100	%	0	36.Hardwood F&O
			22.Undev Paved (F				%		37.Softwood TG
			23.Developed Grav				%		38.Mixed Wood TG
			<b>Acres</b>				%		39.Hardwood TG
			24.Undev Gravel (				%		40.Wasteland
			25.Comm Base Pave				%		41.Open Space
			26.Comm Base Grav				%		42.Mobile Home Si
			27.Backlot				%		43.Condo Site
			28.Rear Land	<b>Total Acreege</b>		25.78			44.Lot Improvemen
			29.Pavement						45.Subdivision Lo
									46.Heavy Ind Sit

**Washburn**

Map Lot 011-133

Account 874

Location ATV Trail

Card 1 Of 1 9/04/2024

Building Style <b>0</b>	SF Bsmt Living <b>0</b>	Layout <b>0</b>
1.Conv. 5.Garrison 9.Gambrel	Fin Bsmt Grade <b>0 0</b>	1.Typical 4. 7.
2.Ranch 6.Salt Box 10.Other	OPEN 5 OPTIONAL <b>0</b>	2.Inadeq 5. 8.
3.R Ranch 7.Contemp 11.Split	Heat Type <b>100% 0</b>	3.Poor 6. 9.
4.Cape 8.Log 12.	1.HWBB 5.FWA 9.No Heat	Attic <b>0</b>
Dwelling Units <b>0</b>	2.HWCI 6.GravWA 10.	1.1/4 Fin 4.Full Fin 7.
Other Units <b>0</b>	3.H Pump 7.Electric 11.	2.1/2 Fin 5.F/Stair 8.
Stories <b>0</b>	4.Steam 8.F/Wall 12.	3.3/4 Fin 6. 9.None
1.1 4.1.5 7.	Cool Type <b>0% 9 None</b>	Insulation <b>0</b>
2.2 5.1.75 8.	1.Refrig 4.W&C Air 7.	1.Full 4.Minimal 7.
3.3 6.2.5 9.	2.Evapor 5. 8.	2.Heavy 5.Partial 8.
Exterior Walls <b>0</b>	3.H Pump 6. 9.None	3.Capped 6. 9.None
1.Wood 5.Stucco 9.T-111	Kitchen Style <b>0</b>	Unfinished % <b>0%</b>
2.Vin/Al 6.Brick 10.Other	1.Modern 4.Obsolete 7.	Grade & Factor <b>0 0%</b>
3.Compos. 7.Stone 11.	2.Typical 5. 8.	1.E Grade 4.B Grade 7.
4.Asbestos 8.Concrete 12.	3.Old Type 6. 9.None	2.D Grade 5.A Grade 8.SC Grade
Roof Surface <b>0</b>	Bath(s) Style <b>0</b>	3.C Grade 6.AA Grade 9.Same
1.Asphalt 4.Composit 7.	1.Modern 4.Obsolete 7.	SQFT (Footprint) <b>0</b>
2.Slate 5.Wood 8.	2.Typical 5. 8.	Condition <b>0</b>
3.Metal 6.Other 9.	3.Old Type 6. 9.None	1.Poor 4.Avg 7.V G
SF Masonry Trim <b>0</b>	# Rooms <b>0</b>	2.Fair 5.Avg+ 8.Exc
OPEN-3-CUSTOM <b>0</b>	# Bedrooms <b>0</b>	3.Avg- 6.Good 9.Same
OPEN-4-CUSTOM <b>0</b>	# Full Baths <b>0</b>	Phys. % Good <b>0%</b>
Year Built <b>0</b>	# Half Baths <b>0</b>	Funct. % Good <b>100%</b>
Year Remodeled <b>0</b>	# Addn Fixtures <b>0</b>	Functional Code <b>9 None</b>
Foundation <b>0</b>	# Fireplaces <b>0</b>	1.Incomp 4.Delap 7.No Power
1.Concrete 4.Wood 7.		2.O-Built 5.Bsmt 8.LongTerm
2.C Block 5.Slab 8.		3.Damage 6.Common 9.None
3.Br/Stone 6.Piers 9.		Econ. % Good <b>100%</b>
Basement <b>0</b>		Economic Code <b>None</b>
1.1/4 Bmt 4.Full Bmt 7.		0.None 3.No Power 7.
2.1/2 Bmt 5.None 8.		1.Location 4.Generate 8.
3.3/4 Bmt 6. 9.None		2.Encroach 9.None 9.
Bsmt Gar # Cars <b>0</b>		Entrance Code <b>0</b>
Wet Basement <b>0</b>		1.Interior 4.Vacant 7.
1.Dry 4. 7.		2.Refusal 5.Estimate 8.
2.Damp 5. 8.	3.Informed 6.Reviewed 9.	
3.Wet 6. 9.	Information Code <b>0</b>	
		1.Owner 4.Agent 7.
		2.Relative 5.Estimate 8.
		3.Tenant 6.Other 9.

Date Inspected

Additions, Outbuildings & Improvements								
Type	Year	Units	Grade	Cond	Phys.	Funct.	Sound Value	
					%	%		1.One Story Fram
					%	%		2.Two Story Fram
					%	%		3.Three Story Fr
					%	%		4.1 & 1/2 Story
					%	%		5.1 & 3/4 Story
					%	%		6.2 & 1/2 Story
					%	%		21.Open Frame Por
					%	%		22.Encl Frame Por
					%	%		23.Frame Garage
					%	%		24.Frame Shed
					%	%		25.Frame Bay Wind
					%	%		26.1SFr Overhang
					%	%		27.Unfin Basement
					%	%		28.Unfinished Att
					%	%		29.Finished Attic



**Washburn**

Map Lot 011-133A

Account 236

Location 20 STATION ROAD

Card 1 Of 1 9/04/2024

Building Style <b>0</b>	SF Bsmt Living <b>0</b>	Layout <b>0</b>
1.Conv. 5.Garrison 9.Gambrel	Fin Bsmt Grade <b>0 0</b>	1.Typical 4. 7.
2.Ranch 6.Salt Box 10.Other	OPEN 5 OPTIONAL <b>0</b>	2.Inadeq 5. 8.
3.R Ranch 7.Contemp 11.Split	Heat Type <b>100% 0</b>	3.Poor 6. 9.
4.Cape 8.Log 12.	1.HWBB 5.FWA 9.No Heat	Attic <b>0</b>
Dwelling Units <b>0</b>	2.HWCI 6.GravWA 10.	1.1/4 Fin 4.Full Fin 7.
Other Units <b>0</b>	3.H Pump 7.Electric 11.	2.1/2 Fin 5.FI/Stair 8.
Stories <b>0</b>	4.Steam 8.FI/Wall 12.	3.3/4 Fin 6. 9.None
1.1 4.1.5 7.	Cool Type <b>0% 9 None</b>	Insulation <b>0</b>
2.2 5.1.75 8.	1.Refrig 4.W&C Air 7.	1.Full 4.Minimal 7.
3.3 6.2.5 9.	2.Evapor 5. 8.	2.Heavy 5.Partial 8.
Exterior Walls <b>0</b>	3.H Pump 6. 9.None	3.Capped 6. 9.None
1.Wood 5.Stucco 9.T-111	Kitchen Style <b>0</b>	Unfinished % <b>0%</b>
2.Vin/Al 6.Brick 10.Other	1.Modern 4.Obsolete 7.	Grade & Factor <b>0 0%</b>
3.Compos. 7.Stone 11.	2.Typical 5. 8.	1.E Grade 4.B Grade 7.
4.Asbestos 8.Concrete 12.	3.Old Type 6. 9.None	2.D Grade 5.A Grade 8.SC Grade
Roof Surface <b>0</b>	Bath(s) Style <b>0</b>	3.C Grade 6.AA Grade 9.Same
1.Asphalt 4.Composit 7.	1.Modern 4.Obsolete 7.	SQFT (Footprint) <b>0</b>
2.Slate 5.Wood 8.	2.Typical 5. 8.	Condition <b>0</b>
3.Metal 6.Other 9.	3.Old Type 6. 9.None	1.Poor 4.Avg 7.V G
SF Masonry Trim <b>0</b>	# Rooms <b>0</b>	2.Fair 5.Avg+ 8.Exc
OPEN-3-CUSTOM <b>0</b>	# Bedrooms <b>0</b>	3.Avg- 6.Good 9.Same
OPEN-4-CUSTOM <b>0</b>	# Full Baths <b>0</b>	Phys. % Good <b>0%</b>
Year Built <b>0</b>	# Half Baths <b>0</b>	Funct. % Good <b>100%</b>
Year Remodeled <b>0</b>	# Addn Fixtures <b>0</b>	Functional Code <b>9 None</b>
Foundation <b>0</b>	# Fireplaces <b>0</b>	1.Incomp 4.Delap 7.No Power
1.Concrete 4.Wood 7.		2.O-Built 5.Bsmt 8.LongTerm
2.C Block 5.Slab 8.		3.Damage 6.Common 9.None
3.Br/Stone 6.Piers 9.		Econ. % Good <b>100%</b>
Basement <b>0</b>		Economic Code <b>None</b>
1.1/4 Bmt 4.Full Bmt 7.		0.None 3.No Power 7.
2.1/2 Bmt 5.None 8.		1.Location 4.Generate 8.
3.3/4 Bmt 6. 9.None		2.Encroach 9.None 9.
Bsmt Gar # Cars <b>0</b>		Entrance Code <b>0</b>
Wet Basement <b>0</b>		1.Interior 4.Vacant 7.
1.Dry 4. 7.		2.Refusal 5.Estimate 8.
2.Damp 5. 8.	3.Informed 6.Reviewed 9.	
3.Wet 6. 9.	Information Code <b>0</b>	
		1.Owner 4.Agent 7.
		2.Relative 5.Estimate 8.
		3.Tenant 6.Other 9.

Date Inspected

**Additions, Outbuildings & Improvements**

Type	Year	Units	Grade	Cond	Phys.	Funct.	Sound Value
					%	%	1.One Story Fram
					%	%	2.Two Story Fram
					%	%	3.Three Story Fr
					%	%	4.1 & 1/2 Story
					%	%	5.1 & 3/4 Story
					%	%	6.2 & 1/2 Story
					%	%	21.Open Frame Por
					%	%	22.Encl Frame Por
					%	%	23.Frame Garage
					%	%	24.Frame Shed
					%	%	25.Frame Bay Wind
					%	%	26.1SFr Overhang
					%	%	27.Unfin Basement
					%	%	28.Unfinished Att
					%	%	29.Finished Attic



Washburn Beaver ATV Club  
20 Station Road  
Washburn ME 04786

			Property Data			Assessment Record					
			Neighborhood	1 Neighborhood One		Year	Land	Buildings	Exempt	Total	
			Tree Growth Year 0			2020	0	21,500	0	21,500	
			1ST MORTGAGE 0			2021	0	21,500	0	21,500	
			2ND MORTGAGE 0			2022	0	22,600	0	22,600	
			Zone/Land Use 2 Commercial			2023	0	26,900	0	26,900	
			Secondary Zone			2024	0	26,900	0	26,900	
			Topography 2 Rolling								
			1.Level 4.Below St 7.LevelBog								
			2.Rolling 5.Low 8.								
			3.Above St 6.Swampy 9.								
			Utilities								
			1.Public 4.Dr Well 7.Cesspool								
			2.Water 5.Dug Well 8.								
			3.Sewer 6.Septic 9.None								
			Street 1 Paved								
			1.Paved 4.Proposed 7.								
			2.Semi Imp 5.R/O/W 8.								
			3.Gravel 6. 9.None								
			TG PLAN YEAR 0								
Inspection Witnessed By:			Tif District # 0								
			Sale Data								
X			Sale Date								
			Price								
No./Date			Sale Type								
			1.Land 4.Mobile 7.C/I L&B								
Description			2.L & B 5.Other 8.								
			3.Building 6.C/I Land 9.								
Date Insp.			Financing								
			1.Convent 4.Seller 7.								
			2.FHA/VA 5.Private 8.								
			3.Assumed 6.Cash 9.Unknown								
			Validity								
			1.Valid 4.Split 7.Renovate								
			2.Related 5.Partial 8.Other								
			3.Distress 6.Exempt 9.								
			Verified								
			1.Buyer 4.Agent 7.Family								
			2.Seller 5.Pub Rec 8.Other								
			3.Lender 6.MLS 9.								
						Land Data					
						Front Foot			Influence Codes		
						Type			Effective		
						Frontage			Depth		
						Factor			Code		
						11.Regular Lot			1.Unimproved		
						12.Delta Triangle			2.Excess Frtg		
						13.Nabla Triangle			3.Topography		
						14.Rear Land			4.Size/Shape		
						15.Class I Road			5.Access		
									6.Restriction		
									7.Open Space		
									8.View/Environ		
									9.Fract Share		
									Acres		
									30.Utility R O W		
									31.Tillable		
									32.Pasture		
									33.Orchard		
									34.Softwood F&O		
									35.Mixed Wood F&O		
									36.Hardwood F&O		
									37.Softwood TG		
									38.Mixed Wood TG		
									39.Hardwood TG		
									40.Wasteland		
									41.Open Space		
									42.Mobile Home Si		
									43.Condo Site		
									44.Lot Improvemen		
									45.Subdivision Lo		
									46.Heavy Ind Sit		
						Square Foot			Square Feet		
						16.Class II Road					
						17.Municipal Rese					
						18.Munic Sep Lago					
						19.Gravel Pit					
						20.Industrial Bas					
						Fract. Acre			Acreage/Sites		
						21.Developed Pave					
						22.Undev Paved (F					
						23.Developed Grav					
						Acres					
						24.Undev Gravel (					
						25.Comm Base Pave					
						26.Comm Base Grav					
						27.Backlot					
						28.Rear Land					
						29.Pavement					
						Total Acreage			0.00		

Inspection Witnessed By:

No./Date	Description	Date Insp.

Notes:  
\* Added garage to property for 2020.

**Washburn**

Map Lot 011-133-ON

Account 1139

Location 20 Station Road

Card 1 Of 1 9/04/2024

Building Style	SF Bsmt Living	Layout
1.Conv. 5.Garrison 9.Gambrel	Fin Bsmt Grade	1.Typical 4. 7.
2.Ranch 6.Salt Box 10.Other	OPEN 5 OPTIONAL	2.Inadeq 5. 8.
3.R Ranch 7.Contemp 11.Split	Heat Type <b>100%</b>	3.Poor 6. 9.
4.Cape 8.Log 12.	1.HWBB 5.FWA 9.No Heat	Attic
Dwelling Units	2.HWCI 6.GravWA 10.	1.1/4 Fin 4.Full Fin 7.
Other Units	3.H Pump 7.Electric 11.	2.1/2 Fin 5.F/Stair 8.
Stories	4.Steam 8.F/Wall 12.	3.3/4 Fin 6. 9.None
1.1 4.1.5 7.	Cool Type <b>0%</b>	Insulation
2.2 5.1.75 8.	1.Refrig 4.W&C Air 7.	1.Full 4.Minimal 7.
3.3 6.2.5 9.	2.Evapor 5. 8.	2.Heavy 5.Partial 8.
Exterior Walls	3.H Pump 6. 9.None	3.Capped 6. 9.None
1.Wood 5.Stucco 9.T-111	Kitchen Style	Unfinished %
2.Vin/Al 6.Brick 10.Other	1.Modern 4.Obsolete 7.	Grade & Factor
3.Compos. 7.Stone 11.	2.Typical 5. 8.	1.E Grade 4.B Grade 7.
4.Asbestos 8.Concrete 12.	3.Old Type 6. 9.None	2.D Grade 5.A Grade 8.SC Grade
Roof Surface	Bath(s) Style	3.C Grade 6.AA Grade 9.Same
1.Asphalt 4.Composit 7.	1.Modern 4.Obsolete 7.	SQFT (Footprint)
2.Slate 5.Wood 8.	2.Typical 5. 8.	Condition
3.Metal 6.Other 9.	3.Old Type 6. 9.None	1.Poor 4.Avg 7.V G
SF Masonry Trim	# Rooms	2.Fair 5.Avg+ 8.Exc
OPEN-3-CUSTOM	# Bedrooms	3.Avg- 6.Good 9.Same
OPEN-4-CUSTOM	# Full Baths	Phys. % Good
Year Built	# Half Baths	Funct. % Good
Year Remodeled	# Addn Fixtures	Functional Code
Foundation	# Fireplaces	1.Incomp 4.Delap 7.No Power
1.Concrete 4.Wood 7.		2.O-Built 5.Bsmt 8.LongTerm
2.C Block 5.Slab 8.		3.Damage 6.Common 9.None
3.Br/Stone 6.Piers 9.		Econ. % Good
Basement		Economic Code
1.1/4 Bmt 4.Full Bmt 7.		0.None 3.No Power 7.
2.1/2 Bmt 5.None 8.		1.Location 4.Generate 8.
3.3/4 Bmt 6. 9.None		2.Encroach 9.None 9.
Bsmt Gar # Cars		Entrance Code <b>5 Estimated</b>
Wet Basement		1.Interior 4.Vacant 7.
1.Dry 4. 7.		2.Refusal 5.Estimate 8.
2.Damp 5. 8.	3.Informed 6.Reviewed 9.	
3.Wet 6. 9.	Information Code <b>5 Estimate</b>	
	1.Owner 4.Agent 7.	
	2.Relative 5.Estimate 8.	
	3.Tenant 6.Other 9.	

Date Inspected 7/01/2020

**Additions, Outbuildings & Improvements**

Type	Year	Units	Grade	Cond	Phys.	Funct.	Sound Value
23 Frame Garage	2019	1280	3 100	4	0 %	100 %	
					%	%	
					%	%	
					%	%	
					%	%	
					%	%	
					%	%	
					%	%	
					%	%	
					%	%	
					%	%	
					%	%	

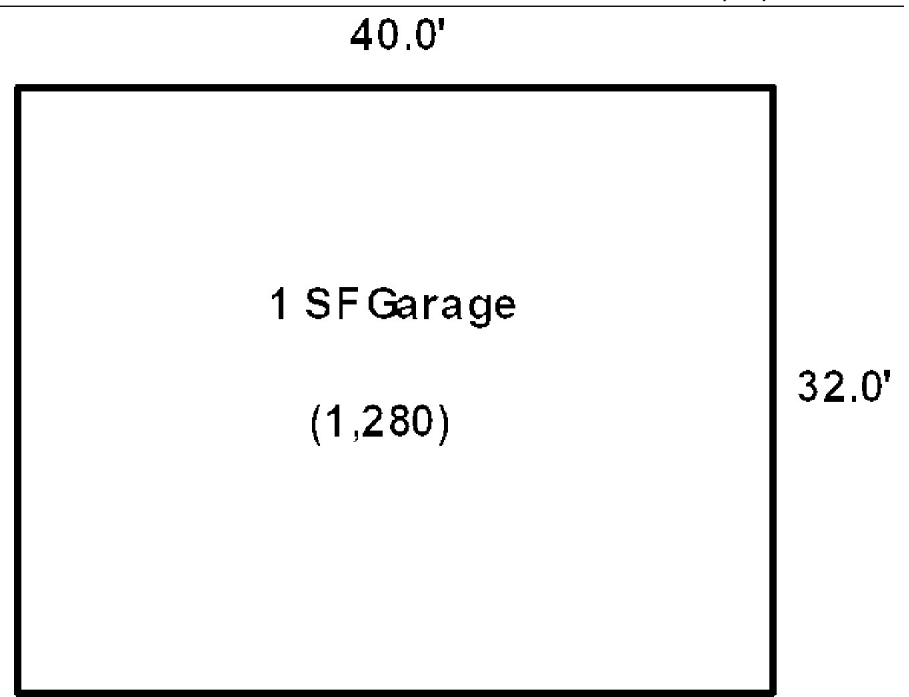

- 1.One Story Fram
- 2.Two Story Fram
- 3.Three Story Fr
- 4.1 & 1/2 Story
- 5.1 & 3/4 Story
- 6.2 & 1/2 Story
- 21.Open Frame Por
- 22.Encl Frame Por
- 23.Frame Garage
- 24.Frame Shed
- 25.Frame Bay Wind
- 26.1SFr Overhang
- 27.Unfin Basement
- 28.Unfinished Att
- 29.Finished Attic



**Washburn**

Map Lot 011-134

Account 925

Location Gould Street

Card 1 Of 1 9/04/2024

Building Style <b>0</b>	SF Bsmt Living <b>0</b>	Layout <b>0</b>
1.Conv. 5.Garrison 9.Gambrel	Fin Bsmt Grade <b>0 0</b>	1.Typical 4. 7.
2.Ranch 6.Salt Box 10.Other	OPEN 5 OPTIONAL <b>0</b>	2.Inadeq 5. 8.
3.R Ranch 7.Contemp 11.Split	Heat Type <b>100% 0</b>	3.Poor 6. 9.
4.Cape 8.Log 12.	1.HWBB 5.FWA 9.No Heat	Attic <b>0</b>
Dwelling Units <b>0</b>	2.HWCI 6.GravWA 10.	1.1/4 Fin 4.Full Fin 7.
Other Units <b>0</b>	3.H Pump 7.Electric 11.	2.1/2 Fin 5.F/Stair 8.
Stories <b>0</b>	4.Steam 8.F/Wall 12.	3.3/4 Fin 6. 9.None
1.1 4.1.5 7.	Cool Type <b>0% 9 None</b>	Insulation <b>0</b>
2.2 5.1.75 8.	1.Refrig 4.W&C Air 7.	1.Full 4.Minimal 7.
3.3 6.2.5 9.	2.Evapor 5. 8.	2.Heavy 5.Partial 8.
Exterior Walls <b>0</b>	3.H Pump 6. 9.None	3.Capped 6. 9.None
1.Wood 5.Stucco 9.T-111	Kitchen Style <b>0</b>	Unfinished % <b>0%</b>
2.Vin/Al 6.Brick 10.Other	1.Modern 4.Obsolete 7.	Grade & Factor <b>0 0%</b>
3.Compos. 7.Stone 11.	2.Typical 5. 8.	1.E Grade 4.B Grade 7.
4.Asbestos 8.Concrete 12.	3.Old Type 6. 9.None	2.D Grade 5.A Grade 8.SC Grade
Roof Surface <b>0</b>	Bath(s) Style <b>0</b>	3.C Grade 6.AA Grade 9.Same
1.Asphalt 4.Composit 7.	1.Modern 4.Obsolete 7.	SQFT (Footprint) <b>0</b>
2.Slate 5.Wood 8.	2.Typical 5. 8.	Condition <b>0</b>
3.Metal 6.Other 9.	3.Old Type 6. 9.None	1.Poor 4.Avg 7.V G
SF Masonry Trim <b>0</b>	# Rooms <b>0</b>	2.Fair 5.Avg+ 8.Exc
OPEN-3-CUSTOM <b>0</b>	# Bedrooms <b>0</b>	3.Avg- 6.Good 9.Same
OPEN-4-CUSTOM <b>0</b>	# Full Baths <b>0</b>	Phys. % Good <b>0%</b>
Year Built <b>0</b>	# Half Baths <b>0</b>	Funct. % Good <b>100%</b>
Year Remodeled <b>0</b>	# Addn Fixtures <b>0</b>	Functional Code <b>9 None</b>
Foundation <b>0</b>	# Fireplaces <b>0</b>	1.Incomp 4.Delap 7.No Power
1.Concrete 4.Wood 7.		2.O-Built 5.Bsmt 8.LongTerm
2.C Block 5.Slab 8.		3.Damage 6.Common 9.None
3.Br/Stone 6.Piers 9.		Econ. % Good <b>100%</b>
Basement <b>0</b>		Economic Code <b>None</b>
1.1/4 Bmt 4.Full Bmt 7.		0.None 3.No Power 7.
2.1/2 Bmt 5.None 8.		1.Location 4.Generate 8.
3.3/4 Bmt 6. 9.None		2.Encroach 9.None 9.
Bsmt Gar # Cars <b>0</b>		Entrance Code <b>0</b>
Wet Basement <b>0</b>		1.Interior 4.Vacant 7.
1.Dry 4. 7.		2.Refusal 5.Estimate 8.
2.Damp 5. 8.	3.Informed 6.Reviewed 9.	
3.Wet 6. 9.	Information Code <b>0</b>	
		1.Owner 4.Agent 7.
		2.Relative 5.Estimate 8.
		3.Tenant 6.Other 9.

Date Inspected

**Additions, Outbuildings & Improvements**

Type	Year	Units	Grade	Cond	Phys.	Funct.	Sound Value
					%	%	1.One Story Fram
					%	%	2.Two Story Fram
					%	%	3.Three Story Fr
					%	%	4.1 & 1/2 Story
					%	%	5.1 & 3/4 Story
					%	%	6.2 & 1/2 Story
					%	%	21.Open Frame Por
					%	%	22.Encl Frame Por
					%	%	23.Frame Garage
					%	%	24.Frame Shed
					%	%	25.Frame Bay Wind
					%	%	26.1SFr Overhang
					%	%	27.Unfin Basement
					%	%	28.Unfinished Att
					%	%	29.Finished Attic

COUNTRY FARMS PROPERTIES, INC.  
P.O. BOX 72  
WASHBURN ME 04786

B5607P69

Previous Owner  
Johnston, Charles  
113 Fleetwood Street

Presque Isle ME 04786  
Sale Date: 11/10/2016

Inspection Witnessed By:

X Date

No./Date	Description	Date Insp.

Notes:

Washburn

Property Data			Assessment Record						
Neighborhood <b>1 Neighborhood One</b>			Year	Land	Buildings	Exempt	Total		
Tree Growth Year <b>0</b>			2012	2,900	0	0	2,900		
1ST MORTGAGE <b>0</b>			2013	3,700	0	0	3,700		
2ND MORTGAGE <b>0</b>			2015	3,700	0	0	3,700		
Zone/Land Use <b>2 Commercial</b>			2018	3,700	0	0	3,700		
Secondary Zone			2019	3,200	0	0	3,200		
Topography <b>2 Rolling</b>			2020	3,200	0	0	3,200		
1.Level 4.Below St 7.LevelBog			2021	3,200	0	0	3,200		
2.Rolling 5.Low 8.			2022	3,200	0	0	3,200		
3.Above St 6.Swampy 9.			2023	3,600	0	0	3,600		
Utilities			2024	3,600	0	0	3,600		
1.Public 4.Dr Well 7.Cesspool									
2.Water 5.Dug Well 8.									
3.Sewer 6.Septic 9.None									
Street <b>3 Gravel</b>									
1.Paved 4.Proposed 7.			<b>Land Data</b>						
2.Semi Imp 5.R/O/W 8.									
3.Gravel 6. 9.None			<b>Front Foot</b>	<b>Type</b>	<b>Effective</b>		<b>Influence</b>		<b>Influence Codes</b>
TG PLAN YEAR <b>0</b>			11.Regular Lot		<b>Frontage</b>	<b>Depth</b>	<b>Factor</b>	<b>Code</b>	
Tif District # <b>0</b>			12.Delta Triangle				%		1.Unimproved
<b>Sale Data</b>			13.Nabla Triangle				%		2.Excess Frtg
Sale Date <b>11/10/2016</b>			14.Rear Land				%		3.Topography
Price <b>2,700</b>			15.Class I Road				%		4.Size/Shape
Sale Type <b>1 Land Only</b>							%		5.Access
1.Land 4.Mobile 7.C/I L&B			<b>Square Foot</b>	<b>Square Feet</b>					6.Restriction
2.L & B 5.Other 8.			16.Class II Road				%		7.Open Space
3.Building 6.C/I Land 9.			17.Municipal Rese				%		8.View/Environ
Financing			18.Munic Sep Lago				%		9.Fract Share
1.Convent 4.Seller 7.			19.Gravel Pit				%		<b>Acres</b>
2.FHA/VA 5.Private 8.			20.Industrial Bas				%		30.Utility R O W
3.Assumed 6.Cash 9.Unknown							%		31.Tillable
Validity <b>1 Arms Length Sale</b>			<b>Fract. Acre</b>	<b>Acreege/Sites</b>					32.Pasture
1.Valid 4.Split 7.Renovate			21.Developed Pave	26	0.11	100	%	0	33.Orchard
2.Related 5.Partial 8.Other			22.Undev Paved (F				%		34.Softwood F&O
3.Distress 6.Exempt 9.			23.Developed Grav				%		35.Mixed Wood F&O
Verified <b>5 Public Record</b>			<b>Acres</b>				%		36.Hardwood F&O
1.Buyer 4.Agent 7.Family			24.Undev Gravel (				%		37.Softwood TG
2.Seller 5.Pub Rec 8.Other			25.Comm Base Pave				%		38.Mixed Wood TG
3.Lender 6.MLS 9.			26.Comm Base Grav				%		39.Hardwood TG
			27.Backlot				%		40.Wasteland
			28.Rear Land				%		41.Open Space
			29.Pavement				%		42.Mobile Home Si
			<b>Total Acreage</b>		<b>0.11</b>				43.Condo Site
									44.Lot Improvemen
									45.Subdivision Lo
									46.Heavy Ind Sit

**Washburn**

Map Lot 011-134A

Account 569

Location GOULD STREET

Card 1 Of 1 9/04/2024

Building Style <b>0</b>	SF Bsmt Living <b>0</b>	Layout <b>0</b>
1.Conv. 5.Garrison 9.Gambrel	Fin Bsmt Grade <b>0 0</b>	1.Typical 4. 7.
2.Ranch 6.Salt Box 10.Other	OPEN 5 OPTIONAL <b>0</b>	2.Inadeq 5. 8.
3.R Ranch 7.Contemp 11.Split	Heat Type <b>100% 0</b>	3.Poor 6. 9.
4.Cape 8.Log 12.	1.HWBB 5.FWA 9.No Heat	Attic <b>0</b>
Dwelling Units <b>0</b>	2.HWCI 6.GravWA 10.	1.1/4 Fin 4.Full Fin 7.
Other Units <b>0</b>	3.H Pump 7.Electric 11.	2.1/2 Fin 5.F/Stair 8.
Stories <b>0</b>	4.Steam 8.F/Wall 12.	3.3/4 Fin 6. 9.None
1.1 4.1.5 7.	Cool Type <b>0% 9 None</b>	Insulation <b>0</b>
2.2 5.1.75 8.	1.Refrig 4.W&C Air 7.	1.Full 4.Minimal 7.
3.3 6.2.5 9.	2.Evapor 5. 8.	2.Heavy 5.Partial 8.
Exterior Walls <b>0</b>	3.H Pump 6. 9.None	3.Capped 6. 9.None
1.Wood 5.Stucco 9.T-111	Kitchen Style <b>0</b>	Unfinished % <b>0%</b>
2.Vin/Al 6.Brick 10.Other	1.Modern 4.Obsolete 7.	Grade & Factor <b>0 0%</b>
3.Compos. 7.Stone 11.	2.Typical 5. 8.	1.E Grade 4.B Grade 7.
4.Asbestos 8.Concrete 12.	3.Old Type 6. 9.None	2.D Grade 5.A Grade 8.SC Grade
Roof Surface <b>0</b>	Bath(s) Style <b>0</b>	3.C Grade 6.AA Grade 9.Same
1.Asphalt 4.Composit 7.	1.Modern 4.Obsolete 7.	SQFT (Footprint) <b>0</b>
2.Slate 5.Wood 8.	2.Typical 5. 8.	Condition <b>0</b>
3.Metal 6.Other 9.	3.Old Type 6. 9.None	1.Poor 4.Avg 7.V G
SF Masonry Trim <b>0</b>	# Rooms <b>0</b>	2.Fair 5.Avg+ 8.Exc
OPEN-3-CUSTOM <b>0</b>	# Bedrooms <b>0</b>	3.Avg- 6.Good 9.Same
OPEN-4-CUSTOM <b>0</b>	# Full Baths <b>0</b>	Phys. % Good <b>0%</b>
Year Built <b>0</b>	# Half Baths <b>0</b>	Funct. % Good <b>100%</b>
Year Remodeled <b>0</b>	# Addn Fixtures <b>0</b>	Functional Code <b>9 None</b>
Foundation <b>0</b>	# Fireplaces <b>0</b>	1.Incomp 4.Delap 7.No Power
1.Concrete 4.Wood 7.		2.O-Built 5.Bsmt 8.LongTerm
2.C Block 5.Slab 8.		3.Damage 6.Common 9.None
3.Br/Stone 6.Piers 9.		Econ. % Good <b>100%</b>
Basement <b>0</b>		Economic Code <b>None</b>
1.1/4 Bmt 4.Full Bmt 7.		0.None 3.No Power 7.
2.1/2 Bmt 5.None 8.		1.Location 4.Generate 8.
3.3/4 Bmt 6. 9.None		2.Encroach 9.None 9.
Bsmt Gar # Cars <b>0</b>		Entrance Code <b>0</b>
Wet Basement <b>0</b>		1.Interior 4.Vacant 7.
1.Dry 4. 7.		2.Refusal 5.Estimate 8.
2.Damp 5. 8.	3.Informed 6.Reviewed 9.	
3.Wet 6. 9.	Information Code <b>0</b>	
		1.Owner 4.Agent 7.
		2.Relative 5.Estimate 8.
		3.Tenant 6.Other 9.

Date Inspected

Additions, Outbuildings & Improvements								
Type	Year	Units	Grade	Cond	Phys.	Funct.	Sound Value	
					%	%		1.One Story Fram
					%	%		2.Two Story Fram
					%	%		3.Three Story Fr
					%	%		4.1 & 1/2 Story
					%	%		5.1 & 3/4 Story
					%	%		6.2 & 1/2 Story
					%	%		21.Open Frame Por
					%	%		22.Encl Frame Por
					%	%		23.Frame Garage
					%	%		24.Frame Shed
					%	%		25.Frame Bay Wind
					%	%		26.1SFr Overhang
					%	%		27.Unfin Basement
					%	%		28.Unfinished Att
					%	%		29.Finished Attic



**Washburn**

Map Lot 011-134B

Account 5

Location MAIN STREET

Card 1 Of 1 9/04/2024

Building Style <b>0</b>	SF Bsmt Living <b>0</b>	Layout <b>0</b>
1.Conv. 5.Garrison 9.Gambrel	Fin Bsmt Grade <b>0 0</b>	1.Typical 4. 7.
2.Ranch 6.Salt Box 10.Other	OPEN 5 OPTIONAL <b>0</b>	2.Inadeq 5. 8.
3.R Ranch 7.Contemp 11.Split	Heat Type <b>100% 0</b>	3.Poor 6. 9.
4.Cape 8.Log 12.	1.HWBB 5.FWA 9.No Heat	Attic <b>0</b>
Dwelling Units <b>0</b>	2.HWCI 6.GravWA 10.	1.1/4 Fin 4.Full Fin 7.
Other Units <b>0</b>	3.H Pump 7.Electric 11.	2.1/2 Fin 5.F/Stair 8.
Stories <b>0</b>	4.Steam 8.F/Wall 12.	3.3/4 Fin 6. 9.None
1.1 4.1.5 7.	Cool Type <b>0% 9 None</b>	Insulation <b>0</b>
2.2 5.1.75 8.	1.Refrig 4.W&C Air 7.	1.Full 4.Minimal 7.
3.3 6.2.5 9.	2.Evapor 5. 8.	2.Heavy 5.Partial 8.
Exterior Walls <b>0</b>	3.H Pump 6. 9.None	3.Capped 6. 9.None
1.Wood 5.Stucco 9.T-111	Kitchen Style <b>0</b>	Unfinished % <b>0%</b>
2.Vin/Al 6.Brick 10.Other	1.Modern 4.Obsolete 7.	Grade & Factor <b>0 0%</b>
3.Compos. 7.Stone 11.	2.Typical 5. 8.	1.E Grade 4.B Grade 7.
4.Asbestos 8.Concrete 12.	3.Old Type 6. 9.None	2.D Grade 5.A Grade 8.SC Grade
Roof Surface <b>0</b>	Bath(s) Style <b>0</b>	3.C Grade 6.AA Grade 9.Same
1.Asphalt 4.Composit 7.	1.Modern 4.Obsolete 7.	SQFT (Footprint) <b>0</b>
2.Slate 5.Wood 8.	2.Typical 5. 8.	Condition <b>0</b>
3.Metal 6.Other 9.	3.Old Type 6. 9.None	1.Poor 4.Avg 7.V G
SF Masonry Trim <b>0</b>	# Rooms <b>0</b>	2.Fair 5.Avg+ 8.Exc
OPEN-3-CUSTOM <b>0</b>	# Bedrooms <b>0</b>	3.Avg- 6.Good 9.Same
OPEN-4-CUSTOM <b>0</b>	# Full Baths <b>0</b>	Phys. % Good <b>0%</b>
Year Built <b>0</b>	# Half Baths <b>0</b>	Funct. % Good <b>100%</b>
Year Remodeled <b>0</b>	# Addn Fixtures <b>0</b>	Functional Code <b>9 None</b>
Foundation <b>0</b>	# Fireplaces <b>0</b>	1.Incomp 4.Delap 7.No Power
1.Concrete 4.Wood 7.		2.O-Built 5.Bsmt 8.LongTerm
2.C Block 5.Slab 8.		3.Damage 6.Common 9.None
3.Br/Stone 6.Piers 9.		Econ. % Good <b>100%</b>
Basement <b>0</b>		Economic Code <b>None</b>
1.1/4 Bmt 4.Full Bmt 7.		0.None 3.No Power 7.
2.1/2 Bmt 5.None 8.		1.Location 4.Generate 8.
3.3/4 Bmt 6. 9.None		2.Encroach 9.None 9.
Bsmt Gar # Cars <b>0</b>		Entrance Code <b>0</b>
Wet Basement <b>0</b>		1.Interior 4.Vacant 7.
1.Dry 4. 7.		2.Refusal 5.Estimate 8.
2.Damp 5. 8.	3.Informed 6.Reviewed 9.	
3.Wet 6. 9.	Information Code <b>0</b>	
		1.Owner 4.Agent 7.
		2.Relative 5.Estimate 8.
		3.Tenant 6.Other 9.

Date Inspected

**Additions, Outbuildings & Improvements**

Type	Year	Units	Grade	Cond	Phys.	Funct.	Sound Value
					%	%	1.One Story Fram
					%	%	2.Two Story Fram
					%	%	3.Three Story Fr
					%	%	4.1 & 1/2 Story
					%	%	5.1 & 3/4 Story
					%	%	6.2 & 1/2 Story
					%	%	21.Open Frame Por
					%	%	22.Encl Frame Por
					%	%	23.Frame Garage
					%	%	24.Frame Shed
					%	%	25.Frame Bay Wind
					%	%	26.1SFr Overhang
					%	%	27.Unfin Basement
					%	%	28.Unfinished Att
					%	%	29.Finished Attic







Town of Washburn  
1287 MAIN STREET  
WASHBURN ME 04786

			Property Data			Assessment Record						
			Neighborhood	1 Neighborhood One		Year	Land	Buildings	Exempt	Total		
			Tree Growth Year	0		2012	2,800	0	2,800	0		
			1ST MORTGAGE	0		2013	3,700	0	3,700	0		
			2ND MORTGAGE	0		2015	3,700	0	3,700	0		
			Zone/Land Use	1 Residential		2018	3,700	0	3,700	0		
			Secondary Zone			2019	7,100	0	7,100	0		
			Topography	2 Rolling		2020	7,100	0	7,100	0		
			1.Level	4.Below St	7.LevelBog	2022	7,100	0	7,100	0		
			2.Rolling	5.Low	8.	2023	9,200	0	9,200	0		
			3.Above St	6.Swampy	9.	2024	9,200	0	9,200	0		
			Utilities									
			1.Public	4.Dr Well	7.Cesspool							
			2.Water	5.Dug Well	8.							
			3.Sewer	6.Septic	9.None							
			Street	3 Gravel								
			1.Paved	4.Proposed	7.	<b>Land Data</b>						
			2.Semi Imp	5.R/O/W	8.							
			3.Gravel	6.	9.None	<b>Front Foot</b>	<b>Type</b>	<b>Effective</b>		<b>Influence</b>		<b>Influence Codes</b>
			TG PLAN YEAR	0		11.Regular Lot		<b>Frontage</b>	<b>Depth</b>	<b>Factor</b>	<b>Code</b>	
			Tif District #	0		12.Delta Triangle						1.Unimproved
			<b>Sale Data</b>			13.Nabla Triangle						
			Sale Date			14.Rear Land						3.Topography
			Price			15.Class I Road						
			Sale Type	1 Land Only		<b>Square Foot</b>	<b>Square Feet</b>					5.Access
			1.Land	4.Mobile	7.C/I L&B	16.Class II Road						
			2.L & B	5.Other	8.	17.Municipal Rese						7.Open Space
			3.Building	6.C/I Land	9.	18.Munic Sep Lago						
			Financing			19.Gravel Pit						9.Fract Share
			1.Convent	4.Seller	7.	20.Industrial Bas						
			2.FHA/VA	5.Private	8.	<b>Fract. Acre</b>	<b>Acreege/Sites</b>					30.Utility R O W
			3.Assumed	6.Cash	9.Unknown	21.Developed Pave	24	1.00	100	%	0	31.Tillable
			Validity			22.Undev Paved (F	28	0.26	100	%	0	32.Pasture
			1.Valid	4.Split	7.Renovate	23.Developed Grav						
			2.Related	5.Partial	8.Other	<b>Acres</b>						34.Softwood F&O
			3.Distress	6.Exempt	9.	24.Undev Gravel (						
			Verified	5 Public Record		25.Comm Base Pave						36.Hardwood F&O
			1.Buyer	4.Agent	7.Family	26.Comm Base Grav						37.Softwood TG
			2.Seller	5.Pub Rec	8.Other	27.Backlot						38.Mixed Wood TG
			3.Lender	6.MLS	9.	28.Rear Land						39.Hardwood TG
						29.Pavement						40.Wasteland
											42.Mobile Home Si	
											43.Condo Site	
											44.Lot Improvemen	
											45.Subdivision Lo	
											46.Heavy Ind Sit	

Inspection Witnessed By:

X	Date	Description	Date Insp.

Notes:

**Washburn**

Map Lot 011-137

Account 926

Location Victoria Street

Card 1 Of 1 9/04/2024

Building Style <b>0</b>	SF Bsmt Living <b>0</b>	Layout <b>0</b>
1.Conv. 5.Garrison 9.Gambrel	Fin Bsmt Grade <b>0 0</b>	1.Typical 4. 7.
2.Ranch 6.Salt Box 10.Other	OPEN 5 OPTIONAL <b>0</b>	2.Inadeq 5. 8.
3.R Ranch 7.Contemp 11.Split	Heat Type <b>100% 0</b>	3.Poor 6. 9.
4.Cape 8.Log 12.	1.HWBB 5.FWA 9.No Heat	Attic <b>0</b>
Dwelling Units <b>0</b>	2.HWCI 6.GravWA 10.	1.1/4 Fin 4.Full Fin 7.
Other Units <b>0</b>	3.H Pump 7.Electric 11.	2.1/2 Fin 5.FI/Stair 8.
Stories <b>0</b>	4.Steam 8.FI/Wall 12.	3.3/4 Fin 6. 9.None
1.1 4.1.5 7.	Cool Type <b>0% 9 None</b>	Insulation <b>0</b>
2.2 5.1.75 8.	1.Refrig 4.W&C Air 7.	1.Full 4.Minimal 7.
3.3 6.2.5 9.	2.Evapor 5. 8.	2.Heavy 5.Partial 8.
Exterior Walls <b>0</b>	3.H Pump 6. 9.None	3.Capped 6. 9.None
1.Wood 5.Stucco 9.T-111	Kitchen Style <b>0</b>	Unfinished % <b>0%</b>
2.Vin/Al 6.Brick 10.Other	1.Modern 4.Obsolete 7.	Grade & Factor <b>0 0%</b>
3.Compos. 7.Stone 11.	2.Typical 5. 8.	1.E Grade 4.B Grade 7.
4.Asbestos 8.Concrete 12.	3.Old Type 6. 9.None	2.D Grade 5.A Grade 8.SC Grade
Roof Surface <b>0</b>	Bath(s) Style <b>0</b>	3.C Grade 6.AA Grade 9.Same
1.Asphalt 4.Composit 7.	1.Modern 4.Obsolete 7.	SQFT (Footprint) <b>0</b>
2.Slate 5.Wood 8.	2.Typical 5. 8.	Condition <b>0</b>
3.Metal 6.Other 9.	3.Old Type 6. 9.None	1.Poor 4.Avg 7.V G
SF Masonry Trim <b>0</b>	# Rooms <b>0</b>	2.Fair 5.Avg+ 8.Exc
OPEN-3-CUSTOM <b>0</b>	# Bedrooms <b>0</b>	3.Avg- 6.Good 9.Same
OPEN-4-CUSTOM <b>0</b>	# Full Baths <b>0</b>	Phys. % Good <b>0%</b>
Year Built <b>0</b>	# Half Baths <b>0</b>	Funct. % Good <b>100%</b>
Year Remodeled <b>0</b>	# Addn Fixtures <b>0</b>	Functional Code <b>9 None</b>
Foundation <b>0</b>	# Fireplaces <b>0</b>	1.Incomp 4.Delap 7.No Power
1.Concrete 4.Wood 7.	 <p><b>TRIO</b> Software A Division of Harris Computer Systems</p>	2.O-Built 5.Bsmt 8.LongTerm
2.C Block 5.Slab 8.		3.Damage 6.Common 9.None
3.Br/Stone 6.Piers 9.		Econ. % Good <b>100%</b>
Basement <b>0</b>		Economic Code <b>None</b>
1.1/4 Bmt 4.Full Bmt 7.		0.None 3.No Power 7.
2.1/2 Bmt 5.None 8.		1.Location 4.Generate 8.
3.3/4 Bmt 6. 9.None		2.Encroach 9.None 9.
Bsmt Gar # Cars <b>0</b>		Entrance Code <b>0</b>
Wet Basement <b>0</b>		1.Interior 4.Vacant 7.
1.Dry 4. 7.		2.Refusal 5.Estimate 8.
2.Damp 5. 8.	3.Informed 6.Reviewed 9.	
3.Wet 6. 9.	Information Code <b>0</b>	
		1.Owner 4.Agent 7.
		2.Relative 5.Estimate 8.
		3.Tenant 6.Other 9.

Date Inspected

Additions, Outbuildings & Improvements								
Type	Year	Units	Grade	Cond	Phys.	Funct.	Sound Value	
					%	%		1.One Story Fram
					%	%		2.Two Story Fram
					%	%		3.Three Story Fr
					%	%		4.1 & 1/2 Story
					%	%		5.1 & 3/4 Story
					%	%		6.2 & 1/2 Story
					%	%		21.Open Frame Por
					%	%		22.Encl Frame Por
					%	%		23.Frame Garage
					%	%		24.Frame Shed
					%	%		25.Frame Bay Wind
					%	%		26.1SFr Overhang
					%	%		27.Unfin Basement
					%	%		28.Unfinished Att
					%	%		29.Finished Attic

Town of Washburn  
1287 MAIN STREET  
WASHBURN ME 04786

B3978P3

Inspection Witnessed By:

No./Date	Description	Date Insp.
X		

Notes:

Washburn

Property Data			Assessment Record						
Neighborhood <b>1 Neighborhood One</b>			Year	Land	Buildings	Exempt	Total		
Tree Growth Year <b>0</b>			2012	4,000	0	4,000	0		
1ST MORTGAGE <b>0</b>			2013	5,100	0	5,100	0		
2ND MORTGAGE <b>0</b>			2015	5,100	0	5,100	0		
Zone/Land Use <b>1 Residential</b>			2018	5,100	0	5,100	0		
Secondary Zone			2019	6,100	0	6,100	0		
Topography <b>2 Rolling</b>			2020	6,100	0	6,100	0		
1.Level 4.Below St 7.LevelBog			2021	6,100	0	6,100	0		
2.Rolling 5.Low 8.			2022	6,100	0	6,100	0		
3.Above St 6.Swampy 9.			2023	7,800	0	7,800	0		
Utilities			2024	7,800	0	7,800	0		
1.Public 4.Dr Well 7.Cesspool									
2.Water 5.Dug Well 8.									
3.Sewer 6.Septic 9.None									
Street <b>3 Gravel</b>									
1.Paved 4.Proposed 7.									
2.Semi Imp 5.R/O/W 8.									
3.Gravel 6. 9.None									
TG PLAN YEAR <b>0</b>									
Tif District # <b>0</b>									
Sale Data			<b>Land Data</b>						
Sale Date			<b>Front Foot</b>	<b>Type</b>	<b>Effective</b>		<b>Influence</b>		<b>Influence Codes</b>
Price					Frontage	Depth	Factor	Code	
Sale Type <b>1 Land Only</b>			11.Regular Lot						1.Unimproved
1.Land 4.Mobile 7.C/I L&B			12.Delta Triangle						2.Excess Frtg
2.L & B 5.Other 8.			13.Nabla Triangle						3.Topography
3.Building 6.C/I Land 9.			14.Rear Land						4.Size/Shape
Financing			15.Class I Road						5.Access
1.Convent 4.Seller 7.									6.Restriction
2.FHA/VA 5.Private 8.									7.Open Space
3.Assumed 6.Cash 9.Unknown									8.View/Environ
Validity									9.Fract Share
1.Valid 4.Split 7.Renovate			<b>Square Foot</b>	<b>Square Feet</b>					<b>Acres</b>
2.Related 5.Partial 8.Other			16.Class II Road						30.Utility R O W
3.Distress 6.Exempt 9.			17.Municipal Rese						31.Tillable
Verified			18.Munic Sep Lago						32.Pasture
1.Buyer 4.Agent 7.Family			19.Gravel Pit						33.Orchard
2.Seller 5.Pub Rec 8.Other			20.Industrial Bas						34.Softwood F&O
3.Lender 6.MLS 9.			<b>Fract. Acre</b>						35.Mixed Wood F&O
			21.Developed Pave	24	0.75	100	%	0	36.Hardwood F&O
			22.Undev Paved (F						37.Softwood TG
			23.Developed Grav						38.Mixed Wood TG
			<b>Acres</b>						39.Hardwood TG
			24.Undev Gravel (						40.Wasteland
			25.Comm Base Pave						41.Open Space
			26.Comm Base Grav						42.Mobile Home Si
			27.Backlot						43.Condo Site
			28.Rear Land						44.Lot Improvemen
			29.Pavement						45.Subdivision Lo
				<b>Total Acreage</b>		0.75			46.Heavy Ind Sit

**Washburn**

Map Lot 011-138

Account 1052

Location Victoria Street

Card 1 Of 1 9/04/2024

Building Style <b>0</b>	SF Bsmt Living <b>0</b>	Layout <b>0</b>
1.Conv. 5.Garrison 9.Gambrel	Fin Bsmt Grade <b>0 0</b>	1.Typical 4. 7.
2.Ranch 6.Salt Box 10.Other	OPEN 5 OPTIONAL <b>0</b>	2.Inadeq 5. 8.
3.R Ranch 7.Contemp 11.Split	Heat Type <b>100% 0</b>	3.Poor 6. 9.
4.Cape 8.Log 12.	1.HWBB 5.FWA 9.No Heat	Attic <b>0</b>
Dwelling Units <b>0</b>	2.HWCI 6.GravWA 10.	1.1/4 Fin 4.Full Fin 7.
Other Units <b>0</b>	3.H Pump 7.Electric 11.	2.1/2 Fin 5.FI/Stair 8.
Stories <b>0</b>	4.Steam 8.FI/Wall 12.	3.3/4 Fin 6. 9.None
1.1 4.1.5 7.	Cool Type <b>0% 9 None</b>	Insulation <b>0</b>
2.2 5.1.75 8.	1.Refrig 4.W&C Air 7.	1.Full 4.Minimal 7.
3.3 6.2.5 9.	2.Evapor 5. 8.	2.Heavy 5.Partial 8.
Exterior Walls <b>0</b>	3.H Pump 6. 9.None	3.Capped 6. 9.None
1.Wood 5.Stucco 9.T-111	Kitchen Style <b>0</b>	Unfinished % <b>0%</b>
2.Vin/Al 6.Brick 10.Other	1.Modern 4.Obsolete 7.	Grade & Factor <b>0 0%</b>
3.Compos. 7.Stone 11.	2.Typical 5. 8.	1.E Grade 4.B Grade 7.
4.Asbestos 8.Concrete 12.	3.Old Type 6. 9.None	2.D Grade 5.A Grade 8.SC Grade
Roof Surface <b>0</b>	Bath(s) Style <b>0</b>	3.C Grade 6.AA Grade 9.Same
1.Asphalt 4.Composit 7.	1.Modern 4.Obsolete 7.	SQFT (Footprint) <b>0</b>
2.Slate 5.Wood 8.	2.Typical 5. 8.	Condition <b>0</b>
3.Metal 6.Other 9.	3.Old Type 6. 9.None	1.Poor 4.Avg 7.V G
SF Masonry Trim <b>0</b>	# Rooms <b>0</b>	2.Fair 5.Avg+ 8.Exc
OPEN-3-CUSTOM <b>0</b>	# Bedrooms <b>0</b>	3.Avg- 6.Good 9.Same
OPEN-4-CUSTOM <b>0</b>	# Full Baths <b>0</b>	Phys. % Good <b>0%</b>
Year Built <b>0</b>	# Half Baths <b>0</b>	Funct. % Good <b>100%</b>
Year Remodeled <b>0</b>	# Addn Fixtures <b>0</b>	Functional Code <b>9 None</b>
Foundation <b>0</b>	# Fireplaces <b>0</b>	1.Incomp 4.Delap 7.No Power
1.Concrete 4.Wood 7.		2.O-Built 5.Bsmt 8.LongTerm
2.C Block 5.Slab 8.		3.Damage 6.Common 9.None
3.Br/Stone 6.Piers 9.		Econ. % Good <b>100%</b>
Basement <b>0</b>		Economic Code <b>None</b>
1.1/4 Bmt 4.Full Bmt 7.		0.None 3.No Power 7.
2.1/2 Bmt 5.None 8.		1.Location 4.Generate 8.
3.3/4 Bmt 6. 9.None		2.Encroach 9.None 9.
Bsmt Gar # Cars <b>0</b>		Entrance Code <b>0</b>
Wet Basement <b>0</b>		1.Interior 4.Vacant 7.
1.Dry 4. 7.		2.Refusal 5.Estimate 8.
2.Damp 5. 8.	3.Informed 6.Reviewed 9.	
3.Wet 6. 9.	Information Code <b>0</b>	
		1.Owner 4.Agent 7.
		2.Relative 5.Estimate 8.
		3.Tenant 6.Other 9.

Date Inspected

Additions, Outbuildings & Improvements								
Type	Year	Units	Grade	Cond	Phys.	Funct.	Sound Value	
					%	%		1.One Story Fram
					%	%		2.Two Story Fram
					%	%		3.Three Story Fr
					%	%		4.1 & 1/2 Story
					%	%		5.1 & 3/4 Story
					%	%		6.2 & 1/2 Story
					%	%		21.Open Frame Por
					%	%		22.Encl Frame Por
					%	%		23.Frame Garage
					%	%		24.Frame Shed
					%	%		25.Frame Bay Wind
					%	%		26.1SFr Overhang
					%	%		27.Unfin Basement
					%	%		28.Unfinished Att
					%	%		29.Finished Attic