

Washburn

Map Lot 011-061

Account 764

Location 25 HINES STREET

Card 1

Of 1

9/04/2024

Building Style 0	SF Bsmt Living 0	Layout 0
1.Conv. 5.Garrison 9.Gambrel	Fin Bsmt Grade 0 0	1.Typical 4. 7.
2.Ranch 6.Salt Box 10.Other	OPEN 5 OPTIONAL 0	2.Inadeq 5. 8.
3.R Ranch 7.Contemp 11.Split	Heat Type 100% 0	3.Pool 6. 9.
4.Cape 8.Log 12.	1.HWBB 5.FWA 9.No Heat	Attic 0
Dwelling Units 0	2.HWCI 6.GravWA 10.	1.1/4 Fin 4.Full Fin 7.
Other Units 0	3.H Pump 7.Electric 11.	2.1/2 Fin 5.FI/Stair 8.
Stories 0	4.Steam 8.FI/Wall 12.	3.3/4 Fin 6. 9.None
1.1 4.1.5 7.	Cool Type 0% 9 None	Insulation 0
2.2 5.1.75 8.	1.Refrig 4.W&C Air 7.	1.Full 4.Minimal 7.
3.3 6.2.5 9.	2.Evapor 5. 8.	2.Heavy 5.Partial 8.
Exterior Walls 0	3.H Pump 6. 9.None	3.Capped 6. 9.None
1.Wood 5.Stucco 9.T-111	Kitchen Style 0	Unfinished % 0%
2.Vin/Al 6.Brick 10.Other	1.Modern 4.Obsolete 7.	Grade & Factor 0 0%
3.Compos. 7.Stone 11.	2.Typical 5. 8.	1.E Grade 4.B Grade 7.
4.Asbestos 8.Concrete 12.	3.Old Type 6. 9.None	2.D Grade 5.A Grade 8.SC Grade
Roof Surface 0	Bath(s) Style 0	3.C Grade 6.AA Grade 9.Same
1.Asphalt 4.Composit 7.	1.Modern 4.Obsolete 7.	SQFT (Footprint) 0
2.Slate 5.Wood 8.	2.Typical 5. 8.	Condition 0
3.Metal 6.Other 9.	3.Old Type 6. 9.None	1.Poor 4.Avg 7.V G
SF Masonry Trim 0	# Rooms 0	2.Fair 5.Avg+ 8.Exc
OPEN-3-CUSTOM 0	# Bedrooms 0	3.Avg- 6.Good 9.Same
OPEN-4-CUSTOM 0	# Full Baths 0	Phys. % Good 0%
Year Built 0	# Half Baths 0	Funct. % Good 100%
Year Remodeled 0	# Addn Fixtures 0	Functional Code 9 None
Foundation 0	# Fireplaces 0	1.Incomp 4.Delap 7.No Power
1.Concrete 4.Wood 7.	 <p>TRIO Software A Division of Harris Computer Systems</p>	2.O-Built 5.Bsmt 8.LongTerm
2.C Block 5.Slab 8.		3.Damage 6.Common 9.None
3.Br/Stone 6.Piers 9.		Econ. % Good 100%
Basement 0		Economic Code None
1.1/4 Bmt 4.Full Bmt 7.		0.None 3.No Power 7.
2.1/2 Bmt 5.None 8.		1.Location 4.Generate 8.
3.3/4 Bmt 6. 9.None		2.Encroach 9.None 9.
Bsmt Gar # Cars 0		Entrance Code 5 Estimated
Wet Basement 0		1.Interior 4.Vacant 7.
1.Dry 4. 7.		2.Refusal 5.Estimate 8.
2.Damp 5. 8.	3.Informed 6.Reviewed 9.	
3.Wet 6. 9.	Information Code 5 Estimate	
	1.Owner 4.Agent 7.	
	2.Relative 5.Estimate 8.	
	3.Tenant 6.Other 9.	

Date Inspected 10/04/2018

Additions, Outbuildings & Improvements

Type	Year	Units	Grade	Cond	Phys.	Funct.	Sound Value
228 Church	1900	1728	2 110	4	0 %	100 %	
25 Frame Bay	1900	30	2 100	4	0 %	100 %	
21 Open Frame	1930	104	3 100	4	0 %	100 %	
20 1 Story/Bsmt	1930	304	2 110	4	0 %	100 %	
1 One Story Frame	1950	51	3 90	4	0 %	100 %	
40 Basement Entry	1930	40	2 100	4	0 %	100 %	
24 Frame Shed	1980	288	2 105	4	0 %	100 %	
					%	%	
					%	%	
					%	%	

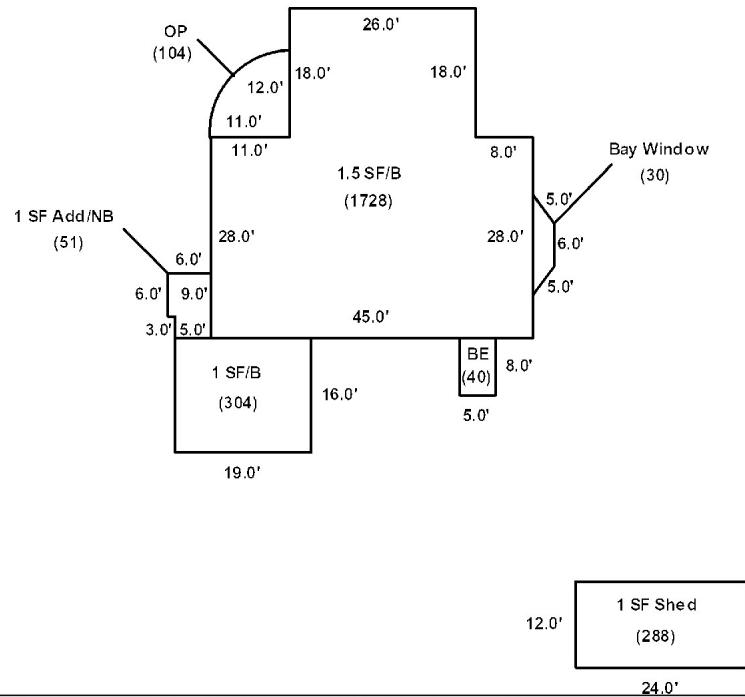

Washburn

Map Lot 011-063

Account 1048

Location 6 CHURCH STREET

Card 1 Of 1 9/04/2024

Building Style	4 Cape Cod		SF Bsmt Living	0		Layout	1 Typical							
1.Conv.	5.Garrison	9.Gambrel	Fin Bsmt Grade	0 0		1.Typical	4.	7.						
2.Ranch	6.Salt Box	10.Other	OPEN 5 OPTIONAL	0		2.Inadeq	5.	8.						
3.R Ranch	7.Contemp	11.Split	Heat Type	100% 5 Forced Warm Air		3.Poor	6.	9.						
4.Cape	8.Log	12.	1.HWBB	5.FWA	9.No Heat	Attic	9 None							
Dwelling Units	1		2.HWCI	6.GravWA	10.	1.1/4 Fin	4.Full Fin	7.						
Other Units	0		3.H Pump	7.Electric	11.	2.1/2 Fin	5.F/ Stair	8.						
Stories	4 One & 1/2 Story		4.Steam	8.F/ Wall	12.	3.3/4 Fin	6.	9.None						
1.1	4.1.5	7.	Cool Type	0% 9 None		Insulation	1 Full							
2.2	5.1.75	8.	1.Refrig	4.W&C Air	7.	1.Full	4.Minimal	7.						
3.3	6.2.5	9.	2.Evapor	5.	8.	2.Heavy	5.Partial	8.						
Exterior Walls	4 Asbestos Siding		3.H Pump	6.	9.None	3.Capped	6.	9.None						
1.Wood	5.Stucco	9.T-111	Kitchen Style	2 Typical		Unfinished %	0%							
2.Vin/Al	6.Brick	10.Other	1.Modern	4.Obsolete	7.	Grade & Factor	2 Fair 110%							
3.Compos.	7.Stone	11.	2.Typical	5.	8.	1.E Grade	4.B Grade	7.						
4.Asbestos	8.Concrete	12.	3.Old Type	6.	9.None	2.D Grade	5.A Grade	8.SC Grade						
Roof Surface	1 Asphalt Shingles		Bath(s) Style	2 Typical Bath(s)		3.C Grade	6.AA Grade	9.Same						
1.Asphalt	4.Composit	7.	1.Modern	4.Obsolete	7.	SQFT (Footprint)	840							
2.Slate	5.Wood	8.	2.Typical	5.	8.	Condition	5 Above Average							
3.Metal	6.Other	9.	3.Old Type	6.	9.None	1.Poor	4.Avg	7.V G						
SF Masonry Trim	0		# Rooms	6		2.Fair	5.Avg+	8.Exc						
OPEN-3-CUSTOM	0		# Bedrooms	3		3.Avg-	6.Good	9.Same						
OPEN-4-CUSTOM	0		# Full Baths	1		Phys. % Good	0%							
Year Built	1948		# Half Baths	0		Funct. % Good	100%							
Year Remodeled	0		# Addn Fixtures	0		Functional Code	9 None							
Foundation	1 Concrete		# Fireplaces	0		1.Incomp	4.Delap	7.No Power						
1.Concrete	4.Wood	7.							2.O-Built	5.Bsmt	8.LongTerm			
2.C Block	5.Slab	8.							Economic Code	None		3.Damage	6.Common	9.None
3.Br/Stone	6.Piers	9.							0.None	3.No Power	7.	Econ. % Good	100%	
Basement	4 Full Basement								1.Location	4.Generate	8.	Economic Code	None	
1.1/4 Bmt	4.Full Bmt	7.							2.Encroach	9.None	9.	Entrance Code	3 Information Only	
2.1/2 Bmt	5.None	8.							1.Interior	4.Vacant	7.	1.Owner	4.Agent	7.
3.3/4 Bmt	6.	9.None							2.Refusal	5.Estimate	8.	2.Relative	5.Estimate	8.
Bsmt Gar # Cars	0								3.Informed	6.Reviewed	9.	3.Tenant	6.Other	9.
Wet Basement	1 Dry Basement								Information Code	1 Owner		1.Owner	4.Agent	7.
1.Dry	4.	7.							2.Relative	5.Estimate	8.	2.Relative	5.Estimate	8.
2.Damp	5.	8.	3.Tenant	6.Other	9.	3.Tenant	6.Other	9.						
3.Wet	6.	9.												

Date Inspected 10/05/2018

Additions, Outbuildings & Improvements

Type	Year	Units	Grade	Cond	Phys.	Funct.	Sound Value
21 Open Frame	1948	20	2 110	5	0 %	100 %	
20 1 Story/Bsmt	1960	208	3 100	5	0 %	100 %	
22 Encl Frame Porch	1960	96	2 110	4	0 %	100 %	
68 Wood Deck	1990	60	3 100	4	0 %	100 %	
40 Basement Entry	1948	36	9 100	9	0 %	100 %	
24 Frame Shed	0				%	%	900
					%	%	
					%	%	
					%	%	
					%	%	
					%	%	

1.5 SF Shed SV S900

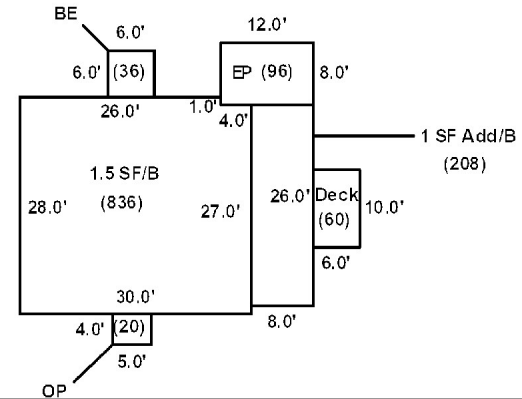
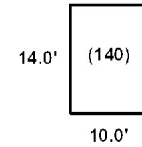

GOOD, JUSTIN
10 Church Street
Washburn ME 04786

B4816P330 B6045P272

Previous Owner
POULIN, JEREMY E
POULIN, JACQUELYN N (Raymond)
P.O. BOX 37
WASHBURN ME 04786
Sale Date: 7/31/2020

Previous Owner
Allen, Nathan
Allen, Mary
P.O. Box 462
Washburn ME 04786
Sale Date: 4/30/2010

Previous Owner
McIntosh, Matthew
Mcintosh, Kelly R.
P.O. Box 1645
Presque Isle ME
Sale Date: 12/15/2006

Inspection Witnessed By:

X	Date
No./Date	Description
	Date Insp.

Notes:
* 6-18-2019 Dwelling assessed at 95% functional due to water leaking in from roof.

Washburn

Property Data			Assessment Record						
Neighborhood 1 Neighborhood One			Year	Land	Buildings	Exempt	Total		
Tree Growth Year 0			2012	4,100	72,700	8,800	68,000		
1ST MORTGAGE 0			2013	5,300	72,700	8,800	69,200		
2ND MORTGAGE 0			2015	5,300	72,700	9,000	69,000		
Zone/Land Use 1 Residential			2018	5,300	72,700	18,400	59,600		
Secondary Zone			2019	8,700	96,300	20,000	85,000		
Topography 1 Level			2020	8,700	96,300	25,000	80,000		
1.Level 4.Below St 7.LevelBog			2021	8,700	96,300	0	105,000		
2.Rolling 5.Low 8.			2022	8,700	101,100	25,000	84,800		
3.Above St 6.Swampy 9.			2023	11,600	120,300	25,000	106,900		
Utilities 2 Public Water 3 Public Sewer			2024	11,600	120,300	25,000	106,900		
1.Public 4.Dr Well 7.Cesspool									
2.Water 5.Dug Well 8.									
3.Sewer 6.Septic 9.None									
Street 1 Paved									
1.Paved 4.Proposed 7.									
2.Semi Imp 5.R/O/W 8.									
3.Gravel 6. 9.None									
TG PLAN YEAR 0									
Tif District # 0									
Sale Data			Land Data						
Sale Date 7/31/2020			Front Foot	Type	Effective		Influence		Influence Codes
Price 137,200					Frontage	Depth	Factor	Code	
Sale Type 2 Land & Buildings			11.Regular Lot					1.Unimproved	
1.Land 4.Mobile 7.C/I L&B			12.Delta Triangle			%		2.Excess Frtg	
2.L & B 5.Other 8.			13.Nabla Triangle			%		3.Topography	
3.Building 6.C/I Land 9.			14.Rear Land			%		4.Size/Shape	
Financing 1 Conventional			15.Class I Road			%		5.Access	
1.Convent 4.Seller 7.						%		6.Restriction	
2.FHA/VA 5.Private 8.						%		7.Open Space	
3.Assumed 6.Cash 9.Unknown						%		8.View/Environ	
Validity 1 Arms Length Sale						%		9.Fract Share	
1.Valid 4.Split 7.Renovate			Square Foot	Square Feet				Acres	
2.Related 5.Partial 8.Other			16.Class II Road			%		30.Utility R O W	
3.Distress 6.Exempt 9.			17.Municipal Rese			%		31.Tillable	
Verified 5 Public Record			18.Munic Sep Lago			%		32.Pasture	
1.Buyer 4.Agent 7.Family			19.Gravel Pit			%		33.Orchard	
2.Seller 5.Pub Rec 8.Other			20.Industrial Bas			%		34.Softwood F&O	
3.Lender 6.MLS 9.						%		35.Mixed Wood F&O	
			Fract. Acre			%		36.Hardwood F&O	
			21.Developed Pave	21	0.28	100	%	0	
			22.Undev Paved (F			%		37.Softwood TG	
			23.Developed Grav			%		38.Mixed Wood TG	
			Acres			%		39.Hardwood TG	
			24.Undev Gravel (%		40.Wasteland	
			25.Comm Base Pave			%		41.Open Space	
			26.Comm Base Grav			%		42.Mobile Home Si	
			27.Backlot			%		43.Condo Site	
			28.Rear Land			%		44.Lot Improvemen	
			29.Pavement			%		45.Subdivision Lo	
			Total Acreage		0.28			46.Heavy Ind Sit	

Washburn

Map Lot 011-064

Account 740

Location 10 CHURCH STREET

Card 1 Of 1 9/04/2024

Building Style	4 Cape Cod	SF Bsmt Living	0	Layout	1 Typical
1.Conv.	5.Garrison	9.Gambrel	Fin Bsmt Grade	0 0	1.Typical
2.Ranch	6.Salt Box	10.Other	OPEN 5 OPTIONAL	0	2.Inadeq
3.R Ranch	7.Contemp	11.Split	Heat Type	100%	3.Pool
4.Cape	8.Log	12.	1.HWBB	5.FWA	9.No Heat
Dwelling Units	1	2.HWCI	6.GravWA	10.	Attic
Other Units	0	3.H Pump	7.Electric	11.	1.1/4 Fin
Stories	4 One & 1/2 Story	4.Steam	8.Fi/Wall	12.	4.Full Fin
1.1	4.1.5	7.	Cool Type	0%	9.None
2.2	5.1.75	8.	1.Refrig	4.W&C Air	7.
3.3	6.2.5	9.	2.Evapor	5.	8.
Exterior Walls	2 Vinyl/Aluminum	3.H Pump	6.	9.None	Insulation
1.Wood	5.Stucco	9.T-111	Kitchen Style	2 Typical	1 Full
2.Vin/Al	6.Brick	10.Other	1.Modern	4.Obsolete	7.
3.Compos.	7.Stone	11.	2.Typical	5.	8.
4.Asbestos	8.Concrete	12.	3.Old Type	6.	9.None
Roof Surface	3 Sheet Metal	Bath(s) Style	2 Typical Bath(s)	1.Modern	4.Obsolete
1.Asphalt	4.Composit	7.	1.Modern	4.Obsolete	7.
2.Slate	5.Wood	8.	2.Typical	5.	8.
3.Metal	6.Other	9.	3.Old Type	6.	9.None
SF Masonry Trim	0	# Rooms	5	Unfinished %	0%
OPEN-3-CUSTOM	0	# Bedrooms	3	Grade & Factor	3 Average 100%
OPEN-4-CUSTOM	0	# Full Baths	1	1.E Grade	4.B Grade
Year Built	1950	# Half Baths	0	2.D Grade	5.A Grade
Year Remodeled	0	# Addn Fixtures	0	3.C Grade	6.AA Grade
Foundation	3 Brick &/or Stone	# Fireplaces	0	8.SC Grade	9.Same
1.Concrete	4.Wood	7.	SQFT (Footprint)	560	Condition
2.C Block	5.Slab	8.	1.Poor	4.Avg	7.V G
3.Br/Stone	6.Piers	9.	2.Fair	5.Avg+	8.Exc
Basement	4 Full Basement	Phys. % Good	0%	3.Avg-	6.Good
1.1/4 Bmt	4.Full Bmt	7.	Funct. % Good	95%	Functional Code
2.1/2 Bmt	5.None	8.	1.Incomp	4.Delap	7.No Power
3.3/4 Bmt	6.	9.None	2.O-Built	5.Bsmt	8.LongTerm
Bsmt Gar # Cars	0	Economic Code	None	3.Damage	6.Common
Wet Basement	2 Damp Basement	0.None	3.No Power	7.	9.None
1.Dry	4.	7.	1.Location	4.Generate	8.
2.Damp	5.	8.	2.Encroach	9.None	9.
3.Wet	6.	9.	Entrance Code	1 Interior Inspect	1.Interior
			1.Interior	4.Vacant	7.
			2.Refusal	5.Estimate	8.
			3.Informed	6.Reviewed	9.
			Information Code	1 Owner	1.Owner
			1.Owner	4.Agent	7.
			2.Relative	5.Estimate	8.
			3.Tenant	6.Other	9.



Date Inspected 6/18/2019

Additions, Outbuildings & Improvements

Type	Year	Units	Grade	Cond	Phys.	Funct.	Sound Value
20 1 Story/Bsmt	1990	735	3 100	4	0 %	95 %	
40 Basement Entry	1990	42	2 110	4	0 %	100 %	
68 Wood Deck	1990	192	3 100	4	0 %	100 %	
23 Frame Garage	1980	728	3 100	4	0 %	100 %	
					%	%	
					%	%	
					%	%	
					%	%	
					%	%	
					%	%	
					%	%	
					%	%	

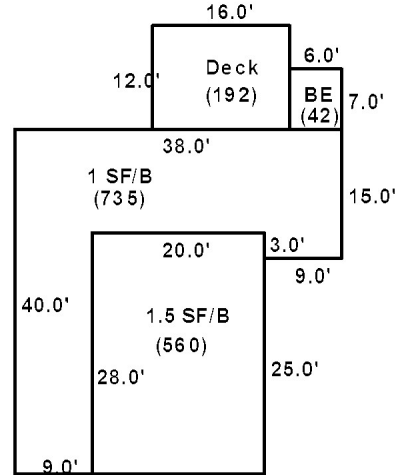
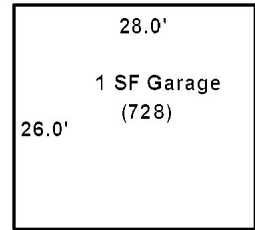

Washburn

Map Lot 011-065

Account 21

Location 4 PLEASANT STREET

Card 1

Of 1

9/04/2024

Building Style	4 Cape Cod	SF Bsmt Living	0	Layout	1 Typical	
1.Conv.	5.Garrison	9.Gambrel	Fin Bsmt Grade	0 0	1.Typical	
2.Ranch	6.Salt Box	10.Other	OPEN 5 OPTIONAL	0	2.Inadeq	
3.R Ranch	7.Contemp	11.Split	Heat Type	100% 5 Forced Warm Air	3.Poor	
4.Cape	8.Log	12.	1.HWBB	5.FWA	9.No Heat	
Dwelling Units	1	2.HWCI	6.GravWA	10.	Attic	
Other Units	0	3.H Pump	7.Electric	11.	1.1/4 Fin	
Stories	4 One & 1/2 Story	4.Steam	8.Fi/Wall	12.	4.Full Fin	
1.1	4.1.5	7.	Cool Type	0% 9 None	7.	
2.2	5.1.75	8.	1.Refrig	4.W&C Air	7.	
3.3	6.2.5	9.	2.Evapor	5.	8.	
Exterior Walls	2 Vinyl/Aluminum	3.H Pump	6.	9.None	Insulation	
1.Wood	5.Stucco	9.T-111	Kitchen Style	2 Typical	1 Full	
2.Vin/Al	6.Brick	10.Other	1.Modern	4.Obsolete	7.	
3.Compos.	7.Stone	11.	2.Typical	5.	8.	
4.Asbestos	8.Concrete	12.	3.Old Type	6.	9.None	
Roof Surface	1 Asphalt Shingles	Bath(s) Style	2 Typical Bath(s)	1.Modern	4.Obsolete	
1.Asphalt	4.Composit	7.	1.Modern	4.Obsolete	7.	
2.Slate	5.Wood	8.	2.Typical	5.	8.	
3.Metal	6.Other	9.	3.Old Type	6.	9.None	
SF Masonry Trim	0	# Rooms	6	Unfinished %	0%	
OPEN-3-CUSTOM	0	# Bedrooms	3	Grade & Factor	2 Fair 105%	
OPEN-4-CUSTOM	0	# Full Baths	1	1.E Grade	4.B Grade	
Year Built	1965	# Half Baths	1	7.	8.	
Year Remodeled	0	# Addn Fixtures	0	2.D Grade	5.A Grade	
Foundation	1 Concrete	# Fireplaces	0	8.	8.SC Grade	
1.Concrete	4.Wood	7.		3.C Grade	6.AA Grade	
2.C Block	5.Slab	8.		SQFT (Footprint)	828	
3.Br/Stone	6.Piers	9.		Condition	4 Average	
Basement	4 Full Basement	1.Poor		4.Avg	7.V G	
1.1/4 Bmt	4.Full Bmt	7.		2.Fair	5.Avg+	
2.1/2 Bmt	5.None	8.		3.Avg-	6.Good	
3.3/4 Bmt	6.	9.None		9.Same	Phys. % Good	
Bsmt Gar # Cars	0	Phys. % Good		0%	Funct. % Good	85%
Wet Basement	1 Dry Basement	Functional Code		1 Incomplete	1.Incomp	4.Delap
1.Dry	4.	7.		2.O-Built	5.Bsmt	8.LongTerm
2.Damp	5.	8.	3.Damage	6.Common	9.None	
3.Wet	6.	9.	Econ. % Good	100%	Economic Code	
					None	
					0.None	
					3.No Power	
					7.	
					1.Location	
					4.Generate	
					8.	
					2.Encroach	
					9.	
					Entrance Code	
					3 Information Only	
					1.Interior	
					4.Vacant	
					7.	
					2.Refusal	
					5.Estimate	
					8.	
					3.Informed	
					6.Reviewed	
					9.	
					Information Code	
					2 Relative	
					1.Owner	
					4.Agent	
					7.	
					2.Relative	
					5.Estimate	
					8.	
					3.Tenant	
					6.Other	
					9.	

Date Inspected 10/05/2018

Additions, Outbuildings & Improvements

Type	Year	Units	Grade	Cond	Phys.	Funct.	Sound Value
68 Wood Deck	1990	96	3 90	3	0 %	100 %	
22 Encl Frame Porch	1970	56	2 110	3	0 %	100 %	
68 Wood Deck	1990	40	3 90	3	0 %	100 %	
40 Basement Entry	1965	49	2 105	3	0 %	100 %	
					%	%	
					%	%	
					%	%	
					%	%	
					%	%	
					%	%	
					%	%	

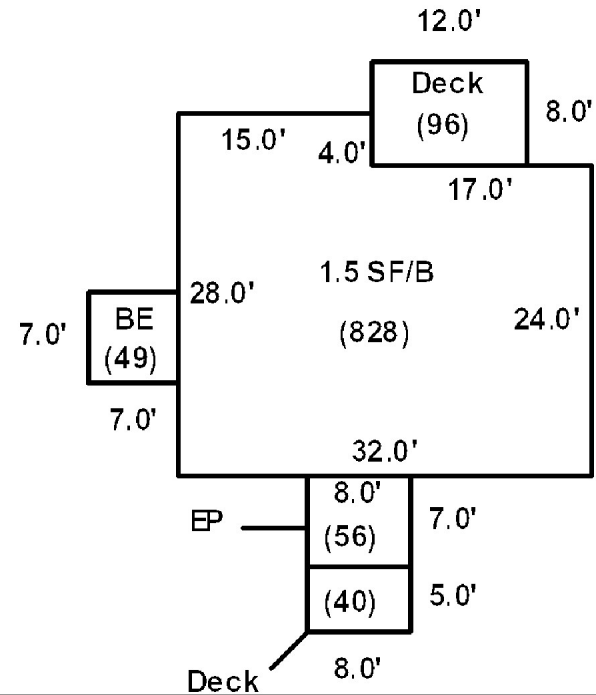

GOOD, JUSTIN
10 Church Street
Washburn ME 04786

B5021P196 B6045P272

Previous Owner
Boucher, James
12 Church Street

Washburn ME 04786
Sale Date: 1/26/2012

Previous Owner
Harris, Carroll
c/o James Boucher
12 Church Street
Washburn ME 04786
Sale Date: 2/29/2008

Inspection Witnessed By:

X	Date
No./Date	Description
	Date Insp.

Notes:

Washburn

Property Data			Assessment Record						
Neighborhood 1 Neighborhood One			Year	Land	Buildings	Exempt	Total		
Tree Growth Year 0			2012	1,600	12,500	0	14,100		
1ST MORTGAGE 0			2013	2,100	0	0	2,100		
2ND MORTGAGE 0			2015	2,100	0	0	2,100		
Zone/Land Use 1 Residential			2018	2,100	0	0	2,100		
Secondary Zone			2019	3,100	0	0	3,100		
Topography 2 Rolling			2020	3,100	0	0	3,100		
1.Level 4.Below St 7.LevelBog			2021	3,100	0	0	3,100		
2.Rolling 5.Low 8.			2022	3,100	0	0	3,100		
3.Above St 6.Swampy 9.			2023	3,800	0	0	3,800		
Utilities			2024	3,800	0	0	3,800		
1.Public 4.Dr Well 7.Cesspool									
2.Water 5.Dug Well 8.									
3.Sewer 6.Septic 9.None									
Street 1 Paved									
1.Paved 4.Proposed 7.									
2.Semi Imp 5.R/O/W 8.									
3.Gravel 6. 9.None									
TG PLAN YEAR 0									
Tif District # 0									
Sale Data			Land Data						
Sale Date 1/26/2012			Front Foot	Type	Effective		Influence		Influence Codes
Price 1,500					Frontage	Depth	Factor	Code	
Sale Type 1 Land Only			11.Regular Lot					1.Unimproved	
1.Land 4.Mobile 7.C/I L&B			12.Delta Triangle					2.Excess Frtg	
2.L & B 5.Other 8.			13.Nabla Triangle					3.Topography	
3.Building 6.C/I Land 9.			14.Rear Land					4.Size/Shape	
Financing			15.Class I Road					5.Access	
1.Convent 4.Seller 7.								6.Restriction	
2.FHA/VA 5.Private 8.								7.Open Space	
3.Assumed 6.Cash 9.Unknown								8.View/Environ	
Validity 1 Arms Length Sale								9.Fract Share	
1.Valid 4.Split 7.Renovate			Square Foot	Square Feet				Acres	
2.Related 5.Partial 8.Other			16.Class II Road					30.Utility R O W	
3.Distress 6.Exempt 9.			17.Municipal Rese					31.Tillable	
Verified 5 Public Record			18.Munic Sep Lago					32.Pasture	
1.Buyer 4.Agent 7.Family			19.Gravel Pit					33.Orchard	
2.Seller 5.Pub Rec 8.Other			20.Industrial Bas					34.Softwood F&O	
3.Lender 6.MLS 9.								35.Mixed Wood F&O	
			Fract. Acre					36.Hardwood F&O	
			21.Developed Pave	22	0.12	100	%	0	
			22.Undev Paved (F					%	
			23.Developed Grav					%	
			Acres					%	
			24.Undev Gravel (%	
			25.Comm Base Pave					%	
			26.Comm Base Grav					%	
			27.Backlot					%	
			28.Rear Land					%	
			29.Pavement					%	
			Total Acreage 0.12						
								44.Lot Improvemen	
								45.Subdivision Lo	
								46.Heavy Ind Sit	

Washburn

Map Lot 011-066A

Account 776

Location 12 CHURCH STREET

Card 1 Of 1 9/04/2024

Building Style 0	SF Bsmt Living 0	Layout 0
1.Conv. 5.Garrison 9.Gambrel	Fin Bsmt Grade 0 0	1.Typical 4. 7.
2.Ranch 6.Salt Box 10.Other	OPEN 5 OPTIONAL 0	2.Inadeq 5. 8.
3.R Ranch 7.Contemp 11.Split	Heat Type 100% 0	3.Poor 6. 9.
4.Cape 8.Log 12.	1.HWBB 5.FWA 9.No Heat	Attic 0
Dwelling Units 0	2.HWCI 6.GravWA 10.	1.1/4 Fin 4.Full Fin 7.
Other Units 0	3.H Pump 7.Electric 11.	2.1/2 Fin 5.F/Stair 8.
Stories 0	4.Steam 8.F/Wall 12.	3.3/4 Fin 6. 9.None
1.1 4.1.5 7.	Cool Type 0% 9 None	Insulation 0
2.2 5.1.75 8.	1.Refrig 4.W&C Air 7.	1.Full 4.Minimal 7.
3.3 6.2.5 9.	2.Evapor 5. 8.	2.Heavy 5.Partial 8.
Exterior Walls 0	3.H Pump 6. 9.None	3.Capped 6. 9.None
1.Wood 5.Stucco 9.T-111	Kitchen Style 0	Unfinished % 0%
2.Vin/Al 6.Brick 10.Other	1.Modern 4.Obsolete 7.	Grade & Factor 0 0%
3.Compos. 7.Stone 11.	2.Typical 5. 8.	1.E Grade 4.B Grade 7.
4.Asbestos 8.Concrete 12.	3.Old Type 6. 9.None	2.D Grade 5.A Grade 8.SC Grade
Roof Surface 0	Bath(s) Style 0	3.C Grade 6.AA Grade 9.Same
1.Asphalt 4.Composit 7.	1.Modern 4.Obsolete 7.	SQFT (Footprint) 0
2.Slate 5.Wood 8.	2.Typical 5. 8.	Condition 0
3.Metal 6.Other 9.	3.Old Type 6. 9.None	1.Poor 4.Avg 7.V G
SF Masonry Trim 0	# Rooms 0	2.Fair 5.Avg+ 8.Exc
OPEN-3-CUSTOM 0	# Bedrooms 0	3.Avg- 6.Good 9.Same
OPEN-4-CUSTOM 0	# Full Baths 0	Phys. % Good 0%
Year Built 0	# Half Baths 0	Funct. % Good 100%
Year Remodeled 0	# Addn Fixtures 0	Functional Code 9 None
Foundation 0	# Fireplaces 0	1.Incomp 4.Delap 7.No Power
1.Concrete 4.Wood 7.		2.O-Built 5.Bsmt 8.LongTerm
2.C Block 5.Slab 8.		3.Damage 6.Common 9.None
3.Br/Stone 6.Piers 9.		Econ. % Good 100%
Basement 0		Economic Code None
1.1/4 Bmt 4.Full Bmt 7.		0.None 3.No Power 7.
2.1/2 Bmt 5.None 8.		1.Location 4.Generate 8.
3.3/4 Bmt 6. 9.None		2.Encroach 9.None 9.
Bsmt Gar # Cars 0		Entrance Code 0
Wet Basement 0		1.Interior 4.Vacant 7.
1.Dry 4. 7.		2.Refusal 5.Estimate 8.
2.Damp 5. 8.	3.Informed 6.Reviewed 9.	
3.Wet 6. 9.	Information Code 0	
		1.Owner 4.Agent 7.
		2.Relative 5.Estimate 8.
		3.Tenant 6.Other 9.

Date Inspected

Additions, Outbuildings & Improvements

Type	Year	Units	Grade	Cond	Phys.	Funct.	Sound Value
					%	%	1.One Story Fram
					%	%	2.Two Story Fram
					%	%	3.Three Story Fr
					%	%	4.1 & 1/2 Story
					%	%	5.1 & 3/4 Story
					%	%	6.2 & 1/2 Story
					%	%	21.Open Frame Por
					%	%	22.Encl Frame Por
					%	%	23.Frame Garage
					%	%	24.Frame Shed
					%	%	25.Frame Bay Wind
					%	%	26.1SFr Overhang
					%	%	27.Unfin Basement
					%	%	28.Unfinished Att
					%	%	29.Finished Attic

Washburn

Map Lot 011-067

Account 1037

Location 13 McMANUS STREET

Card 1

Of 1

9/04/2024

Building Style	4 Cape Cod		SF Bsmt Living	0		Layout	1 Typical							
1.Conv.	5.Garrison	9.Gambrel	Fin Bsmt Grade	0 0		1.Typical	4.	7.						
2.Ranch	6.Salt Box	10.Other	OPEN 5 OPTIONAL	0		2.Inadeq	5.	8.						
3.R Ranch	7.Contemp	11.Split	Heat Type	100% 1 Hot Water BB		3.Poor	6.	9.						
4.Cape	8.Log	12.	1.HWBB	5.FWA	9.No Heat	Attic	9 None							
Dwelling Units	1		2.HWCI	6.GravWA	10.	1.1/4 Fin	4.Full Fin	7.						
Other Units	0		3.H Pump	7.Electric	11.	2.1/2 Fin	5.FI/Stair	8.						
Stories	4 One & 1/2 Story		4.Steam	8.FI/Wall	12.	3.3/4 Fin	6.	9.None						
1.1	4.1.5	7.	Cool Type	0% 9 None		Insulation	1 Full							
2.2	5.1.75	8.	1.Refrig	4.W&C Air	7.	1.Full	4.Minimal	7.						
3.3	6.2.5	9.	2.Evapor	5.	8.	2.Heavy	5.Partial	8.						
Exterior Walls	4 Asbestos Siding		3.H Pump	6.	9.None	3.Capped	6.	9.None						
1.Wood	5.Stucco	9.T-111	Kitchen Style	2 Typical		Unfinished %	0%							
2.Vin/Al	6.Brick	10.Other	1.Modern	4.Obsolete	7.	Grade & Factor	2 Fair 110%							
3.Compos.	7.Stone	11.	2.Typical	5.	8.	1.E Grade	4.B Grade	7.						
4.Asbestos	8.Concrete	12.	3.Old Type	6.	9.None	2.D Grade	5.A Grade	8.SC Grade						
Roof Surface	3 Sheet Metal		Bath(s) Style	2 Typical Bath(s)		3.C Grade	6.AA Grade	9.Same						
1.Asphalt	4.Composit	7.	1.Modern	4.Obsolete	7.	SQFT (Footprint) 520								
2.Slate	5.Wood	8.	2.Typical	5.	8.	Condition	5 Above Average							
3.Metal	6.Other	9.	3.Old Type	6.	9.None	1.Poor	4.Avg	7.V G						
SF Masonry Trim	0		# Rooms	6		2.Fair	5.Avg+	8.Exc						
OPEN-3-CUSTOM	0		# Bedrooms	4		3.Avg-	6.Good	9.Same						
OPEN-4-CUSTOM	0		# Full Baths	1		Phys. % Good	0%							
Year Built	1942		# Half Baths	1		Funct. % Good	100%							
Year Remodeled	0		# Addn Fixtures	0		Functional Code	9 None							
Foundation	3 Brick &/or Stone		# Fireplaces	0		1.Incomp	4.Delap	7.No Power						
1.Concrete	4.Wood	7.							2.O-Built	5.Bsmt	8.LongTerm			
2.C Block	5.Slab	8.							Econ. % Good	100%		3.Damage	6.Common	9.None
3.Br/Stone	6.Piers	9.							Economic Code	None		0.None	3.No Power	7.
Basement	4 Full Basement								Entrance Code	1 Interior Inspect		1.Location	4.Generate	8.
1.1/4 Bmt	4.Full Bmt	7.							1.Interior	4.Vacant	7.	2.Encroach	9.None	9.
2.1/2 Bmt	5.None	8.							2.Refusal	5.Estimate	8.	Information Code	1 Owner	
3.3/4 Bmt	6.	9.None							3.Informed	6.Reviewed	9.	1.Owner	4.Agent	7.
Bsmt Gar # Cars	0								2.Relative	5.Estimate	8.	3.Relative	5.Estimate	8.
Wet Basement	1 Dry Basement								3.Tenant	6.Other	9.	2.Tenant	6.Other	9.
1.Dry	4.	7.												
2.Damp	5.	8.												
3.Wet	6.	9.												

Date Inspected 10/03/2018

Additions, Outbuildings & Improvements

Type	Year	Units	Grade	Cond	Phys.	Funct.	Sound Value
21 Open Frame	1975	130	2 110	4	0 %	100 %	
68 Wood Deck	1975	60	3 100	4	0 %	100 %	
40 Basement Entry	1942	36	2 105	4	0 %	100 %	
20 1 Story/Bsmt	1942	312	9 100	9	0 %	100 %	
22 Encl Frame Porch	1960	48	3 100	4	0 %	100 %	
83 1.75 S-Gar	1955	780	3 95	4	0 %	100 %	
83 1.75 S-Gar	1960	408	3 95	4	0 %	80 %	
61 Canopy	1960	572	2 110	4	0 %	100 %	
					%	%	
					%	%	

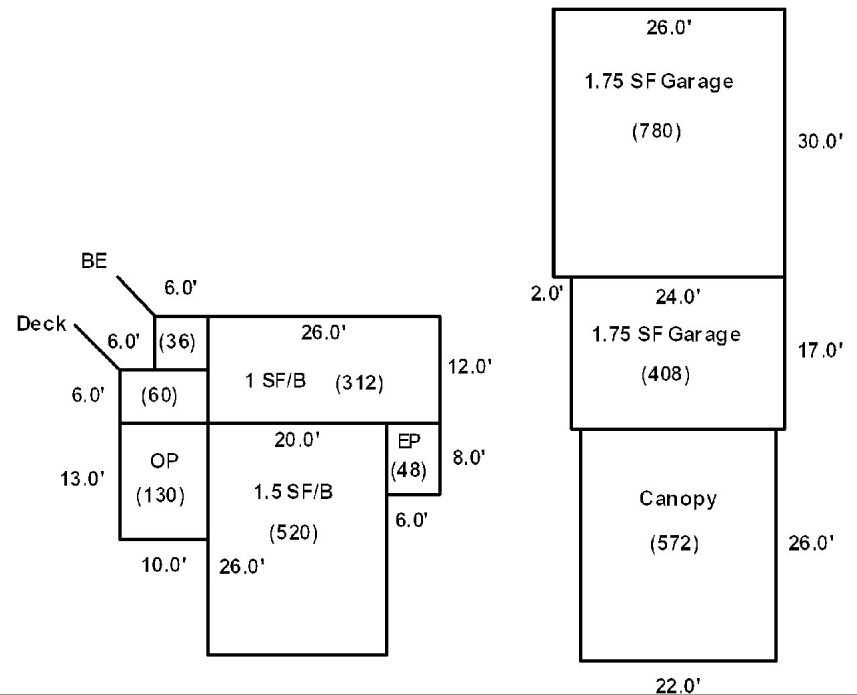

Washburn

Map Lot 011-068

Account 73

Location 7 McManus Street

Card 1 Of 1 9/04/2024

Building Style 2 Ranch	SF Bsmt Living 0	Layout 1 Typical
1.Conv. 5.Garrison 9.Gambrel	Fin Bsmt Grade 0 0	1.Typical 4. 7.
2.Ranch 6.Salt Box 10.Other	OPEN 5 OPTIONAL 0	2.Inadeq 5. 8.
3.R Ranch 7.Contemp 11.Split	Heat Type 100% 5 Forced Warm Air	3.Pool 6. 9.
4.Cape 8.Log 12.	1.HWBB 5.FWA 9.No Heat	Attic 9 None
Dwelling Units 1	2.HWCI 6.GravWA 10.	1.1/4 Fin 4.Full Fin 7.
Other Units 0	3.H Pump 7.Electric 11.	2.1/2 Fin 5.FI/Stair 8.
Stories 1 One Story	4.Steam 8.FI/Wall 12.	3.3/4 Fin 6. 9.None
1.1 4.1.5 7.	Cool Type 0% 9 None	Insulation 1 Full
2.2 5.1.75 8.	1.Refrig 4.W&C Air 7.	1.Full 4.Minimal 7.
3.3 6.2.5 9.	2.Evapor 5. 8.	2.Heavy 5.Partial 8.
Exterior Walls 2 Vinyl/Aluminum	3.H Pump 6. 9.None	3.Capped 6. 9.None
1.Wood 5.Stucco 9.T-111	Kitchen Style 2 Typical	Unfinished % 0%
2.Vin/Al 6.Brick 10.Other	1.Modern 4.Obsolete 7.	Grade & Factor 3 Average 100%
3.Compos. 7.Stone 11.	2.Typical 5. 8.	1.E Grade 4.B Grade 7.
4.Asbestos 8.Concrete 12.	3.Old Type 6. 9.None	2.D Grade 5.A Grade 8.SC Grade
Roof Surface 3 Sheet Metal	Bath(s) Style 2 Typical Bath(s)	SQFT (Footprint) 1430
1.Asphalt 4.Composit 7.	1.Modern 4.Obsolete 7.	Condition 6 Good
2.Slate 5.Wood 8.	2.Typical 5. 8.	1.Poor 4.Avg 7.V G
3.Metal 6.Other 9.	3.Old Type 6. 9.None	2.Fair 5.Avg+ 8.Exc
SF Masonry Trim 0	# Rooms 5	3.Avg- 6.Good 9.Same
OPEN-3-CUSTOM 0	# Bedrooms 3	Phys. % Good 0%
OPEN-4-CUSTOM 0	# Full Baths 1	Funct. % Good 100%
Year Built 1960	# Half Baths 0	Functional Code 9 None
Year Remodeled 0	# Addn Fixtures 0	1.Incomp 4.Delap 7.No Power
Foundation 1 Concrete	# Fireplaces 0	2.O-Built 5.Bsmt 8.LongTerm
1.Concrete 4.Wood 7.	 <p>TRIO Software <i>A Division of Harris Computer Systems</i></p>	3.Damage 6.Common 9.None
2.C Block 5.Slab 8.		Econ. % Good 100%
3.Br/Stone 6.Piers 9.		Economic Code None
Basement 4 Full Basement		0.None 3.No Power 7.
1.1/4 Bmt 4.Full Bmt 7.		1.Location 4.Generate 8.
2.1/2 Bmt 5.None 8.		2.Encroach 9.None 9.
3.3/4 Bmt 6. 9.None		Entrance Code 5 Estimated
Bsmt Gar # Cars 0		1.Interior 4.Vacant 7.
Wet Basement 1 Dry Basement		2.Refusal 5.Estimate 8.
1.Dry 4. 7.		3.Informed 6.Reviewed 9.
2.Damp 5. 8.	Information Code 5 Estimate	
3.Wet 6. 9.	1.Owner 4.Agent 7.	
	2.Relative 5.Estimate 8.	
	3.Tenant 6.Other 9.	

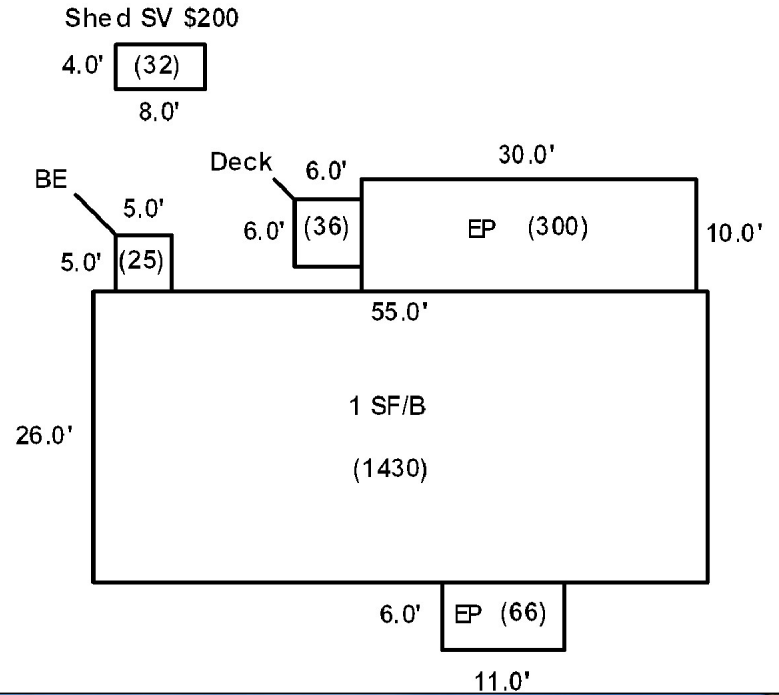

Date Inspected 10/05/2018

Additions, Outbuildings & Improvements

Type	Year	Units	Grade	Cond	Phys.	Funct.	Sound Value
22 Encl Frame Porch	1960	66	3 100	5	0 %	100 %	
22 Encl Frame Porch	1980	300	3 90	5	0 %	100 %	
68 Wood Deck	2000	36	3 100	4	0 %	100 %	
40 Basement Entry	1960	25	9 100	9	0 %	100 %	
24 Frame Shed	0				%	%	200
					%	%	
					%	%	
					%	%	
					%	%	
					%	%	
					%	%	
					%	%	
					%	%	

- 1.One Story Fram
- 2.Two Story Fram
- 3.Three Story Fr
- 4.1 & 1/2 Story
- 5.1 & 3/4 Story
- 6.2 & 1/2 Story
- 21.Open Frame Por
- 22.Encl Frame Por
- 23.Frame Garage
- 24.Frame Shed
- 25.Frame Bay Wind
- 26.1SFr Overhang
- 27.Unfin Basement
- 28.Unfinished Att
- 29.Finished Attic

STATEWIDE HOUSING SOLUTIONS LLC
911 Iowa Avenue
Groveland FL 34736

B6280P125

Previous Owner
GINZBURG, SERGEY
KISLOV, EVGENII
203 S. CLYDE AVENUE
KISSIMMEE FL 34741
Sale Date: 1/21/2022

Previous Owner
VAUGHAN, WAYNE
c/o CROWN TRAVEL
493 MAIN STREET
PRESQUE ISLE ME 04769
Sale Date: 11/19/2014

Previous Owner
Cox, Maxine
c/o Debra Deveau
337 Easton Road
Presque Isle ME 04769
Sale Date: 10/21/2011

Inspection Witnessed By:

X	Date
No./Date	Description
	Date Insp.

Notes:

Washburn

Property Data			Assessment Record						
Neighborhood 1 Neighborhood One			Year	Land	Buildings	Exempt	Total		
Tree Growth Year 0			2012	2,500	46,400	0	48,900		
1ST MORTGAGE 0			2013	3,200	46,400	0	49,600		
2ND MORTGAGE 0			2015	3,200	35,300	0	38,500		
Zone/Land Use 1 Residential			2018	3,200	35,300	0	38,500		
Secondary Zone			2019	6,400	49,600	0	56,000		
Topography 1 Level			2020	6,400	49,600	0	56,000		
1.Level 4.Below St 7.LevelBog			2021	6,400	49,600	0	56,000		
2.Rolling 5.Low 8.			2022	6,400	52,100	0	58,500		
3.Above St 6.Swampy 9.			2023	8,500	62,000	0	70,500		
Utilities 2 Public Water 3 Public Sewer			2024	8,500	62,000	0	70,500		
1.Public 4.Dr Well 7.Cesspool									
2.Water 5.Dug Well 8.									
3.Sewer 6.Septic 9.None									
Street 1 Paved									
1.Paved 4.Proposed 7.									
2.Semi Imp 5.R/O/W 8.									
3.Gravel 6. 9.None									
TG PLAN YEAR 0									
Tif District # 0									
Sale Data			Land Data						
Sale Date 1/21/2022			Front Foot	Type	Effective		Influence		Influence Codes
Price 10,000					Frontage	Depth	Factor	Code	
Sale Type 2 Land & Buildings			11.Regular Lot					1.Unimproved	
1.Land 4.Mobile 7.C/I L&B			12.Delta Triangle			%		2.Excess Frtg	
2.L & B 5.Other 8.			13.Nabla Triangle			%		3.Topography	
3.Building 6.C/I Land 9.			14.Rear Land			%		4.Size/Shape	
Financing 1 Conventional			15.Class I Road			%		5.Access	
1.Convent 4.Seller 7.						%		6.Restriction	
2.FHA/VA 5.Private 8.						%		7.Open Space	
3.Assumed 6.Cash 9.Unknown						%		8.View/Environ	
Validity 1 Arms Length Sale						%		9.Fract Share	
1.Valid 4.Split 7.Renovate			Square Foot	Square Feet				Acres	
2.Related 5.Partial 8.Other			16.Class II Road			%		30.Utility R O W	
3.Distress 6.Exempt 9.			17.Municipal Rese			%		31.Tillable	
Verified 5 Public Record			18.Munic Sep Lago			%		32.Pasture	
1.Buyer 4.Agent 7.Family			19.Gravel Pit			%		33.Orchard	
2.Seller 5.Pub Rec 8.Other			20.Industrial Bas			%		34.Softwood F&O	
3.Lender 6.MLS 9.						%		35.Mixed Wood F&O	
			Fract. Acre	Acreege/Sites				36.Hardwood F&O	
			21.Developed Pave	21	0.15	100	%	0	37.Softwood TG
			22.Undev Paved (F				%		38.Mixed Wood TG
			23.Developed Grav				%		39.Hardwood TG
			Acres				%		40.Wasteland
			24.Undev Gravel (%		41.Open Space
			25.Comm Base Pave				%		42.Mobile Home Si
			26.Comm Base Grav				%		43.Condo Site
			27.Backlot				%		44.Lot Improvemen
			28.Rear Land				%		45.Subdivision Lo
			29.Pavement				%		46.Heavy Ind Sit
			Total Acreage		0.15				

Washburn

Map Lot 011-068A

Account 289

Location 11 McMANUS STREET

Card 1

Of 1

9/04/2024

Building Style 1 Conventional	SF Bsmt Living 0	Layout 1 Typical
1.Conv. 5.Garrison 9.Gambrel	Fin Bsmt Grade 0 0	1.Typical 4. 7.
2.Ranch 6.Salt Box 10.Other	OPEN 5 OPTIONAL 0	2.Inadeq 5. 8.
3.R Ranch 7.Contemp 11.Split	Heat Type 100% 5 Forced Warm Air	3.Poor 6. 9.
4.Cape 8.Log 12.	1.HWBB 5.FWA 9.No Heat	Attic 9 None
Dwelling Units 1	2.HWCI 6.GravWA 10.	1.1/4 Fin 4.Full Fin 7.
Other Units 0	3.H Pump 7.Electric 11.	2.1/2 Fin 5.F/Stair 8.
Stories 2 Two Story	4.Steam 8.F/Wall 12.	3.3/4 Fin 6. 9.None
1.1 4.1.5 7.	Cool Type 0% 9 None	Insulation 1 Full
2.2 5.1.75 8.	1.Refrig 4.W&C Air 7.	1.Full 4.Minimal 7.
3.3 6.2.5 9.	2.Evapor 5. 8.	2.Heavy 5.Partial 8.
Exterior Walls 4 Asbestos Siding	3.H Pump 6. 9.None	3.Capped 6. 9.None
1.Wood 5.Stucco 9.T-111	Kitchen Style 2 Typical	Unfinished % 0%
2.Vin/Al 6.Brick 10.Other	1.Modern 4.Obsolete 7.	Grade & Factor 2 Fair 110%
3.Compos. 7.Stone 11.	2.Typical 5. 8.	1.E Grade 4.B Grade 7.
4.Asbestos 8.Concrete 12.	3.Old Type 6. 9.None	2.D Grade 5.A Grade 8.SC Grade
Roof Surface 3 Sheet Metal	Bath(s) Style 2 Typical Bath(s)	3.C Grade 6.AA Grade 9.Same
1.Asphalt 4.Composit 7.	1.Modern 4.Obsolete 7.	SQFT (Footprint) 320
2.Slate 5.Wood 8.	2.Typical 5. 8.	Condition 4 Average
3.Metal 6.Other 9.	3.Old Type 6. 9.None	1.Poor 4.Avg 7.V G
SF Masonry Trim 0	# Rooms 6	2.Fair 5.Avg+ 8.Exc
OPEN-3-CUSTOM 0	# Bedrooms 3	3.Avg- 6.Good 9.Same
OPEN-4-CUSTOM 0	# Full Baths 1	Phys. % Good 0%
Year Built 1940	# Half Baths 0	Funct. % Good 100%
Year Remodeled 0	# Addn Fixtures 0	Functional Code 9 None
Foundation 1 Concrete	# Fireplaces 0	1.Incomp 4.Delap 7.No Power
1.Concrete 4.Wood 7.	 <p>TRIO Software <i>A Division of Harris Computer Systems</i></p>	2.O-Built 5.Bsmt 8.LongTerm
2.C Block 5.Slab 8.		3.Damage 6.Common 9.None
3.Br/Stone 6.Piers 9.		Econ. % Good 100%
Basement 4 Full Basement		Economic Code None
1.1/4 Bmt 4.Full Bmt 7.		0.None 3.No Power 7.
2.1/2 Bmt 5.None 8.		1.Location 4.Generate 8.
3.3/4 Bmt 6. 9.None		2.Encroach 9.None 9.
Bsmt Gar # Cars 0		Entrance Code 5 Estimated
Wet Basement 1 Dry Basement		1.Interior 4.Vacant 7.
1.Dry 4. 7.		2.Refusal 5.Estimate 8.
2.Damp 5. 8.	3.Informed 6.Reviewed 9.	
3.Wet 6. 9.	Information Code 5 Estimate	
	1.Owner 4.Agent 7.	
	2.Relative 5.Estimate 8.	
	3.Tenant 6.Other 9.	

Date Inspected 10/05/2018

Additions, Outbuildings & Improvements

Type	Year	Units	Grade	Cond	Phys.	Funct.	Sound Value
21 Open Frame	1960	200	3 90	3	0 %	100 %	
20 1 Story/Bsmt	1940	480	9 100	9	0 %	100 %	
26 1SFr Overhang	1940	104	9 100	9	0 %	100 %	
					%	%	
					%	%	
					%	%	
					%	%	
					%	%	
					%	%	
					%	%	
					%	%	

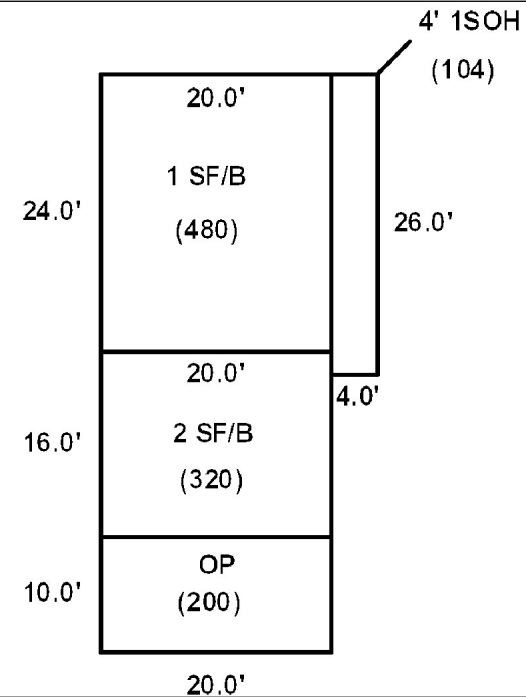

Washburn

Map Lot 011-069

Account 440

Location 5 McManus Street

Card 1 Of 1 9/04/2024

Building Style 1 Conventional	SF Bsmt Living 0	Layout 1 Typical
1.Conv. 5.Garrison 9.Gambrel	Fin Bsmt Grade 0 0	1.Typical 4. 7.
2.Ranch 6.Salt Box 10.Other	OPEN 5 OPTIONAL 0	2.Inadeq 5. 8.
3.R Ranch 7.Contemp 11.Split	Heat Type 100% 5 Forced Warm Air	3.Poor 6. 9.
4.Cape 8.Log 12.	1.HWBB 5.FWA 9.No Heat	Attic 9 None
Dwelling Units 1	2.HWCI 6.GravWA 10.	1.1/4 Fin 4.Full Fin 7.
Other Units 0	3.H Pump 7.Electric 11.	2.1/2 Fin 5.FI/Stair 8.
Stories 2 Two Story	4.Steam 8.FI/Wall 12.	3.3/4 Fin 6. 9.None
1.1 4.1.5 7.	Cool Type 0% 9 None	Insulation 1 Full
2.2 5.1.75 8.	1.Refrig 4.W&C Air 7.	1.Full 4.Minimal 7.
3.3 6.2.5 9.	2.Evapor 5. 8.	2.Heavy 5.Partial 8.
Exterior Walls 2 Vinyl/Aluminum	3.H Pump 6. 9.None	3.Capped 6. 9.None
1.Wood 5.Stucco 9.T-111	Kitchen Style 2 Typical	Unfinished % 0%
2.Vin/Al 6.Brick 10.Other	1.Modern 4.Obsolete 7.	Grade & Factor 2 Fair 110%
3.Compos. 7.Stone 11.	2.Typical 5. 8.	1.E Grade 4.B Grade 7.
4.Asbestos 8.Concrete 12.	3.Old Type 6. 9.None	2.D Grade 5.A Grade 8.SC Grade
Roof Surface 1 Asphalt Shingles	Bath(s) Style 2 Typical Bath(s)	3.C Grade 6.AA Grade 9.Same
1.Asphalt 4.Composit 7.	1.Modern 4.Obsolete 7.	SQFT (Footprint) 672
2.Slate 5.Wood 8.	2.Typical 5. 8.	Condition 6 Good
3.Metal 6.Other 9.	3.Old Type 6. 9.None	1.Poor 4.Avg 7.V G
SF Masonry Trim 0	# Rooms 8	2.Fair 5.Avg+ 8.Exc
OPEN-3-CUSTOM 0	# Bedrooms 4	3.Avg- 6.Good 9.Same
OPEN-4-CUSTOM 0	# Full Baths 2	Phys. % Good 0%
Year Built 1950	# Half Baths 0	Funct. % Good 100%
Year Remodeled 0	# Addn Fixtures 0	Functional Code 9 None
Foundation 2 Concrete Block	# Fireplaces 0	1.Incomp 4.Delap 7.No Power
1.Concrete 4.Wood 7.	 <p>TRIO Software <i>A Division of Harris Computer Systems</i></p>	2.O-Built 5.Bsmt 8.LongTerm
2.C Block 5.Slab 8.		Econ. % Good 100%
3.Br/Stone 6.Piers 9.		Economic Code None
Basement 4 Full Basement		0.None 3.No Power 7.
1.1/4 Bmt 4.Full Bmt 7.		1.Location 4.Generate 8.
2.1/2 Bmt 5.None 8.		2.Encroach 9.None 9.
3.3/4 Bmt 6. 9.None		Entrance Code 5 Estimated
Bsmt Gar # Cars 0		1.Interior 4.Vacant 7.
Wet Basement 1 Dry Basement		2.Refusal 5.Estimate 8.
1.Dry 4. 7.		3.Informed 6.Reviewed 9.
2.Damp 5. 8.	Information Code 5 Estimate	
3.Wet 6. 9.	1.Owner 4.Agent 7.	
	2.Relative 5.Estimate 8.	
	3.Tenant 6.Other 9.	

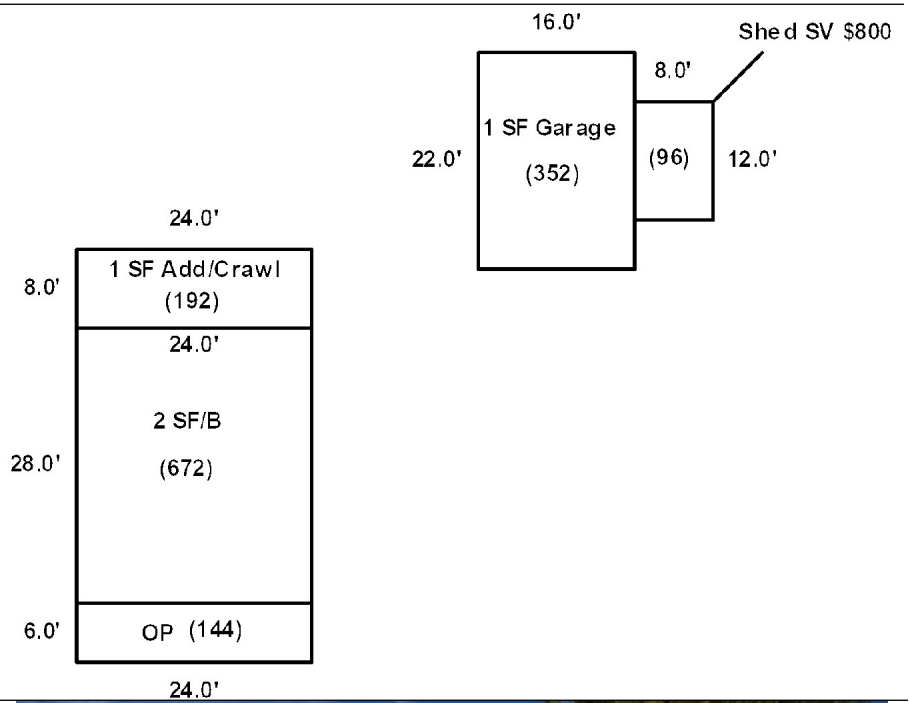

Date Inspected 10/05/2018

Additions, Outbuildings & Improvements

Type	Year	Units	Grade	Cond	Phys.	Funct.	Sound Value
21 Open Frame	1960	144	3 90	4	0 %	100 %	
1 One Story Frame	1955	192	3 90	5	0 %	100 %	
23 Frame Garage	1960	352	3 95	4	0 %	100 %	
24 Frame Shed	0				%	%	800
					%	%	
					%	%	
					%	%	
					%	%	
					%	%	
					%	%	
					%	%	



Washburn

Map Lot 011-070

Account 180

Location 1 McManus Street

Card 1 Of 1 9/04/2024

Building Style	4 Cape Cod		SF Bsmt Living	0		Layout	1 Typical							
1.Conv.	5.Garrison	9.Gambrel	Fin Bsmt Grade	0 0		1.Typical	4.	7.						
2.Ranch	6.Salt Box	10.Other	OPEN 5 OPTIONAL	0		2.Inadeq	5.	8.						
3.R Ranch	7.Contemp	11.Split	Heat Type	100% 5 Forced Warm Air		3.Poor	6.	9.						
4.Cape	8.Log	12.	1.HWBB	5.FWA	9.No Heat	Attic	9 None							
Dwelling Units	1		2.HWCI	6.GravWA	10.	1.1/4 Fin	4.Full Fin	7.						
Other Units	0		3.H Pump	7.Electric	11.	2.1/2 Fin	5.FI/Stair	8.						
Stories	4 One & 1/2 Story		4.Steam	8.FI/Wall	12.	3.3/4 Fin	6.	9.None						
1.1	4.1.5	7.	Cool Type	0% 9 None		Insulation	1 Full							
2.2	5.1.75	8.	1.Refrig	4.W&C Air	7.	1.Full	4.Minimal	7.						
3.3	6.2.5	9.	2.Evapor	5.	8.	2.Heavy	5.Partial	8.						
Exterior Walls	2 Vinyl/Aluminum		3.H Pump	6.	9.None	3.Capped	6.	9.None						
1.Wood	5.Stucco	9.T-111	Kitchen Style	2 Typical		Unfinished %	0%							
2.Vin/Al	6.Brick	10.Other	1.Modern	4.Obsolete	7.	Grade & Factor	2 Fair 110%							
3.Compos.	7.Stone	11.	2.Typical	5.	8.	1.E Grade	4.B Grade	7.						
4.Asbestos	8.Concrete	12.	3.Old Type	6.	9.None	2.D Grade	5.A Grade	8.SC Grade						
Roof Surface	3 Sheet Metal		Bath(s) Style	2 Typical Bath(s)		3.C Grade	6.AA Grade	9.Same						
1.Asphalt	4.Composit	7.	1.Modern	4.Obsolete	7.	SQFT (Footprint)	270							
2.Slate	5.Wood	8.	2.Typical	5.	8.	Condition	6 Good							
3.Metal	6.Other	9.	3.Old Type	6.	9.None	1.Poor	4.Avg	7.V G						
SF Masonry Trim	0		# Rooms	5		2.Fair	5.Avg+	8.Exc						
OPEN-3-CUSTOM	0		# Bedrooms	3		3.Avg-	6.Good	9.Same						
OPEN-4-CUSTOM	0		# Full Baths	1		Phys. % Good	0%							
Year Built	1920		# Half Baths	0		Funct. % Good	100%							
Year Remodeled	0		# Addn Fixtures	0		Functional Code	9 None							
Foundation	1 Concrete		# Fireplaces	0		1.Incomp	4.Delap	7.No Power						
1.Concrete	4.Wood	7.							2.O-Built	5.Bsmt	8.LongTerm			
2.C Block	5.Slab	8.							Econ. % Good	100%		3.Damage	6.Common	9.None
3.Br/Stone	6.Piers	9.							Economic Code	None		1.None	3.No Power	7.
Basement	4 Full Basement								0.None	3.No Power	7.	1.Location	4.Generate	8.
1.1/4 Bmt	4.Full Bmt	7.							1.Location	4.Generate	8.	2.Encroach	9.None	9.
2.1/2 Bmt	5.None	8.							Entrance Code	5 Estimated		1.Interior	4.Vacant	7.
3.3/4 Bmt	6.	9.None							2.Refusal	5.Estimate	8.	3.Informed	6.Reviewed	9.
Bsmt Gar # Cars	0								Information Code	5 Estimate		1.Owner	4.Agent	7.
Wet Basement	1 Dry Basement								2.Relative	5.Estimate	8.	3.Tenant	6.Other	9.
1.Dry	4.	7.							29.Finished Attic					
2.Damp	5.	8.												
3.Wet	6.	9.												

Date Inspected 10/05/2018

Additions, Outbuildings & Improvements

Type	Year	Units	Grade	Cond	Phys.	Funct.	Sound Value
1 One Story Frame	1940	216	2 110	5	0 %	100 %	
22 Encl Frame Porch	1965	168	3 95	4	0 %	100 %	
21 Open Frame	1965	40	2 115	4	0 %	100 %	
23 Frame Garage	1960	384	3 100	4	0 %	100 %	
					%	%	
					%	%	
					%	%	
					%	%	
					%	%	
					%	%	
					%	%	
					%	%	

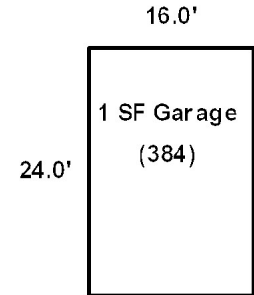
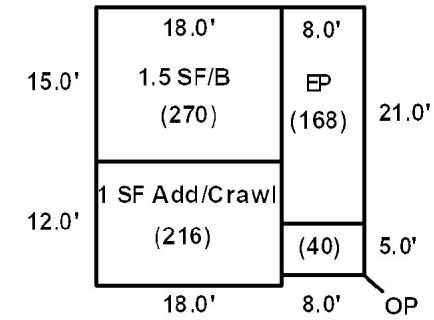

NORTHERN NEW ENGLAND
TELEPHONE OPERATIONS LLC
2116 South 17th Street
Mattoon IL 61938

B4559P140

Inspection Witnessed By:

X Date

No./Date	Description	Date Insp.

Notes:

Washburn

Property Data			Assessment Record						
Neighborhood 1 Neighborhood One			Year	Land	Buildings	Exempt	Total		
Tree Growth Year 0			2012	5,900	41,500	0	47,400		
1ST MORTGAGE 0			2013	7,600	41,500	0	49,100		
2ND MORTGAGE 0			2015	7,600	41,500	0	49,100		
Zone/Land Use 2 Commercial			2018	7,600	41,500	0	49,100		
Secondary Zone			2019	5,000	32,800	0	37,800		
Topography 2 Rolling			2020	5,000	32,400	0	37,400		
1.Level 4.Below St 7.LevelBog			2021	5,000	32,800	0	37,800		
2.Rolling 5.Low 8.			2022	5,000	34,500	0	39,500		
3.Above St 6.Swampy 9.			2023	5,600	41,100	0	46,700		
Utilities			2024	5,600	41,100	0	46,700		
1.Public 4.Dr Well 7.Cesspool									
2.Water 5.Dug Well 8.									
3.Sewer 6.Septic 9.None									
Street 1 Paved									
1.Paved 4.Proposed 7.			Land Data						
2.Semi Imp 5.R/O/W 8.									
3.Gravel 6. 9.None			Front Foot	Type	Effective		Influence		Influence Codes
TG PLAN YEAR 0			11.Regular Lot		Frontage	Depth	Factor	Code	
Tif District # 0			12.Delta Triangle				%		1.Unimproved
Sale Data			13.Nabla Triangle				%		2.Excess Frtg
Sale Date 3/31/2008			14.Rear Land				%		3.Topography
Price			15.Class I Road				%		4.Size/Shape
Sale Type 2 Land & Buildings							%		5.Access
1.Land 4.Mobile 7.C/I L&B			Square Foot	Square Feet					6.Restriction
2.L & B 5.Other 8.			16.Class II Road				%		7.Open Space
3.Building 6.C/I Land 9.			17.Municipal Rese				%		8.View/Environ
Financing			18.Munic Sep Lago				%		9.Fract Share
1.Convent 4.Seller 7.			19.Gravel Pit				%		Acres
2.FHA/VA 5.Private 8.			20.Industrial Bas				%		30.Utility R O W
3.Assumed 6.Cash 9.Unknown							%		31.Tillable
Validity 1 Arms Length Sale			Fract. Acre	Acres/Sites					32.Pasture
1.Valid 4.Split 7.Renovate			21.Developed Pave	25	0.15	100	%	0	33.Orchard
2.Related 5.Partial 8.Other			22.Undev Paved (F				%		34.Softwood F&O
3.Distress 6.Exempt 9.			23.Developed Grav				%		35.Mixed Wood F&O
Verified 5 Public Record			Acres				%		36.Hardwood F&O
1.Buyer 4.Agent 7.Family			24.Undev Gravel (%		37.Softwood TG
2.Seller 5.Pub Rec 8.Other			25.Comm Base Pave				%		38.Mixed Wood TG
3.Lender 6.MLS 9.			26.Comm Base Grav				%		39.Hardwood TG
			27.Backlot				%		40.Wasteland
			28.Rear Land				%		41.Open Space
			29.Pavement				%		42.Mobile Home Si
			Total Acreage		0.15				43.Condo Site
									44.Lot Improvemen
									45.Subdivision Lo
									46.Heavy Ind Sit

Washburn

Map Lot 011-072

Account 222

Location 1296 MAIN STREET

Card 1 Of 1 9/04/2024

Building Style 0	SF Bsmt Living 0	Layout 0
1.Conv. 5.Garrison 9.Gambrel	Fin Bsmt Grade 0 0	1.Typical 4. 7.
2.Ranch 6.Salt Box 10.Other	OPEN 5 OPTIONAL 0	2.Inadeq 5. 8.
3.R Ranch 7.Contemp 11.Split	Heat Type 100% 0	3.Poor 6. 9.
4.Cape 8.Log 12.	1.HWBB 5.FWA 9.No Heat	Attic 0
Dwelling Units 0	2.HWCI 6.GravWA 10.	1.1/4 Fin 4.Full Fin 7.
Other Units 0	3.H Pump 7.Electric 11.	2.1/2 Fin 5.FI/Stair 8.
Stories 0	4.Steam 8.FI/Wall 12.	3.3/4 Fin 6. 9.None
1.1 4.1.5 7.	Cool Type 0% 9 None	Insulation 0
2.2 5.1.75 8.	1.Refrig 4.W&C Air 7.	1.Full 4.Minimal 7.
3.3 6.2.5 9.	2.Evapor 5. 8.	2.Heavy 5.Partial 8.
Exterior Walls 0	3.H Pump 6. 9.None	3.Capped 6. 9.None
1.Wood 5.Stucco 9.T-111	Kitchen Style 0	Unfinished % 0%
2.Vin/Al 6.Brick 10.Other	1.Modern 4.Obsolete 7.	Grade & Factor 0 0%
3.Compos. 7.Stone 11.	2.Typical 5. 8.	1.E Grade 4.B Grade 7.
4.Asbestos 8.Concrete 12.	3.Old Type 6. 9.None	2.D Grade 5.A Grade 8.SC Grade
Roof Surface 0	Bath(s) Style 0	3.C Grade 6.AA Grade 9.Same
1.Asphalt 4.Composit 7.	1.Modern 4.Obsolete 7.	SQFT (Footprint) 0
2.Slate 5.Wood 8.	2.Typical 5. 8.	Condition 0
3.Metal 6.Other 9.	3.Old Type 6. 9.None	1.Poor 4.Avg 7.V G
SF Masonry Trim 0	# Rooms 0	2.Fair 5.Avg+ 8.Exc
OPEN-3-CUSTOM 0	# Bedrooms 0	3.Avg- 6.Good 9.Same
OPEN-4-CUSTOM 0	# Full Baths 0	Phys. % Good 0%
Year Built 0	# Half Baths 0	Funct. % Good 100%
Year Remodeled 0	# Addn Fixtures 0	Functional Code 9 None
Foundation 0	# Fireplaces 0	1.Incomp 4.Delap 7.No Power
1.Concrete 4.Wood 7.	 <p>TRIO Software A Division of Harris Computer Systems</p>	2.O-Built 5.Bsmt 8.LongTerm
2.C Block 5.Slab 8.		3.Damage 6.Common 9.None
3.Br/Stone 6.Piers 9.		Econ. % Good 100%
Basement 0		Economic Code None
1.1/4 Bmt 4.Full Bmt 7.		0.None 3.No Power 7.
2.1/2 Bmt 5.None 8.		1.Location 4.Generate 8.
3.3/4 Bmt 6. 9.None		2.Encroach 9.None 9.
Bsmt Gar # Cars 0		Entrance Code 1 Interior Inspect
Wet Basement 0		1.Interior 4.Vacant 7.
1.Dry 4. 7.		2.Refusal 5.Estimate 8.
2.Damp 5. 8.	3.Informed 6.Reviewed 9.	
3.Wet 6. 9.	Information Code 1 Owner	
		1.Owner 4.Agent 7.
		2.Relative 5.Estimate 8.
		3.Tenant 6.Other 9.

Date Inspected 10/15/2018

Additions, Outbuildings & Improvements

Type	Year	Units	Grade	Cond	Phys.	Funct.	Sound Value
20 1 Story/Bsmt	1920	476	2 100	3	0 %	100 %	
21 Open Frame	1950	28	2 100	3	0 %	100 %	
1 One Story Frame	1920	196	2 100	2	0 %	100 %	
24 Frame Shed	1940	290	2 100	2	0 %	100 %	
24 Frame Shed	0				%	%	400
					%	%	
					%	%	
					%	%	
					%	%	
					%	%	
					%	%	

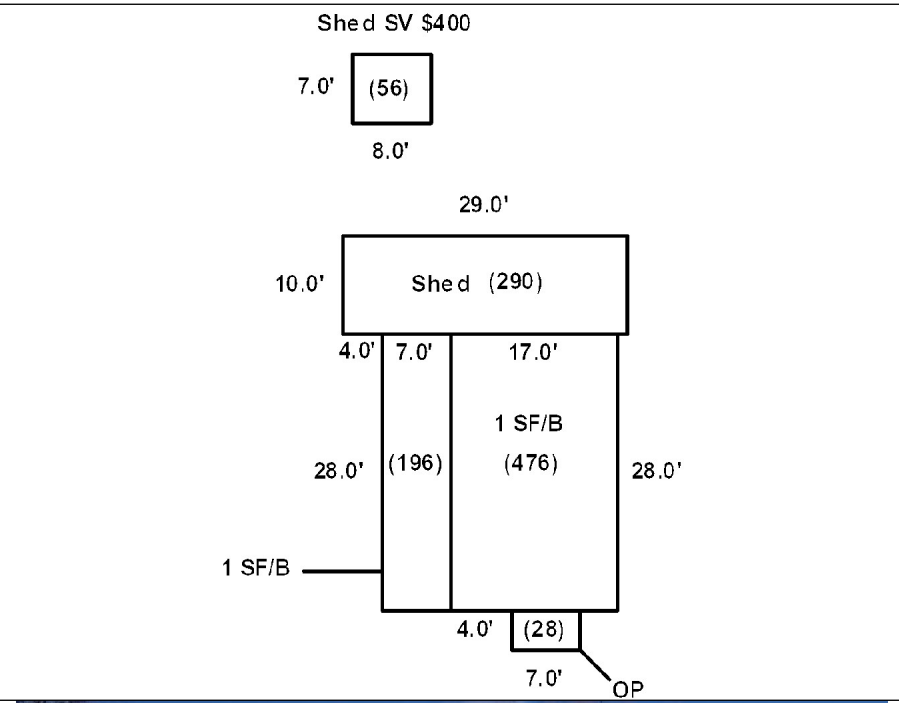

Washburn

Map Lot 011-073

Account 277

Location 1298 MAIN STREET

Card 1 Of 1 9/04/2024

Building Style 4 Cape Cod	SF Bsmt Living 0	Layout 1 Typical
1.Conv. 5.Garrison 9.Gambrel	Fin Bsmt Grade 0 0	1.Typical 4. 7.
2.Ranch 6.Salt Box 10.Other	OPEN 5 OPTIONAL 0	2.Inadeq 5. 8.
3.R Ranch 7.Contemp 11.Split	Heat Type 100% 8 Floor/Wall Unit	3.Poor 6. 9.
4.Cape 8.Log 12.	1.HWBB 5.FWA 9.No Heat	Attic 9 None
Dwelling Units 1	2.HWCI 6.GravWA 10.	1.1/4 Fin 4.Full Fin 7.
Other Units 0	3.H Pump 7.Electric 11.	2.1/2 Fin 5.F/Stair 8.
Stories 4 One & 1/2 Story	4.Steam 8.F/Wall 12.	3.3/4 Fin 6. 9.None
1.1 4.1.5 7.	Cool Type 0% 9 None	Insulation 1 Full
2.2 5.1.75 8.	1.Refrig 4.W&C Air 7.	1.Full 4.Minimal 7.
3.3 6.2.5 9.	2.Evapor 5. 8.	2.Heavy 5.Partial 8.
Exterior Walls 2 Vinyl/Aluminum	3.H Pump 6. 9.None	3.Capped 6. 9.None
1.Wood 5.Stucco 9.T-111	Kitchen Style 2 Typical	Unfinished % 0%
2.Vin/Al 6.Brick 10.Other	1.Modern 4.Obsolete 7.	Grade & Factor 2 Fair 100%
3.Compos. 7.Stone 11.	2.Typical 5. 8.	1.E Grade 4.B Grade 7.
4.Asbestos 8.Concrete 12.	3.Old Type 6. 9.None	2.D Grade 5.A Grade 8.SC Grade
Roof Surface 6 Other	Bath(s) Style 2 Typical Bath(s)	3.C Grade 6.AA Grade 9.Same
1.Asphalt 4.Composit 7.	1.Modern 4.Obsolete 7.	SQFT (Footprint) 360
2.Slate 5.Wood 8.	2.Typical 5. 8.	Condition 3 Below Average
3.Metal 6.Other 9.	3.Old Type 6. 9.None	1.Poor 4.Avg 7.V G
SF Masonry Trim 0	# Rooms 3	2.Fair 5.Avg+ 8.Exc
OPEN-3-CUSTOM 0	# Bedrooms 1	3.Avg- 6.Good 9.Same
OPEN-4-CUSTOM 0	# Full Baths 1	Phys. % Good 0%
Year Built 1930	# Half Baths 0	Funct. % Good 100%
Year Remodeled 0	# Addn Fixtures 0	Functional Code 9 None
Foundation 1 Concrete	# Fireplaces 0	1.Incomp 4.Delap 7.No Power
1.Concrete 4.Wood 7.	 <p>TRIO Software A Division of Harris Computer Systems</p>	2.O-Built 5.Bsmt 8.LongTerm
2.C Block 5.Slab 8.		3.Damage 6.Common 9.None
3.Br/Stone 6.Piers 9.		Econ. % Good 100%
Basement 4 Full Basement		Economic Code None
1.1/4 Bmt 4.Full Bmt 7.		0.None 3.No Power 7.
2.1/2 Bmt 5.None 8.		1.Location 4.Generate 8.
3.3/4 Bmt 6. 9.None		2.Encroach 9.None 9.
Bsmt Gar # Cars 0		Entrance Code 1 Interior Inspect
Wet Basement 2 Damp Basement		1.Interior 4.Vacant 7.
1.Dry 4. 7.		2.Refusal 5.Estimate 8.
2.Damp 5. 8.	3.Informed 6.Reviewed 9.	
3.Wet 6. 9.	Information Code 1 Owner	
	1.Owner 4.Agent 7.	
	2.Relative 5.Estimate 8.	
	3.Tenant 6.Other 9.	

Date Inspected 10/15/2018

Additions, Outbuildings & Improvements

Type	Year	Units	Grade	Cond	Phys.	Funct.	Sound Value
20 1 Story/Bsmt	1930	220	9 100	9	0 %	100 %	
24 Frame Shed	1950	160	2 100	3	0 %	80 %	
24 Frame Shed	1950	224	2 95	2	0 %	85 %	
					%	%	
					%	%	
					%	%	
					%	%	
					%	%	
					%	%	
					%	%	
					%	%	
					%	%	

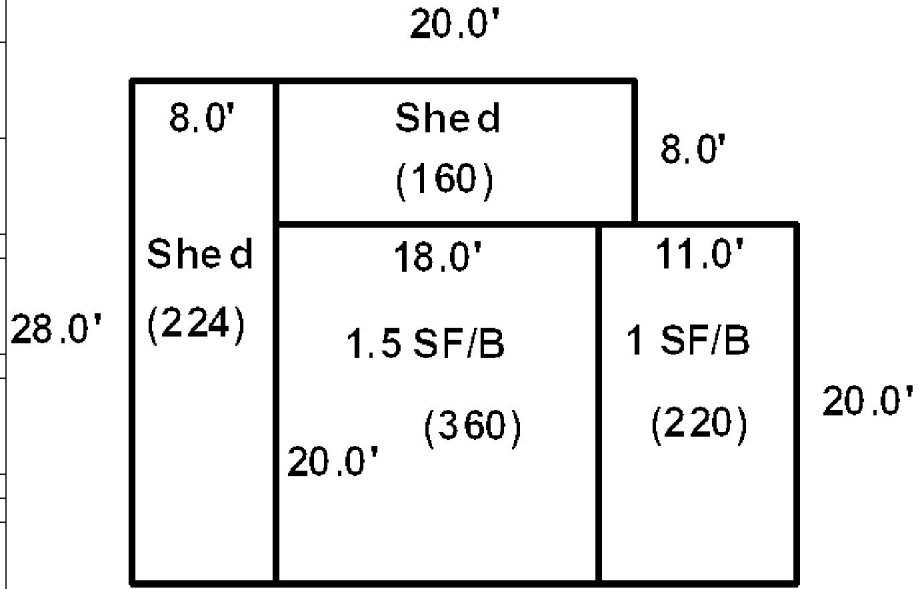

ANTIUK, ALICIA M
337 FOREST AVENUE #1
BANGOR ME 04401

B5191P304 B5777P178

Previous Owner
AROOSTOOK COUNTY FEDERAL
SAVINGS AND LOAN ASSOCIATION
PO BOX 808
CARIBOU ME 04736
Sale Date: 6/06/2013

Previous Owner
STURGIS, HARRY J.
STURGIS, SHERRY
P.O. BOX 522
S. SEAVILLE NJ 08246 0522
Sale Date: 4/17/2013

Inspection Witnessed By:

X	Date
No./Date	Description
	Date Insp.

Notes:

Washburn

Property Data			Assessment Record						
Neighborhood 1 Neighborhood One			Year	Land	Buildings	Exempt	Total		
Tree Growth Year 0			2012	4,100	39,300	0	43,400		
1ST MORTGAGE 0			2013	5,400	0	0	5,400		
2ND MORTGAGE 0			2015	5,400	0	0	5,400		
Zone/Land Use 1 Residential			2018	5,400	0	0	5,400		
Secondary Zone			2019	4,700	0	0	4,700		
Topography 1 Level			2020	4,700	0	0	4,700		
1.Level 4.Below St 7.LevelBog			2021	4,700	0	0	4,700		
2.Rolling 5.Low 8.			2022	4,700	0	0	4,700		
3.Above St 6.Swampy 9.			2023	5,700	0	0	5,700		
Utilities			2024	5,700	0	0	5,700		
1.Public 4.Dr Well 7.Cesspool									
2.Water 5.Dug Well 8.									
3.Sewer 6.Septic 9.None									
Street 1 Paved									
1.Paved 4.Proposed 7.									
2.Semi Imp 5.R/O/W 8.									
3.Gravel 6. 9.None									
TG PLAN YEAR 0									
Tif District # 0									
Sale Data			Land Data						
Sale Date 6/06/2013			Front Foot	Type	Effective		Influence		Influence Codes
Price 22,000					Frontage	Depth	Factor	Code	
Sale Type 2 Land & Buildings			11.Regular Lot					1.Unimproved	
1.Land 4.Mobile 7.C/I L&B			12.Delta Triangle					2.Excess Frtg	
2.L & B 5.Other 8.			13.Nabla Triangle					3.Topography	
3.Building 6.C/I Land 9.			14.Rear Land					4.Size/Shape	
Financing			15.Class I Road					5.Access	
1.Convent 4.Seller 7.								6.Restriction	
2.FHA/VA 5.Private 8.								7.Open Space	
3.Assumed 6.Cash 9.Unknown								8.View/Environ	
Validity 3 Distressed Sale								9.Fract Share	
1.Valid 4.Split 7.Renovate			Square Foot	Square Feet				Acres	
2.Related 5.Partial 8.Other			16.Class II Road					30.Utility R O W	
3.Distress 6.Exempt 9.			17.Municipal Rese					31.Tillable	
Verified 5 Public Record			18.Munic Sep Lago					32.Pasture	
1.Buyer 4.Agent 7.Family			19.Gravel Pit					33.Orchard	
2.Seller 5.Pub Rec 8.Other			20.Industrial Bas					34.Softwood F&O	
3.Lender 6.MLS 9.								35.Mixed Wood F&O	
			Fract. Acre					36.Hardwood F&O	
			21.Developed Pave	22	0.27	100	%	0	
			22.Undev Paved (F					%	
			23.Developed Grav					%	
			Acres					%	
			24.Undev Gravel (%	
			25.Comm Base Pave					%	
			26.Comm Base Grav					%	
			27.Backlot					%	
			28.Rear Land					%	
			29.Pavement					%	
			Total Acreage		0.27				
								44.Lot Improvemen	
								45.Subdivision Lo	
								46.Heavy Ind Sit	

Washburn

Map Lot 011-074

Account 271

Location 1348 MAIN STREET

Card 1 Of 1 9/04/2024

Building Style 0	SF Bsmt Living 0	Layout 0
1.Conv. 5.Garrison 9.Gambrel	Fin Bsmt Grade 0 0	1.Typical 4. 7.
2.Ranch 6.Salt Box 10.Other	OPEN 5 OPTIONAL 0	2.Inadeq 5. 8.
3.R Ranch 7.Contemp 11.Split	Heat Type 100% 0	3.Poor 6. 9.
4.Cape 8.Log 12.	1.HWBB 5.FWA 9.No Heat	Attic 0
Dwelling Units 0	2.HWCI 6.GravWA 10.	1.1/4 Fin 4.Full Fin 7.
Other Units 0	3.H Pump 7.Electric 11.	2.1/2 Fin 5.F/Stair 8.
Stories 0	4.Steam 8.F/Wall 12.	3.3/4 Fin 6. 9.None
1.1 4.1.5 7.	Cool Type 0% 9 None	Insulation 0
2.2 5.1.75 8.	1.Refrig 4.W&C Air 7.	1.Full 4.Minimal 7.
3.3 6.2.5 9.	2.Evapor 5. 8.	2.Heavy 5.Partial 8.
Exterior Walls 0	3.H Pump 6. 9.None	3.Capped 6. 9.None
1.Wood 5.Stucco 9.T-111	Kitchen Style 0	Unfinished % 0%
2.Vin/Al 6.Brick 10.Other	1.Modern 4.Obsolete 7.	Grade & Factor 0 0%
3.Compos. 7.Stone 11.	2.Typical 5. 8.	1.E Grade 4.B Grade 7.
4.Asbestos 8.Concrete 12.	3.Old Type 6. 9.None	2.D Grade 5.A Grade 8.SC Grade
Roof Surface 0	Bath(s) Style 0	3.C Grade 6.AA Grade 9.Same
1.Asphalt 4.Composit 7.	1.Modern 4.Obsolete 7.	SQFT (Footprint) 0
2.Slate 5.Wood 8.	2.Typical 5. 8.	Condition 0
3.Metal 6.Other 9.	3.Old Type 6. 9.None	1.Poor 4.Avg 7.V G
SF Masonry Trim 0	# Rooms 0	2.Fair 5.Avg+ 8.Exc
OPEN-3-CUSTOM 0	# Bedrooms 0	3.Avg- 6.Good 9.Same
OPEN-4-CUSTOM 0	# Full Baths 0	Phys. % Good 0%
Year Built 0	# Half Baths 0	Funct. % Good 100%
Year Remodeled 0	# Addn Fixtures 0	Functional Code 9 None
Foundation 0	# Fireplaces 0	1.Incomp 4.Delap 7.No Power
1.Concrete 4.Wood 7.	 <p>TRIO Software A Division of Harris Computer Systems</p>	2.O-Built 5.Bsmt 8.LongTerm
2.C Block 5.Slab 8.		3.Damage 6.Common 9.None
3.Br/Stone 6.Piers 9.		Econ. % Good 100%
Basement 0		Economic Code None
1.1/4 Bmt 4.Full Bmt 7.		0.None 3.No Power 7.
2.1/2 Bmt 5.None 8.		1.Location 4.Generate 8.
3.3/4 Bmt 6. 9.None		2.Encroach 9.None 9.
Bsmt Gar # Cars 0		Entrance Code 0
Wet Basement 0		1.Interior 4.Vacant 7.
1.Dry 4. 7.		2.Refusal 5.Estimate 8.
2.Damp 5. 8.	3.Informed 6.Reviewed 9.	
3.Wet 6. 9.	Information Code 0	
		1.Owner 4.Agent 7.
		2.Relative 5.Estimate 8.
		3.Tenant 6.Other 9.

Date Inspected

Additions, Outbuildings & Improvements

Type	Year	Units	Grade	Cond	Phys.	Funct.	Sound Value
					%	%	1.One Story Fram
					%	%	2.Two Story Fram
					%	%	3.Three Story Fr
					%	%	4.1 & 1/2 Story
					%	%	5.1 & 3/4 Story
					%	%	6.2 & 1/2 Story
					%	%	21.Open Frame Por
					%	%	22.Encl Frame Por
					%	%	23.Frame Garage
					%	%	24.Frame Shed
					%	%	25.Frame Bay Wind
					%	%	26.1SFr Overhang
					%	%	27.Unfin Basement
					%	%	28.Unfinished Att
					%	%	29.Finished Attic

HOBBS, CRAIG/CRYSTAL
CHRISTEN HOBBS TRUST
562 PERHAM ROAD
PERHAM ME 04766

B5168P282

Previous Owner
Hallowell, Larry D.
48 Lombard Street

Presque Isle ME 04769
Sale Date: 4/02/2013

Previous Owner
South Wade Farms Inc.
c/o Larry Hallowell
P.O. Box 509
Washburn ME 04786
Sale Date: 12/18/2009

Previous Owner
Howard, Gary
1747 Washburn Road

Washburn ME
Sale Date: 6/12/2006

Inspection Witnessed By:

X	Date
No./Date	Description
	Date Insp.

Notes:

Washburn

Property Data			Assessment Record						
Neighborhood 1 Neighborhood One			Year	Land	Buildings	Exempt	Total		
Tree Growth Year 0			2012	5,800	0	0	5,800		
1ST MORTGAGE 0			2013	7,500	0	0	7,500		
2ND MORTGAGE 0			2015	7,500	0	0	7,500		
Zone/Land Use 1 Residential			2018	7,500	0	0	7,500		
Secondary Zone			2019	5,800	0	0	5,800		
Topography 1 Level			2020	5,800	0	0	5,800		
1.Level 4.Below St 7.LevelBog			2021	5,800	0	0	5,800		
2.Rolling 5.Low 8.			2022	5,800	0	0	5,800		
3.Above St 6.Swampy 9.			2023	7,100	0	0	7,100		
Utilities			2024	7,100	0	0	7,100		
1.Public 4.Dr Well 7.Cesspool									
2.Water 5.Dug Well 8.									
3.Sewer 6.Septic 9.None									
Street 1 Paved									
1.Paved 4.Proposed 7.									
2.Semi Imp 5.R/O/W 8.									
3.Gravel 6. 9.None									
TG PLAN YEAR 0									
Tif District # 0									
Sale Data			Land Data						
Sale Date 4/12/2013			Front Foot	Type	Effective		Influence		Influence Codes
Price 2,500					Frontage	Depth	Factor	Code	
Sale Type 1 Land Only			11.Regular Lot					1.Unimproved	
1.Land 4.Mobile 7.C/I L&B			12.Delta Triangle			%		2.Excess Frtg	
2.L & B 5.Other 8.			13.Nabla Triangle			%		3.Topography	
3.Building 6.C/I Land 9.			14.Rear Land			%		4.Size/Shape	
Financing			15.Class I Road			%		5.Access	
1.Convent 4.Seller 7.						%		6.Restriction	
2.FHA/VA 5.Private 8.						%		7.Open Space	
3.Assumed 6.Cash 9.Unknown						%		8.View/Environ	
Validity 1 Arms Length Sale			Square Foot	Square Feet				9.Fract Share	
1.Valid 4.Split 7.Renovate			16.Class II Road			%		10.Acres	
2.Related 5.Partial 8.Other			17.Municipal Rese			%		30.Utility R O W	
3.Distress 6.Exempt 9.			18.Munic Sep Lago			%		31.Tillable	
Verified 5 Public Record			19.Gravel Pit			%		32.Pasture	
1.Buyer 4.Agent 7.Family			20.Industrial Bas			%		33.Orchard	
2.Seller 5.Pub Rec 8.Other						%		34.Softwood F&O	
3.Lender 6.MLS 9.			Fract. Acre	Acreege/Sites				35.Mixed Wood F&O	
			21.Developed Pave	22	0.42	100	%	0	36.Hardwood F&O
			22.Undev Paved (F				%		37.Softwood TG
			23.Developed Grav				%		38.Mixed Wood TG
			Acres				%		39.Hardwood TG
			24.Undev Gravel (%		40.Wasteland
			25.Comm Base Pave				%		41.Open Space
			26.Comm Base Grav				%		42.Mobile Home Si
			27.Backlot				%		43.Condo Site
			28.Rear Land	Total Acreege		0.42			44.Lot Improvemen
			29.Pavement						45.Subdivision Lo
									46.Heavy Ind Sit

Washburn

Map Lot 011-074A

Account 506

Location MAIN STREET

Card 1 Of 1 9/04/2024

Building Style 0	SF Bsmt Living 0	Layout 0
1.Conv. 5.Garrison 9.Gambrel	Fin Bsmt Grade 0 0	1.Typical 4. 7.
2.Ranch 6.Salt Box 10.Other	OPEN 5 OPTIONAL 0	2.Inadeq 5. 8.
3.R Ranch 7.Contemp 11.Split	Heat Type 100% 0	3.Poor 6. 9.
4.Cape 8.Log 12.	1.HWBB 5.FWA 9.No Heat	Attic 0
Dwelling Units 0	2.HWCI 6.GravWA 10.	1.1/4 Fin 4.Full Fin 7.
Other Units 0	3.H Pump 7.Electric 11.	2.1/2 Fin 5.FI/Stair 8.
Stories 0	4.Steam 8.FI/Wall 12.	3.3/4 Fin 6. 9.None
1.1 4.1.5 7.	Cool Type 0% 9 None	Insulation 0
2.2 5.1.75 8.	1.Refrig 4.W&C Air 7.	1.Full 4.Minimal 7.
3.3 6.2.5 9.	2.Evapor 5. 8.	2.Heavy 5.Partial 8.
Exterior Walls 0	3.H Pump 6. 9.None	3.Capped 6. 9.None
1.Wood 5.Stucco 9.T-111	Kitchen Style 0	Unfinished % 0%
2.Vin/Al 6.Brick 10.Other	1.Modern 4.Obsolete 7.	Grade & Factor 0 0%
3.Compos. 7.Stone 11.	2.Typical 5. 8.	1.E Grade 4.B Grade 7.
4.Asbestos 8.Concrete 12.	3.Old Type 6. 9.None	2.D Grade 5.A Grade 8.SC Grade
Roof Surface 0	Bath(s) Style 0	3.C Grade 6.AA Grade 9.Same
1.Asphalt 4.Composit 7.	1.Modern 4.Obsolete 7.	SQFT (Footprint) 0
2.Slate 5.Wood 8.	2.Typical 5. 8.	Condition 0
3.Metal 6.Other 9.	3.Old Type 6. 9.None	1.Poor 4.Avg 7.V G
SF Masonry Trim 0	# Rooms 0	2.Fair 5.Avg+ 8.Exc
OPEN-3-CUSTOM 0	# Bedrooms 0	3.Avg- 6.Good 9.Same
OPEN-4-CUSTOM 0	# Full Baths 0	Phys. % Good 0%
Year Built 0	# Half Baths 0	Funct. % Good 100%
Year Remodeled 0	# Addn Fixtures 0	Functional Code 9 None
Foundation 0	# Fireplaces 0	1.Incomp 4.Delap 7.No Power
1.Concrete 4.Wood 7.		2.O-Built 5.Bsmt 8.LongTerm
2.C Block 5.Slab 8.		3.Damage 6.Common 9.None
3.Br/Stone 6.Piers 9.		Econ. % Good 100%
Basement 0		Economic Code None
1.1/4 Bmt 4.Full Bmt 7.		0.None 3.No Power 7.
2.1/2 Bmt 5.None 8.		1.Location 4.Generate 8.
3.3/4 Bmt 6. 9.None		2.Encroach 9.None 9.
Bsmt Gar # Cars 0		Entrance Code 0
Wet Basement 0		1.Interior 4.Vacant 7.
1.Dry 4. 7.		2.Refusal 5.Estimate 8.
2.Damp 5. 8.	3.Informed 6.Reviewed 9.	
3.Wet 6. 9.	Information Code 0	
		1.Owner 4.Agent 7.
		2.Relative 5.Estimate 8.
		3.Tenant 6.Other 9.

Date Inspected

Additions, Outbuildings & Improvements								
Type	Year	Units	Grade	Cond	Phys.	Funct.	Sound Value	
					%	%		1.One Story Fram
					%	%		2.Two Story Fram
					%	%		3.Three Story Fr
					%	%		4.1 & 1/2 Story
					%	%		5.1 & 3/4 Story
					%	%		6.2 & 1/2 Story
					%	%		21.Open Frame Por
					%	%		22.Encl Frame Por
					%	%		23.Frame Garage
					%	%		24.Frame Shed
					%	%		25.Frame Bay Wind
					%	%		26.1SFr Overhang
					%	%		27.Unfin Basement
					%	%		28.Unfinished Att
					%	%		29.Finished Attic

Washburn

Map Lot 011-076

Account 2

Location 1356 MAIN STREET

Card 1

Of 1

9/04/2024

Building Style	4 Cape Cod		SF Bsmt Living	269		Layout	1 Typical							
1.Conv.	5.Garrison	9.Gambrel	Fin Bsmt Grade	3 100		1.Typical	4.	7.						
2.Ranch	6.Salt Box	10.Other	OPEN 5 OPTIONAL	0		2.Inadeq	5.	8.						
3.R Ranch	7.Contemp	11.Split	Heat Type	100% 5 Forced Warm Air		3.Pool	6.	9.						
4.Cape	8.Log	12.	1.HWBB	5.FWA	9.No Heat	Attic	9 None							
Dwelling Units	1		2.HWCI	6.GravWA	10.	1.1/4 Fin	4.Full Fin	7.						
Other Units	0		3.H Pump	7.Electric	11.	2.1/2 Fin	5.F/ Stair	8.						
Stories	4 One & 1/2 Story		4.Steam	8.F/Wall	12.	3.3/4 Fin	6.	9.None						
1.1	4.1.5	7.	Cool Type	0% 9 None		Insulation	1 Full							
2.2	5.1.75	8.	1.Refrig	4.W&C Air	7.	1.Full	4.Minimal	7.						
3.3	6.2.5	9.	2.Evapor	5.	8.	2.Heavy	5.Partial	8.						
Exterior Walls	1 Wood Siding		3.H Pump	6.	9.None	3.Capped	6.	9.None						
1.Wood	5.Stucco	9.T-111	Kitchen Style	2 Typical		Unfinished %	0%							
2.Vin/Al	6.Brick	10.Other	1.Modern	4.Obsolete	7.	Grade & Factor	3 Average 100%							
3.Compos.	7.Stone	11.	2.Typical	5.	8.	1.E Grade	4.B Grade	7.						
4.Asbestos	8.Concrete	12.	3.Old Type	6.	9.None	2.D Grade	5.A Grade	8.SC Grade						
Roof Surface	1 Asphalt Shingles		Bath(s) Style	2 Typical Bath(s)		3.C Grade	6.AA Grade	9.Same						
1.Asphalt	4.Composit	7.	1.Modern	4.Obsolete	7.	SQFT (Footprint)	1076							
2.Slate	5.Wood	8.	2.Typical	5.	8.	Condition	6 Good							
3.Metal	6.Other	9.	3.Old Type	6.	9.None	1.Poor	4.Avg	7.V G						
SF Masonry Trim	0		# Rooms	6		2.Fair	5.Avg+	8.Exc						
OPEN-3-CUSTOM	0		# Bedrooms	4		3.Avg-	6.Good	9.Same						
OPEN-4-CUSTOM	0		# Full Baths	1		Phys. % Good	0%							
Year Built	1951		# Half Baths	1		Funct. % Good	100%							
Year Remodeled	0		# Addn Fixtures	0		Functional Code	9 None							
Foundation	1 Concrete		# Fireplaces	1		1.Incomp	4.Delap	7.No Power						
1.Concrete	4.Wood	7.							2.O-Built	5.Bsmt	8.LongTerm			
2.C Block	5.Slab	8.							Econ. % Good	100%		3.Damage	6.Common	9.None
3.Br/Stone	6.Piers	9.							Economic Code	None		0.None	3.No Power	7.
Basement	4 Full Basement								Entrance Code	1 Interior Inspect		1.Location	4.Generate	8.
1.1/4 Bmt	4.Full Bmt	7.							1.Interior	4.Vacant	7.	2.Encroach	9.None	9.
2.1/2 Bmt	5.None	8.							2.Refusal	5.Estimate	8.	Information Code	1 Owner	
3.3/4 Bmt	6.	9.None							3.Informed	6.Reviewed	9.	1.Owner	4.Agent	7.
Bsmt Gar # Cars	0								2.Relative	5.Estimate	8.	2.Relative	5.Estimate	8.
Wet Basement	1 Dry Basement								3.Tenant	6.Other	9.	3.Tenant	6.Other	9.
1.Dry	4.	7.												
2.Damp	5.	8.												
3.Wet	6.	9.												

Date Inspected 10/15/2018

Additions, Outbuildings & Improvements

Type	Year	Units	Grade	Cond	Phys.	Funct.	Sound Value
68 Wood Deck	1990	55	3 100	4	0 %	100 %	
82 1.5 S-Gar	1960	624	3 95	5	0 %	100 %	
24 Frame Shed	0				%	%	600
24 Frame Shed	0				%	%	700
					%	%	
					%	%	
					%	%	
					%	%	
					%	%	
					%	%	
					%	%	

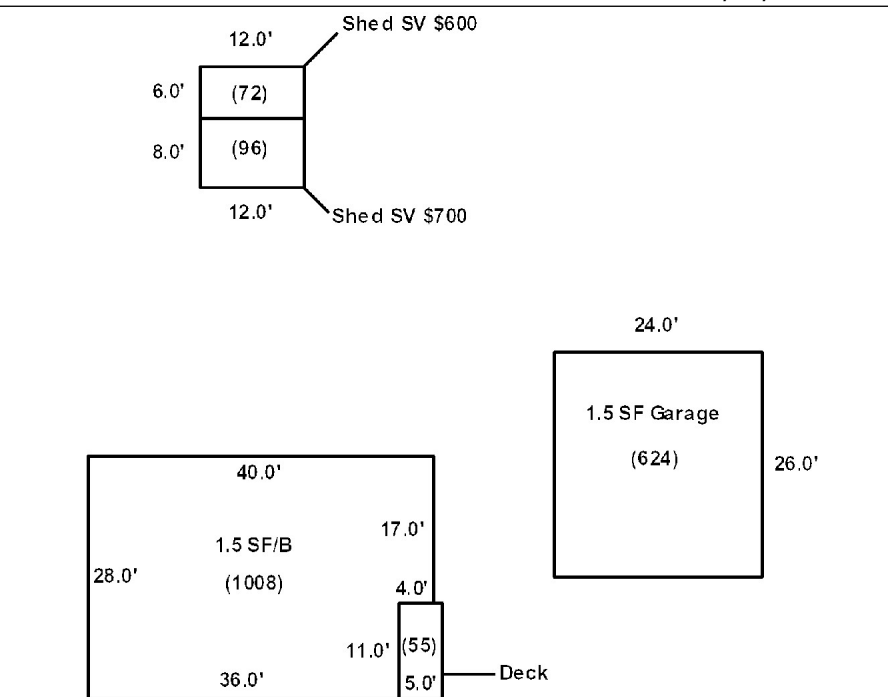

Guerrette, Roger U
Baird, Yolanda M
1360 Main Street
Washburn ME 04786

B6365P121

Previous Owner
Bragg, Sterling D
PO BOX 243

WASHBURN ME 04786
Sale Date: 8/29/2022

Previous Owner
Bragg, Sterling
P.O. Box 243

WASHBURN ME 04786
Sale Date: 12/10/2019

Previous Owner
WASHBURN, TOWN OF
787 WASHBURN ROAD

WASHBURN ME 04786
Sale Date: 6/10/2019

Inspection Witnessed By:

X	Date
No./Date	Description
	Date Insp.

Notes:

Needs pic for 2025-Complete Remodel use effective age of 1997 for 04/01/2024 GSR
* Dwelling assessed at 65 complete for 2022. 5-13-2022 - RD
* Dwelling assessed at 60% complete for 2021. 4-7-2021 ED
* Adjusted dwelling information per interior inspection with owner. Dwelling assessed at 50% functional due to being torn down to studs and doing major remodel.
*5-9-2019 Town owned property.

Washburn

Property Data			Assessment Record						
Neighborhood 1 Neighborhood One			Year	Land	Buildings	Exempt	Total		
Tree Growth Year 0			2012	5,900	49,200	0	55,100		
1ST MORTGAGE 0			2013	7,600	49,200	8,800	48,000		
2ND MORTGAGE 0			2015	7,600	49,200	9,000	47,800		
Zone/Land Use 1 Residential			2018	7,600	49,200	0	56,800		
Secondary Zone			2019	11,200	23,700	34,900	0		
Topography 1 Level			2020	11,200	7,800	0	19,000		
1.Level 4.Below St 7.LevelBog			2021	11,200	9,400	0	20,600		
2.Rolling 5.Low 8.			2022	11,200	10,700	0	21,900		
3.Above St 6.Swampy 9.			2023	14,900	12,700	0	27,600		
Utilities 2 Public Water 3 Public Sewer			2024	14,900	85,000	25,000	74,900		
1.Public 4.Dr Well 7.Cesspool									
2.Water 5.Dug Well 8.									
3.Sewer 6.Septic 9.None									
Street 1 Paved									
1.Paved 4.Proposed 7.									
2.Semi Imp 5.R/O/W 8.									
3.Gravel 6. 9.None									
TG PLAN YEAR 0									
Tif District # 0									
Sale Data			Land Data						
Sale Date 8/29/2022			Front Foot	Type	Effective		Influence		Influence Codes
Price 80,000					Frontage	Depth	Factor	Code	
Sale Type 2 Land & Buildings			11.Regular Lot					1.Unimproved	
1.Land 4.Mobile 7.C/I L&B			12.Delta Triangle			%		2.Excess Frtg	
2.L & B 5.Other 8.			13.Nabla Triangle			%		3.Topography	
3.Building 6.C/I Land 9.			14.Rear Land			%		4.Size/Shape	
Financing 9 Unknown			15.Class I Road			%		5.Access	
1.Convent 4.Seller 7.						%		6.Restriction	
2.FHA/VA 5.Private 8.						%		7.Open Space	
3.Assumed 6.Cash 9.Unknown						%		8.View/Environ	
Validity 1 Arms Length Sale						%		9.Fract Share	
1.Valid 4.Split 7.Renovate			Square Foot	Square Feet				Acres	
2.Related 5.Partial 8.Other			16.Class II Road			%		30.Utility R O W	
3.Distress 6.Exempt 9.			17.Municipal Rese			%		31.Tillable	
Verified 8 Other Source			18.Munic Sep Lago			%		32.Pasture	
1.Buyer 4.Agent 7.Family			19.Gravel Pit			%		33.Orchard	
2.Seller 5.Pub Rec 8.Other			20.Industrial Bas			%		34.Softwood F&O	
3.Lender 6.MLS 9.						%		35.Mixed Wood F&O	
			Fract. Acre	Acres/Sites				36.Hardwood F&O	
			21.Developed Pave	21	0.46	100	%	0	
			22.Undev Paved (F				%	37.Softwood TG	
			23.Developed Grav				%	38.Mixed Wood TG	
			Acres				%	39.Hardwood TG	
			24.Undev Gravel (%	40.Wasteland	
			25.Comm Base Pave				%	41.Open Space	
			26.Comm Base Grav				%	42.Mobile Home Si	
			27.Backlot				%	43.Condo Site	
			28.Rear Land				%	44.Lot Improvemen	
			29.Pavement				%	45.Subdivision Lo	
			Total Acreage		0.46				46.Heavy Ind Sit

Washburn

Map Lot 011-077

Account 241

Location 1360 MAIN STREET

Card 1

Of 1

9/04/2024

Building Style	2 Ranch		SF Bsmt Living	0		Layout	1 Typical	
1.Conv.	5.Garrison	9.Gambrel	Fin Bsmt Grade	0 0		1.Typical	4.	7.
2.Ranch	6.Salt Box	10.Other	OPEN 5 OPTIONAL	0		2.Inadeq	5.	8.
3.R Ranch	7.Contemp	11.Split	Heat Type	100% 1 Hot Water BB		3.Poor	6.	9.
4.Cape	8.Log	12.	1.HWBB	5.FWA	9.No Heat	Attic	9 None	
Dwelling Units	1		2.HWCI	6.GravWA	10.	1.1/4 Fin	4.Full Fin	7.
Other Units	0		3.H Pump	7.Electric	11.	2.1/2 Fin	5.FI/Stair	8.
Stories	1 One Story		4.Steam	8.FI/Wall	12.	3.3/4 Fin	6.	9.None
1.1	4.1.5	7.	Cool Type	0% 9 None		1.Full	4.Minimal	7.
2.2	5.1.75	8.	1.Refrig	4.W&C Air	7.	2.Heavy	5.Partial	8.
3.3	6.2.5	9.	2.Evapor	5.	8.	3.Capped	6.	9.None
Exterior Walls	2 Vinyl/Aluminum		3.H Pump	6.	9.None	Unfinished %	0%	
1.Wood	5.Stucco	9.T-111	Kitchen Style	2 Typical		Grade & Factor	3 Average 100%	
2.Vin/Al	6.Brick	10.Other	1.Modern	4.Obsolete	7.	1.E Grade	4.B Grade	7.
3.Compos.	7.Stone	11.	2.Typical	5.	8.	2.D Grade	5.A Grade	8.SC Grade
4.Asbestos	8.Concrete	12.	3.Old Type	6.	9.None	3.C Grade	6.AA Grade	9.Same
Roof Surface	3 Sheet Metal		Bath(s) Style	2 Typical Bath(s)		SQFT (Footprint)	1394	
1.Asphalt	4.Composit	7.	1.Modern	4.Obsolete	7.	Condition	4 Average	
2.Slate	5.Wood	8.	2.Typical	5.	8.	1.Poor	4.Avg	7.V G
3.Metal	6.Other	9.	3.Old Type	6.	9.None	2.Fair	5.Avg+	8.Exc
SF Masonry Trim	0		# Rooms	5		3.Avg-	6.Good	9.Same
OPEN-3-CUSTOM	0		# Bedrooms	3		Phys. % Good	0%	
OPEN-4-CUSTOM	0		# Full Baths	1		Funct. % Good	100%	
Year Built	1997		# Addn Fixtures	0		Functional Code	9 None	
Year Remodeled	1957		# Fireplaces	0		1.Incomp	4.Delap	7.No Power
Foundation	1 Concrete							
1.Concrete	4.Wood	7.						
2.C Block	5.Slab	8.						
3.Br/Stone	6.Piers	9.						
Basement	4 Full Basement							
1.1/4 Bmt	4.Full Bmt	7.						
2.1/2 Bmt	5.None	8.						
3.3/4 Bmt	6.	9.None						
Bsmt Gar # Cars	0							
Wet Basement	1 Dry Basement							
1.Dry	4.	7.						
2.Damp	5.	8.						
3.Wet	6.	9.						

Date Inspected 7/01/2020

Additions, Outbuildings & Improvements

Type	Year	Units	Grade	Cond	Phys.	Funct.	Sound Value
40 Basement Entry	1957	30	9 100	9	0 %	60 %	
24 Frame Shed	0				%	%	1,500
68 Wood Deck	2023	224	3 100	4	0 %	100 %	
					%	%	
					%	%	
					%	%	
					%	%	
					%	%	
					%	%	
					%	%	
					%	%	

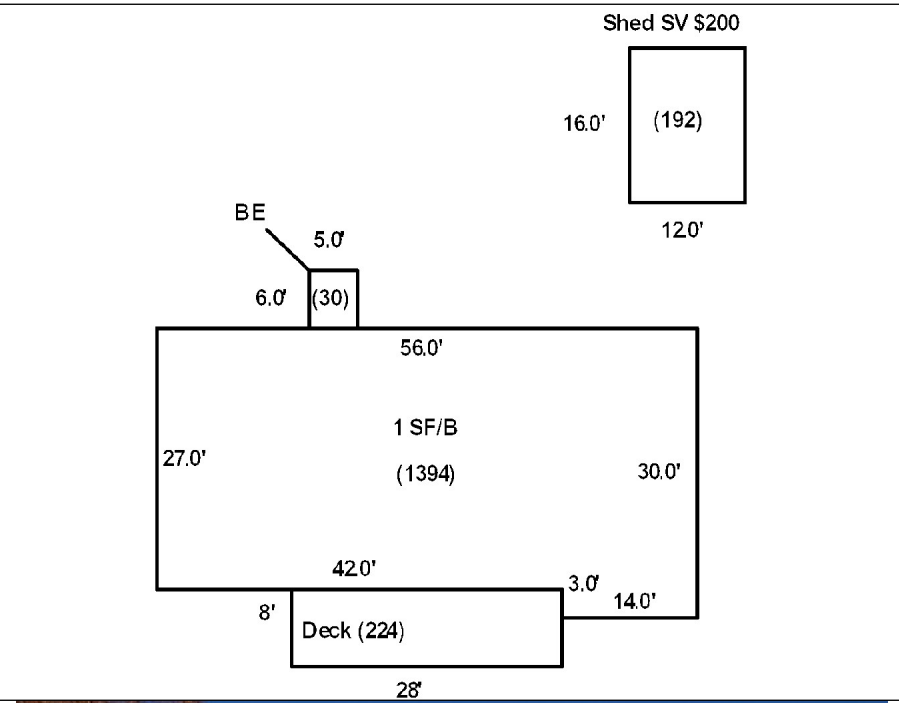

Washburn

Map Lot 011-078

Account 666

Location 1355 Main Street

Card 1

Of 1

9/04/2024

Building Style 2 Ranch	SF Bsmt Living 0	Layout 1 Typical
1.Conv. 5.Garrison 9.Gambrel	Fin Bsmt Grade 0 0	1.Typical 4. 7.
2.Ranch 6.Salt Box 10.Other	OPEN 5 OPTIONAL 0	2.Inadeq 5. 8.
3.R Ranch 7.Contemp 11.Split	Heat Type 100% 5 Forced Warm Air	3.Poor 6. 9.
4.Cape 8.Log 12.	1.HWBB 5.FWA 9.No Heat	Attic 9 None
Dwelling Units 1	2.HWCI 6.GravWA 10.	1.1/4 Fin 4.Full Fin 7.
Other Units 0	3.H Pump 7.Electric 11.	2.1/2 Fin 5.F/ Stair 8.
Stories 1 One Story	4.Steam 8.F/ Wall 12.	3.3/4 Fin 6. 9.None
1.1 4.1.5 7.	Cool Type 0% 9 None	Insulation 1 Full
2.2 5.1.75 8.	1.Refrig 4.W&C Air 7.	1.Full 4.Minimal 7.
3.3 6.2.5 9.	2.Evapor 5. 8.	2.Heavy 5.Partial 8.
Exterior Walls 4 Asbestos Siding	3.H Pump 6. 9.None	3.Capped 6. 9.None
1.Wood 5.Stucco 9.T-111	Kitchen Style 2 Typical	Unfinished % 0%
2.Vin/Al 6.Brick 10.Other	1.Modern 4.Obsolete 7.	Grade & Factor 3 Average 100%
3.Compos. 7.Stone 11.	2.Typical 5. 8.	1.E Grade 4.B Grade 7.
4.Asbestos 8.Concrete 12.	3.Old Type 6. 9.None	2.D Grade 5.A Grade 8.SC Grade
Roof Surface 1 Asphalt Shingles	Bath(s) Style 2 Typical Bath(s)	3.C Grade 6.AA Grade 9.Same
1.Asphalt 4.Composit 7.	1.Modern 4.Obsolete 7.	SQFT (Footprint) 840
2.Slate 5.Wood 8.	2.Typical 5. 8.	Condition 6 Good
3.Metal 6.Other 9.	3.Old Type 6. 9.None	1.Poor 4.Avg 7.V G
SF Masonry Trim 0	# Rooms 5	2.Fair 5.Avg+ 8.Exc
OPEN-3-CUSTOM 0	# Bedrooms 3	3.Avg- 6.Good 9.Same
OPEN-4-CUSTOM 0	# Full Baths 1	Phys. % Good 0%
Year Built 1950	# Half Baths 0	Funct. % Good 100%
Year Remodeled 0	# Addn Fixtures 0	Functional Code 9 None
Foundation 1 Concrete	# Fireplaces 0	1.Incomp 4.Delap 7.No Power
1.Concrete 4.Wood 7.		2.O-Built 5.Bsmt 8.LongTerm
2.C Block 5.Slab 8.		3.Damage 6.Common 9.None
3.Br/Stone 6.Piers 9.		Econ. % Good 100%
Basement 4 Full Basement		Economic Code None
1.1/4 Bmt 4.Full Bmt 7.		0.None 3.No Power 7.
2.1/2 Bmt 5.None 8.		1.Location 4.Generate 8.
3.3/4 Bmt 6. 9.None		2.Encroach 9.None 9.
Bsmt Gar # Cars 0		Entrance Code 1 Interior Inspect
Wet Basement 2 Damp Basement		1.Interior 4.Vacant 7.
1.Dry 4. 7.		2.Refusal 5.Estimate 8.
2.Damp 5. 8.	3.Informed 6.Reviewed 9.	
3.Wet 6. 9.	Information Code 1 Owner	
	1.Owner 4.Agent 7.	
	2.Relative 5.Estimate 8.	
	3.Tenant 6.Other 9.	

Date Inspected 5/01/2019

Additions, Outbuildings & Improvements

Type	Year	Units	Grade	Cond	Phys.	Funct.	Sound Value
22 Encl Frame Porch	1950	200	2 115	4	0 %	100 %	
22 Encl Frame Porch	1970	16	3 90	5	0 %	100 %	
68 Wood Deck	2000	104	3 100	4	0 %	100 %	
23 Frame Garage	1950	792	3 95	5	0 %	80 %	
24 Frame Shed	0				%	%	600
					%	%	
					%	%	
					%	%	
					%	%	
					%	%	
					%	%	

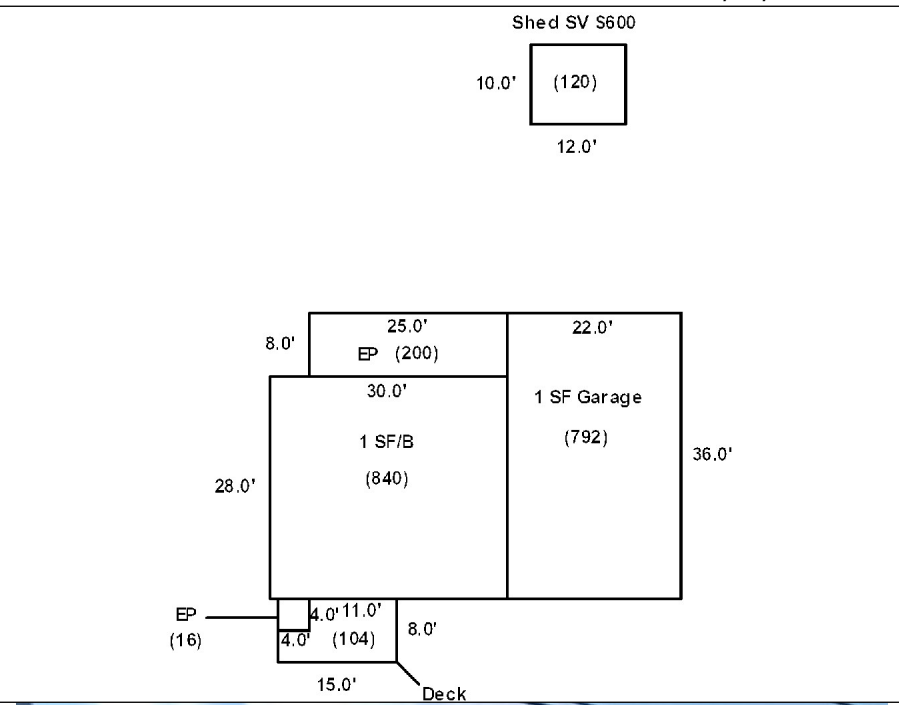

Washburn

Map Lot 011-079

Account 344

Location 1353 Main Street

Card 1 Of 1 9/04/2024

Building Style	4 Cape Cod	SF Bsmt Living	0	Layout	1 Typical	
1.Conv.	5.Garrison	9.Gambrel	Fin Bsmt Grade	0 0	1.Typical	
2.Ranch	6.Salt Box	10.Other	OPEN 5 OPTIONAL	0	2.Inadeq	
3.R Ranch	7.Contemp	11.Split	Heat Type	100% 5 Forced Warm Air	3.Poor	
4.Cape	8.Log	12.	1.HWBB	5.FWA	9.No Heat	
Dwelling Units	1	2.HWCI	6.GravWA	10.	Attic	
Other Units	0	3.H Pump	7.Electric	11.	1.1/4 Fin	
Stories	4 One & 1/2 Story	4.Steam	8.Fi/Wall	12.	4.Full Fin	
1.1	4.1.5	7.	Cool Type	50% 3 Heat Pump	7.	
2.2	5.1.75	8.	1.Refrig	4.W&C Air	7.	
3.3	6.2.5	9.	2.Evapor	5.	8.	
Exterior Walls	1 Wood Siding	3.H Pump	6.	9.None	Insulation	
1.Wood	5.Stucco	9.T-111	Kitchen Style	2 Typical	1 Full	
2.Vin/Al	6.Brick	10.Other	1.Modern	4.Obsolete	7.	
3.Compos.	7.Stone	11.	2.Typical	5.	8.	
4.Asbestos	8.Concrete	12.	3.Old Type	6.	9.None	
Roof Surface	3 Sheet Metal	Bath(s) Style	2 Typical Bath(s)	1.Modern	4.Obsolete	
1.Asphalt	4.Composit	7.	1.Modern	4.Obsolete	7.	
2.Slate	5.Wood	8.	2.Typical	5.	8.	
3.Metal	6.Other	9.	3.Old Type	6.	9.None	
SF Masonry Trim	0	# Rooms	6	Unfinished %	0%	
OPEN-3-CUSTOM	0	# Bedrooms	3	Grade & Factor	2 Fair 105%	
OPEN-4-CUSTOM	0	# Full Baths	2	1.E Grade	4.B Grade	
Year Built	1950	# Half Baths	0	7.	8.	
Year Remodeled	0	# Addn Fixtures	0	2.D Grade	5.A Grade	
Foundation	1 Concrete	# Fireplaces	0	8.	8.SC Grade	
1.Concrete	4.Wood	7.		3.C Grade	6.AA Grade	
2.C Block	5.Slab	8.		SQFT (Footprint)	891	
3.Br/Stone	6.Piers	9.		Condition	4 Average	
Basement	4 Full Basement	1.Poor		4.Avg	7.V G	
1.1/4 Bmt	4.Full Bmt	7.		2.Fair	5.Avg+	
2.1/2 Bmt	5.None	8.		3.Avg-	6.Good	
3.3/4 Bmt	6.	9.None		Phys. % Good	0%	
Bsmt Gar # Cars	0	Funct. % Good		100%	Functional Code	9 None
Wet Basement	1 Dry Basement	1.Incomp		4.Delap	7.No Power	
1.Dry	4.	7.		2.O-Built	5.Bsmt	
2.Damp	5.	8.	3.Damage	6.Common		
3.Wet	6.	9.	Econ. % Good	100%		
			Economic Code	None		
			0.None	3.No Power		
			1.Location	4.Generate		
			2.Encroach	9.None		
			Entrance Code	5 Estimated		
			1.Interior	4.Vacant		
			2.Refusal	5.Estimate		
			3.Informed	6.Reviewed		
			Information Code	5 Estimate		
			1.Owner	4.Agent		
			2.Relative	5.Estimate		
			3.Tenant	6.Other		

Date Inspected 10/15/2018

Additions, Outbuildings & Improvements

Type	Year	Units	Grade	Cond	Phys.	Funct.	Sound Value
1 One Story Frame	1960	105	3 95	4	0 %	100 %	
1 One Story Frame	1950	168	9 100	9	0 %	100 %	
23 Frame Garage	1965	864	3 95	5	0 %	100 %	
29 Finished Attic	1965	864	3 90	4	0 %	100 %	
					%	%	
					%	%	
					%	%	
					%	%	
					%	%	
					%	%	
					%	%	
					%	%	

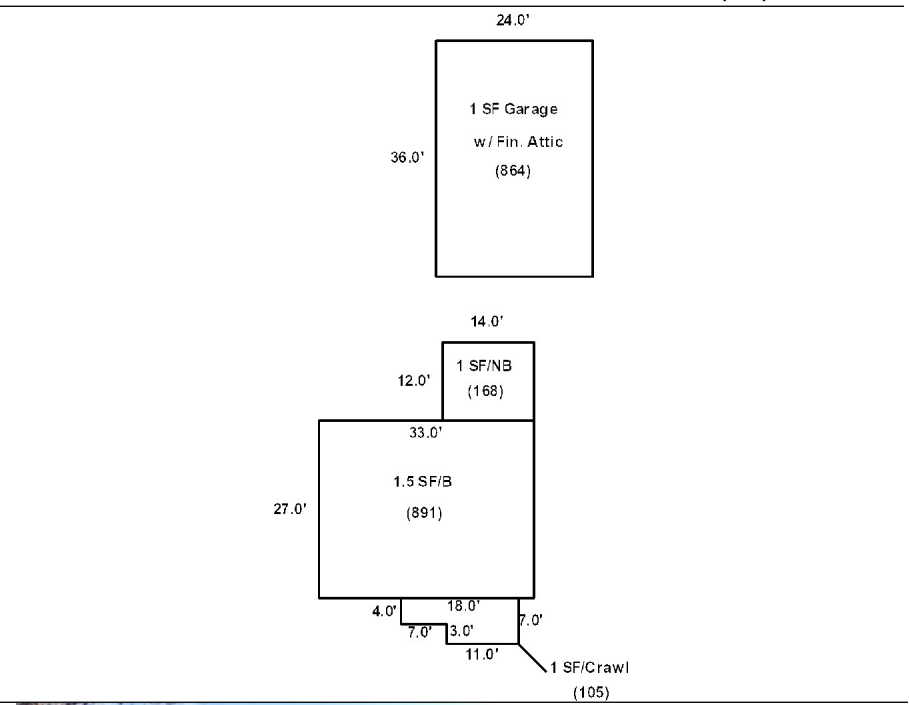

Washburn

Map Lot 011-080

Account 842

Location 1349 MAIN STREET

Card 1 Of 1 9/04/2024

Building Style	4 Cape Cod	SF Bsmt Living	0	Layout	1 Typical	
1.Conv.	5.Garrison	9.Gambrel	Fin Bsmt Grade	0 0	1.Typical	
2.Ranch	6.Salt Box	10.Other	OPEN 5 OPTIONAL	0	2.Inadeq	
3.R Ranch	7.Contemp	11.Split	Heat Type	100% 5 Forced Warm Air	3.Poor	
4.Cape	8.Log	12.	1.HWBB	5.FWA	9.No Heat	
Dwelling Units	1	2.HWCI	6.GravWA	10.	Attic	
Other Units	0	3.H Pump	7.Electric	11.	1.1/4 Fin	
Stories	4 One & 1/2 Story	4.Steam	8.Fi/Wall	12.	4.Full Fin	
1.1	4.1.5	7.	Cool Type	0% 9 None	7.	
2.2	5.1.75	8.	1.Refrig	4.W&C Air	7.	
3.3	6.2.5	9.	2.Evapor	5.	8.	
Exterior Walls	2 Vinyl/Aluminum	3.H Pump	6.	9.None	Insulation	
1.Wood	5.Stucco	9.T-111	Kitchen Style	2 Typical	1 Full	
2.Vin/Al	6.Brick	10.Other	1.Modern	4.Obsolete	7.	
3.Compos.	7.Stone	11.	2.Typical	5.	8.	
4.Asbestos	8.Concrete	12.	3.Old Type	6.	9.None	
Roof Surface	1 Asphalt Shingles	Bath(s) Style	2 Typical Bath(s)	1.Modern	4.Obsolete	
1.Asphalt	4.Composit	7.	1.Modern	4.Obsolete	7.	
2.Slate	5.Wood	8.	2.Typical	5.	8.	
3.Metal	6.Other	9.	3.Old Type	6.	9.None	
SF Masonry Trim	0	# Rooms	5	Unfinished %	0%	
OPEN-3-CUSTOM	0	# Bedrooms	3	Grade & Factor	3 Average 100%	
OPEN-4-CUSTOM	0	# Full Baths	1	1.E Grade	4.B Grade	
Year Built	1960	# Half Baths	0	2.D Grade	5.A Grade	
Year Remodeled	0	# Addn Fixtures	0	3.C Grade	6.AA Grade	
Foundation	1 Concrete	# Fireplaces	0	SQFT (Footprint) 988		
1.Concrete	4.Wood	7.	Condition 5 Above Average			
2.C Block	5.Slab	8.	1.Poor	4.Avg	7.V G	
3.Br/Stone	6.Piers	9.	2.Fair	5.Avg+	8.Exc	
Basement	4 Full Basement	Phys. % Good 0%			3.Avg-	6.Good
1.1/4 Bmt	4.Full Bmt	7.	Funct. % Good 100%			
2.1/2 Bmt	5.None	8.	Functional Code 9 None			
3.3/4 Bmt	6.	9.None	1.Incomp	4.Delap	7.No Power	
Bsmt Gar # Cars	0	Economic Code None			2.O-Built	5.Bsmt
Wet Basement	1 Dry Basement	0.None			3.No Power	7.
1.Dry	4.	7.	1.Location			4.Generate
2.Damp	5.	8.	2.Encroach			9.None
3.Wet	6.	9.	Entrance Code 5 Estimated			
			1.Interior			4.Vacant
			2.Refusal			5.Estimate
			3.Informed			6.Reviewed
			Information Code 5 Estimate			
			1.Owner			4.Agent
			2.Relative			5.Estimate
			3.Tenant			6.Other

Date Inspected 10/15/2018

Additions, Outbuildings & Improvements

Type	Year	Units	Grade	Cond	Phys.	Funct.	Sound Value
21 Open Frame	1965	98	3 95	5	0 %	100 %	
68 Wood Deck	1990	36	3 90	4	0 %	100 %	
22 Encl Frame Porch	1960	78	2 115	5	0 %	100 %	
68 Wood Deck	1990	253	3 100	4	0 %	100 %	
40 Basement Entry	1960	48	3 90	5	0 %	100 %	
23 Frame Garage	1960	720	3 90	5	0 %	100 %	
					%	%	
					%	%	
					%	%	
					%	%	

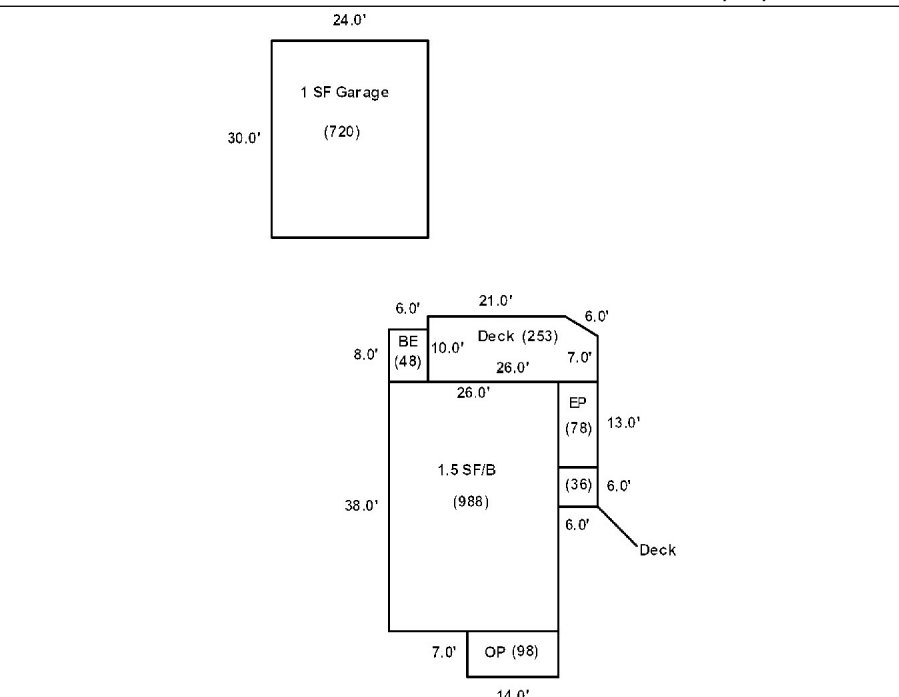

BISSON, ASHLI BROOK
PO BOX 56
WASHBURN ME 04786

B6224P256 B6422P253

Previous Owner
MCINTOSH, JEREMIAH
PO BOX 472

WASHBURN ME 04786
Sale Date: 3/02/2023

Previous Owner
BULL, LARRY
BULL, PERLIN
16 STORY STREET
WASHBURN ME 04786
Sale Date: 9/20/2021

Previous Owner
KATAHDIN TRUST COMPANY
6 NORTH STREET

PRESQUE ISLE ME 04769
Sale Date: 12/22/2016

Inspection Witnessed By:

X	Date
No./Date	Description
	Date Insp.

Notes:
*5-9-2019 -20% for attached shed.

Washburn

Property Data			Assessment Record						
Neighborhood 1 Neighborhood One			Year	Land	Buildings	Exempt	Total		
Tree Growth Year 0			2012	5,500	39,100	14,080	30,520		
1ST MORTGAGE 0			2013	7,100	44,900	0	52,000		
2ND MORTGAGE 0			2015	7,100	44,900	0	52,000		
Zone/Land Use 1 Residential			2018	7,100	44,900	0	52,000		
Secondary Zone			2019	10,400	59,100	0	69,500		
Topography 1 Level			2020	10,400	59,000	0	69,400		
1.Level 4.Below St 7.LevelBog			2021	10,400	59,100	0	69,500		
2.Rolling 5.Low 8.			2022	10,400	62,000	0	72,400		
3.Above St 6.Swampy 9.			2023	13,900	73,700	0	87,600		
Utilities 2 Public Water 3 Public Sewer			2024	13,900	73,700	25,000	62,600		
1.Public 4.Dr Well 7.Cesspool									
2.Water 5.Dug Well 8.									
3.Sewer 6.Septic 9.None									
Street 1 Paved									
1.Paved 4.Proposed 7.									
2.Semi Imp 5.R/O/W 8.									
3.Gravel 6. 9.None									
TG PLAN YEAR 0									
Tif District # 0									
Sale Data			Land Data						
Sale Date 3/02/2023			Front Foot	Type	Effective		Influence		Influence Codes
Price 83,000					Frontage	Depth	Factor	Code	
Sale Type 2 Land & Buildings			11.Regular Lot					1.Unimproved	
1.Land 4.Mobile 7.C/I L&B			12.Delta Triangle			%		2.Excess Frtg	
2.L & B 5.Other 8.			13.Nabla Triangle			%		3.Topography	
3.Building 6.C/I Land 9.			14.Rear Land			%		4.Size/Shape	
Financing 1 Conventional			15.Class I Road			%		5.Access	
1.Convent 4.Seller 7.						%		6.Restriction	
2.FHA/VA 5.Private 8.						%		7.Open Space	
3.Assumed 6.Cash 9.Unknown						%		8.View/Environ	
Validity 1 Arms Length Sale						%		9.Fract Share	
1.Valid 4.Split 7.Renovate			Square Foot	Square Feet				Acres	
2.Related 5.Partial 8.Other			16.Class II Road			%		30.Utility R O W	
3.Distress 6.Exempt 9.			17.Municipal Rese			%		31.Tillable	
Verified 5 Public Record			18.Munic Sep Lago			%		32.Pasture	
1.Buyer 4.Agent 7.Family			19.Gravel Pit			%		33.Orchard	
2.Seller 5.Pub Rec 8.Other			20.Industrial Bas			%		34.Softwood F&O	
3.Lender 6.MLS 9.						%		35.Mixed Wood F&O	
			Fract. Acre	Acreege/Sites				36.Hardwood F&O	
			21.Developed Pave	21	0.40	100	%	0	37.Softwood TG
			22.Undev Paved (F				%		38.Mixed Wood TG
			23.Developed Grav				%		39.Hardwood TG
			Acres				%		40.Wasteland
			24.Undev Gravel (%		41.Open Space
			25.Comm Base Pave				%		42.Mobile Home Si
			26.Comm Base Grav				%		43.Condo Site
			27.Backlot				%		44.Lot Improvemen
			28.Rear Land				%		45.Subdivision Lo
			29.Pavement				%		46.Heavy Ind Sit
			Total Acreage		0.40				

Washburn

Map Lot 011-081

Account 322

Location 1345 MAIN STREET

Card 1

Of 1

9/04/2024

Building Style	4 Cape Cod	SF Bsmt Living	0	Layout	1 Typical
1.Conv.	5.Garrison	9.Gambrel	Fin Bsmt Grade	0 0	1.Typical
2.Ranch	6.Salt Box	10.Other	OPEN 5 OPTIONAL	0	2.Inadeq
3.R Ranch	7.Contemp	11.Split	Heat Type	100% 1 Hot Water BB	3.Poor
4.Cape	8.Log	12.	1.HWBB	5.FWA	9.No Heat
Dwelling Units	1	2.HWCI	6.GravWA	10.	Attic
Other Units	0	3.H Pump	7.Electric	11.	1.1/4 Fin
Stories	4 One & 1/2 Story	4.Steam	8.Fi/Wall	12.	4.Full Fin
1.1	4.1.5	7.	Cool Type	0% 9 None	7.
2.2	5.1.75	8.	1.Refrig	4.W&C Air	7.
3.3	6.2.5	9.	2.Evapor	5.	8.
Exterior Walls	2 Vinyl/Aluminum	3.H Pump	6.	9.None	3.Capped
1.Wood	5.Stucco	9.T-111	Kitchen Style	2 Typical	9.None
2.Vin/Al	6.Brick	10.Other	1.Modern	4.Obsolete	7.
3.Compos.	7.Stone	11.	2.Typical	5.	8.
4.Asbestos	8.Concrete	12.	3.Old Type	6.	9.None
Roof Surface	3 Sheet Metal	Bath(s) Style	2 Typical Bath(s)		Unfinished %
1.Asphalt	4.Composit	7.	1.Modern	4.Obsolete	7.
2.Slate	5.Wood	8.	2.Typical	5.	8.
3.Metal	6.Other	9.	3.Old Type	6.	9.None
SF Masonry Trim	0	# Rooms	6		Grade & Factor
OPEN-3-CUSTOM	0	# Bedrooms	3		2 Fair 110%
OPEN-4-CUSTOM	0	# Full Baths	1		1.E Grade
Year Built	1950	# Half Baths	0		4.B Grade
Year Remodeled	0	# Addn Fixtures	0		7.
Foundation	2 Concrete Block	# Fireplaces	1		2.D Grade
1.Concrete	4.Wood	7.			5.A Grade
2.C Block	5.Slab	8.			8.SC Grade
3.Br/Stone	6.Piers	9.			3.C Grade
Basement	4 Full Basement				6.AA Grade
1.1/4 Bmt	4.Full Bmt	7.			9.Same
2.1/2 Bmt	5.None	8.			
3.3/4 Bmt	6.	9.None			
Bsmt Gar # Cars	0				SQFT (Footprint)
Wet Basement	1 Dry Basement				480
1.Dry	4.	7.			Condition
2.Damp	5.	8.			5 Above Average
3.Wet	6.	9.			1.Poor
					4.Avg
					7.V G
					2.Fair
					5.Avg+
					8.Exc
					3.Avg-
					6.Good
					9.Same
					Phys. % Good
					0%
					Funct. % Good
					100%
					Functional Code
					9 None
					1.Incomp
					4.Delap
					7.No Power
					2.O-Built
					5.Bsmt
					8.LongTerm
					3.Damage
					6.Common
					9.None
					Econ. % Good
					100%
					Economic Code
					None
					0.None
					3.No Power
					7.
					1.Location
					4.Generate
					8.
					2.Encroach
					9.None
					Entrance Code
					5 Estimated
					1.Interior
					4.Vacant
					7.
					2.Refusal
					5.Estimate
					8.
					3.Informed
					6.Reviewed
					9.
					Information Code
					5 Estimate
					1.Owner
					4.Agent
					7.
					2.Relative
					5.Estimate
					8.
					3.Tenant
					6.Other
					9.

Date Inspected 10/15/2018

Additions, Outbuildings & Improvements

Type	Year	Units	Grade	Cond	Phys.	Funct.	Sound Value
1 One Story Frame	1960	140	2 110	4	0 %	100 %	
40 Basement Entry	1950	20	2 110	4	0 %	100 %	
20 1 Story/Bsmt	1950	260	9 100	9	0 %	100 %	
68 Wood Deck	1990	65	3 95	3	0 %	100 %	
24 Frame Shed	1980	160	2 100	2	0 %	80 %	
23 Frame Garage	1965	336	3 95	3	0 %	100 %	
24 Frame Shed	0				%	%	400
24 Frame Shed	0				%	%	400
					%	%	
					%	%	

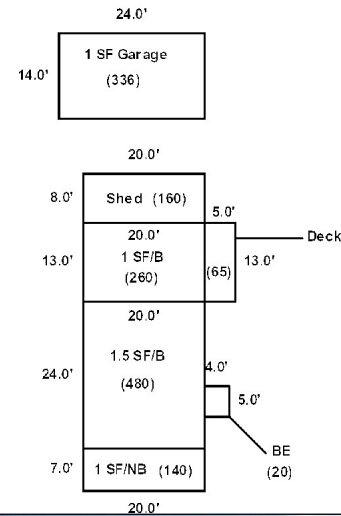

Washburn

Map Lot 011-083

Account 936

Location 1 Garage Drive

Card 1 Of 1 9/04/2024

Building Style 0	SF Bsmt Living 0	Layout 0
1.Conv. 5.Garrison 9.Gambrel	Fin Bsmt Grade 0 0	1.Typical 4. 7.
2.Ranch 6.Salt Box 10.Other	OPEN 5 OPTIONAL 0	2.Inadeq 5. 8.
3.R Ranch 7.Contemp 11.Split	Heat Type 100% 0	3.Pool 6. 9.
4.Cape 8.Log 12.	1.HWBB 5.FWA 9.No Heat	Attic 0
Dwelling Units 0	2.HWCI 6.GravWA 10.	1.1/4 Fin 4.Full Fin 7.
Other Units 0	3.H Pump 7.Electric 11.	2.1/2 Fin 5.FI/Stair 8.
Stories 0	4.Steam 8.FI/Wall 12.	3.3/4 Fin 6. 9.None
1.1 4.1.5 7.	Cool Type 0% 9 None	Insulation 0
2.2 5.1.75 8.	1.Refrig 4.W&C Air 7.	1.Full 4.Minimal 7.
3.3 6.2.5 9.	2.Evapor 5. 8.	2.Heavy 5.Partial 8.
Exterior Walls 0	3.H Pump 6. 9.None	3.Capped 6. 9.None
1.Wood 5.Stucco 9.T-111	Kitchen Style 0	Unfinished % 0%
2.Vin/Al 6.Brick 10.Other	1.Modern 4.Obsolete 7.	Grade & Factor 0 0%
3.Compos. 7.Stone 11.	2.Typical 5. 8.	1.E Grade 4.B Grade 7.
4.Asbestos 8.Concrete 12.	3.Old Type 6. 9.None	2.D Grade 5.A Grade 8.SC Grade
Roof Surface 0	Bath(s) Style 0	3.C Grade 6.AA Grade 9.Same
1.Asphalt 4.Composit 7.	1.Modern 4.Obsolete 7.	SQFT (Footprint) 0
2.Slate 5.Wood 8.	2.Typical 5. 8.	Condition 0
3.Metal 6.Other 9.	3.Old Type 6. 9.None	1.Poor 4.Avg 7.V G
SF Masonry Trim 0	# Rooms 0	2.Fair 5.Avg+ 8.Exc
OPEN-3-CUSTOM 0	# Bedrooms 0	3.Avg- 6.Good 9.Same
OPEN-4-CUSTOM 0	# Full Baths 0	Phys. % Good 0%
Year Built 0	# Half Baths 0	Funct. % Good 100%
Year Remodeled 0	# Addn Fixtures 0	Functional Code 9 None
Foundation 0	# Fireplaces 0	1.Incomp 4.Delap 7.No Power
1.Concrete 4.Wood 7.		2.O-Built 5.Bsmt 8.LongTerm
2.C Block 5.Slab 8.		3.Damage 6.Common 9.None
3.Br/Stone 6.Piers 9.		Econ. % Good 100%
Basement 0		Economic Code None
1.1/4 Bmt 4.Full Bmt 7.		0.None 3.No Power 7.
2.1/2 Bmt 5.None 8.		1.Location 4.Generate 8.
3.3/4 Bmt 6. 9.None		2.Encroach 9.None 9.
Bsmt Gar # Cars 0		Entrance Code 1 Interior Inspect
Wet Basement 0		1.Interior 4.Vacant 7.
1.Dry 4. 7.		2.Refusal 5.Estimate 8.
2.Damp 5. 8.		3.Informed 6.Reviewed 9.
3.Wet 6. 9.		Information Code 1 Owner
		1.Owner 4.Agent 7.
		2.Relative 5.Estimate 8.
		3.Tenant 6.Other 9.

Date Inspected 10/15/2018

Additions, Outbuildings & Improvements

Type	Year	Units	Grade	Cond	Phys.	Funct.	Sound Value
247 Municipal	1965	2448	3 100	4	0 %	85 %	
247 Municipal	1965	1872	3 100	4	0 %	85 %	
247 Municipal	1965	1680	3 100	4	0 %	85 %	
24 Frame Shed	0				%	%	600
					%	%	
					%	%	
					%	%	
					%	%	
					%	%	
					%	%	
					%	%	

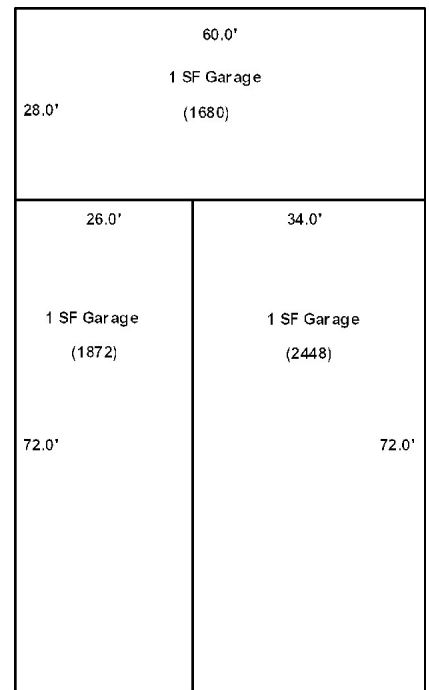

Washburn

Map Lot 011-085

Account 1029

Location 17 CLARK STREET

Card 1 Of 1 9/04/2024

Building Style 2 Ranch 1.Conv. 5.Garrison 9.Gambrel 2.Ranch 6.Salt Box 10.Other 3.R Ranch 7.Contemp 11.Split 4.Cape 8.Log 12.	SF Bsmt Living 0 Fin Bsmt Grade 0 0 OPEN 5 OPTIONAL 0 Heat Type 100% 1 Hot Water BB 1.HWBB 5.FWA 9.No Heat 2.HWCI 6.GravWA 10. 3.H Pump 7.Electric 11. 4.Steam 8.Fi/Wall 12.	Layout 1 Typical 1.Typical 4. 7. 2.Inadeq 5. 8. 3.Poor 6. 9. Attic 9 None 1.1/4 Fin 4.Full Fin 7. 2.1/2 Fin 5.Fi/Stair 8. 3.3/4 Fin 6. 9.None	
Dwelling Units 1 Other Units 0 Stories 1 One Story 1.1 4.1.5 7. 2.2 5.1.75 8. 3.3 6.2.5 9.	Cool Type 0% 9 None 1.Refrig 4.W&C Air 7. 2.Evapor 5. 8. 3.H Pump 6. 9.None	Insulation 1 Full 1.Full 4.Minimal 7. 2.Heavy 5.Partial 8. 3.Capped 6. 9.None	
Exterior Walls 4 Asbestos Siding 1.Wood 5.Stucco 9.T-111 2.Vin/Al 6.Brick 10.Other 3.Compos. 7.Stone 11. 4.Asbestos 8.Concrete 12.	Kitchen Style 2 Typical 1.Modern 4.Obsolete 7. 2.Typical 5. 8. 3.Old Type 6. 9.None	Unfinished % 0% Grade & Factor 2 Fair 115% 1.E Grade 4.B Grade 7. 2.D Grade 5.A Grade 8.SC Grade 3.C Grade 6.AA Grade 9.Same	
Roof Surface 3 Sheet Metal 1.Asphalt 4.Composit 7. 2.Slate 5.Wood 8. 3.Metal 6.Other 9.	Bath(s) Style 2 Typical Bath(s) 1.Modern 4.Obsolete 7. 2.Typical 5. 8. 3.Old Type 6. 9.None	SQFT (Footprint) 1080 Condition 5 Above Average 1.Poor 4.Avg 7.V G 2.Fair 5.Avg+ 8.Exc 3.Avg- 6.Good 9.Same	
SF Masonry Trim 0 OPEN-3-CUSTOM 0 OPEN-4-CUSTOM 0 Year Built 1950 Year Remodeled 0	# Rooms 5 # Bedrooms 3 # Full Baths 1 # Half Baths 0 # Addn Fixtures 0 # Fireplaces 0	Phys. % Good 0% Funct. % Good 100% Functional Code 9 None 1.Incomp 4.Delap 7.No Power 2.O-Built 5.Bsmt 8.LongTerm 3.Damage 6.Common 9.None	
Foundation 1 Concrete 1.Concrete 4.Wood 7. 2.C Block 5.Slab 8. 3.Br/Stone 6.Piers 9.			Econ. % Good 100% Economic Code None 0.None 3.No Power 7. 1.Location 4.Generate 8. 2.Encroach 9.None 9.
Basement 4 Full Basement 1.1/4 Bmt 4.Full Bmt 7. 2.1/2 Bmt 5.None 8. 3.3/4 Bmt 6. 9.None			Entrance Code 1 Interior Inspect 1.Interior 4.Vacant 7. 2.Refusal 5.Estimate 8. 3.Informed 6.Reviewed 9.
Bsmt Gar # Cars 0 Wet Basement 1 Dry Basement 1.Dry 4. 7. 2.Damp 5. 8. 3.Wet 6. 9.			Information Code 2 Relative 1.Owner 4.Agent 7. 2.Relative 5.Estimate 8. 3.Tenant 6.Other 9.

Date Inspected 10/15/2018

Additions, Outbuildings & Improvements

Type	Year	Units	Grade	Cond	Phys.	Funct.	Sound Value
21 Open Frame	1970	48	2 110	3	0 %	100 %	
22 Encl Frame Porch	1960	132	2 110	5	0 %	100 %	
23 Frame Garage	1960	242	2 115	4	0 %	80 %	
68 Wood Deck	1990	100	3 100	3	0 %	100 %	
40 Basement Entry	1950	30	2 110	4	0 %	100 %	
24 Frame Shed	0				%	%	800
24 Frame Shed	0				%	%	650
24 Frame Shed	0				%	%	600
48 Concrete Slab	0				%	%	300
					%	%	

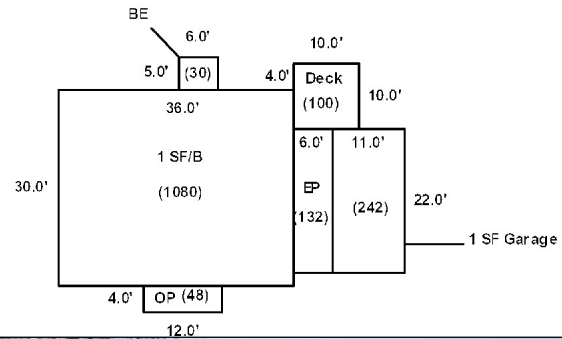
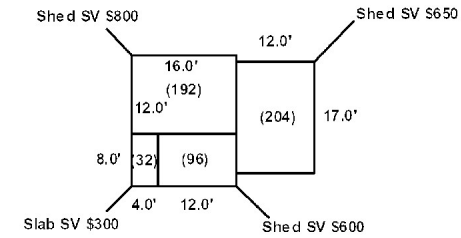

DOODY, LARRY W
13 CLARK ST
WASHBURN ME 04786

B2830P62 B2946P111

Inspection Witnessed By:

No./Date	Description	Date Insp.
X		

Notes:
*2-6-2019 MH HUD # NTA 582534

Washburn

Property Data			Assessment Record						
Neighborhood 1 Neighborhood One			Year	Land	Buildings	Exempt	Total		
Tree Growth Year 0			2012	3,700	31,100	8,800	26,000		
1ST MORTGAGE 0			2013	4,900	31,100	8,800	27,200		
2ND MORTGAGE 0			2015	4,900	31,100	9,000	27,000		
Zone/Land Use 1 Residential			2018	4,900	31,100	18,400	17,600		
Secondary Zone			2019	8,300	18,400	20,000	6,700		
Topography 1 Level			2020	8,300	18,400	25,000	1,700		
1.Level 4.Below St 7.LevelBog			2021	8,300	18,400	25,000	1,700		
2.Rolling 5.Low 8.			2022	8,300	19,300	25,000	2,600		
3.Above St 6.Swampy 9.			2023	11,000	22,900	25,000	8,900		
Utilities 2 Public Water 3 Public Sewer			2024	11,000	22,900	25,000	8,900		
1.Public 4.Dr Well 7.Cesspool									
2.Water 5.Dug Well 8.									
3.Sewer 6.Septic 9.None									
Street 1 Paved									
1.Paved 4.Proposed 7.									
2.Semi Imp 5.R/O/W 8.									
3.Gravel 6. 9.None									
TG PLAN YEAR 0									
Tif District # 0									
Sale Data			Land Data						
Sale Date 9/20/1995			Front Foot	Type	Effective		Influence		Influence Codes
Price					Frontage	Depth	Factor	Code	
Sale Type 2 Land & Buildings			11.Regular Lot					1.Unimproved	
1.Land 4.Mobile 7.C/I L&B			12.Delta Triangle					2.Excess Frtg	
2.L & B 5.Other 8.			13.Nabla Triangle					3.Topography	
3.Building 6.C/I Land 9.			14.Rear Land					4.Size/Shape	
Financing 1 Conventional			15.Class I Road					5.Access	
1.Convent 4.Seller 7.								6.Restriction	
2.FHA/VA 5.Private 8.								7.Open Space	
3.Assumed 6.Cash 9.Unknown								8.View/Environ	
Validity 2 Related Parties								9.Fract Share	
1.Valid 4.Split 7.Renovate			Square Foot	Square Feet				Acres	
2.Related 5.Partial 8.Other			16.Class II Road					30.Utility R O W	
3.Distress 6.Exempt 9.			17.Municipal Rese					31.Tillable	
Verified 5 Public Record			18.Munic Sep Lago					32.Pasture	
1.Buyer 4.Agent 7.Family			19.Gravel Pit					33.Orchard	
2.Seller 5.Pub Rec 8.Other			20.Industrial Bas					34.Softwood F&O	
3.Lender 6.MLS 9.			Fract. Acre	Acreege/Sites				35.Mixed Wood F&O	
			21.Developed Pave	21	0.25	100	%	0	36.Hardwood F&O
			22.Undev Paved (F				%		37.Softwood TG
			23.Developed Grav				%		38.Mixed Wood TG
			Acres				%		39.Hardwood TG
			24.Undev Gravel (%		40.Wasteland
			25.Comm Base Pave				%		41.Open Space
			26.Comm Base Grav				%		42.Mobile Home Si
			27.Backlot				%		43.Condo Site
			28.Rear Land				%		44.Lot Improvemen
			29.Pavement				%		45.Subdivision Lo
			Total Acreage		0.25				46.Heavy Ind Sit

Washburn

Map Lot 011-086

Account 374

Location 13 CLARK STREET

Card 1 Of 1 9/04/2024

Building Style 0	SF Bsmt Living 0	Layout 0
1.Conv. 5.Garrison 9.Gambrel	Fin Bsmt Grade 0 0	1.Typical 4. 7.
2.Ranch 6.Salt Box 10.Other	OPEN 5 OPTIONAL 0	2.Inadeq 5. 8.
3.R Ranch 7.Contemp 11.Split	Heat Type 100% 0	3.Poor 6. 9.
4.Cape 8.Log 12.	1.HWBB 5.FWA 9.No Heat	Attic 0
Dwelling Units 0	2.HWCI 6.GravWA 10.	1.1/4 Fin 4.Full Fin 7.
Other Units 0	3.H Pump 7.Electric 11.	2.1/2 Fin 5.FI/Stair 8.
Stories 0	4.Steam 8.FI/Wall 12.	3.3/4 Fin 6. 9.None
1.1 4.1.5 7.	Cool Type 0% 9 None	Insulation 0
2.2 5.1.75 8.	1.Refrig 4.W&C Air 7.	1.Full 4.Minimal 7.
3.3 6.2.5 9.	2.Evapor 5. 8.	2.Heavy 5.Partial 8.
Exterior Walls 0	3.H Pump 6. 9.None	3.Capped 6. 9.None
1.Wood 5.Stucco 9.T-111	Kitchen Style 0	Unfinished % 0%
2.Vin/Al 6.Brick 10.Other	1.Modern 4.Obsolete 7.	Grade & Factor 0 0%
3.Compos. 7.Stone 11.	2.Typical 5. 8.	1.E Grade 4.B Grade 7.
4.Asbestos 8.Concrete 12.	3.Old Type 6. 9.None	2.D Grade 5.A Grade 8.SC Grade
Roof Surface 0	Bath(s) Style 0	3.C Grade 6.AA Grade 9.Same
1.Asphalt 4.Composit 7.	1.Modern 4.Obsolete 7.	SQFT (Footprint) 0
2.Slate 5.Wood 8.	2.Typical 5. 8.	Condition 0
3.Metal 6.Other 9.	3.Old Type 6. 9.None	1.Poor 4.Avg 7.V G
SF Masonry Trim 0	# Rooms 0	2.Fair 5.Avg+ 8.Exc
OPEN-3-CUSTOM 0	# Bedrooms 0	3.Avg- 6.Good 9.Same
OPEN-4-CUSTOM 0	# Full Baths 0	Phys. % Good 0%
Year Built 0	# Half Baths 0	Funct. % Good 100%
Year Remodeled 0	# Addn Fixtures 0	Functional Code 9 None
Foundation 0	# Fireplaces 0	1.Incomp 4.Delap 7.No Power
1.Concrete 4.Wood 7.	 <p>TRIO Software A Division of Harris Computer Systems</p>	2.O-Built 5.Bsmt 8.LongTerm
2.C Block 5.Slab 8.		3.Damage 6.Common 9.None
3.Br/Stone 6.Piers 9.		Econ. % Good 100%
Basement 0		Economic Code None
1.1/4 Bmt 4.Full Bmt 7.		0.None 3.No Power 7.
2.1/2 Bmt 5.None 8.		1.Location 4.Generate 8.
3.3/4 Bmt 6. 9.None		2.Encroach 9.None 9.
Bsmt Gar # Cars 0		Entrance Code 5 Estimated
Wet Basement 0		1.Interior 4.Vacant 7.
1.Dry 4. 7.		2.Refusal 5.Estimate 8.
2.Damp 5. 8.	3.Informed 6.Reviewed 9.	
3.Wet 6. 9.	Information Code 5 Estimate	
	1.Owner 4.Agent 7.	
	2.Relative 5.Estimate 8.	
	3.Tenant 6.Other 9.	

Date Inspected 10/15/2018

Additions, Outbuildings & Improvements

Type	Year	Units	Grade	Cond	Phys.	Funct.	Sound Value
998 14Mobile Home	1995	14x65	4 105	7	0 %	100 %	
48 Concrete Slab	1995	910	3 100	4	0 %	100 %	
68 Wood Deck	2000	42	2 110	4	0 %	100 %	
24 Frame Shed	0				%	%	500
					%	%	
					%	%	
					%	%	
					%	%	
					%	%	
					%	%	
					%	%	
					%	%	

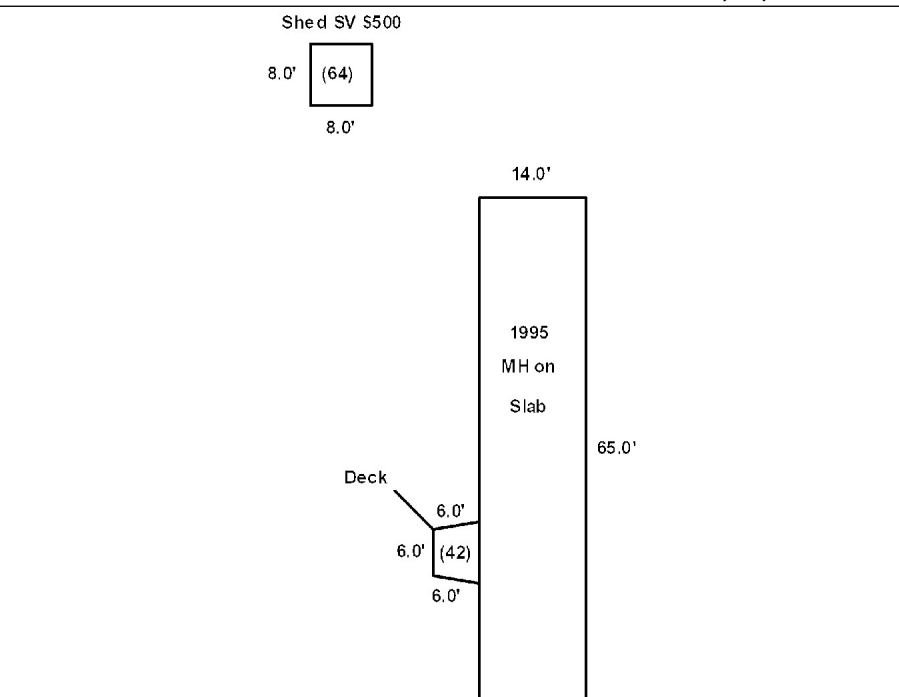

SNYDER, ELEANOR J
SNYDER, HEIRS OF CHRISTOPHER T
239 TANGLE RIDGE ROAD
PERHAM ME 04766

B2825P328

Inspection Witnessed By:

No./Date	Description	Date Insp.
X		

Notes:

Washburn

Property Data			Assessment Record							
Neighborhood 1 Neighborhood One			Year	Land	Buildings	Exempt	Total			
Tree Growth Year 0			2012	5,100	0	0	5,100			
1ST MORTGAGE 0			2013	6,700	0	0	6,700			
2ND MORTGAGE 0			2015	6,700	0	0	6,700			
Zone/Land Use 1 Residential			2018	6,700	0	0	6,700			
Secondary Zone			2019	5,400	0	0	5,400			
Topography 1 Level			2020	5,400	0	0	5,400			
1.Level 4.Below St 7.LevelBog			2021	5,400	0	0	5,400			
2.Rolling 5.Low 8.			2022	5,400	0	0	5,400			
3.Above St 6.Swampy 9.			2023	6,600	0	0	6,600			
Utilities			2024	6,600	0	0	6,600			
1.Public 4.Dr Well 7.Cesspool										
2.Water 5.Dug Well 8.										
3.Sewer 6.Septic 9.None										
Street 1 Paved										
1.Paved 4.Proposed 7.										
2.Semi Imp 5.R/O/W 8.										
3.Gravel 6. 9.None										
TG PLAN YEAR 0										
Tif District # 0										
Sale Data			Land Data							
Sale Date			Front Foot	Type	Effective		Influence		Influence Codes	
Price			11.Regular Lot		Frontage	Depth	Factor	Code		
Sale Type 2 Land & Buildings			12.Delta Triangle				%		1.Unimproved	
1.Land 4.Mobile 7.C/I L&B			13.Nabla Triangle				%		2.Excess Frtg	
2.L & B 5.Other 8.			14.Rear Land				%		3.Topography	
3.Building 6.C/I Land 9.			15.Class I Road				%		4.Size/Shape	
Financing							%		5.Access	
1.Convent 4.Seller 7.							%		6.Restriction	
2.FHA/VA 5.Private 8.							%		7.Open Space	
3.Assumed 6.Cash 9.Unknown							%		8.View/Environ	
Validity 2 Related Parties			Square Foot	Square Feet					9.Fract Share	
1.Valid 4.Split 7.Renovate			16.Class II Road				%		10.Acres	
2.Related 5.Partial 8.Other			17.Municipal Rese				%		30.Utility R O W	
3.Distress 6.Exempt 9.			18.Munic Sep Lago				%		31.Tillable	
Verified 5 Public Record			19.Gravel Pit				%		32.Pasture	
1.Buyer 4.Agent 7.Family			20.Industrial Bas				%		33.Orchard	
2.Seller 5.Pub Rec 8.Other			Fract. Acre	Acres/Sites					34.Softwood F&O	
3.Lender 6.MLS 9.			21.Developed Pave	22	0.36		100	%	0	35.Mixed Wood F&O
			22.Undev Paved (F				%		36.Hardwood F&O	
			23.Developed Grav				%		37.Softwood TG	
			Acres				%		38.Mixed Wood TG	
			24.Undev Gravel (%		39.Hardwood TG	
			25.Comm Base Pave				%		40.Wasteland	
			26.Comm Base Grav				%		41.Open Space	
			27.Backlot				%		42.Mobile Home Si	
			28.Rear Land				%		43.Condo Site	
			29.Pavement				%		44.Lot Improvemen	
			Total Acreage 0.36							45.Subdivision Lo
										46.Heavy Ind Sit

Washburn

Map Lot 011-087

Account 843

Location 9 CLARK STREET

Card 1 Of 1 9/04/2024

Building Style 0	SF Bsmt Living 0	Layout 0
1.Conv. 5.Garrison 9.Gambrel	Fin Bsmt Grade 0 0	1.Typical 4. 7.
2.Ranch 6.Salt Box 10.Other	OPEN 5 OPTIONAL 0	2.Inadeq 5. 8.
3.R Ranch 7.Contemp 11.Split	Heat Type 100% 0	3.Poor 6. 9.
4.Cape 8.Log 12.	1.HWBB 5.FWA 9.No Heat	Attic 0
Dwelling Units 0	2.HWCI 6.GravWA 10.	1.1/4 Fin 4.Full Fin 7.
Other Units 0	3.H Pump 7.Electric 11.	2.1/2 Fin 5.FI/Stair 8.
Stories 0	4.Steam 8.FI/Wall 12.	3.3/4 Fin 6. 9.None
1.1 4.1.5 7.	Cool Type 0% 9 None	Insulation 0
2.2 5.1.75 8.	1.Refrig 4.W&C Air 7.	1.Full 4.Minimal 7.
3.3 6.2.5 9.	2.Evapor 5. 8.	2.Heavy 5.Partial 8.
Exterior Walls 0	3.H Pump 6. 9.None	3.Capped 6. 9.None
1.Wood 5.Stucco 9.T-111	Kitchen Style 0	Unfinished % 0%
2.Vin/Al 6.Brick 10.Other	1.Modern 4.Obsolete 7.	Grade & Factor 0 0%
3.Compos. 7.Stone 11.	2.Typical 5. 8.	1.E Grade 4.B Grade 7.
4.Asbestos 8.Concrete 12.	3.Old Type 6. 9.None	2.D Grade 5.A Grade 8.SC Grade
Roof Surface 0	Bath(s) Style 0	3.C Grade 6.AA Grade 9.Same
1.Asphalt 4.Composit 7.	1.Modern 4.Obsolete 7.	SQFT (Footprint) 0
2.Slate 5.Wood 8.	2.Typical 5. 8.	Condition 0
3.Metal 6.Other 9.	3.Old Type 6. 9.None	1.Poor 4.Avg 7.V G
SF Masonry Trim 0	# Rooms 0	2.Fair 5.Avg+ 8.Exc
OPEN-3-CUSTOM 0	# Bedrooms 0	3.Avg- 6.Good 9.Same
OPEN-4-CUSTOM 0	# Full Baths 0	Phys. % Good 0%
Year Built 0	# Half Baths 0	Funct. % Good 100%
Year Remodeled 0	# Addn Fixtures 0	Functional Code 9 None
Foundation 0	# Fireplaces 0	1.Incomp 4.Delap 7.No Power
1.Concrete 4.Wood 7.		2.O-Built 5.Bsmt 8.LongTerm
2.C Block 5.Slab 8.		3.Damage 6.Common 9.None
3.Br/Stone 6.Piers 9.		Econ. % Good 100%
Basement 0		Economic Code None
1.1/4 Bmt 4.Full Bmt 7.		0.None 3.No Power 7.
2.1/2 Bmt 5.None 8.		1.Location 4.Generate 8.
3.3/4 Bmt 6. 9.None		2.Encroach 9.None 9.
Bsmt Gar # Cars 0		Entrance Code 0
Wet Basement 0		1.Interior 4.Vacant 7.
1.Dry 4. 7.		2.Refusal 5.Estimate 8.
2.Damp 5. 8.	3.Informed 6.Reviewed 9.	
3.Wet 6. 9.	Information Code 0	
		1.Owner 4.Agent 7.
		2.Relative 5.Estimate 8.
		3.Tenant 6.Other 9.

Date Inspected

Additions, Outbuildings & Improvements

Type	Year	Units	Grade	Cond	Phys.	Funct.	Sound Value
					%	%	1.One Story Fram
					%	%	2.Two Story Fram
					%	%	3.Three Story Fr
					%	%	4.1 & 1/2 Story
					%	%	5.1 & 3/4 Story
					%	%	6.2 & 1/2 Story
					%	%	21.Open Frame Por
					%	%	22.Encl Frame Por
					%	%	23.Frame Garage
					%	%	24.Frame Shed
					%	%	25.Frame Bay Wind
					%	%	26.1SFr Overhang
					%	%	27.Unfin Basement
					%	%	28.Unfinished Att
					%	%	29.Finished Attic

FITZHERBERT, WILLIAM W
FITZHERBERT, LEASHA A
PO BOX 641
WASHBURN ME 04786

B4287P133

Inspection Witnessed By:

No./Date	Description	Date Insp.
X		

Notes:

Washburn

Property Data			Assessment Record						
Neighborhood 1 Neighborhood One			Year	Land	Buildings	Exempt	Total		
Tree Growth Year 0			2012	5,100	71,000	8,800	67,300		
1ST MORTGAGE 0			2013	6,700	71,000	8,800	68,900		
2ND MORTGAGE 0			2015	6,700	71,000	9,000	68,700		
Zone/Land Use 1 Residential			2018	6,700	71,000	18,400	59,300		
Secondary Zone			2019	16,200	111,300	20,000	107,500		
Topography 1 Level			2020	16,200	111,000	25,000	102,200		
1.Level 4.Below St 7.LevelBog			2021	16,200	111,300	25,000	102,500		
2.Rolling 5.Low 8.			2022	16,200	116,800	25,000	108,000		
3.Above St 6.Swampy 9.			2023	19,500	138,900	25,000	133,400		
Utilities 2 Public Water 3 Public Sewer			2024	19,500	138,900	25,000	133,400		
1.Public 4.Dr Well 7.Cesspool									
2.Water 5.Dug Well 8.									
3.Sewer 6.Septic 9.None									
Street 1 Paved									
1.Paved 4.Proposed 7.									
2.Semi Imp 5.R/O/W 8.									
3.Gravel 6. 9.None									
TG PLAN YEAR 0									
Tif District # 0									
Sale Data			Land Data						
Sale Date			Front Foot	Type	Effective		Influence		Influence Codes
Price					Frontage	Depth	Factor	Code	
Sale Type 2 Land & Buildings			11.Regular Lot					1.Unimproved	
1.Land 4.Mobile 7.C/I L&B			12.Delta Triangle					2.Excess Frtg	
2.L & B 5.Other 8.			13.Nabla Triangle					3.Topography	
3.Building 6.C/I Land 9.			14.Rear Land					4.Size/Shape	
Financing 1 Conventional			15.Class I Road					5.Access	
1.Convent 4.Seller 7.								6.Restriction	
2.FHA/VA 5.Private 8.								7.Open Space	
3.Assumed 6.Cash 9.Unknown								8.View/Environ	
Validity 1 Arms Length Sale			Square Foot	Square Feet				9.Fract Share	
1.Valid 4.Split 7.Renovate			16.Class II Road	29	2,500	100	%	0	
2.Related 5.Partial 8.Other			17.Municipal Rese						
3.Distress 6.Exempt 9.			18.Munic Sep Lago						
Verified 5 Public Record			19.Gravel Pit						
1.Buyer 4.Agent 7.Family			20.Industrial Bas						
2.Seller 5.Pub Rec 8.Other			Fract. Acre	Acres/Sites					
3.Lender 6.MLS 9.			21.Developed Pave	21	0.36	100	%	0	
			22.Undev Paved (F						
			23.Developed Grav						
			Acres						
			24.Undev Gravel (
			25.Comm Base Pave						
			26.Comm Base Grav						
			27.Backlot						
			28.Rear Land						
			29.Pavement						
			Total Acreage		0.36				

- 1.Unimproved
- 2.Excess Frtg
- 3.Topography
- 4.Size/Shape
- 5.Access
- 6.Restriction
- 7.Open Space
- 8.View/Environ
- 9.Fract Share
- Acres**
- 30.Utility R O W
- 31.Tillable
- 32.Pasture
- 33.Orchard
- 34.Softwood F&O
- 35.Mixed Wood F&O
- 36.Hardwood F&O
- 37.Softwood TG
- 38.Mixed Wood TG
- 39.Hardwood TG
- 40.Wasteland
- 41.Open Space
- 42.Mobile Home Si
- 43.Condo Site
- 44.Lot Improvemen
- 45.Subdivision Lo
- 46.Heavy Ind Sit

Washburn

Map Lot 011-089

Account 441

Location 1335 MAIN STREET

Card 1

Of 1

9/04/2024

Building Style 1 Conventional	SF Bsmt Living 0	Layout 1 Typical
1.Conv. 5.Garrison 9.Gambrel	Fin Bsmt Grade 0 0	1.Typical 4. 7.
2.Ranch 6.Salt Box 10.Other	OPEN 5 OPTIONAL 0	2.Inadeq 5. 8.
3.R Ranch 7.Contemp 11.Split	Heat Type 100% 5 Forced Warm Air	3.Poor 6. 9.
4.Cape 8.Log 12.	1.HWBB 5.FWA 9.No Heat	Attic 9 None
Dwelling Units 1	2.HWCI 6.GravWA 10.	1.1/4 Fin 4.Full Fin 7.
Other Units 0	3.H Pump 7.Electric 11.	2.1/2 Fin 5.FI/Stair 8.
Stories 2 Two Story	4.Steam 8.FI/Wall 12.	3.3/4 Fin 6. 9.None
1.1 4.1.5 7.	Cool Type 0% 9 None	Insulation 1 Full
2.2 5.1.75 8.	1.Refrig 4.W&C Air 7.	1.Full 4.Minimal 7.
3.3 6.2.5 9.	2.Evapor 5. 8.	2.Heavy 5.Partial 8.
Exterior Walls 2 Vinyl/Aluminum	3.H Pump 6. 9.None	3.Capped 6. 9.None
1.Wood 5.Stucco 9.T-111	Kitchen Style 2 Typical	Unfinished % 0%
2.Vin/Al 6.Brick 10.Other	1.Modern 4.Obsolete 7.	Grade & Factor 3 Average 90%
3.Compos. 7.Stone 11.	2.Typical 5. 8.	1.E Grade 4.B Grade 7.
4.Asbestos 8.Concrete 12.	3.Old Type 6. 9.None	2.D Grade 5.A Grade 8.SC Grade
Roof Surface 3 Sheet Metal	Bath(s) Style 2 Typical Bath(s)	3.C Grade 6.AA Grade 9.Same
1.Asphalt 4.Composit 7.	1.Modern 4.Obsolete 7.	SQFT (Footprint) 832
2.Slate 5.Wood 8.	2.Typical 5. 8.	Condition 6 Good
3.Metal 6.Other 9.	3.Old Type 6. 9.None	1.Poor 4.Avg 7.V G
SF Masonry Trim 0	# Rooms 8	2.Fair 5.Avg+ 8.Exc
OPEN-3-CUSTOM 0	# Bedrooms 3	3.Avg- 6.Good 9.Same
OPEN-4-CUSTOM 0	# Full Baths 2	Phys. % Good 0%
Year Built 1910	# Half Baths 0	Funct. % Good 100%
Year Remodeled 0	# Addn Fixtures 0	Functional Code 9 None
Foundation 2 Concrete Block	# Fireplaces 0	1.Incomp 4.Delap 7.No Power
1.Concrete 4.Wood 7.		2.O-Built 5.Bsmt 8.LongTerm
2.C Block 5.Slab 8.		3.Damage 6.Common 9.None
3.Br/Stone 6.Piers 9.		Econ. % Good 100%
Basement 4 Full Basement		Economic Code None
1.1/4 Bmt 4.Full Bmt 7.		0.None 3.No Power 7.
2.1/2 Bmt 5.None 8.		1.Location 4.Generate 8.
3.3/4 Bmt 6. 9.None		2.Encroach 9.None 9.
Bsmt Gar # Cars 0		Entrance Code 1 Interior Inspect
Wet Basement 1 Dry Basement		1.Interior 4.Vacant 7.
1.Dry 4. 7.		2.Refusal 5.Estimate 8.
2.Damp 5. 8.	3.Informed 6.Reviewed 9.	
3.Wet 6. 9.	Information Code 1 Owner	
		1.Owner 4.Agent 7.
		2.Relative 5.Estimate 8.
		3.Tenant 6.Other 9.

Date Inspected 10/15/2018

Additions, Outbuildings & Improvements

Type	Year	Units	Grade	Cond	Phys.	Funct.	Sound Value
1 One Story Frame	1920	112	3 90	5	0 %	100 %	
1 One Story Frame	2005	392	3 95	4	0 %	100 %	
22 Encl Frame Porch	1910	217	2 110	5	0 %	100 %	
68 Wood Deck	1990	324	2 110	4	0 %	100 %	
22 Encl Frame Porch	2016	126	2 110	4	0 %	100 %	
68 Wood Deck	2012	210	2 100	4	0 %	100 %	
82 1.5 S-Gar	2003	1120	3 100	4	0 %	100 %	
24 Frame Shed	0				%	%	850
					%	%	
					%	%	

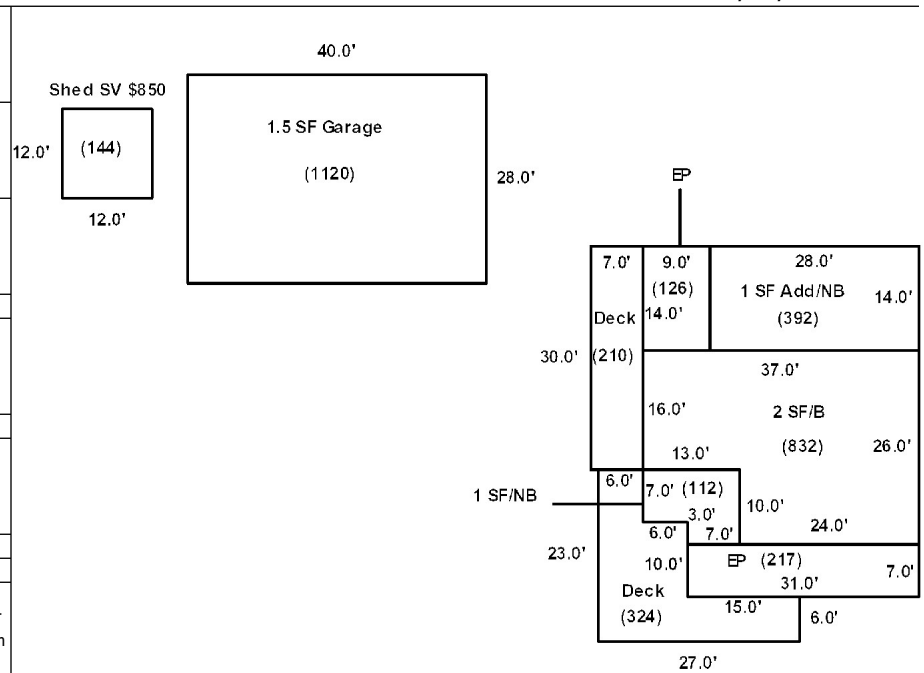

PEARCE, ROBERT
PEARCE, TRACEY
424 MILL STREET
AUBURN ME 04210

B6106P84

Previous Owner
Rossignol, Bernadette
Rossignol, Wayne
424 MILL STREET
AUBURN ME 04210
Sale Date: 12/09/2020

Inspection Witnessed By:

X Date

No./Date	Description	Date Insp.

Notes:

Washburn

Property Data			Assessment Record						
Neighborhood 1 Neighborhood One			Year	Land	Buildings	Exempt	Total		
Tree Growth Year 0			2012	2,900	49,300	14,080	38,120		
1ST MORTGAGE 0			2013	3,800	49,300	14,080	39,020		
2ND MORTGAGE 0			2015	3,800	49,300	14,400	38,700		
Zone/Land Use 1 Residential			2018	3,800	49,300	23,920	29,180		
Secondary Zone			2019	10,200	49,600	26,000	33,800		
Topography 1 Level			2020	10,200	49,600	31,000	28,800		
1.Level 4.Below St 7.LevelBog			2021	10,200	49,600	0	59,800		
2.Rolling 5.Low 8.			2022	10,200	52,100	0	62,300		
3.Above St 6.Swampy 9.			2023	12,600	62,000	0	74,600		
Utilities 2 Public Water 3 Public Sewer			2024	12,600	62,000	0	74,600		
1.Public 4.Dr Well 7.Cesspool									
2.Water 5.Dug Well 8.									
3.Sewer 6.Septic 9.None									
Street 1 Paved									
1.Paved 4.Proposed 7.									
2.Semi Imp 5.R/O/W 8.									
3.Gravel 6. 9.None									
TG PLAN YEAR 0									
Tif District # 0									
Sale Data			Land Data						
Sale Date 12/09/2020			Front Foot	Type	Effective		Influence		Influence Codes
Price 65,500					Frontage	Depth	Factor	Code	
Sale Type 2 Land & Buildings			11.Regular Lot					1.Unimproved	
1.Land 4.Mobile 7.C/I L&B			12.Delta Triangle					2.Excess Frtg	
2.L & B 5.Other 8.			13.Nabla Triangle					3.Topography	
3.Building 6.C/I Land 9.			14.Rear Land					4.Size/Shape	
Financing 1 Conventional			15.Class I Road					5.Access	
1.Convent 4.Seller 7.								6.Restriction	
2.FHA/VA 5.Private 8.								7.Open Space	
3.Assumed 6.Cash 9.Unknown								8.View/Environ	
Validity 1 Arms Length Sale								9.Fract Share	
1.Valid 4.Split 7.Renovate			Square Foot	Square Feet				Acres	
2.Related 5.Partial 8.Other				29	1,200				100
3.Distress 6.Exempt 9.			16.Class II Road					30.Utility R O W	
Verified 5 Public Record			17.Municipal Rese					31.Tillable	
1.Buyer 4.Agent 7.Family			18.Munic Sep Lago					32.Pasture	
2.Seller 5.Pub Rec 8.Other			19.Gravel Pit					33.Orchard	
3.Lender 6.MLS 9.			20.Industrial Bas					34.Softwood F&O	
								35.Mixed Wood F&O	
								36.Hardwood F&O	
								37.Softwood TG	
								38.Mixed Wood TG	
								39.Hardwood TG	
								40.Wasteland	
								41.Open Space	
								42.Mobile Home Si	
								43.Condo Site	
								44.Lot Improvemen	
								45.Subdivision Lo	
								46.Heavy Ind Sit	
			Total Acreage		0.19				

