

Wade

Map Lot 003-001

Account 163

Location 46 Reed Lane

Card 1 Of 1 9/06/2024

Building Style 1 CONVENTIONAL	SF Bsmt Living 0	Layout 1 TYPICAL
1.CONVENTI 5.GARRISON 9.GAMBREL	Fin Bsmt Grade 0 0	1.TYPICAL 4. 7.
2.RANCH 6.SALT BOX 10.OTHER	DIRT FLOOR 0	2.INADEQUA 5. 8.
3.RAISED R 7.CONTEMP 11.SPLIT	Heat Type 100% 5 FORCED WARM AIR	3.POOR 6. 9.
4.CAPE 8.LOG 12.NE	1.HWBB 5.FWA 9.NOT HEAT	Attic 9 NONE
Dwelling Units 1	2.HWCI 6.GRAVWA 10.	1.1/4 FINI 4.FULL FIN 7.
Other Units 0	3.HP 7.ELECTRIC 11.	2.1/2 FINI 5.FL / STA 8.
Stories 4 ONE & 1/2 STORY	4.STEAM 8.FL/WALL 12.	3.3/4 FINI 6. 9.NONE
1.ONE STOR 4.1.5 STOR 7.1.25 STO	Cool Type 0% 9 NONE	Insulation 1 FULLY INSULATED
2.TWO STOR 5.1.75 STO 8.	1.REFRIG A 4.W&C AIR 7.	1.FULLY IN 4.MINIMAL 7.
3.THREE ST 6.2.5 STOR 9.	2.EVAPORAT 5. 8.	2.HEAVY 5.UNKNOWN 8.
Exterior Walls 2 VINYL/ALUMINUM	3.HEAT PUM 6. 9.NONE	3.CAPPED O 6. 9.NONE
1.WOOD 5.STUCKO 9.T-111	Kitchen Style 2 TYPICAL	Unfinished % 0%
2.VIN/AL 6.BRICK 10.OTHER	1.GOOD 4.OBSOLETE 7.	Grade & Factor 3 AVERAGE QUALITY
3.COMPOS. 7.STONE 11.LOG	2.TYPICAL 5. 8.	1.E GRADE 4.B GRADE 7.
4.ASBESTOS 8.CONCRETE 12.	3.OLD STYL 6. 9.NONE	2.D GRADE 5.A GRADE 8.
Roof Surface 1 ASPHALT SHINGLES	Bath(s) Style 2 TYPICAL	3.C GRADE 6.AA GRADE 9.SAME
1.ASPHALT 4.COMPOSIT 7.	1.GOOD 4.OBSOLETE 7.	SQFT (Footprint) 440
2.SLATE 5.WOOD 8.	2.TYPICAL 5. 8.	Condition 4 AVERAGE
3.METAL 6.OTHER 9.	3.OLD STYL 6. 9.NONE	1.POOR 4.AVERAGE 7.VERY GOO
SF Masonry Trim 0	# Rooms 6	2.FAIR 5.ABOVE AV 8.EXCELLEN
0	# Bedrooms 2	3.BELOW AV 6.GOOD 9.SAME
0	# Full Baths 2	Phys. % Good 0%
Year Built 1950	# Half Baths 0	Funct. % Good 100%
Year Remodeled 0	# Addn Fixtures 0	Functional Code 9 None
Foundation 1 CONCRETE	# Fireplaces 0	1.Incomp 4.LongTerm 7.Layout
1.CONCRETE 4.WOOD 7.		2.Overbuil 5.Utility 8.Other
2.CONCRETE 5.SLAB 8.		3.Delap 6.Style 9.None
3.BRICK/ST 6.PIERS 9.		Econ. % Good 100%
Basement 4 FULL BASEMENT		Economic Code NONE
1.1/4 BASE 4.FULL BAS 7.		0.None 3.NO ELECT 6.
2.1/2 BASE 5.CRAWL 8.		1.LOCATION 4.GENERATC 7.
3.3/4 BASE 6. 9.NO BASEM		2.ENCROACH 5. 8.OTHER
Bsmt Gar # Cars 0		Entrance Code 5 ESTIMATED
Wet Basement 2 DAMP BASEMENT		1.INTERIOR 4.UNOCCUPI 7.
1.DRY BASE 4. 7.		2.REFUSED 5.ESTIMATE 8.
2.DAMP BAS 5. 8.		3.INFO ONL 6. 9.
3.WET BASE 6. 9.NO BASEM		Information Code 5 ESTIMATE
		1.OWNER 4.AGENT 7.
		2.RELATIVE 5.ESTIMATE 8.
		3.TENANT 6.OTHER 9.

Date Inspected 7/11/2022

Additions, Outbuildings & Improvements

Type	Year	Units	Grade	Cond	Phys.	Funct.	Sound Value
68 Deck	1990	120	3 100	4	0 %	100 %	
14 1 & 1/2 Story w/	1950	280	3 100	4	0 %	100 %	
21 Open Porch	1950	368	3 100	4	0 %	100 %	
23 Frame Garage	1980	324	3 100	4	0 %	100 %	
					%	%	
					%	%	
					%	%	
					%	%	
					%	%	
					%	%	
					%	%	
					%	%	

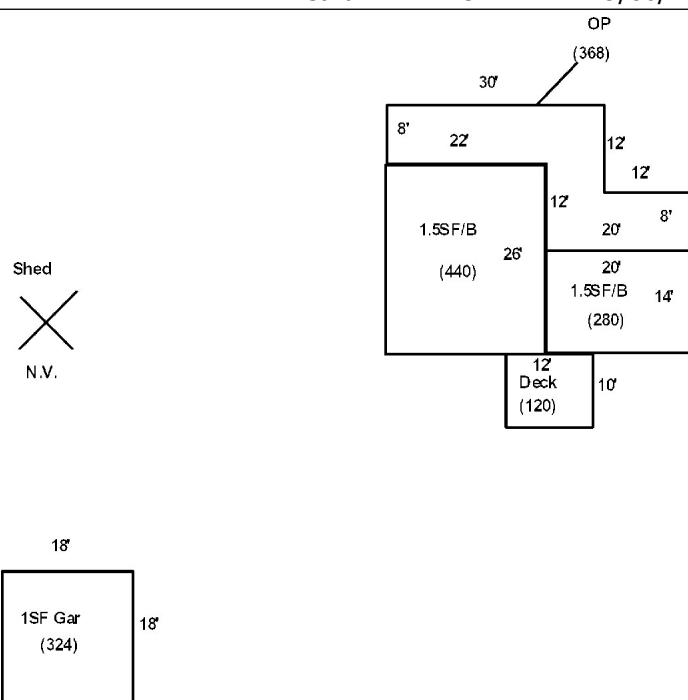

Wade

Map Lot 003-001A

Account 164

Location 53 Reed Lane

Card 1 Of 1 9/06/2024

Building Style 2 RANCH	SF Bsmt Living 0	Layout 1 TYPICAL
1.CONVENTI 5.GARRISON 9.GAMBREL	Fin Bsmt Grade 0 0	1.TYPICAL 4. 7.
2.RANCH 6.SALT BOX 10.OTHER	DIRT FLOOR 0	2.INADEQUA 5. 8.
3.RAISED R 7.CONTEMP 11.SPLIT	Heat Type 100% 1 HOT WATER BB	3.POOR 6. 9.
4.CAPE 8.LOG 12.NE	1.HWBB 5.FWA 9.NOT HEAT	Attic 9 NONE
Dwelling Units 1	2.HWCI 6.GRAWWA 10.	1.1/4 FINI 4.FULL FIN 7.
Other Units 0	3.HP 7.ELECTRIC 11.	2.1/2 FINI 5.FL / STA 8.
Stories 1 ONE STORY	4.STEAM 8.FL/WALL 12.	3.3/4 FINI 6. 9.NONE
1.ONE STOR 4.1.5 STOR 7.1.25 STO	Cool Type 100% 3 HEAT PUMP	Insulation 1 FULLY INSULATED
2.TWO STOR 5.1.75 STO 8.	1.REFRIG A 4.W&C AIR 7.	1.FULLY IN 4.MINIMAL 7.
3.THREE ST 6.2.5 STOR 9.	2.EVAPORAT 5. 8.	2.HEAVY 5.UNKNOWN 8.
Exterior Walls 2 VINYL/ALUMINUM	3.HEAT PUM 6. 9.NONE	3.CAPPED O 6. 9.NONE
1.WOOD 5.STUCKO 9.T-111	Kitchen Style 2 TYPICAL	Unfinished % 0%
2.VIN/AL 6.BRICK 10.OTHER	1.GOOD 4.OBSOLETE 7.	Grade & Factor 3 AVERAGE QUALITY
3.COMPOS. 7.STONE 11.LOG	2.TYPICAL 5. 8.	1.E GRADE 4.B GRADE 7.
4.ASBESTOS 8.CONCRETE 12.	3.OLD STYL 6. 9.NONE	2.D GRADE 5.A GRADE 8.
Roof Surface 1 ASPHALT SHINGLES	Bath(s) Style 2 TYPICAL	3.C GRADE 6.AA GRADE 9.SAME
1.ASPHALT 4.COMPOSIT 7.	1.GOOD 4.OBSOLETE 7.	SQFT (Footprint) 1040
2.SLATE 5.WOOD 8.	2.TYPICAL 5. 8.	Condition 4 AVERAGE
3.METAL 6.OTHER 9.	3.OLD STYL 6. 9.NONE	1.POOR 4.AVERAGE 7.VERY GOO
SF Masonry Trim 0	# Rooms 5	2.FAIR 5.ABOVE AV 8.EXCELLEN
0	# Bedrooms 2	3.BELOW AV 6.GOOD 9.SAME
0	# Full Baths 1	Phys. % Good 0%
Year Built 1995	# Half Baths 0	Funct. % Good 100%
Year Remodeled 0	# Addn Fixtures 0	Functional Code 9 None
Foundation 1 CONCRETE	# Fireplaces 0	1.Incomp 4.LongTerm 7.Layout
1.CONCRETE 4.WOOD 7.		2.Overbuil 5.Utility 8.Other
2.CONCRETE 5.SLAB 8.		3.Delap 6.Style 9.None
3.BRICK/ST 6.PIERS 9.		Econ. % Good 100%
Basement 4 FULL BASEMENT		Economic Code NONE
1.1/4 BASE 4.FULL BAS 7.		0.None 3.NO ELECT 6.
2.1/2 BASE 5.CRAWL 8.		1.LOCATION 4.GENERATC 7.
3.3/4 BASE 6. 9.NO BASEM		2.ENCROACH 5. 8.OTHER
Bsmt Gar # Cars 0		Entrance Code 1 INTERIOR INSPECT
Wet Basement 1 DRY BASEMENT		1.INTERIOR 4.UNOCCUPI 7.
1.DRY BASE 4. 7.		2.REFUSED 5.ESTIMATE 8.
2.DAMP BAS 5. 8.	3.INFO ONL 6. 9.	
3.WET BASE 6. 9.NO BASEM	Information Code 1 OWNER	
	1.OWNER 4.AGENT 7.	
	2.RELATIVE 5.ESTIMATE 8.	
	3.TENANT 6.OTHER 9.	

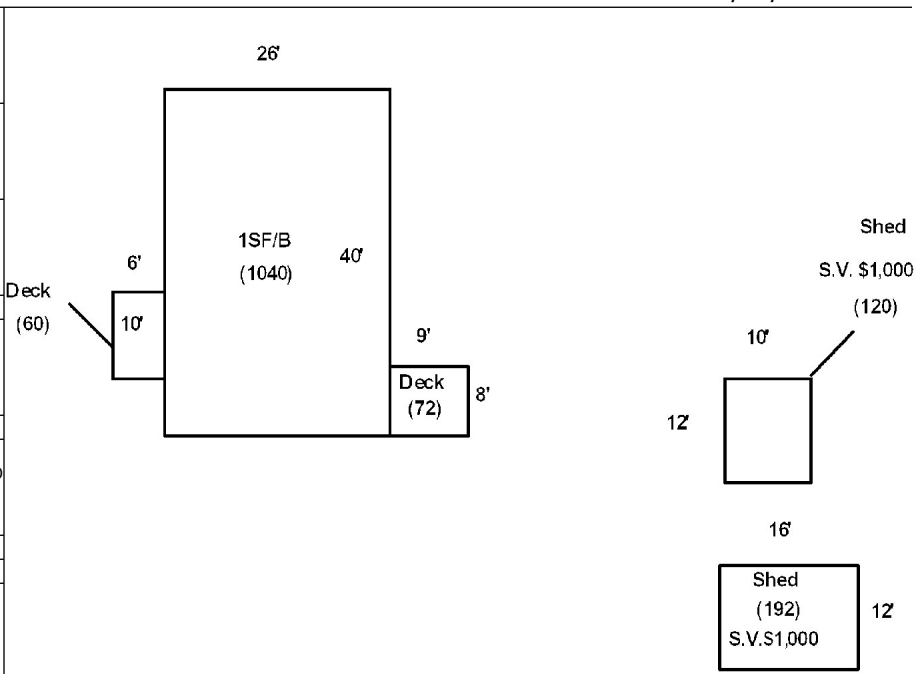

Date Inspected 8/29/2022

Additions, Outbuildings & Improvements

Type	Year	Units	Grade	Cond	Phys.	Funct.	Sound Value
68 Deck	2000	72	3 100	4	0 %	100 %	
68 Deck	2000	60	3 100	4	0 %	100 %	
24 Frame Shed	2000				%	%	1,000
24 Frame Shed	2023				%	%	1,000
					%	%	
					%	%	
					%	%	
					%	%	
					%	%	
					%	%	
					%	%	



Wade

Map Lot 003-002

Account 91

Location

Card 1 Of 1 9/06/2024

Building Style 0	SF Bsmt Living 0	Layout 0
1.CONVENTI 5.GARRISON 9.GAMBREL	Fin Bsmt Grade 0 0	1.TYPICAL 4. 7.
2.RANCH 6.SALT BOX 10.OTHER	DIRT FLOOR 0	2.INADEQUA 5. 8.
3.RAISED R 7.CONTEMP 11.SPLIT	Heat Type 100% 0	3.POOR 6. 9.
4.CAPE 8.LOG 12.NE	1.HWBB 5.FWA 9.NOT HEAT	Attic 0
Dwelling Units 0	2.HWCI 6.GRAWWA 10.	1.1/4 FINI 4.FULL FIN 7.
Other Units 0	3.HP 7.ELECTRIC 11.	2.1/2 FINI 5.FL / STA 8.
Stories 0	4.STEAM 8.FL/WALL 12.	3.3/4 FINI 6. 9.NONE
1.ONE STOR 4.1.5 STOR 7.1.25 STO	Cool Type 0% 9 NONE	Insulation 0
2.TWO STOR 5.1.75 STO 8.	1.REFRIG A 4.W&C AIR 7.	1.FULLY IN 4.MINIMAL 7.
3.THREE ST 6.2.5 STOR 9.	2.EVAPORAT 5. 8.	2.HEAVY 5.UNKNOWN 8.
Exterior Walls 0	3.HEAT PUM 6. 9.NONE	3.CAPPED O 6. 9.NONE
1.WOOD 5.STUCKO 9.T-111	Kitchen Style 0	Unfinished % 0%
2.VIN/AL 6.BRICK 10.OTHER	1.GOOD 4.OBSOLETE 7.	Grade & Factor 0 0%
3.COMPOS. 7.STONE 11.LOG	2.TYPICAL 5. 8.	1.E GRADE 4.B GRADE 7.
4.ASBESTOS 8.CONCRETE 12.	3.OLD STYL 6. 9.NONE	2.D GRADE 5.A GRADE 8.
Roof Surface 0	Bath(s) Style 0	3.C GRADE 6.AA GRADE 9.SAME
1.ASPHALT 4.COMPOSIT 7.	1.GOOD 4.OBSOLETE 7.	SQFT (Footprint) 0
2.SLATE 5.WOOD 8.	2.TYPICAL 5. 8.	Condition 0
3.METAL 6.OTHER 9.	3.OLD STYL 6. 9.NONE	1.POOR 4.AVERAGE 7.VERY GOO
SF Masonry Trim 0	# Rooms 0	2.FAIR 5.ABOVE AV 8.EXCELLEN
0	# Bedrooms 0	3.BELOW AV 6.GOOD 9.SAME
0	# Full Baths 0	Phys. % Good 0%
Year Built 0	# Half Baths 0	Funct. % Good 100%
Year Remodeled 0	# Addn Fixtures 0	Functional Code 9 None
Foundation 0	# Fireplaces 0	1.Incomp 4.LongTerm 7.Layout
1.CONCRETE 4.WOOD 7.		2.Overbuil 5.Utility 8.Other
2.CONCRETE 5.SLAB 8.		3.Delap 6.Style 9.None
3.BRICK/ST 6.PIERS 9.		Econ. % Good 100%
Basement 0		Economic Code NONE
1.1/4 BASE 4.FULL BAS 7.		0.None 3.NO ELECT 6.
2.1/2 BASE 5.CRAWL 8.		1.LOCATION 4.GENERATC 7.
3.3/4 BASE 6. 9.NO BASEM		2.ENCROACH 5. 8.OTHER
Bsmt Gar # Cars 0		Entrance Code 5 ESTIMATED
Wet Basement 0		1.INTERIOR 4.UNOCCUPI 7.
1.DRY BASE 4. 7.		2.REFUSED 5.ESTIMATE 8.
2.DAMP BAS 5. 8.		3.INFO ONL 6. 9.
3.WET BASE 6. 9.NO BASEM		Information Code 5 ESTIMATE
		1.OWNER 4.AGENT 7.
		2.RELATIVE 5.ESTIMATE 8.
		3.TENANT 6.OTHER 9.



Date Inspected 7/14/2022

Additions, Outbuildings & Improvements								
Type	Year	Units	Grade	Cond	Phys.	Funct.	Sound Value	
					%	%		1.One Story Fram
					%	%		2.Two Story Fram
					%	%		3.Three Story Fr
					%	%		4.1 & 1/2 Story
					%	%		5.1 & 3/4 Story
					%	%		6.2 & 1/2 Story
					%	%		21.Open Porch
					%	%		22.Enclosed Porch
					%	%		23.Frame Garage
					%	%		24.Frame Shed
					%	%		25.1SF Bay Window
					%	%		26.1SF Over Hang
					%	%		27.Unfinished Bas
					%	%		28.Unfinished Att
					%	%		29.Finished Basem

Klei, Jr., Herbert E.
76 Turnpike Road
Willington CT 06279

B3077P333

Inspection Witnessed By:

No./Date	Description	Date Insp.
X		

Notes:

Wade

Property Data			Assessment Record																																																																																																																																																																																																					
Neighborhood 1 Rural			Year	Land	Buildings	Exempt	Total																																																																																																																																																																																																	
Tree Growth Year 0			2017	24,300	0	0	24,300																																																																																																																																																																																																	
X Coordinate			2018	24,200	0	0	24,200																																																																																																																																																																																																	
Y Coordinate			2020	20,700	0	0	20,700																																																																																																																																																																																																	
Zone/Land Use 1 Residential			2021	21,300	0	0	21,300																																																																																																																																																																																																	
Secondary Zone			2022	22,800	0	0	22,800																																																																																																																																																																																																	
Topography 2 Rolling			2023	23,000	0	0	23,000																																																																																																																																																																																																	
			2024	23,000	0	0	23,000																																																																																																																																																																																																	
1.Level 4.Below Stre 7.Steep 2.Rolling 5.Low 8.Rough 3.Above Stre 6.Swampy 9.																																																																																																																																																																																																								
Utilities																																																																																																																																																																																																								
1.Well+Septi 4.Public Wat 7.Cess Pool 2.Drilled We 5.Public Sew 8.Holding Ta 3.Septic Sys 6.Dug Well 9.NoW/NoSew																																																																																																																																																																																																								
Street 3 Gravel																																																																																																																																																																																																								
1.Paved 4.Proposed 7. 2.Semi-Impro 5.Private 8. 3.Gravel 6. 9.No Street																																																																																																																																																																																																								
LAND USE 0			<table border="1"> <thead> <tr> <th rowspan="2">Front Foot</th> <th rowspan="2">Type</th> <th colspan="2">Effective</th> <th colspan="2">Influence</th> <th rowspan="2">Influence Codes</th> </tr> <tr> <th>Frontage</th> <th>Depth</th> <th>Factor</th> <th>Code</th> </tr> </thead> <tbody> <tr> <td>11.Regular Lot</td> <td></td> <td></td> <td></td> <td>%</td> <td></td> <td>1.Vacancy</td> </tr> <tr> <td>12.Delta Triangle</td> <td></td> <td></td> <td></td> <td>%</td> <td></td> <td>2.Unimproved</td> </tr> <tr> <td>13.Nabla Triangle</td> <td></td> <td></td> <td></td> <td>%</td> <td></td> <td>3.Topography</td> </tr> <tr> <td>14.Rear Land</td> <td></td> <td></td> <td></td> <td>%</td> <td></td> <td>4.Size/Shape</td> </tr> <tr> <td>15.Class I Road</td> <td></td> <td></td> <td></td> <td>%</td> <td></td> <td>5.Access</td> </tr> <tr> <td></td> <td></td> <td></td> <td></td> <td>%</td> <td></td> <td>6.Restriction</td> </tr> <tr> <td></td> <td></td> <td></td> <td></td> <td>%</td> <td></td> <td>7.Corner/Locatio</td> </tr> <tr> <td></td> <td></td> <td></td> <td></td> <td>%</td> <td></td> <td>8.View/Environme</td> </tr> <tr> <td></td> <td></td> <td></td> <td></td> <td>%</td> <td></td> <td>9.Fractional Sha</td> </tr> <tr> <td></td> <td></td> <td></td> <td></td> <td>%</td> <td></td> <td>Acres</td> </tr> <tr> <td></td> <td></td> <td></td> <td></td> <td>%</td> <td></td> <td>32.Pasture</td> </tr> <tr> <td></td> <td></td> <td></td> <td></td> <td>%</td> <td></td> <td>33.Orchard</td> </tr> <tr> <td></td> <td></td> <td></td> <td></td> <td>%</td> <td></td> <td>34.Softwood (FL)</td> </tr> <tr> <td></td> <td></td> <td></td> <td></td> <td>%</td> <td></td> <td>35.Mixed Wood (FL)</td> </tr> <tr> <td></td> <td></td> <td></td> <td></td> <td>%</td> <td></td> <td>36.Hardwood (FL)</td> </tr> <tr> <td></td> <td></td> <td></td> <td></td> <td>%</td> <td></td> <td>37.Softwood (TG)</td> </tr> <tr> <td></td> <td></td> <td></td> <td></td> <td>%</td> <td></td> <td>38.Mixed Wood (TG)</td> </tr> <tr> <td></td> <td></td> <td></td> <td></td> <td>%</td> <td></td> <td>39.Hardwood (TG)</td> </tr> <tr> <td></td> <td></td> <td></td> <td></td> <td>%</td> <td></td> <td>40.Wasteland</td> </tr> <tr> <td></td> <td></td> <td></td> <td></td> <td>%</td> <td></td> <td>41.Open Space</td> </tr> <tr> <td></td> <td></td> <td></td> <td></td> <td>%</td> <td></td> <td>42.Mobile Home Si</td> </tr> <tr> <td></td> <td></td> <td></td> <td></td> <td>%</td> <td></td> <td>43.Condo Site</td> </tr> <tr> <td></td> <td></td> <td></td> <td></td> <td>%</td> <td></td> <td>44.Lot Improvemen</td> </tr> <tr> <td></td> <td></td> <td></td> <td></td> <td>%</td> <td></td> <td>45.Subdivision Lo</td> </tr> <tr> <td></td> <td></td> <td></td> <td></td> <td>%</td> <td></td> <td>46.Heavy Ind Sit</td> </tr> <tr> <td colspan="2"></td> <td colspan="2"></td> <td colspan="2">Total Acreage</td> <td>67.00</td> </tr> </tbody> </table>					Front Foot	Type	Effective		Influence		Influence Codes	Frontage	Depth	Factor	Code	11.Regular Lot				%		1.Vacancy	12.Delta Triangle				%		2.Unimproved	13.Nabla Triangle				%		3.Topography	14.Rear Land				%		4.Size/Shape	15.Class I Road				%		5.Access					%		6.Restriction					%		7.Corner/Locatio					%		8.View/Environme					%		9.Fractional Sha					%		Acres					%		32.Pasture					%		33.Orchard					%		34.Softwood (FL)					%		35.Mixed Wood (FL)					%		36.Hardwood (FL)					%		37.Softwood (TG)					%		38.Mixed Wood (TG)					%		39.Hardwood (TG)					%		40.Wasteland					%		41.Open Space					%		42.Mobile Home Si					%		43.Condo Site					%		44.Lot Improvemen					%		45.Subdivision Lo					%		46.Heavy Ind Sit					Total Acreage		67.00
Front Foot	Type	Effective								Influence		Influence Codes																																																																																																																																																																																												
		Frontage	Depth	Factor	Code																																																																																																																																																																																																			
11.Regular Lot				%		1.Vacancy																																																																																																																																																																																																		
12.Delta Triangle				%		2.Unimproved																																																																																																																																																																																																		
13.Nabla Triangle				%		3.Topography																																																																																																																																																																																																		
14.Rear Land				%		4.Size/Shape																																																																																																																																																																																																		
15.Class I Road				%		5.Access																																																																																																																																																																																																		
				%		6.Restriction																																																																																																																																																																																																		
				%		7.Corner/Locatio																																																																																																																																																																																																		
				%		8.View/Environme																																																																																																																																																																																																		
				%		9.Fractional Sha																																																																																																																																																																																																		
				%		Acres																																																																																																																																																																																																		
				%		32.Pasture																																																																																																																																																																																																		
				%		33.Orchard																																																																																																																																																																																																		
				%		34.Softwood (FL)																																																																																																																																																																																																		
				%		35.Mixed Wood (FL)																																																																																																																																																																																																		
				%		36.Hardwood (FL)																																																																																																																																																																																																		
				%		37.Softwood (TG)																																																																																																																																																																																																		
				%		38.Mixed Wood (TG)																																																																																																																																																																																																		
				%		39.Hardwood (TG)																																																																																																																																																																																																		
				%		40.Wasteland																																																																																																																																																																																																		
				%		41.Open Space																																																																																																																																																																																																		
				%		42.Mobile Home Si																																																																																																																																																																																																		
				%		43.Condo Site																																																																																																																																																																																																		
				%		44.Lot Improvemen																																																																																																																																																																																																		
				%		45.Subdivision Lo																																																																																																																																																																																																		
				%		46.Heavy Ind Sit																																																																																																																																																																																																		
				Total Acreage		67.00																																																																																																																																																																																																		
Sale Data			<table border="1"> <thead> <tr> <th rowspan="2">Fract. Acre</th> <th colspan="2">Acreage/Sites</th> <th colspan="2"></th> <th colspan="2"></th> </tr> <tr> <th></th> <th></th> <th></th> <th></th> <th></th> <th></th> </tr> </thead> <tbody> <tr> <td>21.Developed Pave</td> <td>22</td> <td>1.00</td> <td>100</td> <td>%</td> <td>0</td> <td></td> </tr> <tr> <td>22.Undev Paved (F</td> <td>26</td> <td>14.00</td> <td>100</td> <td>%</td> <td>0</td> <td></td> </tr> <tr> <td>23.Developed Grav</td> <td>39</td> <td>12.00</td> <td>100</td> <td>%</td> <td>0</td> <td></td> </tr> <tr> <td>Acres</td> <td>40</td> <td>40.00</td> <td>100</td> <td>%</td> <td>0</td> <td></td> </tr> <tr> <td>24.Undev Gravel (</td> <td></td> <td></td> <td></td> <td>%</td> <td></td> <td></td> </tr> <tr> <td>26.Rear Land</td> <td></td> <td></td> <td></td> <td>%</td> <td></td> <td></td> </tr> <tr> <td>27.Backlot</td> <td></td> <td></td> <td></td> <td>%</td> <td></td> <td></td> </tr> <tr> <td>29.Pavement</td> <td></td> <td></td> <td></td> <td>%</td> <td></td> <td></td> </tr> <tr> <td>30.Utility R O W</td> <td></td> <td></td> <td></td> <td>%</td> <td></td> <td></td> </tr> <tr> <td>31.Tillable</td> <td></td> <td></td> <td></td> <td>%</td> <td></td> <td></td> </tr> </tbody> </table>					Fract. Acre	Acreage/Sites												21.Developed Pave	22	1.00	100	%	0		22.Undev Paved (F	26	14.00	100	%	0		23.Developed Grav	39	12.00	100	%	0		Acres	40	40.00	100	%	0		24.Undev Gravel (%			26.Rear Land				%			27.Backlot				%			29.Pavement				%			30.Utility R O W				%			31.Tillable				%																																																																																																																
Fract. Acre	Acreage/Sites																																																																																																																																																																																																							
21.Developed Pave	22	1.00	100	%	0																																																																																																																																																																																																			
22.Undev Paved (F	26	14.00	100	%	0																																																																																																																																																																																																			
23.Developed Grav	39	12.00	100	%	0																																																																																																																																																																																																			
Acres	40	40.00	100	%	0																																																																																																																																																																																																			
24.Undev Gravel (%																																																																																																																																																																																																				
26.Rear Land				%																																																																																																																																																																																																				
27.Backlot				%																																																																																																																																																																																																				
29.Pavement				%																																																																																																																																																																																																				
30.Utility R O W				%																																																																																																																																																																																																				
31.Tillable				%																																																																																																																																																																																																				
Validity																																																																																																																																																																																																								
1.Valid 4.Split 7.Renovate 2.Related 5.Partial 8.Other 3.Distress 6.Exempt 9.																																																																																																																																																																																																								
Verified																																																																																																																																																																																																								
1.Buyer 4.Agent 7.Family 2.Seller 5.Pub Rec 8.Other 3.Lender 6.MLS 9.																																																																																																																																																																																																								

Wade

Map Lot 003-002-1 & 005-2

Account 109

Location 287 South Wade Rd

Card 1

Of 1

9/06/2024

Building Style 0	SF Bsmt Living 0	Layout 0
1.CONVENTI 5.GARRISON 9.GAMBREL	Fin Bsmt Grade 0 0	1.TYPICAL 4. 7.
2.RANCH 6.SALT BOX 10.OTHER	DIRT FLOOR 0	2.INADEQUA 5. 8.
3.RAISED R 7.CONTEMP 11.SPLIT	Heat Type 100% 0	3.POOR 6. 9.
4.CAPE 8.LOG 12.NE	1.HWBB 5.FWA 9.NOT HEAT	Attic 0
Dwelling Units 0	2.HWCI 6.GRAVWA 10.	1.1/4 FINI 4.FULL FIN 7.
Other Units 0	3.HP 7.ELECTRIC 11.	2.1/2 FINI 5.FL / STA 8.
Stories 0	4.STEAM 8.FL/WALL 12.	3.3/4 FINI 6. 9.NONE
1.ONE STOR 4.1.5 STOR 7.1.25 STO	Cool Type 0% 9 NONE	Insulation 0
2.TWO STOR 5.1.75 STO 8.	1.REFRIG A 4.W&C AIR 7.	1.FULLY IN 4.MINIMAL 7.
3.THREE ST 6.2.5 STOR 9.	2.EVAPORAT 5. 8.	2.HEAVY 5.UNKNOWN 8.
Exterior Walls 0	3.HEAT PUM 6. 9.NONE	3.CAPPED O 6. 9.NONE
1.WOOD 5.STUCKO 9.T-111	Kitchen Style 0	Unfinished % 0%
2.VIN/AL 6.BRICK 10.OTHER	1.GOOD 4.OBSOLETE 7.	Grade & Factor 0 0%
3.COMPOS. 7.STONE 11.LOG	2.TYPICAL 5. 8.	1.E GRADE 4.B GRADE 7.
4.ASBESTOS 8.CONCRETE 12.	3.OLD STYL 6. 9.NONE	2.D GRADE 5.A GRADE 8.
Roof Surface 0	Bath(s) Style 0	3.C GRADE 6.AA GRADE 9.SAME
1.ASPHALT 4.COMPOSIT 7.	1.GOOD 4.OBSOLETE 7.	SQFT (Footprint) 0
2.SLATE 5.WOOD 8.	2.TYPICAL 5. 8.	Condition 0
3.METAL 6.OTHER 9.	3.OLD STYL 6. 9.NONE	1.POOR 4.AVERAGE 7.VERY GOO
SF Masonry Trim 0	# Rooms 0	2.FAIR 5.ABOVE AV 8.EXCELLEN
0	# Bedrooms 0	3.BELOW AV 6.GOOD 9.SAME
0	# Full Baths 0	Phys. % Good 0%
Year Built 0	# Half Baths 0	Funct. % Good 100%
Year Remodeled 0	# Addn Fixtures 0	Functional Code 9 None
Foundation 0	# Fireplaces 0	1.Incomp 4.LongTerm 7.Layout
1.CONCRETE 4.WOOD 7.		2.Overbuil 5.Utility 8.Other
2.CONCRETE 5.SLAB 8.		3.Delap 6.Style 9.None
3.BRICK/ST 6.PIERS 9.		Econ. % Good 100%
Basement 0		Economic Code NONE
1.1/4 BASE 4.FULL BAS 7.		0.None 3.NO ELECT 6.
2.1/2 BASE 5.CRAWL 8.		1.LOCATION 4.GENERATC 7.
3.3/4 BASE 6. 9.NO BASEM		2.ENCROACH 5. 8.OTHER
Bsmt Gar # Cars 0		Entrance Code 0
Wet Basement 0		1.INTERIOR 4.UNOCCUPI 7.
1.DRY BASE 4. 7.		2.REFUSED 5.ESTIMATE 8.
2.DAMP BAS 5. 8.	3.INFO ONL 6. 9.	
3.WET BASE 6. 9.NO BASEM	Information Code 0	
	1.OWNER 4.AGENT 7.	
	2.RELATIVE 5.ESTIMATE 8.	
	3.TENANT 6.OTHER 9.	

Date Inspected

Additions, Outbuildings & Improvements

Type	Year	Units	Grade	Cond	Phys.	Funct.	Sound Value
					%	%	1.One Story Fram
					%	%	2.Two Story Fram
					%	%	3.Three Story Fr
					%	%	4.1 & 1/2 Story
					%	%	5.1 & 3/4 Story
					%	%	6.2 & 1/2 Story
					%	%	21.Open Porch
					%	%	22.Enclosed Porch
					%	%	23.Frame Garage
					%	%	24.Frame Shed
					%	%	25.1SF Bay Window
					%	%	26.1SF Over Hang
					%	%	27.Unfinished Bas
					%	%	28.Unfinished Att
					%	%	29.Finished Basem

KLEI, HERBERT E
76 Turnpike Rd
Willington CT 06279

B3077P333

Inspection Witnessed By:

No./Date	Description	Date Insp.
X		

Notes:

Wade

Property Data			Assessment Record																																																																																																																																																																																														
Neighborhood 1 Rural			Year	Land	Buildings	Exempt	Total																																																																																																																																																																																										
Tree Growth Year 0			2017	42,400	24,200	0	66,600																																																																																																																																																																																										
X Coordinate			2018	42,000	11,100	0	53,100																																																																																																																																																																																										
Y Coordinate			2020	40,700	3,760	0	44,460																																																																																																																																																																																										
Zone/Land Use 1 Residential			2021	39,800	3,800	0	43,600																																																																																																																																																																																										
Secondary Zone			2022	49,700	3,000	0	52,700																																																																																																																																																																																										
Topography 2 Rolling			2023	50,300	3,000	0	53,300																																																																																																																																																																																										
1.Level 4.Below Stre 7.Steep			2024	50,600	3,000	0	53,600																																																																																																																																																																																										
2.Rolling 5.Low 8.Rough																																																																																																																																																																																																	
3.Above Stre 6.Swampy 9.																																																																																																																																																																																																	
Utilities 9 NoWater/NoSewer																																																																																																																																																																																																	
1.Well+Septi 4.Public Wat 7.Cess Pool																																																																																																																																																																																																	
2.Drilled We 5.Public Sew 8.Holding Ta																																																																																																																																																																																																	
3.Septic Sys 6.Dug Well 9.NoW/NoSew																																																																																																																																																																																																	
Street 1 Paved																																																																																																																																																																																																	
1.Paved 4.Proposed 7.																																																																																																																																																																																																	
2.Semi-Impro 5.Private 8.																																																																																																																																																																																																	
3.Gravel 6. 9.No Street																																																																																																																																																																																																	
LAND USE 0			<table border="1"> <thead> <tr> <th rowspan="2">Front Foot</th> <th rowspan="2">Type</th> <th colspan="2">Effective</th> <th colspan="2">Influence</th> <th rowspan="2">Influence Codes</th> </tr> <tr> <th>Frontage</th> <th>Depth</th> <th>Factor</th> <th>Code</th> </tr> </thead> <tbody> <tr> <td>11.Regular Lot</td> <td></td> <td></td> <td></td> <td>%</td> <td></td> <td>1.Vacancy</td> </tr> <tr> <td>12.Delta Triangle</td> <td></td> <td></td> <td></td> <td>%</td> <td></td> <td>2.Unimproved</td> </tr> <tr> <td>13.Nabla Triangle</td> <td></td> <td></td> <td></td> <td>%</td> <td></td> <td>3.Topography</td> </tr> <tr> <td>14.Rear Land</td> <td></td> <td></td> <td></td> <td>%</td> <td></td> <td>4.Size/Shape</td> </tr> <tr> <td>15.Class I Road</td> <td></td> <td></td> <td></td> <td>%</td> <td></td> <td>5.Access</td> </tr> <tr> <td></td> <td></td> <td></td> <td></td> <td>%</td> <td></td> <td>6.Restriction</td> </tr> <tr> <td></td> <td></td> <td></td> <td></td> <td>%</td> <td></td> <td>7.Corner/Locatio</td> </tr> <tr> <td></td> <td></td> <td></td> <td></td> <td>%</td> <td></td> <td>8.View/Environme</td> </tr> <tr> <td></td> <td></td> <td></td> <td></td> <td>%</td> <td></td> <td>9.Fractional Sha</td> </tr> <tr> <td></td> <td></td> <td></td> <td></td> <td>%</td> <td></td> <td>Acres</td> </tr> <tr> <td></td> <td></td> <td></td> <td></td> <td>%</td> <td></td> <td>32.Pasture</td> </tr> <tr> <td></td> <td></td> <td></td> <td></td> <td>%</td> <td></td> <td>33.Orchard</td> </tr> <tr> <td></td> <td></td> <td></td> <td></td> <td>%</td> <td></td> <td>34.Softwood (FL)</td> </tr> <tr> <td></td> <td></td> <td></td> <td></td> <td>%</td> <td></td> <td>35.Mixed Wood (FL)</td> </tr> <tr> <td></td> <td></td> <td></td> <td></td> <td>%</td> <td></td> <td>36.Hardwood (FL)</td> </tr> <tr> <td></td> <td></td> <td></td> <td></td> <td>%</td> <td></td> <td>37.Softwood (TG)</td> </tr> <tr> <td></td> <td></td> <td></td> <td></td> <td>%</td> <td></td> <td>38.Mixed Wood (TG)</td> </tr> <tr> <td></td> <td></td> <td></td> <td></td> <td>%</td> <td></td> <td>39.Hardwood (TG)</td> </tr> <tr> <td></td> <td></td> <td></td> <td></td> <td>%</td> <td></td> <td>40.Wasteland</td> </tr> <tr> <td></td> <td></td> <td></td> <td></td> <td>%</td> <td></td> <td>41.Open Space</td> </tr> <tr> <td></td> <td></td> <td></td> <td></td> <td>%</td> <td></td> <td>42.Mobile Home Si</td> </tr> <tr> <td></td> <td></td> <td></td> <td></td> <td>%</td> <td></td> <td>43.Condo Site</td> </tr> <tr> <td></td> <td></td> <td></td> <td></td> <td>%</td> <td></td> <td>44.Lot Improvemen</td> </tr> <tr> <td></td> <td></td> <td></td> <td></td> <td>%</td> <td></td> <td>45.Subdivision Lo</td> </tr> <tr> <td></td> <td></td> <td></td> <td></td> <td>%</td> <td></td> <td>46.Heavy Ind Sit</td> </tr> </tbody> </table>					Front Foot	Type	Effective		Influence		Influence Codes	Frontage	Depth	Factor	Code	11.Regular Lot				%		1.Vacancy	12.Delta Triangle				%		2.Unimproved	13.Nabla Triangle				%		3.Topography	14.Rear Land				%		4.Size/Shape	15.Class I Road				%		5.Access					%		6.Restriction					%		7.Corner/Locatio					%		8.View/Environme					%		9.Fractional Sha					%		Acres					%		32.Pasture					%		33.Orchard					%		34.Softwood (FL)					%		35.Mixed Wood (FL)					%		36.Hardwood (FL)					%		37.Softwood (TG)					%		38.Mixed Wood (TG)					%		39.Hardwood (TG)					%		40.Wasteland					%		41.Open Space					%		42.Mobile Home Si					%		43.Condo Site					%		44.Lot Improvemen					%		45.Subdivision Lo					%		46.Heavy Ind Sit
Front Foot	Type	Effective								Influence		Influence Codes																																																																																																																																																																																					
		Frontage	Depth	Factor	Code																																																																																																																																																																																												
11.Regular Lot				%		1.Vacancy																																																																																																																																																																																											
12.Delta Triangle				%		2.Unimproved																																																																																																																																																																																											
13.Nabla Triangle				%		3.Topography																																																																																																																																																																																											
14.Rear Land				%		4.Size/Shape																																																																																																																																																																																											
15.Class I Road				%		5.Access																																																																																																																																																																																											
				%		6.Restriction																																																																																																																																																																																											
				%		7.Corner/Locatio																																																																																																																																																																																											
				%		8.View/Environme																																																																																																																																																																																											
				%		9.Fractional Sha																																																																																																																																																																																											
				%		Acres																																																																																																																																																																																											
				%		32.Pasture																																																																																																																																																																																											
				%		33.Orchard																																																																																																																																																																																											
				%		34.Softwood (FL)																																																																																																																																																																																											
				%		35.Mixed Wood (FL)																																																																																																																																																																																											
				%		36.Hardwood (FL)																																																																																																																																																																																											
				%		37.Softwood (TG)																																																																																																																																																																																											
				%		38.Mixed Wood (TG)																																																																																																																																																																																											
				%		39.Hardwood (TG)																																																																																																																																																																																											
				%		40.Wasteland																																																																																																																																																																																											
				%		41.Open Space																																																																																																																																																																																											
				%		42.Mobile Home Si																																																																																																																																																																																											
				%		43.Condo Site																																																																																																																																																																																											
				%		44.Lot Improvemen																																																																																																																																																																																											
				%		45.Subdivision Lo																																																																																																																																																																																											
				%		46.Heavy Ind Sit																																																																																																																																																																																											
Sale Date			Sale Data																																																																																																																																																																																														
Price			11.Regular Lot																																																																																																																																																																																														
Sale Type			12.Delta Triangle																																																																																																																																																																																														
1.Land 4.Mobile 7.C/I L&B			13.Nabla Triangle																																																																																																																																																																																														
2.L & B 5.Other 8.			14.Rear Land																																																																																																																																																																																														
3.Building 6.C/I Land 9.			15.Class I Road																																																																																																																																																																																														
Financing			Square Foot																																																																																																																																																																																														
1.Convent 4.Seller 7.			16.Class II Road																																																																																																																																																																																														
2.FHA/VA 5.Private 8.			17.Municipal Rese																																																																																																																																																																																														
3.Assumed 6.Cash 9.Unknown			18.Munic Sep Lago																																																																																																																																																																																														
Validity			19.Gravel Pit																																																																																																																																																																																														
1.Valid 4.Split 7.Renovate			20.Industrial Bas																																																																																																																																																																																														
2.Related 5.Partial 8.Other			Fract. Acre																																																																																																																																																																																														
3.Distress 6.Exempt 9.			21.Developed Pave																																																																																																																																																																																														
Verified			22.Undev Paved (F																																																																																																																																																																																														
1.Buyer 4.Agent 7.Family			23.Developed Grav																																																																																																																																																																																														
2.Seller 5.Pub Rec 8.Other			Acres																																																																																																																																																																																														
3.Lender 6.MLS 9.			24.Undev Gravel (
			26.Rear Land																																																																																																																																																																																														
			27.Backlot																																																																																																																																																																																														
			29.Pavement																																																																																																																																																																																														
			30.Utility R O W																																																																																																																																																																																														
			31.Tillable																																																																																																																																																																																														
			Total Acreage 137.00																																																																																																																																																																																														

Wade

Map Lot 003-003 & 004-2

Account 110

Location 228 South Wade Rd

Card 1 Of 1 9/06/2024

Building Style 0	SF Bsmt Living 0	Layout 0
1.CONVENTI 5.GARRISON 9.GAMBREL	Fin Bsmt Grade 0 0	1.TYPICAL 4. 7.
2.RANCH 6.SALT BOX 10.OTHER	DIRT FLOOR 0	2.INADEQUA 5. 8.
3.RAISED R 7.CONTEMP 11.SPLIT	Heat Type 100% 0	3.POOR 6. 9.
4.CAPE 8.LOG 12.NE	1.HWBB 5.FWA 9.NOT HEAT	Attic 0
Dwelling Units 0	2.HWCI 6.GRAVWA 10.	1.1/4 FINI 4.FULL FIN 7.
Other Units 0	3.HP 7.ELECTRIC 11.	2.1/2 FINI 5.FL / STA 8.
Stories 0	4.STEAM 8.FL/WALL 12.	3.3/4 FINI 6. 9.NONE
1.ONE STOR 4.1.5 STOR 7.1.25 STO	Cool Type 0% 9 NONE	Insulation 0
2.TWO STOR 5.1.75 STO 8.	1.REFRIG A 4.W&C AIR 7.	1.FULLY IN 4.MINIMAL 7.
3.THREE ST 6.2.5 STOR 9.	2.EVAPORAT 5. 8.	2.HEAVY 5.UNKNOWN 8.
Exterior Walls 0	3.HEAT PUM 6. 9.NONE	3.CAPPED O 6. 9.NONE
1.WOOD 5.STUCKO 9.T-111	Kitchen Style 0	Unfinished % 0%
2.VIN/AL 6.BRICK 10.OTHER	1.GOOD 4.OBSOLETE 7.	Grade & Factor 0 0%
3.COMPOS. 7.STONE 11.LOG	2.TYPICAL 5. 8.	1.E GRADE 4.B GRADE 7.
4.ASBESTOS 8.CONCRETE 12.	3.OLD STYL 6. 9.NONE	2.D GRADE 5.A GRADE 8.
Roof Surface 0	Bath(s) Style 0	3.C GRADE 6.AA GRADE 9.SAME
1.ASPHALT 4.COMPOSIT 7.	1.GOOD 4.OBSOLETE 7.	SQFT (Footprint) 0
2.SLATE 5.WOOD 8.	2.TYPICAL 5. 8.	Condition 0
3.METAL 6.OTHER 9.	3.OLD STYL 6. 9.NONE	1.POOR 4.AVERAGE 7.VERY GOO
SF Masonry Trim 0	# Rooms 0	2.FAIR 5.ABOVE AV 8.EXCELLEN
0	# Bedrooms 0	3.BELOW AV 6.GOOD 9.SAME
0	# Full Baths 0	Phys. % Good 0%
Year Built 0	# Half Baths 0	Funct. % Good 100%
Year Remodeled 0	# Addn Fixtures 0	Functional Code 9 None
Foundation 0	# Fireplaces 0	1.Incomp 4.LongTerm 7.Layout
1.CONCRETE 4.WOOD 7.		2.Overbuil 5.Utility 8.Other
2.CONCRETE 5.SLAB 8.		3.Delap 6.Style 9.None
3.BRICK/ST 6.PIERS 9.		Econ. % Good 100%
Basement 0		Economic Code NONE
1.1/4 BASE 4.FULL BAS 7.		0.None 3.NO ELECT 6.
2.1/2 BASE 5.CRAWL 8.		1.LOCATION 4.GENERATC 7.
3.3/4 BASE 6. 9.NO BASEM		2.ENCROACH 5. 8.OTHER
Bsmt Gar # Cars 0		Entrance Code 3 INFORMATION ONLY
Wet Basement 0		1.INTERIOR 4.UNOCCUPI 7.
1.DRY BASE 4. 7.		2.REFUSED 5.ESTIMATE 8.
2.DAMP BAS 5. 8.		3.INFO ONL 6. 9.
3.WET BASE 6. 9.NO BASEM		Information Code 4 AGENT
		1.OWNER 4.AGENT 7.
		2.RELATIVE 5.ESTIMATE 8.
		3.TENANT 6.OTHER 9.

Date Inspected 7/11/2022

Additions, Outbuildings & Improvements

Type	Year	Units	Grade	Cond	Phys.	Funct.	Sound Value
231	970				%	%	3,000
					%	%	
					%	%	
					%	%	
					%	%	
					%	%	
					%	%	
					%	%	
					%	%	
					%	%	
					%	%	

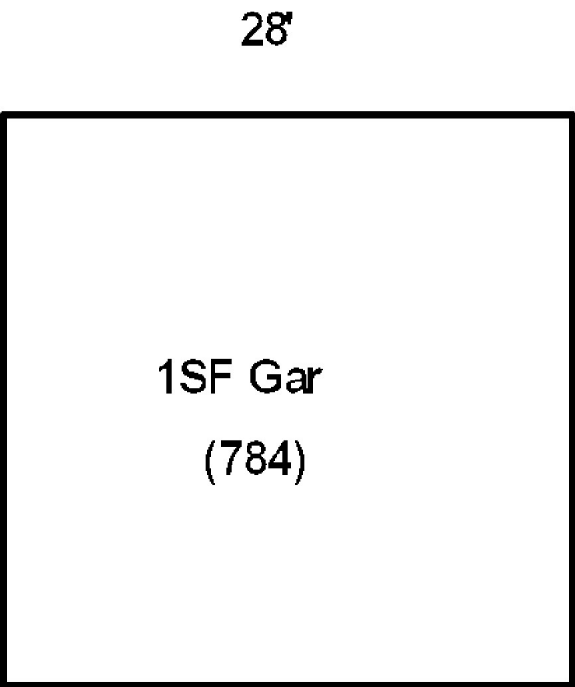

Hallowell, Larry
Hallowell, Wanita
131 Timoga Trail
St. Augustine FL 32084

B4049P48

Inspection Witnessed By:

No./Date	Description	Date Insp.
X		

Notes:

Wade

Property Data			Assessment Record																																																																																																																																																																																																					
Neighborhood 1 Rural			Year	Land	Buildings	Exempt	Total																																																																																																																																																																																																	
Tree Growth Year 0			2017	10,900	0	0	10,900																																																																																																																																																																																																	
X Coordinate			2018	10,900	0	0	10,900																																																																																																																																																																																																	
Y Coordinate			2020	10,900	0	0	10,900																																																																																																																																																																																																	
Zone/Land Use 1 Residential			2021	11,400	0	0	11,400																																																																																																																																																																																																	
Secondary Zone			2022	16,500	0	0	16,500																																																																																																																																																																																																	
Topography 2 Rolling			2023	16,500	0	0	16,500																																																																																																																																																																																																	
2024			2024	16,500	0	0	16,500																																																																																																																																																																																																	
1.Level 4.Below Stre 7.Steep 2.Rolling 5.Low 8.Rough 3.Above Stre 6.Swampy 9.																																																																																																																																																																																																								
Utilities 9 NoWater/NoSewer 1.Well+Septi 4.Public Wat 7.Cess Pool 2.Drilled We 5.Public Sew 8.Holding Ta 3.Septic Sys 6.Dug Well 9.NoW/NoSew																																																																																																																																																																																																								
Street 1 Paved 1.Paved 4.Proposed 7. 2.Semi-Impro 5.Private 8. 3.Gravel 6. 9.No Street																																																																																																																																																																																																								
LAND USE 0			<table border="1"> <thead> <tr> <th rowspan="2">Front Foot</th> <th rowspan="2">Type</th> <th colspan="2">Effective</th> <th colspan="2">Influence</th> <th rowspan="2">Influence Codes</th> </tr> <tr> <th>Frontage</th> <th>Depth</th> <th>Factor</th> <th>Code</th> </tr> </thead> <tbody> <tr><td>11.Regular Lot</td><td></td><td></td><td></td><td>%</td><td></td><td>1.Vacancy</td></tr> <tr><td>12.Delta Triangle</td><td></td><td></td><td></td><td>%</td><td></td><td>2.Unimproved</td></tr> <tr><td>13.Nabla Triangle</td><td></td><td></td><td></td><td>%</td><td></td><td>3.Topography</td></tr> <tr><td>14.Rear Land</td><td></td><td></td><td></td><td>%</td><td></td><td>4.Size/Shape</td></tr> <tr><td>15.Class I Road</td><td></td><td></td><td></td><td>%</td><td></td><td>5.Access</td></tr> <tr><td></td><td></td><td></td><td></td><td>%</td><td></td><td>6.Restriction</td></tr> <tr><td></td><td></td><td></td><td></td><td>%</td><td></td><td>7.Corner/Locatio</td></tr> <tr><td></td><td></td><td></td><td></td><td>%</td><td></td><td>8.View/Environme</td></tr> <tr><td></td><td></td><td></td><td></td><td>%</td><td></td><td>9.Fractional Sha</td></tr> <tr><td></td><td></td><td></td><td></td><td>%</td><td></td><td>Acres</td></tr> <tr><td></td><td></td><td></td><td></td><td>%</td><td></td><td>32.Pasture</td></tr> <tr><td></td><td></td><td></td><td></td><td>%</td><td></td><td>33.Orchard</td></tr> <tr><td></td><td></td><td></td><td></td><td>%</td><td></td><td>34.Softwood (FL)</td></tr> <tr><td></td><td></td><td></td><td></td><td>%</td><td></td><td>35.Mixed Wood (FL)</td></tr> <tr><td></td><td></td><td></td><td></td><td>%</td><td></td><td>36.Hardwood (FL)</td></tr> <tr><td></td><td></td><td></td><td></td><td>%</td><td></td><td>37.Softwood (TG)</td></tr> <tr><td></td><td></td><td></td><td></td><td>%</td><td></td><td>38.Mixed Wood (TG)</td></tr> <tr><td></td><td></td><td></td><td></td><td>%</td><td></td><td>39.Hardwood (TG)</td></tr> <tr><td></td><td></td><td></td><td></td><td>%</td><td></td><td>40.Wasteland</td></tr> <tr><td></td><td></td><td></td><td></td><td>%</td><td></td><td>41.Open Space</td></tr> <tr><td></td><td></td><td></td><td></td><td>%</td><td></td><td>42.Mobile Home Si</td></tr> <tr><td></td><td></td><td></td><td></td><td>%</td><td></td><td>43.Condo Site</td></tr> <tr><td></td><td></td><td></td><td></td><td>%</td><td></td><td>44.Lot Improvemen</td></tr> <tr><td></td><td></td><td></td><td></td><td>%</td><td></td><td>45.Subdivision Lo</td></tr> <tr><td></td><td></td><td></td><td></td><td>%</td><td></td><td>46.Heavy Ind Sit</td></tr> <tr> <td colspan="2">Total Acreage</td> <td colspan="2">12.00</td> <td colspan="3"></td> </tr> </tbody> </table>					Front Foot	Type	Effective		Influence		Influence Codes	Frontage	Depth	Factor	Code	11.Regular Lot				%		1.Vacancy	12.Delta Triangle				%		2.Unimproved	13.Nabla Triangle				%		3.Topography	14.Rear Land				%		4.Size/Shape	15.Class I Road				%		5.Access					%		6.Restriction					%		7.Corner/Locatio					%		8.View/Environme					%		9.Fractional Sha					%		Acres					%		32.Pasture					%		33.Orchard					%		34.Softwood (FL)					%		35.Mixed Wood (FL)					%		36.Hardwood (FL)					%		37.Softwood (TG)					%		38.Mixed Wood (TG)					%		39.Hardwood (TG)					%		40.Wasteland					%		41.Open Space					%		42.Mobile Home Si					%		43.Condo Site					%		44.Lot Improvemen					%		45.Subdivision Lo					%		46.Heavy Ind Sit	Total Acreage		12.00				
Front Foot	Type	Effective								Influence		Influence Codes																																																																																																																																																																																												
		Frontage	Depth	Factor	Code																																																																																																																																																																																																			
11.Regular Lot				%		1.Vacancy																																																																																																																																																																																																		
12.Delta Triangle				%		2.Unimproved																																																																																																																																																																																																		
13.Nabla Triangle				%		3.Topography																																																																																																																																																																																																		
14.Rear Land				%		4.Size/Shape																																																																																																																																																																																																		
15.Class I Road				%		5.Access																																																																																																																																																																																																		
				%		6.Restriction																																																																																																																																																																																																		
				%		7.Corner/Locatio																																																																																																																																																																																																		
				%		8.View/Environme																																																																																																																																																																																																		
				%		9.Fractional Sha																																																																																																																																																																																																		
				%		Acres																																																																																																																																																																																																		
				%		32.Pasture																																																																																																																																																																																																		
				%		33.Orchard																																																																																																																																																																																																		
				%		34.Softwood (FL)																																																																																																																																																																																																		
				%		35.Mixed Wood (FL)																																																																																																																																																																																																		
				%		36.Hardwood (FL)																																																																																																																																																																																																		
				%		37.Softwood (TG)																																																																																																																																																																																																		
				%		38.Mixed Wood (TG)																																																																																																																																																																																																		
				%		39.Hardwood (TG)																																																																																																																																																																																																		
				%		40.Wasteland																																																																																																																																																																																																		
				%		41.Open Space																																																																																																																																																																																																		
				%		42.Mobile Home Si																																																																																																																																																																																																		
				%		43.Condo Site																																																																																																																																																																																																		
				%		44.Lot Improvemen																																																																																																																																																																																																		
				%		45.Subdivision Lo																																																																																																																																																																																																		
				%		46.Heavy Ind Sit																																																																																																																																																																																																		
Total Acreage		12.00																																																																																																																																																																																																						
Sale Date			<table border="1"> <thead> <tr> <th rowspan="2">Fract. Acre</th> <th colspan="2">Acreage/Sites</th> <th colspan="2"></th> <th colspan="2"></th> </tr> <tr> <th></th> <th></th> <th></th> <th></th> <th></th> <th></th> </tr> </thead> <tbody> <tr><td>21.Developed Pave</td><td>22</td><td>1.00</td><td>100</td><td>%</td><td>0</td><td></td></tr> <tr><td>22.Undev Paved (F</td><td>26</td><td>8.00</td><td>100</td><td>%</td><td>0</td><td></td></tr> <tr><td>23.Developed Grav</td><td>32</td><td>3.00</td><td>100</td><td>%</td><td>0</td><td></td></tr> <tr><td>Acres</td><td></td><td></td><td></td><td>%</td><td></td><td></td></tr> <tr><td>24.Undev Gravel (</td><td></td><td></td><td></td><td>%</td><td></td><td></td></tr> <tr><td>26.Rear Land</td><td></td><td></td><td></td><td>%</td><td></td><td></td></tr> <tr><td>27.Backlot</td><td></td><td></td><td></td><td>%</td><td></td><td></td></tr> <tr><td>29.Pavement</td><td></td><td></td><td></td><td>%</td><td></td><td></td></tr> <tr><td>30.Utility R O W</td><td></td><td></td><td></td><td>%</td><td></td><td></td></tr> <tr><td>31.Tillable</td><td></td><td></td><td></td><td>%</td><td></td><td></td></tr> </tbody> </table>					Fract. Acre	Acreage/Sites												21.Developed Pave	22	1.00	100	%	0		22.Undev Paved (F	26	8.00	100	%	0		23.Developed Grav	32	3.00	100	%	0		Acres				%			24.Undev Gravel (%			26.Rear Land				%			27.Backlot				%			29.Pavement				%			30.Utility R O W				%			31.Tillable				%																																																																																																																
Fract. Acre	Acreage/Sites																																																																																																																																																																																																							
21.Developed Pave	22	1.00	100	%	0																																																																																																																																																																																																			
22.Undev Paved (F	26	8.00	100	%	0																																																																																																																																																																																																			
23.Developed Grav	32	3.00	100	%	0																																																																																																																																																																																																			
Acres				%																																																																																																																																																																																																				
24.Undev Gravel (%																																																																																																																																																																																																				
26.Rear Land				%																																																																																																																																																																																																				
27.Backlot				%																																																																																																																																																																																																				
29.Pavement				%																																																																																																																																																																																																				
30.Utility R O W				%																																																																																																																																																																																																				
31.Tillable				%																																																																																																																																																																																																				
Building Use 0																																																																																																																																																																																																								
Sale Type																																																																																																																																																																																																								
1.Land 4.Mobile 7.C/I L&B 2.L & B 5.Other 8. 3.Building 6.C/I Land 9.																																																																																																																																																																																																								
Financing																																																																																																																																																																																																								
1.Convent 4.Seller 7. 2.FHA/VA 5.Private 8. 3.Assumed 6.Cash 9.Unknown																																																																																																																																																																																																								
Validity																																																																																																																																																																																																								
1.Valid 4.Split 7.Renovate 2.Related 5.Partial 8.Other 3.Distress 6.Exempt 9.																																																																																																																																																																																																								
Verified																																																																																																																																																																																																								
1.Buyer 4.Agent 7.Family 2.Seller 5.Pub Rec 8.Other 3.Lender 6.MLS 9.																																																																																																																																																																																																								

Wade

Map Lot 003-004-1

Account 118

Location South Wade Rd

Card 1 Of 1 9/06/2024

Building Style 0	SF Bsmt Living 0	Layout 0
1.CONVENTI 5.GARRISON 9.GAMBREL	Fin Bsmt Grade 0 0	1.TYPICAL 4. 7.
2.RANCH 6.SALT BOX 10.OTHER	DIRT FLOOR 0	2.INADEQUA 5. 8.
3.RAISED R 7.CONTEMP 11.SPLIT	Heat Type 100% 0	3.POOR 6. 9.
4.CAPE 8.LOG 12.NE	1.HWBB 5.FWA 9.NOT HEAT	Attic 0
Dwelling Units 0	2.HWCI 6.GRAWWA 10.	1.1/4 FINI 4.FULL FIN 7.
Other Units 0	3.HP 7.ELECTRIC 11.	2.1/2 FINI 5.FL / STA 8.
Stories 0	4.STEAM 8.FL/WALL 12.	3.3/4 FINI 6. 9.NONE
1.ONE STOR 4.1.5 STOR 7.1.25 STO	Cool Type 0% 9 NONE	Insulation 0
2.TWO STOR 5.1.75 STO 8.	1.REFRIG A 4.W&C AIR 7.	1.FULLY IN 4.MINIMAL 7.
3.THREE ST 6.2.5 STOR 9.	2.EVAPORAT 5. 8.	2.HEAVY 5.UNKNOWN 8.
Exterior Walls 0	3.HEAT PUM 6. 9.NONE	3.CAPPED O 6. 9.NONE
1.WOOD 5.STUCKO 9.T-111	Kitchen Style 0	Unfinished % 0%
2.VIN/AL 6.BRICK 10.OTHER	1.GOOD 4.OBSOLETE 7.	Grade & Factor 0 0%
3.COMPOS. 7.STONE 11.LOG	2.TYPICAL 5. 8.	1.E GRADE 4.B GRADE 7.
4.ASBESTOS 8.CONCRETE 12.	3.OLD STYL 6. 9.NONE	2.D GRADE 5.A GRADE 8.
Roof Surface 0	Bath(s) Style 0	3.C GRADE 6.AA GRADE 9.SAME
1.ASPHALT 4.COMPOSIT 7.	1.GOOD 4.OBSOLETE 7.	SQFT (Footprint) 0
2.SLATE 5.WOOD 8.	2.TYPICAL 5. 8.	Condition 0
3.METAL 6.OTHER 9.	3.OLD STYL 6. 9.NONE	1.POOR 4.AVERAGE 7.VERY GOO
SF Masonry Trim 0	# Rooms 0	2.FAIR 5.ABOVE AV 8.EXCELLEN
0	# Bedrooms 0	3.BELOW AV 6.GOOD 9.SAME
0	# Full Baths 0	Phys. % Good 0%
Year Built 0	# Half Baths 0	Funct. % Good 100%
Year Remodeled 0	# Addn Fixtures 0	Functional Code 9 None
Foundation 0	# Fireplaces 0	1.Incomp 4.LongTerm 7.Layout
1.CONCRETE 4.WOOD 7.		2.Overbuil 5.Utility 8.Other
2.CONCRETE 5.SLAB 8.		3.Delap 6.Style 9.None
3.BRICK/ST 6.PIERS 9.		Econ. % Good 100%
Basement 0		Economic Code NONE
1.1/4 BASE 4.FULL BAS 7.		0.None 3.NO ELECT 6.
2.1/2 BASE 5.CRAWL 8.		1.LOCATION 4.GENERATC 7.
3.3/4 BASE 6. 9.NO BASEM		2.ENCROACH 5. 8.OTHER
Bsmt Gar # Cars 0		Entrance Code 5 ESTIMATED
Wet Basement 0		1.INTERIOR 4.UNOCCUPI 7.
1.DRY BASE 4. 7.		2.REFUSED 5.ESTIMATE 8.
2.DAMP BAS 5. 8.		3.INFO ONL 6. 9.
3.WET BASE 6. 9.NO BASEM		Information Code 5 ESTIMATE
		1.OWNER 4.AGENT 7.
		2.RELATIVE 5.ESTIMATE 8.
		3.TENANT 6.OTHER 9.



Date Inspected 7/14/2022

Additions, Outbuildings & Improvements								
Type	Year	Units	Grade	Cond	Phys.	Funct.	Sound Value	
					%	%		1.One Story Fram
					%	%		2.Two Story Fram
					%	%		3.Three Story Fr
					%	%		4.1 & 1/2 Story
					%	%		5.1 & 3/4 Story
					%	%		6.2 & 1/2 Story
					%	%		21.Open Porch
					%	%		22.Enclosed Porch
					%	%		23.Frame Garage
					%	%		24.Frame Shed
					%	%		25.1SF Bay Window
					%	%		26.1SF Over Hang
					%	%		27.Unfinished Bas
					%	%		28.Unfinished Att
					%	%		29.Finished Basem

CUNNINGHAM, KEVIN R
2630 SE 75 AVE
PORTLAND OR 97206

B1607P216 B5820P44 B5842P88

Previous Owner
Cunningham, Sheldon & Sandi
c/o Sheldon & Sandi Cunningham
287 South Wade Road
Wade ME 04786
Sale Date: 9/11/2018

Inspection Witnessed By:

X	Date	Description	Date Insp.

Notes:
* 1SF Gar (2100): -15% functional due to size
obsolescence.

Wade

Property Data			Assessment Record					
Neighborhood 1 Rural			Year	Land	Buildings	Exempt	Total	
Tree Growth Year 0			2017	21,900	93,300	0	115,200	
X Coordinate			2018	21,900	93,300	20,000	95,200	
Y Coordinate			2020	21,900	93,300	25,000	90,200	
Zone/Land Use 1 Residential			2021	22,900	93,300	25,000	91,200	
Secondary Zone			2022	34,800	138,800	25,000	148,600	
Topography 2 Rolling			2023	35,000	138,800	25,000	148,800	
2024			2024	35,000	138,800	25,000	148,800	
1.Level 4.Below Stre 7.Steep 2.Rolling 5.Low 8.Rough 3.Above Stre 6.Swampy 9.								
Utilities 1 Drilled Well / Septic								
1.Well+Septi 4.Public Wat 7.Cess Pool 2.Drilled We 5.Public Sew 8.Holding Ta 3.Septic Sys 6.Dug Well 9.NoW/NoSew								
Street 1 Paved								
1.Paved 4.Proposed 7. 2.Semi-Impro 5.Private 8. 3.Gravel 6. 9.No Street								
LAND USE 0			Land Data					
Building Use 0			Front Foot	Type	Effective		Influence	
Sale Data			11.Regular Lot		Frontage	Depth	Factor	Code
			12.Delta Triangle					
Sale Date 9/11/2018			13.Nabla Triangle				%	
Price 116,000			14.Rear Land				%	
Sale Type 2 Land & Building			15.Class I Road				%	
1.Land 4.Mobile 7.C/I L&B							%	
2.L & B 5.Other 8.			Square Foot		Square Feet			
3.Building 6.C/I Land 9.			16.Class II Road				%	
Financing 1 Conventional			17.Municipal Rese				%	
1.Convent 4.Seller 7.			18.Munic Sep Lago				%	
2.FHA/VA 5.Private 8.			19.Gravel Pit				%	
3.Assumed 6.Cash 9.Unknown			20.Industrial Bas				%	
Validity 2 Related Parties			Fract. Acre		Acreage/Sites			
1.Valid 4.Split 7.Renovate			21.Developed Pave	21		1.00	100 %	0
2.Related 5.Partial 8.Other			22.Undev Paved (F	26		15.00	100 %	0
3.Distress 6.Exempt 9.			23.Developed Grav	32		6.00	100 %	0
Verified 1 Buyer			Acres	39		12.00	100 %	0
1.Buyer 4.Agent 7.Family			24.Undev Gravel (%	
2.Seller 5.Pub Rec 8.Other			26.Rear Land				%	
3.Lender 6.MLS 9.			27.Backlot				%	
			29.Pavement				%	
			30.Utility R O W				%	
			31.Tillable				%	
			Total Acreage		34.00			

- 1.Vacancy
- 2.Unimproved
- 3.Topography
- 4.Size/Shape
- 5.Access
- 6.Restriction
- 7.Corner/Locatio
- 8.View/Environme
- 9.Fractional Sha
- Acres**
- 32.Pasture
- 33.Orchard
- 34.Softwood (FL)
- 35.Mixed Wood (FL)
- 36.Hardwood (FL)
- 37.Softwood (TG)
- 38.Mixed Wood (TG)
- 39.Hardwood (TG)
- 40.Wasteland
- 41.Open Space
- 42.Mobile Home Si
- 43.Condo Site
- 44.Lot Improvemen
- 45.Subdivision Lo
- 46.Heavy Ind Sit

Klei, Hugh T
76 Turnpike Road
Willington CT 06279

B4894P218 B5748P239

Previous Owner
Klei Trust, Irene
Herbert E. Klei, Trustee
76 Turnpike Road
Willington CT 06279
Sale Date: 12/28/2017

Inspection Witnessed By:

X	Date	Description	Date Insp.

Notes:

Wade

Property Data			Assessment Record																																																																																																																																																																																														
Neighborhood 1 Rural			Year	Land	Buildings	Exempt	Total																																																																																																																																																																																										
Tree Growth Year 0			2017	24,300	71,900	0	96,200																																																																																																																																																																																										
X Coordinate			2018	24,100	71,900	0	96,000																																																																																																																																																																																										
Y Coordinate			2020	23,200	71,900	0	95,100																																																																																																																																																																																										
Zone/Land Use 1 Residential			2021	23,300	71,900	0	95,200																																																																																																																																																																																										
Secondary Zone			2022	36,100	74,200	0	110,300																																																																																																																																																																																										
Topography 2 Rolling			2023	36,400	74,200	0	110,600																																																																																																																																																																																										
			2024	36,500	74,200	0	110,700																																																																																																																																																																																										
1.Level 4.Below Stre 7.Steep 2.Rolling 5.Low 8.Rough 3.Above Stre 6.Swampy 9.																																																																																																																																																																																																	
Utilities 1 Drilled Well / Septic																																																																																																																																																																																																	
1.Well+Septi 4.Public Wat 7.Cess Pool 2.Drilled We 5.Public Sew 8.Holding Ta 3.Septic Sys 6.Dug Well 9.NoW/NoSew																																																																																																																																																																																																	
Street 1 Paved																																																																																																																																																																																																	
1.Paved 4.Proposed 7. 2.Semi-Impro 5.Private 8. 3.Gravel 6. 9.No Street																																																																																																																																																																																																	
LAND USE 0			<table border="1"> <thead> <tr> <th rowspan="2">Front Foot</th> <th rowspan="2">Type</th> <th colspan="2">Effective</th> <th colspan="2">Influence</th> <th rowspan="2">Influence Codes</th> </tr> <tr> <th>Frontage</th> <th>Depth</th> <th>Factor</th> <th>Code</th> </tr> </thead> <tbody> <tr> <td>11.Regular Lot</td> <td></td> <td></td> <td></td> <td>%</td> <td></td> <td>1.Vacancy</td> </tr> <tr> <td>12.Delta Triangle</td> <td></td> <td></td> <td></td> <td>%</td> <td></td> <td>2.Unimproved</td> </tr> <tr> <td>13.Nabla Triangle</td> <td></td> <td></td> <td></td> <td>%</td> <td></td> <td>3.Topography</td> </tr> <tr> <td>14.Rear Land</td> <td></td> <td></td> <td></td> <td>%</td> <td></td> <td>4.Size/Shape</td> </tr> <tr> <td>15.Class I Road</td> <td></td> <td></td> <td></td> <td>%</td> <td></td> <td>5.Access</td> </tr> <tr> <td></td> <td></td> <td></td> <td></td> <td>%</td> <td></td> <td>6.Restriction</td> </tr> <tr> <td></td> <td></td> <td></td> <td></td> <td>%</td> <td></td> <td>7.Corner/Locatio</td> </tr> <tr> <td></td> <td></td> <td></td> <td></td> <td>%</td> <td></td> <td>8.View/Environme</td> </tr> <tr> <td></td> <td></td> <td></td> <td></td> <td>%</td> <td></td> <td>9.Fractional Sha</td> </tr> <tr> <td></td> <td></td> <td></td> <td></td> <td>%</td> <td></td> <td>Acres</td> </tr> <tr> <td></td> <td></td> <td></td> <td></td> <td>%</td> <td></td> <td>32.Pasture</td> </tr> <tr> <td></td> <td></td> <td></td> <td></td> <td>%</td> <td></td> <td>33.Orchard</td> </tr> <tr> <td></td> <td></td> <td></td> <td></td> <td>%</td> <td></td> <td>34.Softwood (FL)</td> </tr> <tr> <td></td> <td></td> <td></td> <td></td> <td>%</td> <td></td> <td>35.Mixed Wood (FL)</td> </tr> <tr> <td></td> <td></td> <td></td> <td></td> <td>%</td> <td></td> <td>36.Hardwood (FL)</td> </tr> <tr> <td></td> <td></td> <td></td> <td></td> <td>%</td> <td></td> <td>37.Softwood (TG)</td> </tr> <tr> <td></td> <td></td> <td></td> <td></td> <td>%</td> <td></td> <td>38.Mixed Wood (TG)</td> </tr> <tr> <td></td> <td></td> <td></td> <td></td> <td>%</td> <td></td> <td>39.Hardwood (TG)</td> </tr> <tr> <td></td> <td></td> <td></td> <td></td> <td>%</td> <td></td> <td>40.Wasteland</td> </tr> <tr> <td></td> <td></td> <td></td> <td></td> <td>%</td> <td></td> <td>41.Open Space</td> </tr> <tr> <td></td> <td></td> <td></td> <td></td> <td>%</td> <td></td> <td>42.Mobile Home Si</td> </tr> <tr> <td></td> <td></td> <td></td> <td></td> <td>%</td> <td></td> <td>43.Condo Site</td> </tr> <tr> <td></td> <td></td> <td></td> <td></td> <td>%</td> <td></td> <td>44.Lot Improvemen</td> </tr> <tr> <td></td> <td></td> <td></td> <td></td> <td>%</td> <td></td> <td>45.Subdivision Lo</td> </tr> <tr> <td></td> <td></td> <td></td> <td></td> <td>%</td> <td></td> <td>46.Heavy Ind Sit</td> </tr> </tbody> </table>					Front Foot	Type	Effective		Influence		Influence Codes	Frontage	Depth	Factor	Code	11.Regular Lot				%		1.Vacancy	12.Delta Triangle				%		2.Unimproved	13.Nabla Triangle				%		3.Topography	14.Rear Land				%		4.Size/Shape	15.Class I Road				%		5.Access					%		6.Restriction					%		7.Corner/Locatio					%		8.View/Environme					%		9.Fractional Sha					%		Acres					%		32.Pasture					%		33.Orchard					%		34.Softwood (FL)					%		35.Mixed Wood (FL)					%		36.Hardwood (FL)					%		37.Softwood (TG)					%		38.Mixed Wood (TG)					%		39.Hardwood (TG)					%		40.Wasteland					%		41.Open Space					%		42.Mobile Home Si					%		43.Condo Site					%		44.Lot Improvemen					%		45.Subdivision Lo					%		46.Heavy Ind Sit
Front Foot	Type	Effective								Influence		Influence Codes																																																																																																																																																																																					
		Frontage	Depth	Factor	Code																																																																																																																																																																																												
11.Regular Lot				%		1.Vacancy																																																																																																																																																																																											
12.Delta Triangle				%		2.Unimproved																																																																																																																																																																																											
13.Nabla Triangle				%		3.Topography																																																																																																																																																																																											
14.Rear Land				%		4.Size/Shape																																																																																																																																																																																											
15.Class I Road				%		5.Access																																																																																																																																																																																											
				%		6.Restriction																																																																																																																																																																																											
				%		7.Corner/Locatio																																																																																																																																																																																											
				%		8.View/Environme																																																																																																																																																																																											
				%		9.Fractional Sha																																																																																																																																																																																											
				%		Acres																																																																																																																																																																																											
				%		32.Pasture																																																																																																																																																																																											
				%		33.Orchard																																																																																																																																																																																											
				%		34.Softwood (FL)																																																																																																																																																																																											
				%		35.Mixed Wood (FL)																																																																																																																																																																																											
				%		36.Hardwood (FL)																																																																																																																																																																																											
				%		37.Softwood (TG)																																																																																																																																																																																											
				%		38.Mixed Wood (TG)																																																																																																																																																																																											
				%		39.Hardwood (TG)																																																																																																																																																																																											
				%		40.Wasteland																																																																																																																																																																																											
				%		41.Open Space																																																																																																																																																																																											
				%		42.Mobile Home Si																																																																																																																																																																																											
				%		43.Condo Site																																																																																																																																																																																											
				%		44.Lot Improvemen																																																																																																																																																																																											
				%		45.Subdivision Lo																																																																																																																																																																																											
				%		46.Heavy Ind Sit																																																																																																																																																																																											
Sale Date 12/28/2017			Land Data																																																																																																																																																																																														
Price			Front Foot		Square Foot																																																																																																																																																																																												
Sale Type 1 Land Only			11.Regular Lot		29																																																																																																																																																																																												
1.Land 4.Mobile 7.C/I L&B			12.Delta Triangle		3,159																																																																																																																																																																																												
2.L & B 5.Other 8.			13.Nabla Triangle		75																																																																																																																																																																																												
3.Building 6.C/I Land 9.			14.Rear Land		%		2																																																																																																																																																																																										
Financing 9 Unknown			15.Class I Road		%																																																																																																																																																																																												
1.Convent 4.Seller 7.					%																																																																																																																																																																																												
2.FHA/VA 5.Private 8.					%																																																																																																																																																																																												
3.Assumed 6.Cash 9.Unknown					%																																																																																																																																																																																												
Validity 2 Related Parties					%																																																																																																																																																																																												
1.Valid 4.Split 7.Renovate					%																																																																																																																																																																																												
2.Related 5.Partial 8.Other					%																																																																																																																																																																																												
3.Distress 6.Exempt 9.					%																																																																																																																																																																																												
Verified 7 Family Member					%																																																																																																																																																																																												
1.Buyer 4.Agent 7.Family					%																																																																																																																																																																																												
2.Seller 5.Pub Rec 8.Other					%																																																																																																																																																																																												
3.Lender 6.MLS 9.					%																																																																																																																																																																																												
			Fract. Acre		Acres/Sites																																																																																																																																																																																												
			21.Developed Pave		21																																																																																																																																																																																												
			22.Undev Paved (F		1.00		0																																																																																																																																																																																										
			23.Developed Grav		26		0																																																																																																																																																																																										
			Acres		40		0																																																																																																																																																																																										
			24.Undev Gravel (2.30		0																																																																																																																																																																																										
			26.Rear Land		44.50		0																																																																																																																																																																																										
			27.Backlot		4.10		0																																																																																																																																																																																										
			29.Pavement		7.50		0																																																																																																																																																																																										
			30.Utility R O W																																																																																																																																																																																														
			31.Tillable																																																																																																																																																																																														
			Total Acreage		60.70																																																																																																																																																																																												

Klei, Herbert E
76 Turnpike Rd
Willington CT 06279

B2166P37

Previous Owner
Klei, Jr., Herbert E.
& Irene Klei Trust
76 Turnpike Road
Willington CT 06279
Sale Date: 2/12/2018

Inspection Witnessed By:

X	Date	Description	Date Insp.

Notes:

Wade

Property Data			Assessment Record																																																																																																																																																																																																						
Neighborhood 1 Rural			Year	Land	Buildings	Exempt	Total																																																																																																																																																																																																		
Tree Growth Year 0			2017	22,900	28,500	0	51,400																																																																																																																																																																																																		
X Coordinate			2018	22,700	28,500	0	51,200																																																																																																																																																																																																		
Y Coordinate			2020	20,800	28,500	0	49,300																																																																																																																																																																																																		
Zone/Land Use 1 Residential			2021	20,800	28,500	0	49,300																																																																																																																																																																																																		
Secondary Zone			2022	29,300	36,800	0	66,100																																																																																																																																																																																																		
Topography 2 Rolling			2023	29,600	36,800	0	66,400																																																																																																																																																																																																		
			2024	29,800	36,800	0	66,600																																																																																																																																																																																																		
1.Level 4.Below Stre 7.Steep 2.Rolling 5.Low 8.Rough 3.Above Stre 6.Swampy 9.																																																																																																																																																																																																									
Utilities 1 Drilled Well / Septic																																																																																																																																																																																																									
1.Well+Septi 4.Public Wat 7.Cess Pool 2.Drilled We 5.Public Sew 8.Holding Ta 3.Septic Sys 6.Dug Well 9.NoW/NoSew																																																																																																																																																																																																									
Street 1 Paved																																																																																																																																																																																																									
1.Paved 4.Proposed 7. 2.Semi-Impro 5.Private 8. 3.Gravel 6. 9.No Street																																																																																																																																																																																																									
LAND USE 0			<table border="1"> <thead> <tr> <th rowspan="2">Front Foot</th> <th rowspan="2">Type</th> <th colspan="2">Effective</th> <th colspan="2">Influence</th> <th rowspan="2">Influence Codes</th> </tr> <tr> <th>Frontage</th> <th>Depth</th> <th>Factor</th> <th>Code</th> </tr> </thead> <tbody> <tr> <td>11.Regular Lot</td> <td></td> <td></td> <td></td> <td>%</td> <td></td> <td>1.Vacancy</td> </tr> <tr> <td>12.Delta Triangle</td> <td></td> <td></td> <td></td> <td>%</td> <td></td> <td>2.Unimproved</td> </tr> <tr> <td>13.Nabla Triangle</td> <td></td> <td></td> <td></td> <td>%</td> <td></td> <td>3.Topography</td> </tr> <tr> <td>14.Rear Land</td> <td></td> <td></td> <td></td> <td>%</td> <td></td> <td>4.Size/Shape</td> </tr> <tr> <td>15.Class I Road</td> <td></td> <td></td> <td></td> <td>%</td> <td></td> <td>5.Access</td> </tr> <tr> <td></td> <td></td> <td></td> <td></td> <td>%</td> <td></td> <td>6.Restriction</td> </tr> <tr> <td></td> <td></td> <td></td> <td></td> <td>%</td> <td></td> <td>7.Corner/Locatio</td> </tr> <tr> <td></td> <td></td> <td></td> <td></td> <td>%</td> <td></td> <td>8.View/Environme</td> </tr> <tr> <td></td> <td></td> <td></td> <td></td> <td>%</td> <td></td> <td>9.Fractional Sha</td> </tr> <tr> <td></td> <td></td> <td></td> <td></td> <td>%</td> <td></td> <td>Acres</td> </tr> <tr> <td></td> <td></td> <td></td> <td></td> <td>%</td> <td></td> <td>32.Pasture</td> </tr> <tr> <td></td> <td></td> <td></td> <td></td> <td>%</td> <td></td> <td>33.Orchard</td> </tr> <tr> <td></td> <td></td> <td></td> <td></td> <td>%</td> <td></td> <td>34.Softwood (FL)</td> </tr> <tr> <td></td> <td></td> <td></td> <td></td> <td>%</td> <td></td> <td>35.Mixed Wood (FL)</td> </tr> <tr> <td></td> <td></td> <td></td> <td></td> <td>%</td> <td></td> <td>36.Hardwood (FL)</td> </tr> <tr> <td></td> <td></td> <td></td> <td></td> <td>%</td> <td></td> <td>37.Softwood (TG)</td> </tr> <tr> <td></td> <td></td> <td></td> <td></td> <td>%</td> <td></td> <td>38.Mixed Wood (TG)</td> </tr> <tr> <td></td> <td></td> <td></td> <td></td> <td>%</td> <td></td> <td>39.Hardwood (TG)</td> </tr> <tr> <td></td> <td></td> <td></td> <td></td> <td>%</td> <td></td> <td>40.Wasteland</td> </tr> <tr> <td></td> <td></td> <td></td> <td></td> <td>%</td> <td></td> <td>41.Open Space</td> </tr> <tr> <td></td> <td></td> <td></td> <td></td> <td>%</td> <td></td> <td>42.Mobile Home Si</td> </tr> <tr> <td></td> <td></td> <td></td> <td></td> <td>%</td> <td></td> <td>43.Condo Site</td> </tr> <tr> <td></td> <td></td> <td></td> <td></td> <td>%</td> <td></td> <td>44.Lot Improvemen</td> </tr> <tr> <td></td> <td></td> <td></td> <td></td> <td>%</td> <td></td> <td>45.Subdivision Lo</td> </tr> <tr> <td></td> <td></td> <td></td> <td></td> <td>%</td> <td></td> <td>46.Heavy Ind Sit</td> </tr> <tr> <td colspan="2"></td> <td></td> <td colspan="2">Total Acreage</td> <td colspan="2">58.00</td> <td></td> </tr> </tbody> </table>					Front Foot	Type	Effective		Influence		Influence Codes	Frontage	Depth	Factor	Code	11.Regular Lot				%		1.Vacancy	12.Delta Triangle				%		2.Unimproved	13.Nabla Triangle				%		3.Topography	14.Rear Land				%		4.Size/Shape	15.Class I Road				%		5.Access					%		6.Restriction					%		7.Corner/Locatio					%		8.View/Environme					%		9.Fractional Sha					%		Acres					%		32.Pasture					%		33.Orchard					%		34.Softwood (FL)					%		35.Mixed Wood (FL)					%		36.Hardwood (FL)					%		37.Softwood (TG)					%		38.Mixed Wood (TG)					%		39.Hardwood (TG)					%		40.Wasteland					%		41.Open Space					%		42.Mobile Home Si					%		43.Condo Site					%		44.Lot Improvemen					%		45.Subdivision Lo					%		46.Heavy Ind Sit				Total Acreage		58.00		
Front Foot	Type	Effective								Influence		Influence Codes																																																																																																																																																																																													
		Frontage	Depth	Factor	Code																																																																																																																																																																																																				
11.Regular Lot				%		1.Vacancy																																																																																																																																																																																																			
12.Delta Triangle				%		2.Unimproved																																																																																																																																																																																																			
13.Nabla Triangle				%		3.Topography																																																																																																																																																																																																			
14.Rear Land				%		4.Size/Shape																																																																																																																																																																																																			
15.Class I Road				%		5.Access																																																																																																																																																																																																			
				%		6.Restriction																																																																																																																																																																																																			
				%		7.Corner/Locatio																																																																																																																																																																																																			
				%		8.View/Environme																																																																																																																																																																																																			
				%		9.Fractional Sha																																																																																																																																																																																																			
				%		Acres																																																																																																																																																																																																			
				%		32.Pasture																																																																																																																																																																																																			
				%		33.Orchard																																																																																																																																																																																																			
				%		34.Softwood (FL)																																																																																																																																																																																																			
				%		35.Mixed Wood (FL)																																																																																																																																																																																																			
				%		36.Hardwood (FL)																																																																																																																																																																																																			
				%		37.Softwood (TG)																																																																																																																																																																																																			
				%		38.Mixed Wood (TG)																																																																																																																																																																																																			
				%		39.Hardwood (TG)																																																																																																																																																																																																			
				%		40.Wasteland																																																																																																																																																																																																			
				%		41.Open Space																																																																																																																																																																																																			
				%		42.Mobile Home Si																																																																																																																																																																																																			
				%		43.Condo Site																																																																																																																																																																																																			
				%		44.Lot Improvemen																																																																																																																																																																																																			
				%		45.Subdivision Lo																																																																																																																																																																																																			
				%		46.Heavy Ind Sit																																																																																																																																																																																																			
			Total Acreage		58.00																																																																																																																																																																																																				
Sale Date 2/12/2018			<table border="1"> <thead> <tr> <th>Fract. Acre</th> <th colspan="2">Acreage/Sites</th> <th colspan="2"></th> <th colspan="2"></th> </tr> </thead> <tbody> <tr> <td>21.Developed Pave</td> <td>21</td> <td>1.00</td> <td>100</td> <td>%</td> <td>0</td> <td></td> </tr> <tr> <td>22.Undev Paved (F</td> <td>37</td> <td>10.20</td> <td>100</td> <td>%</td> <td>0</td> <td></td> </tr> <tr> <td>23.Developed Grav</td> <td>38</td> <td>41.10</td> <td>100</td> <td>%</td> <td>0</td> <td></td> </tr> <tr> <td>Acres</td> <td>39</td> <td>5.70</td> <td>100</td> <td>%</td> <td>0</td> <td></td> </tr> <tr> <td>24.Undev Gravel (</td> <td></td> <td></td> <td></td> <td>%</td> <td></td> <td></td> </tr> <tr> <td>26.Rear Land</td> <td></td> <td></td> <td></td> <td>%</td> <td></td> <td></td> </tr> <tr> <td>27.Backlot</td> <td></td> <td></td> <td></td> <td>%</td> <td></td> <td></td> </tr> <tr> <td>29.Pavement</td> <td></td> <td></td> <td></td> <td>%</td> <td></td> <td></td> </tr> <tr> <td>30.Utility R O W</td> <td></td> <td></td> <td></td> <td>%</td> <td></td> <td></td> </tr> <tr> <td>31.Tillable</td> <td></td> <td></td> <td></td> <td>%</td> <td></td> <td></td> </tr> </tbody> </table>					Fract. Acre	Acreage/Sites						21.Developed Pave	21	1.00	100	%	0		22.Undev Paved (F	37	10.20	100	%	0		23.Developed Grav	38	41.10	100	%	0		Acres	39	5.70	100	%	0		24.Undev Gravel (%			26.Rear Land				%			27.Backlot				%			29.Pavement				%			30.Utility R O W				%			31.Tillable				%																																																																																																																							
Fract. Acre	Acreage/Sites																																																																																																																																																																																																								
21.Developed Pave	21	1.00	100	%	0																																																																																																																																																																																																				
22.Undev Paved (F	37	10.20	100	%	0																																																																																																																																																																																																				
23.Developed Grav	38	41.10	100	%	0																																																																																																																																																																																																				
Acres	39	5.70	100	%	0																																																																																																																																																																																																				
24.Undev Gravel (%																																																																																																																																																																																																					
26.Rear Land				%																																																																																																																																																																																																					
27.Backlot				%																																																																																																																																																																																																					
29.Pavement				%																																																																																																																																																																																																					
30.Utility R O W				%																																																																																																																																																																																																					
31.Tillable				%																																																																																																																																																																																																					
Validity 2 Related Parties																																																																																																																																																																																																									
1.Valid 4.Split 7.Renovate 2.Related 5.Partial 8.Other 3.Distress 6.Exempt 9.																																																																																																																																																																																																									
Verified 7 Family Member																																																																																																																																																																																																									
1.Buyer 4.Agent 7.Family 2.Seller 5.Pub Rec 8.Other 3.Lender 6.MLS 9.																																																																																																																																																																																																									

Klei, Howard W
76 Turnpike Road
Wilmington CT 06279

B5140P192

Inspection Witnessed By:

No./Date	Description	Date Insp.
X		

Notes:

Wade

Property Data			Assessment Record																																																																																																																																																																																																					
Neighborhood 1 Rural			Year	Land	Buildings	Exempt	Total																																																																																																																																																																																																	
Tree Growth Year 0			2017	49,400	0	0	49,400																																																																																																																																																																																																	
X Coordinate			2018	48,800	0	0	48,800																																																																																																																																																																																																	
Y Coordinate			2020	30,100	0	0	30,100																																																																																																																																																																																																	
Zone/Land Use 1 Residential			2021	27,300	0	0	27,300																																																																																																																																																																																																	
Secondary Zone			2022	31,400	0	0	31,400																																																																																																																																																																																																	
Topography 2 Rolling			2023	32,100	0	0	32,100																																																																																																																																																																																																	
1.Level 4.Below Stre 7.Steep 2.Rolling 5.Low 8.Rough 3.Above Stre 6.Swampy 9.			2024	32,600	0	0	32,600																																																																																																																																																																																																	
Utilities 9 NoWater/NoSewer 1.Well+Septi 4.Public Wat 7.Cess Pool 2.Drilled We 5.Public Sew 8.Holding Ta 3.Septic Sys 6.Dug Well 9.NoW/NoSew																																																																																																																																																																																																								
Street 1 Paved 1.Paved 4.Proposed 7. 2.Semi-Impro 5.Private 8. 3.Gravel 6. 9.No Street																																																																																																																																																																																																								
LAND USE 0			<table border="1"> <thead> <tr> <th rowspan="2">Front Foot</th> <th rowspan="2">Type</th> <th colspan="2">Effective</th> <th colspan="2">Influence</th> <th rowspan="2">Influence Codes</th> </tr> <tr> <th>Frontage</th> <th>Depth</th> <th>Factor</th> <th>Code</th> </tr> </thead> <tbody> <tr><td>11.Regular Lot</td><td></td><td></td><td></td><td>%</td><td></td><td>1.Vacancy</td></tr> <tr><td>12.Delta Triangle</td><td></td><td></td><td></td><td>%</td><td></td><td>2.Unimproved</td></tr> <tr><td>13.Nabla Triangle</td><td></td><td></td><td></td><td>%</td><td></td><td>3.Topography</td></tr> <tr><td>14.Rear Land</td><td></td><td></td><td></td><td>%</td><td></td><td>4.Size/Shape</td></tr> <tr><td>15.Class I Road</td><td></td><td></td><td></td><td>%</td><td></td><td>5.Access</td></tr> <tr><td></td><td></td><td></td><td></td><td>%</td><td></td><td>6.Restriction</td></tr> <tr><td></td><td></td><td></td><td></td><td>%</td><td></td><td>7.Corner/Locatio</td></tr> <tr><td></td><td></td><td></td><td></td><td>%</td><td></td><td>8.View/Environme</td></tr> <tr><td></td><td></td><td></td><td></td><td>%</td><td></td><td>9.Fractional Sha</td></tr> <tr><td></td><td></td><td></td><td></td><td>%</td><td></td><td>Acres</td></tr> <tr><td></td><td></td><td></td><td></td><td>%</td><td></td><td>32.Pasture</td></tr> <tr><td></td><td></td><td></td><td></td><td>%</td><td></td><td>33.Orchard</td></tr> <tr><td></td><td></td><td></td><td></td><td>%</td><td></td><td>34.Softwood (FL)</td></tr> <tr><td></td><td></td><td></td><td></td><td>%</td><td></td><td>35.Mixed Wood (FL)</td></tr> <tr><td></td><td></td><td></td><td></td><td>%</td><td></td><td>36.Hardwood (FL)</td></tr> <tr><td></td><td></td><td></td><td></td><td>%</td><td></td><td>37.Softwood (TG)</td></tr> <tr><td></td><td></td><td></td><td></td><td>%</td><td></td><td>38.Mixed Wood (TG)</td></tr> <tr><td></td><td></td><td></td><td></td><td>%</td><td></td><td>39.Hardwood (TG)</td></tr> <tr><td></td><td></td><td></td><td></td><td>%</td><td></td><td>40.Wasteland</td></tr> <tr><td></td><td></td><td></td><td></td><td>%</td><td></td><td>41.Open Space</td></tr> <tr><td></td><td></td><td></td><td></td><td>%</td><td></td><td>42.Mobile Home Si</td></tr> <tr><td></td><td></td><td></td><td></td><td>%</td><td></td><td>43.Condo Site</td></tr> <tr><td></td><td></td><td></td><td></td><td>%</td><td></td><td>44.Lot Improvemen</td></tr> <tr><td></td><td></td><td></td><td></td><td>%</td><td></td><td>45.Subdivision Lo</td></tr> <tr><td></td><td></td><td></td><td></td><td>%</td><td></td><td>46.Heavy Ind Sit</td></tr> <tr> <td colspan="2">Total Acreage</td> <td>168.20</td> <td colspan="4"></td> </tr> </tbody> </table>					Front Foot	Type	Effective		Influence		Influence Codes	Frontage	Depth	Factor	Code	11.Regular Lot				%		1.Vacancy	12.Delta Triangle				%		2.Unimproved	13.Nabla Triangle				%		3.Topography	14.Rear Land				%		4.Size/Shape	15.Class I Road				%		5.Access					%		6.Restriction					%		7.Corner/Locatio					%		8.View/Environme					%		9.Fractional Sha					%		Acres					%		32.Pasture					%		33.Orchard					%		34.Softwood (FL)					%		35.Mixed Wood (FL)					%		36.Hardwood (FL)					%		37.Softwood (TG)					%		38.Mixed Wood (TG)					%		39.Hardwood (TG)					%		40.Wasteland					%		41.Open Space					%		42.Mobile Home Si					%		43.Condo Site					%		44.Lot Improvemen					%		45.Subdivision Lo					%		46.Heavy Ind Sit	Total Acreage		168.20				
Front Foot	Type	Effective								Influence		Influence Codes																																																																																																																																																																																												
		Frontage	Depth	Factor	Code																																																																																																																																																																																																			
11.Regular Lot				%		1.Vacancy																																																																																																																																																																																																		
12.Delta Triangle				%		2.Unimproved																																																																																																																																																																																																		
13.Nabla Triangle				%		3.Topography																																																																																																																																																																																																		
14.Rear Land				%		4.Size/Shape																																																																																																																																																																																																		
15.Class I Road				%		5.Access																																																																																																																																																																																																		
				%		6.Restriction																																																																																																																																																																																																		
				%		7.Corner/Locatio																																																																																																																																																																																																		
				%		8.View/Environme																																																																																																																																																																																																		
				%		9.Fractional Sha																																																																																																																																																																																																		
				%		Acres																																																																																																																																																																																																		
				%		32.Pasture																																																																																																																																																																																																		
				%		33.Orchard																																																																																																																																																																																																		
				%		34.Softwood (FL)																																																																																																																																																																																																		
				%		35.Mixed Wood (FL)																																																																																																																																																																																																		
				%		36.Hardwood (FL)																																																																																																																																																																																																		
				%		37.Softwood (TG)																																																																																																																																																																																																		
				%		38.Mixed Wood (TG)																																																																																																																																																																																																		
				%		39.Hardwood (TG)																																																																																																																																																																																																		
				%		40.Wasteland																																																																																																																																																																																																		
				%		41.Open Space																																																																																																																																																																																																		
				%		42.Mobile Home Si																																																																																																																																																																																																		
				%		43.Condo Site																																																																																																																																																																																																		
				%		44.Lot Improvemen																																																																																																																																																																																																		
				%		45.Subdivision Lo																																																																																																																																																																																																		
				%		46.Heavy Ind Sit																																																																																																																																																																																																		
Total Acreage		168.20																																																																																																																																																																																																						
Sale Date			<table border="1"> <thead> <tr> <th rowspan="2">Fract. Acre</th> <th colspan="2">Acreage/Sites</th> <td colspan="3"></td> </tr> <tr> <th></th> <th></th> <td colspan="3"></td> </tr> </thead> <tbody> <tr><td>21.Developed Pave</td><td>38</td><td>151.40</td><td>100</td><td>%</td><td>0</td></tr> <tr><td>22.Undev Paved (F</td><td>27</td><td>1.90</td><td>100</td><td>%</td><td>0</td></tr> <tr><td>23.Developed Grav</td><td>37</td><td>14.90</td><td>100</td><td>%</td><td>0</td></tr> <tr><td>Acres</td><td></td><td></td><td></td><td>%</td><td></td></tr> <tr><td>24.Undev Gravel (</td><td></td><td></td><td></td><td>%</td><td></td></tr> <tr><td>26.Rear Land</td><td></td><td></td><td></td><td>%</td><td></td></tr> <tr><td>27.Backlot</td><td></td><td></td><td></td><td>%</td><td></td></tr> <tr><td>29.Pavement</td><td></td><td></td><td></td><td>%</td><td></td></tr> <tr><td>30.Utility R O W</td><td></td><td></td><td></td><td>%</td><td></td></tr> <tr><td>31.Tillable</td><td></td><td></td><td></td><td>%</td><td></td></tr> </tbody> </table>					Fract. Acre	Acreage/Sites										21.Developed Pave	38	151.40	100	%	0	22.Undev Paved (F	27	1.90	100	%	0	23.Developed Grav	37	14.90	100	%	0	Acres				%		24.Undev Gravel (%		26.Rear Land				%		27.Backlot				%		29.Pavement				%		30.Utility R O W				%		31.Tillable				%																																																																																																																											
Fract. Acre	Acreage/Sites																																																																																																																																																																																																							
21.Developed Pave	38	151.40	100	%	0																																																																																																																																																																																																			
22.Undev Paved (F	27	1.90	100	%	0																																																																																																																																																																																																			
23.Developed Grav	37	14.90	100	%	0																																																																																																																																																																																																			
Acres				%																																																																																																																																																																																																				
24.Undev Gravel (%																																																																																																																																																																																																				
26.Rear Land				%																																																																																																																																																																																																				
27.Backlot				%																																																																																																																																																																																																				
29.Pavement				%																																																																																																																																																																																																				
30.Utility R O W				%																																																																																																																																																																																																				
31.Tillable				%																																																																																																																																																																																																				
Building Use 0																																																																																																																																																																																																								
Sale Date																																																																																																																																																																																																								
Price																																																																																																																																																																																																								
Sale Type																																																																																																																																																																																																								
1.Land 4.Mobile 7.C/I L&B 2.L & B 5.Other 8. 3.Building 6.C/I Land 9.																																																																																																																																																																																																								
Financing																																																																																																																																																																																																								
1.Convent 4.Seller 7. 2.FHA/VA 5.Private 8. 3.Assumed 6.Cash 9.Unknown																																																																																																																																																																																																								
Validity																																																																																																																																																																																																								
1.Valid 4.Split 7.Renovate 2.Related 5.Partial 8.Other 3.Distress 6.Exempt 9.																																																																																																																																																																																																								
Verified																																																																																																																																																																																																								
1.Buyer 4.Agent 7.Family 2.Seller 5.Pub Rec 8.Other 3.Lender 6.MLS 9.																																																																																																																																																																																																								

Wade

Map Lot 003-014

Account 113

Location

Card 1 Of 1 9/06/2024

Building Style 0	SF Bsmt Living 0	Layout 0
1.CONVENTI 5.GARRISON 9.GAMBREL	Fin Bsmt Grade 0 0	1.TYPICAL 4. 7.
2.RANCH 6.SALT BOX 10.OTHER	DIRT FLOOR 0	2.INADEQUA 5. 8.
3.RAISED R 7.CONTEMP 11.SPLIT	Heat Type 100% 0	3.POOR 6. 9.
4.CAPE 8.LOG 12.NE	1.HWBB 5.FWA 9.NOT HEAT	Attic 0
Dwelling Units 0	2.HWCI 6.GRAWWA 10.	1.1/4 FINI 4.FULL FIN 7.
Other Units 0	3.HP 7.ELECTRIC 11.	2.1/2 FINI 5.FL / STA 8.
Stories 0	4.STEAM 8.FL/WALL 12.	3.3/4 FINI 6. 9.NONE
1.ONE STOR 4.1.5 STOR 7.1.25 STO	Cool Type 0% 9 NONE	Insulation 0
2.TWO STOR 5.1.75 STO 8.	1.REFRIG A 4.W&C AIR 7.	1.FULLY IN 4.MINIMAL 7.
3.THREE ST 6.2.5 STOR 9.	2.EVAPORAT 5. 8.	2.HEAVY 5.UNKNOWN 8.
Exterior Walls 0	3.HEAT PUM 6. 9.NONE	3.CAPPED O 6. 9.NONE
1.WOOD 5.STUCKO 9.T-111	Kitchen Style 0	Unfinished % 0%
2.VIN/AL 6.BRICK 10.OTHER	1.GOOD 4.OBSOLETE 7.	Grade & Factor 0 0%
3.COMPOS. 7.STONE 11.LOG	2.TYPICAL 5. 8.	1.E GRADE 4.B GRADE 7.
4.ASBESTOS 8.CONCRETE 12.	3.OLD STYL 6. 9.NONE	2.D GRADE 5.A GRADE 8.
Roof Surface 0	Bath(s) Style 0	3.C GRADE 6.AA GRADE 9.SAME
1.ASPHALT 4.COMPOSIT 7.	1.GOOD 4.OBSOLETE 7.	SQFT (Footprint) 0
2.SLATE 5.WOOD 8.	2.TYPICAL 5. 8.	Condition 0
3.METAL 6.OTHER 9.	3.OLD STYL 6. 9.NONE	1.POOR 4.AVERAGE 7.VERY GOO
SF Masonry Trim 0	# Rooms 0	2.FAIR 5.ABOVE AV 8.EXCELLEN
0	# Bedrooms 0	3.BELOW AV 6.GOOD 9.SAME
0	# Full Baths 0	Phys. % Good 0%
Year Built 0	# Half Baths 0	Funct. % Good 100%
Year Remodeled 0	# Addn Fixtures 0	Functional Code 9 None
Foundation 0	# Fireplaces 0	1.Incomp 4.LongTerm 7.Layout
1.CONCRETE 4.WOOD 7.		2.Overbuil 5.Utility 8.Other
2.CONCRETE 5.SLAB 8.		3.Delap 6.Style 9.None
3.BRICK/ST 6.PIERS 9.		Econ. % Good 100%
Basement 0		Economic Code NONE
1.1/4 BASE 4.FULL BAS 7.		0.None 3.NO ELECT 6.
2.1/2 BASE 5.CRAWL 8.		1.LOCATION 4.GENERATC 7.
3.3/4 BASE 6. 9.NO BASEM		2.ENCROACH 5. 8.OTHER
Bsmt Gar # Cars 0		Entrance Code 5 ESTIMATED
Wet Basement 0		1.INTERIOR 4.UNOCCUPI 7.
1.DRY BASE 4. 7.		2.REFUSED 5.ESTIMATE 8.
2.DAMP BAS 5. 8.		3.INFO ONL 6. 9.
3.WET BASE 6. 9.NO BASEM		Information Code 5 ESTIMATE
		1.OWNER 4.AGENT 7.
		2.RELATIVE 5.ESTIMATE 8.
		3.TENANT 6.OTHER 9.



Date Inspected 7/14/2022

Additions, Outbuildings & Improvements								
Type	Year	Units	Grade	Cond	Phys.	Funct.	Sound Value	
					%	%		1.One Story Fram
					%	%		2.Two Story Fram
					%	%		3.Three Story Fr
					%	%		4.1 & 1/2 Story
					%	%		5.1 & 3/4 Story
					%	%		6.2 & 1/2 Story
					%	%		21.Open Porch
					%	%		22.Enclosed Porch
					%	%		23.Frame Garage
					%	%		24.Frame Shed
					%	%		25.1SF Bay Window
					%	%		26.1SF Over Hang
					%	%		27.Unfinished Bas
					%	%		28.Unfinished Att
					%	%		29.Finished Basem

Wade

Map Lot 003-015

Account 134

Location 129 Haynes Road

Card 1

Of 1

9/06/2024

Building Style 2 RANCH	SF Bsmt Living 0	Layout 1 TYPICAL
1.CONVENTI 5.GARRISON 9.GAMBREL	Fin Bsmt Grade 0 0	1.TYPICAL 4. 7.
2.RANCH 6.SALT BOX 10.OTHER	DIRT FLOOR 0	2.INADEQUA 5. 8.
3.RAISED R 7.CONTEMP 11.SPLIT	Heat Type 100% 5 FORCED WARM AIR	3.POOR 6. 9.
4.CAPE 8.LOG 12.NE	1.HWBB 5.FWA 9.NOT HEAT	Attic 9 NONE
Dwelling Units 1	2.HWCI 6.GRAVWA 10.	1.1/4 FINI 4.FULL FIN 7.
Other Units 0	3.HP 7.ELECTRIC 11.	2.1/2 FINI 5.FL / STA 8.
Stories 1 ONE STORY	4.STEAM 8.FL/WALL 12.	3.3/4 FINI 6. 9.NONE
1.ONE STOR 4.1.5 STOR 7.1.25 STO	Cool Type 0% 9 NONE	Insulation 1 FULLY INSULATED
2.TWO STOR 5.1.75 STO 8.	1.REFRIG A 4.W&C AIR 7.	1.FULLY IN 4.MINIMAL 7.
3.THREE ST 6.2.5 STOR 9.	2.EVAPORAT 5. 8.	2.HEAVY 5.UNKNOWN 8.
Exterior Walls 2 VINYL/ALUMINUM	3.HEAT PUM 6. 9.NONE	3.CAPPED O 6. 9.NONE
1.WOOD 5.STUCKO 9.T-111	Kitchen Style 2 TYPICAL	Unfinished % 0%
2.VIN/AL 6.BRICK 10.OTHER	1.GOOD 4.OBSOLETE 7.	Grade & Factor 3 AVERAGE QUALITY
3.COMPOS. 7.STONE 11.LOG	2.TYPICAL 5. 8.	1.E GRADE 4.B GRADE 7.
4.ASBESTOS 8.CONCRETE 12.	3.OLD STYL 6. 9.NONE	2.D GRADE 5.A GRADE 8.
Roof Surface 3 METAL	Bath(s) Style 2 TYPICAL	3.C GRADE 6.AA GRADE 9.SAME
1.ASPHALT 4.COMPOSIT 7.	1.GOOD 4.OBSOLETE 7.	SQFT (Footprint) 1104
2.SLATE 5.WOOD 8.	2.TYPICAL 5. 8.	Condition 5 ABOVE AVERAGE
3.METAL 6.OTHER 9.	3.OLD STYL 6. 9.NONE	1.POOR 4.AVERAGE 7.VERY GOO
SF Masonry Trim 0	# Rooms 6	2.FAIR 5.ABOVE AV 8.EXCELLEN
0	# Bedrooms 3	3.BELOW AV 6.GOOD 9.SAME
0	# Full Baths 1	Phys. % Good 0%
Year Built 2000	# Half Baths 0	Funct. % Good 100%
Year Remodeled 0	# Addn Fixtures 0	Functional Code 9 None
Foundation 1 CONCRETE	# Fireplaces 0	1.Incomp 4.LongTerm 7.Layout
1.CONCRETE 4.WOOD 7.		2.Overbuil 5.Utility 8.Other
2.CONCRETE 5.SLAB 8.		3.Delap 6.Style 9.None
3.BRICK/ST 6.PIERS 9.		Econ. % Good 100%
Basement 4 FULL BASEMENT		Economic Code NONE
1.1/4 BASE 4.FULL BAS 7.		0.None 3.NO ELECT 6.
2.1/2 BASE 5.CRAWL 8.		1.LOCATION 4.GENERATC 7.
3.3/4 BASE 6. 9.NO BASEM		2.ENCROACH 5. 8.OTHER
Bsmt Gar # Cars 0		Entrance Code 2 REFUSED ENTRY
Wet Basement 1 DRY BASEMENT		1.INTERIOR 4.UNOCCUPI 7.
1.DRY BASE 4. 7.		2.REFUSED 5.ESTIMATE 8.
2.DAMP BAS 5. 8.	3.INFO ONL 6. 9.	
3.WET BASE 6. 9.NO BASEM	Information Code 1 OWNER	
	1.OWNER 4.AGENT 7.	
	2.RELATIVE 5.ESTIMATE 8.	
	3.TENANT 6.OTHER 9.	

Date Inspected 7/11/2022

Additions, Outbuildings & Improvements

Type	Year	Units	Grade	Cond	Phys.	Funct.	Sound Value
1 One Story Frame	2000	192	9 100	9	0 %	100 %	
68 Deck	2000	560	3 100	5	0 %	100 %	
23 Frame Garage	2000	480	3 100	5	0 %	100 %	
96 Quonset Garage	1990	960	3 100	5	0 %	100 %	
					%	%	
					%	%	
					%	%	
					%	%	
					%	%	
					%	%	
					%	%	
					%	%	
					%	%	
					%	%	
					%	%	
					%	%	
					%	%	
					%	%	
					%	%	
					%	%	
					%	%	

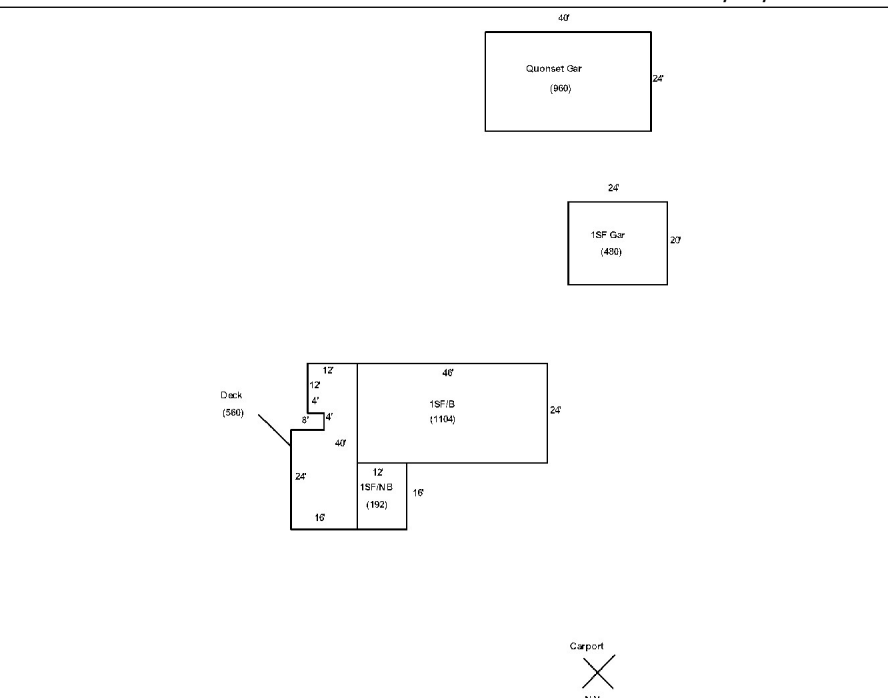

Klei, Jr., Herbert E.
76 Turnpike Road
Willington CT 06279

B1664P210

Inspection Witnessed By:

No./Date	Description	Date Insp.
X		

Notes:

Wade

Property Data			Assessment Record						
Neighborhood 1 Rural			Year	Land	Buildings	Exempt	Total		
Tree Growth Year 0			2017	2,100	0	0	2,100		
X Coordinate			2018	2,100	0	0	2,100		
Y Coordinate			2020	1,800	0	0	1,800		
Zone/Land Use 1 Residential			2021	1,600	0	0	1,600		
Secondary Zone			2022	1,700	0	0	1,700		
Topography 2 Rolling			2023	1,800	0	0	1,800		
2024			2024	1,800	0	0	1,800		
1.Level 4.Below Stre 7.Steep 2.Rolling 5.Low 8.Rough 3.Above Stre 6.Swampy 9.									
Utilities 9 NoWater/NoSewer 1.Well+Septi 4.Public Wat 7.Cess Pool 2.Drilled We 5.Public Sew 8.Holding Ta 3.Septic Sys 6.Dug Well 9.NoW/NoSew									
Street 1 Paved 1.Paved 4.Proposed 7. 2.Semi-Impro 5.Private 8. 3.Gravel 6. 9.No Street									
LAND USE 0			Land Data						
Building Use 0									
Sale Data			Front Foot	Type	Effective		Influence		Influence Codes
Sale Date			11.Regular Lot		Frontage	Depth	Factor	Code	
Price			12.Delta Triangle						1.Vacancy
Sale Type			13.Nabla Triangle						2.Unimproved
1.Land 4.Mobile 7.C/I L&B			14.Rear Land						3.Topography
2.L & B 5.Other 8.			15.Class I Road						4.Size/Shape
3.Building 6.C/I Land 9.									5.Access
Financing									6.Restriction
1.Convent 4.Seller 7.			Square Foot	Square Feet					7.Corner/Locatio
2.FHA/VA 5.Private 8.			16.Class II Road						8.View/Environme
3.Assumed 6.Cash 9.Unknown			17.Municipal Rese						9.Fractional Sha
Validity			18.Munic Sep Lago						Acres
1.Valid 4.Split 7.Renovate			19.Gravel Pit						32.Pasture
2.Related 5.Partial 8.Other			20.Industrial Bas						33.Orchard
3.Distress 6.Exempt 9.									34.Softwood (FL)
Verified			Fract. Acre	Acres/Sites					35.Mixed Wood (FL)
1.Buyer 4.Agent 7.Family			21.Developed Pave	38	4.70	100	%	0	36.Hardwood (FL)
2.Seller 5.Pub Rec 8.Other			22.Undev Paved (F	37	2.80	100	%	0	37.Softwood (TG)
3.Lender 6.MLS 9.			23.Developed Grav	39	4.50	100	%	0	38.Mixed Wood (TG)
			Acres						39.Hardwood (TG)
			24.Undev Gravel (40.Wasteland
			26.Rear Land						41.Open Space
			27.Backlot						42.Mobile Home Si
			29.Pavement						43.Condo Site
			30.Utility R O W						44.Lot Improvemen
			31.Tillable						45.Subdivision Lo
			Total Acreage		12.00				46.Heavy Ind Sit

Wade

Map Lot 003-016

Account 108

Location Haynes Rd

Card 1 Of 1 9/06/2024

Building Style 0	SF Bsmt Living 0	Layout 0
1.CONVENTI 5.GARRISON 9.GAMBREL	Fin Bsmt Grade 0 0	1.TYPICAL 4. 7.
2.RANCH 6.SALT BOX 10.OTHER	DIRT FLOOR 0	2.INADEQUA 5. 8.
3.RAISED R 7.CONTEMP 11.SPLIT	Heat Type 100% 0	3.POOR 6. 9.
4.CAPE 8.LOG 12.NE	1.HWBB 5.FWA 9.NOT HEAT	Attic 0
Dwelling Units 0	2.HWCI 6.GRAVWA 10.	1.1/4 FINI 4.FULL FIN 7.
Other Units 0	3.HP 7.ELECTRIC 11.	2.1/2 FINI 5.FL / STA 8.
Stories 0	4.STEAM 8.FL/WALL 12.	3.3/4 FINI 6. 9.NONE
1.ONE STOR 4.1.5 STOR 7.1.25 STO	Cool Type 0% 9 NONE	Insulation 0
2.TWO STOR 5.1.75 STO 8.	1.REFRIG A 4.W&C AIR 7.	1.FULLY IN 4.MINIMAL 7.
3.THREE ST 6.2.5 STOR 9.	2.EVAPORAT 5. 8.	2.HEAVY 5.UNKNOWN 8.
Exterior Walls 0	3.HEAT PUM 6. 9.NONE	3.CAPPED O 6. 9.NONE
1.WOOD 5.STUCKO 9.T-111	Kitchen Style 0	Unfinished % 0%
2.VIN/AL 6.BRICK 10.OTHER	1.GOOD 4.OBSOLETE 7.	Grade & Factor 0 0%
3.COMPOS. 7.STONE 11.LOG	2.TYPICAL 5. 8.	1.E GRADE 4.B GRADE 7.
4.ASBESTOS 8.CONCRETE 12.	3.OLD STYL 6. 9.NONE	2.D GRADE 5.A GRADE 8.
Roof Surface 0	Bath(s) Style 0	3.C GRADE 6.AA GRADE 9.SAME
1.ASPHALT 4.COMPOSIT 7.	1.GOOD 4.OBSOLETE 7.	SQFT (Footprint) 0
2.SLATE 5.WOOD 8.	2.TYPICAL 5. 8.	Condition 0
3.METAL 6.OTHER 9.	3.OLD STYL 6. 9.NONE	1.POOR 4.AVERAGE 7.VERY GOO
SF Masonry Trim 0	# Rooms 0	2.FAIR 5.ABOVE AV 8.EXCELLEN
0	# Bedrooms 0	3.BELOW AV 6.GOOD 9.SAME
0	# Full Baths 0	Phys. % Good 0%
Year Built 0	# Half Baths 0	Funct. % Good 100%
Year Remodeled 0	# Addn Fixtures 0	Functional Code 9 None
Foundation 0	# Fireplaces 0	1.Incomp 4.LongTerm 7.Layout
1.CONCRETE 4.WOOD 7.		2.Overbuil 5.Utility 8.Other
2.CONCRETE 5.SLAB 8.		3.Delap 6.Style 9.None
3.BRICK/ST 6.PIERS 9.		Econ. % Good 100%
Basement 0		Economic Code NONE
1.1/4 BASE 4.FULL BAS 7.		0.None 3.NO ELECT 6.
2.1/2 BASE 5.CRAWL 8.		1.LOCATION 4.GENERATC 7.
3.3/4 BASE 6. 9.NO BASEM		2.ENCROACH 5. 8.OTHER
Bsmt Gar # Cars 0		Entrance Code 5 ESTIMATED
Wet Basement 0		1.INTERIOR 4.UNOCCUPI 7.
1.DRY BASE 4. 7.		2.REFUSED 5.ESTIMATE 8.
2.DAMP BAS 5. 8.		3.INFO ONL 6. 9.
3.WET BASE 6. 9.NO BASEM		Information Code 5 ESTIMATE
		1.OWNER 4.AGENT 7.
		2.RELATIVE 5.ESTIMATE 8.
		3.TENANT 6.OTHER 9.



Date Inspected 7/14/2022

Additions, Outbuildings & Improvements								
Type	Year	Units	Grade	Cond	Phys.	Funct.	Sound Value	
					%	%		1.One Story Fram
					%	%		2.Two Story Fram
					%	%		3.Three Story Fr
					%	%		4.1 & 1/2 Story
					%	%		5.1 & 3/4 Story
					%	%		6.2 & 1/2 Story
					%	%		21.Open Porch
					%	%		22.Enclosed Porch
					%	%		23.Frame Garage
					%	%		24.Frame Shed
					%	%		25.1SF Bay Window
					%	%		26.1SF Over Hang
					%	%		27.Unfinished Bas
					%	%		28.Unfinished Att
					%	%		29.Finished Basem

Wade

Map Lot 003-017

Account 35

Location 97 Haynes Rd

Card 1 Of 1 9/06/2024

Building Style 1 CONVENTIONAL	SF Bsmt Living 0	Layout 1 TYPICAL
1.CONVENTI 5.GARRISON 9.GAMBREL	Fin Bsmt Grade 0 0	1.TYPICAL 4. 7.
2.RANCH 6.SALT BOX 10.OTHER	DIRT FLOOR 0	2.INADEQUA 5. 8.
3.RAISED R 7.CONTEMP 11.SPLIT	Heat Type 100% 5 FORCED WARM AIR	3.POOR 6. 9.
4.CAPE 8.LOG 12.NE	1.HWBB 5.FWA 9.NOT HEAT	Attic 9 NONE
Dwelling Units 1	2.HWCI 6.GRAVWA 10.	1.1/4 FINI 4.FULL FIN 7.
Other Units 0	3.HP 7.ELECTRIC 11.	2.1/2 FINI 5.FL / STA 8.
Stories 4 ONE & 1/2 STORY	4.STEAM 8.FL/WALL 12.	3.3/4 FINI 6. 9.NONE
1.ONE STOR 4.1.5 STOR 7.1.25 STO	Cool Type 0% 9 NONE	Insulation 1 FULLY INSULATED
2.TWO STOR 5.1.75 STO 8.	1.REFRIG A 4.W&C AIR 7.	1.FULLY IN 4.MINIMAL 7.
3.THREE ST 6.2.5 STOR 9.	2.EVAPORAT 5. 8.	2.HEAVY 5.UNKNOWN 8.
Exterior Walls 2 VINYL/ALUMINUM	3.HEAT PUM 6. 9.NONE	3.CAPPED O 6. 9.NONE
1.WOOD 5.STUCKO 9.T-111	Kitchen Style 2 TYPICAL	Unfinished % 0%
2.VIN/AL 6.BRICK 10.OTHER	1.GOOD 4.OBSOLETE 7.	Grade & Factor 3 AVERAGE QUALITY
3.COMPOS. 7.STONE 11.LOG	2.TYPICAL 5. 8.	1.E GRADE 4.B GRADE 7.
4.ASBESTOS 8.CONCRETE 12.	3.OLD STYL 6. 9.NONE	2.D GRADE 5.A GRADE 8.
Roof Surface 3 METAL	Bath(s) Style 2 TYPICAL	3.C GRADE 6.AA GRADE 9.SAME
1.ASPHALT 4.COMPOSIT 7.	1.GOOD 4.OBSOLETE 7.	SQFT (Footprint) 600
2.SLATE 5.WOOD 8.	2.TYPICAL 5. 8.	Condition 4 AVERAGE
3.METAL 6.OTHER 9.	3.OLD STYL 6. 9.NONE	1.POOR 4.AVERAGE 7.VERY GOO
SF Masonry Trim 0	# Rooms 8	2.FAIR 5.ABOVE AV 8.EXCELLEN
0	# Bedrooms 5	3.BELOW AV 6.GOOD 9.SAME
0	# Full Baths 1	Phys. % Good 0%
Year Built 1900	# Half Baths 0	Funct. % Good 100%
Year Remodeled 0	# Addn Fixtures 0	Functional Code 9 None
Foundation 6 PIERS	# Fireplaces 0	1.Incomp 4.LongTerm 7.Layout
1.CONCRETE 4.WOOD 7.	 <p>TRIO Software A Division of Harris Computer Systems</p>	2.Overbuil 5.Utility 8.Other
2.CONCRETE 5.SLAB 8.		3.Delap 6.Style 9.None
3.BRICK/ST 6.PIERS 9.		Econ. % Good 100%
Basement 5 CRAWL		Economic Code NONE
1.1/4 BASE 4.FULL BAS 7.		0.None 3.NO ELECT 6.
2.1/2 BASE 5.CRAWL 8.		1.LOCATION 4.GENERATC 7.
3.3/4 BASE 6. 9.NO BASEM		2.ENCROACH 5. 8.OTHER
Bsmt Gar # Cars 0		Entrance Code 3 INFORMATION ONLY
Wet Basement 9 NO BASEMENT		1.INTERIOR 4.UNOCCUPI 7.
1.DRY BASE 4. 7.		2.REFUSED 5.ESTIMATE 8.
2.DAMP BAS 5. 8.	3.INFO ONL 6. 9.	
3.WET BASE 6. 9.NO BASEM	Information Code 1 OWNER	
	1.OWNER 4.AGENT 7.	
	2.RELATIVE 5.ESTIMATE 8.	
	3.TENANT 6.OTHER 9.	

Date Inspected 7/11/2022

Additions, Outbuildings & Improvements

Type	Year	Units	Grade	Cond	Phys.	Funct.	Sound Value
22 Enclosed Porch	1960	132	3 100	4	0 %	100 %	
1 One Story Frame	1960	240	3 100	4	0 %	90 %	
23 Frame Garage	1960	1200	3 100	4	0 %	100 %	
23 Frame Garage	2000	988	3 105	4	0 %	100 %	
					%	%	
					%	%	
					%	%	
					%	%	
					%	%	
					%	%	
					%	%	

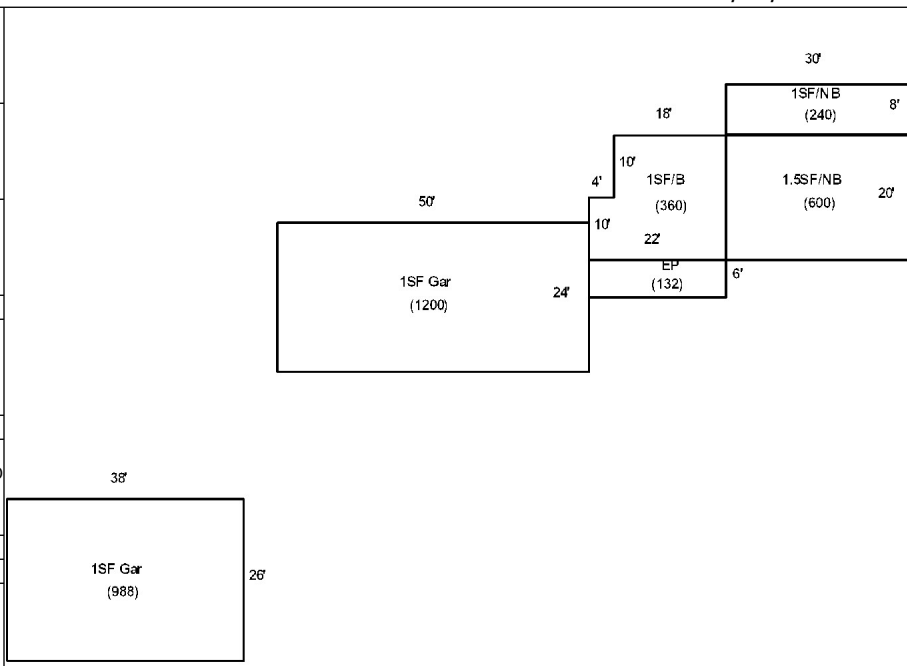

Wade

Map Lot 003-019

Account 79

Location 75 Haynes Rd

Card 1 Of 1 9/06/2024

Building Style 3 RAISED RANCH	SF Bsmt Living 462	Layout 1 TYPICAL
1.CONVENTI 5.GARRISON 9.GAMBREL	Fin Bsmt Grade 3 100	1.TYPICAL 4. 7.
2.RANCH 6.SALT BOX 10.OTHER	DIRT FLOOR 0	2.INADEQUA 5. 8.
3.RAISED R 7.CONTEMP 11.SPLIT	Heat Type 100% 1 HOT WATER BB	3.POOR 6. 9.
4.CAPE 8.LOG 12.NE	1.HWBB 5.FWA 9.NOT HEAT	Attic 9 NONE
Dwelling Units 1	2.HWCI 6.GRAWWA 10.	1.1/4 FINI 4.FULL FIN 7.
Other Units 0	3.HP 7.ELECTRIC 11.	2.1/2 FINI 5.FL / STA 8.
Stories 1 ONE STORY	4.STEAM 8.FL/WALL 12.	3.3/4 FINI 6. 9.NONE
1.ONE STOR 4.1.5 STOR 7.1.25 STO	Cool Type 0% 9 NONE	Insulation 1 FULLY INSULATED
2.TWO STOR 5.1.75 STO 8.	1.REFRIG A 4.W&C AIR 7.	1.FULLY IN 4.MINIMAL 7.
3.THREE ST 6.2.5 STOR 9.	2.EVAPORAT 5. 8.	2.HEAVY 5.UNKNOWN 8.
Exterior Walls 2 VINYL/ALUMINUM	3.HEAT PUM 6. 9.NONE	3.CAPPED O 6. 9.NONE
1.WOOD 5.STUCKO 9.T-111	Kitchen Style 2 TYPICAL	Unfinished % 0%
2.VIN/AL 6.BRICK 10.OTHER	1.GOOD 4.OBSOLETE 7.	Grade & Factor 3 AVERAGE QUALITY
3.COMPOS. 7.STONE 11.LOG	2.TYPICAL 5. 8.	1.E GRADE 4.B GRADE 7.
4.ASBESTOS 8.CONCRETE 12.	3.OLD STYL 6. 9.NONE	2.D GRADE 5.A GRADE 8.
Roof Surface 1 ASPHALT SHINGLES	Bath(s) Style 2 TYPICAL	3.C GRADE 6.AA GRADE 9.SAME
1.ASPHALT 4.COMPOSIT 7.	1.GOOD 4.OBSOLETE 7.	SQFT (Footprint) 924
2.SLATE 5.WOOD 8.	2.TYPICAL 5. 8.	Condition 4 AVERAGE
3.METAL 6.OTHER 9.	3.OLD STYL 6. 9.NONE	1.POOR 4.AVERAGE 7.VERY GOO
SF Masonry Trim 0	# Rooms 5	2.FAIR 5.ABOVE AV 8.EXCELLEN
0	# Bedrooms 3	3.BELOW AV 6.GOOD 9.SAME
0	# Full Baths 1	Phys. % Good 0%
Year Built 2000	# Half Baths 0	Funct. % Good 100%
Year Remodeled 0	# Addn Fixtures 0	Functional Code 9 None
Foundation 1 CONCRETE	# Fireplaces 0	1.Incomp 4.LongTerm 7.Layout
1.CONCRETE 4.WOOD 7.	 <p>TRIO Software A Division of Harris Computer Systems</p>	2.Overbuil 5.Utility 8.Other
2.CONCRETE 5.SLAB 8.		3.Delap 6.Style 9.None
3.BRICK/ST 6.PIERS 9.		Econ. % Good 100%
Basement 4 FULL BASEMENT		Economic Code NONE
1.1/4 BASE 4.FULL BAS 7.		0.None 3.NO ELECT 6.
2.1/2 BASE 5.CRAWL 8.		1.LOCATION 4.GENERATC 7.
3.3/4 BASE 6. 9.NO BASEM		2.ENCROACH 5. 8.OTHER
Bsmt Gar # Cars 0		Entrance Code 3 INFORMATION ONLY
Wet Basement 1 DRY BASEMENT		1.INTERIOR 4.UNOCCUPI 7.
1.DRY BASE 4. 7.		2.REFUSED 5.ESTIMATE 8.
2.DAMP BAS 5. 8.	3.INFO ONL 6. 9.	
3.WET BASE 6. 9.NO BASEM	Information Code 1 OWNER	
	1.OWNER 4.AGENT 7.	
	2.RELATIVE 5.ESTIMATE 8.	
	3.TENANT 6.OTHER 9.	

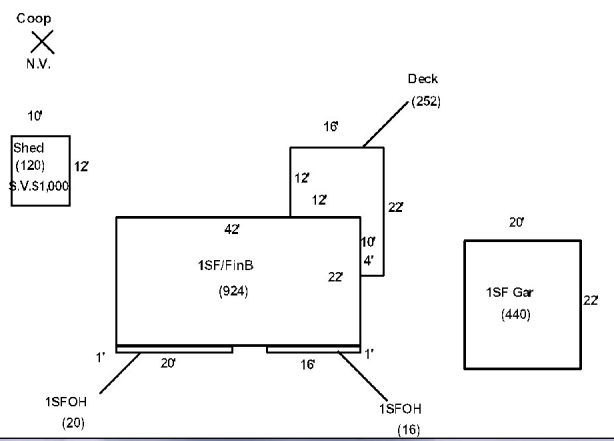
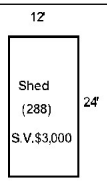

Date Inspected 7/11/2022

Additions, Outbuildings & Improvements

Type	Year	Units	Grade	Cond	Phys.	Funct.	Sound Value
26 1SF Over Hang	2000	40	9 100	9	0 %	100 %	
26 1SF Over Hang	2000	32	9 100	9	0 %	100 %	
68 Deck	2010	252	3 100	4	0 %	100 %	
23 Frame Garage	2010	440	3 100	4	0 %	100 %	
24 Frame Shed	2000				%	%	1,000
24 Frame Shed	2021				%	%	3,000
					%	%	
					%	%	
					%	%	
					%	%	
					%	%	
					%	%	



Chandler Family LLC
1634 State Road
Mapleton ME 04757

B3482P1

Inspection Witnessed By:

X		Date
No./Date	Description	Date Insp.

Notes:

Wade

Property Data			Assessment Record						
Neighborhood	1 Rural		Year	Land	Buildings	Exempt	Total		
Tree Growth Year	0		2017	112,800	0	0	112,800		
X Coordinate			2018	112,800	0	0	112,800		
Y Coordinate			2020	112,800	0	0	112,800		
Zone/Land Use	1 Residential		2021	124,300	0	0	124,300		
Secondary Zone			2022	148,300	0	0	148,300		
Topography	2 Rolling		2023	148,300	0	0	148,300		
			2024	148,300	0	0	148,300		
1.Level	4.Below Stre	7.Steep							
2.Rolling	5.Low	8.Rough							
3.Above Stre	6.Swampy	9.							
Utilities	1 Drilled Well / Septic								
1.Well+Septi	4.Public Wat	7.Cess Pool							
2.Drilled We	5.Public Sew	8.Holding Ta							
3.Septic Sys	6.Dug Well	9.NoW/NoSew							
Street									
1.Paved	4.Proposed	7.							
2.Semi-Impro	5.Private	8.							
3.Gravel	6.	9.No Street							
LAND USE	0		Land Data						
Building Use	0		Front Foot	Type	Effective		Influence		
Sale Data			11.Regular Lot		Frontage	Depth	Factor	Code	
			12.Delta Triangle						
Sale Date			13.Nabla Triangle						
Price			14.Rear Land						
Sale Type			15.Class I Road						
1.Land	4.Mobile	7.C/I L&B	Square Foot		Square Feet		Influence Codes		
2.L & B	5.Other	8.							
3.Building	6.C/I Land	9.	16.Class II Road						
Financing			17.Municipal Rese						
			18.Munic Sep Lago						
1.Convent	4.Seller	7.	19.Gravel Pit						
2.FHA/VA	5.Private	8.	20.Industrial Bas						
3.Assumed	6.Cash	9.Unknown	Fract. Acre		Acreage/Sites		Acres		
Validity									
			1.Valid	4.Split	7.Renovate	21.Developed Pave	21	1.00	100
2.Related	5.Partial	8.Other	22.Undev Paved (F	26	78.00	100	%	0	
3.Distress	6.Exempt	9.	23.Developed Grav	31	84.00	100	%	0	
Verified			Acres		40	4.00	100	%	0
					24.Undev Gravel (
1.Buyer	4.Agent	7.Family	26.Rear Land						
2.Seller	5.Pub Rec	8.Other	27.Backlot						
3.Lender	6.MLS	9.	29.Pavement						
Total Acreage			30.Utility R O W	167.00		Influence Codes			
			31.Tillable						
Total Acreage			167.00		1.Vacancy 2.Unimproved 3.Topography 4.Size/Shape 5.Access 6.Restriction 7.Corner/Locatio 8.View/Environme 9.Fractional Sha Acres 32.Pasture 33.Orchard 34.Softwood (FL) 35.Mixed Wood (FL) 36.Hardwood (FL) 37.Softwood (TG) 38.Mixed Wood (TG) 39.Hardwood (TG) 40.Wasteland 41.Open Space 42.Mobile Home Si 43.Condo Site 44.Lot Improvemen 45.Subdivision Lo 46.Heavy Ind Sit				

Wade

Map Lot 003-020

Account 24

Location 5 Haynes Rd

Card 1 Of 1 9/06/2024

Building Style 0	SF Bsmt Living 0	Layout 0
1.CONVENTI 5.GARRISON 9.GAMBREL	Fin Bsmt Grade 0 0	1.TYPICAL 4. 7.
2.RANCH 6.SALT BOX 10.OTHER	DIRT FLOOR 0	2.INADEQUA 5. 8.
3.RAISED R 7.CONTEMP 11.SPLIT	Heat Type 100% 0	3.POOR 6. 9.
4.CAPE 8.LOG 12.NE	1.HWBB 5.FWA 9.NOT HEAT	Attic 0
Dwelling Units 0	2.HWCI 6.GRAVWA 10.	1.1/4 FINI 4.FULL FIN 7.
Other Units 0	3.HP 7.ELECTRIC 11.	2.1/2 FINI 5.FL / STA 8.
Stories 0	4.STEAM 8.FL/WALL 12.	3.3/4 FINI 6. 9.NONE
1.ONE STOR 4.1.5 STOR 7.1.25 STO	Cool Type 0% 9 NONE	Insulation 0
2.TWO STOR 5.1.75 STO 8.	1.REFRIG A 4.W&C AIR 7.	1.FULLY IN 4.MINIMAL 7.
3.THREE ST 6.2.5 STOR 9.	2.EVAPORAT 5. 8.	2.HEAVY 5.UNKNOWN 8.
Exterior Walls 0	3.HEAT PUM 6. 9.NONE	3.CAPPED O 6. 9.NONE
1.WOOD 5.STUCKO 9.T-111	Kitchen Style 0	Unfinished % 0%
2.VIN/AL 6.BRICK 10.OTHER	1.GOOD 4.OBSOLETE 7.	Grade & Factor 0 0%
3.COMPOS. 7.STONE 11.LOG	2.TYPICAL 5. 8.	1.E GRADE 4.B GRADE 7.
4.ASBESTOS 8.CONCRETE 12.	3.OLD STYL 6. 9.NONE	2.D GRADE 5.A GRADE 8.
Roof Surface 0	Bath(s) Style 0	3.C GRADE 6.AA GRADE 9.SAME
1.ASPHALT 4.COMPOSIT 7.	1.GOOD 4.OBSOLETE 7.	SQFT (Footprint) 0
2.SLATE 5.WOOD 8.	2.TYPICAL 5. 8.	Condition 0
3.METAL 6.OTHER 9.	3.OLD STYL 6. 9.NONE	1.POOR 4.AVERAGE 7.VERY GOO
SF Masonry Trim 0	# Rooms 0	2.FAIR 5.ABOVE AV 8.EXCELLEN
0	# Bedrooms 0	3.BELOW AV 6.GOOD 9.SAME
0	# Full Baths 0	Phys. % Good 0%
Year Built 0	# Half Baths 0	Funct. % Good 100%
Year Remodeled 0	# Addn Fixtures 0	Functional Code 9 None
Foundation 0	# Fireplaces 0	1.Incomp 4.LongTerm 7.Layout
1.CONCRETE 4.WOOD 7.		2.Overbuil 5.Utility 8.Other
2.CONCRETE 5.SLAB 8.		3.Delap 6.Style 9.None
3.BRICK/ST 6.PIERS 9.		Econ. % Good 100%
Basement 0		Economic Code NONE
1.1/4 BASE 4.FULL BAS 7.		0.None 3.NO ELECT 6.
2.1/2 BASE 5.CRAWL 8.		1.LOCATION 4.GENERATC 7.
3.3/4 BASE 6. 9.NO BASEM		2.ENCROACH 5. 8.OTHER
Bsmt Gar # Cars 0		Entrance Code 0
Wet Basement 0		1.INTERIOR 4.UNOCCUPI 7.
1.DRY BASE 4. 7.		2.REFUSED 5.ESTIMATE 8.
2.DAMP BAS 5. 8.	3.INFO ONL 6. 9.	
3.WET BASE 6. 9.NO BASEM	Information Code 0	
	1.OWNER 4.AGENT 7.	
	2.RELATIVE 5.ESTIMATE 8.	
	3.TENANT 6.OTHER 9.	

Date Inspected

Additions, Outbuildings & Improvements

Type	Year	Units	Grade	Cond	Phys.	Funct.	Sound Value
					%	%	1.One Story Fram
					%	%	2.Two Story Fram
					%	%	3.Three Story Fr
					%	%	4.1 & 1/2 Story
					%	%	5.1 & 3/4 Story
					%	%	6.2 & 1/2 Story
					%	%	21.Open Porch
					%	%	22.Enclosed Porch
					%	%	23.Frame Garage
					%	%	24.Frame Shed
					%	%	25.1SF Bay Window
					%	%	26.1SF Over Hang
					%	%	27.Unfinished Bas
					%	%	28.Unfinished Att
					%	%	29.Finished Basem