

Washburn

Map Lot 002-002

Account 976

Location NORTH WHITE ROAD

Card 1 Of 1 9/04/2024

Building Style 0	SF Bsmt Living 0	Layout 0
1.Conv. 5.Garrison 9.Gambrel	Fin Bsmt Grade 0 0	1.Typical 4. 7.
2.Ranch 6.Salt Box 10.Other	OPEN 5 OPTIONAL 0	2.Inadeq 5. 8.
3.R Ranch 7.Contemp 11.Split	Heat Type 100% 0	3.Poor 6. 9.
4.Cape 8.Log 12.	1.HWBB 5.FWA 9.No Heat	Attic 0
Dwelling Units 0	2.HWCI 6.GravWA 10.	1.1/4 Fin 4.Full Fin 7.
Other Units 0	3.H Pump 7.Electric 11.	2.1/2 Fin 5.FI/Stair 8.
Stories 0	4.Steam 8.FI/Wall 12.	3.3/4 Fin 6. 9.None
1.1 4.1.5 7.	Cool Type 0% 9 None	Insulation 0
2.2 5.1.75 8.	1.Refrig 4.W&C Air 7.	1.Full 4.Minimal 7.
3.3 6.2.5 9.	2.Evapor 5. 8.	2.Heavy 5.Partial 8.
Exterior Walls 0	3.H Pump 6. 9.None	3.Capped 6. 9.None
1.Wood 5.Stucco 9.T-111	Kitchen Style 0	Unfinished % 0%
2.Vin/Al 6.Brick 10.Other	1.Modern 4.Obsolete 7.	Grade & Factor 0 0%
3.Compos. 7.Stone 11.	2.Typical 5. 8.	1.E Grade 4.B Grade 7.
4.Asbestos 8.Concrete 12.	3.Old Type 6. 9.None	2.D Grade 5.A Grade 8.SC Grade
Roof Surface 0	Bath(s) Style 0	3.C Grade 6.AA Grade 9.Same
1.Asphalt 4.Composit 7.	1.Modern 4.Obsolete 7.	SQFT (Footprint) 0
2.Slate 5.Wood 8.	2.Typical 5. 8.	Condition 0
3.Metal 6.Other 9.	3.Old Type 6. 9.None	1.Poor 4.Avg 7.V G
SF Masonry Trim 0	# Rooms 0	2.Fair 5.Avg+ 8.Exc
OPEN-3-CUSTOM 0	# Bedrooms 0	3.Avg- 6.Good 9.Same
OPEN-4-CUSTOM 0	# Full Baths 0	Phys. % Good 0%
Year Built 0	# Half Baths 0	Funct. % Good 100%
Year Remodeled 0	# Addn Fixtures 0	Functional Code 9 None
Foundation 0	# Fireplaces 0	1.Incomp 4.Delap 7.No Power
1.Concrete 4.Wood 7.		2.O-Built 5.Bsmt 8.LongTerm
2.C Block 5.Slab 8.		3.Damage 6.Common 9.None
3.Br/Stone 6.Piers 9.		Econ. % Good 100%
Basement 0		Economic Code None
1.1/4 Bmt 4.Full Bmt 7.		0.None 3.No Power 7.
2.1/2 Bmt 5.None 8.		1.Location 4.Generate 8.
3.3/4 Bmt 6. 9.None		2.Encroach 9.None 9.
Bsmt Gar # Cars 0		Entrance Code 0
Wet Basement 0		1.Interior 4.Vacant 7.
1.Dry 4. 7.		2.Refusal 5.Estimate 8.
2.Damp 5. 8.	3.Informed 6.Reviewed 9.	
3.Wet 6. 9.	Information Code 0	
		1.Owner 4.Agent 7.
		2.Relative 5.Estimate 8.
		3.Tenant 6.Other 9.

Date Inspected

Additions, Outbuildings & Improvements								
Type	Year	Units	Grade	Cond	Phys.	Funct.	Sound Value	
					%	%		1.One Story Fram
					%	%		2.Two Story Fram
					%	%		3.Three Story Fr
					%	%		4.1 & 1/2 Story
					%	%		5.1 & 3/4 Story
					%	%		6.2 & 1/2 Story
					%	%		21.Open Frame Por
					%	%		22.Encl Frame Por
					%	%		23.Frame Garage
					%	%		24.Frame Shed
					%	%		25.Frame Bay Wind
					%	%		26.1SFr Overhang
					%	%		27.Unfin Basement
					%	%		28.Unfinished Att
					%	%		29.Finished Attic

CARTER, ALAN
CARTER, ELIZABETH ANNE
P.O. BOX 601
WASHBURN ME 04786

B1154P392 B5439P182

Inspection Witnessed By:

X	Date
No./Date	Description
	Date Insp.

Notes:
*Owner is concerned that the scrap metal pile next to her property is effecting her property value.

Washburn

Property Data			Assessment Record						
Neighborhood 1 Neighborhood One			Year	Land	Buildings	Exempt	Total		
Tree Growth Year 0			2012	4,600	53,100	8,800	48,900		
1ST MORTGAGE 0			2013	6,000	53,100	14,080	45,020		
2ND MORTGAGE 0			2015	6,000	53,100	14,400	44,700		
Zone/Land Use 1 Residential			2018	6,000	53,100	23,920	35,180		
Secondary Zone			2019	15,000	20,600	26,000	9,600		
Topography 1 Level 3 Above Street			2020	15,000	19,100	31,000	3,100		
1.Level 4.Below St 7.LevelBog			2021	15,000	20,600	31,000	4,600		
2.Rolling 5.Low 8.			2022	15,000	21,600	31,000	5,600		
3.Above St 6.Swampy 9.			2023	18,900	25,700	31,000	13,600		
Utilities 4 Drilled Well 6 Septic System			2024	18,900	25,700	31,000	13,600		
1.Public 4.Dr Well 7.Cesspool									
2.Water 5.Dug Well 8.									
3.Sewer 6.Septic 9.None									
Street 1 Paved									
1.Paved 4.Proposed 7.									
2.Semi Imp 5.R/O/W 8.									
3.Gravel 6. 9.None									
TG PLAN YEAR 0									
Tif District # 0									
Sale Data			Land Data						
Sale Date 8/01/1974			Front Foot	Type	Effective		Influence		Influence Codes
Price 76,500					Frontage	Depth	Factor	Code	
Sale Type 2 Land & Buildings			11.Regular Lot					1.Unimproved	
1.Land 4.Mobile 7.C/I L&B			12.Delta Triangle					2.Excess Frtg	
2.L & B 5.Other 8.			13.Nabla Triangle					3.Topography	
3.Building 6.C/I Land 9.			14.Rear Land					4.Size/Shape	
Financing 1 Conventional			15.Class I Road					5.Access	
1.Convent 4.Seller 7.								6.Restriction	
2.FHA/VA 5.Private 8.								7.Open Space	
3.Assumed 6.Cash 9.Unknown								8.View/Environ	
Validity 1 Arms Length Sale								9.Fract Share	
1.Valid 4.Split 7.Renovate			Square Foot	Square Feet				Acres	
2.Related 5.Partial 8.Other			16.Class II Road	29	1,800	75	%	0	
3.Distress 6.Exempt 9.			17.Municipal Rese						
Verified 5 Public Record			18.Munic Sep Lago						
1.Buyer 4.Agent 7.Family			19.Gravel Pit						
2.Seller 5.Pub Rec 8.Other			20.Industrial Bas						
3.Lender 6.MLS 9.									
			Fract. Acre	Acreege/Sites					
			21.Developed Pave	21	0.50	100	%	0	
			22.Undev Paved (F						
			23.Developed Grav						
			Acres						
			24.Undev Gravel (
			25.Comm Base Pave						
			26.Comm Base Grav						
			27.Backlot						
			28.Rear Land						
			29.Pavement						
			Total Acreage		0.50				
								30.Utility R O W	
								31.Tillable	
								32.Pasture	
								33.Orchard	
								34.Softwood F&O	
								35.Mixed Wood F&O	
								36.Hardwood F&O	
								37.Softwood TG	
								38.Mixed Wood TG	
								39.Hardwood TG	
								40.Wasteland	
								41.Open Space	
								42.Mobile Home Si	
								43.Condo Site	
								44.Lot Improvemen	
								45.Subdivision Lo	
								46.Heavy Ind Sit	

Washburn

Map Lot 002-003

Account 90

Location 837 WASHBURN ROAD

Card 1 Of 1 9/04/2024

Building Style 0	SF Bsmt Living 0	Layout 0
1.Conv. 5.Garrison 9.Gambrel	Fin Bsmt Grade 0 0	1.Typical 4. 7.
2.Ranch 6.Salt Box 10.Other	OPEN 5 OPTIONAL 0	2.Inadeq 5. 8.
3.R Ranch 7.Contemp 11.Split	Heat Type 100% 0	3.Poor 6. 9.
4.Cape 8.Log 12.	1.HWBB 5.FWA 9.No Heat	Attic 0
Dwelling Units 0	2.HWCI 6.GravWA 10.	1.1/4 Fin 4.Full Fin 7.
Other Units 0	3.H Pump 7.Electric 11.	2.1/2 Fin 5.FI/Stair 8.
Stories 0	4.Steam 8.FI/Wall 12.	3.3/4 Fin 6. 9.None
1.1 4.1.5 7.	Cool Type 0% 9 None	Insulation 0
2.2 5.1.75 8.	1.Refrig 4.W&C Air 7.	1.Full 4.Minimal 7.
3.3 6.2.5 9.	2.Evapor 5. 8.	2.Heavy 5.Partial 8.
Exterior Walls 0	3.H Pump 6. 9.None	3.Capped 6. 9.None
1.Wood 5.Stucco 9.T-111	Kitchen Style 0	Unfinished % 0%
2.Vin/Al 6.Brick 10.Other	1.Modern 4.Obsolete 7.	Grade & Factor 0 0%
3.Compos. 7.Stone 11.	2.Typical 5. 8.	1.E Grade 4.B Grade 7.
4.Asbestos 8.Concrete 12.	3.Old Type 6. 9.None	2.D Grade 5.A Grade 8.SC Grade
Roof Surface 0	Bath(s) Style 0	3.C Grade 6.AA Grade 9.Same
1.Asphalt 4.Composit 7.	1.Modern 4.Obsolete 7.	SQFT (Footprint) 0
2.Slate 5.Wood 8.	2.Typical 5. 8.	Condition 0
3.Metal 6.Other 9.	3.Old Type 6. 9.None	1.Poor 4.Avg 7.V G
SF Masonry Trim 0	# Rooms 0	2.Fair 5.Avg+ 8.Exc
OPEN-3-CUSTOM 0	# Bedrooms 0	3.Avg- 6.Good 9.Same
OPEN-4-CUSTOM 0	# Full Baths 0	Phys. % Good 0%
Year Built 0	# Half Baths 0	Funct. % Good 100%
Year Remodeled 0	# Addn Fixtures 0	Functional Code 9 None
Foundation 0	# Fireplaces 0	1.Incomp 4.Delap 7.No Power
1.Concrete 4.Wood 7.	 <p>TRIO Software A Division of Harris Computer Systems</p>	2.O-Built 5.Bsmt 8.LongTerm
2.C Block 5.Slab 8.		3.Damage 6.Common 9.None
3.Br/Stone 6.Piers 9.		Econ. % Good 100%
Basement 0		Economic Code None
1.1/4 Bmt 4.Full Bmt 7.		0.None 3.No Power 7.
2.1/2 Bmt 5.None 8.		1.Location 4.Generate 8.
3.3/4 Bmt 6. 9.None		2.Encroach 9.None 9.
Bsmt Gar # Cars 0		Entrance Code 5 Estimated
Wet Basement 0		1.Interior 4.Vacant 7.
1.Dry 4. 7.		2.Refusal 5.Estimate 8.
2.Damp 5. 8.	3.Informed 6.Reviewed 9.	
3.Wet 6. 9.	Information Code 5 Estimate	
	1.Owner 4.Agent 7.	
	2.Relative 5.Estimate 8.	
	3.Tenant 6.Other 9.	

Date Inspected 8/02/2018

Additions, Outbuildings & Improvements

Type	Year	Units	Grade	Cond	Phys.	Funct.	Sound Value	
847 Maple Leaf	2000	16x72	5 100	4	0 %	100 %		1.One Story Fram
68 Wood Deck	2000	160	3 100	4	0 %	100 %		2.Two Story Fram
23 Frame Garage	1980	768	3 95	3	0 %	100 %		3.Three Story Fr
					%	%		4.1 & 1/2 Story
					%	%		5.1 & 3/4 Story
					%	%		6.2 & 1/2 Story
					%	%		21.Open Frame Por
					%	%		22.Encl Frame Por
					%	%		23.Frame Garage
					%	%		24.Frame Shed
					%	%		25.Frame Bay Wind
					%	%		26.1SFr Overhang
					%	%		27.Unfin Basement
					%	%		28.Unfinished Att
					%	%		29.Finished Attic

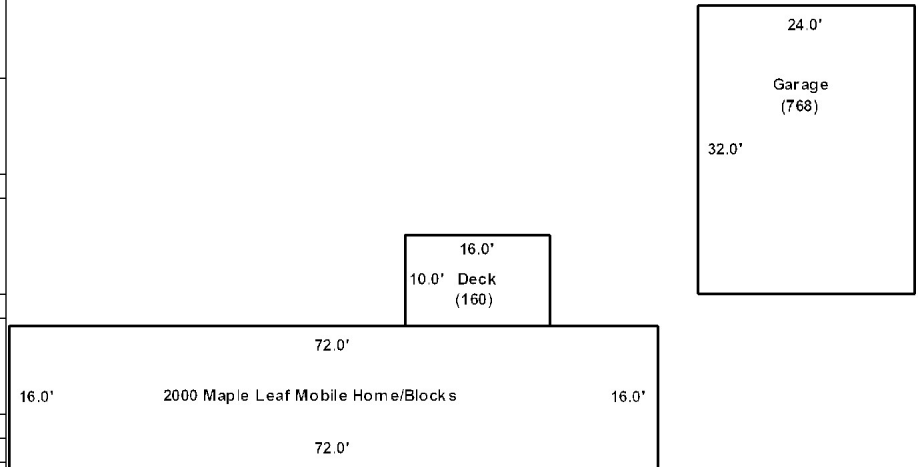

THOMPSON, ALAN R
THOMPSON, SHARON M
P.O. BOX 82
WASHBURN ME 04786

B3949P306

Inspection Witnessed By:

No./Date	Description	Date Insp.
X		

Notes:

Washburn

Property Data			Assessment Record						
Neighborhood 1 Neighborhood One			Year	Land	Buildings	Exempt	Total		
Tree Growth Year 0			2012	4,000	16,900	0	20,900		
1ST MORTGAGE 0			2013	5,200	16,900	0	22,100		
2ND MORTGAGE 0			2015	5,200	16,900	0	22,100		
Zone/Land Use 1 Residential			2018	5,200	0	0	5,200		
Secondary Zone			2019	5,500	0	0	5,500		
Topography 1 Level			2020	5,500	0	0	5,500		
1.Level 4.Below St 7.LevelBog			2022	5,500	0	0	5,500		
2.Rolling 5.Low 8.			2023	6,800	0	0	6,800		
3.Above St 6.Swampy 9.			2024	6,800	0	0	6,800		
Utilities									
1.Public 4.Dr Well 7.Cesspool									
2.Water 5.Dug Well 8.									
3.Sewer 6.Septic 9.None									
Street 1 Paved									
1.Paved 4.Proposed 7.									
2.Semi Imp 5.R/O/W 8.									
3.Gravel 6. 9.None									
TG PLAN YEAR 0									
Tif District # 0									
Sale Data			Land Data						
Sale Date 4/07/2004			Front Foot	Type	Effective		Influence		Influence Codes
Price 4,000					Frontage	Depth	Factor	Code	
Sale Type 1 Land Only			11.Regular Lot					1.Unimproved	
1.Land 4.Mobile 7.C/I L&B			12.Delta Triangle					2.Excess Frtg	
2.L & B 5.Other 8.			13.Nabla Triangle					3.Topography	
3.Building 6.C/I Land 9.			14.Rear Land					4.Size/Shape	
Financing 1 Conventional			15.Class I Road					5.Access	
1.Convent 4.Seller 7.								6.Restriction	
2.FHA/VA 5.Private 8.								7.Open Space	
3.Assumed 6.Cash 9.Unknown								8.View/Environ	
Validity 3 Distressed Sale								9.Fract Share	
1.Valid 4.Split 7.Renovate			Square Foot	Square Feet				Acres	
2.Related 5.Partial 8.Other			16.Class II Road					30.Utility R O W	
3.Distress 6.Exempt 9.			17.Municipal Rese					31.Tillable	
Verified 5 Public Record			18.Munic Sep Lago					32.Pasture	
1.Buyer 4.Agent 7.Family			19.Gravel Pit					33.Orchard	
2.Seller 5.Pub Rec 8.Other			20.Industrial Bas					34.Softwood F&O	
3.Lender 6.MLS 9.								35.Mixed Wood F&O	
			Fract. Acre					36.Hardwood F&O	
			21.Developed Pave	22	0.38	100	%	0	
			22.Undev Paved (F					%	
			23.Developed Grav					%	
			Acres					%	
			24.Undev Gravel (%	
			25.Comm Base Pave					%	
			26.Comm Base Grav					%	
			27.Backlot					%	
			28.Rear Land					%	
			29.Pavement					%	
			Total Acreage		0.38				
									44.Lot Improvemen
									45.Subdivision Lo
									46.Heavy Ind Sit

Washburn

Map Lot 002-004

Account 906

Location 833 WASHBURN ROAD

Card 1 Of 1 9/04/2024

Building Style 0	SF Bsmt Living 0	Layout 0
1.Conv. 5.Garrison 9.Gambrel	Fin Bsmt Grade 0 0	1.Typical 4. 7.
2.Ranch 6.Salt Box 10.Other	OPEN 5 OPTIONAL 0	2.Inadeq 5. 8.
3.R Ranch 7.Contemp 11.Split	Heat Type 100% 0	3.Poor 6. 9.
4.Cape 8.Log 12.	1.HWBB 5.FWA 9.No Heat	Attic 0
Dwelling Units 0	2.HWCI 6.GravWA 10.	1.1/4 Fin 4.Full Fin 7.
Other Units 0	3.H Pump 7.Electric 11.	2.1/2 Fin 5.F/Stair 8.
Stories 0	4.Steam 8.F/Wall 12.	3.3/4 Fin 6. 9.None
1.1 4.1.5 7.	Cool Type 0% 9 None	Insulation 0
2.2 5.1.75 8.	1.Refrig 4.W&C Air 7.	1.Full 4.Minimal 7.
3.3 6.2.5 9.	2.Evapor 5. 8.	2.Heavy 5.Partial 8.
Exterior Walls 0	3.H Pump 6. 9.None	3.Capped 6. 9.None
1.Wood 5.Stucco 9.T-111	Kitchen Style 0	Unfinished % 0%
2.Vin/Al 6.Brick 10.Other	1.Modern 4.Obsolete 7.	Grade & Factor 0 0%
3.Compos. 7.Stone 11.	2.Typical 5. 8.	1.E Grade 4.B Grade 7.
4.Asbestos 8.Concrete 12.	3.Old Type 6. 9.None	2.D Grade 5.A Grade 8.SC Grade
Roof Surface 0	Bath(s) Style 0	3.C Grade 6.AA Grade 9.Same
1.Asphalt 4.Composit 7.	1.Modern 4.Obsolete 7.	SQFT (Footprint) 0
2.Slate 5.Wood 8.	2.Typical 5. 8.	Condition 0
3.Metal 6.Other 9.	3.Old Type 6. 9.None	1.Poor 4.Avg 7.V G
SF Masonry Trim 0	# Rooms 0	2.Fair 5.Avg+ 8.Exc
OPEN-3-CUSTOM 0	# Bedrooms 0	3.Avg- 6.Good 9.Same
OPEN-4-CUSTOM 0	# Full Baths 0	Phys. % Good 0%
Year Built 0	# Half Baths 0	Funct. % Good 100%
Year Remodeled 0	# Addn Fixtures 0	Functional Code 9 None
Foundation 0	# Fireplaces 0	1.Incomp 4.Delap 7.No Power
1.Concrete 4.Wood 7.		2.O-Built 5.Bsmt 8.LongTerm
2.C Block 5.Slab 8.		3.Damage 6.Common 9.None
3.Br/Stone 6.Piers 9.		Econ. % Good 100%
Basement 0		Economic Code None
1.1/4 Bmt 4.Full Bmt 7.		0.None 3.No Power 7.
2.1/2 Bmt 5.None 8.		1.Location 4.Generate 8.
3.3/4 Bmt 6. 9.None		2.Encroach 9.None 9.
Bsmt Gar # Cars 0		Entrance Code 0
Wet Basement 0		1.Interior 4.Vacant 7.
1.Dry 4. 7.		2.Refusal 5.Estimate 8.
2.Damp 5. 8.	3.Informed 6.Reviewed 9.	
3.Wet 6. 9.	Information Code 0	
		1.Owner 4.Agent 7.
		2.Relative 5.Estimate 8.
		3.Tenant 6.Other 9.

Date Inspected

Additions, Outbuildings & Improvements

Type	Year	Units	Grade	Cond	Phys.	Funct.	Sound Value
					%	%	1.One Story Fram
					%	%	2.Two Story Fram
					%	%	3.Three Story Fr
					%	%	4.1 & 1/2 Story
					%	%	5.1 & 3/4 Story
					%	%	6.2 & 1/2 Story
					%	%	21.Open Frame Por
					%	%	22.Encl Frame Por
					%	%	23.Frame Garage
					%	%	24.Frame Shed
					%	%	25.Frame Bay Wind
					%	%	26.1SFr Overhang
					%	%	27.Unfin Basement
					%	%	28.Unfinished Att
					%	%	29.Finished Attic

Washburn

Map Lot 002-006B

Account 182

Location 723 WASHBURN ROAD

Card 1

Of 1

9/04/2024

Building Style 1 Conventional	SF Bsmt Living 0	Layout 1 Typical
1.Conv. 5.Garrison 9.Gambrel	Fin Bsmt Grade 0 0	1.Typical 4. 7.
2.Ranch 6.Salt Box 10.Other	OPEN 5 OPTIONAL 0	2.Inadeq 5. 8.
3.R Ranch 7.Contemp 11.Split	Heat Type 100% 1 Hot Water BB	3.Poor 6. 9.
4.Cape 8.Log 12.	1.HWBB 5.FWA 9.No Heat	Attic 9 None
Dwelling Units 1	2.HWCI 6.GravWA 10.	1.1/4 Fin 4.Full Fin 7.
Other Units 0	3.H Pump 7.Electric 11.	2.1/2 Fin 5.FI/Stair 8.
Stories 4 One & 1/2 Story	4.Steam 8.FI/Wall 12.	3.3/4 Fin 6. 9.None
1.1 4.1.5 7.	Cool Type 0% 9 None	Insulation 4 Minimal
2.2 5.1.75 8.	1.Refrig 4.W&C Air 7.	1.Full 4.Minimal 7.
3.3 6.2.5 9.	2.Evapor 5. 8.	2.Heavy 5.Partial 8.
Exterior Walls 1 Wood Siding	3.H Pump 6. 9.None	3.Capped 6. 9.None
1.Wood 5.Stucco 9.T-111	Kitchen Style 2 Typical	Unfinished % 0%
2.Vin/Al 6.Brick 10.Other	1.Modern 4.Obsolete 7.	Grade & Factor 3 Average 100%
3.Compos. 7.Stone 11.	2.Typical 5. 8.	1.E Grade 4.B Grade 7.
4.Asbestos 8.Concrete 12.	3.Old Type 6. 9.None	2.D Grade 5.A Grade 8.SC Grade
Roof Surface 1 Asphalt Shingles	Bath(s) Style 2 Typical Bath(s)	3.C Grade 6.AA Grade 9.Same
1.Asphalt 4.Composit 7.	1.Modern 4.Obsolete 7.	SQFT (Footprint) 1632
2.Slate 5.Wood 8.	2.Typical 5. 8.	Condition 4 Average
3.Metal 6.Other 9.	3.Old Type 6. 9.None	1.Poor 4.Avg 7.V G
SF Masonry Trim 0	# Rooms 8	2.Fair 5.Avg+ 8.Exc
OPEN-3-CUSTOM 0	# Bedrooms 4	3.Avg- 6.Good 9.Same
OPEN-4-CUSTOM 0	# Full Baths 3	Phys. % Good 0%
Year Built 2018	# Half Baths 0	Funct. % Good 100%
Year Remodeled 1850	# Addn Fixtures 0	Functional Code 9 None
Foundation 1 Concrete	# Fireplaces 0	1.Incomp 4.Delap 7.No Power
1.Concrete 4.Wood 7.	 <p>TRIO Software A Division of Harris Computer Systems</p>	2.O-Built 5.Bsmt 8.LongTerm
2.C Block 5.Slab 8.		3.Damage 6.Common 9.None
3.Br/Stone 6.Piers 9.		Econ. % Good 100%
Basement 3 3/4 Basement		Economic Code None
1.1/4 Bmt 4.Full Bmt 7.		0.None 3.No Power 7.
2.1/2 Bmt 5.None 8.		1.Location 4.Generate 8.
3.3/4 Bmt 6. 9.None		2.Encroach 9.None 9.
Bsmt Gar # Cars 0		Entrance Code 1 Interior Inspect
Wet Basement 3 Wet Basement		1.Interior 4.Vacant 7.
1.Dry 4. 7.		2.Refusal 5.Estimate 8.
2.Damp 5. 8.	3.Informed 6.Reviewed 9.	
3.Wet 6. 9.	Information Code 1 Owner	
	1.Owner 4.Agent 7.	
	2.Relative 5.Estimate 8.	
	3.Tenant 6.Other 9.	

Date Inspected 8/02/2018

Additions, Outbuildings & Improvements

Type	Year	Units	Grade	Cond	Phys.	Funct.	Sound Value
21 Open Frame	0	272	0 0	0	0 %	0 %	
22 Encl Frame Porch	0	288	9 100	4	0 %	100 %	
68 Wood Deck	2010	354	3 100	4	0 %	100 %	
85 Camper Trlr	0				%	%	300
23 Frame Garage	1900	528	2 110	3	0 %	100 %	
61 Canopy	2000	120	2 90	4	0 %	100 %	
					%	%	
					%	%	
					%	%	
					%	%	
					%	%	

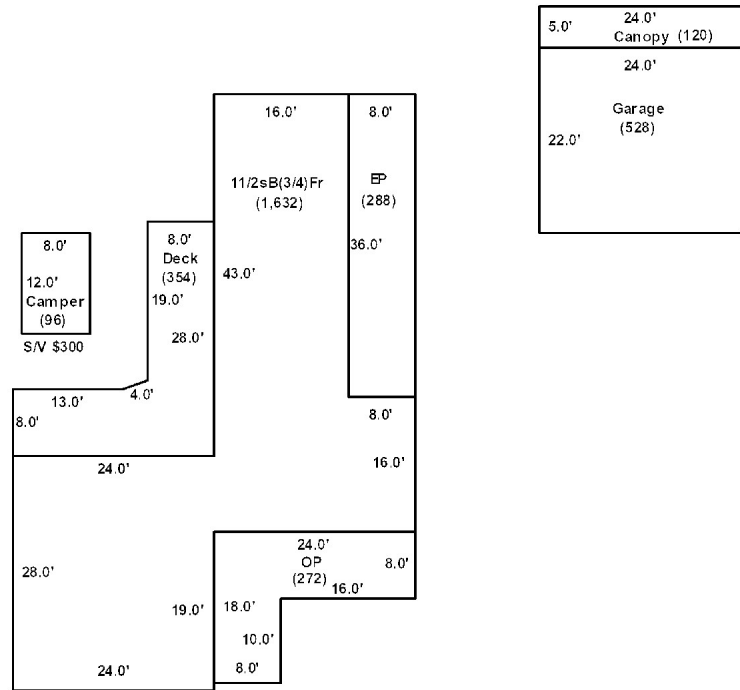

PHILBRICK, ROBERT D
PHILBRICK, PATRICIA J
79 Center Drive
Orrington ME 04474

B1014P354

Inspection Witnessed By:

X	Date	Date Insp.
No./Date	Description	Date Insp.

Notes:

*Dwelling has 30A box w/ fuse info. given at reval.

Washburn

Property Data			Assessment Record						
Neighborhood 1 Neighborhood One			Year	Land	Buildings	Exempt	Total		
Tree Growth Year 0			2012	6,500	39,400	8,800	37,100		
1ST MORTGAGE 0			2013	8,500	39,400	8,800	39,100		
2ND MORTGAGE 0			2015	8,500	39,400	9,000	38,900		
Zone/Land Use 1 Residential			2018	8,500	39,400	18,400	29,500		
Secondary Zone			2019	16,500	45,700	20,000	42,200		
Topography 1 Level			2020	16,500	45,700	25,000	37,200		
1.Level 4.Below St 7.LevelBog			2022	16,500	47,900	0	64,400		
2.Rolling 5.Low 8.			2023	22,000	57,000	0	79,000		
3.Above St 6.Swampy 9.			2024	22,000	57,000	0	79,000		
Utilities 4 Drilled Well 6 Septic System									
1.Public 4.Dr Well 7.Cesspool									
2.Water 5.Dug Well 8.									
3.Sewer 6.Septic 9.None									
Street 1 Paved									
1.Paved 4.Proposed 7.									
2.Semi Imp 5.R/O/W 8.									
3.Gravel 6. 9.None									
TG PLAN YEAR 0									
Tif District # 0									
Sale Data			Land Data						
Sale Date 9/28/1967			Front Foot	Type	Effective		Influence		Influence Codes
Price					Frontage	Depth	Factor	Code	
Sale Type 2 Land & Buildings			11.Regular Lot					1.Unimproved	
1.Land 4.Mobile 7.C/I L&B			12.Delta Triangle					2.Excess Frtg	
2.L & B 5.Other 8.			13.Nabla Triangle					3.Topography	
3.Building 6.C/I Land 9.			14.Rear Land					4.Size/Shape	
Financing			15.Class I Road					5.Access	
1.Convent 4.Seller 7.								6.Restriction	
2.FHA/VA 5.Private 8.								7.Open Space	
3.Assumed 6.Cash 9.Unknown								8.View/Environ	
Validity 1 Arms Length Sale								9.Fract Share	
1.Valid 4.Split 7.Renovate			Square Foot	Square Feet				Acres	
2.Related 5.Partial 8.Other			16.Class II Road					30.Utility R O W	
3.Distress 6.Exempt 9.			17.Municipal Rese					31.Tillable	
Verified 5 Public Record			18.Munic Sep Lago					32.Pasture	
1.Buyer 4.Agent 7.Family			19.Gravel Pit					33.Orchard	
2.Seller 5.Pub Rec 8.Other			20.Industrial Bas					34.Softwood F&O	
3.Lender 6.MLS 9.								35.Mixed Wood F&O	
			Fract. Acre					36.Hardwood F&O	
			21.Developed Pave	21	1.00	100	%	0	
			22.Undev Paved (F					%	
			23.Developed Grav					%	
			Acres					%	
			24.Undev Gravel (%	
			25.Comm Base Pave					%	
			26.Comm Base Grav					%	
			27.Backlot					%	
			28.Rear Land					%	
			29.Pavement					%	
			Total Acreage 1.00						44.Lot Improvemen
									45.Subdivision Lo
									46.Heavy Ind Sit

Washburn

Map Lot 002-007

Account 617

Location 697 WASHBURN ROAD

Card 1 Of 1 9/04/2024

Building Style	1 Conventional			SF Bsmt Living	0			Layout	1 Typical		
1.Conv.	5.Garrison	9.Gambrel		Fin Bsmt Grade	0 0			1.Typical	4.	7.	
2.Ranch	6.Salt Box	10.Other		OPEN 5 OPTIONAL	0			2.Inadeq	5.	8.	
3.R Ranch	7.Contemp	11.Split		Heat Type	100% 1 Hot Water BB			3.Pool	6.	9.	
4.Cape	8.Log	12.		1.HWBB	5.FWA	9.No Heat		Attic	9 None		
Dwelling Units	1			2.HWCI	6.GravWA	10.		1.1/4 Fin	4.Full Fin	7.	
Other Units	0			3.H Pump	7.Electric	11.		2.1/2 Fin	5.FI/Stair	8.	
Stories	4 One & 1/2 Story			4.Steam	8.FI/Wall	12.		3.3/4 Fin	6.	9.None	
1.1	4.1.5	7.		Cool Type	0% 9 None			1.Full	4.Minimal	7.	
2.2	5.1.75	8.		1.Refrig	4.W&C Air	7.		2.Heavy	5.Partial	8.	
3.3	6.2.5	9.		2.Evapor	5.	8.		3.Capped	6.	9.None	
Exterior Walls	3 Composition			3.H Pump	6.	9.None		Insulation	1 Full		
1.Wood	5.Stucco	9.T-111		Kitchen Style	2 Typical			1.Full	4.Minimal	7.	
2.Vin/Al	6.Brick	10.Other		1.Modern	4.Obsolete	7.		2.Heavy	5.Partial	8.	
3.Compos.	7.Stone	11.		2.Typical	5.	8.		3.Capped	6.	9.None	
4.Asbestos	8.Concrete	12.		3.Old Type	6.	9.None		Unfinished %	0%		
Roof Surface	1 Asphalt Shingles			1.Modern	4.Obsolete	7.		Grade & Factor	2 Fair 100%		
1.Asphalt	4.Composit	7.		2.Typical	5.	8.		1.E Grade	4.B Grade	7.	
2.Slate	5.Wood	8.		3.Old Type	6.	9.None		2.D Grade	5.A Grade	8.SC Grade	
3.Metal	6.Other	9.		Bath(s) Style	2 Typical Bath(s)			3.C Grade	6.AA Grade	9.Same	
SF Masonry Trim	0			1.Modern	4.Obsolete	7.		SQFT (Footprint)	900		
OPEN-3-CUSTOM	0			2.Typical	5.	8.		Condition	3 Below Average		
OPEN-4-CUSTOM	0			3.Old Type	6.	9.None		1.Poor	4.Avg	7.V G	
Year Built	1955			# Rooms	6			2.Fair	5.Avg+	8.Exc	
Year Remodeled	0			# Bedrooms	4			3.Avg-	6.Good	9.Same	
Foundation	1 Concrete			# Full Baths	1			Phys. % Good	0%		
1.Concrete	4.Wood	7.		# Half Baths	0			Funct. % Good	80%		
2.C Block	5.Slab	8.		# Addn Fixtures	0			Functional Code	4 Delapidation		
3.Br/Stone	6.Piers	9.		# Fireplaces	0			1.Incomp	4.Delap	7.No Power	
Basement	4 Full Basement										
1.1/4 Bmt	4.Full Bmt	7.									
2.1/2 Bmt	5.None	8.									
3.3/4 Bmt	6.	9.None									
Bsmt Gar # Cars	0										
Wet Basement	2 Damp Basement										
1.Dry	4.	7.									
2.Damp	5.	8.									
3.Wet	6.	9.									
Economic Code	None										
0.None	3.No Power	7.									
1.Location	4.Generate	8.									
2.Encroach	9.None	9.									
Entrance Code	1 Interior Inspect										
1.Interior	4.Vacant	7.									
2.Refusal	5.Estimate	8.									
3.Informed	6.Reviewed	9.									
Information Code	1 Owner										
1.Owner	4.Agent	7.									
2.Relative	5.Estimate	8.									
3.Tenant	6.Other	9.									

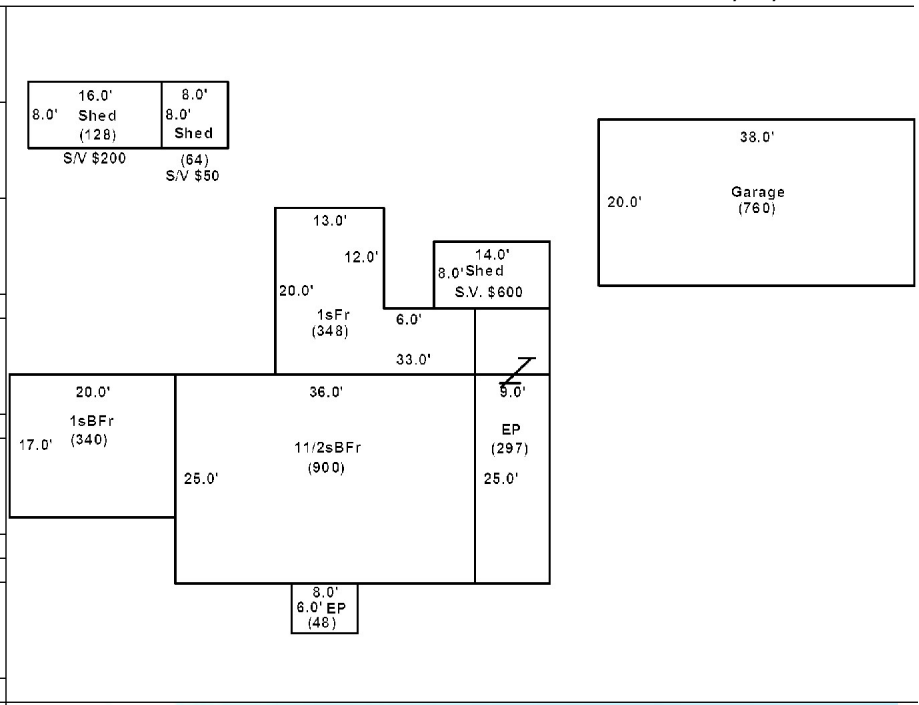

Date Inspected 6/19/2019

Additions, Outbuildings & Improvements

Type	Year	Units	Grade	Cond	Phys.	Funct.	Sound Value
20 1 Story/Bsmt	1990	340	0 0	0	0 %	0 %	
22 Encl Frame Porch	0	297	0 0	0	0 %	0 %	
22 Encl Frame Porch	0	48	0 0	0	0 %	0 %	
1 One Story Frame	1980	348	0 0	0	0 %	80 %	
23 Frame Garage	0	760	0 0	0	0 %	0 %	
24 Frame Shed	0	128	0 0	0	0 %	0 %	
24 Frame Shed	0	64	0 0	0	0 %	0 %	
24 Frame Shed	0				%	%	600
					%	%	
					%	%	



BUSSE, WILLIAM J
689 WASHBURN ROAD
WASHBURN ME 04786

B1347P179 B4701P216 B4888P259 B5635P8 B5689P148

Inspection Witnessed By:

No./Date	Description	Date Insp.
X		

Notes:

Washburn

Property Data			Assessment Record						
Neighborhood 1 Neighborhood One			Year	Land	Buildings	Exempt	Total		
Tree Growth Year 0			2012	5,900	47,800	8,800	44,900		
1ST MORTGAGE 0			2013	7,600	48,300	8,800	47,100		
2ND MORTGAGE 0			2015	7,600	48,300	9,000	46,900		
Zone/Land Use 1 Residential			2018	7,600	48,300	18,400	37,500		
Secondary Zone			2019	14,900	53,000	20,000	47,900		
Topography 1 Level			2020	14,900	53,000	25,000	42,900		
1.Level 4.Below St 7.LevelBog			2021	14,900	53,000	25,000	42,900		
2.Rolling 5.Low 8.			2022	14,900	55,700	25,000	45,600		
3.Above St 6.Swampy 9.			2023	19,800	66,300	25,000	61,100		
Utilities 4 Drilled Well 6 Septic System			2024	19,800	66,300	25,000	61,100		
1.Public 4.Dr Well 7.Cesspool									
2.Water 5.Dug Well 8.									
3.Sewer 6.Septic 9.None									
Street 1 Paved									
1.Paved 4.Proposed 7.									
2.Semi Imp 5.R/O/W 8.									
3.Gravel 6. 9.None									
TG PLAN YEAR 0									
Tif District # 0									
Sale Data			Land Data						
Sale Date 4/18/1978			Front Foot	Type	Effective		Influence		Influence Codes
Price					Frontage	Depth	Factor	Code	
Sale Type 2 Land & Buildings			11.Regular Lot					1.Unimproved	
1.Land 4.Mobile 7.C/I L&B			12.Delta Triangle					2.Excess Frtg	
2.L & B 5.Other 8.			13.Nabla Triangle					3.Topography	
3.Building 6.C/I Land 9.			14.Rear Land					4.Size/Shape	
Financing 1 Conventional			15.Class I Road					5.Access	
1.Convent 4.Seller 7.								6.Restriction	
2.FHA/VA 5.Private 8.								7.Open Space	
3.Assumed 6.Cash 9.Unknown								8.View/Environ	
Validity 1 Arms Length Sale								9.Fract Share	
1.Valid 4.Split 7.Renovate			Square Foot	Square Feet				Acres	
2.Related 5.Partial 8.Other			16.Class II Road					30.Utility R O W	
3.Distress 6.Exempt 9.			17.Municipal Rese					31.Tillable	
Verified 5 Public Record			18.Munic Sep Lago					32.Pasture	
1.Buyer 4.Agent 7.Family			19.Gravel Pit					33.Orchard	
2.Seller 5.Pub Rec 8.Other			20.Industrial Bas					34.Softwood F&O	
3.Lender 6.MLS 9.								35.Mixed Wood F&O	
			Fract. Acre					36.Hardwood F&O	
			21.Developed Pave	21	0.81	100	%	0	
			22.Undev Paved (F					%	
			23.Developed Grav					%	
			Acres					%	
			24.Undev Gravel (%	
			25.Comm Base Pave					%	
			26.Comm Base Grav					%	
			27.Backlot					%	
			28.Rear Land					%	
			29.Pavement					%	
			Total Acreage		0.81				
								44.Lot Improvemen	
								45.Subdivision Lo	
								46.Heavy Ind Sit	

Washburn

Map Lot 002-008

Account 72

Location 689 WASHBURN ROAD

Card 1 Of 1 9/04/2024

Building Style 2 Ranch	SF Bsmt Living 0	Layout 1 Typical
1.Conv. 5.Garrison 9.Gambrel	Fin Bsmt Grade 0 0	1.Typical 4. 7.
2.Ranch 6.Salt Box 10.Other	OPEN 5 OPTIONAL 0	2.Inadeq 5. 8.
3.R Ranch 7.Contemp 11.Split	Heat Type 100% 1 Hot Water BB	3.Pool 6. 9.
4.Cape 8.Log 12.	1.HWBB 5.FWA 9.No Heat	Attic 9 None
Dwelling Units 1	2.HWCI 6.GravWA 10.	1.1/4 Fin 4.Full Fin 7.
Other Units 0	3.H Pump 7.Electric 11.	2.1/2 Fin 5.FI/Stair 8.
Stories 1 One Story	4.Steam 8.FI/Wall 12.	3.3/4 Fin 6. 9.None
1.1 4.1.5 7.	Cool Type 0% 9 None	Insulation 1 Full
2.2 5.1.75 8.	1.Refrig 4.W&C Air 7.	1.Full 4.Minimal 7.
3.3 6.2.5 9.	2.Evapor 5. 8.	2.Heavy 5.Partial 8.
Exterior Walls 2 Vinyl/Aluminum	3.H Pump 6. 9.None	3.Capped 6. 9.None
1.Wood 5.Stucco 9.T-111	Kitchen Style 2 Typical	Unfinished % 0%
2.Vin/Al 6.Brick 10.Other	1.Modern 4.Obsolete 7.	Grade & Factor 3 Average 100%
3.Compos. 7.Stone 11.	2.Typical 5. 8.	1.E Grade 4.B Grade 7.
4.Asbestos 8.Concrete 12.	3.Old Type 6. 9.None	2.D Grade 5.A Grade 8.SC Grade
Roof Surface 1 Asphalt Shingles	Bath(s) Style 2 Typical Bath(s)	3.C Grade 6.AA Grade 9.Same
1.Asphalt 4.Composit 7.	1.Modern 4.Obsolete 7.	SQFT (Footprint) 960
2.Slate 5.Wood 8.	2.Typical 5. 8.	Condition 6 Good
3.Metal 6.Other 9.	3.Old Type 6. 9.None	1.Poor 4.Avg 7.V G
SF Masonry Trim 0	# Rooms 5	2.Fair 5.Avg+ 8.Exc
OPEN-3-CUSTOM 0	# Bedrooms 2	3.Avg- 6.Good 9.Same
OPEN-4-CUSTOM 0	# Full Baths 1	Phys. % Good 0%
Year Built 1972	# Half Baths 0	Funct. % Good 100%
Year Remodeled 0	# Addn Fixtures 0	Functional Code 9 None
Foundation 1 Concrete	# Fireplaces 0	1.Incomp 4.Delap 7.No Power
1.Concrete 4.Wood 7.	 <p>TRIO Software A Division of Harris Computer Systems</p>	2.O-Built 5.Bsmt 8.LongTerm
2.C Block 5.Slab 8.		3.Damage 6.Common 9.None
3.Br/Stone 6.Piers 9.		Econ. % Good 100%
Basement 4 Full Basement		Economic Code None
1.1/4 Bmt 4.Full Bmt 7.		0.None 3.No Power 7.
2.1/2 Bmt 5.None 8.		1.Location 4.Generate 8.
3.3/4 Bmt 6. 9.None		2.Encroach 9.None 9.
Bsmt Gar # Cars 0		Entrance Code 1 Interior Inspect
Wet Basement 2 Damp Basement		1.Interior 4.Vacant 7.
1.Dry 4. 7.		2.Refusal 5.Estimate 8.
2.Damp 5. 8.	3.Informed 6.Reviewed 9.	
3.Wet 6. 9.	Information Code 1 Owner	
		1.Owner 4.Agent 7.
		2.Relative 5.Estimate 8.
		3.Tenant 6.Other 9.

Date Inspected 8/05/2018

Additions, Outbuildings & Improvements

Type	Year	Units	Grade	Cond	Phys.	Funct.	Sound Value
68 Wood Deck	2000	768	3 105	4	0 %	100 %	
40 Basement Entry	1972	30	9 100	9	0 %	100 %	
					%	%	
					%	%	
					%	%	
					%	%	
					%	%	
					%	%	
					%	%	
					%	%	
					%	%	
					%	%	

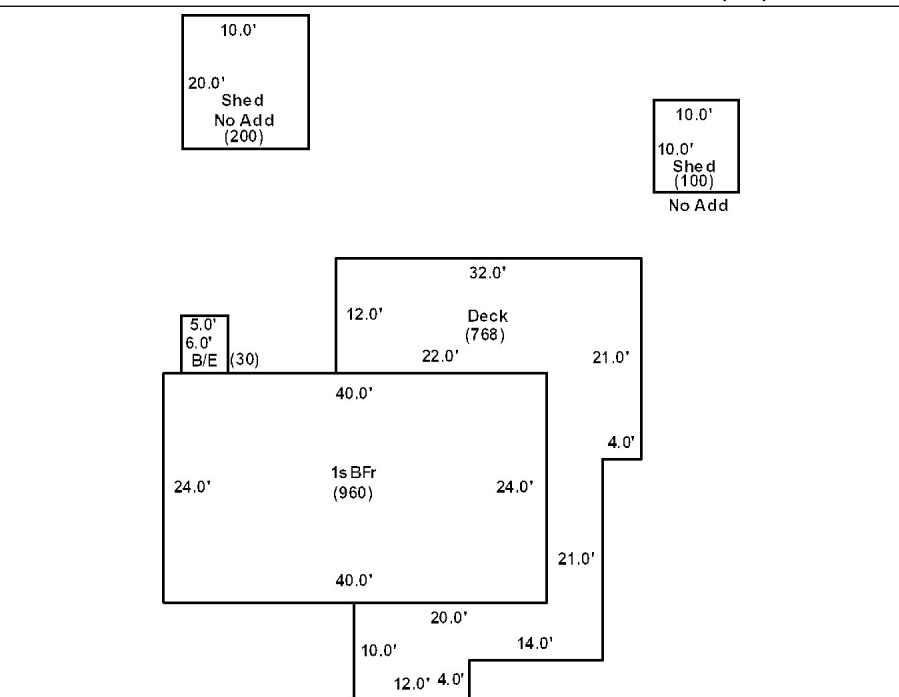

HKS PARTNERSHIP
76 TURNPIKE ROAD
WILLINGTON CT 06279

B5981P234 B5981P243

Previous Owner
KLEI, HOWARD
173 ELK ROAD

MONROEVILLE NJ 04343
Sale Date: 1/24/2020

Previous Owner
HKS PARTNERSHIP
76 TURNPIKE ROAD

WILMINGTON CT 06279
Sale Date: 1/01/2020

Previous Owner
NATIONSTAR MORTGAGE LLC
8950 CYPRESS WATERS BLVD

COPPELL TX 75019
Sale Date: 6/24/2019

Inspection Witnessed By:

X	Date
No./Date	Description
	Date Insp.

Notes:

- *Removed all building on property 6/13/2022 - RD
- * 2022 updated TG Plan
- * Bk 5981 Pg 234 combines lots 2-1 and 2-6A with lot 2-10. There are now 488.76 acres on lot 2-10.
- * Dwelling assessed at 50% at time of reval due to delap. Barn - 50% for delap during reval.

Washburn

Property Data			Assessment Record																																																																																																																																																																																																												
Neighborhood 1 Neighborhood One			Year	Land	Buildings	Exempt	Total																																																																																																																																																																																																								
Tree Growth Year 2032			2012	24,200	95,600	8,800	111,000																																																																																																																																																																																																								
1ST MORTGAGE 0			2013	31,400	90,500	8,800	113,100																																																																																																																																																																																																								
2ND MORTGAGE 0			2015	31,400	90,500	0	121,900																																																																																																																																																																																																								
Zone/Land Use 1 Residential			2018	31,400	90,500	0	121,900																																																																																																																																																																																																								
Secondary Zone			2019	59,000	30,900	0	89,900																																																																																																																																																																																																								
Topography 1 Level			2020	132,700	30,800	0	163,500																																																																																																																																																																																																								
1.Level 4.Below St 7.LevelBog			2021	127,200	30,900	0	158,100																																																																																																																																																																																																								
2.Rolling 5.Low 8.			2022	105,600	0	0	105,600																																																																																																																																																																																																								
3.Above St 6.Swampy 9.			2023	112,300	0	0	112,300																																																																																																																																																																																																								
Utilities 4 Drilled Well 6 Septic System			2024	112,300	0	0	112,300																																																																																																																																																																																																								
1.Public 4.Dr Well 7.Cesspool																																																																																																																																																																																																															
2.Water 5.Dug Well 8.																																																																																																																																																																																																															
3.Sewer 6.Septic 9.None																																																																																																																																																																																																															
Street 1 Paved																																																																																																																																																																																																															
1.Paved 4.Proposed 7.																																																																																																																																																																																																															
2.Semi Imp 5.R/O/W 8.																																																																																																																																																																																																															
3.Gravel 6. 9.None																																																																																																																																																																																																															
TG PLAN YEAR 2022			<table border="1"> <thead> <tr> <th rowspan="2">Front Foot</th> <th rowspan="2">Type</th> <th colspan="2">Effective</th> <th colspan="2">Influence</th> <th rowspan="2">Influence Codes</th> </tr> <tr> <th>Frontage</th> <th>Depth</th> <th>Factor</th> <th>Code</th> </tr> </thead> <tbody> <tr><td>11.Regular Lot</td><td></td><td></td><td></td><td>%</td><td></td><td>1.Unimproved</td></tr> <tr><td>12.Delta Triangle</td><td></td><td></td><td></td><td>%</td><td></td><td>2.Excess Frtg</td></tr> <tr><td>13.Nabla Triangle</td><td></td><td></td><td></td><td>%</td><td></td><td>3.Topography</td></tr> <tr><td>14.Rear Land</td><td></td><td></td><td></td><td>%</td><td></td><td>4.Size/Shape</td></tr> <tr><td>15.Class I Road</td><td></td><td></td><td></td><td>%</td><td></td><td>5.Access</td></tr> <tr><td></td><td></td><td></td><td></td><td>%</td><td></td><td>6.Restriction</td></tr> <tr><td></td><td></td><td></td><td></td><td>%</td><td></td><td>7.Open Space</td></tr> <tr><td></td><td></td><td></td><td></td><td>%</td><td></td><td>8.View/Environ</td></tr> <tr><td></td><td></td><td></td><td></td><td>%</td><td></td><td>9.Fract Share</td></tr> <tr><td></td><td></td><td></td><td></td><td>%</td><td></td><td>Acres</td></tr> <tr><td></td><td></td><td></td><td></td><td>%</td><td></td><td>30.Utility R O W</td></tr> <tr><td></td><td></td><td></td><td></td><td>%</td><td></td><td>31.Tillable</td></tr> <tr><td></td><td></td><td></td><td></td><td>%</td><td></td><td>32.Pasture</td></tr> <tr><td></td><td></td><td></td><td></td><td>%</td><td></td><td>33.Orchard</td></tr> <tr><td></td><td></td><td></td><td></td><td>%</td><td></td><td>34.Softwood F&O</td></tr> <tr><td></td><td></td><td></td><td></td><td>%</td><td></td><td>35.Mixed Wood F&O</td></tr> <tr><td></td><td></td><td></td><td></td><td>%</td><td></td><td>36.Hardwood F&O</td></tr> <tr><td></td><td></td><td></td><td></td><td>%</td><td></td><td>37.Softwood TG</td></tr> <tr><td></td><td></td><td></td><td></td><td>%</td><td></td><td>38.Mixed Wood TG</td></tr> <tr><td></td><td></td><td></td><td></td><td>%</td><td></td><td>39.Hardwood TG</td></tr> <tr><td></td><td></td><td></td><td></td><td>%</td><td></td><td>40.Wasteland</td></tr> <tr><td></td><td></td><td></td><td></td><td>%</td><td></td><td>41.Open Space</td></tr> <tr><td></td><td></td><td></td><td></td><td>%</td><td></td><td>42.Mobile Home Si</td></tr> <tr><td></td><td></td><td></td><td></td><td>%</td><td></td><td>43.Condo Site</td></tr> <tr><td></td><td></td><td></td><td></td><td>%</td><td></td><td>44.Lot Improvemen</td></tr> <tr><td></td><td></td><td></td><td></td><td>%</td><td></td><td>45.Subdivision Lo</td></tr> <tr><td></td><td></td><td></td><td></td><td>%</td><td></td><td>46.Heavy Ind Sit</td></tr> </tbody> </table>					Front Foot	Type	Effective		Influence		Influence Codes	Frontage	Depth	Factor	Code	11.Regular Lot				%		1.Unimproved	12.Delta Triangle				%		2.Excess Frtg	13.Nabla Triangle				%		3.Topography	14.Rear Land				%		4.Size/Shape	15.Class I Road				%		5.Access					%		6.Restriction					%		7.Open Space					%		8.View/Environ					%		9.Fract Share					%		Acres					%		30.Utility R O W					%		31.Tillable					%		32.Pasture					%		33.Orchard					%		34.Softwood F&O					%		35.Mixed Wood F&O					%		36.Hardwood F&O					%		37.Softwood TG					%		38.Mixed Wood TG					%		39.Hardwood TG					%		40.Wasteland					%		41.Open Space					%		42.Mobile Home Si					%		43.Condo Site					%		44.Lot Improvemen					%		45.Subdivision Lo					%		46.Heavy Ind Sit
Front Foot	Type	Effective								Influence		Influence Codes																																																																																																																																																																																																			
		Frontage	Depth	Factor	Code																																																																																																																																																																																																										
11.Regular Lot				%		1.Unimproved																																																																																																																																																																																																									
12.Delta Triangle				%		2.Excess Frtg																																																																																																																																																																																																									
13.Nabla Triangle				%		3.Topography																																																																																																																																																																																																									
14.Rear Land				%		4.Size/Shape																																																																																																																																																																																																									
15.Class I Road				%		5.Access																																																																																																																																																																																																									
				%		6.Restriction																																																																																																																																																																																																									
				%		7.Open Space																																																																																																																																																																																																									
				%		8.View/Environ																																																																																																																																																																																																									
				%		9.Fract Share																																																																																																																																																																																																									
				%		Acres																																																																																																																																																																																																									
				%		30.Utility R O W																																																																																																																																																																																																									
				%		31.Tillable																																																																																																																																																																																																									
				%		32.Pasture																																																																																																																																																																																																									
				%		33.Orchard																																																																																																																																																																																																									
				%		34.Softwood F&O																																																																																																																																																																																																									
				%		35.Mixed Wood F&O																																																																																																																																																																																																									
				%		36.Hardwood F&O																																																																																																																																																																																																									
				%		37.Softwood TG																																																																																																																																																																																																									
				%		38.Mixed Wood TG																																																																																																																																																																																																									
				%		39.Hardwood TG																																																																																																																																																																																																									
				%		40.Wasteland																																																																																																																																																																																																									
				%		41.Open Space																																																																																																																																																																																																									
				%		42.Mobile Home Si																																																																																																																																																																																																									
				%		43.Condo Site																																																																																																																																																																																																									
				%		44.Lot Improvemen																																																																																																																																																																																																									
				%		45.Subdivision Lo																																																																																																																																																																																																									
				%		46.Heavy Ind Sit																																																																																																																																																																																																									
Tif District # 0			Land Data																																																																																																																																																																																																												
Sale Data			Front Foot		Square Feet		Acres																																																																																																																																																																																																								
			11.Regular Lot		22.Developed Pave																																																																																																																																																																																																										
Sale Date 1/24/2020			12.Delta Triangle		28		23.Developed Grav																																																																																																																																																																																																								
Price			13.Nabla Triangle		31																																																																																																																																																																																																										
Sale Type 2 Land & Buildings			14.Rear Land		37		24.Undev Gravel (
1.Land 4.Mobile 7.C/I L&B			15.Class I Road		38																																																																																																																																																																																																										
2.L & B 5.Other 8.			TG PLAN YEAR 2022		39		25.Comm Base Pave																																																																																																																																																																																																								
3.Building 6.C/I Land 9.			Tif District # 0		40																																																																																																																																																																																																										
Financing 9 Unknown			Sale Date 1/24/2020		20.Industrial Bas		26.Comm Base Grav																																																																																																																																																																																																								
1.Convent 4.Seller 7.			Price		27.Backlot																																																																																																																																																																																																										
2.FHA/VA 5.Private 8.			Sale Type 2 Land & Buildings		28.Rear Land		29.Pavement																																																																																																																																																																																																								
3.Assumed 6.Cash 9.Unknown			1.Land 4.Mobile 7.C/I L&B		29.Pavement																																																																																																																																																																																																										
Validity 2 Related Parties			2.L & B 5.Other 8.		Fract. Acre		Acres																																																																																																																																																																																																								
1.Valid 4.Split 7.Renovate			3.Building 6.C/I Land 9.		21.Developed Pave																																																																																																																																																																																																										
3.Distress 6.Exempt 9.			Financing 9 Unknown		22.Undev Paved (F		Acres																																																																																																																																																																																																								
1.Convent 4.Seller 7.			1.Valid 4.Split 7.Renovate		23.Developed Grav																																																																																																																																																																																																										
2.FHA/VA 5.Private 8.			2.Related 5.Partial 8.Other		Acres		Acres																																																																																																																																																																																																								
3.Assumed 6.Cash 9.Unknown			3.Distress 6.Exempt 9.		24.Undev Gravel (
Verified 5 Public Record			3.Verified 6.Exempt 9.		25.Comm Base Pave		Acres																																																																																																																																																																																																								
1.Buyer 4.Agent 7.Family			1.Valid 4.Split 7.Renovate		26.Comm Base Grav																																																																																																																																																																																																										
2.Seller 5.Pub Rec 8.Other			2.Related 5.Partial 8.Other		27.Backlot		Acres																																																																																																																																																																																																								
3.Lender 6.MLS 9.			3.Distress 6.Exempt 9.		28.Rear Land																																																																																																																																																																																																										
			3.Verified 6.Exempt 9.		29.Pavement		Acres																																																																																																																																																																																																								
			1.Buyer 4.Agent 7.Family		24.Undev Gravel (
			2.Seller 5.Pub Rec 8.Other		25.Comm Base Pave		Acres																																																																																																																																																																																																								
			3.Lender 6.MLS 9.		26.Comm Base Grav																																																																																																																																																																																																										
					27.Backlot		Acres																																																																																																																																																																																																								
					28.Rear Land																																																																																																																																																																																																										
					29.Pavement		Acres																																																																																																																																																																																																								
					24.Undev Gravel (
					25.Comm Base Pave		Acres																																																																																																																																																																																																								
					26.Comm Base Grav																																																																																																																																																																																																										
					27.Backlot		Acres																																																																																																																																																																																																								
					28.Rear Land																																																																																																																																																																																																										
					29.Pavement		Acres																																																																																																																																																																																																								
					24.Undev Gravel (
					25.Comm Base Pave		Acres																																																																																																																																																																																																								
					26.Comm Base Grav																																																																																																																																																																																																										
					27.Backlot		Acres																																																																																																																																																																																																								
					28.Rear Land																																																																																																																																																																																																										
					29.Pavement		Acres																																																																																																																																																																																																								
					24.Undev Gravel (
					25.Comm Base Pave		Acres																																																																																																																																																																																																								
					26.Comm Base Grav																																																																																																																																																																																																										
					27.Backlot		Acres																																																																																																																																																																																																								
					28.Rear Land																																																																																																																																																																																																										
					29.Pavement		Acres																																																																																																																																																																																																								
					24.Undev Gravel (
					25.Comm Base Pave		Acres																																																																																																																																																																																																								
					26.Comm Base Grav																																																																																																																																																																																																										
					27.Backlot		Acres																																																																																																																																																																																																								
					28.Rear Land																																																																																																																																																																																																										
					29.Pavement		Acres																																																																																																																																																																																																								
					24.Undev Gravel (
					25.Comm Base Pave		Acres																																																																																																																																																																																																								
					26.Comm Base Grav																																																																																																																																																																																																										
					27.Backlot		Acres																																																																																																																																																																																																								
					28.Rear Land																																																																																																																																																																																																										
					29.Pavement		Acres																																																																																																																																																																																																								
					24.Undev Gravel (
					25.Comm Base Pave		Acres																																																																																																																																																																																																								
					26.Comm Base Grav																																																																																																																																																																																																										
					27.Backlot		Acres																																																																																																																																																																																																								
					28.Rear Land																																																																																																																																																																																																										
					29.Pavement		Acres																																																																																																																																																																																																								
					24.Undev Gravel (
					25.Comm Base Pave		Acres																																																																																																																																																																																																								
					26.Comm Base Grav																																																																																																																																																																																																										
					27.Backlot		Acres																																																																																																																																																																																																								
					28.Rear Land																																																																																																																																																																																																										
					29.Pavement		Acres																																																																																																																																																																																																								
					24.Undev Gravel (
					25.Comm Base Pave		Acres																																																																																																																																																																																																								
					26.Comm Base Grav																																																																																																																																																																																																										
					27.Backlot		Acres																																																																																																																																																																																																								
					28.Rear Land																																																																																																																																																																																																										
					29.Pavement		Acres																																																																																																																																																																																																								
					24.Undev Gravel (
					25.Comm Base Pave		Acres																																																																																																																																																																																																								
					26.Comm Base Grav																																																																																																																																																																																																										
					27.Backlot		Acres																																																																																																																																																																																																								
					28.Rear Land																																																																																																																																																																																																										
					29.Pavement		Acres																																																																																																																																																																																																								
					24.Undev Gravel (
					25.Comm Base Pave		Acres																																																																																																																																																																																																								
					26.Comm Base Grav																																																																																																																																																																																																										
					27.Backlot		Acres																																																																																																																																																																																																								
					28.Rear Land																																																																																																																																																																																																										
					29.Pavement		Acres																																																																																																																																																																																																								
					24.Undev Gravel (
					25.Comm Base Pave		Acres																																																																																																																																																																																																								
					26.Comm Base Grav																																																																																																																																																																																																										
					27.Backlot		Acres																																																																																																																																																																																																								
					28.Rear Land																																																																																																																																																																																																										
					29.Pavement		Acres																																																																																																																																																																																																								
					24.Undev Gravel (
					25.Comm Base Pave		Acres																																																																																																																																																																																																								
					26.Comm Base Grav																																																																																																																																																																																																										
					27.Backlot		Acres																																																																																																																																																																																																								
					28.Rear Land																																																																																																																																																																																																										
					29.Pavement		Acres																																																																																																																																																																																																								
					24.Undev Gravel (
					25.Comm Base Pave		Acres																																																																																																																																																																																																								
					26.Comm Base Grav																																																																																																																																																																																																										
					27.Backlot		Acres																																																																																																																																																																																																								
					28.Rear Land																																																																																																																																																																																																										
					29.Pavement		Acres																																																																																																																																																																																																								
					24.Undev Gravel (
					25.Comm Base Pave		Acres																																																																																																																																																																																																								
					26.Comm Base Grav																																																																																																																																																																																																										
					27.Backlot		Acres																																																																																																																																																																																																								
					28.Rear Land																																																																																																																																																																																																										
					29.Pavement		Acres																																																																																																																																																																																																								
					24.Undev Gravel (
					25.Comm Base Pave		Acres																																																																																																																																																																																																								
					26.Comm Base Grav																																																																																																																																																																																																										
					27.Backlot		Acres																																																																																																																																																																																																								
					28.Rear Land																																																																																																																																																																																																										
					29.Pavement		Acres																																																																																																																																																																																																								
					24.Undev Gravel (
					25.Comm Base Pave		Acres																																																																																																																																																																																																								
					26.Comm Base Grav																																																																																																																																																																																																										
					27.Backlot		Acres																																																																																																																																																																																																								
					28.Rear Land																																																																																																																																																																																																										
					29.Pavement		Acres																																																																																																																																																																																																								
					24.Undev Gravel (
					25.Comm Base Pave		Acres																																																																																																																																																																																																								
					26.Comm Base Grav																																																																																																																																																																																																										
					27.Backlot		Acres																																																																																																																																																																																																								
					28.Rear Land																																																																																																																																																																																																										
					29.Pavement		Acres																																																																																																																																																																																																								
					24.Undev Gravel (
					25.Comm Base Pave		Acres																																																																																																																																																																																																								
					26.Comm Base Grav																																																																																																																																																																																																										
					27.Backlot		Acres																																																																																																																																																																																																								
					28.Rear Land																																																																																																																																																																																																										
					29.Pavement		Acres																																																																																																																																																																																																								
					24.Undev Gravel (
					25.Comm Base Pave		Acres																																																																																																																																																																																																								
					26.Comm Base Grav																																																																																																																																																																																																										
					27.Backlot		Acres																																																																																																																																																																																																								
					28.Rear Land																																																																																																																																																																																																										
					29.Pavement		Acres																																																																																																																																																																																																								
					24.Undev Gravel (
					25.Comm Base Pave		Acres																																																																																																																																																																																																								
					26.Comm Base Grav																																																																																																																																																																																																										
					27.Backlot		Acres																																																																																																																																																																																																								
					28.Rear Land																																																																																																																																																																																																										
					29.Pavement		Acres																																																																																																																																																																																																								
					24.Undev Gravel (
					25.Comm Base Pave		Acres																																																																																																																																																																																																								
					26.Comm Base Grav																																																																																																																																																																																																										
					27.Backlot		Acres																																																																																																																																																																																																								
					28.Rear Land																																																																																																																																																																																																										
					29.Pavement		Acres																																																																																																																																																																																																								
					24.Undev Gravel (
					25.Comm Base Pave		Acres																																																																																																																																																																																																								
					26.Comm Base Grav																																																																																																																																																																																																										
					27.Backlot		Acres																																																																																																																																																																																																								
					28.Rear Land																																																																																																																																																																																																										
					29.Pavement		Acres																																																																																																																																																																																																								
					24.Undev Gravel (
					25.Comm Base Pave		Acres																																																																																																																																																																																																								
					26.Comm Base Grav																																																																																																																																																																																																										
					27.Backlot		Acres																																																																																																																																																																																																								
					28.Rear Land																																																																																																																																																																																																										
					29.Pavement		Acres																																																																																																																																																																																																								
					24.Undev Gravel (
					25.Comm Base Pave		Acres																																																																																																																																																																																																								
					26.Comm Base Grav																																																																																																																																																																																																										
					27.Backlot		Acres																																																																																																																																																																																																								
					28.Rear Land																																																																																																																																																																																																										
					29.Pavement		Acres																																																																																																																																																																																																								
					24.Undev Gravel (
					25.Comm Base Pave		Acres																																																																																																																																																																																																								
					26.Comm Base Grav																																																																																																																																																																																																										
					27.Backlot		Acres																																																																																																																																																																																																								
					28.Rear Land																																																																																																																																																																																																										
					29.Pavement		Acres																																																																																																																																																																																																								
					24.Undev Gravel (
					25.Comm Base Pave		Acres																																																																																																																																																																																																								
					26.Comm Base Grav																																																																																																																																																																																																										
					27.Backlot																																																																																																																																																																																																										

Washburn

Map Lot 002-010

Account 803

Location

Card 2 Of 2 9/04/2024

Building Style	SF Bsmt Living	Layout
1.Conv. 5.Garrison 9.Gambrel	Fin Bsmt Grade	1.Typical 4. 7.
2.Ranch 6.Salt Box 10.Other	OPEN 5 OPTIONAL	2.Inadeq 5. 8.
3.R Ranch 7.Contemp 11.Split	Heat Type 100%	3.Poor 6. 9.
4.Cape 8.Log 12.	1.HWBB 5.FWA 9.No Heat	Attic
Dwelling Units	2.HWCI 6.GravWA 10.	1.1/4 Fin 4.Full Fin 7.
Other Units	3.H Pump 7.Electric 11.	2.1/2 Fin 5.F/Stair 8.
Stories	4.Steam 8.F/Wall 12.	3.3/4 Fin 6. 9.None
1.1 4.1.5 7.	Cool Type 0%	Insulation
2.2 5.1.75 8.	1.Refrig 4.W&C Air 7.	1.Full 4.Minimal 7.
3.3 6.2.5 9.	2.Evapor 5. 8.	2.Heavy 5.Partial 8.
Exterior Walls	3.H Pump 6. 9.None	3.Capped 6. 9.None
1.Wood 5.Stucco 9.T-111	Kitchen Style	Unfinished %
2.Vin/Al 6.Brick 10.Other	1.Modern 4.Obsolete 7.	Grade & Factor
3.Compos. 7.Stone 11.	2.Typical 5. 8.	1.E Grade 4.B Grade 7.
4.Asbestos 8.Concrete 12.	3.Old Type 6. 9.None	2.D Grade 5.A Grade 8.SC Grade
Roof Surface	Bath(s) Style	3.C Grade 6.AA Grade 9.Same
1.Asphalt 4.Composit 7.	1.Modern 4.Obsolete 7.	SQFT (Footprint)
2.Slate 5.Wood 8.	2.Typical 5. 8.	Condition
3.Metal 6.Other 9.	3.Old Type 6. 9.None	1.Poor 4.Avg 7.V G
SF Masonry Trim	# Rooms	2.Fair 5.Avg+ 8.Exc
OPEN-3-CUSTOM	# Bedrooms	3.Avg- 6.Good 9.Same
OPEN-4-CUSTOM	# Full Baths	Phys. % Good
Year Built	# Half Baths	Funct. % Good
Year Remodeled	# Addn Fixtures	Functional Code
Foundation	# Fireplaces	1.Incomp 4.Delap 7.No Power
1.Concrete 4.Wood 7.		2.O-Built 5.Bsmt 8.LongTerm
2.C Block 5.Slab 8.		3.Damage 6.Common 9.None
3.Br/Stone 6.Piers 9.		Econ. % Good
Basement		Economic Code
1.1/4 Bmt 4.Full Bmt 7.		0.None 3.No Power 7.
2.1/2 Bmt 5.None 8.		1.Location 4.Generate 8.
3.3/4 Bmt 6. 9.None		2.Encroach 9.None 9.
Bsmt Gar # Cars		Entrance Code 0
Wet Basement		1.Interior 4.Vacant 7.
1.Dry 4. 7.		2.Refusal 5.Estimate 8.
2.Damp 5. 8.	3.Informed 6.Reviewed 9.	
3.Wet 6. 9.	Information Code 0	
		1.Owner 4.Agent 7.
		2.Relative 5.Estimate 8.
		3.Tenant 6.Other 9.

Date Inspected 8/05/2018

Additions, Outbuildings & Improvements								1.One Story Fram
Type	Year	Units	Grade	Cond	Phys.	Funct.	Sound Value	2.Two Story Fram
					%	%		3.Three Story Fr
					%	%		4.1 & 1/2 Story
					%	%		5.1 & 3/4 Story
					%	%		6.2 & 1/2 Story
					%	%		21.Open Frame Por
					%	%		22.Encl Frame Por
					%	%		23.Frame Garage
					%	%		24.Frame Shed
					%	%		25.Frame Bay Wind
					%	%		26.1SFr Overhang
					%	%		27.Unfin Basement
					%	%		28.Unfinished Att
					%	%		29.Finished Attic

THOMPSON, JASON A
THOMPSON, AMY L
629 WASHBURN ROAD
WASHBURN ME 04786

B3447P14 B5048P126 B5329P24 B5944P64

Previous Owner
OLSON, SCOTT A.
OLSON, JENNIFER A.
629 WASHBURN ROAD
WASHBURN ME 04786
Sale Date: 10/01/2019

Inspection Witnessed By:

X	Date
No./Date	Description
	Date Insp.

Notes:

*Will have 2nd home on this lot. Has new address for future home of 601 Washburn Road
*Garage -20% for attached during reval.
** Bk 5840 Pg 256 describes an easment being granted to Emera Maine.

Washburn

Property Data			Assessment Record						
Neighborhood 1 Neighborhood One			Year	Land	Buildings	Exempt	Total		
Tree Growth Year 0			2012	21,000	188,200	8,800	200,400		
1ST MORTGAGE 0			2013	27,300	188,200	8,800	206,700		
2ND MORTGAGE 0			2015	27,300	188,200	9,000	206,500		
Zone/Land Use 1 Residential			2018	27,300	190,200	18,400	199,100		
Secondary Zone			2019	48,500	196,300	20,000	224,800		
Topography 1 Level			2020	19,700	194,100	25,000	188,800		
1.Level 4.Below St 7.LevelBog			2021	19,700	223,200	25,000	217,900		
2.Rolling 5.Low 8.			2022	19,700	230,200	25,000	224,900		
3.Above St 6.Swampy 9.			2023	25,700	274,000	25,000	274,700		
Utilities 4 Drilled Well 6 Septic System			2024	25,700	274,000	25,000	274,700		
1.Public 4.Dr Well 7.Cesspool									
2.Water 5.Dug Well 8.									
3.Sewer 6.Septic 9.None									
Street 1 Paved									
1.Paved 4.Proposed 7.									
2.Semi Imp 5.R/O/W 8.									
3.Gravel 6. 9.None									
TG PLAN YEAR 0									
Tif District # 0									
Sale Data			Land Data						
Sale Date 10/01/2019			Front Foot	Type	Effective		Influence		Influence Codes
Price 325,000					Frontage	Depth	Factor	Code	
Sale Type 2 Land & Buildings			11.Regular Lot					1.Unimproved	
1.Land 4.Mobile 7.C/I L&B			12.Delta Triangle			%		2.Excess Frtg	
2.L & B 5.Other 8.			13.Nabla Triangle			%		3.Topography	
3.Building 6.C/I Land 9.			14.Rear Land			%		4.Size/Shape	
Financing 1 Conventional			15.Class I Road			%		5.Access	
1.Convent 4.Seller 7.						%		6.Restriction	
2.FHA/VA 5.Private 8.						%		7.Open Space	
3.Assumed 6.Cash 9.Unknown						%		8.View/Environ	
Validity 1 Arms Length Sale						%		9.Fract Share	
1.Valid 4.Split 7.Renovate			Square Foot	Square Feet				Acres	
2.Related 5.Partial 8.Other			16.Class II Road			%		30.Utility R O W	
3.Distress 6.Exempt 9.			17.Municipal Rese			%		31.Tillable	
Verified 5 Public Record			18.Munic Sep Lago			%		32.Pasture	
1.Buyer 4.Agent 7.Family			19.Gravel Pit			%		33.Orchard	
2.Seller 5.Pub Rec 8.Other			20.Industrial Bas			%		34.Softwood F&O	
3.Lender 6.MLS 9.						%		35.Mixed Wood F&O	
			Fract. Acre	Acres/Sites				36.Hardwood F&O	
			21.Developed Pave	21	1.00	100	%	0	
			22.Undev Paved (F	28	6.44	100	%	0	
			23.Developed Grav				%		
			Acres				%		
			24.Undev Gravel (%		
			25.Comm Base Pave				%		
			26.Comm Base Grav				%		
			27.Backlot				%		
			28.Rear Land				%		
			29.Pavement				%		
			Total Acreage		7.44				
								44.Lot Improvemen	
								45.Subdivision Lo	
								46.Heavy Ind Sit	

Washburn

Map Lot 002-011

Account 810

Location 629 WASHBURN ROAD

Card 1

Of 1

9/04/2024

Building Style 1 Conventional	SF Bsmt Living 0	Layout 1 Typical
1.Conv. 5.Garrison 9.Gambrel	Fin Bsmt Grade 0 0	1.Typical 4. 7.
2.Ranch 6.Salt Box 10.Other	OPEN 5 OPTIONAL 0	2.Inadeq 5. 8.
3.R Ranch 7.Contemp 11.Split	Heat Type 100% 1 Hot Water BB	3.Poor 6. 9.
4.Cape 8.Log 12.	1.HWBB 5.FWA 9.No Heat	Attic 9 None
Dwelling Units 1	2.HWCI 6.GravWA 10.	1.1/4 Fin 4.Full Fin 7.
Other Units 0	3.H Pump 7.Electric 11.	2.1/2 Fin 5.FI/Stair 8.
Stories 2 Two Story	4.Steam 8.FI/Wall 12.	3.3/4 Fin 6. 9.None
1.1 4.1.5 7.	Cool Type 100% 3 Heat Pump	Insulation 1 Full
2.2 5.1.75 8.	1.Refrig 4.W&C Air 7.	1.Full 4.Minimal 7.
3.3 6.2.5 9.	2.Evapor 5. 8.	2.Heavy 5.Partial 8.
Exterior Walls 2 Vinyl/Aluminum	3.H Pump 6. 9.None	3.Capped 6. 9.None
1.Wood 5.Stucco 9.T-111	Kitchen Style 2 Typical	Unfinished % 0%
2.Vin/Al 6.Brick 10.Other	1.Modern 4.Obsolete 7.	Grade & Factor 5 Very Good 100%
3.Compos. 7.Stone 11.	2.Typical 5. 8.	1.E Grade 4.B Grade 7.
4.Asbestos 8.Concrete 12.	3.Old Type 6. 9.None	2.D Grade 5.A Grade 8.SC Grade
Roof Surface 1 Asphalt Shingles	Bath(s) Style 2 Typical Bath(s)	3.C Grade 6.AA Grade 9.Same
1.Asphalt 4.Composit 7.	1.Modern 4.Obsolete 7.	SQFT (Footprint) 1364
2.Slate 5.Wood 8.	2.Typical 5. 8.	Condition 6 Good
3.Metal 6.Other 9.	3.Old Type 6. 9.None	1.Poor 4.Avg 7.V G
SF Masonry Trim 0	# Rooms 7	2.Fair 5.Avg+ 8.Exc
OPEN-3-CUSTOM 0	# Bedrooms 4	3.Avg- 6.Good 9.Same
OPEN-4-CUSTOM 0	# Full Baths 2	Phys. % Good 0%
Year Built 2005	# Half Baths 1	Funct. % Good 100%
Year Remodeled 0	# Addn Fixtures 0	Functional Code 9 None
Foundation 1 Concrete	# Fireplaces 0	1.Incomp 4.Delap 7.No Power
1.Concrete 4.Wood 7.	 <p>TRIO Software <i>A Division of Harris Computer Systems</i></p>	2.O-Built 5.Bsmt 8.LongTerm
2.C Block 5.Slab 8.		3.Damage 6.Common 9.None
3.Br/Stone 6.Piers 9.		Econ. % Good 100%
Basement 4 Full Basement		Economic Code None
1.1/4 Bmt 4.Full Bmt 7.		0.None 3.No Power 7.
2.1/2 Bmt 5.None 8.		1.Location 4.Generate 8.
3.3/4 Bmt 6. 9.None		2.Encroach 9.None 9.
Bsmt Gar # Cars 0		Entrance Code 1 Interior Inspect
Wet Basement 1 Dry Basement		1.Interior 4.Vacant 7.
1.Dry 4. 7.		2.Refusal 5.Estimate 8.
2.Damp 5. 8.	3.Informed 6.Reviewed 9.	
3.Wet 6. 9.	Information Code 1 Owner	
		1.Owner 4.Agent 7.
		2.Relative 5.Estimate 8.
		3.Tenant 6.Other 9.

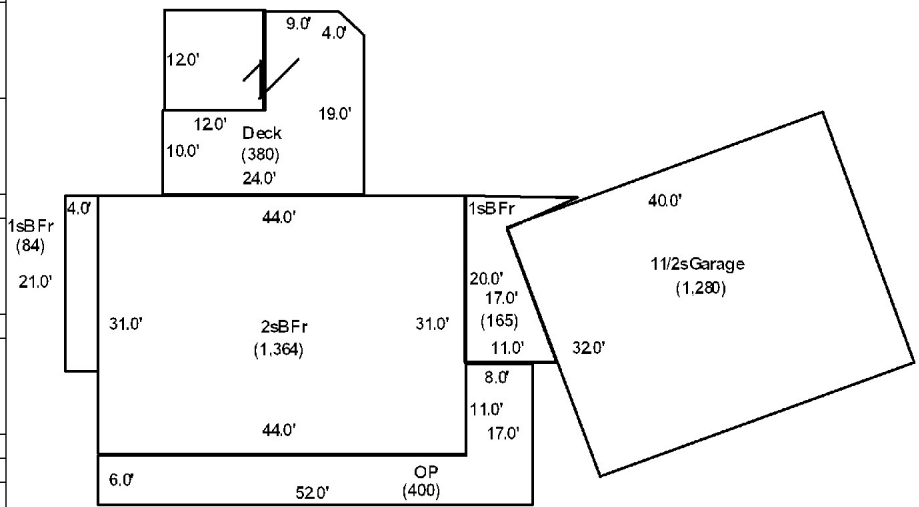

Date Inspected 8/05/2018

Additions, Outbuildings & Improvements

Type	Year	Units	Grade	Cond	Phys.	Funct.	Sound Value
68 Wood Deck	0	512	9 100	9	0 %	100 %	
20 1 Story/Bsmt	0	84	9 100	9	0 %	0 %	
21 Open Frame	0	400	9 100	9	0 %	0 %	
82 1.5 S-Gar	0	1280	4 100	4	0 %	80 %	
20 1 Story/Bsmt	0	165	9 100	9	0 %	0 %	
					%	%	
					%	%	
					%	%	
					%	%	
					%	%	
					%	%	
					%	%	
					%	%	



Washburn

Map Lot 002-012A

Account 701

Location 587 WASHBURN ROAD

Card 1

Of 1

9/04/2024

Building Style	9 Gambrel			SF Bsmt Living	0			Layout	1 Typical		
1.Conv.	5.Garrison	9.Gambrel		Fin Bsmt Grade	0 0			1.Typical	4.	7.	
2.Ranch	6.Salt Box	10.Other		OPEN 5 OPTIONAL	0			2.Inadeq	5.	8.	
3.R Ranch	7.Contemp	11.Split		Heat Type	100% 1 Hot Water BB			3.Poor	6.	9.	
4.Cape	8.Log	12.		1.HWBB	5.FWA	9.No Heat	Attic	9 None			
Dwelling Units	1			2.HWCI	6.GravWA	10.	1.1/4 Fin	4.Full Fin	7.		
Other Units	0			3.H Pump	7.Electric	11.	2.1/2 Fin	5.FI/Stair	8.		
Stories	4 One & 1/2 Story			4.Steam	8.FI/Wall	12.	3.3/4 Fin	6.	9.None		
1.1	4.1.5	7.		Cool Type	0% 9 None			Insulation	1 Full		
2.2	5.1.75	8.		1.Refrig	4.W&C Air	7.	1.Full	4.Minimal	7.		
3.3	6.2.5	9.		2.Evapor	5.	8.	2.Heavy	5.Partial	8.		
Exterior Walls	9 T-111			3.H Pump	6.	9.None	3.Capped	6.	9.None		
1.Wood	5.Stucco	9.T-111		Kitchen Style	2 Typical			Unfinished %	0%		
2.Vin/Al	6.Brick	10.Other		1.Modern	4.Obsolete	7.	Grade & Factor	2 Fair 110%			
3.Compos.	7.Stone	11.		2.Typical	5.	8.	1.E Grade	4.B Grade	7.		
4.Asbestos	8.Concrete	12.		3.Old Type	6.	9.None	2.D Grade	5.A Grade	8.SC Grade		
Roof Surface	3 Sheet Metal			Bath(s) Style	2 Typical Bath(s)			3.C Grade	6.AA Grade	9.Same	
1.Asphalt	4.Composit	7.		1.Modern	4.Obsolete	7.	SOQFT (Footprint)	432			
2.Slate	5.Wood	8.		2.Typical	5.	8.	Condition	4 Average			
3.Metal	6.Other	9.		3.Old Type	6.	9.None	1.Poor	4.Avg	7.V G		
SF Masonry Trim	0			# Rooms	7			2.Fair	5.Avg+	8.Exc	
OPEN-3-CUSTOM	0			# Bedrooms	4			3.Avg-	6.Good	9.Same	
OPEN-4-CUSTOM	0			# Full Baths	1			Phys. % Good	0%		
Year Built	1986			# Half Baths	1			Funct. % Good	100%		
Year Remodeled	0			# Addn Fixtures	0			Functional Code	9 None		
Foundation	1 Concrete			# Fireplaces	0			1.Incomp	4.Delap	7.No Power	
1.Concrete	4.Wood	7.		 <p>TRIO Software A Division of Harris Computer Systems</p>	2.O-Built	5.Bsmt	8.LongTerm				
2.C Block	5.Slab	8.			3.Damage	6.Common	9.None				
3.Br/Stone	6.Piers	9.			Econ. % Good	100%					
Basement	4 Full Basement				Economic Code	None					
1.1/4 Bmt	4.Full Bmt	7.			0.None	3.No Power	7.				
2.1/2 Bmt	5.None	8.			1.Location	4.Generate	8.				
3.3/4 Bmt	6.	9.None			2.Encroach	9.None	9.				
Bsmt Gar # Cars	0				Entrance Code	1 Interior Inspect					
Wet Basement	2 Damp Basement				1.Interior	4.Vacant	7.				
1.Dry	4.	7.			2.Refusal	5.Estimate	8.				
2.Damp	5.	8.		3.Informed	6.Reviewed	9.					
3.Wet	6.	9.		Information Code	1 Owner						
				1.Owner	4.Agent	7.					
				2.Relative	5.Estimate	8.					
				3.Tenant	6.Other	9.					

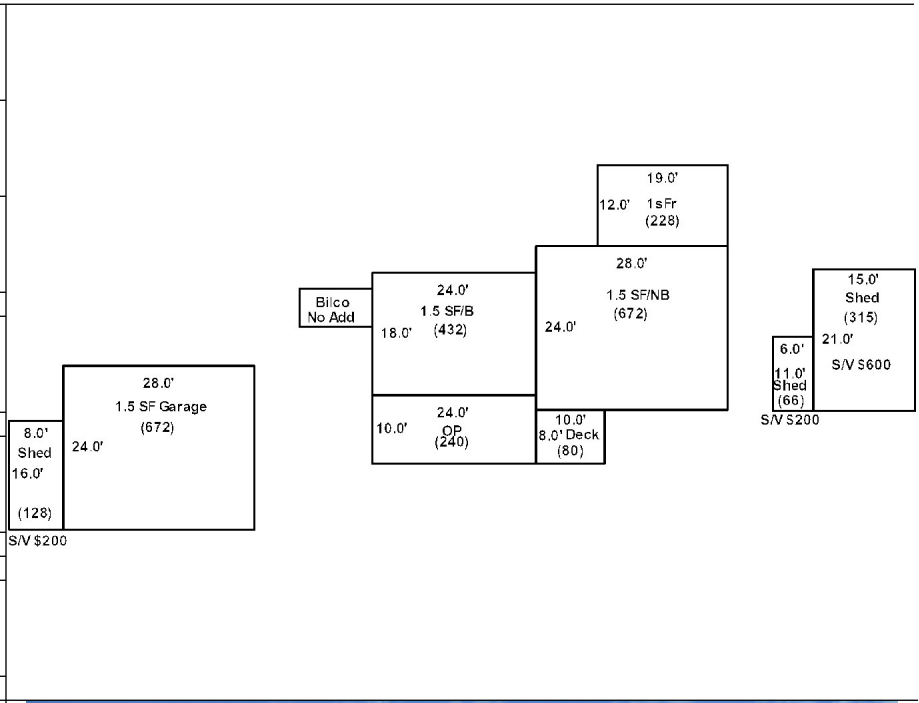

Date Inspected 8/05/2018

Additions, Outbuildings & Improvements

Type	Year	Units	Grade	Cond	Phys.	Funct.	Sound Value
4 1 & 1/2 Story Fr	1990	672	2 115	4	0 %	80 %	
21 Open Frame	1990	240	2 115	4	0 %	100 %	
68 Wood Deck	1990	80	2 115	4	0 %	100 %	
1 One Story Frame	1990	228	2 115	4	0 %	100 %	
24 Frame Shed	0						600
24 Frame Shed	0						200
82 1.5 S-Gar	1990	672	2 115	3	0 %	100 %	
24 Frame Shed	0						200



DOAK, MICHAEL J
DOAK, SAMANTHA J (HOBBS)
593 WASHBURN ROAD
WASHBURN ME 04786

B3898P199 B5078P325 B5386P90

Property Data			Assessment Record						
Neighborhood 1 Neighborhood One			Year	Land	Buildings	Exempt	Total		
Tree Growth Year 0			2012	8,300	23,400	8,800	22,900		
1ST MORTGAGE 0			2013	10,800	23,000	8,800	25,000		
2ND MORTGAGE 0			2015	10,800	23,000	9,000	24,800		
Zone/Land Use 1 Residential			2018	10,800	23,000	18,400	15,400		
Secondary Zone			2019	18,300	51,800	20,000	50,100		
Topography 1 Level			2020	18,300	51,700	25,000	45,000		
1.Level 4.Below St 7.LevelBog			2021	18,300	51,800	25,000	45,100		
2.Rolling 5.Low 8.			2022	18,300	54,400	25,000	47,700		
3.Above St 6.Swampy 9.			2023	24,100	93,600	25,000	92,700		
Utilities 4 Drilled Well 6 Septic System			2024	24,100	93,600	25,000	92,700		
1.Public 4.Dr Well 7.Cesspool									
2.Water 5.Dug Well 8.									
3.Sewer 6.Septic 9.None									
Street 1 Paved									
1.Paved 4.Proposed 7.									
2.Semi Imp 5.R/O/W 8.									
3.Gravel 6. 9.None									
TG PLAN YEAR 0									
Tif District # 0									
Sale Data			Land Data						
Sale Date 11/10/2003			Front Foot	Type	Effective		Influence		Influence Codes
Price 39,000					Frontage	Depth	Factor	Code	
Sale Type 2 Land & Buildings			11.Regular Lot					1.Unimproved	
1.Land 4.Mobile 7.C/I L&B			12.Delta Triangle					2.Excess Frtg	
2.L & B 5.Other 8.			13.Nabla Triangle					3.Topography	
3.Building 6.C/I Land 9.			14.Rear Land					4.Size/Shape	
Financing 1 Conventional			15.Class I Road					5.Access	
1.Convent 4.Seller 7.								6.Restriction	
2.FHA/VA 5.Private 8.								7.Open Space	
3.Assumed 6.Cash 9.Unknown								8.View/Environ	
Validity 1 Arms Length Sale								9.Fract Share	
1.Valid 4.Split 7.Renovate			Square Foot	Square Feet				Acres	
2.Related 5.Partial 8.Other			16.Class II Road					30.Utility R O W	
3.Distress 6.Exempt 9.			17.Municipal Rese					31.Tillable	
Verified 5 Public Record			18.Munic Sep Lago					32.Pasture	
1.Buyer 4.Agent 7.Family			19.Gravel Pit					33.Orchard	
2.Seller 5.Pub Rec 8.Other			20.Industrial Bas					34.Softwood F&O	
3.Lender 6.MLS 9.								35.Mixed Wood F&O	
			Fract. Acre	Acres/Sites				36.Hardwood F&O	
			21.Developed Pave	21	1.00	100	% 0	37.Softwood TG	
			22.Undev Paved (F	28	3.55	100	% 0	38.Mixed Wood TG	
			23.Developed Grav					39.Hardwood TG	
			Acres					40.Wasteland	
			24.Undev Gravel (41.Open Space	
			25.Comm Base Pave					42.Mobile Home Si	
			26.Comm Base Grav					43.Condo Site	
			27.Backlot					44.Lot Improvemen	
			28.Rear Land					45.Subdivision Lo	
			29.Pavement					46.Heavy Ind Sit	
			Total Acreage		4.55				

Inspection Witnessed By:

No./Date	Description	Date Insp.
X		

Notes:

Washburn

Map Lot 002-012B

Account 635

Location 593 WASHBURN ROAD

Card 1 Of 1 9/04/2024

Building Style 10 Other	SF Bsmt Living 0	Layout 1 Typical
1.Conv. 5.Garrison 9.Gambrel	Fin Bsmt Grade 0 0	1.Typical 4. 7.
2.Ranch 6.Salt Box 10.Other	OPEN 5 OPTIONAL 0	2.Inadeq 5. 8.
3.R Ranch 7.Contemp 11.Split	Heat Type 0% 9 Not Heated	3.Pool 6. 9.
4.Cape 8.Log 12.	1.HWBB 5.FWA 9.No Heat	Attic 9 None
Dwelling Units 1	2.HWCI 6.GravWA 10.	1.1/4 Fin 4.Full Fin 7.
Other Units 0	3.H Pump 7.Electric 11.	2.1/2 Fin 5.FI/Stair 8.
Stories 4 One & 1/2 Story	4.Steam 8.FI/Wall 12.	3.3/4 Fin 6. 9.None
1.1 4.1.5 7.	Cool Type 100% 3 Heat Pump	Insulation 4 Minimal
2.2 5.1.75 8.	1.Refrig 4.W&C Air 7.	1.Full 4.Minimal 7.
3.3 6.2.5 9.	2.Evapor 5. 8.	2.Heavy 5.Partial 8.
Exterior Walls 1 Wood Siding	3.H Pump 6. 9.None	3.Capped 6. 9.None
1.Wood 5.Stucco 9.T-111	Kitchen Style 2 Typical	Unfinished % 0%
2.Vin/Al 6.Brick 10.Other	1.Modern 4.Obsolete 7.	Grade & Factor 2 Fair 110%
3.Compos. 7.Stone 11.	2.Typical 5. 8.	1.E Grade 4.B Grade 7.
4.Asbestos 8.Concrete 12.	3.Old Type 6. 9.None	2.D Grade 5.A Grade 8.SC Grade
Roof Surface 3 Sheet Metal	Bath(s) Style 2 Typical Bath(s)	3.C Grade 6.AA Grade 9.Same
1.Asphalt 4.Composit 7.	1.Modern 4.Obsolete 7.	SQFT (Footprint) 535
2.Slate 5.Wood 8.	2.Typical 5. 8.	Condition 4 Average
3.Metal 6.Other 9.	3.Old Type 6. 9.None	1.Poor 4.Avg 7.V G
SF Masonry Trim 0	# Rooms 5	2.Fair 5.Avg+ 8.Exc
OPEN-3-CUSTOM 0	# Bedrooms 2	3.Avg- 6.Good 9.Same
OPEN-4-CUSTOM 0	# Full Baths 1	Phys. % Good 0%
Year Built 1978	# Half Baths 0	Funct. % Good 90%
Year Remodeled 0	# Addn Fixtures 0	Functional Code 2 Overbuilt
Foundation 1 Concrete	# Fireplaces 0	1.Incomp 4.Delap 7.No Power
1.Concrete 4.Wood 7.	 <p>TRIO Software A Division of Harris Computer Systems</p>	2.O-Built 5.Bsmt 8.LongTerm
2.C Block 5.Slab 8.		3.Damage 6.Common 9.None
3.Br/Stone 6.Piers 9.		Econ. % Good 100%
Basement 9 No Basement		Economic Code None
1.1/4 Bmt 4.Full Bmt 7.		0.None 3.No Power 7.
2.1/2 Bmt 5.None 8.		1.Location 4.Generate 8.
3.3/4 Bmt 6. 9.None		2.Encroach 9.None 9.
Bsmt Gar # Cars 0		Entrance Code 3 Information Only
Wet Basement 9 No Basement		1.Interior 4.Vacant 7.
1.Dry 4. 7.		2.Refusal 5.Estimate 8.
2.Damp 5. 8.	3.Informed 6.Reviewed 9.	
3.Wet 6. 9.	Information Code 1 Owner	
		1.Owner 4.Agent 7.
		2.Relative 5.Estimate 8.
		3.Tenant 6.Other 9.

Date Inspected 8/05/2018

Additions, Outbuildings & Improvements

Type	Year	Units	Grade	Cond	Phys.	Funct.	Sound Value
68 Wood Deck	1990	327	3 100	2	0 %	100 %	
4 1 & 1/2 Story Fr	0	225	2 105	4	0 %	100 %	
1 One Story Frame	1990	144	2 105	5	0 %	100 %	
68 Wood Deck	1990	60	2 100	4	0 %	100 %	
24 Frame Shed	0				%	%	500
24 Frame Shed	1990	384	2 90	3	0 %	100 %	
61 Canopy	1990	64	2 90	3	0 %	100 %	
23 Frame Garage	2022	1120	4 100	4	0 %	100 %	
					%	%	
					%	%	

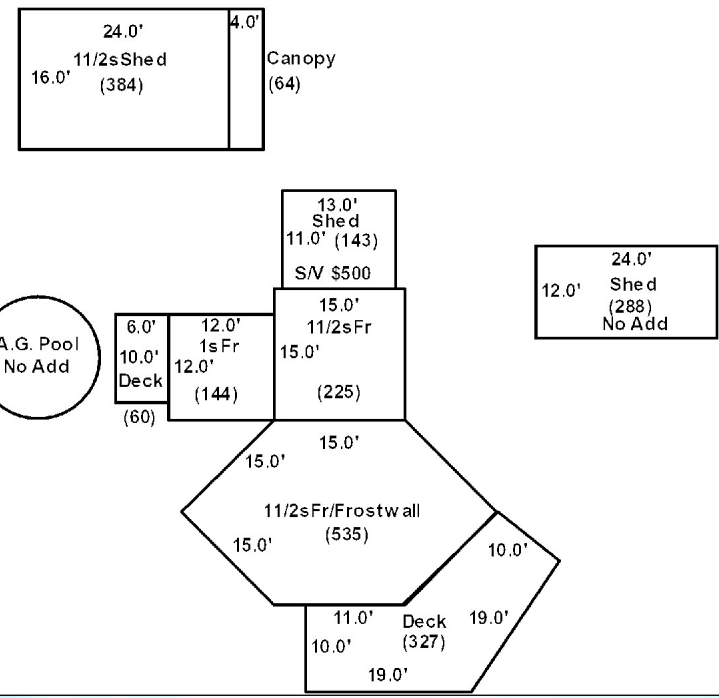

DOODY, RYAN L
567A WASHBURN ROAD
WASHBURN ME 04786

B6534P118

Previous Owner
BOUCHEY, CARL L
C/O SANDRA JANE BOUCHEY
P.O. BOX 385
CLINTON ME 04927
Sale Date: 2/26/2024

Previous Owner
Doak, Richard Jr.
681 Washburn Road

Washburn ME 04786
Sale Date: 5/11/2012

Previous Owner
Doak, Michael J.
593 Washburn Road

Washburn ME 04786
Sale Date: 4/30/2008

Inspection Witnessed By:

X	Date
No./Date	Description
	Date Insp.

Notes:

Washburn

Property Data			Assessment Record						
Neighborhood 1 Neighborhood One			Year	Land	Buildings	Exempt	Total		
Tree Growth Year 0			2012	7,400	12,200	0	19,600		
1ST MORTGAGE 0			2013	9,600	16,500	14,080	12,020		
2ND MORTGAGE 0			2015	9,600	16,500	14,400	11,700		
Zone/Land Use 1 Residential			2018	9,600	16,500	23,920	2,180		
Secondary Zone			2019	17,400	23,800	26,000	15,200		
Topography 1 Level			2020	17,400	23,400	0	40,800		
1.Level 4.Below St 7.LevelBog			2021	17,400	23,800	0	41,200		
2.Rolling 5.Low 8.			2022	17,400	24,900	0	42,300		
3.Above St 6.Swampy 9.			2023	23,000	29,600	0	52,600		
Utilities 4 Drilled Well 6 Septic System			2024	23,000	16,600	0	39,600		
1.Public 4.Dr Well 7.Cesspool									
2.Water 5.Dug Well 8.									
3.Sewer 6.Septic 9.None									
Street 1 Paved									
1.Paved 4.Proposed 7.									
2.Semi Imp 5.R/O/W 8.									
3.Gravel 6. 9.None									
TG PLAN YEAR 0									
Tif District # 0									
Sale Data			Land Data						
Sale Date 2/26/2024			Front Foot	Type	Effective		Influence		Influence Codes
Price 10,000					Frontage	Depth	Factor	Code	
Sale Type 2 Land & Buildings			11.Regular Lot					1.Unimproved	
1.Land 4.Mobile 7.C/I L&B			12.Delta Triangle			%		2.Excess Frtg	
2.L & B 5.Other 8.			13.Nabla Triangle			%		3.Topography	
3.Building 6.C/I Land 9.			14.Rear Land			%		4.Size/Shape	
Financing 1 Conventional			15.Class I Road			%		5.Access	
1.Convent 4.Seller 7.						%		6.Restriction	
2.FHA/VA 5.Private 8.						%		7.Open Space	
3.Assumed 6.Cash 9.Unknown						%		8.View/Environ	
Validity 3 Distressed Sale						%		9.Fract Share	
1.Valid 4.Split 7.Renovate			Square Foot	Square Feet				Acres	
2.Related 5.Partial 8.Other			16.Class II Road			%		30.Utility R O W	
3.Distress 6.Exempt 9.			17.Municipal Rese			%		31.Tillable	
Verified 5 Public Record			18.Munic Sep Lago			%		32.Pasture	
1.Buyer 4.Agent 7.Family			19.Gravel Pit			%		33.Orchard	
2.Seller 5.Pub Rec 8.Other			20.Industrial Bas			%		34.Softwood F&O	
3.Lender 6.MLS 9.						%		35.Mixed Wood F&O	
			Fract. Acre	Acres/Sites				36.Hardwood F&O	
			21.Developed Pave	21	1.00	100	% 0	37.Softwood TG	
			22.Undev Paved (F	28	1.70	100	% 0	38.Mixed Wood TG	
			23.Developed Grav				%	39.Hardwood TG	
			Acres				%	40.Wasteland	
			24.Undev Gravel (%	41.Open Space	
			25.Comm Base Pave				%	42.Mobile Home Si	
			26.Comm Base Grav				%	43.Condo Site	
			27.Backlot				%	44.Lot Improvemen	
			28.Rear Land				%	45.Subdivision Lo	
			29.Pavement				%	46.Heavy Ind Sit	
			Total Acreage		2.70				

Washburn

Map Lot 002-012C

Account 1

Location 567 WASHBURN ROAD

Card 1 Of 1 9/04/2024

Building Style 1 Conventional	SF Bsmt Living 0	Layout 2 Inadequate
1.Conv. 5.Garrison 9.Gambrel	Fin Bsmt Grade 0 0	1.Typical 4. 7.
2.Ranch 6.Salt Box 10.Other	OPEN 5 OPTIONAL 0	2.Inadeq 5. 8.
3.R Ranch 7.Contemp 11.Split	Heat Type 100% 5 Forced Warm Air	3.Poor 6. 9.
4.Cape 8.Log 12.	1.HWBB 5.FWA 9.No Heat	Attic 9 None
Dwelling Units 1	2.HWCI 6.GravWA 10.	1.1/4 Fin 4.Full Fin 7.
Other Units 0	3.H Pump 7.Electric 11.	2.1/2 Fin 5.F/Stair 8.
Stories 1 One Story	4.Steam 8.F/Wall 12.	3.3/4 Fin 6. 9.None
1.1 4.1.5 7.	Cool Type 0% 9 None	Insulation 4 Minimal
2.2 5.1.75 8.	1.Refrig 4.W&C Air 7.	1.Full 4.Minimal 7.
3.3 6.2.5 9.	2.Evapor 5. 8.	2.Heavy 5.Partial 8.
Exterior Walls 2 Vinyl/Aluminum	3.H Pump 6. 9.None	3.Capped 6. 9.None
1.Wood 5.Stucco 9.T-111	Kitchen Style 2 Typical	Unfinished % 0%
2.Vin/Al 6.Brick 10.Other	1.Modern 4.Obsolete 7.	Grade & Factor 2 Fair 100%
3.Compos. 7.Stone 11.	2.Typical 5. 8.	1.E Grade 4.B Grade 7.
4.Asbestos 8.Concrete 12.	3.Old Type 6. 9.None	2.D Grade 5.A Grade 8.SC Grade
Roof Surface 1 Asphalt Shingles	Bath(s) Style 2 Typical Bath(s)	3.C Grade 6.AA Grade 9.Same
1.Asphalt 4.Composit 7.	1.Modern 4.Obsolete 7.	SQFT (Footprint) 378
2.Slate 5.Wood 8.	2.Typical 5. 8.	Condition 2 Fair
3.Metal 6.Other 9.	3.Old Type 6. 9.None	1.Poor 4.Avg 7.V G
SF Masonry Trim 0	# Rooms 3	2.Fair 5.Avg+ 8.Exc
OPEN-3-CUSTOM 0	# Bedrooms 1	3.Avg- 6.Good 9.Same
OPEN-4-CUSTOM 0	# Full Baths 1	Phys. % Good 0%
Year Built 1990	# Half Baths 0	Funct. % Good 75%
Year Remodeled 0	# Addn Fixtures 0	Functional Code 4 Delapidation
Foundation 6 Piers	# Fireplaces 0	1.Incomp 4.Delap 7.No Power
1.Concrete 4.Wood 7.	 <p>TRIO Software <small>A Division of Harris Computer Systems</small></p>	2.O-Built 5.Bsmt 8.LongTerm
2.C Block 5.Slab 8.		3.Damage 6.Common 9.None
3.Br/Stone 6.Piers 9.		Econ. % Good 100%
Basement 9 No Basement		Economic Code None
1.1/4 Bmt 4.Full Bmt 7.		0.None 3.No Power 7.
2.1/2 Bmt 5.None 8.		1.Location 4.Generate 8.
3.3/4 Bmt 6. 9.None		2.Encroach 9.None 9.
Bsmt Gar # Cars 0		Entrance Code 5 Estimated
Wet Basement 9 No Basement		1.Interior 4.Vacant 7.
1.Dry 4. 7.		2.Refusal 5.Estimate 8.
2.Damp 5. 8.	3.Informed 6.Reviewed 9.	
3.Wet 6. 9.	Information Code 5 Estimate	
	1.Owner 4.Agent 7.	
	2.Relative 5.Estimate 8.	
	3.Tenant 6.Other 9.	

Date Inspected 8/05/2018

Additions, Outbuildings & Improvements

Type	Year	Units	Grade	Cond	Phys.	Funct.	Sound Value
1 One Story Frame	0	180	0 0	0	0 %	0 %	
1 One Story Frame	0	36	0 0	0	0 %	0 %	
68 Wood Deck	2006	48	3 95	4	0 %	100 %	
24 Frame Shed	0				%	%	300
					%	%	
					%	%	
					%	%	
					%	%	
					%	%	
					%	%	
					%	%	

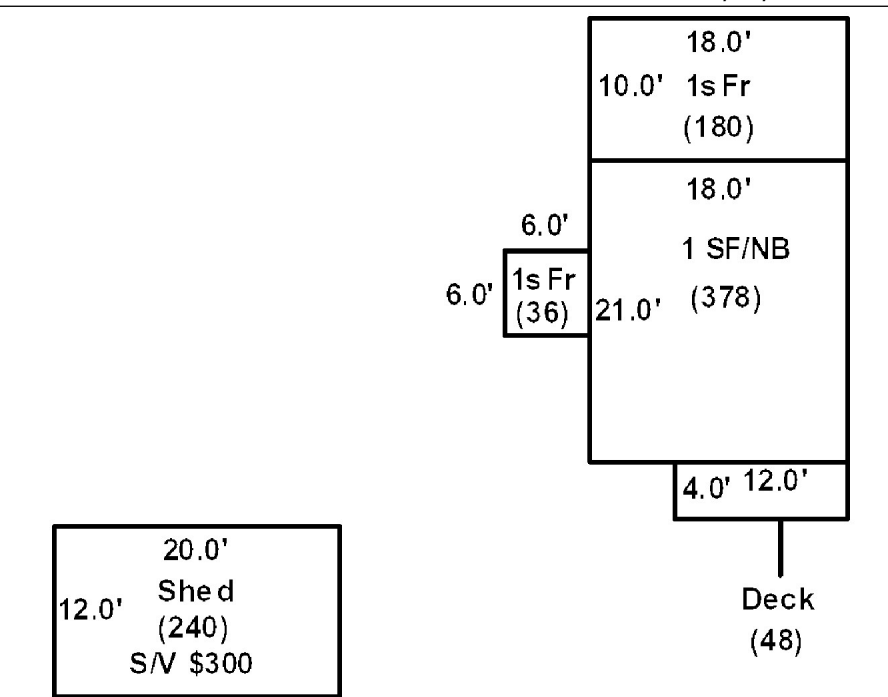

DOAK, RICHARD F SR
DOAK, BARBARA J
567 WASHBURN ROAD
WASHBURN ME 04786

B5046P340 B5097P74 B5478P312

Inspection Witnessed By:

X	Date
No./Date	Description
	Date Insp.

Notes:
** Deeded 2.03 Acres to son creating lot 12 E B6378P87
10/03/2022

Washburn

Property Data			Assessment Record						
Neighborhood 1 Neighborhood One			Year	Land	Buildings	Exempt	Total		
Tree Growth Year 0			2013	11,400	47,800	8,800	50,400		
1ST MORTGAGE 0			2015	11,400	47,800	9,000	50,200		
2ND MORTGAGE 0			2018	11,400	47,800	18,400	40,800		
Zone/Land Use 1 Residential			2019	17,900	62,900	20,000	60,800		
Secondary Zone			2020	17,900	62,900	25,000	55,800		
Topography 1 Level			2021	21,000	62,900	25,000	58,900		
1.Level 4.Below St 7.LevelBog			2022	21,000	66,000	25,000	62,000		
2.Rolling 5.Low 8.			2023	26,000	78,100	25,000	79,100		
3.Above St 6.Swampy 9.			2024	26,000	78,100	25,000	79,100		
Utilities 4 Drilled Well 6 Septic System									
1.Public 4.Dr Well 7.Cesspool									
2.Water 5.Dug Well 8.									
3.Sewer 6.Septic 9.None									
Street 1 Paved									
1.Paved 4.Proposed 7.									
2.Semi Imp 5.R/O/W 8.									
3.Gravel 6. 9.None									
TG PLAN YEAR 0									
Tif District # 0									
Sale Data			Land Data						
Sale Date 9/08/1978			Front Foot	Type	Effective		Influence		Influence Codes
Price					Frontage	Depth	Factor	Code	
Sale Type 2 Land & Buildings			11.Regular Lot					1.Unimproved	
1.Land 4.Mobile 7.C/I L&B			12.Delta Triangle			%		2.Excess Frtg	
2.L & B 5.Other 8.			13.Nabla Triangle			%		3.Topography	
3.Building 6.C/I Land 9.			14.Rear Land			%		4.Size/Shape	
Financing 1 Conventional			15.Class I Road			%		5.Access	
1.Convent 4.Seller 7.						%		6.Restriction	
2.FHA/VA 5.Private 8.						%		7.Open Space	
3.Assumed 6.Cash 9.Unknown						%		8.View/Environ	
Validity 1 Arms Length Sale						%		9.Fract Share	
1.Valid 4.Split 7.Renovate			Square Foot	Square Feet				Acres	
2.Related 5.Partial 8.Other			16.Class II Road			%		30.Utility R O W	
3.Distress 6.Exempt 9.			17.Municipal Rese			%		31.Tillable	
Verified 5 Public Record			18.Munic Sep Lago			%		32.Pasture	
1.Buyer 4.Agent 7.Family			19.Gravel Pit			%		33.Orchard	
2.Seller 5.Pub Rec 8.Other			20.Industrial Bas			%		34.Softwood F&O	
3.Lender 6.MLS 9.			Fract. Acre	Acres/Sites				35.Mixed Wood F&O	
			21.Developed Pave	21	1.00	100	%	0	
			22.Undev Paved (F	28	6.97	100	%	0	
			23.Developed Grav				%		
			Acres				%		
			24.Undev Gravel (%		
			25.Comm Base Pave				%		
			26.Comm Base Grav				%		
			27.Backlot				%		
			28.Rear Land				%		
			29.Pavement				%		
			Total Acreage		7.97				
								44.Lot Improvemen	
								45.Subdivision Lo	
								46.Heavy Ind Sit	

Washburn

Map Lot 002-012D

Account 612

Location 567 WASHBURN ROAD

Card 1 Of 1 9/04/2024

Building Style	2 Ranch		SF Bsmt Living	0		Layout	1 Typical		
1.Conv.	5.Garrison	9.Gambrel	Fin Bsmt Grade	0 0		1.Typical	4.	7.	
2.Ranch	6.Salt Box	10.Other	OPEN 5 OPTIONAL	0		2.Inadeq	5.	8.	
3.R Ranch	7.Contemp	11.Split	Heat Type	100% 8 Floor/Wall Unit		3.Poor	6.	9.	
4.Cape	8.Log	12.	1.HWBB	5.FWA	9.No Heat	Attic	9 None		
Dwelling Units	1		2.HWCI	6.GravWA	10.	1.1/4 Fin	4.Full Fin	7.	
Other Units	0		3.H Pump	7.Electric	11.	2.1/2 Fin	5.FI/Stair	8.	
Stories	1 One Story		4.Steam	8.FI/Wall	12.	3.3/4 Fin	6.	9.None	
1.1	4.1.5	7.	Cool Type	0% 9 None		Insulation	4 Minimal		
2.2	5.1.75	8.	1.Refrig	4.W&C Air	7.	1.Full	4.Minimal	7.	
3.3	6.2.5	9.	2.Evapor	5.	8.	2.Heavy	5.Partial	8.	
Exterior Walls	9 T-111		3.H Pump	6.	9.None	3.Capped	6.	9.None	
1.Wood	5.Stucco	9.T-111	Kitchen Style	2 Typical		Unfinished %	0%		
2.Vin/Al	6.Brick	10.Other	1.Modern	4.Obsolete	7.	Grade & Factor	3 Average 100%		
3.Compos.	7.Stone	11.	2.Typical	5.	8.	1.E Grade	4.B Grade	7.	
4.Asbestos	8.Concrete	12.	3.Old Type	6.	9.None	2.D Grade	5.A Grade	8.SC Grade	
Roof Surface	3 Sheet Metal		Bath(s) Style	2 Typical Bath(s)		3.C Grade	6.AA Grade	9.Same	
1.Asphalt	4.Composit	7.	1.Modern	4.Obsolete	7.	SQFT (Footprint)	768		
2.Slate	5.Wood	8.	2.Typical	5.	8.	Condition	4 Average		
3.Metal	6.Other	9.	3.Old Type	6.	9.None	1.Poor	4.Avg	7.V G	
SF Masonry Trim	0		# Rooms	3		2.Fair	5.Avg+	8.Exc	
OPEN-3-CUSTOM	0		# Bedrooms	1		3.Avg-	6.Good	9.Same	
OPEN-4-CUSTOM	0		# Full Baths	1		Phys. % Good	0%		
Year Built	1996		# Half Baths	0		Funct. % Good	100%		
Year Remodeled	0		# Addn Fixtures	0		Functional Code	9 None		
Foundation	1 Concrete		# Fireplaces	0		1.Incomp	4.Delap	7.No Power	
1.Concrete	4.Wood	7.	 <p>TRIO Software <small>A Division of Harris Computer Systems</small></p>	Economic Code	None		0.None	3.No Power	7.
2.C Block	5.Slab	8.		1.Location	4.Generate	8.	1.Location	4.Generate	8.
3.Br/Stone	6.Piers	9.		2.Encroach	9.None	9.	2.Encroach	9.None	9.
Basement	4 Full Basement			Entrance Code	1 Interior Inspect		1.Interior	4.Vacant	7.
1.1/4 Bmt	4.Full Bmt	7.		1.Interior	4.Vacant	7.	2.Refusal	5.Estimate	8.
2.1/2 Bmt	5.None	8.		3.Informed	6.Reviewed	9.	3.Informed	6.Reviewed	9.
3.3/4 Bmt	6.	9.None		Information Code	1 Owner		1.Owner	4.Agent	7.
Bsmt Gar # Cars	0			1.Owner	4.Agent	7.	2.Relative	5.Estimate	8.
Wet Basement	1 Dry Basement			2.Relative	5.Estimate	8.	3.Tenant	6.Other	9.
1.Dry	4.	7.		3.Tenant	6.Other	9.			
2.Damp	5.	8.							
3.Wet	6.	9.							

Date Inspected 8/05/2018

Additions, Outbuildings & Improvements

Type	Year	Units	Grade	Cond	Phys.	Funct.	Sound Value
21 Open Frame	0	216	0 0	0	0 %	0 %	
40 Basement Entry	0	35	0 0	0	0 %	0 %	
24 Frame Shed	0				%	%	1,500
24 Frame Shed	0				%	%	400
82 1.5 S-Gar	0	672	3 105	5	0 %	100 %	
24 Frame Shed	0				%	%	400
					%	%	
					%	%	
					%	%	
					%	%	
					%	%	

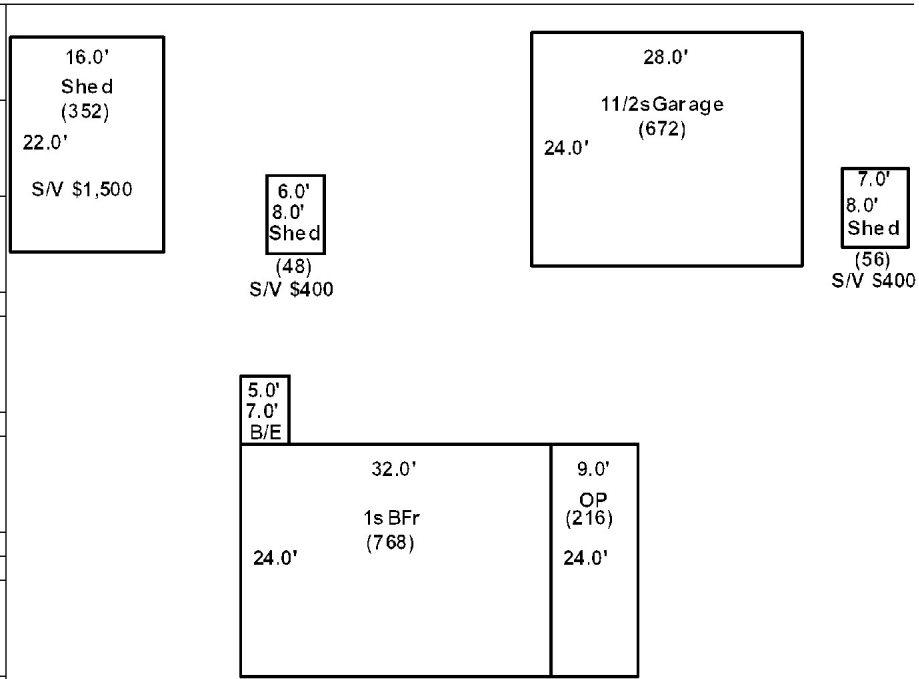

THOMPSON'S PROPERTY MAINTENANCE INC.
P.O. BOX 42
WASHBURN ME 04786

B5383P326

Inspection Witnessed By:

No./Date	Description	Date Insp.
X		

Notes:

Washburn

Property Data			Assessment Record						
Neighborhood 1 Neighborhood One			Year	Land	Buildings	Exempt	Total		
Tree Growth Year 0			2018	20,500	0	0	20,500		
1ST MORTGAGE 0			2019	31,500	0	0	31,500		
2ND MORTGAGE 0			2020	31,500	0	0	31,500		
Zone/Land Use 2 Commercial			2021	31,500	0	0	31,500		
Secondary Zone			2022	31,500	0	0	31,500		
Topography 1 Level			2023	36,500	0	0	36,500		
			2024	36,500	0	0	36,500		
1.Level 4.Below St 7.LevelBog 2.Rolling 5.Low 8. 3.Above St 6.Swampy 9.									
Utilities									
1.Public 4.Dr Well 7.Cesspool 2.Water 5.Dug Well 8. 3.Sewer 6.Septic 9.None									
Street 1 Paved									
1.Paved 4.Proposed 7. 2.Semi Imp 5.R/O/W 8. 3.Gravel 6. 9.None									
TG PLAN YEAR 0									
Tif District # 0									
Sale Data			Land Data						
Sale Date 12/23/2014			Front Foot	Type	Effective		Influence		Influence Codes
Price 500					Frontage	Depth	Factor	Code	
Sale Type 1 Land Only			11.Regular Lot					1.Unimproved	
1.Land 4.Mobile 7.C/I L&B			12.Delta Triangle					2.Excess Frtg	
2.L & B 5.Other 8.			13.Nabla Triangle					3.Topography	
3.Building 6.C/I Land 9.			14.Rear Land					4.Size/Shape	
Financing			15.Class I Road					5.Access	
1.Convent 4.Seller 7.								6.Restriction	
2.FHA/VA 5.Private 8.								7.Open Space	
3.Assumed 6.Cash 9.Unknown								8.View/Environ	
Validity 1 Arms Length Sale								9.Fract Share	
1.Valid 4.Split 7.Renovate			Square Foot	Square Feet				Acres	
2.Related 5.Partial 8.Other			16.Class II Road					30.Utility R O W	
3.Distress 6.Exempt 9.			17.Municipal Rese					31.Tillable	
Verified 5 Public Record			18.Munic Sep Lago					32.Pasture	
1.Buyer 4.Agent 7.Family			19.Gravel Pit					33.Orchard	
2.Seller 5.Pub Rec 8.Other			20.Industrial Bas					34.Softwood F&O	
3.Lender 6.MLS 9.								35.Mixed Wood F&O	
			Fract. Acre					36.Hardwood F&O	
			21.Developed Pave	28	63.00	100	%	0	
			22.Undev Paved (F					%	
			23.Developed Grav					%	
			Acres					%	
			24.Undev Gravel (%	
			25.Comm Base Pave					%	
			26.Comm Base Grav					%	
			27.Backlot					%	
			28.Rear Land					%	
			29.Pavement					%	
			Total Acreage		63.00				
								44.Lot Improvemen	
								45.Subdivision Lo	
								46.Heavy Ind Sit	

Washburn

Map Lot 002-012E

Account 1126

Location 589 WASHBURN ROAD

Card 1 Of 1 9/04/2024

Building Style 0	SF Bsmt Living 0	Layout 0
1.Conv. 5.Garrison 9.Gambrel	Fin Bsmt Grade 0 0	1.Typical 4. 7.
2.Ranch 6.Salt Box 10.Other	OPEN 5 OPTIONAL 0	2.Inadeq 5. 8.
3.R Ranch 7.Contemp 11.Split	Heat Type 100% 0	3.Poor 6. 9.
4.Cape 8.Log 12.	1.HWBB 5.FWA 9.No Heat	Attic 0
Dwelling Units 0	2.HWCI 6.GravWA 10.	1.1/4 Fin 4.Full Fin 7.
Other Units 0	3.H Pump 7.Electric 11.	2.1/2 Fin 5.FI/Stair 8.
Stories 0	4.Steam 8.FI/Wall 12.	3.3/4 Fin 6. 9.None
1.1 4.1.5 7.	Cool Type 0% 9 None	Insulation 0
2.2 5.1.75 8.	1.Refrig 4.W&C Air 7.	1.Full 4.Minimal 7.
3.3 6.2.5 9.	2.Evapor 5. 8.	2.Heavy 5.Partial 8.
Exterior Walls 0	3.H Pump 6. 9.None	3.Capped 6. 9.None
1.Wood 5.Stucco 9.T-111	Kitchen Style 0	Unfinished % 0%
2.Vin/Al 6.Brick 10.Other	1.Modern 4.Obsolete 7.	Grade & Factor 0 0%
3.Compos. 7.Stone 11.	2.Typical 5. 8.	1.E Grade 4.B Grade 7.
4.Asbestos 8.Concrete 12.	3.Old Type 6. 9.None	2.D Grade 5.A Grade 8.SC Grade
Roof Surface 0	Bath(s) Style 0	3.C Grade 6.AA Grade 9.Same
1.Asphalt 4.Composit 7.	1.Modern 4.Obsolete 7.	SQFT (Footprint) 0
2.Slate 5.Wood 8.	2.Typical 5. 8.	Condition 0
3.Metal 6.Other 9.	3.Old Type 6. 9.None	1.Poor 4.Avg 7.V G
SF Masonry Trim 0	# Rooms 0	2.Fair 5.Avg+ 8.Exc
OPEN-3-CUSTOM 0	# Bedrooms 0	3.Avg- 6.Good 9.Same
OPEN-4-CUSTOM 0	# Full Baths 0	Phys. % Good 0%
Year Built 0	# Half Baths 0	Funct. % Good 100%
Year Remodeled 0	# Addn Fixtures 0	Functional Code 9 None
Foundation 0	# Fireplaces 0	1.Incomp 4.Delap 7.No Power
1.Concrete 4.Wood 7.		2.O-Built 5.Bsmt 8.LongTerm
2.C Block 5.Slab 8.		3.Damage 6.Common 9.None
3.Br/Stone 6.Piers 9.		Econ. % Good 100%
Basement 0		Economic Code None
1.1/4 Bmt 4.Full Bmt 7.		0.None 3.No Power 7.
2.1/2 Bmt 5.None 8.		1.Location 4.Generate 8.
3.3/4 Bmt 6. 9.None		2.Encroach 9.None 9.
Bsmt Gar # Cars 0		Entrance Code 0
Wet Basement 0		1.Interior 4.Vacant 7.
1.Dry 4. 7.		2.Refusal 5.Estimate 8.
2.Damp 5. 8.	3.Informed 6.Reviewed 9.	
3.Wet 6. 9.	Information Code 0	
	1.Owner 4.Agent 7.	
	2.Relative 5.Estimate 8.	
	3.Tenant 6.Other 9.	

Date Inspected

Additions, Outbuildings & Improvements

Type	Year	Units	Grade	Cond	Phys.	Funct.	Sound Value
					%	%	1.One Story Fram
					%	%	2.Two Story Fram
					%	%	3.Three Story Fr
					%	%	4.1 & 1/2 Story
					%	%	5.1 & 3/4 Story
					%	%	6.2 & 1/2 Story
					%	%	21.Open Frame Por
					%	%	22.Encl Frame Por
					%	%	23.Frame Garage
					%	%	24.Frame Shed
					%	%	25.Frame Bay Wind
					%	%	26.1SFr Overhang
					%	%	27.Unfin Basement
					%	%	28.Unfinished Att
					%	%	29.Finished Attic

Washburn

Map Lot 002-013

Account 334

Location WASHBURN ROAD

Card 1 Of 1 9/04/2024

Building Style 0	SF Bsmt Living 0	Layout 0
1.Conv. 5.Garrison 9.Gambrel	Fin Bsmt Grade 0 0	1.Typical 4. 7.
2.Ranch 6.Salt Box 10.Other	OPEN 5 OPTIONAL 0	2.Inadeq 5. 8.
3.R Ranch 7.Contemp 11.Split	Heat Type 100% 0	3.Poor 6. 9.
4.Cape 8.Log 12.	1.HWBB 5.FWA 9.No Heat	Attic 0
Dwelling Units 0	2.HWCI 6.GravWA 10.	1.1/4 Fin 4.Full Fin 7.
Other Units 0	3.H Pump 7.Electric 11.	2.1/2 Fin 5.FI/Stair 8.
Stories 0	4.Steam 8.FI/Wall 12.	3.3/4 Fin 6. 9.None
1.1 4.1.5 7.	Cool Type 0% 9 None	Insulation 0
2.2 5.1.75 8.	1.Refrig 4.W&C Air 7.	1.Full 4.Minimal 7.
3.3 6.2.5 9.	2.Evapor 5. 8.	2.Heavy 5.Partial 8.
Exterior Walls 0	3.H Pump 6. 9.None	3.Capped 6. 9.None
1.Wood 5.Stucco 9.T-111	Kitchen Style 0	Unfinished % 0%
2.Vin/Al 6.Brick 10.Other	1.Modern 4.Obsolete 7.	Grade & Factor 0 0%
3.Compos. 7.Stone 11.	2.Typical 5. 8.	1.E Grade 4.B Grade 7.
4.Asbestos 8.Concrete 12.	3.Old Type 6. 9.None	2.D Grade 5.A Grade 8.SC Grade
Roof Surface 0	Bath(s) Style 0	3.C Grade 6.AA Grade 9.Same
1.Asphalt 4.Composit 7.	1.Modern 4.Obsolete 7.	SQFT (Footprint) 0
2.Slate 5.Wood 8.	2.Typical 5. 8.	Condition 0
3.Metal 6.Other 9.	3.Old Type 6. 9.None	1.Poor 4.Avg 7.V G
SF Masonry Trim 0	# Rooms 0	2.Fair 5.Avg+ 8.Exc
OPEN-3-CUSTOM 0	# Bedrooms 0	3.Avg- 6.Good 9.Same
OPEN-4-CUSTOM 0	# Full Baths 0	Phys. % Good 0%
Year Built 0	# Half Baths 0	Funct. % Good 100%
Year Remodeled 0	# Addn Fixtures 0	Functional Code 9 None
Foundation 0	# Fireplaces 0	1.Incomp 4.Delap 7.No Power
1.Concrete 4.Wood 7.		2.O-Built 5.Bsmt 8.LongTerm
2.C Block 5.Slab 8.		3.Damage 6.Common 9.None
3.Br/Stone 6.Piers 9.		Econ. % Good 100%
Basement 0		Economic Code None
1.1/4 Bmt 4.Full Bmt 7.		0.None 3.No Power 7.
2.1/2 Bmt 5.None 8.		1.Location 4.Generate 8.
3.3/4 Bmt 6. 9.None		2.Encroach 9.None 9.
Bsmt Gar # Cars 0		Entrance Code 0
Wet Basement 0		1.Interior 4.Vacant 7.
1.Dry 4. 7.		2.Refusal 5.Estimate 8.
2.Damp 5. 8.	3.Informed 6.Reviewed 9.	
3.Wet 6. 9.	Information Code 0	
		1.Owner 4.Agent 7.
		2.Relative 5.Estimate 8.
		3.Tenant 6.Other 9.

Date Inspected

Additions, Outbuildings & Improvements

Type	Year	Units	Grade	Cond	Phys.	Funct.	Sound Value
					%	%	1.One Story Fram
					%	%	2.Two Story Fram
					%	%	3.Three Story Fr
					%	%	4.1 & 1/2 Story
					%	%	5.1 & 3/4 Story
					%	%	6.2 & 1/2 Story
					%	%	21.Open Frame Por
					%	%	22.Encl Frame Por
					%	%	23.Frame Garage
					%	%	24.Frame Shed
					%	%	25.Frame Bay Wind
					%	%	26.1SFr Overhang
					%	%	27.Unfin Basement
					%	%	28.Unfinished Att
					%	%	29.Finished Attic

Washburn

Map Lot 002-013A

Account 299

Location WASHBURN ROAD

Card 1 Of 1 9/04/2024

Building Style 0	SF Bsmt Living 0	Layout 0
1.Conv. 5.Garrison 9.Gambrel	Fin Bsmt Grade 0 0	1.Typical 4. 7.
2.Ranch 6.Salt Box 10.Other	OPEN 5 OPTIONAL 0	2.Inadeq 5. 8.
3.R Ranch 7.Contemp 11.Split	Heat Type 100% 0	3.Poor 6. 9.
4.Cape 8.Log 12.	1.HWBB 5.FWA 9.No Heat	Attic 0
Dwelling Units 0	2.HWCI 6.GravWA 10.	1.1/4 Fin 4.Full Fin 7.
Other Units 0	3.H Pump 7.Electric 11.	2.1/2 Fin 5.FI/Stair 8.
Stories 0	4.Steam 8.FI/Wall 12.	3.3/4 Fin 6. 9.None
1.1 4.1.5 7.	Cool Type 0% 9 None	Insulation 0
2.2 5.1.75 8.	1.Refrig 4.W&C Air 7.	1.Full 4.Minimal 7.
3.3 6.2.5 9.	2.Evapor 5. 8.	2.Heavy 5.Partial 8.
Exterior Walls 0	3.H Pump 6. 9.None	3.Capped 6. 9.None
1.Wood 5.Stucco 9.T-111	Kitchen Style 0	Unfinished % 0%
2.Vin/Al 6.Brick 10.Other	1.Modern 4.Obsolete 7.	Grade & Factor 0 0%
3.Compos. 7.Stone 11.	2.Typical 5. 8.	1.E Grade 4.B Grade 7.
4.Asbestos 8.Concrete 12.	3.Old Type 6. 9.None	2.D Grade 5.A Grade 8.SC Grade
Roof Surface 0	Bath(s) Style 0	3.C Grade 6.AA Grade 9.Same
1.Asphalt 4.Composit 7.	1.Modern 4.Obsolete 7.	SQFT (Footprint) 0
2.Slate 5.Wood 8.	2.Typical 5. 8.	Condition 0
3.Metal 6.Other 9.	3.Old Type 6. 9.None	1.Poor 4.Avg 7.V G
SF Masonry Trim 0	# Rooms 0	2.Fair 5.Avg+ 8.Exc
OPEN-3-CUSTOM 0	# Bedrooms 0	3.Avg- 6.Good 9.Same
OPEN-4-CUSTOM 0	# Full Baths 0	Phys. % Good 0%
Year Built 0	# Half Baths 0	Funct. % Good 100%
Year Remodeled 0	# Addn Fixtures 0	Functional Code 9 None
Foundation 0	# Fireplaces 0	1.Incomp 4.Delap 7.No Power
1.Concrete 4.Wood 7.		2.O-Built 5.Bsmt 8.LongTerm
2.C Block 5.Slab 8.		3.Damage 6.Common 9.None
3.Br/Stone 6.Piers 9.		Econ. % Good 100%
Basement 0		Economic Code None
1.1/4 Bmt 4.Full Bmt 7.		0.None 3.No Power 7.
2.1/2 Bmt 5.None 8.		1.Location 4.Generate 8.
3.3/4 Bmt 6. 9.None		2.Encroach 9.None 9.
Bsmt Gar # Cars 0		Entrance Code 0
Wet Basement 0		1.Interior 4.Vacant 7.
1.Dry 4. 7.		2.Refusal 5.Estimate 8.
2.Damp 5. 8.	3.Informed 6.Reviewed 9.	
3.Wet 6. 9.	Information Code 0	
		1.Owner 4.Agent 7.
		2.Relative 5.Estimate 8.
		3.Tenant 6.Other 9.

Date Inspected

Additions, Outbuildings & Improvements

Type	Year	Units	Grade	Cond	Phys.	Funct.	Sound Value
					%	%	1.One Story Fram
					%	%	2.Two Story Fram
					%	%	3.Three Story Fr
					%	%	4.1 & 1/2 Story
					%	%	5.1 & 3/4 Story
					%	%	6.2 & 1/2 Story
					%	%	21.Open Frame Por
					%	%	22.Encl Frame Por
					%	%	23.Frame Garage
					%	%	24.Frame Shed
					%	%	25.Frame Bay Wind
					%	%	26.1SFr Overhang
					%	%	27.Unfin Basement
					%	%	28.Unfinished Att
					%	%	29.Finished Attic

Washburn

Map Lot 002-015

Account 838

Location 70 CROSS ROAD

Card 1 Of 1 9/04/2024

Building Style 0	SF Bsmt Living 0	Layout 0
1.Conv. 5.Garrison 9.Gambrel	Fin Bsmt Grade 0 0	1.Typical 4. 7.
2.Ranch 6.Salt Box 10.Other	OPEN 5 OPTIONAL 0	2.Inadeq 5. 8.
3.R Ranch 7.Contemp 11.Split	Heat Type 100% 0	3.Poor 6. 9.
4.Cape 8.Log 12.	1.HWBB 5.FWA 9.No Heat	Attic 0
Dwelling Units 0	2.HWCI 6.GravWA 10.	1.1/4 Fin 4.Full Fin 7.
Other Units 0	3.H Pump 7.Electric 11.	2.1/2 Fin 5.FI/Stair 8.
Stories 0	4.Steam 8.FI/Wall 12.	3.3/4 Fin 6. 9.None
1.1 4.1.5 7.	Cool Type 0% 9 None	Insulation 0
2.2 5.1.75 8.	1.Refrig 4.W&C Air 7.	1.Full 4.Minimal 7.
3.3 6.2.5 9.	2.Evapor 5. 8.	2.Heavy 5.Partial 8.
Exterior Walls 0	3.H Pump 6. 9.None	3.Capped 6. 9.None
1.Wood 5.Stucco 9.T-111	Kitchen Style 0	Unfinished % 0%
2.Vin/Al 6.Brick 10.Other	1.Modern 4.Obsolete 7.	Grade & Factor 0 0%
3.Compos. 7.Stone 11.	2.Typical 5. 8.	1.E Grade 4.B Grade 7.
4.Asbestos 8.Concrete 12.	3.Old Type 6. 9.None	2.D Grade 5.A Grade 8.SC Grade
Roof Surface 0	Bath(s) Style 0	3.C Grade 6.AA Grade 9.Same
1.Asphalt 4.Composit 7.	1.Modern 4.Obsolete 7.	SQFT (Footprint) 0
2.Slate 5.Wood 8.	2.Typical 5. 8.	Condition 0
3.Metal 6.Other 9.	3.Old Type 6. 9.None	1.Poor 4.Avg 7.V G
SF Masonry Trim 0	# Rooms 0	2.Fair 5.Avg+ 8.Exc
OPEN-3-CUSTOM 0	# Bedrooms 0	3.Avg- 6.Good 9.Same
OPEN-4-CUSTOM 0	# Full Baths 0	Phys. % Good 0%
Year Built 0	# Half Baths 0	Funct. % Good 100%
Year Remodeled 0	# Addn Fixtures 0	Functional Code 9 None
Foundation 0	# Fireplaces 0	1.Incomp 4.Delap 7.No Power
1.Concrete 4.Wood 7.	 <p>TRIO Software A Division of Harris Computer Systems</p>	2.O-Built 5.Bsmt 8.LongTerm
2.C Block 5.Slab 8.		3.Damage 6.Common 9.None
3.Br/Stone 6.Piers 9.		Econ. % Good 100%
Basement 0		Economic Code None
1.1/4 Bmt 4.Full Bmt 7.		0.None 3.No Power 7.
2.1/2 Bmt 5.None 8.		1.Location 4.Generate 8.
3.3/4 Bmt 6. 9.None		2.Encroach 9.None 9.
Bsmt Gar # Cars 0		Entrance Code 5 Estimated
Wet Basement 0		1.Interior 4.Vacant 7.
1.Dry 4. 7.		2.Refusal 5.Estimate 8.
2.Damp 5. 8.	3.Informed 6.Reviewed 9.	
3.Wet 6. 9.	Information Code 5 Estimate	
	1.Owner 4.Agent 7.	
	2.Relative 5.Estimate 8.	
	3.Tenant 6.Other 9.	

Date Inspected 8/05/2018

Additions, Outbuildings & Improvements

Type	Year	Units	Grade	Cond	Phys.	Funct.	Sound Value
998 14Mobile Home	1985	14x66	4 100	3	0 %	100 %	
18 1 S-MH add	2010	168	3 105	4	0 %	100 %	
68 Wood Deck	2000	292	3 100	4	0 %	100 %	
24 Frame Shed	0				%	%	800
68 Wood Deck	2000	60	3 100	4	0 %	100 %	
24 Frame Shed	0				%	%	800
61 Canopy	0				%	%	200
24 Frame Shed	0				%	%	400
75 Quonset Shed	1970	1200	3 100	4	0 %	35 %	
23 Frame Garage	2000	576	3 100	4	0 %	100 %	

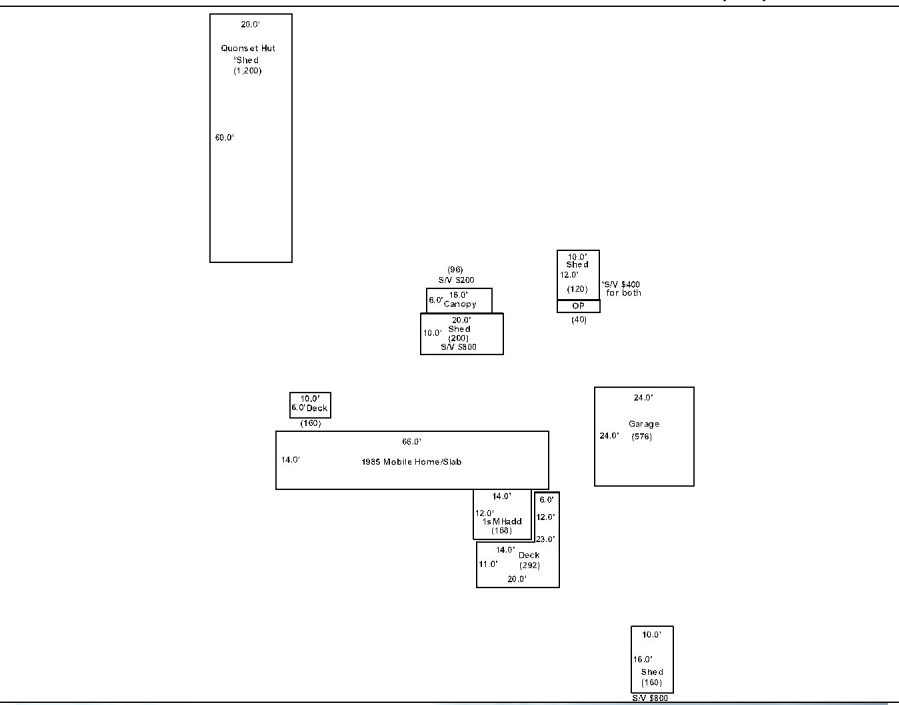

Washburn

Map Lot 002-016

Account 207

Location 122 CROSS ROAD

Card 1

Of 1

9/04/2024

Building Style	2 Ranch		SF Bsmt Living	0		Layout	1 Typical							
1.Conv.	5.Garrison	9.Gambrel	Fin Bsmt Grade	0 0		1.Typical	4.	7.						
2.Ranch	6.Salt Box	10.Other	OPEN 5 OPTIONAL	0		2.Inadeq	5.	8.						
3.R Ranch	7.Contemp	11.Split	Heat Type	100% 5 Forced Warm Air		3.Poor	6.	9.						
4.Cape	8.Log	12.	1.HWBB	5.FWA	9.No Heat	Attic	9 None							
Dwelling Units	1		2.HWCI	6.GravWA	10.	1.1/4 Fin	4.Full Fin	7.						
Other Units	0		3.H Pump	7.Electric	11.	2.1/2 Fin	5.FI/Stair	8.						
Stories	1 One Story		4.Steam	8.FI/Wall	12.	3.3/4 Fin	6.	9.None						
1.1	4.1.5	7.	Cool Type	0% 9 None		Insulation	1 Full							
2.2	5.1.75	8.	1.Refrig	4.W&C Air	7.	1.Full	4.Minimal	7.						
3.3	6.2.5	9.	2.Evapor	5.	8.	2.Heavy	5.Partial	8.						
Exterior Walls	2 Vinyl/Aluminum		3.H Pump	6.	9.None	3.Capped	6.	9.None						
1.Wood	5.Stucco	9.T-111	Kitchen Style	2 Typical		Unfinished %	0%							
2.Vin/Al	6.Brick	10.Other	1.Modern	4.Obsolete	7.	Grade & Factor	3 Average 100%							
3.Compos.	7.Stone	11.	2.Typical	5.	8.	1.E Grade	4.B Grade	7.						
4.Asbestos	8.Concrete	12.	3.Old Type	6.	9.None	2.D Grade	5.A Grade	8.SC Grade						
Roof Surface	3 Sheet Metal		Bath(s) Style	2 Typical Bath(s)		3.C Grade	6.AA Grade	9.Same						
1.Asphalt	4.Composit	7.	1.Modern	4.Obsolete	7.	SQFT (Footprint)	1092							
2.Slate	5.Wood	8.	2.Typical	5.	8.	Condition	4 Average							
3.Metal	6.Other	9.	3.Old Type	6.	9.None	1.Poor	4.Avg	7.V G						
SF Masonry Trim	0		# Rooms	4		2.Fair	5.Avg+	8.Exc						
OPEN-3-CUSTOM	0		# Bedrooms	3		3.Avg-	6.Good	9.Same						
OPEN-4-CUSTOM	0		# Full Baths	1		Phys. % Good	0%							
Year Built	2007		# Half Baths	0		Funct. % Good	100%							
Year Remodeled	0		# Addn Fixtures	0		Functional Code	9 None							
Foundation	1 Concrete		# Fireplaces	0		1.Incomp	4.Delap	7.No Power						
1.Concrete	4.Wood	7.							2.O-Built	5.Bsmt	8.LongTerm			
2.C Block	5.Slab	8.							Econ. % Good	100%		3.Damage	6.Common	9.None
3.Br/Stone	6.Piers	9.							Economic Code	None		0.None	3.No Power	7.
Basement	4 Full Basement								Entrance Code	3 Information Only		1.Location	4.Generate	8.
1.1/4 Bmt	4.Full Bmt	7.							1.Interior	4.Vacant	7.	2.Encroach	9.None	9.
2.1/2 Bmt	5.None	8.							2.Refusal	5.Estimate	8.	Information Code	2 Relative	
3.3/4 Bmt	6.	9.None							3.Informed	6.Reviewed	9.	1.Owner	4.Agent	7.
Bsmt Gar # Cars	0								2.Relative	5.Estimate	8.	3.Tenant	6.Other	9.
Wet Basement	1 Dry Basement								3.Fin	6.Reviewed	9.			
1.Dry	4.	7.												
2.Damp	5.	8.												
3.Wet	6.	9.												

Date Inspected 8/05/2018

Additions, Outbuildings & Improvements

Type	Year	Units	Grade	Cond	Phys.	Funct.	Sound Value
68 Wood Deck	0	260	0 0	0	0 %	0 %	
23 Frame Garage	0	2000	4 100	4	0 %	100 %	
1 One Story Frame	0	308	0 0	0	0 %	0 %	
24 Frame Shed	0				%	%	1,000
1 One Story Frame	0	120	0 0	0	0 %	0 %	
21 Open Frame	2007	180	3 100	4	0 %	100 %	
					%	%	
					%	%	
					%	%	
					%	%	
					%	%	

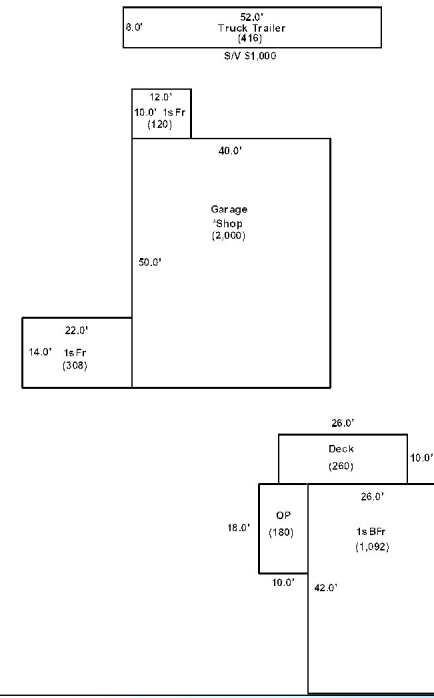

Washburn

Map Lot 002-016A

Account 97

Location 112 CROSS ROAD

Card 1 Of 1 9/04/2024

Building Style 0	SF Bsmt Living 0	Layout 0
1.Conv. 5.Garrison 9.Gambrel	Fin Bsmt Grade 0 0	1.Typical 4. 7.
2.Ranch 6.Salt Box 10.Other	OPEN 5 OPTIONAL 0	2.Inadeq 5. 8.
3.R Ranch 7.Contemp 11.Split	Heat Type 100% 0	3.Poor 6. 9.
4.Cape 8.Log 12.	1.HWBB 5.FWA 9.No Heat	Attic 0
Dwelling Units 0	2.HWCI 6.GravWA 10.	1.1/4 Fin 4.Full Fin 7.
Other Units 0	3.H Pump 7.Electric 11.	2.1/2 Fin 5.F/Stair 8.
Stories 0	4.Steam 8.F/Wall 12.	3.3/4 Fin 6. 9.None
1.1 4.1.5 7.	Cool Type 0% 9 None	Insulation 0
2.2 5.1.75 8.	1.Refrig 4.W&C Air 7.	1.Full 4.Minimal 7.
3.3 6.2.5 9.	2.Evapor 5. 8.	2.Heavy 5.Partial 8.
Exterior Walls 0	3.H Pump 6. 9.None	3.Capped 6. 9.None
1.Wood 5.Stucco 9.T-111	Kitchen Style 0	Unfinished % 0%
2.Vin/Al 6.Brick 10.Other	1.Modern 4.Obsolete 7.	Grade & Factor 0 0%
3.Compos. 7.Stone 11.	2.Typical 5. 8.	1.E Grade 4.B Grade 7.
4.Asbestos 8.Concrete 12.	3.Old Type 6. 9.None	2.D Grade 5.A Grade 8.SC Grade
Roof Surface 0	Bath(s) Style 0	3.C Grade 6.AA Grade 9.Same
1.Asphalt 4.Composit 7.	1.Modern 4.Obsolete 7.	SQFT (Footprint) 0
2.Slate 5.Wood 8.	2.Typical 5. 8.	Condition 0
3.Metal 6.Other 9.	3.Old Type 6. 9.None	1.Poor 4.Avg 7.V G
SF Masonry Trim 0	# Rooms 0	2.Fair 5.Avg+ 8.Exc
OPEN-3-CUSTOM 0	# Bedrooms 0	3.Avg- 6.Good 9.Same
OPEN-4-CUSTOM 0	# Full Baths 0	Phys. % Good 0%
Year Built 0	# Half Baths 0	Funct. % Good 100%
Year Remodeled 0	# Addn Fixtures 0	Functional Code 9 None
Foundation 0	# Fireplaces 0	1.Incomp 4.Delap 7.No Power
1.Concrete 4.Wood 7.		2.O-Built 5.Bsmt 8.LongTerm
2.C Block 5.Slab 8.		3.Damage 6.Common 9.None
3.Br/Stone 6.Piers 9.		Econ. % Good 100%
Basement 0		Economic Code None
1.1/4 Bmt 4.Full Bmt 7.		0.None 3.No Power 7.
2.1/2 Bmt 5.None 8.		1.Location 4.Generate 8.
3.3/4 Bmt 6. 9.None		2.Encroach 9.None 9.
Bsmt Gar # Cars 0		Entrance Code 3 Information Only
Wet Basement 0		1.Interior 4.Vacant 7.
1.Dry 4. 7.		2.Refusal 5.Estimate 8.
2.Damp 5. 8.		3.Informed 6.Reviewed 9.
3.Wet 6. 9.		Information Code 1 Owner
		1.Owner 4.Agent 7.
		2.Relative 5.Estimate 8.
		3.Tenant 6.Other 9.

Date Inspected 8/05/2018

Additions, Outbuildings & Improvements

Type	Year	Units	Grade	Cond	Phys.	Funct.	Sound Value
992 Double Wide	2000	27x48	4 100	6	0 %	100 %	
23 Frame Garage	2000	672	3 100	4	0 %	100 %	
24 Frame Shed	0				%	%	400
48 Concrete Slab	2000	1296	3 100	4	0 %	100 %	
					%	%	
					%	%	
					%	%	
					%	%	
					%	%	
					%	%	
					%	%	
					%	%	

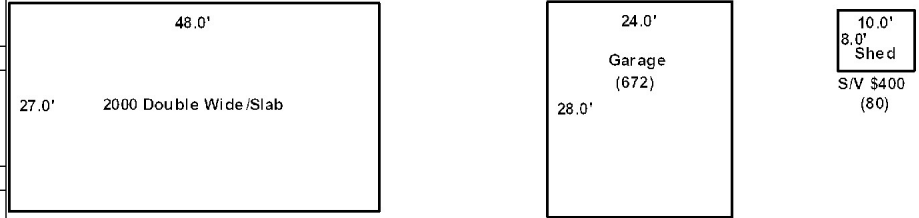

CASTONGUAY, JERRY
PO BOX 15
WASHBURN ME 04786

B3146P257

Inspection Witnessed By:

No./Date	Description	Date Insp.
X		

Notes:

Washburn

Property Data			Assessment Record						
Neighborhood 1 Neighborhood One			Year	Land	Buildings	Exempt	Total		
Tree Growth Year 0			2012	4,500	0	0	4,500		
1ST MORTGAGE 0			2013	5,900	0	0	5,900		
2ND MORTGAGE 0			2015	5,900	0	0	5,900		
Zone/Land Use 1 Residential			2018	5,900	2,000	0	7,900		
Secondary Zone			2019	9,000	2,000	0	11,000		
Topography 1 Level			2020	9,000	2,000	0	11,000		
1.Level 4.Below St 7.LevelBog			2021	9,000	2,000	0	11,000		
2.Rolling 5.Low 8.			2022	9,000	2,000	0	11,000		
3.Above St 6.Swampy 9.			2023	11,000	2,000	0	13,000		
Utilities			2024	11,000	2,000	0	13,000		
1.Public 4.Dr Well 7.Cesspool									
2.Water 5.Dug Well 8.									
3.Sewer 6.Septic 9.None									
Street 1 Paved									
1.Paved 4.Proposed 7.									
2.Semi Imp 5.R/O/W 8.									
3.Gravel 6. 9.None									
TG PLAN YEAR 0									
Tif District # 0									
Sale Data			Land Data						
Sale Date 6/05/1998			Front Foot	Type	Effective		Influence		Influence Codes
Price 4,000					Frontage	Depth	Factor	Code	
Sale Type 2 Land & Buildings			11.Regular Lot					1.Unimproved	
1.Land 4.Mobile 7.C/I L&B			12.Delta Triangle					2.Excess Frtg	
2.L & B 5.Other 8.			13.Nabla Triangle					3.Topography	
3.Building 6.C/I Land 9.			14.Rear Land					4.Size/Shape	
Financing 1 Conventional			15.Class I Road					5.Access	
1.Convent 4.Seller 7.								6.Restriction	
2.FHA/VA 5.Private 8.								7.Open Space	
3.Assumed 6.Cash 9.Unknown								8.View/Environ	
Validity 1 Arms Length Sale								9.Fract Share	
1.Valid 4.Split 7.Renovate			Square Foot	Square Feet				Acres	
2.Related 5.Partial 8.Other			16.Class II Road					30.Utility R O W	
3.Distress 6.Exempt 9.			17.Municipal Rese					31.Tillable	
Verified 5 Public Record			18.Munic Sep Lago					32.Pasture	
1.Buyer 4.Agent 7.Family			19.Gravel Pit					33.Orchard	
2.Seller 5.Pub Rec 8.Other			20.Industrial Bas					34.Softwood F&O	
3.Lender 6.MLS 9.			Fract. Acre	Acres/Sites				35.Mixed Wood F&O	
			21.Developed Pave	22	1.00	100	%	0	
			22.Undev Paved (F				%		
			23.Developed Grav				%		
			Acres				%		
			24.Undev Gravel (%		
			25.Comm Base Pave				%		
			26.Comm Base Grav				%		
			27.Backlot				%		
			28.Rear Land				%		
			29.Pavement				%		
			Total Acreage		1.00				
								44.Lot Improvemen	
								45.Subdivision Lo	
								46.Heavy Ind Sit	

Drost, Dylan
102 Cross Rd
Washburn ME 04786

B6274P59

Previous Owner
DROST, MARIE
DROST, BRUCE J
EASLER, CYNTHIA A.
WASHBURN ME 04786
Sale Date: 1/05/2022

Inspection Witnessed By:

X Date

No./Date	Description	Date Insp.

Notes:

Washburn

Property Data			Assessment Record							
Neighborhood 1 Neighborhood One			Year	Land	Buildings	Exempt	Total			
Tree Growth Year 0			2012	6,700	49,500	8,800	47,400			
1ST MORTGAGE 0			2013	8,700	49,500	8,800	49,400			
2ND MORTGAGE 0			2015	8,700	49,500	9,000	49,200			
Zone/Land Use 1 Residential			2018	8,700	49,500	18,400	39,800			
Secondary Zone			2019	16,700	47,800	20,000	44,500			
Topography 1 Level			2020	16,700	47,800	25,000	39,500			
1.Level 4.Below St 7.LevelBog			2021	16,700	47,800	25,000	39,500			
2.Rolling 5.Low 8.			2022	16,700	50,100	0	66,800			
3.Above St 6.Swampy 9.			2023	22,200	59,400	25,000	56,600			
Utilities 4 Drilled Well 6 Septic System			2024	22,200	59,400	25,000	56,600			
1.Public 4.Dr Well 7.Cesspool										
2.Water 5.Dug Well 8.										
3.Sewer 6.Septic 9.None										
Street 1 Paved										
1.Paved 4.Proposed 7.										
2.Semi Imp 5.R/O/W 8.										
3.Gravel 6. 9.None										
TG PLAN YEAR 0										
Tif District # 0										
Sale Data			Land Data							
Sale Date 1/05/2022			Front Foot	Type	Effective		Influence		Influence Codes	
Price 57,633					Frontage	Depth	Factor	Code		
Sale Type 2 Land & Buildings				11.Regular Lot						1.Unimproved
1.Land 4.Mobile 7.C/I L&B				12.Delta Triangle						2.Excess Frtg
2.L & B 5.Other 8.				13.Nabla Triangle						3.Topography
3.Building 6.C/I Land 9.			14.Rear Land					4.Size/Shape		
Financing 1 Conventional			15.Class I Road					5.Access		
1.Convent 4.Seller 7.			Square Foot	Square Feet				6.Restriction		
2.FHA/VA 5.Private 8.				16.Class II Road				7.Open Space		
3.Assumed 6.Cash 9.Unknown				17.Municipal Rese				8.View/Environ		
Validity 2 Related Parties				18.Munic Sep Lago				9.Fract Share		
1.Valid 4.Split 7.Renovate				19.Gravel Pit				30.Utility R O W		
2.Related 5.Partial 8.Other			20.Industrial Bas				31.Tillable			
3.Distress 6.Exempt 9.			Fract. Acre	Acres/Sites				32.Pasture		
Verified 5 Public Record				21.Developed Pave	21	1.00	100	%	0	33.Orchard
1.Buyer 4.Agent 7.Family				22.Undev Paved (F	28	0.37	100	%	0	34.Softwood F&O
2.Seller 5.Pub Rec 8.Other				23.Developed Grav						35.Mixed Wood F&O
3.Lender 6.MLS 9.				24.Undev Gravel (36.Hardwood F&O
			25.Comm Base Pave						37.Softwood TG	
			26.Comm Base Grav						38.Mixed Wood TG	
			27.Backlot						39.Hardwood TG	
			28.Rear Land						40.Wasteland	
			29.Pavement						41.Open Space	
			Total Acreage		1.37				42.Mobile Home Si	
									43.Condo Site	
									44.Lot Improvemen	
									45.Subdivision Lo	
									46.Heavy Ind Sit	

Washburn

Map Lot 002-017

Account 401

Location 102 CROSS ROAD

Card 1 Of 1 9/04/2024

Building Style 2 Ranch	SF Bsmt Living 0	Layout 1 Typical
1.Conv. 5.Garrison 9.Gambrel	Fin Bsmt Grade 0 0	1.Typical 4. 7.
2.Ranch 6.Salt Box 10.Other	OPEN 5 OPTIONAL 0	2.Inadeq 5. 8.
3.R Ranch 7.Contemp 11.Split	Heat Type 100% 5 Forced Warm Air	3.Poor 6. 9.
4.Cape 8.Log 12.	1.HWBB 5.FWA 9.No Heat	Attic 9 None
Dwelling Units 1	2.HWCI 6.GravWA 10.	1.1/4 Fin 4.Full Fin 7.
Other Units 0	3.H Pump 7.Electric 11.	2.1/2 Fin 5.FI/Stair 8.
Stories 1 One Story	4.Steam 8.FI/Wall 12.	3.3/4 Fin 6. 9.None
1.1 4.1.5 7.	Cool Type 0% 9 None	Insulation 4 Minimal
2.2 5.1.75 8.	1.Refrig 4.W&C Air 7.	1.Full 4.Minimal 7.
3.3 6.2.5 9.	2.Evapor 5. 8.	2.Heavy 5.Partial 8.
Exterior Walls 2 Vinyl/Aluminum	3.H Pump 6. 9.None	3.Capped 6. 9.None
1.Wood 5.Stucco 9.T-111	Kitchen Style 2 Typical	Unfinished % 0%
2.Vin/Al 6.Brick 10.Other	1.Modern 4.Obsolete 7.	Grade & Factor 3 Average 95%
3.Compos. 7.Stone 11.	2.Typical 5. 8.	1.E Grade 4.B Grade 7.
4.Asbestos 8.Concrete 12.	3.Old Type 6. 9.None	2.D Grade 5.A Grade 8.SC Grade
Roof Surface 1 Asphalt Shingles	Bath(s) Style 2 Typical Bath(s)	3.C Grade 6.AA Grade 9.Same
1.Asphalt 4.Composit 7.	1.Modern 4.Obsolete 7.	SQFT (Footprint) 1064
2.Slate 5.Wood 8.	2.Typical 5. 8.	Condition 5 Above Average
3.Metal 6.Other 9.	3.Old Type 6. 9.None	1.Poor 4.Avg 7.V G
SF Masonry Trim 0	# Rooms 5	2.Fair 5.Avg+ 8.Exc
OPEN-3-CUSTOM 0	# Bedrooms 3	3.Avg- 6.Good 9.Same
OPEN-4-CUSTOM 0	# Full Baths 1	Phys. % Good 0%
Year Built 1959	# Half Baths 0	Funct. % Good 100%
Year Remodeled 0	# Addn Fixtures 0	Functional Code 9 None
Foundation 1 Concrete	# Fireplaces 0	1.Incomp 4.Delap 7.No Power
1.Concrete 4.Wood 7.	 <p>TRIO Software <small>A Division of Harris Computer Systems</small></p>	2.O-Built 5.Bsmt 8.LongTerm
2.C Block 5.Slab 8.		3.Damage 6.Common 9.None
3.Br/Stone 6.Piers 9.		Econ. % Good 100%
Basement 4 Full Basement		Economic Code None
1.1/4 Bmt 4.Full Bmt 7.		0.None 3.No Power 7.
2.1/2 Bmt 5.None 8.		1.Location 4.Generate 8.
3.3/4 Bmt 6. 9.None		2.Encroach 9.None 9.
Bsmt Gar # Cars 0		Entrance Code 1 Interior Inspect
Wet Basement 3 Wet Basement		1.Interior 4.Vacant 7.
1.Dry 4. 7.		2.Refusal 5.Estimate 8.
2.Damp 5. 8.	3.Informed 6.Reviewed 9.	
3.Wet 6. 9.	Information Code 1 Owner	
	1.Owner 4.Agent 7.	
	2.Relative 5.Estimate 8.	
	3.Tenant 6.Other 9.	

12.0'
Shed
16.0'
(192)
S/V \$500

8.0'
16.0'
(128)

Trailer Box
S/V \$1,000

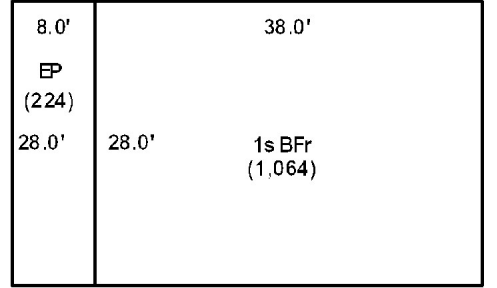

Date Inspected 9/06/2018

Additions, Outbuildings & Improvements

Type	Year	Units	Grade	Cond	Phys.	Funct.	Sound Value
22 Encl Frame Porch	1980	224	3 100	4	0 %	100 %	
24 Frame Shed	0				%	%	1,000
24 Frame Shed	0				%	%	500
					%	%	
					%	%	
					%	%	
					%	%	
					%	%	
					%	%	
					%	%	



- 1.One Story Fram
- 2.Two Story Fram
- 3.Three Story Fr
- 4.1 & 1/2 Story
- 5.1 & 3/4 Story
- 6.2 & 1/2 Story
- 21.Open Frame Por
- 22.Encl Frame Por
- 23.Frame Garage
- 24.Frame Shed
- 25.Frame Bay Wind
- 26.1SFr Overhang
- 27.Unfin Basement
- 28.Unfinished Att
- 29.Finished Attic

KIDNEY, KEVIN C
134 CROSS ROAD
WASHBURN ME 04786

B3431P243 B4080P340

Inspection Witnessed By:

No./Date	Description	Date Insp.
X		

Notes:
*Garage -15% for size obsol. during reval.

Washburn

Property Data			Assessment Record						
Neighborhood 1 Neighborhood One			Year	Land	Buildings	Exempt	Total		
Tree Growth Year 0			2012	6,700	72,700	8,800	70,600		
1ST MORTGAGE 0			2013	8,700	72,700	8,800	72,600		
2ND MORTGAGE 0			2015	8,700	72,700	9,000	72,400		
Zone/Land Use 1 Residential			2018	8,700	72,700	18,400	63,000		
Secondary Zone			2019	16,700	81,500	20,000	78,200		
Topography 4 Below Street			2020	16,700	80,400	25,000	72,100		
1.Level 4.Below St 7.LevelBog			2021	16,700	81,500	25,000	73,200		
2.Rolling 5.Low 8.			2022	16,700	85,500	25,000	77,200		
3.Above St 6.Swampy 9.			2023	22,200	101,800	25,000	99,000		
Utilities 4 Drilled Well 6 Septic System			2024	22,200	101,800	25,000	99,000		
1.Public 4.Dr Well 7.Cesspool									
2.Water 5.Dug Well 8.									
3.Sewer 6.Septic 9.None									
Street 1 Paved									
1.Paved 4.Proposed 7.									
2.Semi Imp 5.R/O/W 8.									
3.Gravel 6. 9.None									
TG PLAN YEAR 0									
Tif District # 0									
Sale Data			Land Data						
Sale Date 8/31/2000			Front Foot	Type	Effective		Influence		Influence Codes
Price 73,500					Frontage	Depth	Factor	Code	
Sale Type 2 Land & Buildings			11.Regular Lot					1.Unimproved	
1.Land 4.Mobile 7.C/I L&B			12.Delta Triangle			%		2.Excess Frtg	
2.L & B 5.Other 8.			13.Nabla Triangle			%		3.Topography	
3.Building 6.C/I Land 9.			14.Rear Land			%		4.Size/Shape	
Financing 1 Conventional			15.Class I Road			%		5.Access	
1.Convent 4.Seller 7.						%		6.Restriction	
2.FHA/VA 5.Private 8.						%		7.Open Space	
3.Assumed 6.Cash 9.Unknown						%		8.View/Environ	
Validity 1 Arms Length Sale						%		9.Fract Share	
1.Valid 4.Split 7.Renovate			Square Foot	Square Feet				Acres	
2.Related 5.Partial 8.Other			16.Class II Road			%		30.Utility R O W	
3.Distress 6.Exempt 9.			17.Municipal Rese			%		31.Tillable	
Verified 5 Public Record			18.Munic Sep Lago			%		32.Pasture	
1.Buyer 4.Agent 7.Family			19.Gravel Pit			%		33.Orchard	
2.Seller 5.Pub Rec 8.Other			20.Industrial Bas			%		34.Softwood F&O	
3.Lender 6.MLS 9.						%		35.Mixed Wood F&O	
			Fract. Acre	Acres/Sites				36.Hardwood F&O	
			21.Developed Pave	21	1.00	100	% 0	37.Softwood TG	
			22.Undev Paved (F	28	0.42	100	% 0	38.Mixed Wood TG	
			23.Developed Grav				%	39.Hardwood TG	
			Acres				%	40.Wasteland	
			24.Undev Gravel (%	41.Open Space	
			25.Comm Base Pave				%	42.Mobile Home Si	
			26.Comm Base Grav				%	43.Condo Site	
			27.Backlot				%	44.Lot Improvemen	
			28.Rear Land				%	45.Subdivision Lo	
			29.Pavement				%	46.Heavy Ind Sit	
			Total Acreage		1.42				

Washburn

Map Lot 002-019

Account 1026

Location 166 CROSS ROAD

Card 1 Of 1 9/04/2024

Building Style 0	SF Bsmt Living 0	Layout 0
1.Conv. 5.Garrison 9.Gambrel	Fin Bsmt Grade 0 0	1.Typical 4. 7.
2.Ranch 6.Salt Box 10.Other	OPEN 5 OPTIONAL 0	2.Inadeq 5. 8.
3.R Ranch 7.Contemp 11.Split	Heat Type 100% 0	3.Poor 6. 9.
4.Cape 8.Log 12.	1.HWBB 5.FWA 9.No Heat	Attic 0
Dwelling Units 0	2.HWCI 6.GravWA 10.	1.1/4 Fin 4.Full Fin 7.
Other Units 0	3.H Pump 7.Electric 11.	2.1/2 Fin 5.FI/Stair 8.
Stories 0	4.Steam 8.FI/Wall 12.	3.3/4 Fin 6. 9.None
1.1 4.1.5 7.	Cool Type 0% 9 None	Insulation 0
2.2 5.1.75 8.	1.Refrig 4.W&C Air 7.	1.Full 4.Minimal 7.
3.3 6.2.5 9.	2.Evapor 5. 8.	2.Heavy 5.Partial 8.
Exterior Walls 0	3.H Pump 6. 9.None	3.Capped 6. 9.None
1.Wood 5.Stucco 9.T-111	Kitchen Style 0	Unfinished % 0%
2.Vin/Al 6.Brick 10.Other	1.Modern 4.Obsolete 7.	Grade & Factor 0 0%
3.Compos. 7.Stone 11.	2.Typical 5. 8.	1.E Grade 4.B Grade 7.
4.Asbestos 8.Concrete 12.	3.Old Type 6. 9.None	2.D Grade 5.A Grade 8.SC Grade
Roof Surface 0	Bath(s) Style 0	3.C Grade 6.AA Grade 9.Same
1.Asphalt 4.Composit 7.	1.Modern 4.Obsolete 7.	SQFT (Footprint) 0
2.Slate 5.Wood 8.	2.Typical 5. 8.	Condition 0
3.Metal 6.Other 9.	3.Old Type 6. 9.None	1.Poor 4.Avg 7.V G
SF Masonry Trim 0	# Rooms 0	2.Fair 5.Avg+ 8.Exc
OPEN-3-CUSTOM 0	# Bedrooms 0	3.Avg- 6.Good 9.Same
OPEN-4-CUSTOM 0	# Full Baths 0	Phys. % Good 0%
Year Built 0	# Half Baths 0	Funct. % Good 100%
Year Remodeled 0	# Addn Fixtures 0	Functional Code 9 None
Foundation 0	# Fireplaces 0	1.Incomp 4.Delap 7.No Power
1.Concrete 4.Wood 7.		2.O-Built 5.Bsmt 8.LongTerm
2.C Block 5.Slab 8.		3.Damage 6.Common 9.None
3.Br/Stone 6.Piers 9.		Econ. % Good 100%
Basement 0		Economic Code None
1.1/4 Bmt 4.Full Bmt 7.		0.None 3.No Power 7.
2.1/2 Bmt 5.None 8.		1.Location 4.Generate 8.
3.3/4 Bmt 6. 9.None		2.Encroach 9.None 9.
Bsmt Gar # Cars 0		Entrance Code 0
Wet Basement 0		1.Interior 4.Vacant 7.
1.Dry 4. 7.		2.Refusal 5.Estimate 8.
2.Damp 5. 8.	3.Informed 6.Reviewed 9.	
3.Wet 6. 9.	Information Code 0	
		1.Owner 4.Agent 7.
		2.Relative 5.Estimate 8.
		3.Tenant 6.Other 9.

Date Inspected

Additions, Outbuildings & Improvements

Type	Year	Units	Grade	Cond	Phys.	Funct.	Sound Value
					%	%	1.One Story Fram
					%	%	2.Two Story Fram
					%	%	3.Three Story Fr
					%	%	4.1 & 1/2 Story
					%	%	5.1 & 3/4 Story
					%	%	6.2 & 1/2 Story
					%	%	21.Open Frame Por
					%	%	22.Encl Frame Por
					%	%	23.Frame Garage
					%	%	24.Frame Shed
					%	%	25.Frame Bay Wind
					%	%	26.1SFr Overhang
					%	%	27.Unfin Basement
					%	%	28.Unfinished Att
					%	%	29.Finished Attic

