



## Washburn

Map Lot 001-027

Account 173

Location 1056 WASHBURN ROAD

Card 1 Of 1 9/04/2024

Building Style <b>1 Conventional</b>	SF Bsmt Living <b>0</b>	Layout <b>1 Typical</b>
1.Conv. 5.Garrison 9.Gambrel	Fin Bsmt Grade <b>0 0</b>	1.Typical 4. 7.
2.Ranch 6.Salt Box 10.Other	OPEN 5 OPTIONAL <b>0</b>	2.Inadeq 5. 8.
3.R Ranch 7.Contemp 11.Split	Heat Type <b>100% 8 Floor/Wall Unit</b>	3.Poor 6. 9.
4.Cape 8.Log 12.	1.HWBB 5.FWA 9.No Heat	Attic <b>9 None</b>
Dwelling Units <b>1</b>	2.HWCI 6.GravWA 10.	1.1/4 Fin 4.Full Fin 7.
Other Units <b>0</b>	3.H Pump 7.Electric 11.	2.1/2 Fin 5.FI/Stair 8.
Stories <b>1 One Story</b>	4.Steam 8.FI/Wall 12.	3.3/4 Fin 6. 9.None
1.1 4.1.5 7.	Cool Type <b>100% 3 Heat Pump</b>	Insulation <b>1 Full</b>
2.2 5.1.75 8.	1.Refrig 4.W&C Air 7.	1.Full 4.Minimal 7.
3.3 6.2.5 9.	2.Evapor 5. 8.	2.Heavy 5.Partial 8.
Exterior Walls <b>2 Vinyl/Aluminum</b>	3.H Pump 6. 9.None	3.Capped 6. 9.None
1.Wood 5.Stucco 9.T-111	Kitchen Style <b>2 Typical</b>	Unfinished % <b>0%</b>
2.Vin/Al 6.Brick 10.Other	1.Modern 4.Obsolete 7.	Grade & Factor <b>3 Average 95%</b>
3.Compos. 7.Stone 11.	2.Typical 5. 8.	1.E Grade 4.B Grade 7.
4.Asbestos 8.Concrete 12.	3.Old Type 6. 9.None	2.D Grade 5.A Grade 8.SC Grade
Roof Surface <b>1 Asphalt Shingles</b>	Bath(s) Style <b>2 Typical Bath(s)</b>	3.C Grade 6.AA Grade 9.Same
1.Asphalt 4.Composit 7.	1.Modern 4.Obsolete 7.	SQFT (Footprint) <b>1800</b>
2.Slate 5.Wood 8.	2.Typical 5. 8.	Condition <b>5 Above Average</b>
3.Metal 6.Other 9.	3.Old Type 6. 9.None	1.Poor 4.Avg 7.V G
SF Masonry Trim <b>0</b>	# Rooms <b>5</b>	2.Fair 5.Avg+ 8.Exc
OPEN-3-CUSTOM <b>0</b>	# Bedrooms <b>3</b>	3.Avg- 6.Good 9.Same
OPEN-4-CUSTOM <b>0</b>	# Full Baths <b>1</b>	Phys. % Good <b>0%</b>
Year Built <b>2000</b>	# Half Baths <b>1</b>	Funct. % Good <b>100%</b>
Year Remodeled <b>0</b>	# Addn Fixtures <b>0</b>	Functional Code <b>9 None</b>
Foundation <b>5 Concrete Slab</b>	# Fireplaces <b>0</b>	1.Incomp 4.Delap 7.No Power
1.Concrete 4.Wood 7.	 <p><b>TRIO</b> Software A Division of Harris Computer Systems</p>	2.O-Built 5.Bsmt 8.LongTerm
2.C Block 5.Slab 8.		3.Damage 6.Common 9.None
3.Br/Stone 6.Piers 9.		Econ. % Good <b>100%</b>
Basement <b>9 No Basement</b>		Economic Code <b>None</b>
1.1/4 Bmt 4.Full Bmt 7.		0.None 3.No Power 7.
2.1/2 Bmt 5.None 8.		1.Location 4.Generate 8.
3.3/4 Bmt 6. 9.None		2.Encroach 9.None 9.
Bsmt Gar # Cars <b>0</b>		Entrance Code <b>1 Interior Inspect</b>
Wet Basement <b>9 No Basement</b>		1.Interior 4.Vacant 7.
1.Dry 4. 7.		2.Refusal 5.Estimate 8.
2.Damp 5. 8.	3.Informed 6.Reviewed 9.	
3.Wet 6. 9.	Information Code <b>1 Owner</b>	
	1.Owner 4.Agent 7.	
	2.Relative 5.Estimate 8.	
	3.Tenant 6.Other 9.	

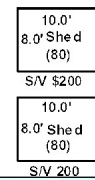
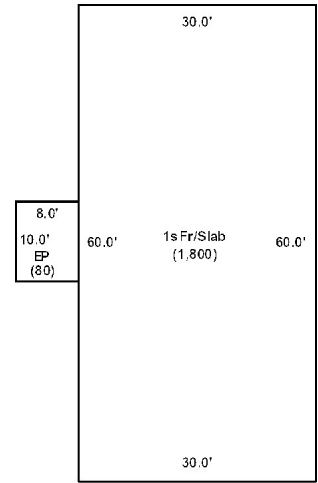

Date Inspected 7/28/2018

### Additions, Outbuildings & Improvements

Type	Year	Units	Grade	Cond	Phys.	Funct.	Sound Value
22 Encl Frame Porch	0	80	0 0	0	0 %	0 %	
24 Frame Shed	0				%	%	200
24 Frame Shed	0				%	%	200
					%	%	
					%	%	
					%	%	
					%	%	
					%	%	
					%	%	
					%	%	
					%	%	



- 1.One Story Fram
- 2.Two Story Fram
- 3.Three Story Fr
- 4.1 & 1/2 Story
- 5.1 & 3/4 Story
- 6.2 & 1/2 Story
- 21.Open Frame Por
- 22.Encl Frame Por
- 23.Frame Garage
- 24.Frame Shed
- 25.Frame Bay Wind
- 26.1SFr Overhang
- 27.Unfin Basement
- 28.Unfinished Att
- 29.Finished Attic



## Washburn

Map Lot 001-027A

Account 172

Location 1060 WASHBURN ROAD

Card 1 Of 1 9/04/2024

Building Style	<b>3 Raised Ranch</b>			SF Bsmt Living	<b>500</b>			Layout	<b>1 Typical</b>		
1.Conv.	5.Garrison	9.Gambrel		Fin Bsmt Grade	<b>9 100</b>			1.Typical	4.	7.	
2.Ranch	6.Salt Box	10.Other		OPEN 5 OPTIONAL	<b>0</b>			2.Inadeq	5.	8.	
3.R Ranch	7.Contemp	11.Split		Heat Type	<b>100% 1 Hot Water BB</b>			3.Poor	6.	9.	
4.Cape	8.Log	12.		1.HWBB	5.FWA	9.No Heat	Attic	<b>9 None</b>			
Dwelling Units	<b>1</b>			2.HWCI	6.GravWA	10.	1.1/4 Fin	4.Full Fin	7.		
Other Units	<b>0</b>			3.H Pump	7.Electric	11.	2.1/2 Fin	5.FI/Stair	8.		
Stories	<b>1 One Story</b>			4.Steam	8.FI/Wall	12.	3.3/4 Fin	6.	9.None		
1.1	4.1.5	7.		Cool Type	<b>100% 3 Heat Pump</b>			Insulation	<b>1 Full</b>		
2.2	5.1.75	8.		1.Refrig	4.W&C Air	7.	1.Full	4.Minimal	7.		
3.3	6.2.5	9.		2.Evapor	5.	8.	2.Heavy	5.Partial	8.		
Exterior Walls	<b>2 Vinyl/Aluminum</b>			3.H Pump	6.	9.None	3.Capped	6.	9.None		
1.Wood	5.Stucco	9.T-111		Kitchen Style	<b>2 Typical</b>			Unfinished %	<b>0%</b>		
2.Vin/Al	6.Brick	10.Other		1.Modern	4.Obsolete	7.	Grade & Factor	<b>3 Average 110%</b>			
3.Compos.	7.Stone	11.		2.Typical	5.	8.	1.E Grade	4.B Grade	7.		
4.Asbestos	8.Concrete	12.		3.Old Type	6.	9.None	2.D Grade	5.A Grade	8.SC Grade		
Roof Surface	<b>1 Asphalt Shingles</b>			Bath(s) Style	<b>2 Typical Bath(s)</b>			3.C Grade	6.AA Grade	9.Same	
1.Asphalt	4.Composit	7.		1.Modern	4.Obsolete	7.	SQFT (Footprint)	<b>1232</b>			
2.Slate	5.Wood	8.		2.Typical	5.	8.	Condition	<b>5 Above Average</b>			
3.Metal	6.Other	9.		3.Old Type	6.	9.None	1.Poor	4.Avg	7.V G		
SF Masonry Trim	<b>0</b>			# Rooms	<b>6</b>			2.Fair	5.Avg+	8.Exc	
OPEN-3-CUSTOM	<b>0</b>			# Bedrooms	<b>3</b>			3.Avg-	6.Good	9.Same	
OPEN-4-CUSTOM	<b>0</b>			# Full Baths	<b>2</b>			Phys. % Good	<b>0%</b>		
Year Built	<b>2005</b>			# Half Baths	<b>0</b>			Funct. % Good	<b>100%</b>		
Year Remodeled	<b>0</b>			# Addn Fixtures	<b>0</b>			Functional Code	<b>9 None</b>		
Foundation	<b>1 Concrete</b>			# Fireplaces	<b>0</b>			1.Incomp	4.Delap	7.No Power	
1.Concrete	4.Wood	7.		 <p><b>TRIO</b> Software A Division of Harris Computer Systems</p>	2.O-Built	5.Bsmt	8.LongTerm				
2.C Block	5.Slab	8.			3.Damage	6.Common	9.None	Econ. % Good	<b>100%</b>		
3.Br/Stone	6.Piers	9.			Economic Code	<b>None</b>			0.None	3.No Power	7.
Basement	<b>4 Full Basement</b>				1.Location	4.Generate	8.	Entrance Code	<b>5 Estimated</b>		
1.1/4 Bmt	4.Full Bmt	7.			2.Encroach	9.None	9.	1.Interior	4.Vacant	7.	
2.1/2 Bmt	5.None	8.			Information Code	<b>5 Estimate</b>			2.Refusal	5.Estimate	8.
3.3/4 Bmt	6.	9.None			1.Owner	4.Agent	7.	3.Informed	6.Reviewed	9.	
Bsmt Gar # Cars	<b>0</b>				2.Relative	5.Estimate	8.	Information Code	<b>5 Estimate</b>		
Wet Basement	<b>1 Dry Basement</b>				3.Tenant	6.Other	9.	1.Owner	4.Agent	7.	
1.Dry	4.	7.						2.Relative	5.Estimate	8.	
2.Damp	5.	8.					3.Tenant	6.Other	9.		
3.Wet	6.	9.									

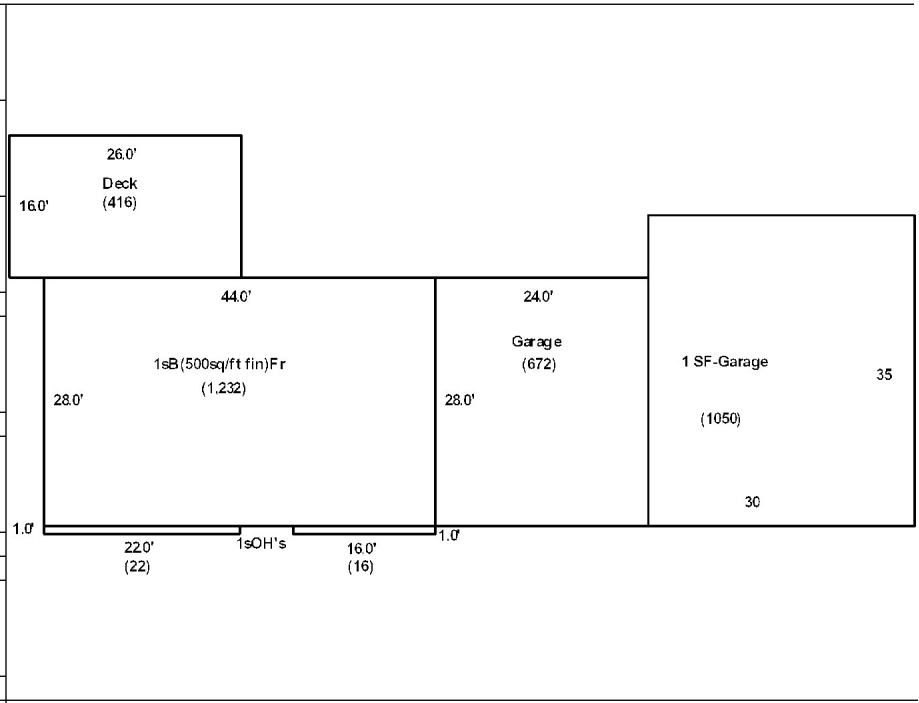

Date Inspected 7/28/2018

### Additions, Outbuildings & Improvements

Type	Year	Units	Grade	Cond	Phys.	Funct.	Sound Value
26 1SFr Overhang	0	22	0 0	0	0 %	0 %	
26 1SFr Overhang	0	16	0 0	0	0 %	0 %	
23 Frame Garage	0	672	0 0	0	0 %	80 %	
68 Wood Deck	0	416	3 100	2	0 %	100 %	
23 Frame Garage	2023	1050	3 115	4	0 %	100 %	
					%	%	
					%	%	
					%	%	
					%	%	
					%	%	
					%	%	
					%	%	

- 1.One Story Fram
- 2.Two Story Fram
- 3.Three Story Fr
- 4.1 & 1/2 Story
- 5.1 & 3/4 Story
- 6.2 & 1/2 Story
- 21.Open Frame Por
- 22.Encl Frame Por
- 23.Frame Garage
- 24.Frame Shed
- 25.Frame Bay Wind
- 26.1SFr Overhang
- 27.Unfin Basement
- 28.Unfinished Att
- 29.Finished Attic







## Washburn

Map Lot 001-029

Account 425

Location 40 Riverside Drive S

Card 1

Of 1

9/04/2024

Building Style <b>0</b>	SF Bsmt Living <b>0</b>	Layout <b>0</b>
1.Conv. 5.Garrison 9.Gambrel	Fin Bsmt Grade <b>0 0</b>	1.Typical 4. 7.
2.Ranch 6.Salt Box 10.Other	OPEN 5 OPTIONAL <b>0</b>	2.Inadeq 5. 8.
3.R Ranch 7.Contemp 11.Split	Heat Type <b>100% 0</b>	3.Poor 6. 9.
4.Cape 8.Log 12.	1.HWBB 5.FWA 9.No Heat	Attic <b>0</b>
Dwelling Units <b>0</b>	2.HWCI 6.GravWA 10.	1.1/4 Fin 4.Full Fin 7.
Other Units <b>0</b>	3.H Pump 7.Electric 11.	2.1/2 Fin 5.FI/Stair 8.
Stories <b>0</b>	4.Steam 8.FI/Wall 12.	3.3/4 Fin 6. 9.None
1.1 4.1.5 7.	Cool Type <b>0% 9 None</b>	Insulation <b>0</b>
2.2 5.1.75 8.	1.Refrig 4.W&C Air 7.	1.Full 4.Minimal 7.
3.3 6.2.5 9.	2.Evapor 5. 8.	2.Heavy 5.Partial 8.
Exterior Walls <b>0</b>	3.H Pump 6. 9.None	3.Capped 6. 9.None
1.Wood 5.Stucco 9.T-111	Kitchen Style <b>0</b>	Unfinished % <b>0%</b>
2.Vin/Al 6.Brick 10.Other	1.Modern 4.Obsolete 7.	Grade & Factor <b>0 0%</b>
3.Compos. 7.Stone 11.	2.Typical 5. 8.	1.E Grade 4.B Grade 7.
4.Asbestos 8.Concrete 12.	3.Old Type 6. 9.None	2.D Grade 5.A Grade 8.SC Grade
Roof Surface <b>0</b>	Bath(s) Style <b>0</b>	3.C Grade 6.AA Grade 9.Same
1.Asphalt 4.Composit 7.	1.Modern 4.Obsolete 7.	SQFT (Footprint) <b>0</b>
2.Slate 5.Wood 8.	2.Typical 5. 8.	Condition <b>0</b>
3.Metal 6.Other 9.	3.Old Type 6. 9.None	1.Poor 4.Avg 7.V G
SF Masonry Trim <b>0</b>	# Rooms <b>0</b>	2.Fair 5.Avg+ 8.Exc
OPEN-3-CUSTOM <b>0</b>	# Bedrooms <b>0</b>	3.Avg- 6.Good 9.Same
OPEN-4-CUSTOM <b>0</b>	# Full Baths <b>0</b>	Phys. % Good <b>0%</b>
Year Built <b>0</b>	# Half Baths <b>0</b>	Funct. % Good <b>100%</b>
Year Remodeled <b>0</b>	# Addn Fixtures <b>0</b>	Functional Code <b>9 None</b>
Foundation <b>0</b>	# Fireplaces <b>0</b>	1.Incomp 4.Delap 7.No Power
1.Concrete 4.Wood 7.	 <p><b>TRIO</b> Software A Division of Harris Computer Systems</p>	2.O-Built 5.Bsmt 8.LongTerm
2.C Block 5.Slab 8.		3.Damage 6.Common 9.None
3.Br/Stone 6.Piers 9.		Econ. % Good <b>100%</b>
Basement <b>0</b>		Economic Code <b>None</b>
1.1/4 Bmt 4.Full Bmt 7.		0.None 3.No Power 7.
2.1/2 Bmt 5.None 8.		1.Location 4.Generate 8.
3.3/4 Bmt 6. 9.None		2.Encroach 9.None 9.
Bsmt Gar # Cars <b>0</b>		Entrance Code <b>5 Estimated</b>
Wet Basement <b>0</b>		1.Interior 4.Vacant 7.
1.Dry 4. 7.		2.Refusal 5.Estimate 8.
2.Damp 5. 8.	3.Informed 6.Reviewed 9.	
3.Wet 6. 9.	Information Code <b>5 Estimate</b>	
	1.Owner 4.Agent 7.	
	2.Relative 5.Estimate 8.	
	3.Tenant 6.Other 9.	

Date Inspected 7/28/2018

### Additions, Outbuildings & Improvements

Type	Year	Units	Grade	Cond	Phys.	Funct.	Sound Value
998 14Mobile Home	1990	14x66	4 100	4	0 %	100 %	
22 Encl Frame Porch	1990	160	2 100	3	0 %	100 %	
24 Frame Shed	1990	960	3 100	4	0 %	100 %	
998 14Mobile Home	1990	14x48	4 100	4	0 %	100 %	
22 Encl Frame Porch	2021	160	3 100	4	0 %	100 %	
21 Open Frame	2021	60	3 100	4	0 %	100 %	
48 Concrete Slab	1990	924	3 100	4	0 %	100 %	
48 Concrete Slab	1990	672	3 100	4	0 %	100 %	
					%	%	
					%	%	

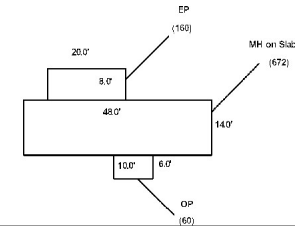
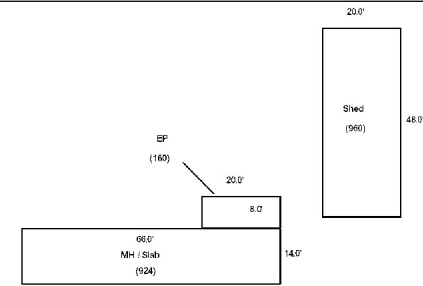





**Washburn**

Map Lot 001-030

Account 265

Location 67 RIVERSIDE DRIVE S

Card 1 Of 1 9/04/2024

Building Style <b>0</b>	SF Bsmt Living <b>0</b>	Layout <b>0</b>
1.Conv. 5.Garrison 9.Gambrel	Fin Bsmt Grade <b>0 0</b>	1.Typical 4. 7.
2.Ranch 6.Salt Box 10.Other	OPEN 5 OPTIONAL <b>0</b>	2.Inadeq 5. 8.
3.R Ranch 7.Contemp 11.Split	Heat Type <b>100% 0</b>	3.Poor 6. 9.
4.Cape 8.Log 12.	1.HWBB 5.FWA 9.No Heat	Attic <b>0</b>
Dwelling Units <b>0</b>	2.HWCI 6.GravWA 10.	1.1/4 Fin 4.Full Fin 7.
Other Units <b>0</b>	3.H Pump 7.Electric 11.	2.1/2 Fin 5.F/Stair 8.
Stories <b>0</b>	4.Steam 8.F/Wall 12.	3.3/4 Fin 6. 9.None
1.1 4.1.5 7.	Cool Type <b>0% 9 None</b>	Insulation <b>0</b>
2.2 5.1.75 8.	1.Refrig 4.W&C Air 7.	1.Full 4.Minimal 7.
3.3 6.2.5 9.	2.Evapor 5. 8.	2.Heavy 5.Partial 8.
Exterior Walls <b>0</b>	3.H Pump 6. 9.None	3.Capped 6. 9.None
1.Wood 5.Stucco 9.T-111	Kitchen Style <b>0</b>	Unfinished % <b>0%</b>
2.Vin/Al 6.Brick 10.Other	1.Modern 4.Obsolete 7.	Grade & Factor <b>0 0%</b>
3.Compos. 7.Stone 11.	2.Typical 5. 8.	1.E Grade 4.B Grade 7.
4.Asbestos 8.Concrete 12.	3.Old Type 6. 9.None	2.D Grade 5.A Grade 8.SC Grade
Roof Surface <b>0</b>	Bath(s) Style <b>0</b>	3.C Grade 6.AA Grade 9.Same
1.Asphalt 4.Composit 7.	1.Modern 4.Obsolete 7.	SQFT (Footprint) <b>0</b>
2.Slate 5.Wood 8.	2.Typical 5. 8.	Condition <b>0</b>
3.Metal 6.Other 9.	3.Old Type 6. 9.None	1.Poor 4.Avg 7.V G
SF Masonry Trim <b>0</b>	# Rooms <b>0</b>	2.Fair 5.Avg+ 8.Exc
OPEN-3-CUSTOM <b>0</b>	# Bedrooms <b>0</b>	3.Avg- 6.Good 9.Same
OPEN-4-CUSTOM <b>0</b>	# Full Baths <b>0</b>	Phys. % Good <b>0%</b>
Year Built <b>0</b>	# Half Baths <b>0</b>	Funct. % Good <b>100%</b>
Year Remodeled <b>0</b>	# Addn Fixtures <b>0</b>	Functional Code <b>9 None</b>
Foundation <b>0</b>	# Fireplaces <b>0</b>	1.Incomp 4.Delap 7.No Power
1.Concrete 4.Wood 7.		2.O-Built 5.Bsmt 8.LongTerm
2.C Block 5.Slab 8.		3.Damage 6.Common 9.None
3.Br/Stone 6.Piers 9.		Econ. % Good <b>100%</b>
Basement <b>0</b>		Economic Code <b>None</b>
1.1/4 Bmt 4.Full Bmt 7.		0.None 3.No Power 7.
2.1/2 Bmt 5.None 8.		1.Location 4.Generate 8.
3.3/4 Bmt 6. 9.None		2.Encroach 9.None 9.
Bsmt Gar # Cars <b>0</b>		Entrance Code <b>0</b>
Wet Basement <b>0</b>		1.Interior 4.Vacant 7.
1.Dry 4. 7.		2.Refusal 5.Estimate 8.
2.Damp 5. 8.	3.Informed 6.Reviewed 9.	
3.Wet 6. 9.	Information Code <b>0</b>	
		1.Owner 4.Agent 7.
		2.Relative 5.Estimate 8.
		3.Tenant 6.Other 9.

Date Inspected

Additions, Outbuildings & Improvements								
Type	Year	Units	Grade	Cond	Phys.	Funct.	Sound Value	
					%	%		1.One Story Fram
					%	%		2.Two Story Fram
					%	%		3.Three Story Fr
					%	%		4.1 & 1/2 Story
					%	%		5.1 & 3/4 Story
					%	%		6.2 & 1/2 Story
					%	%		21.Open Frame Por
					%	%		22.Encl Frame Por
					%	%		23.Frame Garage
					%	%		24.Frame Shed
					%	%		25.Frame Bay Wind
					%	%		26.1SFr Overhang
					%	%		27.Unfin Basement
					%	%		28.Unfinished Att
					%	%		29.Finished Attic

CONLEY, MARK  
P.O. BOX 163  
WASHBURN ME 04786

B5242P301

Inspection Witnessed By:

No./Date	Description	Date Insp.
X		

Notes:  
\*-15% for size of MH during reval.

Washburn

Property Data			Assessment Record						
Neighborhood <b>1 Neighborhood One</b>			Year	Land	Buildings	Exempt	Total		
Tree Growth Year <b>0</b>			2012	6,800	13,000	0	19,800		
1ST MORTGAGE <b>0</b>			2013	8,800	13,000	0	21,800		
2ND MORTGAGE <b>0</b>			2015	8,800	13,000	0	21,800		
Zone/Land Use <b>1 Residential</b>			2018	8,800	13,000	0	21,800		
Secondary Zone			2019	16,800	5,700	0	22,500		
Topography <b>1 Level</b>			2020	16,800	5,700	0	22,500		
1.Level 4.Below St 7.LevelBog			2021	16,800	5,700	0	22,500		
2.Rolling 5.Low 8.			2022	16,800	6,000	0	22,800		
3.Above St 6.Swampy 9.			2023	22,300	7,100	0	29,400		
Utilities <b>3 Public Sewer 4 Drilled Well</b>			2024	22,300	7,100	0	29,400		
1.Public 4.Dr Well 7.Cesspool									
2.Water 5.Dug Well 8.									
3.Sewer 6.Septic 9.None									
Street <b>1 Paved</b>									
1.Paved 4.Proposed 7.									
2.Semi Imp 5.R/O/W 8.									
3.Gravel 6. 9.None									
TG PLAN YEAR <b>0</b>									
Tif District # <b>0</b>									
Sale Data			<b>Land Data</b>						
Sale Date			<b>Front Foot</b>	<b>Type</b>	<b>Effective</b>		<b>Influence</b>		<b>Influence Codes</b>
Price					Frontage	Depth	Factor	Code	
Sale Type <b>2 Land &amp; Buildings</b>			11.Regular Lot				%	1.Unimproved	
1.Land 4.Mobile 7.C/I L&B			12.Delta Triangle				%	2.Excess Frtg	
2.L & B 5.Other 8.			13.Nabla Triangle				%	3.Topography	
3.Building 6.C/I Land 9.			14.Rear Land				%	4.Size/Shape	
Financing			15.Class I Road				%	5.Access	
1.Convent 4.Seller 7.							%	6.Restriction	
2.FHA/VA 5.Private 8.							%	7.Open Space	
3.Assumed 6.Cash 9.Unknown							%	8.View/Environ	
Validity <b>2 Related Parties</b>							%	9.Fract Share	
1.Valid 4.Split 7.Renovate			<b>Square Foot</b>	<b>Square Feet</b>					10.Acres
2.Related 5.Partial 8.Other			16.Class II Road				%	11.Acres	
3.Distress 6.Exempt 9.			17.Municipal Rese				%	12.Acres	
Verified <b>5 Public Record</b>			18.Munic Sep Lago				%	13.Acres	
1.Buyer 4.Agent 7.Family			19.Gravel Pit				%	14.Acres	
2.Seller 5.Pub Rec 8.Other			20.Industrial Bas				%	15.Acres	
3.Lender 6.MLS 9.							%	16.Acres	
			<b>Fract. Acre</b>	<b>Acreege/Sites</b>					17.Acres
			21.Developed Pave	21	1.00	100	%	0	18.Acres
			22.Undev Paved (F	28	0.50	100	%	0	19.Acres
			23.Developed Grav				%		20.Acres
			<b>Acres</b>				%		21.Acres
			24.Undev Gravel (				%		22.Acres
			25.Comm Base Pave				%		23.Acres
			26.Comm Base Grav				%		24.Acres
			27.Backlot				%		25.Acres
			28.Rear Land				%		26.Acres
			29.Pavement				%		27.Acres
			<b>Total Acreage</b>			1.50			28.Acres
									29.Acres
									30.Acres
									31.Acres
									32.Acres
									33.Acres
									34.Acres
									35.Acres
									36.Acres
									37.Acres
									38.Acres
									39.Acres
									40.Acres
									41.Acres
									42.Acres
									43.Acres
									44.Acres
									45.Acres
									46.Acres

## Washburn

Map Lot 001-031

Account 1001

Location 61 RIVERSIDE DRIVE S

Card 1 Of 1 9/04/2024

Building Style <b>0</b>	SF Bsmt Living <b>0</b>	Layout <b>0</b>
1.Conv. 5.Garrison 9.Gambrel	Fin Bsmt Grade <b>0 0</b>	1.Typical 4. 7.
2.Ranch 6.Salt Box 10.Other	OPEN 5 OPTIONAL <b>0</b>	2.Inadeq 5. 8.
3.R Ranch 7.Contemp 11.Split	Heat Type <b>100% 0</b>	3.Poor 6. 9.
4.Cape 8.Log 12.	1.HWBB 5.FWA 9.No Heat	Attic <b>0</b>
Dwelling Units <b>0</b>	2.HWCI 6.GravWA 10.	1.1/4 Fin 4.Full Fin 7.
Other Units <b>0</b>	3.H Pump 7.Electric 11.	2.1/2 Fin 5.FI/Stair 8.
Stories <b>0</b>	4.Steam 8.FI/Wall 12.	3.3/4 Fin 6. 9.None
1.1 4.1.5 7.	Cool Type <b>0% 9 None</b>	Insulation <b>0</b>
2.2 5.1.75 8.	1.Refrig 4.W&C Air 7.	1.Full 4.Minimal 7.
3.3 6.2.5 9.	2.Evapor 5. 8.	2.Heavy 5.Partial 8.
Exterior Walls <b>0</b>	3.H Pump 6. 9.None	3.Capped 6. 9.None
1.Wood 5.Stucco 9.T-111	Kitchen Style <b>0</b>	Unfinished % <b>0%</b>
2.Vin/Al 6.Brick 10.Other	1.Modern 4.Obsolete 7.	Grade & Factor <b>0 0%</b>
3.Compos. 7.Stone 11.	2.Typical 5. 8.	1.E Grade 4.B Grade 7.
4.Asbestos 8.Concrete 12.	3.Old Type 6. 9.None	2.D Grade 5.A Grade 8.SC Grade
Roof Surface <b>0</b>	Bath(s) Style <b>0</b>	3.C Grade 6.AA Grade 9.Same
1.Asphalt 4.Composit 7.	1.Modern 4.Obsolete 7.	SQFT (Footprint) <b>0</b>
2.Slate 5.Wood 8.	2.Typical 5. 8.	Condition <b>0</b>
3.Metal 6.Other 9.	3.Old Type 6. 9.None	1.Poor 4.Avg 7.V G
SF Masonry Trim <b>0</b>	# Rooms <b>0</b>	2.Fair 5.Avg+ 8.Exc
OPEN-3-CUSTOM <b>0</b>	# Bedrooms <b>0</b>	3.Avg- 6.Good 9.Same
OPEN-4-CUSTOM <b>0</b>	# Full Baths <b>0</b>	Phys. % Good <b>0%</b>
Year Built <b>0</b>	# Half Baths <b>0</b>	Funct. % Good <b>100%</b>
Year Remodeled <b>0</b>	# Addn Fixtures <b>0</b>	Functional Code <b>9 None</b>
Foundation <b>0</b>	# Fireplaces <b>0</b>	1.Incomp 4.Delap 7.No Power
1.Concrete 4.Wood 7.	 <p><b>TRIO</b> Software A Division of Harris Computer Systems</p>	2.O-Built 5.Bsmt 8.LongTerm
2.C Block 5.Slab 8.		3.Damage 6.Common 9.None
3.Br/Stone 6.Piers 9.		Econ. % Good <b>100%</b>
Basement <b>0</b>		Economic Code <b>None</b>
1.1/4 Bmt 4.Full Bmt 7.		0.None 3.No Power 7.
2.1/2 Bmt 5.None 8.		1.Location 4.Generate 8.
3.3/4 Bmt 6. 9.None		2.Encroach 9.None 9.
Bsmt Gar # Cars <b>0</b>		Entrance Code <b>5 Estimated</b>
Wet Basement <b>0</b>		1.Interior 4.Vacant 7.
1.Dry 4. 7.		2.Refusal 5.Estimate 8.
2.Damp 5. 8.	3.Informed 6.Reviewed 9.	
3.Wet 6. 9.	Information Code <b>5 Estimate</b>	
	1.Owner 4.Agent 7.	
	2.Relative 5.Estimate 8.	
	3.Tenant 6.Other 9.	

Date Inspected 7/28/2018

### Additions, Outbuildings & Improvements

Type	Year	Units	Grade	Cond	Phys.	Funct.	Sound Value
997 12Mobile Home	1970	12x66	3 100	4	0 %	85 %	
18 1 S-MH add	1980	192	2 100	3	0 %	100 %	
24 Frame Shed	0				%	%	150
68 Wood Deck	1980	116	2 100	3	0 %	100 %	
					%	%	
					%	%	
					%	%	
					%	%	
					%	%	
					%	%	
					%	%	
					%	%	

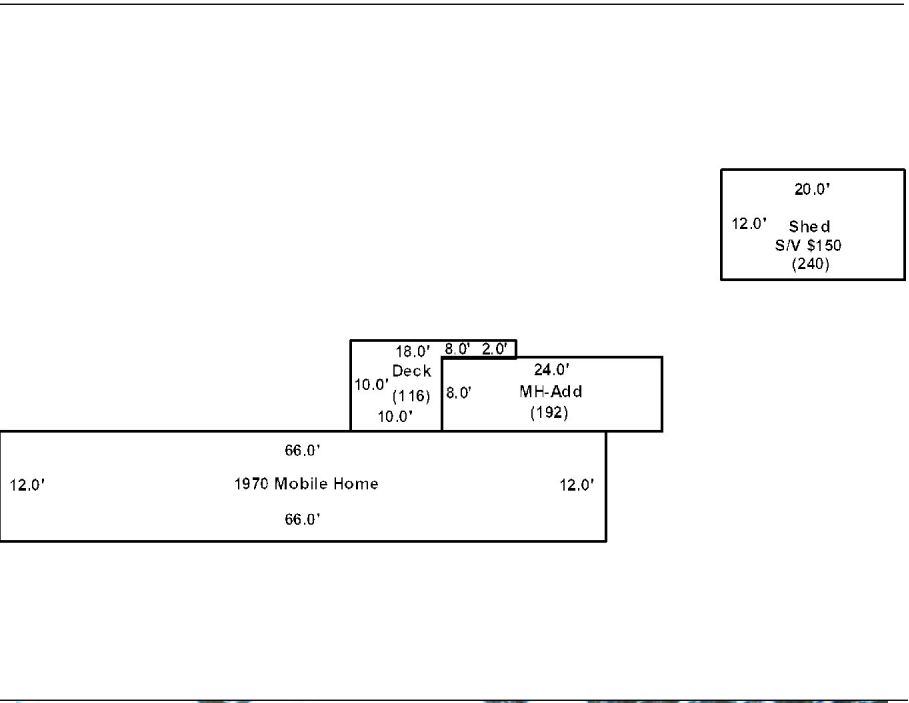



## Washburn

Map Lot 001-032

Account 268

Location 43 RIVERSIDE DRIVE S

Card 1 Of 1 9/04/2024

Building Style <b>0</b>	SF Bsmt Living <b>0</b>	Layout <b>0</b>
1.Conv. 5.Garrison 9.Gambrel	Fin Bsmt Grade <b>0 0</b>	1.Typical 4. 7.
2.Ranch 6.Salt Box 10.Other	OPEN 5 OPTIONAL <b>0</b>	2.Inadeq 5. 8.
3.R Ranch 7.Contemp 11.Split	Heat Type <b>100% 0</b>	3.Poor 6. 9.
4.Cape 8.Log 12.	1.HWBB 5.FWA 9.No Heat	Attic <b>0</b>
Dwelling Units <b>0</b>	2.HWCI 6.GravWA 10.	1.1/4 Fin 4.Full Fin 7.
Other Units <b>0</b>	3.H Pump 7.Electric 11.	2.1/2 Fin 5.FI/Stair 8.
Stories <b>0</b>	4.Steam 8.FI/Wall 12.	3.3/4 Fin 6. 9.None
1.1 4.1.5 7.	Cool Type <b>0% 9 None</b>	Insulation <b>0</b>
2.2 5.1.75 8.	1.Refrig 4.W&C Air 7.	1.Full 4.Minimal 7.
3.3 6.2.5 9.	2.Evapor 5. 8.	2.Heavy 5.Partial 8.
Exterior Walls <b>0</b>	3.H Pump 6. 9.None	3.Capped 6. 9.None
1.Wood 5.Stucco 9.T-111	Kitchen Style <b>0</b>	Unfinished % <b>0%</b>
2.Vin/Al 6.Brick 10.Other	1.Modern 4.Obsolete 7.	Grade & Factor <b>0 0%</b>
3.Compos. 7.Stone 11.	2.Typical 5. 8.	1.E Grade 4.B Grade 7.
4.Asbestos 8.Concrete 12.	3.Old Type 6. 9.None	2.D Grade 5.A Grade 8.SC Grade
Roof Surface <b>0</b>	Bath(s) Style <b>0</b>	3.C Grade 6.AA Grade 9.Same
1.Asphalt 4.Composit 7.	1.Modern 4.Obsolete 7.	SQFT (Footprint) <b>0</b>
2.Slate 5.Wood 8.	2.Typical 5. 8.	Condition <b>0</b>
3.Metal 6.Other 9.	3.Old Type 6. 9.None	1.Poor 4.Avg 7.V G
SF Masonry Trim <b>0</b>	# Rooms <b>0</b>	2.Fair 5.Avg+ 8.Exc
OPEN-3-CUSTOM <b>0</b>	# Bedrooms <b>0</b>	3.Avg- 6.Good 9.Same
OPEN-4-CUSTOM <b>0</b>	# Full Baths <b>0</b>	Phys. % Good <b>0%</b>
Year Built <b>0</b>	# Half Baths <b>0</b>	Funct. % Good <b>100%</b>
Year Remodeled <b>0</b>	# Addn Fixtures <b>0</b>	Functional Code <b>9 None</b>
Foundation <b>0</b>	# Fireplaces <b>0</b>	1.Incomp 4.Delap 7.No Power
1.Concrete 4.Wood 7.	 <p><b>TRIO</b> Software A Division of Harris Computer Systems</p>	2.O-Built 5.Bsmt 8.LongTerm
2.C Block 5.Slab 8.		3.Damage 6.Common 9.None
3.Br/Stone 6.Piers 9.		Econ. % Good <b>100%</b>
Basement <b>0</b>		Economic Code <b>None</b>
1.1/4 Bmt 4.Full Bmt 7.		0.None 3.No Power 7.
2.1/2 Bmt 5.None 8.		1.Location 4.Generate 8.
3.3/4 Bmt 6. 9.None		2.Encroach 9.None 9.
Bsmt Gar # Cars <b>0</b>		Entrance Code <b>5 Estimated</b>
Wet Basement <b>0</b>		1.Interior 4.Vacant 7.
1.Dry 4. 7.		2.Refusal 5.Estimate 8.
2.Damp 5. 8.	3.Informed 6.Reviewed 9.	
3.Wet 6. 9.	Information Code <b>5 Estimate</b>	
	1.Owner 4.Agent 7.	
	2.Relative 5.Estimate 8.	
	3.Tenant 6.Other 9.	

Date Inspected 7/28/2018

### Additions, Outbuildings & Improvements

Type	Year	Units	Grade	Cond	Phys.	Funct.	Sound Value
942 Skyline M/H	1999	14x66	5 100	4	0 %	100 %	
68 Wood Deck	1999	256	3 100	3	0 %	100 %	
24 Frame Shed	0				%	%	300
24 Frame Shed	0				%	%	50
24 Frame Shed	0				%	%	500
					%	%	
					%	%	
					%	%	
					%	%	
					%	%	
					%	%	

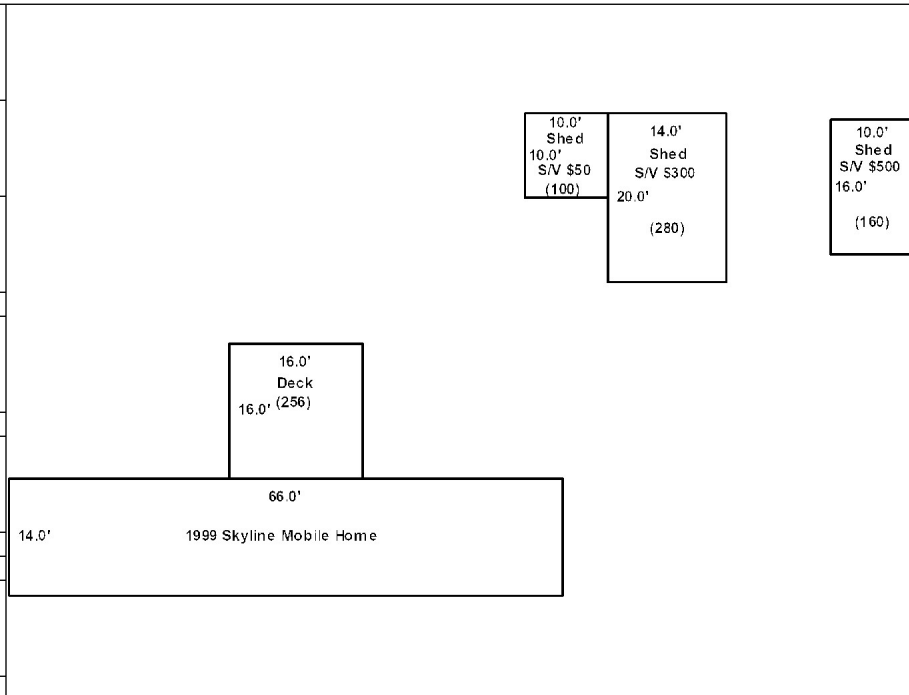



**Washburn**

Map Lot 001-033

Account 607

Location Parsons Road

Card 1 Of 1 9/04/2024

Building Style <b>0</b>	SF Bsmt Living <b>0</b>	Layout <b>0</b>
1.Conv. 5.Garrison 9.Gambrel	Fin Bsmt Grade <b>0 0</b>	1.Typical 4. 7.
2.Ranch 6.Salt Box 10.Other	OPEN 5 OPTIONAL <b>0</b>	2.Inadeq 5. 8.
3.R Ranch 7.Contemp 11.Split	Heat Type <b>100% 0</b>	3.Poor 6. 9.
4.Cape 8.Log 12.	1.HWBB 5.FWA 9.No Heat	Attic <b>0</b>
Dwelling Units <b>0</b>	2.HWCI 6.GravWA 10.	1.1/4 Fin 4.Full Fin 7.
Other Units <b>0</b>	3.H Pump 7.Electric 11.	2.1/2 Fin 5.F/Stair 8.
Stories <b>0</b>	4.Steam 8.F/Wall 12.	3.3/4 Fin 6. 9.None
1.1 4.1.5 7.	Cool Type <b>0% 9 None</b>	Insulation <b>0</b>
2.2 5.1.75 8.	1.Refrig 4.W&C Air 7.	1.Full 4.Minimal 7.
3.3 6.2.5 9.	2.Evapor 5. 8.	2.Heavy 5.Partial 8.
Exterior Walls <b>0</b>	3.H Pump 6. 9.None	3.Capped 6. 9.None
1.Wood 5.Stucco 9.T-111	Kitchen Style <b>0</b>	Unfinished % <b>0%</b>
2.Vin/Al 6.Brick 10.Other	1.Modern 4.Obsolete 7.	Grade & Factor <b>0 0%</b>
3.Compos. 7.Stone 11.	2.Typical 5. 8.	1.E Grade 4.B Grade 7.
4.Asbestos 8.Concrete 12.	3.Old Type 6. 9.None	2.D Grade 5.A Grade 8.SC Grade
Roof Surface <b>0</b>	Bath(s) Style <b>0</b>	3.C Grade 6.AA Grade 9.Same
1.Asphalt 4.Composit 7.	1.Modern 4.Obsolete 7.	SQFT (Footprint) <b>0</b>
2.Slate 5.Wood 8.	2.Typical 5. 8.	Condition <b>0</b>
3.Metal 6.Other 9.	3.Old Type 6. 9.None	1.Poor 4.Avg 7.V G
SF Masonry Trim <b>0</b>	# Rooms <b>0</b>	2.Fair 5.Avg+ 8.Exc
OPEN-3-CUSTOM <b>0</b>	# Bedrooms <b>0</b>	3.Avg- 6.Good 9.Same
OPEN-4-CUSTOM <b>0</b>	# Full Baths <b>0</b>	Phys. % Good <b>0%</b>
Year Built <b>0</b>	# Half Baths <b>0</b>	Funct. % Good <b>100%</b>
Year Remodeled <b>0</b>	# Addn Fixtures <b>0</b>	Functional Code <b>9 None</b>
Foundation <b>0</b>	# Fireplaces <b>0</b>	1.Incomp 4.Delap 7.No Power
1.Concrete 4.Wood 7.		2.O-Built 5.Bsmt 8.LongTerm
2.C Block 5.Slab 8.		3.Damage 6.Common 9.None
3.Br/Stone 6.Piers 9.		Econ. % Good <b>100%</b>
Basement <b>0</b>		Economic Code <b>None</b>
1.1/4 Bmt 4.Full Bmt 7.		0.None 3.No Power 7.
2.1/2 Bmt 5.None 8.		1.Location 4.Generate 8.
3.3/4 Bmt 6. 9.None		2.Encroach 9.None 9.
Bsmt Gar # Cars <b>0</b>		Entrance Code <b>0</b>
Wet Basement <b>0</b>		1.Interior 4.Vacant 7.
1.Dry 4. 7.		2.Refusal 5.Estimate 8.
2.Damp 5. 8.	3.Informed 6.Reviewed 9.	
3.Wet 6. 9.	Information Code <b>0</b>	
		1.Owner 4.Agent 7.
		2.Relative 5.Estimate 8.
		3.Tenant 6.Other 9.

Date Inspected

Additions, Outbuildings & Improvements								
Type	Year	Units	Grade	Cond	Phys.	Funct.	Sound Value	
					%	%		1.One Story Fram
					%	%		2.Two Story Fram
					%	%		3.Three Story Fr
					%	%		4.1 & 1/2 Story
					%	%		5.1 & 3/4 Story
					%	%		6.2 & 1/2 Story
					%	%		21.Open Frame Por
					%	%		22.Encl Frame Por
					%	%		23.Frame Garage
					%	%		24.Frame Shed
					%	%		25.Frame Bay Wind
					%	%		26.1SFr Overhang
					%	%		27.Unfin Basement
					%	%		28.Unfinished Att
					%	%		29.Finished Attic



ROSS, DAVID E  
ROSS, SHIRLEY E  
1331 RIPKEN DRIVE  
HICKORY NC 28602

B2066P313

Inspection Witnessed By:

No./Date	Description	Date Insp.
X		

Notes:

Washburn

Property Data			Assessment Record					
Neighborhood <b>1 Neighborhood One</b>			Year	Land	Buildings	Exempt	Total	
Tree Growth Year <b>0</b>			2012	5,500	0	0	5,500	
1ST MORTGAGE <b>0</b>			2013	7,100	0	0	7,100	
2ND MORTGAGE <b>0</b>			2015	7,100	0	0	7,100	
Zone/Land Use <b>1 Residential</b>			2018	7,100	0	0	7,100	
Secondary Zone			2019	10,000	0	0	10,000	
Topography <b>2 Rolling</b>			2020	10,000	0	0	10,000	
1.Level 4.Below St 7.LevelBog			2021	10,000	0	0	10,000	
2.Rolling 5.Low 8.			2022	10,000	0	0	10,000	
3.Above St 6.Swampy 9.			2023	12,100	0	0	12,100	
Utilities			2024	12,100	0	0	12,100	
1.Public 4.Dr Well 7.Cesspool								
2.Water 5.Dug Well 8.								
3.Sewer 6.Septic 9.None								
Street <b>1 Paved</b>								
1.Paved 4.Proposed 7.								
2.Semi Imp 5.R/O/W 8.								
3.Gravel 6. 9.None								
TG PLAN YEAR <b>0</b>								
Tif District # <b>0</b>								
Sale Data			<b>Land Data</b>					
Sale Date <b>3/22/1988</b>			<b>Front Foot</b>	<b>Type</b>	<b>Effective</b>		<b>Influence</b>	
Price			11.Regular Lot		<b>Frontage</b>	<b>Depth</b>	<b>Factor</b>	<b>Code</b>
Sale Type <b>1 Land Only</b>			12.Delta Triangle				%	1.Unimproved
1.Land 4.Mobile 7.C/I L&B			13.Nabla Triangle				%	2.Excess Frtg
2.L & B 5.Other 8.			14.Rear Land				%	3.Topography
3.Building 6.C/I Land 9.			15.Class I Road				%	4.Size/Shape
Financing							%	5.Access
1.Convent 4.Seller 7.							%	6.Restriction
2.FHA/VA 5.Private 8.							%	7.Open Space
3.Assumed 6.Cash 9.Unknown							%	8.View/Environ
Validity <b>1 Arms Length Sale</b>			<b>Square Foot</b>	<b>Square Feet</b>				9.Fract Share
1.Valid 4.Split 7.Renovate			16.Class II Road				%	30.Utility R O W
2.Related 5.Partial 8.Other			17.Municipal Rese				%	31.Tillable
3.Distress 6.Exempt 9.			18.Munic Sep Lago				%	32.Pasture
Verified <b>5 Public Record</b>			19.Gravel Pit				%	33.Orchard
1.Buyer 4.Agent 7.Family			20.Industrial Bas				%	34.Softwood F&O
2.Seller 5.Pub Rec 8.Other			<b>Fract. Acre</b>	<b>Acres/Sites</b>				35.Mixed Wood F&O
3.Lender 6.MLS 9.			21.Developed Pave	22	1.00	100	%	0
			22.Undev Paved (F	28	1.93	100	%	0
			23.Developed Grav				%	
			<b>Acres</b>				%	
			24.Undev Gravel (				%	
			25.Comm Base Pave				%	
			26.Comm Base Grav				%	
			27.Backlot				%	
			28.Rear Land				%	
			29.Pavement				%	
			<b>Total Acreage</b>		2.93			
								44.Lot Improvemen
								45.Subdivision Lo
								46.Heavy Ind Sit

- 1.Unimproved
- 2.Excess Frtg
- 3.Topography
- 4.Size/Shape
- 5.Access
- 6.Restriction
- 7.Open Space
- 8.View/Environ
- 9.Fract Share
- Acres**
- 30.Utility R O W
- 31.Tillable
- 32.Pasture
- 33.Orchard
- 34.Softwood F&O
- 35.Mixed Wood F&O
- 36.Hardwood F&O
- 37.Softwood TG
- 38.Mixed Wood TG
- 39.Hardwood TG
- 40.Wasteland
- 41.Open Space
- 42.Mobile Home Si
- 43.Condo Site
- 44.Lot Improvemen
- 45.Subdivision Lo
- 46.Heavy Ind Sit

**Washburn**

Map Lot 001-034

Account 654

Location PARSONS ROAD

Card 1 Of 1 9/04/2024

Building Style <b>0</b>	SF Bsmt Living <b>0</b>	Layout <b>0</b>
1.Conv. 5.Garrison 9.Gambrel	Fin Bsmt Grade <b>0 0</b>	1.Typical 4. 7.
2.Ranch 6.Salt Box 10.Other	OPEN 5 OPTIONAL <b>0</b>	2.Inadeq 5. 8.
3.R Ranch 7.Contemp 11.Split	Heat Type <b>100% 0</b>	3.Poor 6. 9.
4.Cape 8.Log 12.	1.HWBB 5.FWA 9.No Heat	Attic <b>0</b>
Dwelling Units <b>0</b>	2.HWCI 6.GravWA 10.	1.1/4 Fin 4.Full Fin 7.
Other Units <b>0</b>	3.H Pump 7.Electric 11.	2.1/2 Fin 5.F/Stair 8.
Stories <b>0</b>	4.Steam 8.F/Wall 12.	3.3/4 Fin 6. 9.None
1.1 4.1.5 7.	Cool Type <b>0% 9 None</b>	Insulation <b>0</b>
2.2 5.1.75 8.	1.Refrig 4.W&C Air 7.	1.Full 4.Minimal 7.
3.3 6.2.5 9.	2.Evapor 5. 8.	2.Heavy 5.Partial 8.
Exterior Walls <b>0</b>	3.H Pump 6. 9.None	3.Capped 6. 9.None
1.Wood 5.Stucco 9.T-111	Kitchen Style <b>0</b>	Unfinished % <b>0%</b>
2.Vin/Al 6.Brick 10.Other	1.Modern 4.Obsolete 7.	Grade & Factor <b>0 0%</b>
3.Compos. 7.Stone 11.	2.Typical 5. 8.	1.E Grade 4.B Grade 7.
4.Asbestos 8.Concrete 12.	3.Old Type 6. 9.None	2.D Grade 5.A Grade 8.SC Grade
Roof Surface <b>0</b>	Bath(s) Style <b>0</b>	3.C Grade 6.AA Grade 9.Same
1.Asphalt 4.Composit 7.	1.Modern 4.Obsolete 7.	SQFT (Footprint) <b>0</b>
2.Slate 5.Wood 8.	2.Typical 5. 8.	Condition <b>0</b>
3.Metal 6.Other 9.	3.Old Type 6. 9.None	1.Poor 4.Avg 7.V G
SF Masonry Trim <b>0</b>	# Rooms <b>0</b>	2.Fair 5.Avg+ 8.Exc
OPEN-3-CUSTOM <b>0</b>	# Bedrooms <b>0</b>	3.Avg- 6.Good 9.Same
OPEN-4-CUSTOM <b>0</b>	# Full Baths <b>0</b>	Phys. % Good <b>0%</b>
Year Built <b>0</b>	# Half Baths <b>0</b>	Funct. % Good <b>100%</b>
Year Remodeled <b>0</b>	# Addn Fixtures <b>0</b>	Functional Code <b>9 None</b>
Foundation <b>0</b>	# Fireplaces <b>0</b>	1.Incomp 4.Delap 7.No Power
1.Concrete 4.Wood 7.		2.O-Built 5.Bsmt 8.LongTerm
2.C Block 5.Slab 8.		3.Damage 6.Common 9.None
3.Br/Stone 6.Piers 9.		Econ. % Good <b>100%</b>
Basement <b>0</b>		Economic Code <b>None</b>
1.1/4 Bmt 4.Full Bmt 7.		0.None 3.No Power 7.
2.1/2 Bmt 5.None 8.		1.Location 4.Generate 8.
3.3/4 Bmt 6. 9.None		2.Encroach 9.None 9.
Bsmt Gar # Cars <b>0</b>		Entrance Code <b>0</b>
Wet Basement <b>0</b>		1.Interior 4.Vacant 7.
1.Dry 4. 7.		2.Refusal 5.Estimate 8.
2.Damp 5. 8.	3.Informed 6.Reviewed 9.	
3.Wet 6. 9.	Information Code <b>0</b>	
		1.Owner 4.Agent 7.
		2.Relative 5.Estimate 8.
		3.Tenant 6.Other 9.

Date Inspected

Additions, Outbuildings & Improvements								
Type	Year	Units	Grade	Cond	Phys.	Funct.	Sound Value	
					%	%		1.One Story Fram
					%	%		2.Two Story Fram
					%	%		3.Three Story Fr
					%	%		4.1 & 1/2 Story
					%	%		5.1 & 3/4 Story
					%	%		6.2 & 1/2 Story
					%	%		21.Open Frame Por
					%	%		22.Encl Frame Por
					%	%		23.Frame Garage
					%	%		24.Frame Shed
					%	%		25.Frame Bay Wind
					%	%		26.1SFr Overhang
					%	%		27.Unfin Basement
					%	%		28.Unfinished Att
					%	%		29.Finished Attic











**Washburn**

Map Lot 001-036

Account 606

Location Parsons Road

Card 1 Of 1 9/04/2024

Building Style <b>0</b>	SF Bsmt Living <b>0</b>	Layout <b>0</b>
1.Conv. 5.Garrison 9.Gambrel	Fin Bsmt Grade <b>0 0</b>	1.Typical 4. 7.
2.Ranch 6.Salt Box 10.Other	OPEN 5 OPTIONAL <b>0</b>	2.Inadeq 5. 8.
3.R Ranch 7.Contemp 11.Split	Heat Type <b>100% 0</b>	3.Poor 6. 9.
4.Cape 8.Log 12.	1.HWBB 5.FWA 9.No Heat	Attic <b>0</b>
Dwelling Units <b>0</b>	2.HWCI 6.GravWA 10.	1.1/4 Fin 4.Full Fin 7.
Other Units <b>0</b>	3.H Pump 7.Electric 11.	2.1/2 Fin 5.FI/Stair 8.
Stories <b>0</b>	4.Steam 8.FI/Wall 12.	3.3/4 Fin 6. 9.None
1.1 4.1.5 7.	Cool Type <b>0% 9 None</b>	Insulation <b>0</b>
2.2 5.1.75 8.	1.Refrig 4.W&C Air 7.	1.Full 4.Minimal 7.
3.3 6.2.5 9.	2.Evapor 5. 8.	2.Heavy 5.Partial 8.
Exterior Walls <b>0</b>	3.H Pump 6. 9.None	3.Capped 6. 9.None
1.Wood 5.Stucco 9.T-111	Kitchen Style <b>0</b>	Unfinished % <b>0%</b>
2.Vin/Al 6.Brick 10.Other	1.Modern 4.Obsolete 7.	Grade & Factor <b>0 0%</b>
3.Compos. 7.Stone 11.	2.Typical 5. 8.	1.E Grade 4.B Grade 7.
4.Asbestos 8.Concrete 12.	3.Old Type 6. 9.None	2.D Grade 5.A Grade 8.SC Grade
Roof Surface <b>0</b>	Bath(s) Style <b>0</b>	3.C Grade 6.AA Grade 9.Same
1.Asphalt 4.Composit 7.	1.Modern 4.Obsolete 7.	SQFT (Footprint) <b>0</b>
2.Slate 5.Wood 8.	2.Typical 5. 8.	Condition <b>0</b>
3.Metal 6.Other 9.	3.Old Type 6. 9.None	1.Poor 4.Avg 7.V G
SF Masonry Trim <b>0</b>	# Rooms <b>0</b>	2.Fair 5.Avg+ 8.Exc
OPEN-3-CUSTOM <b>0</b>	# Bedrooms <b>0</b>	3.Avg- 6.Good 9.Same
OPEN-4-CUSTOM <b>0</b>	# Full Baths <b>0</b>	Phys. % Good <b>0%</b>
Year Built <b>0</b>	# Half Baths <b>0</b>	Funct. % Good <b>100%</b>
Year Remodeled <b>0</b>	# Addn Fixtures <b>0</b>	Functional Code <b>9 None</b>
Foundation <b>0</b>	# Fireplaces <b>0</b>	1.Incomp 4.Delap 7.No Power
1.Concrete 4.Wood 7.		2.O-Built 5.Bsmt 8.LongTerm
2.C Block 5.Slab 8.		3.Damage 6.Common 9.None
3.Br/Stone 6.Piers 9.		Econ. % Good <b>100%</b>
Basement <b>0</b>		Economic Code <b>None</b>
1.1/4 Bmt 4.Full Bmt 7.		0.None 3.No Power 7.
2.1/2 Bmt 5.None 8.		1.Location 4.Generate 8.
3.3/4 Bmt 6. 9.None		2.Encroach 9.None 9.
Bsmt Gar # Cars <b>0</b>		Entrance Code <b>0</b>
Wet Basement <b>0</b>		1.Interior 4.Vacant 7.
1.Dry 4. 7.		2.Refusal 5.Estimate 8.
2.Damp 5. 8.	3.Informed 6.Reviewed 9.	
3.Wet 6. 9.	Information Code <b>0</b>	
		1.Owner 4.Agent 7.
		2.Relative 5.Estimate 8.
		3.Tenant 6.Other 9.

Date Inspected

**Additions, Outbuildings & Improvements**

Type	Year	Units	Grade	Cond	Phys.	Funct.	Sound Value
					%	%	1.One Story Fram
					%	%	2.Two Story Fram
					%	%	3.Three Story Fr
					%	%	4.1 & 1/2 Story
					%	%	5.1 & 3/4 Story
					%	%	6.2 & 1/2 Story
					%	%	21.Open Frame Por
					%	%	22.Encl Frame Por
					%	%	23.Frame Garage
					%	%	24.Frame Shed
					%	%	25.Frame Bay Wind
					%	%	26.1SFr Overhang
					%	%	27.Unfin Basement
					%	%	28.Unfinished Att
					%	%	29.Finished Attic



AUBE, MELINDA L (ALLEN)  
2283 PARSONS ROAD  
WASHBURN ME 04786

B2813P37 B5360P330

Inspection Witnessed By:

No./Date	Description	Date Insp.
X		

Notes:  
\* -5% off baselot due to dug well. -15% on 13/4sGarage for size obsol. during reval.

Washburn

Property Data			Assessment Record						
Neighborhood <b>1 Neighborhood One</b>			Year	Land	Buildings	Exempt	Total		
Tree Growth Year <b>0</b>			2012	6,600	36,800	8,800	34,600		
1ST MORTGAGE <b>0</b>			2013	8,600	76,200	8,800	76,000		
2ND MORTGAGE <b>0</b>			2015	8,600	76,200	9,000	75,800		
Zone/Land Use <b>1 Residential</b>			2018	8,600	76,200	18,400	66,400		
Secondary Zone			2019	16,500	93,800	20,000	90,300		
Topography <b>1 Level</b>			2020	16,500	93,800	25,000	85,300		
1.Level 4.Below St 7.LevelBog			2021	16,500	93,800	25,000	85,300		
2.Rolling 5.Low 8.			2022	16,500	98,500	25,000	90,000		
3.Above St 6.Swampy 9.			2023	21,800	117,300	25,000	114,100		
Utilities <b>5 Dug Well 6 Septic System</b>			2024	21,800	117,300	25,000	114,100		
1.Public 4.Dr Well 7.Cesspool									
2.Water 5.Dug Well 8.									
3.Sewer 6.Septic 9.None									
Street <b>1 Paved</b>									
1.Paved 4.Proposed 7.									
2.Semi Imp 5.R/O/W 8.									
3.Gravel 6. 9.None									
TG PLAN YEAR <b>0</b>									
Tif District # <b>0</b>									
Sale Data			<b>Land Data</b>						
Sale Date <b>7/25/1995</b>			<b>Front Foot</b>	<b>Type</b>	<b>Effective</b>		<b>Influence</b>		<b>Influence Codes</b>
Price <b>49,900</b>					Frontage	Depth	Factor	Code	
Sale Type <b>2 Land &amp; Buildings</b>			11.Regular Lot					1.Unimproved	
1.Land 4.Mobile 7.C/I L&B			12.Delta Triangle					2.Excess Frtg	
2.L & B 5.Other 8.			13.Nabla Triangle					3.Topography	
3.Building 6.C/I Land 9.			14.Rear Land					4.Size/Shape	
Financing <b>1 Conventional</b>			15.Class I Road					5.Access	
1.Convent 4.Seller 7.								6.Restriction	
2.FHA/VA 5.Private 8.								7.Open Space	
3.Assumed 6.Cash 9.Unknown								8.View/Environ	
Validity <b>1 Arms Length Sale</b>								9.Fract Share	
1.Valid 4.Split 7.Renovate			<b>Square Foot</b>	<b>Square Feet</b>				<b>Acres</b>	
2.Related 5.Partial 8.Other			16.Class II Road					30.Utility R O W	
3.Distress 6.Exempt 9.			17.Municipal Rese					31.Tillable	
Verified <b>5 Public Record</b>			18.Munic Sep Lago					32.Pasture	
1.Buyer 4.Agent 7.Family			19.Gravel Pit					33.Orchard	
2.Seller 5.Pub Rec 8.Other			20.Industrial Bas					34.Softwood F&O	
3.Lender 6.MLS 9.								35.Mixed Wood F&O	
			<b>Fract. Acre</b>	<b>Acres/Sites</b>				36.Hardwood F&O	
			21.Developed Pave	21	1.00	95 %	1	37.Softwood TG	
			22.Undev Paved (F	28	1.58	100 %	0	38.Mixed Wood TG	
			23.Developed Grav					39.Hardwood TG	
			<b>Acres</b>					40.Wasteland	
			24.Undev Gravel (					41.Open Space	
			25.Comm Base Pave					42.Mobile Home Si	
			26.Comm Base Grav					43.Condo Site	
			27.Backlot					44.Lot Improvemen	
			28.Rear Land					45.Subdivision Lo	
			29.Pavement					46.Heavy Ind Sit	
			<b>Total Acreage</b>		2.58				

## Washburn

Map Lot 001-037

Account 1081

Location 2283 PARSONS ROAD

Card 1

Of 1

9/04/2024

Building Style	<b>1 Conventional</b>			SF Bsmt Living	<b>0</b>			Layout	<b>1 Typical</b>		
1.Conv.	5.Garrison	9.Gambrel		Fin Bsmt Grade	<b>0 0</b>			1.Typical	4.	7.	
2.Ranch	6.Salt Box	10.Other		OPEN 5 OPTIONAL	<b>0</b>			2.Inadeq	5.	8.	
3.R Ranch	7.Contemp	11.Split		Heat Type	<b>100% 5 Forced Warm Air</b>			3.Poor	6.	9.	
4.Cape	8.Log	12.		1.HWBB	5.FWA	9.No Heat	Attic	<b>9 None</b>			
Dwelling Units	<b>1</b>			2.HWCI	6.GravWA	10.	1.1/4 Fin	4.Full Fin	7.		
Other Units	<b>0</b>			3.H Pump	7.Electric	11.	2.1/2 Fin	5.FI/Stair	8.		
Stories	<b>4 One &amp; 1/2 Story</b>			4.Steam	8.FI/Wall	12.	3.3/4 Fin	6.	9.None		
1.1	4.1.5	7.		Cool Type	<b>0% 9 None</b>			Insulation	<b>4 Minimal</b>		
2.2	5.1.75	8.		1.Refrig	4.W&C Air	7.	1.Full	4.Minimal	7.		
3.3	6.2.5	9.		2.Evapor	5.	8.	2.Heavy	5.Partial	8.		
Exterior Walls	<b>2 Vinyl/Aluminum</b>			3.H Pump	6.	9.None	3.Capped	6.	9.None		
1.Wood	5.Stucco	9.T-111		Kitchen Style	<b>2 Typical</b>			Unfinished %	<b>0%</b>		
2.Vin/Al	6.Brick	10.Other		1.Modern	4.Obsolete	7.	Grade & Factor	<b>3 Average 90%</b>			
3.Compos.	7.Stone	11.		2.Typical	5.	8.	1.E Grade	4.B Grade	7.		
4.Asbestos	8.Concrete	12.		3.Old Type	6.	9.None	2.D Grade	5.A Grade	8.SC Grade		
Roof Surface	<b>3 Sheet Metal</b>			Bath(s) Style	<b>2 Typical Bath(s)</b>			3.C Grade	6.AA Grade	9.Same	
1.Asphalt	4.Composit	7.		1.Modern	4.Obsolete	7.	SQFT (Footprint)	<b>468</b>			
2.Slate	5.Wood	8.		2.Typical	5.	8.	Condition	<b>6 Good</b>			
3.Metal	6.Other	9.		3.Old Type	6.	9.None	1.Poor	4.Avg	7.V G		
SF Masonry Trim	<b>0</b>			# Rooms	<b>5</b>			2.Fair	5.Avg+	8.Exc	
OPEN-3-CUSTOM	<b>0</b>			# Bedrooms	<b>3</b>			3.Avg-	6.Good	9.Same	
OPEN-4-CUSTOM	<b>0</b>			# Full Baths	<b>1</b>			Phys. % Good	<b>0%</b>		
Year Built	<b>1890</b>			# Half Baths	<b>0</b>			Funct. % Good	<b>100%</b>		
Year Remodeled	<b>0</b>			# Addn Fixtures	<b>0</b>			Functional Code	<b>9 None</b>		
Foundation	<b>3 Brick &amp;/or Stone</b>			# Fireplaces	<b>0</b>			1.Incomp	4.Delap	7.No Power	
1.Concrete	4.Wood	7.		 <p><b>TRIO</b> Software A Division of Harris Computer Systems</p>	2.O-Built	5.Bsmt	8.LongTerm	Economic Code	<b>None</b>		
2.C Block	5.Slab	8.			3.Damage	6.Common	9.None	0.None	3.No Power	7.	
3.Br/Stone	6.Piers	9.			Econ. % Good	<b>100%</b>			1.Location	4.Generate	8.
Basement	<b>4 Full Basement</b>				Entrance Code	<b>1 Interior Inspect</b>			2.Encroach	9.None	9.
1.1/4 Bmt	4.Full Bmt	7.			1.Interior	4.Vacant	7.	Information Code	<b>1 Owner</b>		
2.1/2 Bmt	5.None	8.			2.Refusal	5.Estimate	8.	1.Owner	4.Agent	7.	
3.3/4 Bmt	6.	9.None			3.Informed	6.Reviewed	9.	2.Relative	5.Estimate	8.	
Bsmt Gar # Cars	<b>0</b>				Information Code	<b>1 Owner</b>			3.Tenant	6.Other	9.
Wet Basement	<b>3 Wet Basement</b>				1.Owner	4.Agent	7.				
1.Dry	4.	7.			2.Relative	5.Estimate	8.				
2.Damp	5.	8.		3.Tenant	6.Other	9.					
3.Wet	6.	9.									

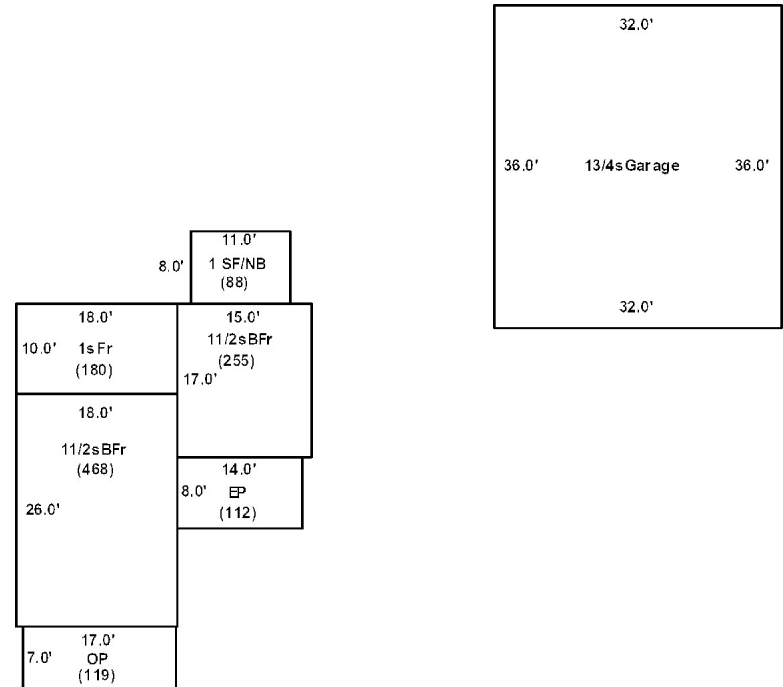

Date Inspected 7/29/2018

### Additions, Outbuildings & Improvements

Type	Year	Units	Grade	Cond	Phys.	Funct.	Sound Value
21 Open Frame	2012	119	3 100	4	0 %	100 %	
1 One Story Frame	2012	180	3 100	4	0 %	100 %	
22 Encl Frame Porch	2012	112	3 100	4	0 %	100 %	
83 1.75 S-Gar	2012	1152	3 100	4	0 %	85 %	
4 1 & 1/2 Story Fr	0	255	0 0	0	0 %	0 %	
27 Unfin Basement	0	255	0 0	0	0 %	0 %	
1 One Story Frame	0	88	0 0	0	0 %	0 %	
					%	%	
					%	%	
					%	%	





## Washburn

Map Lot 001-038/41 & 42

Account 605

Location 2326 Parsons Road

Card 1 Of 3

9/04/2024

Building Style <b>0</b>	SF Bsmt Living <b>0</b>	Layout <b>0</b>
1.Conv. 5.Garrison 9.Gambrel	Fin Bsmt Grade <b>0 0</b>	1.Typical 4. 7.
2.Ranch 6.Salt Box 10.Other	OPEN 5 OPTIONAL <b>0</b>	2.Inadeq 5. 8.
3.R Ranch 7.Contemp 11.Split	Heat Type <b>100% 0</b>	3.Poor 6. 9.
4.Cape 8.Log 12.	1.HWBB 5.FWA 9.No Heat	Attic <b>0</b>
Dwelling Units <b>0</b>	2.HWCI 6.GravWA 10.	1.1/4 Fin 4.Full Fin 7.
Other Units <b>0</b>	3.H Pump 7.Electric 11.	2.1/2 Fin 5.FI/Stair 8.
Stories <b>0</b>	4.Steam 8.FI/Wall 12.	3.3/4 Fin 6. 9.None
1.1 4.1.5 7.	Cool Type <b>0% 9 None</b>	Insulation <b>0</b>
2.2 5.1.75 8.	1.Refrig 4.W&C Air 7.	1.Full 4.Minimal 7.
3.3 6.2.5 9.	2.Evapor 5. 8.	2.Heavy 5.Partial 8.
Exterior Walls <b>0</b>	3.H Pump 6. 9.None	3.Capped 6. 9.None
1.Wood 5.Stucco 9.T-111	Kitchen Style <b>0</b>	Unfinished % <b>0%</b>
2.Vin/Al 6.Brick 10.Other	1.Modern 4.Obsolete 7.	Grade & Factor <b>0 0%</b>
3.Compos. 7.Stone 11.	2.Typical 5. 8.	1.E Grade 4.B Grade 7.
4.Asbestos 8.Concrete 12.	3.Old Type 6. 9.None	2.D Grade 5.A Grade 8.SC Grade
Roof Surface <b>0</b>	Bath(s) Style <b>0</b>	3.C Grade 6.AA Grade 9.Same
1.Asphalt 4.Composit 7.	1.Modern 4.Obsolete 7.	SQFT (Footprint) <b>0</b>
2.Slate 5.Wood 8.	2.Typical 5. 8.	Condition <b>0</b>
3.Metal 6.Other 9.	3.Old Type 6. 9.None	1.Poor 4.Avg 7.V G
SF Masonry Trim <b>0</b>	# Rooms <b>0</b>	2.Fair 5.Avg+ 8.Exc
OPEN-3-CUSTOM <b>0</b>	# Bedrooms <b>0</b>	3.Avg- 6.Good 9.Same
OPEN-4-CUSTOM <b>0</b>	# Full Baths <b>0</b>	Phys. % Good <b>0%</b>
Year Built <b>0</b>	# Half Baths <b>0</b>	Funct. % Good <b>100%</b>
Year Remodeled <b>0</b>	# Addn Fixtures <b>0</b>	Functional Code <b>9 None</b>
Foundation <b>0</b>	# Fireplaces <b>0</b>	1.Incomp 4.Delap 7.No Power
1.Concrete 4.Wood 7.	 <p><b>TRIO</b> Software A Division of Harris Computer Systems</p>	2.O-Built 5.Bsmt 8.LongTerm
2.C Block 5.Slab 8.		3.Damage 6.Common 9.None
3.Br/Stone 6.Piers 9.		Econ. % Good <b>100%</b>
Basement <b>0</b>		Economic Code <b>None</b>
1.1/4 Bmt 4.Full Bmt 7.		0.None 3.No Power 7.
2.1/2 Bmt 5.None 8.		1.Location 4.Generate 8.
3.3/4 Bmt 6. 9.None		2.Encroach 9.None 9.
Bsmt Gar # Cars <b>0</b>		Entrance Code <b>0</b>
Wet Basement <b>0</b>		1.Interior 4.Vacant 7.
1.Dry 4. 7.		2.Refusal 5.Estimate 8.
2.Damp 5. 8.	3.Informed 6.Reviewed 9.	
3.Wet 6. 9.	Information Code <b>0</b>	
		1.Owner 4.Agent 7.
		2.Relative 5.Estimate 8.
		3.Tenant 6.Other 9.

Date Inspected

### Additions, Outbuildings & Improvements

Type	Year	Units	Grade	Cond	Phys.	Funct.	Sound Value
223 1S Warehse	1980	20000	3 100	2	0 %	25 %	
223 1S Warehse	1975	52352	3 100	2	0 %	25 %	
24 Frame Shed	0				%	%	500
24 Frame Shed	0				%	%	2,000
183 Truck Scale	1990	480	2 100	4	0 %	25 %	
183 Truck Scale	1990	480	2 100	4	0 %	25 %	
22 Encl Frame Porch	1950	96	3 100	4	0 %	25 %	
					%	%	
					%	%	
					%	%	

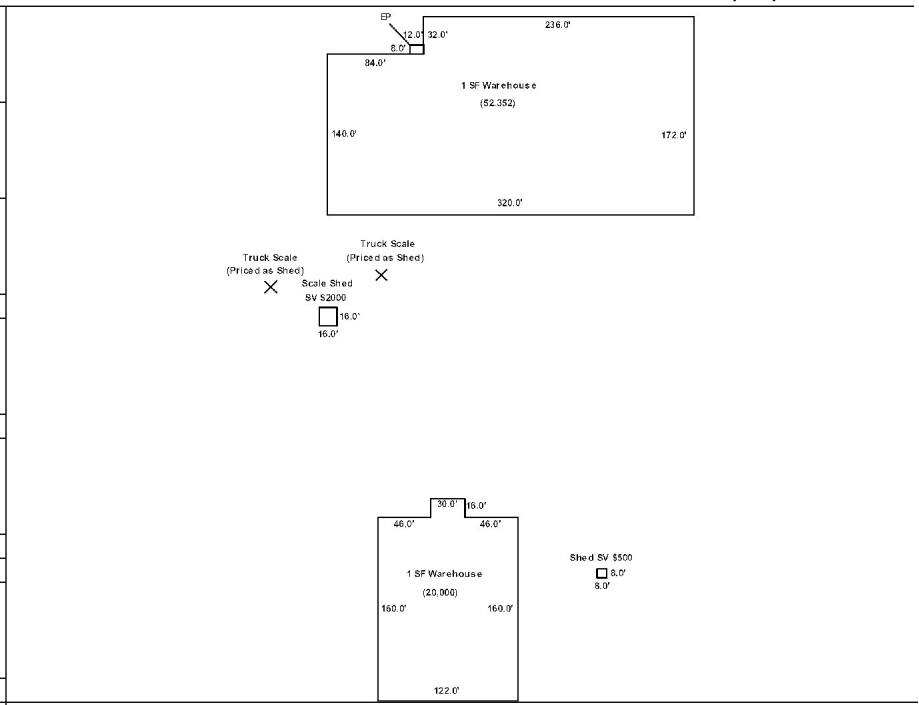



**Washburn**

Map Lot 001-038/41 & 42

Account 605

Location 2326 Parsons Road

Card 2 Of 3 9/04/2024

Building Style	SF Bsmt Living	Layout
1.Conv. 5.Garrison 9.Gambrel	Fin Bsmt Grade	1.Typical 4. 7.
2.Ranch 6.Salt Box 10.Other	OPEN 5 OPTIONAL	2.Inadeq 5. 8.
3.R Ranch 7.Contemp 11.Split	Heat Type <b>100%</b>	3.Poor 6. 9.
4.Cape 8.Log 12.	1.HWBB 5.FWA 9.No Heat	Attic
Dwelling Units	2.HWCI 6.GravWA 10.	1.1/4 Fin 4.Full Fin 7.
Other Units	3.H Pump 7.Electric 11.	2.1/2 Fin 5.F/Stair 8.
Stories	4.Steam 8.F/Wall 12.	3.3/4 Fin 6. 9.None
1.1 4.1.5 7.	Cool Type <b>0%</b>	Insulation
2.2 5.1.75 8.	1.Refrig 4.W&C Air 7.	1.Full 4.Minimal 7.
3.3 6.2.5 9.	2.Evapor 5. 8.	2.Heavy 5.Partial 8.
Exterior Walls	3.H Pump 6. 9.None	3.Capped 6. 9.None
1.Wood 5.Stucco 9.T-111	Kitchen Style	Unfinished %
2.Vin/Al 6.Brick 10.Other	1.Modern 4.Obsolete 7.	Grade & Factor
3.Compos. 7.Stone 11.	2.Typical 5. 8.	1.E Grade 4.B Grade 7.
4.Asbestos 8.Concrete 12.	3.Old Type 6. 9.None	2.D Grade 5.A Grade 8.SC Grade
Roof Surface	Bath(s) Style	3.C Grade 6.AA Grade 9.Same
1.Asphalt 4.Composit 7.	1.Modern 4.Obsolete 7.	SQFT (Footprint)
2.Slate 5.Wood 8.	2.Typical 5. 8.	Condition
3.Metal 6.Other 9.	3.Old Type 6. 9.None	1.Poor 4.Avg 7.V G
SF Masonry Trim	# Rooms	2.Fair 5.Avg+ 8.Exc
OPEN-3-CUSTOM	# Bedrooms	3.Avg- 6.Good 9.Same
OPEN-4-CUSTOM	# Full Baths	Phys. % Good
Year Built	# Half Baths	Funct. % Good
Year Remodeled	# Addn Fixtures	Functional Code
Foundation	# Fireplaces	1.Incomp 4.Delap 7.No Power
1.Concrete 4.Wood 7.		2.O-Built 5.Bsmt 8.LongTerm
2.C Block 5.Slab 8.		3.Damage 6.Common 9.None
3.Br/Stone 6.Piers 9.		Econ. % Good
Basement		Economic Code
1.1/4 Bmt 4.Full Bmt 7.		0.None 3.No Power 7.
2.1/2 Bmt 5.None 8.		1.Location 4.Generate 8.
3.3/4 Bmt 6. 9.None		2.Encroach 9.None 9.
Bsmt Gar # Cars		Entrance Code <b>0</b>
Wet Basement		1.Interior 4.Vacant 7.
1.Dry 4. 7.		2.Refusal 5.Estimate 8.
2.Damp 5. 8.	3.Informed 6.Reviewed 9.	
3.Wet 6. 9.	Information Code <b>0</b>	
	1.Owner 4.Agent 7.	
	2.Relative 5.Estimate 8.	
	3.Tenant 6.Other 9.	

Date Inspected

**Additions, Outbuildings & Improvements**

Type	Year	Units	Grade	Cond	Phys.	Funct.	Sound Value	
279 Main Plant	2020				%	%	32,522,100	1.One Story Fram
102 C-L Fencing /LF 0					%	%	50,000	2.Two Story Fram
281 Light Ind-C-stor	2023	10000	3 100	4	0 %	100 %		3.Three Story Fr
					%	%		4.1 & 1/2 Story
					%	%		5.1 & 3/4 Story
					%	%		6.2 & 1/2 Story
					%	%		21.Open Frame Por
					%	%		22.Encl Frame Por
					%	%		23.Frame Garage
					%	%		24.Frame Shed
					%	%		25.Frame Bay Wind
					%	%		26.1SFr Overhang
					%	%		27.Unfin Basement
					%	%		28.Unfinished Att
					%	%		29.Finished Attic

Penobscot McCrum LLC  
PO Box 220  
Washburn ME 04786

B5237P312

Inspection Witnessed By:

No./Date	Description	Date Insp.
X		

Notes:

Washburn

Property Data			Assessment Record						
Neighborhood <b>1 Neighborhood One</b>			Year	Land	Buildings	Exempt	Total		
Tree Growth Year <b>0</b>			2024	0	545,900	0	545,900		
1ST MORTGAGE <b>0</b>									
2ND MORTGAGE <b>0</b>									
Zone/Land Use <b>2 Commercial</b>									
Secondary Zone									
Topography <b>2 Rolling</b>									
1.Level 4.Below St 7.LevelBog 2.Rolling 5.Low 8. 3.Above St 6.Swampy 9.									
Utilities <b>4 Drilled Well 6 Septic System</b>									
1.Public 4.Dr Well 7.Cesspool 2.Water 5.Dug Well 8. 3.Sewer 6.Septic 9.None									
Street <b>1 Paved</b>									
1.Paved 4.Proposed 7. 2.Semi Imp 5.R/O/W 8. 3.Gravel 6. 9.None									
TG PLAN YEAR <b>0</b>									
Tif District # <b>0</b>									
Sale Data			<b>Land Data</b>						
Sale Date			<b>Front Foot</b>	<b>Type</b>	<b>Effective</b>		<b>Influence</b>		<b>Influence Codes</b>
Price					Frontage	Depth	Factor	Code	
Sale Type			11.Regular Lot						1.Unimproved
1.Land 4.Mobile 7.C/I L&B 2.L & B 5.Other 8. 3.Building 6.C/I Land 9.			12.Delta Triangle						2.Excess Frtg
Financing			13.Nabla Triangle						3.Topography
1.Convent 4.Seller 7. 2.FHA/VA 5.Private 8. 3.Assumed 6.Cash 9.Unknown			14.Rear Land						4.Size/Shape
Validity			15.Class I Road						5.Access
1.Valid 4.Split 7.Renovate 2.Related 5.Partial 8.Other 3.Distress 6.Exempt 9.									6.Restriction
Verified									7.Open Space
1.Buyer 4.Agent 7.Family 2.Seller 5.Pub Rec 8.Other 3.Lender 6.MLS 9.			<b>Square Foot</b>	<b>Square Feet</b>					8.View/Environ
			16.Class II Road						9.Fract Share
			17.Municipal Rese						<b>Acres</b>
			18.Munic Sep Lago						30.Utility R O W
			19.Gravel Pit						31.Tillable
			20.Industrial Bas						32.Pasture
									33.Orchard
			<b>Fract. Acre</b>	<b>Acreege/Sites</b>					34.Softwood F&O
			21.Developed Pave						35.Mixed Wood F&O
			22.Undev Paved (F						36.Hardwood F&O
			23.Developed Grav						37.Softwood TG
			<b>Acres</b>						38.Mixed Wood TG
			24.Undev Gravel (						39.Hardwood TG
			25.Comm Base Pave						40.Wasteland
			26.Comm Base Grav						41.Open Space
			27.Backlot						42.Mobile Home Si
			28.Rear Land						43.Condo Site
			29.Pavement						44.Lot Improvemen
						<b>Total Acreege</b>	0.00		45.Subdivision Lo
									46.Heavy Ind Sit





Penobscot McCrum LLC  
 PO Box 220  
 Washburn ME 04786

			Property Data			Assessment Record					
			Neighborhood	1 Neighborhood One		Year	Land	Buildings	Exempt	Total	
			Tree Growth Year		0	2020	1,375,000	0	1,375,000	0	
			1ST MORTGAGE		0	2021	1,375,000	97,200	1,472,200	0	
			2ND MORTGAGE		0	2022	1,375,000	97,200	1,472,200	0	
			Zone/Land Use		2 Commercial		2023	1,375,000	97,200	1,472,200	0
			Secondary Zone			2024	1,375,000	97,200	1,472,200	0	
			Topography		1 Level						
			1.Level		4.Below St	7.LevelBog					
			2.Rolling		5.Low		8.				
			3.Above St		6.Swampy		9.				
			Utilities		4 Drilled Well		6 Septic System				
			1.Public		4.Dr Well		7.Cesspool				
			2.Water		5.Dug Well		8.				
			3.Sewer		6.Septic		9.None				
			Street		1 Paved						
			1.Paved		4.Proposed		7.				
			2.Semi Imp		5.R/O/W		8.				
			3.Gravel		6.		9.None				
			TG PLAN YEAR		0		11.Regular Lot				
			Tif District #		0		12.Delta Triangle				
							13.Nabla Triangle				
							14.Rear Land				
							15.Class I Road				

## Washburn

Map Lot 001-038/41 &42-ON

Account 1140

Location Waste Water Treatment

Card 1 Of 1 9/04/2024

Building Style			SF Bsmt Living			Layout								
1.Conv.	5.Garrison	9.Gambrel	Fin Bsmt Grade			1.Typical	4.	7.						
2.Ranch	6.Salt Box	10.Other	OPEN 5 OPTIONAL			2.Inadeq	5.	8.						
3.R Ranch	7.Contemp	11.Split	Heat Type <b>100%</b>			3.Poor	6.	9.						
4.Cape	8.Log	12.	1.HWBB	5.FWA	9.No Heat	Attic								
Dwelling Units			2.HWCI	6.GravWA	10.	1.1/4 Fin	4.Full Fin	7.						
Other Units			3.H Pump	7.Electric	11.	2.1/2 Fin	5.F/Stair	8.						
Stories			4.Steam	8.F/Wall	12.	3.3/4 Fin	6.	9.None						
1.1	4.1.5	7.	Cool Type <b>0%</b>			Insulation								
2.2	5.1.75	8.	1.Refrig	4.W&C Air	7.	1.Full	4.Minimal	7.						
3.3	6.2.5	9.	2.Evapor	5.	8.	2.Heavy	5.Partial	8.						
Exterior Walls			3.H Pump	6.	9.None	3.Capped	6.	9.None						
1.Wood	5.Stucco	9.T-111	Kitchen Style			Unfinished %								
2.Vin/Al	6.Brick	10.Other	1.Modern	4.Obsolete	7.	Grade & Factor								
3.Compos.	7.Stone	11.	2.Typical	5.	8.	1.E Grade	4.B Grade	7.						
4.Asbestos	8.Concrete	12.	3.Old Type	6.	9.None	2.D Grade	5.A Grade	8.SC Grade						
Roof Surface			Bath(s) Style			3.C Grade	6.AA Grade	9.Same						
1.Asphalt	4.Composit	7.	1.Modern	4.Obsolete	7.	SQFT (Footprint)								
2.Slate	5.Wood	8.	2.Typical	5.	8.	Condition								
3.Metal	6.Other	9.	3.Old Type	6.	9.None	1.Poor	4.Avg	7.V G						
SF Masonry Trim			# Rooms			2.Fair	5.Avg+	8.Exc						
OPEN-3-CUSTOM			# Bedrooms			3.Avg-	6.Good	9.Same						
OPEN-4-CUSTOM			# Full Baths			Phys. % Good								
Year Built			# Half Baths			Funct. % Good								
Year Remodeled			# Addn Fixtures			Functional Code								
Foundation			# Fireplaces			1.Incomp	4.Delap	7.No Power						
1.Concrete	4.Wood	7.							2.O-Built	5.Bsmt	8.LongTerm			
2.C Block	5.Slab	8.							Econ. % Good			3.Damage	6.Common	9.None
3.Br/Stone	6.Piers	9.							Economic Code			0.None 3.No Power 7.		
Basement									0.None 3.No Power 7.			1.Location 4.Generate 8.		
1.1/4 Bmt	4.Full Bmt	7.							1.Location 4.Generate 8.			2.Encroach 9.None 9.		
2.1/2 Bmt	5.None	8.							Entrance Code <b>0</b>			1.Interior 4.Vacant 7.		
3.3/4 Bmt	6.	9.None							1.Interior 4.Vacant 7.			2.Refusal 5.Estimate 8.		
Bsmt Gar # Cars									2.Refusal 5.Estimate 8.			3.Informed 6.Reviewed 9.		
Wet Basement									3.Informed 6.Reviewed 9.			Information Code <b>0</b>		
1.Dry	4.	7.							1.Owner 4.Agent 7.			2.Relative 5.Estimate 8.		
2.Damp	5.	8.	2.Relative 5.Estimate 8.			3.Tenant 6.Other 9.								
3.Wet	6.	9.	3.Tenant 6.Other 9.											
Date Inspected														
<b>Additions, Outbuildings &amp; Improvements</b>														
Type	Year	Units	Grade	Cond	Phys.	Funct.	Sound Value	1.One Story Fram						
23 Frame Garage	2020				%	%	97,200	2.Two Story Fram						
					%	%		3.Three Story Fr						
					%	%		4.1 & 1/2 Story						
					%	%		5.1 & 3/4 Story						
					%	%		6.2 & 1/2 Story						
					%	%		21.Open Frame Por						
					%	%		22.Encl Frame Por						
					%	%		23.Frame Garage						
					%	%		24.Frame Shed						
					%	%		25.Frame Bay Wind						
					%	%		26.1SFr Overhang						
					%	%		27.Unfin Basement						
					%	%		28.Unfinished Att						
					%	%		29.Finished Attic						



SMITH FARM PROPERTIES INC.  
1407 STATE ROAD  
MAPLETON ME 04757

B4117P343

Inspection Witnessed By:

No./Date	Description	Date Insp.
X		

Notes:

Washburn

Property Data			Assessment Record						
Neighborhood <b>1 Neighborhood One</b>			Year	Land	Buildings	Exempt	Total		
Tree Growth Year <b>0</b>			2012	35,900	0	0	35,900		
1ST MORTGAGE <b>0</b>			2013	46,600	0	0	46,600		
2ND MORTGAGE <b>0</b>			2015	46,600	0	0	46,600		
Zone/Land Use <b>1 Residential</b>			2018	46,600	0	0	46,600		
Secondary Zone			2019	91,000	0	0	91,000		
Topography <b>2 Rolling</b>			2020	91,000	0	0	91,000		
1.Level 4.Below St 7.LevelBog			2021	91,000	0	0	91,000		
2.Rolling 5.Low 8.			2022	91,000	0	0	91,000		
3.Above St 6.Swampy 9.			2023	97,500	0	0	97,500		
Utilities			2024	97,500	0	0	97,500		
1.Public 4.Dr Well 7.Cesspool									
2.Water 5.Dug Well 8.									
3.Sewer 6.Septic 9.None									
Street <b>1 Paved</b>									
1.Paved 4.Proposed 7.									
2.Semi Imp 5.R/O/W 8.									
3.Gravel 6. 9.None									
TG PLAN YEAR <b>0</b>									
Tif District # <b>0</b>									
Sale Data			<b>Land Data</b>						
Sale Date <b>5/10/2005</b>			<b>Front Foot</b>	<b>Type</b>	<b>Effective</b>		<b>Influence</b>		<b>Influence Codes</b>
Price					Frontage	Depth	Factor	Code	
Sale Type <b>1 Land Only</b>			11.Regular Lot					1.Unimproved	
1.Land 4.Mobile 7.C/I L&B			12.Delta Triangle			%		2.Excess Frtg	
2.L & B 5.Other 8.			13.Nabla Triangle			%		3.Topography	
3.Building 6.C/I Land 9.			14.Rear Land			%		4.Size/Shape	
Financing			15.Class I Road			%		5.Access	
1.Convent 4.Seller 7.						%		6.Restriction	
2.FHA/VA 5.Private 8.						%		7.Open Space	
3.Assumed 6.Cash 9.Unknown						%		8.View/Environ	
Validity <b>2 Related Parties</b>			<b>Square Foot</b>	<b>Square Feet</b>				9.Fract Share	
1.Valid 4.Split 7.Renovate			16.Class II Road			%		30.Utility R O W	
2.Related 5.Partial 8.Other			17.Municipal Rese			%		31.Tillable	
3.Distress 6.Exempt 9.			18.Munic Sep Lago			%		32.Pasture	
Verified <b>5 Public Record</b>			19.Gravel Pit			%		33.Orchard	
1.Buyer 4.Agent 7.Family			20.Industrial Bas			%		34.Softwood F&O	
2.Seller 5.Pub Rec 8.Other			<b>Fract. Acre</b>	<b>Acres/Sites</b>				35.Mixed Wood F&O	
3.Lender 6.MLS 9.			21.Developed Pave	22	1.00	100	%	0	
			22.Undev Paved (F	28	56.00	100	%	0	
			23.Developed Grav	31	54.00	100	%	0	
			<b>Acres</b>			%			
			24.Undev Gravel (			%			
			25.Comm Base Pave			%			
			26.Comm Base Grav			%			
			27.Backlot			%			
			28.Rear Land			%			
			29.Pavement			%			
			<b>Total Acreage</b>		111.00				
							44.Lot Improvemen		
							45.Subdivision Lo		
							46.Heavy Ind Sit		

**Washburn**

Map Lot 001-039

Account 814

Location PARSONS ROAD

Card 1 Of 1 9/04/2024

Building Style <b>0</b>	SF Bsmt Living <b>0</b>	Layout <b>0</b>
1.Conv. 5.Garrison 9.Gambrel	Fin Bsmt Grade <b>0 0</b>	1.Typical 4. 7.
2.Ranch 6.Salt Box 10.Other	OPEN 5 OPTIONAL <b>0</b>	2.Inadeq 5. 8.
3.R Ranch 7.Contemp 11.Split	Heat Type <b>100% 0</b>	3.Poor 6. 9.
4.Cape 8.Log 12.	1.HWBB 5.FWA 9.No Heat	Attic <b>0</b>
Dwelling Units <b>0</b>	2.HWCI 6.GravWA 10.	1.1/4 Fin 4.Full Fin 7.
Other Units <b>0</b>	3.H Pump 7.Electric 11.	2.1/2 Fin 5.FI/Stair 8.
Stories <b>0</b>	4.Steam 8.FI/Wall 12.	3.3/4 Fin 6. 9.None
1.1 4.1.5 7.	Cool Type <b>0% 9 None</b>	Insulation <b>0</b>
2.2 5.1.75 8.	1.Refrig 4.W&C Air 7.	1.Full 4.Minimal 7.
3.3 6.2.5 9.	2.Evapor 5. 8.	2.Heavy 5.Partial 8.
Exterior Walls <b>0</b>	3.H Pump 6. 9.None	3.Capped 6. 9.None
1.Wood 5.Stucco 9.T-111	Kitchen Style <b>0</b>	Unfinished % <b>0%</b>
2.Vin/Al 6.Brick 10.Other	1.Modern 4.Obsolete 7.	Grade & Factor <b>0 0%</b>
3.Compos. 7.Stone 11.	2.Typical 5. 8.	1.E Grade 4.B Grade 7.
4.Asbestos 8.Concrete 12.	3.Old Type 6. 9.None	2.D Grade 5.A Grade 8.SC Grade
Roof Surface <b>0</b>	Bath(s) Style <b>0</b>	3.C Grade 6.AA Grade 9.Same
1.Asphalt 4.Composit 7.	1.Modern 4.Obsolete 7.	SQFT (Footprint) <b>0</b>
2.Slate 5.Wood 8.	2.Typical 5. 8.	Condition <b>0</b>
3.Metal 6.Other 9.	3.Old Type 6. 9.None	1.Poor 4.Avg 7.V G
SF Masonry Trim <b>0</b>	# Rooms <b>0</b>	2.Fair 5.Avg+ 8.Exc
OPEN-3-CUSTOM <b>0</b>	# Bedrooms <b>0</b>	3.Avg- 6.Good 9.Same
OPEN-4-CUSTOM <b>0</b>	# Full Baths <b>0</b>	Phys. % Good <b>0%</b>
Year Built <b>0</b>	# Half Baths <b>0</b>	Funct. % Good <b>100%</b>
Year Remodeled <b>0</b>	# Addn Fixtures <b>0</b>	Functional Code <b>9 None</b>
Foundation <b>0</b>	# Fireplaces <b>0</b>	1.Incomp 4.Delap 7.No Power
1.Concrete 4.Wood 7.		2.O-Built 5.Bsmt 8.LongTerm
2.C Block 5.Slab 8.		3.Damage 6.Common 9.None
3.Br/Stone 6.Piers 9.		Econ. % Good <b>100%</b>
Basement <b>0</b>		Economic Code <b>None</b>
1.1/4 Bmt 4.Full Bmt 7.		0.None 3.No Power 7.
2.1/2 Bmt 5.None 8.		1.Location 4.Generate 8.
3.3/4 Bmt 6. 9.None		2.Encroach 9.None 9.
Bsmt Gar # Cars <b>0</b>		Entrance Code <b>0</b>
Wet Basement <b>0</b>		1.Interior 4.Vacant 7.
1.Dry 4. 7.		2.Refusal 5.Estimate 8.
2.Damp 5. 8.	3.Informed 6.Reviewed 9.	
3.Wet 6. 9.	Information Code <b>0</b>	
		1.Owner 4.Agent 7.
		2.Relative 5.Estimate 8.
		3.Tenant 6.Other 9.

Date Inspected

Additions, Outbuildings & Improvements								
Type	Year	Units	Grade	Cond	Phys.	Funct.	Sound Value	
					%	%		1.One Story Fram
					%	%		2.Two Story Fram
					%	%		3.Three Story Fr
					%	%		4.1 & 1/2 Story
					%	%		5.1 & 3/4 Story
					%	%		6.2 & 1/2 Story
					%	%		21.Open Frame Por
					%	%		22.Encl Frame Por
					%	%		23.Frame Garage
					%	%		24.Frame Shed
					%	%		25.Frame Bay Wind
					%	%		26.1SFr Overhang
					%	%		27.Unfin Basement
					%	%		28.Unfinished Att
					%	%		29.Finished Attic













## Washburn

Map Lot 001-043

Account 30

Location 2398 PARSONS ROAD

Card 1

Of 1

9/04/2024

Building Style	<b>5 Garrison</b>		SF Bsmt Living	<b>300</b>		Layout	<b>1 Typical</b>						
1.Conv.	5.Garrison	9.Gambrel	Fin Bsmt Grade	<b>2 100</b>		1.Typical	4.	7.					
2.Ranch	6.Salt Box	10.Other	OPEN 5 OPTIONAL	<b>0</b>		2.Inadeq	5.	8.					
3.R Ranch	7.Contemp	11.Split	Heat Type	<b>100%</b>	<b>1 Hot Water BB</b>	3.Poor	6.	9.					
4.Cape	8.Log	12.	1.HWBB	5.FWA	9.No Heat	<b>Attic 5 Floor &amp; Stairs</b>							
Dwelling Units	<b>1</b>		2.HWCI	6.GravWA	10.	1.1/4 Fin	4.Full Fin	7.					
Other Units	<b>0</b>		3.H Pump	7.Electric	11.	2.1/2 Fin	5.FI/Stair	8.					
Stories	<b>2 Two Story</b>		4.Steam	8.FI/Wall	12.	3.3/4 Fin	6.	9.None					
1.1	4.1.5	7.	Cool Type	<b>0%</b>	<b>9 None</b>	<b>Insulation 1 Full</b>							
2.2	5.1.75	8.	1.Refrig	4.W&C Air	7.	1.Full	4.Minimal	7.					
3.3	6.2.5	9.	2.Evapor	5.	8.	2.Heavy	5.Partial	8.					
Exterior Walls	<b>2 Vinyl/Aluminum</b>		3.H Pump	6.	9.None	3.Capped	6.	9.None					
1.Wood	5.Stucco	9.T-111	Kitchen Style	<b>2 Typical</b>		<b>Unfinished % 0%</b>							
2.Vin/Al	6.Brick	10.Other	1.Modern	4.Obsolete	7.	<b>Grade &amp; Factor 3 Average 100%</b>							
3.Compos.	7.Stone	11.	2.Typical	5.	8.	1.E Grade	4.B Grade	7.					
4.Asbestos	8.Concrete	12.	3.Old Type	6.	9.None	2.D Grade	5.A Grade	8.SC Grade					
Roof Surface	<b>1 Asphalt Shingles</b>		Bath(s) Style	<b>2 Typical Bath(s)</b>		3.C Grade	6.AA Grade	9.Same					
1.Asphalt	4.Composit	7.	1.Modern	4.Obsolete	7.	<b>SQFT (Footprint) 864</b>							
2.Slate	5.Wood	8.	2.Typical	5.	8.	<b>Condition 5 Above Average</b>							
3.Metal	6.Other	9.	3.Old Type	6.	9.None	1.Poor	4.Avg	7.V G					
SF Masonry Trim	<b>0</b>		# Rooms	<b>7</b>		2.Fair	5.Avg+	8.Exc					
OPEN-3-CUSTOM	<b>0</b>		# Bedrooms	<b>4</b>		3.Avg-	6.Good	9.Same					
OPEN-4-CUSTOM	<b>0</b>		# Full Baths	<b>1</b>		<b>Phys. % Good 0%</b>							
Year Built	<b>1948</b>		# Half Baths	<b>1</b>		<b>Funct. % Good 100%</b>							
Year Remodeled	<b>0</b>		# Addn Fixtures	<b>0</b>		<b>Functional Code 9 None</b>							
Foundation	<b>1 Concrete</b>		# Fireplaces	<b>2</b>		1.Incomp	4.Delap	7.No Power					
1.Concrete	4.Wood	7.							2.O-Built	5.Bsmt	8.LongTerm		
2.C Block	5.Slab	8.							<b>Economic Code None</b>				
3.Br/Stone	6.Piers	9.							0.None			3.No Power	7.
Basement	<b>4 Full Basement</b>								1.Location			4.Generate	8.
1.1/4 Bmt	4.Full Bmt	7.							2.Encroach			9.None	9.
2.1/2 Bmt	5.None	8.							<b>Entrance Code 1 Interior Inspect</b>				
3.3/4 Bmt	6.	9.None							1.Interior			4.Vacant	7.
Bsmt Gar # Cars	<b>0</b>								2.Refusal			5.Estimate	8.
Wet Basement	<b>2 Damp Basement</b>								3.Informed			6.Reviewed	9.
1.Dry	4.	7.							<b>Information Code 1 Owner</b>				
2.Damp	5.	8.	1.Owner			4.Agent	7.						
3.Wet	6.	9.	2.Relative			5.Estimate	8.						
			3.Tenant			6.Other	9.						

Date Inspected 7/29/2018

### Additions, Outbuildings & Improvements

Type	Year	Units	Grade	Cond	Phys.	Funct.	Sound Value
68 Wood Deck	0	100	0 0	0	0 %	0 %	
1 One Story Frame	0	276	0 0	0	0 %	0 %	
23 Frame Garage	1965	576	3 90	4	0 %	80 %	
24 Frame Shed	0				%	%	200
24 Frame Shed	0				%	%	50
24 Frame Shed	0				%	%	300
24 Frame Shed	0				%	%	100
87 Pole Barn	0				%	%	200
66 Res. Greenhouse	0				%	%	1,500
					%	%	

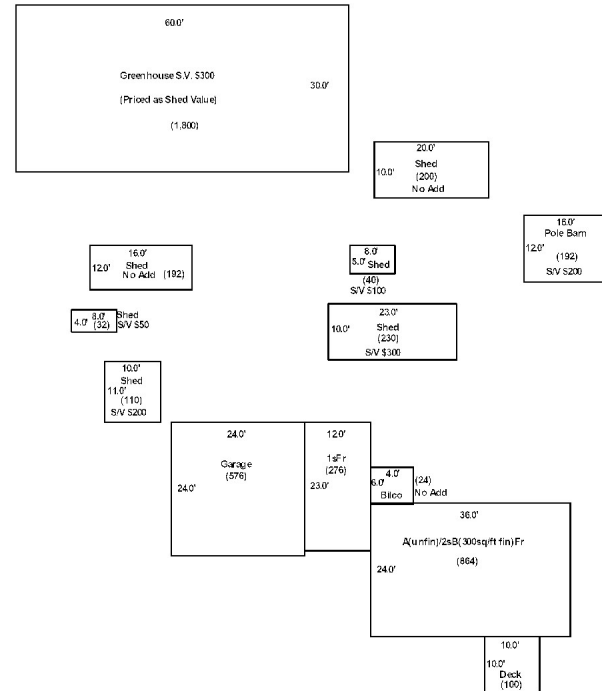

KLEI, HUGH T  
76 TURNPIKE ROAD  
WILLINGTON CT 06279

B5199P59 B5968P320 B5968P322

Inspection Witnessed By:

No./Date	Description	Date Insp.
X		

Notes:  
\* Bk 5968 Pg 320 is memorandum of lease  
Changed 172 Acres from Tillable to Floodfields for plant -  
(Waste)

Washburn

Property Data			Assessment Record						
Neighborhood <b>1 Neighborhood One</b>			Year	Land	Buildings	Exempt	Total		
Tree Growth Year <b>0</b>			2012	71,300	0	0	71,300		
1ST MORTGAGE <b>0</b>			2013	92,700	0	0	92,700		
2ND MORTGAGE <b>0</b>			2015	92,700	0	0	92,700		
Zone/Land Use <b>1 Residential</b>			2018	92,700	0	0	92,700		
Secondary Zone			2019	227,500	0	0	227,500		
Topography <b>1 Level</b>			2020	132,900	0	0	132,900		
1.Level 4.Below St 7.LevelBog			2021	132,900	0	0	132,900		
2.Rolling 5.Low 8.			2022	132,900	0	0	132,900		
3.Above St 6.Swampy 9.			2023	151,000	0	0	151,000		
Utilities			2024	151,000	0	0	151,000		
1.Public 4.Dr Well 7.Cesspool									
2.Water 5.Dug Well 8.									
3.Sewer 6.Septic 9.None									
Street <b>1 Paved</b>									
1.Paved 4.Proposed 7.									
2.Semi Imp 5.R/O/W 8.									
3.Gravel 6. 9.None									
TG PLAN YEAR <b>0</b>									
Tif District # <b>0</b>									
Sale Data			<b>Land Data</b>						
Sale Date <b>8/14/2008</b>			<b>Front Foot</b>	<b>Type</b>	<b>Effective</b>		<b>Influence</b>		<b>Influence Codes</b>
Price <b>227,000</b>					Frontage	Depth	Factor	Code	
Sale Type <b>1 Land Only</b>			11.Regular Lot					1.Unimproved	
1.Land 4.Mobile 7.C/I L&B			12.Delta Triangle			%		2.Excess Frtg	
2.L & B 5.Other 8.			13.Nabla Triangle			%		3.Topography	
3.Building 6.C/I Land 9.			14.Rear Land			%		4.Size/Shape	
Financing			15.Class I Road			%		5.Access	
1.Convent 4.Seller 7.						%		6.Restriction	
2.FHA/VA 5.Private 8.						%		7.Open Space	
3.Assumed 6.Cash 9.Unknown						%		8.View/Environ	
Validity <b>3 Distressed Sale</b>						%		9.Fract Share	
1.Valid 4.Split 7.Renovate			<b>Square Foot</b>	<b>Square Feet</b>				<b>Acres</b>	
2.Related 5.Partial 8.Other			16.Class II Road			%		30.Utility R O W	
3.Distress 6.Exempt 9.			17.Municipal Rese			%		31.Tillable	
Verified <b>5 Public Record</b>			18.Munic Sep Lago			%		32.Pasture	
1.Buyer 4.Agent 7.Family			19.Gravel Pit			%		33.Orchard	
2.Seller 5.Pub Rec 8.Other			20.Industrial Bas			%		34.Softwood F&O	
3.Lender 6.MLS 9.						%		35.Mixed Wood F&O	
			<b>Fract. Acre</b>	<b>Acreege/Sites</b>				36.Hardwood F&O	
			21.Developed Pave	22	1.00	100 %	0	37.Softwood TG	
			22.Undev Paved (F	28	25.50	100 %	0	38.Mixed Wood TG	
			23.Developed Grav	31	24.00	100 %	0	39.Hardwood TG	
			<b>Acres</b>	28	172.00	100 %	0	40.Wasteland	
			24.Undev Gravel (	40	19.50	100 %	0	41.Open Space	
			25.Comm Base Pave			%		42.Mobile Home Si	
			26.Comm Base Grav			%		43.Condo Site	
			27.Backlot			%		44.Lot Improvemen	
			28.Rear Land			%		45.Subdivision Lo	
			29.Pavement			%		46.Heavy Ind Sit	
				<b>Total Acreage</b>		242.00			

**Washburn**

Map Lot 001-044

Account 1105

Location CASTLE HILL ROAD

Card 1 Of 1 9/04/2024

Building Style <b>0</b>	SF Bsmt Living <b>0</b>	Layout <b>0</b>
1.Conv. 5.Garrison 9.Gambrel	Fin Bsmt Grade <b>0 0</b>	1.Typical 4. 7.
2.Ranch 6.Salt Box 10.Other	OPEN 5 OPTIONAL <b>0</b>	2.Inadeq 5. 8.
3.R Ranch 7.Contemp 11.Split	Heat Type <b>100% 0</b>	3.Poor 6. 9.
4.Cape 8.Log 12.	1.HWBB 5.FWA 9.No Heat	Attic <b>0</b>
Dwelling Units <b>0</b>	2.HWCI 6.GravWA 10.	1.1/4 Fin 4.Full Fin 7.
Other Units <b>0</b>	3.H Pump 7.Electric 11.	2.1/2 Fin 5.F/Stair 8.
Stories <b>0</b>	4.Steam 8.F/Wall 12.	3.3/4 Fin 6. 9.None
1.1 4.1.5 7.	Cool Type <b>0% 9 None</b>	Insulation <b>0</b>
2.2 5.1.75 8.	1.Refrig 4.W&C Air 7.	1.Full 4.Minimal 7.
3.3 6.2.5 9.	2.Evapor 5. 8.	2.Heavy 5.Partial 8.
Exterior Walls <b>0</b>	3.H Pump 6. 9.None	3.Capped 6. 9.None
1.Wood 5.Stucco 9.T-111	Kitchen Style <b>0</b>	Unfinished % <b>0%</b>
2.Vin/Al 6.Brick 10.Other	1.Modern 4.Obsolete 7.	Grade & Factor <b>0 0%</b>
3.Compos. 7.Stone 11.	2.Typical 5. 8.	1.E Grade 4.B Grade 7.
4.Asbestos 8.Concrete 12.	3.Old Type 6. 9.None	2.D Grade 5.A Grade 8.SC Grade
Roof Surface <b>0</b>	Bath(s) Style <b>0</b>	3.C Grade 6.AA Grade 9.Same
1.Asphalt 4.Composit 7.	1.Modern 4.Obsolete 7.	SQFT (Footprint) <b>0</b>
2.Slate 5.Wood 8.	2.Typical 5. 8.	Condition <b>0</b>
3.Metal 6.Other 9.	3.Old Type 6. 9.None	1.Poor 4.Avg 7.V G
SF Masonry Trim <b>0</b>	# Rooms <b>0</b>	2.Fair 5.Avg+ 8.Exc
OPEN-3-CUSTOM <b>0</b>	# Bedrooms <b>0</b>	3.Avg- 6.Good 9.Same
OPEN-4-CUSTOM <b>0</b>	# Full Baths <b>0</b>	Phys. % Good <b>0%</b>
Year Built <b>0</b>	# Half Baths <b>0</b>	Funct. % Good <b>100%</b>
Year Remodeled <b>0</b>	# Addn Fixtures <b>0</b>	Functional Code <b>9 None</b>
Foundation <b>0</b>	# Fireplaces <b>0</b>	1.Incomp 4.Delap 7.No Power
1.Concrete 4.Wood 7.		2.O-Built 5.Bsmt 8.LongTerm
2.C Block 5.Slab 8.		3.Damage 6.Common 9.None
3.Br/Stone 6.Piers 9.		Econ. % Good <b>100%</b>
Basement <b>0</b>		Economic Code <b>None</b>
1.1/4 Bmt 4.Full Bmt 7.		0.None 3.No Power 7.
2.1/2 Bmt 5.None 8.		1.Location 4.Generate 8.
3.3/4 Bmt 6. 9.None		2.Encroach 9.None 9.
Bsmt Gar # Cars <b>0</b>		Entrance Code <b>0</b>
Wet Basement <b>0</b>		1.Interior 4.Vacant 7.
1.Dry 4. 7.		2.Refusal 5.Estimate 8.
2.Damp 5. 8.	3.Informed 6.Reviewed 9.	
3.Wet 6. 9.	Information Code <b>0</b>	
		1.Owner 4.Agent 7.
		2.Relative 5.Estimate 8.
		3.Tenant 6.Other 9.

Date Inspected

**Additions, Outbuildings & Improvements**

Type	Year	Units	Grade	Cond	Phys.	Funct.	Sound Value
					%	%	1.One Story Fram
					%	%	2.Two Story Fram
					%	%	3.Three Story Fr
					%	%	4.1 & 1/2 Story
					%	%	5.1 & 3/4 Story
					%	%	6.2 & 1/2 Story
					%	%	21.Open Frame Por
					%	%	22.Encl Frame Por
					%	%	23.Frame Garage
					%	%	24.Frame Shed
					%	%	25.Frame Bay Wind
					%	%	26.1SFr Overhang
					%	%	27.Unfin Basement
					%	%	28.Unfinished Att
					%	%	29.Finished Attic

SMITH FARM PROPERTIES, INC.  
1407 State Road  
Mapleton ME 04757

B4117P343

Inspection Witnessed By:

No./Date	Description	Date Insp.
X		

Notes:

Washburn

Property Data			Assessment Record						
Neighborhood <b>1 Neighborhood One</b>			Year	Land	Buildings	Exempt	Total		
Tree Growth Year <b>0</b>			2012	27,700	0	0	27,700		
1ST MORTGAGE <b>0</b>			2013	35,900	0	0	35,900		
2ND MORTGAGE <b>0</b>			2015	35,900	0	0	35,900		
Zone/Land Use <b>1 Residential</b>			2018	35,900	0	0	35,900		
Secondary Zone			2019	75,000	0	0	75,000		
Topography <b>2 Rolling</b>			2020	75,000	0	0	75,000		
1.Level 4.Below St 7.LevelBog			2021	75,000	0	0	75,000		
2.Rolling 5.Low 8.			2022	75,000	0	0	75,000		
3.Above St 6.Swampy 9.			2023	78,600	0	0	78,600		
Utilities			2024	78,600	0	0	78,600		
1.Public 4.Dr Well 7.Cesspool									
2.Water 5.Dug Well 8.									
3.Sewer 6.Septic 9.None									
Street <b>1 Paved</b>									
1.Paved 4.Proposed 7.									
2.Semi Imp 5.R/O/W 8.									
3.Gravel 6. 9.None									
TG PLAN YEAR <b>0</b>									
Tif District # <b>0</b>									
Sale Data			<b>Land Data</b>						
Sale Date <b>5/10/2005</b>			<b>Front Foot</b>	<b>Type</b>	<b>Effective</b>		<b>Influence</b>		<b>Influence Codes</b>
Price					Frontage	Depth	Factor	Code	
Sale Type <b>1 Land Only</b>			11.Regular Lot					1.Unimproved	
1.Land 4.Mobile 7.C/I L&B			12.Delta Triangle					2.Excess Frtg	
2.L & B 5.Other 8.			13.Nabla Triangle					3.Topography	
3.Building 6.C/I Land 9.			14.Rear Land					4.Size/Shape	
Financing			15.Class I Road					5.Access	
1.Convent 4.Seller 7.								6.Restriction	
2.FHA/VA 5.Private 8.								7.Open Space	
3.Assumed 6.Cash 9.Unknown								8.View/Environ	
Validity <b>2 Related Parties</b>								9.Fract Share	
1.Valid 4.Split 7.Renovate			<b>Square Foot</b>	<b>Square Feet</b>				<b>Acres</b>	
2.Related 5.Partial 8.Other			16.Class II Road					30.Utility R O W	
3.Distress 6.Exempt 9.			17.Municipal Rese					31.Tillable	
Verified <b>5 Public Record</b>			18.Munic Sep Lago					32.Pasture	
1.Buyer 4.Agent 7.Family			19.Gravel Pit					33.Orchard	
2.Seller 5.Pub Rec 8.Other			20.Industrial Bas					34.Softwood F&O	
3.Lender 6.MLS 9.								35.Mixed Wood F&O	
			<b>Fract. Acre</b>	<b>Acreege/Sites</b>				36.Hardwood F&O	
			21.Developed Pave	22	1.00	100	%	0	
			22.Undev Paved (F	28	20.00	100	%	0	
			23.Developed Grav	31	56.00	100	%	0	
			<b>Acres</b>						
			24.Undev Gravel (					%	
			25.Comm Base Pave					%	
			26.Comm Base Grav					%	
			27.Backlot					%	
			28.Rear Land					%	
			29.Pavement					%	
			<b>Total Acreege</b>			77.00			
								44.Lot Improvemen	
								45.Subdivision Lo	
								46.Heavy Ind Sit	

**Washburn**

Map Lot 001-045

Account 815

Location 463 CASTLE HILL ROAD

Card 1 Of 1 9/04/2024

Building Style <b>0</b>	SF Bsmt Living <b>0</b>	Layout <b>0</b>
1.Conv. 5.Garrison 9.Gambrel	Fin Bsmt Grade <b>0 0</b>	1.Typical 4. 7.
2.Ranch 6.Salt Box 10.Other	OPEN 5 OPTIONAL <b>0</b>	2.Inadeq 5. 8.
3.R Ranch 7.Contemp 11.Split	Heat Type <b>100% 0</b>	3.Poor 6. 9.
4.Cape 8.Log 12.	1.HWBB 5.FWA 9.No Heat	Attic <b>0</b>
Dwelling Units <b>0</b>	2.HWCI 6.GravWA 10.	1.1/4 Fin 4.Full Fin 7.
Other Units <b>0</b>	3.H Pump 7.Electric 11.	2.1/2 Fin 5.FI/Stair 8.
Stories <b>0</b>	4.Steam 8.FI/Wall 12.	3.3/4 Fin 6. 9.None
1.1 4.1.5 7.	Cool Type <b>0% 9 None</b>	Insulation <b>0</b>
2.2 5.1.75 8.	1.Refrig 4.W&C Air 7.	1.Full 4.Minimal 7.
3.3 6.2.5 9.	2.Evapor 5. 8.	2.Heavy 5.Partial 8.
Exterior Walls <b>0</b>	3.H Pump 6. 9.None	3.Capped 6. 9.None
1.Wood 5.Stucco 9.T-111	Kitchen Style <b>0</b>	Unfinished % <b>0%</b>
2.Vin/Al 6.Brick 10.Other	1.Modern 4.Obsolete 7.	Grade & Factor <b>0 0%</b>
3.Compos. 7.Stone 11.	2.Typical 5. 8.	1.E Grade 4.B Grade 7.
4.Asbestos 8.Concrete 12.	3.Old Type 6. 9.None	2.D Grade 5.A Grade 8.SC Grade
Roof Surface <b>0</b>	Bath(s) Style <b>0</b>	3.C Grade 6.AA Grade 9.Same
1.Asphalt 4.Composit 7.	1.Modern 4.Obsolete 7.	SQFT (Footprint) <b>0</b>
2.Slate 5.Wood 8.	2.Typical 5. 8.	Condition <b>0</b>
3.Metal 6.Other 9.	3.Old Type 6. 9.None	1.Poor 4.Avg 7.V G
SF Masonry Trim <b>0</b>	# Rooms <b>0</b>	2.Fair 5.Avg+ 8.Exc
OPEN-3-CUSTOM <b>0</b>	# Bedrooms <b>0</b>	3.Avg- 6.Good 9.Same
OPEN-4-CUSTOM <b>0</b>	# Full Baths <b>0</b>	Phys. % Good <b>0%</b>
Year Built <b>0</b>	# Half Baths <b>0</b>	Funct. % Good <b>100%</b>
Year Remodeled <b>0</b>	# Addn Fixtures <b>0</b>	Functional Code <b>9 None</b>
Foundation <b>0</b>	# Fireplaces <b>0</b>	1.Incomp 4.Delap 7.No Power
1.Concrete 4.Wood 7.		2.O-Built 5.Bsmt 8.LongTerm
2.C Block 5.Slab 8.		3.Damage 6.Common 9.None
3.Br/Stone 6.Piers 9.		Econ. % Good <b>100%</b>
Basement <b>0</b>		Economic Code <b>None</b>
1.1/4 Bmt 4.Full Bmt 7.		0.None 3.No Power 7.
2.1/2 Bmt 5.None 8.		1.Location 4.Generate 8.
3.3/4 Bmt 6. 9.None		2.Encroach 9.None 9.
Bsmt Gar # Cars <b>0</b>		Entrance Code <b>0</b>
Wet Basement <b>0</b>		1.Interior 4.Vacant 7.
1.Dry 4. 7.		2.Refusal 5.Estimate 8.
2.Damp 5. 8.	3.Informed 6.Reviewed 9.	
3.Wet 6. 9.	Information Code <b>0</b>	
		1.Owner 4.Agent 7.
		2.Relative 5.Estimate 8.
		3.Tenant 6.Other 9.

Date Inspected

**Additions, Outbuildings & Improvements**

Type	Year	Units	Grade	Cond	Phys.	Funct.	Sound Value
					%	%	1.One Story Fram
					%	%	2.Two Story Fram
					%	%	3.Three Story Fr
					%	%	4.1 & 1/2 Story
					%	%	5.1 & 3/4 Story
					%	%	6.2 & 1/2 Story
					%	%	21.Open Frame Por
					%	%	22.Encl Frame Por
					%	%	23.Frame Garage
					%	%	24.Frame Shed
					%	%	25.Frame Bay Wind
					%	%	26.1SFr Overhang
					%	%	27.Unfin Basement
					%	%	28.Unfinished Att
					%	%	29.Finished Attic

HART, RONA M  
451 CASTLE HILL ROAD  
WASHBURN ME 04786

B2354P86 B5444P254

Inspection Witnessed By:

No./Date	Description	Date Insp.
X		

Notes:  
\*5-7-2019 Dwelling is vacant.

Washburn

Property Data			Assessment Record						
Neighborhood <b>1 Neighborhood One</b>			Year	Land	Buildings	Exempt	Total		
Tree Growth Year <b>0</b>			2012	6,800	36,000	0	42,800		
1ST MORTGAGE <b>0</b>			2013	8,800	24,400	0	33,200		
2ND MORTGAGE <b>0</b>			2015	8,800	24,400	0	33,200		
Zone/Land Use <b>1 Residential</b>			2018	8,800	24,400	0	33,200		
Secondary Zone			2019	16,800	26,300	0	43,100		
Topography <b>1 Level 4 Below Street</b>			2020	16,800	26,300	0	43,100		
1.Level 4.Below St 7.LevelBog			2021	16,800	26,300	0	43,100		
2.Rolling 5.Low 8.			2022	16,800	27,600	0	44,400		
3.Above St 6.Swampy 9.			2023	22,300	32,800	0	55,100		
Utilities <b>4 Drilled Well 6 Septic System</b>			2024	22,300	32,800	0	55,100		
1.Public 4.Dr Well 7.Cesspool									
2.Water 5.Dug Well 8.									
3.Sewer 6.Septic 9.None									
Street <b>1 Paved</b>									
1.Paved 4.Proposed 7.									
2.Semi Imp 5.R/O/W 8.									
3.Gravel 6. 9.None									
TG PLAN YEAR <b>0</b>									
Tif District # <b>0</b>									
Sale Data			<b>Land Data</b>						
Sale Date <b>5/03/1991</b>			<b>Front Foot</b>	<b>Type</b>	<b>Effective</b>		<b>Influence</b>		<b>Influence Codes</b>
Price					Frontage	Depth	Factor	Code	
Sale Type <b>2 Land &amp; Buildings</b>			11.Regular Lot					1.Unimproved	
1.Land 4.Mobile 7.C/I L&B			12.Delta Triangle					2.Excess Frtg	
2.L & B 5.Other 8.			13.Nabla Triangle					3.Topography	
3.Building 6.C/I Land 9.			14.Rear Land					4.Size/Shape	
Financing <b>1 Conventional</b>			15.Class I Road					5.Access	
1.Convent 4.Seller 7.								6.Restriction	
2.FHA/VA 5.Private 8.								7.Open Space	
3.Assumed 6.Cash 9.Unknown								8.View/Environ	
Validity <b>1 Arms Length Sale</b>								9.Fract Share	
1.Valid 4.Split 7.Renovate			<b>Square Foot</b>	<b>Square Feet</b>				<b>Acres</b>	
2.Related 5.Partial 8.Other			16.Class II Road					30.Utility R O W	
3.Distress 6.Exempt 9.			17.Municipal Rese					31.Tillable	
Verified <b>5 Public Record</b>			18.Munic Sep Lago					32.Pasture	
1.Buyer 4.Agent 7.Family			19.Gravel Pit					33.Orchard	
2.Seller 5.Pub Rec 8.Other			20.Industrial Bas					34.Softwood F&O	
3.Lender 6.MLS 9.								35.Mixed Wood F&O	
			<b>Fract. Acre</b>	<b>Acres/Sites</b>				36.Hardwood F&O	
			21.Developed Pave	21	1.00	100	% 0	37.Softwood TG	
			22.Undev Paved (F	28	0.50	100	% 0	38.Mixed Wood TG	
			23.Developed Grav					39.Hardwood TG	
			<b>Acres</b>					40.Wasteland	
			24.Undev Gravel (					41.Open Space	
			25.Comm Base Pave					42.Mobile Home Si	
			26.Comm Base Grav					43.Condo Site	
			27.Backlot					44.Lot Improvemen	
			28.Rear Land					45.Subdivision Lo	
			29.Pavement					46.Heavy Ind Sit	
			<b>Total Acreage</b>		1.50				

## Washburn

Map Lot 001-046

Account 352

Location 451 CASTLE HILL ROAD

Card 1 Of 1 9/04/2024

Building Style	<b>1 Conventional</b>			SF Bsmt Living	<b>0</b>			Layout	<b>1 Typical</b>		
1.Conv.	5.Garrison	9.Gambrel		Fin Bsmt Grade	<b>0 0</b>			1.Typical	4.	7.	
2.Ranch	6.Salt Box	10.Other		OPEN 5 OPTIONAL	<b>0</b>			2.Inadeq	5.	8.	
3.R Ranch	7.Contemp	11.Split		Heat Type	<b>100% 5 Forced Warm Air</b>			3.Poor	6.	9.	
4.Cape	8.Log	12.		1.HWBB	5.FWA	9.No Heat	Attic	<b>9 None</b>			
Dwelling Units	<b>1</b>			2.HWCI	6.GravWA	10.	1.1/4 Fin	4.Full Fin	7.		
Other Units	<b>0</b>			3.H Pump	7.Electric	11.	2.1/2 Fin	5.FI/Stair	8.		
Stories	<b>4 One &amp; 1/2 Story</b>			4.Steam	8.FI/Wall	12.	3.3/4 Fin	6.	9.None		
1.1	4.1.5	7.		Cool Type	<b>0% 9 None</b>			Insulation	<b>4 Minimal</b>		
2.2	5.1.75	8.		1.Refrig	4.W&C Air	7.	1.Full	4.Minimal	7.		
3.3	6.2.5	9.		2.Evapor	5.	8.	2.Heavy	5.Partial	8.		
Exterior Walls	<b>4 Asbestos Siding</b>			3.H Pump	6.	9.None	3.Capped	6.	9.None		
1.Wood	5.Stucco	9.T-111		Kitchen Style	<b>2 Typical</b>			Unfinished %	<b>40%</b>		
2.Vin/Al	6.Brick	10.Other		1.Modern	4.Obsolete	7.	Grade & Factor	<b>2 Fair 105%</b>			
3.Compos.	7.Stone	11.		2.Typical	5.	8.	1.E Grade	4.B Grade	7.		
4.Asbestos	8.Concrete	12.		3.Old Type	6.	9.None	2.D Grade	5.A Grade	8.SC Grade		
Roof Surface	<b>1 Asphalt Shingles</b>			Bath(s) Style	<b>2 Typical Bath(s)</b>			3.C Grade	6.AA Grade	9.Same	
1.Asphalt	4.Composit	7.		1.Modern	4.Obsolete	7.	SQFT (Footprint)	<b>340</b>			
2.Slate	5.Wood	8.		2.Typical	5.	8.	Condition	<b>3 Below Average</b>			
3.Metal	6.Other	9.		3.Old Type	6.	9.None	1.Poor	4.Avg	7.V G		
SF Masonry Trim	<b>0</b>			# Rooms	<b>5</b>			2.Fair	5.Avg+	8.Exc	
OPEN-3-CUSTOM	<b>0</b>			# Bedrooms	<b>3</b>			3.Avg-	6.Good	9.Same	
OPEN-4-CUSTOM	<b>0</b>			# Full Baths	<b>1</b>			Phys. % Good	<b>0%</b>		
Year Built	<b>1920</b>			# Half Baths	<b>1</b>			Funct. % Good	<b>80%</b>		
Year Remodeled	<b>0</b>			# Addn Fixtures	<b>0</b>			Functional Code	<b>4 Delapidation</b>		
Foundation	<b>1 Concrete</b>			# Fireplaces	<b>0</b>			1.Incomp	4.Delap	7.No Power	
1.Concrete	4.Wood	7.									
2.C Block	5.Slab	8.									
3.Br/Stone	6.Piers	9.									
Basement	<b>4 Full Basement</b>										
1.1/4 Bmt	4.Full Bmt	7.									
2.1/2 Bmt	5.None	8.									
3.3/4 Bmt	6.	9.None									
Bsmt Gar # Cars	<b>0</b>										
Wet Basement	<b>3 Wet Basement</b>										
1.Dry	4.	7.									
2.Damp	5.	8.									
3.Wet	6.	9.									
Economic Code	<b>None</b>										
0.None	3.No Power	7.									
1.Location	4.Generate	8.									
2.Encroach	9.None	9.									
Entrance Code	<b>5 Estimated</b>										
1.Interior	4.Vacant	7.									
2.Refusal	5.Estimate	8.									
3.Informed	6.Reviewed	9.									
Information Code	<b>5 Estimate</b>										
1.Owner	4.Agent	7.									
2.Relative	5.Estimate	8.									
3.Tenant	6.Other	9.									

10.0'  
Shed  
10.0'  
(100)  
S/V \$50

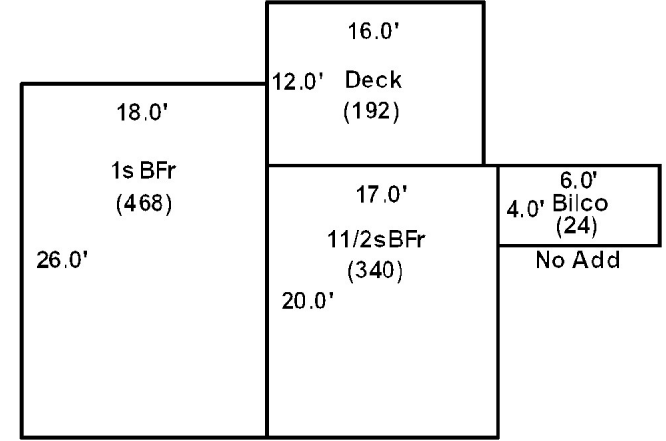

Date Inspected 7/29/2018

### Additions, Outbuildings & Improvements

Type	Year	Units	Grade	Cond	Phys.	Funct.	Sound Value
20 1 Story/Bsmt	0	468	0 0	0	0 %	0 %	
68 Wood Deck	2000	192	3 100	2	0 %	100 %	
24 Frame Shed	0				%	%	50
					%	%	
					%	%	
					%	%	
					%	%	
					%	%	
					%	%	
					%	%	
					%	%	



- 1.One Story Fram
- 2.Two Story Fram
- 3.Three Story Fr
- 4.1 & 1/2 Story
- 5.1 & 3/4 Story
- 6.2 & 1/2 Story
- 21.Open Frame Por
- 22.Encl Frame Por
- 23.Frame Garage
- 24.Frame Shed
- 25.Frame Bay Wind
- 26.1SFr Overhang
- 27.Unfin Basement
- 28.Unfinished Att
- 29.Finished Attic





**Washburn**

Map Lot 001-047

Account 502

Location CASTLE HILL ROAD

Card 1 Of 1 9/04/2024

Building Style <b>0</b>	SF Bsmt Living <b>0</b>	Layout <b>0</b>
1.Conv. 5.Garrison 9.Gambrel	Fin Bsmt Grade <b>0 0</b>	1.Typical 4. 7.
2.Ranch 6.Salt Box 10.Other	OPEN 5 OPTIONAL <b>0</b>	2.Inadeq 5. 8.
3.R Ranch 7.Contemp 11.Split	Heat Type <b>100% 0</b>	3.Poor 6. 9.
4.Cape 8.Log 12.	1.HWBB 5.FWA 9.No Heat	Attic <b>0</b>
Dwelling Units <b>0</b>	2.HWCI 6.GravWA 10.	1.1/4 Fin 4.Full Fin 7.
Other Units <b>0</b>	3.H Pump 7.Electric 11.	2.1/2 Fin 5.FI/Stair 8.
Stories <b>0</b>	4.Steam 8.FI/Wall 12.	3.3/4 Fin 6. 9.None
1.1 4.1.5 7.	Cool Type <b>0% 9 None</b>	Insulation <b>0</b>
2.2 5.1.75 8.	1.Refrig 4.W&C Air 7.	1.Full 4.Minimal 7.
3.3 6.2.5 9.	2.Evapor 5. 8.	2.Heavy 5.Partial 8.
Exterior Walls <b>0</b>	3.H Pump 6. 9.None	3.Capped 6. 9.None
1.Wood 5.Stucco 9.T-111	Kitchen Style <b>0</b>	Unfinished % <b>0%</b>
2.Vin/Al 6.Brick 10.Other	1.Modern 4.Obsolete 7.	Grade & Factor <b>0 0%</b>
3.Compos. 7.Stone 11.	2.Typical 5. 8.	1.E Grade 4.B Grade 7.
4.Asbestos 8.Concrete 12.	3.Old Type 6. 9.None	2.D Grade 5.A Grade 8.SC Grade
Roof Surface <b>0</b>	Bath(s) Style <b>0</b>	3.C Grade 6.AA Grade 9.Same
1.Asphalt 4.Composit 7.	1.Modern 4.Obsolete 7.	SQFT (Footprint) <b>0</b>
2.Slate 5.Wood 8.	2.Typical 5. 8.	Condition <b>0</b>
3.Metal 6.Other 9.	3.Old Type 6. 9.None	1.Poor 4.Avg 7.V G
SF Masonry Trim <b>0</b>	# Rooms <b>0</b>	2.Fair 5.Avg+ 8.Exc
OPEN-3-CUSTOM <b>0</b>	# Bedrooms <b>0</b>	3.Avg- 6.Good 9.Same
OPEN-4-CUSTOM <b>0</b>	# Full Baths <b>0</b>	Phys. % Good <b>0%</b>
Year Built <b>0</b>	# Half Baths <b>0</b>	Funct. % Good <b>100%</b>
Year Remodeled <b>0</b>	# Addn Fixtures <b>0</b>	Functional Code <b>9 None</b>
Foundation <b>0</b>	# Fireplaces <b>0</b>	1.Incomp 4.Delap 7.No Power
1.Concrete 4.Wood 7.		2.O-Built 5.Bsmt 8.LongTerm
2.C Block 5.Slab 8.		3.Damage 6.Common 9.None
3.Br/Stone 6.Piers 9.		Econ. % Good <b>100%</b>
Basement <b>0</b>		Economic Code <b>None</b>
1.1/4 Bmt 4.Full Bmt 7.		0.None 3.No Power 7.
2.1/2 Bmt 5.None 8.		1.Location 4.Generate 8.
3.3/4 Bmt 6. 9.None		2.Encroach 9.None 9.
Bsmt Gar # Cars <b>0</b>		Entrance Code <b>0</b>
Wet Basement <b>0</b>		1.Interior 4.Vacant 7.
1.Dry 4. 7.		2.Refusal 5.Estimate 8.
2.Damp 5. 8.	3.Informed 6.Reviewed 9.	
3.Wet 6. 9.	Information Code <b>0</b>	
		1.Owner 4.Agent 7.
		2.Relative 5.Estimate 8.
		3.Tenant 6.Other 9.

Date Inspected

Additions, Outbuildings & Improvements							
Type	Year	Units	Grade	Cond	Phys.	Funct.	Sound Value
					%	%	1.One Story Fram
					%	%	2.Two Story Fram
					%	%	3.Three Story Fr
					%	%	4.1 & 1/2 Story
					%	%	5.1 & 3/4 Story
					%	%	6.2 & 1/2 Story
					%	%	21.Open Frame Por
					%	%	22.Encl Frame Por
					%	%	23.Frame Garage
					%	%	24.Frame Shed
					%	%	25.Frame Bay Wind
					%	%	26.1SFr Overhang
					%	%	27.Unfin Basement
					%	%	28.Unfinished Att
					%	%	29.Finished Attic

PORTER FARMS, LLC  
749 Pulcifer Road  
Mapleton ME 04757

B5567P210

Previous Owner  
IRVING & MARR FARMS  
221 DAVIS STREET

WOODLAND ME 04736  
Sale Date: 7/27/2016

Inspection Witnessed By:

X	Date	Date Insp.
No./Date	Description	Date Insp.

Notes:

Washburn

Property Data			Assessment Record				
Neighborhood <b>1 Neighborhood One</b>			Year	Land	Buildings	Exempt	Total
Tree Growth Year <b>0</b>			2012	2,800	0	0	2,800
1ST MORTGAGE <b>0</b>			2013	3,600	0	0	3,600
2ND MORTGAGE <b>0</b>			2015	3,600	0	0	3,600
Zone/Land Use <b>1 Residential</b>			2018	3,600	0	0	3,600
Secondary Zone			2019	14,000	0	0	14,000
Topography <b>2 Rolling</b>			2020	14,000	0	0	14,000
1.Level 4.Below St 7.LevelBog			2021	14,000	0	0	14,000
2.Rolling 5.Low 8.			2022	14,000	0	0	14,000
3.Above St 6.Swampy 9.			2023	16,800	0	0	16,800
Utilities			2024	16,800	0	0	16,800
1.Public 4.Dr Well 7.Cesspool							
2.Water 5.Dug Well 8.							
3.Sewer 6.Septic 9.None							
Street <b>1 Paved</b>							
1.Paved 4.Proposed 7.			<b>Land Data</b>				
2.Semi Imp 5.R/O/W 8.							
3.Gravel 6. 9.None			<b>Front Foot</b>				
TG PLAN YEAR <b>0</b>							
Tif District # <b>0</b>			<b>Type</b>				
<b>Sale Data</b>							
Sale Date <b>7/27/2016</b>			<b>Effective</b>				
Price							
Sale Type <b>1 Land Only</b>			<b>Influence</b>				
1.Land 4.Mobile 7.C/I L&B							
2.L & B 5.Other 8.			<b>Influence Codes</b>				
3.Building 6.C/I Land 9.							
Financing <b>4 Seller Financed</b>			<b>Square Foot</b>				
1.Convent 4.Seller 7.							
2.FHA/VA 5.Private 8.			<b>Square Feet</b>				
3.Assumed 6.Cash 9.Unknown							
Validity <b>1 Arms Length Sale</b>			<b>Acres</b>				
1.Valid 4.Split 7.Renovate							
2.Related 5.Partial 8.Other			<b>Fract. Acre</b>				
3.Distress 6.Exempt 9.							
Verified <b>5 Public Record</b>			<b>Acres/Sites</b>				
1.Buyer 4.Agent 7.Family							
2.Seller 5.Pub Rec 8.Other			<b>Acres</b>				
3.Lender 6.MLS 9.							
			<b>Total Acreage</b> 11.00				

- 1.Unimproved
- 2.Excess Frtg
- 3.Topography
- 4.Size/Shape
- 5.Access
- 6.Restriction
- 7.Open Space
- 8.View/Environ
- 9.Fract Share
- Acres**
- 30.Utility R O W
- 31.Tillable
- 32.Pasture
- 33.Orchard
- 34.Softwood F&O
- 35.Mixed Wood F&O
- 36.Hardwood F&O
- 37.Softwood TG
- 38.Mixed Wood TG
- 39.Hardwood TG
- 40.Wasteland
- 41.Open Space
- 42.Mobile Home Si
- 43.Condo Site
- 44.Lot Improvemen
- 45.Subdivision Lo
- 46.Heavy Ind Sit

**Washburn**

Map Lot 001-048

Account 584

Location CASTLE HILL ROAD

Card 1 Of 1 9/04/2024

Building Style <b>0</b>	SF Bsmt Living <b>0</b>	Layout <b>0</b>
1.Conv. 5.Garrison 9.Gambrel	Fin Bsmt Grade <b>0 0</b>	1.Typical 4. 7.
2.Ranch 6.Salt Box 10.Other	OPEN 5 OPTIONAL <b>0</b>	2.Inadeq 5. 8.
3.R Ranch 7.Contemp 11.Split	Heat Type <b>100% 0</b>	3.Poor 6. 9.
4.Cape 8.Log 12.	1.HWBB 5.FWA 9.No Heat	Attic <b>0</b>
Dwelling Units <b>0</b>	2.HWCI 6.GravWA 10.	1.1/4 Fin 4.Full Fin 7.
Other Units <b>0</b>	3.H Pump 7.Electric 11.	2.1/2 Fin 5.FI/Stair 8.
Stories <b>0</b>	4.Steam 8.FI/Wall 12.	3.3/4 Fin 6. 9.None
1.1 4.1.5 7.	Cool Type <b>0% 9 None</b>	Insulation <b>0</b>
2.2 5.1.75 8.	1.Refrig 4.W&C Air 7.	1.Full 4.Minimal 7.
3.3 6.2.5 9.	2.Evapor 5. 8.	2.Heavy 5.Partial 8.
Exterior Walls <b>0</b>	3.H Pump 6. 9.None	3.Capped 6. 9.None
1.Wood 5.Stucco 9.T-111	Kitchen Style <b>0</b>	Unfinished % <b>0%</b>
2.Vin/Al 6.Brick 10.Other	1.Modern 4.Obsolete 7.	Grade & Factor <b>0 0%</b>
3.Compos. 7.Stone 11.	2.Typical 5. 8.	1.E Grade 4.B Grade 7.
4.Asbestos 8.Concrete 12.	3.Old Type 6. 9.None	2.D Grade 5.A Grade 8.SC Grade
Roof Surface <b>0</b>	Bath(s) Style <b>0</b>	3.C Grade 6.AA Grade 9.Same
1.Asphalt 4.Composit 7.	1.Modern 4.Obsolete 7.	SQFT (Footprint) <b>0</b>
2.Slate 5.Wood 8.	2.Typical 5. 8.	Condition <b>0</b>
3.Metal 6.Other 9.	3.Old Type 6. 9.None	1.Poor 4.Avg 7.V G
SF Masonry Trim <b>0</b>	# Rooms <b>0</b>	2.Fair 5.Avg+ 8.Exc
OPEN-3-CUSTOM <b>0</b>	# Bedrooms <b>0</b>	3.Avg- 6.Good 9.Same
OPEN-4-CUSTOM <b>0</b>	# Full Baths <b>0</b>	Phys. % Good <b>0%</b>
Year Built <b>0</b>	# Half Baths <b>0</b>	Funct. % Good <b>100%</b>
Year Remodeled <b>0</b>	# Addn Fixtures <b>0</b>	Functional Code <b>9 None</b>
Foundation <b>0</b>	# Fireplaces <b>0</b>	1.Incomp 4.Delap 7.No Power
1.Concrete 4.Wood 7.		2.O-Built 5.Bsmt 8.LongTerm
2.C Block 5.Slab 8.		3.Damage 6.Common 9.None
3.Br/Stone 6.Piers 9.		Econ. % Good <b>100%</b>
Basement <b>0</b>		Economic Code <b>None</b>
1.1/4 Bmt 4.Full Bmt 7.		0.None 3.No Power 7.
2.1/2 Bmt 5.None 8.		1.Location 4.Generate 8.
3.3/4 Bmt 6. 9.None		2.Encroach 9.None 9.
Bsmt Gar # Cars <b>0</b>		Entrance Code <b>0</b>
Wet Basement <b>0</b>		1.Interior 4.Vacant 7.
1.Dry 4. 7.		2.Refusal 5.Estimate 8.
2.Damp 5. 8.	3.Informed 6.Reviewed 9.	
3.Wet 6. 9.	Information Code <b>0</b>	
		1.Owner 4.Agent 7.
		2.Relative 5.Estimate 8.
		3.Tenant 6.Other 9.

Date Inspected

Additions, Outbuildings & Improvements								1.One Story Fram
Type	Year	Units	Grade	Cond	Phys.	Funct.	Sound Value	2.Two Story Fram
					%	%		3.Three Story Fr
					%	%		4.1 & 1/2 Story
					%	%		5.1 & 3/4 Story
					%	%		6.2 & 1/2 Story
					%	%		21.Open Frame Por
					%	%		22.Encl Frame Por
					%	%		23.Frame Garage
					%	%		24.Frame Shed
					%	%		25.Frame Bay Wind
					%	%		26.1SFr Overhang
					%	%		27.Unfin Basement
					%	%		28.Unfinished Att
					%	%		29.Finished Attic



## Washburn

Map Lot 001-049

Account 678

Location 323 CASTLE HILL ROAD

Card 1

Of 1

9/04/2024

Building Style	<b>4 Cape Cod</b>	SF Bsmt Living	0	Layout	<b>1 Typical</b>			
1.Conv.	5.Garrison	9.Gambrel	Fin Bsmt Grade	0 0	1.Typical	4.	7.	
2.Ranch	6.Salt Box	10.Other	OPEN 5 OPTIONAL	0	2.Inadeq	5.	8.	
3.R Ranch	7.Contemp	11.Split	Heat Type	<b>100%</b>	<b>1 Hot Water BB</b>	3.Pool	6.	
4.Cape	8.Log	12.	1.HWBB	5.FWA	9.No Heat	Attic	<b>9 None</b>	
Dwelling Units	<b>1</b>	2.HWCI	6.GravWA	10.	1.1/4 Fin	4.Full Fin	7.	
Other Units	<b>0</b>	3.H Pump	7.Electric	11.	2.1/2 Fin	5.FI/Stair	8.	
Stories	<b>4 One &amp; 1/2 Story</b>	4.Steam	8.FI/Wall	12.	3.3/4 Fin	6.	9.None	
1.1	4.1.5	7.	Cool Type	<b>0%</b>	<b>9 None</b>	Insulation	<b>1 Full</b>	
2.2	5.1.75	8.	1.Refrig	4.W&C Air	7.	1.Full	4.Minimal	
3.3	6.2.5	9.	2.Evapor	5.	8.	2.Heavy	5.Partial	
Exterior Walls	<b>1 Wood Siding</b>	3.H Pump	6.	9.None	3.Capped	6.	9.None	
1.Wood	5.Stucco	9.T-111	Kitchen Style	<b>2 Typical</b>	Unfinished %	<b>50%</b>		
2.Vin/Al	6.Brick	10.Other	1.Modern	4.Obsolete	7.	Grade & Factor	<b>3 Average 100%</b>	
3.Compos.	7.Stone	11.	2.Typical	5.	8.	1.E Grade	4.B Grade	
4.Asbestos	8.Concrete	12.	3.Old Type	6.	9.None	2.D Grade	5.A Grade	
Roof Surface	<b>1 Asphalt Shingles</b>	Bath(s) Style	<b>2 Typical Bath(s)</b>			3.C Grade	6.AA Grade	
1.Asphalt	4.Composit	7.	1.Modern	4.Obsolete	7.	SQFT (Footprint) <b>1584</b>		
2.Slate	5.Wood	8.	2.Typical	5.	8.	Condition	<b>4 Average</b>	
3.Metal	6.Other	9.	3.Old Type	6.	9.None	1.Poor	4.Avg	
SF Masonry Trim	<b>0</b>	# Rooms	<b>3</b>			2.Fair	5.Avg+	
OPEN-3-CUSTOM	<b>0</b>	# Bedrooms	<b>2</b>			3.Avg-	6.Good	
OPEN-4-CUSTOM	<b>0</b>	# Full Baths	<b>1</b>			Phys. % Good	<b>0%</b>	
Year Built	<b>2007</b>	# Half Baths	<b>1</b>			Funct. % Good	<b>100%</b>	
Year Remodeled	<b>0</b>	# Addn Fixtures	<b>0</b>			Functional Code	<b>9 None</b>	
Foundation	<b>5 Concrete Slab</b>	# Fireplaces	<b>0</b>			1.Incomp	4.Delap	
1.Concrete	4.Wood	7.	 <p><b>TRIO</b> Software A Division of Harris Computer Systems</p>			2.O-Built	5.Bsmt	
2.C Block	5.Slab	8.		Economic Code	<b>None</b>	0.None	3.No Power	7.
3.Br/Stone	6.Piers	9.		1.Location	4.Generate	8.	2.Encroach	9.None
Basement	<b>9 No Basement</b>			Entrance Code	<b>1 Interior Inspect</b>			
1.1/4 Bmt	4.Full Bmt	7.		1.Interior	4.Vacant	7.		
2.1/2 Bmt	5.None	8.		2.Refusal	5.Estimate	8.		
3.3/4 Bmt	6.	9.None		3.Informed	6.Reviewed	9.		
Bsmt Gar # Cars	<b>0</b>			Information Code	<b>2 Relative</b>			
Wet Basement	<b>9 No Basement</b>			1.Owner	4.Agent	7.		
1.Dry	4.	7.		2.Relative	5.Estimate	8.		
2.Damp	5.	8.	3.Tenant	6.Other	9.			
3.Wet	6.	9.						

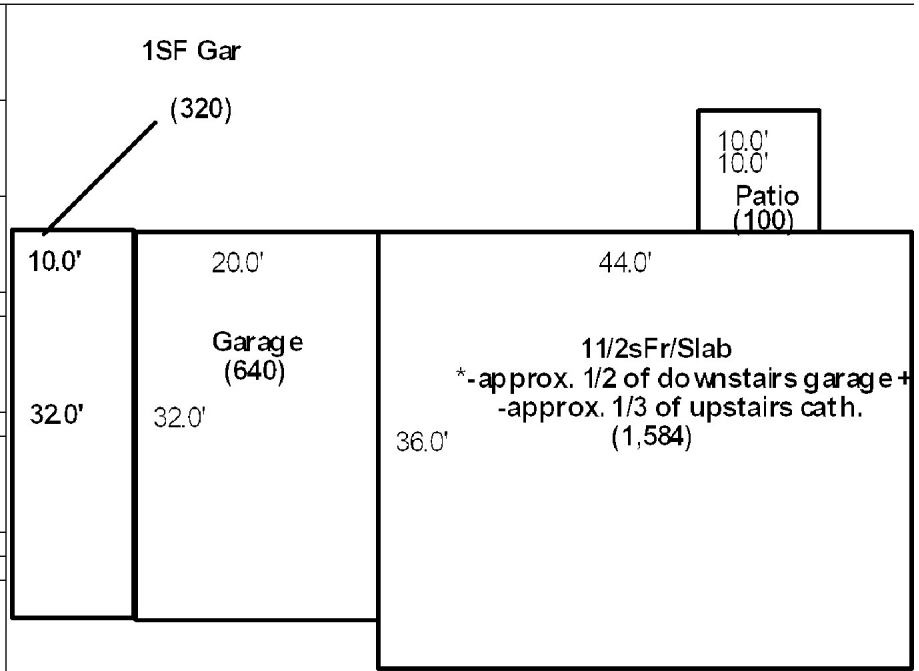

Date Inspected 7/27/2018

### Additions, Outbuildings & Improvements

Type	Year	Units	Grade	Cond	Phys.	Funct.	Sound Value
62 Patio	0	100	3 100	4	0 %	100 %	
23 Frame Garage	0	640	0 0	0	0 %	80 %	
23 Frame Garage	2021	320	3 100	4	0 %	80 %	
					%	%	
					%	%	
					%	%	
					%	%	
					%	%	
					%	%	
					%	%	
					%	%	





**Washburn**

Map Lot 001-050

Account 311

Location Castle Hill Road

Card 1 Of 1 9/04/2024

Building Style <b>0</b>	SF Bsmt Living <b>0</b>	Layout <b>0</b>
1.Conv. 5.Garrison 9.Gambrel	Fin Bsmt Grade <b>0 0</b>	1.Typical 4. 7.
2.Ranch 6.Salt Box 10.Other	OPEN 5 OPTIONAL <b>0</b>	2.Inadeq 5. 8.
3.R Ranch 7.Contemp 11.Split	Heat Type <b>100% 0</b>	3.Poor 6. 9.
4.Cape 8.Log 12.	1.HWBB 5.FWA 9.No Heat	Attic <b>0</b>
Dwelling Units <b>0</b>	2.HWCI 6.GravWA 10.	1.1/4 Fin 4.Full Fin 7.
Other Units <b>0</b>	3.H Pump 7.Electric 11.	2.1/2 Fin 5.FI/Stair 8.
Stories <b>0</b>	4.Steam 8.FI/Wall 12.	3.3/4 Fin 6. 9.None
1.1 4.1.5 7.	Cool Type <b>0% 9 None</b>	Insulation <b>0</b>
2.2 5.1.75 8.	1.Refrig 4.W&C Air 7.	1.Full 4.Minimal 7.
3.3 6.2.5 9.	2.Evapor 5. 8.	2.Heavy 5.Partial 8.
Exterior Walls <b>0</b>	3.H Pump 6. 9.None	3.Capped 6. 9.None
1.Wood 5.Stucco 9.T-111	Kitchen Style <b>0</b>	Unfinished % <b>0%</b>
2.Vin/Al 6.Brick 10.Other	1.Modern 4.Obsolete 7.	Grade & Factor <b>0 0%</b>
3.Compos. 7.Stone 11.	2.Typical 5. 8.	1.E Grade 4.B Grade 7.
4.Asbestos 8.Concrete 12.	3.Old Type 6. 9.None	2.D Grade 5.A Grade 8.SC Grade
Roof Surface <b>0</b>	Bath(s) Style <b>0</b>	3.C Grade 6.AA Grade 9.Same
1.Asphalt 4.Composit 7.	1.Modern 4.Obsolete 7.	SQFT (Footprint) <b>0</b>
2.Slate 5.Wood 8.	2.Typical 5. 8.	Condition <b>0</b>
3.Metal 6.Other 9.	3.Old Type 6. 9.None	1.Poor 4.Avg 7.V G
SF Masonry Trim <b>0</b>	# Rooms <b>0</b>	2.Fair 5.Avg+ 8.Exc
OPEN-3-CUSTOM <b>0</b>	# Bedrooms <b>0</b>	3.Avg- 6.Good 9.Same
OPEN-4-CUSTOM <b>0</b>	# Full Baths <b>0</b>	Phys. % Good <b>0%</b>
Year Built <b>0</b>	# Half Baths <b>0</b>	Funct. % Good <b>100%</b>
Year Remodeled <b>0</b>	# Addn Fixtures <b>0</b>	Functional Code <b>9 None</b>
Foundation <b>0</b>	# Fireplaces <b>0</b>	1.Incomp 4.Delap 7.No Power
1.Concrete 4.Wood 7.		2.O-Built 5.Bsmt 8.LongTerm
2.C Block 5.Slab 8.		3.Damage 6.Common 9.None
3.Br/Stone 6.Piers 9.		Econ. % Good <b>100%</b>
Basement <b>0</b>		Economic Code <b>None</b>
1.1/4 Bmt 4.Full Bmt 7.		0.None 3.No Power 7.
2.1/2 Bmt 5.None 8.		1.Location 4.Generate 8.
3.3/4 Bmt 6. 9.None		2.Encroach 9.None 9.
Bsmt Gar # Cars <b>0</b>		Entrance Code <b>0</b>
Wet Basement <b>0</b>		1.Interior 4.Vacant 7.
1.Dry 4. 7.		2.Refusal 5.Estimate 8.
2.Damp 5. 8.	3.Informed 6.Reviewed 9.	
3.Wet 6. 9.	Information Code <b>0</b>	
	1.Owner 4.Agent 7.	
	2.Relative 5.Estimate 8.	
	3.Tenant 6.Other 9.	

Date Inspected

**Additions, Outbuildings & Improvements**

Type	Year	Units	Grade	Cond	Phys.	Funct.	Sound Value
					%	%	1.One Story Fram
					%	%	2.Two Story Fram
					%	%	3.Three Story Fr
					%	%	4.1 & 1/2 Story
					%	%	5.1 & 3/4 Story
					%	%	6.2 & 1/2 Story
					%	%	21.Open Frame Por
					%	%	22.Encl Frame Por
					%	%	23.Frame Garage
					%	%	24.Frame Shed
					%	%	25.Frame Bay Wind
					%	%	26.1SFr Overhang
					%	%	27.Unfin Basement
					%	%	28.Unfinished Att
					%	%	29.Finished Attic