

KCH LIMITED PARTNERSHIP
76 Turnpike Road
Willington CT 06279

B2341P123

Inspection Witnessed By:

No./Date	Description	Date Insp.
X		

Notes:

Washburn

Property Data			Assessment Record						
Neighborhood 1 Neighborhood One			Year	Land	Buildings	Exempt	Total		
Tree Growth Year 0			2012	16,700	0	0	16,700		
1ST MORTGAGE 0			2013	21,600	0	0	21,600		
2ND MORTGAGE 0			2015	21,600	0	0	21,600		
Zone/Land Use 1 Residential			2018	21,600	0	0	21,600		
Secondary Zone			2019	49,000	0	0	49,000		
Topography 2 Rolling			2020	49,000	0	0	49,000		
1.Level 4.Below St 7.LevelBog			2021	49,000	0	0	49,000		
2.Rolling 5.Low 8.			2022	49,000	0	0	49,000		
3.Above St 6.Swampy 9.			2023	51,600	0	0	51,600		
Utilities			2024	51,600	0	0	51,600		
1.Public 4.Dr Well 7.Cesspool									
2.Water 5.Dug Well 8.									
3.Sewer 6.Septic 9.None									
Street 1 Paved									
1.Paved 4.Proposed 7.									
2.Semi Imp 5.R/O/W 8.									
3.Gravel 6. 9.None									
TG PLAN YEAR 0									
Tif District # 0									
Sale Data			Land Data						
Sale Date 2/05/1991			Front Foot	Type	Effective		Influence		Influence Codes
Price					Frontage	Depth	Factor	Code	
Sale Type 1 Land Only			11.Regular Lot					1.Unimproved	
1.Land 4.Mobile 7.C/I L&B			12.Delta Triangle					2.Excess Frtg	
2.L & B 5.Other 8.			13.Nabla Triangle					3.Topography	
3.Building 6.C/I Land 9.			14.Rear Land					4.Size/Shape	
Financing			15.Class I Road					5.Access	
1.Convent 4.Seller 7.								6.Restriction	
2.FHA/VA 5.Private 8.								7.Open Space	
3.Assumed 6.Cash 9.Unknown								8.View/Environ	
Validity 1 Arms Length Sale								9.Fract Share	
1.Valid 4.Split 7.Renovate			Square Foot	Square Feet				Acres	
2.Related 5.Partial 8.Other			16.Class II Road					30.Utility R O W	
3.Distress 6.Exempt 9.			17.Municipal Rese					31.Tillable	
Verified 5 Public Record			18.Munic Sep Lago					32.Pasture	
1.Buyer 4.Agent 7.Family			19.Gravel Pit					33.Orchard	
2.Seller 5.Pub Rec 8.Other			20.Industrial Bas					34.Softwood F&O	
3.Lender 6.MLS 9.								35.Mixed Wood F&O	
			Fract. Acre	Acreege/Sites				36.Hardwood F&O	
			21.Developed Pave	22	1.00	100	%	0	
			22.Undev Paved (F	28	8.00	100	%	0	
			23.Developed Grav	31	36.00	100	%	0	
			Acres						
			24.Undev Gravel (%	
			25.Comm Base Pave					%	
			26.Comm Base Grav					%	
			27.Backlot					%	
			28.Rear Land					%	
			29.Pavement					%	
			Total Acreege		45.00				
								44.Lot Improvemen	
								45.Subdivision Lo	
								46.Heavy Ind Sit	

Washburn

Map Lot 001-001

Account 572

Location WASHBURN ROAD

Card 1 Of 1 9/04/2024

Building Style 0	SF Bsmt Living 0	Layout 0
1.Conv. 5.Garrison 9.Gambrel	Fin Bsmt Grade 0 0	1.Typical 4. 7.
2.Ranch 6.Salt Box 10.Other	OPEN 5 OPTIONAL 0	2.Inadeq 5. 8.
3.R Ranch 7.Contemp 11.Split	Heat Type 100% 0	3.Poor 6. 9.
4.Cape 8.Log 12.	1.HWBB 5.FWA 9.No Heat	Attic 0
Dwelling Units 0	2.HWCI 6.GravWA 10.	1.1/4 Fin 4.Full Fin 7.
Other Units 0	3.H Pump 7.Electric 11.	2.1/2 Fin 5.FI/Stair 8.
Stories 0	4.Steam 8.FI/Wall 12.	3.3/4 Fin 6. 9.None
1.1 4.1.5 7.	Cool Type 0% 9 None	Insulation 0
2.2 5.1.75 8.	1.Refrig 4.W&C Air 7.	1.Full 4.Minimal 7.
3.3 6.2.5 9.	2.Evapor 5. 8.	2.Heavy 5.Partial 8.
Exterior Walls 0	3.H Pump 6. 9.None	3.Capped 6. 9.None
1.Wood 5.Stucco 9.T-111	Kitchen Style 0	Unfinished % 0%
2.Vin/Al 6.Brick 10.Other	1.Modern 4.Obsolete 7.	Grade & Factor 0 0%
3.Compos. 7.Stone 11.	2.Typical 5. 8.	1.E Grade 4.B Grade 7.
4.Asbestos 8.Concrete 12.	3.Old Type 6. 9.None	2.D Grade 5.A Grade 8.SC Grade
Roof Surface 0	Bath(s) Style 0	3.C Grade 6.AA Grade 9.Same
1.Asphalt 4.Composit 7.	1.Modern 4.Obsolete 7.	SQFT (Footprint) 0
2.Slate 5.Wood 8.	2.Typical 5. 8.	Condition 0
3.Metal 6.Other 9.	3.Old Type 6. 9.None	1.Poor 4.Avg 7.V G
SF Masonry Trim 0	# Rooms 0	2.Fair 5.Avg+ 8.Exc
OPEN-3-CUSTOM 0	# Bedrooms 0	3.Avg- 6.Good 9.Same
OPEN-4-CUSTOM 0	# Full Baths 0	Phys. % Good 0%
Year Built 0	# Half Baths 0	Funct. % Good 100%
Year Remodeled 0	# Addn Fixtures 0	Functional Code 9 None
Foundation 0	# Fireplaces 0	1.Incomp 4.Delap 7.No Power
1.Concrete 4.Wood 7.		2.O-Built 5.Bsmt 8.LongTerm
2.C Block 5.Slab 8.		3.Damage 6.Common 9.None
3.Br/Stone 6.Piers 9.		Econ. % Good 100%
Basement 0		Economic Code None
1.1/4 Bmt 4.Full Bmt 7.		0.None 3.No Power 7.
2.1/2 Bmt 5.None 8.		1.Location 4.Generate 8.
3.3/4 Bmt 6. 9.None		2.Encroach 9.None 9.
Bsmt Gar # Cars 0		Entrance Code 0
Wet Basement 0		1.Interior 4.Vacant 7.
1.Dry 4. 7.		2.Refusal 5.Estimate 8.
2.Damp 5. 8.	3.Informed 6.Reviewed 9.	
3.Wet 6. 9.	Information Code 0	
		1.Owner 4.Agent 7.
		2.Relative 5.Estimate 8.
		3.Tenant 6.Other 9.

Date Inspected

Additions, Outbuildings & Improvements

Type	Year	Units	Grade	Cond	Phys.	Funct.	Sound Value
					%	%	1.One Story Fram
					%	%	2.Two Story Fram
					%	%	3.Three Story Fr
					%	%	4.1 & 1/2 Story
					%	%	5.1 & 3/4 Story
					%	%	6.2 & 1/2 Story
					%	%	21.Open Frame Por
					%	%	22.Encl Frame Por
					%	%	23.Frame Garage
					%	%	24.Frame Shed
					%	%	25.Frame Bay Wind
					%	%	26.1SFr Overhang
					%	%	27.Unfin Basement
					%	%	28.Unfinished Att
					%	%	29.Finished Attic

McCRUM LAND, LLC
P.O. BOX 660
MARS HILL ME 04758

B5197P62

Previous Owner
Howard, Gertrude J.
Howard, Gary G.
Howard, George P.
Washburn ME 04786
Sale Date: 6/20/2013

Inspection Witnessed By:

No./Date	Description	Date Insp.
X		

Notes:

Washburn

Property Data			Assessment Record						
Neighborhood 1 Neighborhood One			Year	Land	Buildings	Exempt	Total		
Tree Growth Year 0			2012	17,300	0	0	17,300		
1ST MORTGAGE 0			2013	22,500	0	0	22,500		
2ND MORTGAGE 0			2015	22,500	0	0	22,500		
Zone/Land Use 1 Residential			2018	22,500	0	0	22,500		
Secondary Zone			2019	41,000	0	0	41,000		
Topography 2 Rolling			2020	41,000	0	0	41,000		
1.Level 4.Below St 7.LevelBog			2021	41,000	0	0	41,000		
2.Rolling 5.Low 8.			2022	41,000	0	0	41,000		
3.Above St 6.Swampy 9.			2023	43,000	0	0	43,000		
Utilities			2024	43,000	0	0	43,000		
1.Public 4.Dr Well 7.Cesspool									
2.Water 5.Dug Well 8.									
3.Sewer 6.Septic 9.None									
Street 1 Paved									
1.Paved 4.Proposed 7.									
2.Semi Imp 5.R/O/W 8.									
3.Gravel 6. 9.None									
TG PLAN YEAR 0									
Tif District # 0									
Sale Data			Land Data						
Sale Date 6/20/2013			Front Foot	Type	Effective		Influence		Influence Codes
Price					Frontage	Depth	Factor	Code	
Sale Type 1 Land Only			11.Regular Lot					1.Unimproved	
1.Land 4.Mobile 7.C/I L&B			12.Delta Triangle					2.Excess Frtg	
2.L & B 5.Other 8.			13.Nabla Triangle					3.Topography	
3.Building 6.C/I Land 9.			14.Rear Land					4.Size/Shape	
Financing 4 Seller Financed			15.Class I Road					5.Access	
1.Convent 4.Seller 7.								6.Restriction	
2.FHA/VA 5.Private 8.								7.Open Space	
3.Assumed 6.Cash 9.Unknown								8.View/Environ	
Validity 1 Arms Length Sale								9.Fract Share	
1.Valid 4.Split 7.Renovate			Square Foot	Square Feet				Acres	
2.Related 5.Partial 8.Other			16.Class II Road					30.Utility R O W	
3.Distress 6.Exempt 9.			17.Municipal Rese					31.Tillable	
Verified 5 Public Record			18.Munic Sep Lago					32.Pasture	
1.Buyer 4.Agent 7.Family			19.Gravel Pit					33.Orchard	
2.Seller 5.Pub Rec 8.Other			20.Industrial Bas					34.Softwood F&O	
3.Lender 6.MLS 9.								35.Mixed Wood F&O	
			Fract. Acre	Acres/Sites				36.Hardwood F&O	
			21.Developed Pave	22	1.00	100	%	0	
			22.Undev Paved (F	31	32.00	100	%	0	
			23.Developed Grav						
			Acres						
			24.Undev Gravel (
			25.Comm Base Pave						
			26.Comm Base Grav						
			27.Backlot						
			28.Rear Land						
			29.Pavement						
			Total Acreage		33.00				
							44.Lot Improvemen		
							45.Subdivision Lo		
							46.Heavy Ind Sit		

Washburn

Map Lot 001-002

Account 507

Location WASHBURN ROAD

Card 1 Of 1 9/04/2024

Building Style 0	SF Bsmt Living 0	Layout 0			
1.Conv. 5.Garrison 9.Gambrel	Fin Bsmt Grade 0 0	1.Typical 4. 7.			
2.Ranch 6.Salt Box 10.Other	OPEN 5 OPTIONAL 0	2.Inadeq 5. 8.			
3.R Ranch 7.Contemp 11.Split	Heat Type 100% 0	3.Poor 6. 9.			
4.Cape 8.Log 12.	1.HWBB 5.FWA 9.No Heat	Attic 0			
Dwelling Units 0	2.HWCI 6.GravWA 10.	1.1/4 Fin 4.Full Fin 7.			
Other Units 0	3.H Pump 7.Electric 11.	2.1/2 Fin 5.FI/Stair 8.			
Stories 0	4.Steam 8.FI/Wall 12.	3.3/4 Fin 6. 9.None			
1.1 4.1.5 7.	Cool Type 0% 9 None	Insulation 0			
2.2 5.1.75 8.	1.Refrig 4.W&C Air 7.	1.Full 4.Minimal 7.			
3.3 6.2.5 9.	2.Evapor 5. 8.	2.Heavy 5.Partial 8.			
Exterior Walls 0	3.H Pump 6. 9.None	3.Capped 6. 9.None			
1.Wood 5.Stucco 9.T-111	Kitchen Style 0	Unfinished % 0%			
2.Vin/Al 6.Brick 10.Other	1.Modern 4.Obsolete 7.	Grade & Factor 0 0%			
3.Compos. 7.Stone 11.	2.Typical 5. 8.	1.E Grade 4.B Grade 7.			
4.Asbestos 8.Concrete 12.	3.Old Type 6. 9.None	2.D Grade 5.A Grade 8.SC Grade			
Roof Surface 0	Bath(s) Style 0	3.C Grade 6.AA Grade 9.Same			
1.Asphalt 4.Composit 7.	1.Modern 4.Obsolete 7.	SQFT (Footprint) 0			
2.Slate 5.Wood 8.	2.Typical 5. 8.	Condition 0			
3.Metal 6.Other 9.	3.Old Type 6. 9.None	1.Poor 4.Avg 7.V G			
SF Masonry Trim 0	# Rooms 0	2.Fair 5.Avg+ 8.Exc			
OPEN-3-CUSTOM 0	# Bedrooms 0	3.Avg- 6.Good 9.Same			
OPEN-4-CUSTOM 0	# Full Baths 0	Phys. % Good 0%			
Year Built 0	# Half Baths 0	Funct. % Good 100%			
Year Remodeled 0	# Addn Fixtures 0	Functional Code 9 None			
Foundation 0	# Fireplaces 0	1.Incomp 4.Delap 7.No Power			
1.Concrete 4.Wood 7.		2.O-Built 5.Bsmt 8.LongTerm			
2.C Block 5.Slab 8.		3.Damage 6.Common 9.None			
3.Br/Stone 6.Piers 9.		Econ. % Good 100%			
Basement 0		Economic Code None			
1.1/4 Bmt 4.Full Bmt 7.		0.None 3.No Power 7.			
2.1/2 Bmt 5.None 8.		1.Location 4.Generate 8.			
3.3/4 Bmt 6. 9.None		2.Encroach 9.None 9.			
Bsmt Gar # Cars 0		Entrance Code 0			
Wet Basement 0		1.Interior 4.Vacant 7.			
1.Dry 4. 7.		2.Refusal 5.Estimate 8.			
2.Damp 5. 8.		3.Informed 6.Reviewed 9.			
3.Wet 6. 9.		Information Code 0			
		1.Owner 4.Agent 7.			
		2.Relative 5.Estimate 8.			
		3.Tenant 6.Other 9.			



Date Inspected

Additions, Outbuildings & Improvements								
Type	Year	Units	Grade	Cond	Phys.	Funct.	Sound Value	
					%	%		1.One Story Fram
					%	%		2.Two Story Fram
					%	%		3.Three Story Fr
					%	%		4.1 & 1/2 Story
					%	%		5.1 & 3/4 Story
					%	%		6.2 & 1/2 Story
					%	%		21.Open Frame Por
					%	%		22.Encl Frame Por
					%	%		23.Frame Garage
					%	%		24.Frame Shed
					%	%		25.Frame Bay Wind
					%	%		26.1SFr Overhang
					%	%		27.Unfin Basement
					%	%		28.Unfinished Att
					%	%		29.Finished Attic

Washburn

Map Lot 001-003

Account 128

Location 995 WASHBURN ROAD

Card 1

Of 1

9/04/2024

Building Style 2 Ranch	SF Bsmt Living 0	Layout 1 Typical
1.Conv. 5.Garrison 9.Gambrel	Fin Bsmt Grade 0 0	1.Typical 4. 7.
2.Ranch 6.Salt Box 10.Other	OPEN 5 OPTIONAL 0	2.Inadeq 5. 8.
3.R Ranch 7.Contemp 11.Split	Heat Type 100% 5 Forced Warm Air	3.Poor 6. 9.
4.Cape 8.Log 12.	1.HWBB 5.FWA 9.No Heat	Attic 9 None
Dwelling Units 1	2.HWCI 6.GravWA 10.	1.1/4 Fin 4.Full Fin 7.
Other Units 0	3.H Pump 7.Electric 11.	2.1/2 Fin 5.F/Stair 8.
Stories 1 One Story	4.Steam 8.F/Wall 12.	3.3/4 Fin 6. 9.None
1.1 4.1.5 7.	Cool Type 0% 9 None	Insulation 1 Full
2.2 5.1.75 8.	1.Refrig 4.W&C Air 7.	1.Full 4.Minimal 7.
3.3 6.2.5 9.	2.Evapor 5. 8.	2.Heavy 5.Partial 8.
Exterior Walls 4 Asbestos Siding	3.H Pump 6. 9.None	3.Capped 6. 9.None
1.Wood 5.Stucco 9.T-111	Kitchen Style 2 Typical	Unfinished % 0%
2.Vin/Al 6.Brick 10.Other	1.Modern 4.Obsolete 7.	Grade & Factor 3 Average 90%
3.Compos. 7.Stone 11.	2.Typical 5. 8.	1.E Grade 4.B Grade 7.
4.Asbestos 8.Concrete 12.	3.Old Type 6. 9.None	2.D Grade 5.A Grade 8.SC Grade
Roof Surface 1 Asphalt Shingles	Bath(s) Style 2 Typical Bath(s)	3.C Grade 6.AA Grade 9.Same
1.Asphalt 4.Composit 7.	1.Modern 4.Obsolete 7.	SQFT (Footprint) 1728
2.Slate 5.Wood 8.	2.Typical 5. 8.	Condition 3 Below Average
3.Metal 6.Other 9.	3.Old Type 6. 9.None	1.Poor 4.Avg 7.V G
SF Masonry Trim 0	# Rooms 6	2.Fair 5.Avg+ 8.Exc
OPEN-3-CUSTOM 0	# Bedrooms 4	3.Avg- 6.Good 9.Same
OPEN-4-CUSTOM 0	# Full Baths 1	Phys. % Good 0%
Year Built 1965	# Half Baths 0	Funct. % Good 85%
Year Remodeled 0	# Addn Fixtures 0	Functional Code 4 Delapidation
Foundation 1 Concrete	# Fireplaces 0	1.Incomp 4.Delap 7.No Power
1.Concrete 4.Wood 7.	 <p>TRIO Software A Division of Harris Computer Systems</p>	2.O-Built 5.Bsmt 8.LongTerm
2.C Block 5.Slab 8.		3.Damage 6.Common 9.None
3.Br/Stone 6.Piers 9.		Econ. % Good 100%
Basement 4 Full Basement		Economic Code None
1.1/4 Bmt 4.Full Bmt 7.		0.None 3.No Power 7.
2.1/2 Bmt 5.None 8.		1.Location 4.Generate 8.
3.3/4 Bmt 6. 9.None		2.Encroach 9.None 9.
Bsmt Gar # Cars 0		Entrance Code 3 Information Only
Wet Basement 2 Damp Basement		1.Interior 4.Vacant 7.
1.Dry 4. 7.		2.Refusal 5.Estimate 8.
2.Damp 5. 8.	3.Informed 6.Reviewed 9.	
3.Wet 6. 9.	Information Code 1 Owner	
		1.Owner 4.Agent 7.
		2.Relative 5.Estimate 8.
		3.Tenant 6.Other 9.

Date Inspected 7/25/2018

Additions, Outbuildings & Improvements

Type	Year	Units	Grade	Cond	Phys.	Funct.	Sound Value
40 Basement Entry	0	25	0 0	0	0 %	0 %	
23 Frame Garage	1980	560	9 100	9	0 %	80 %	
1 One Story Frame	1986	320	3 100	3	0 %	100 %	
21 Open Frame	1986	128	3 95	4	0 %	100 %	
					%	%	
					%	%	
					%	%	
					%	%	
					%	%	
					%	%	
					%	%	

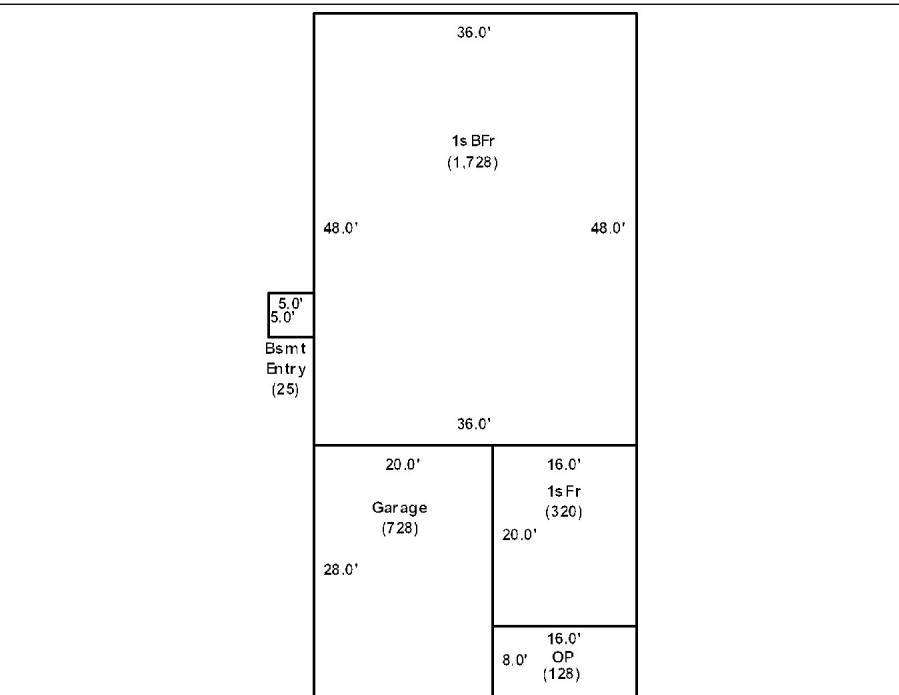

TOWERS NORTH, INC.
P.O. BOX 596
BANGOR ME 04402

B3720P1

Inspection Witnessed By:

No./Date	Description	Date Insp.
X		

Notes:

Washburn

Property Data			Assessment Record						
Neighborhood 1 Neighborhood One			Year	Land	Buildings	Exempt	Total		
Tree Growth Year 0			2012	3,200	0	0	3,200		
1ST MORTGAGE 0			2013	4,200	0	0	4,200		
2ND MORTGAGE 0			2015	4,200	0	0	4,200		
Zone/Land Use 1 Residential			2018	4,200	0	0	4,200		
Secondary Zone			2019	6,400	0	0	6,400		
Topography 2 Rolling			2020	6,400	0	0	6,400		
1.Level 4.Below St 7.LevelBog			2021	6,400	0	0	6,400		
2.Rolling 5.Low 8.			2022	6,400	0	0	6,400		
3.Above St 6.Swampy 9.			2023	7,800	0	0	7,800		
Utilities			2024	7,800	0	0	7,800		
1.Public 4.Dr Well 7.Cesspool									
2.Water 5.Dug Well 8.									
3.Sewer 6.Septic 9.None									
Street 1 Paved									
1.Paved 4.Proposed 7.									
2.Semi Imp 5.R/O/W 8.									
3.Gravel 6. 9.None									
TG PLAN YEAR 0									
Tif District # 0									
Sale Data			Land Data						
Sale Date 10/09/2002			Front Foot	Type	Effective		Influence		Influence Codes
Price					Frontage	Depth	Factor	Code	
Sale Type 1 Land Only			11.Regular Lot					1.Unimproved	
1.Land 4.Mobile 7.C/I L&B			12.Delta Triangle					2.Excess Frtg	
2.L & B 5.Other 8.			13.Nabla Triangle					3.Topography	
3.Building 6.C/I Land 9.			14.Rear Land					4.Size/Shape	
Financing			15.Class I Road					5.Access	
1.Convent 4.Seller 7.								6.Restriction	
2.FHA/VA 5.Private 8.								7.Open Space	
3.Assumed 6.Cash 9.Unknown								8.View/Environ	
Validity 1 Arms Length Sale								9.Fract Share	
1.Valid 4.Split 7.Renovate			Square Foot	Square Feet				Acres	
2.Related 5.Partial 8.Other			16.Class II Road					30.Utility R O W	
3.Distress 6.Exempt 9.			17.Municipal Rese					31.Tillable	
Verified 5 Public Record			18.Munic Sep Lago					32.Pasture	
1.Buyer 4.Agent 7.Family			19.Gravel Pit					33.Orchard	
2.Seller 5.Pub Rec 8.Other			20.Industrial Bas					34.Softwood F&O	
3.Lender 6.MLS 9.			Fract. Acre	Acres/Sites				35.Mixed Wood F&O	
			21.Developed Pave	22	0.50	100	%	0	
			22.Undev Paved (F					36.Hardwood F&O	
			23.Developed Grav					37.Softwood TG	
			Acres					38.Mixed Wood TG	
			24.Undev Gravel (39.Hardwood TG	
			25.Comm Base Pave					40.Wasteland	
			26.Comm Base Grav					41.Open Space	
			27.Backlot					42.Mobile Home Si	
			28.Rear Land					43.Condo Site	
			29.Pavement					44.Lot Improvemen	
				Total Acreage			0.50	45.Subdivision Lo	
								46.Heavy Ind Sit	

Washburn

Map Lot 001-004

Account 923

Location WASHBURN ROAD

Card 1 Of 1 9/04/2024

Building Style 0	SF Bsmt Living 0	Layout 0
1.Conv. 5.Garrison 9.Gambrel	Fin Bsmt Grade 0 0	1.Typical 4. 7.
2.Ranch 6.Salt Box 10.Other	OPEN 5 OPTIONAL 0	2.Inadeq 5. 8.
3.R Ranch 7.Contemp 11.Split	Heat Type 100% 0	3.Poor 6. 9.
4.Cape 8.Log 12.	1.HWBB 5.FWA 9.No Heat	Attic 0
Dwelling Units 0	2.HWCI 6.GravWA 10.	1.1/4 Fin 4.Full Fin 7.
Other Units 0	3.H Pump 7.Electric 11.	2.1/2 Fin 5.FI/Stair 8.
Stories 0	4.Steam 8.FI/Wall 12.	3.3/4 Fin 6. 9.None
1.1 4.1.5 7.	Cool Type 0% 9 None	Insulation 0
2.2 5.1.75 8.	1.Refrig 4.W&C Air 7.	1.Full 4.Minimal 7.
3.3 6.2.5 9.	2.Evapor 5. 8.	2.Heavy 5.Partial 8.
Exterior Walls 0	3.H Pump 6. 9.None	3.Capped 6. 9.None
1.Wood 5.Stucco 9.T-111	Kitchen Style 0	Unfinished % 0%
2.Vin/Al 6.Brick 10.Other	1.Modern 4.Obsolete 7.	Grade & Factor 0 0%
3.Compos. 7.Stone 11.	2.Typical 5. 8.	1.E Grade 4.B Grade 7.
4.Asbestos 8.Concrete 12.	3.Old Type 6. 9.None	2.D Grade 5.A Grade 8.SC Grade
Roof Surface 0	Bath(s) Style 0	3.C Grade 6.AA Grade 9.Same
1.Asphalt 4.Composit 7.	1.Modern 4.Obsolete 7.	SQFT (Footprint) 0
2.Slate 5.Wood 8.	2.Typical 5. 8.	Condition 0
3.Metal 6.Other 9.	3.Old Type 6. 9.None	1.Poor 4.Avg 7.V G
SF Masonry Trim 0	# Rooms 0	2.Fair 5.Avg+ 8.Exc
OPEN-3-CUSTOM 0	# Bedrooms 0	3.Avg- 6.Good 9.Same
OPEN-4-CUSTOM 0	# Full Baths 0	Phys. % Good 0%
Year Built 0	# Half Baths 0	Funct. % Good 100%
Year Remodeled 0	# Addn Fixtures 0	Functional Code 9 None
Foundation 0	# Fireplaces 0	1.Incomp 4.Delap 7.No Power
1.Concrete 4.Wood 7.	 <p>TRIO Software A Division of Harris Computer Systems</p>	2.O-Built 5.Bsmt 8.LongTerm
2.C Block 5.Slab 8.		3.Damage 6.Common 9.None
3.Br/Stone 6.Piers 9.		Econ. % Good 100%
Basement 0		Economic Code None
1.1/4 Bmt 4.Full Bmt 7.		0.None 3.No Power 7.
2.1/2 Bmt 5.None 8.		1.Location 4.Generate 8.
3.3/4 Bmt 6. 9.None		2.Encroach 9.None 9.
Bsmt Gar # Cars 0		Entrance Code 5 Estimated
Wet Basement 0		1.Interior 4.Vacant 7.
1.Dry 4. 7.		2.Refusal 5.Estimate 8.
2.Damp 5. 8.	3.Informed 6.Reviewed 9.	
3.Wet 6. 9.	Information Code 5 Estimate	
		1.Owner 4.Agent 7.
		2.Relative 5.Estimate 8.
		3.Tenant 6.Other 9.

Date Inspected 7/25/2018

Additions, Outbuildings & Improvements								
Type	Year	Units	Grade	Cond	Phys.	Funct.	Sound Value	
					%	%		1.One Story Fram
					%	%		2.Two Story Fram
					%	%		3.Three Story Fr
					%	%		4.1 & 1/2 Story
					%	%		5.1 & 3/4 Story
					%	%		6.2 & 1/2 Story
					%	%		21.Open Frame Por
					%	%		22.Encl Frame Por
					%	%		23.Frame Garage
					%	%		24.Frame Shed
					%	%		25.Frame Bay Wind
					%	%		26.1SFr Overhang
					%	%		27.Unfin Basement
					%	%		28.Unfinished Att
					%	%		29.Finished Attic

TOWERS NORTH, INC.
P.O. BOX 596
BANGOR ME 04402

B4847P78

Previous Owner
Time Warner N.Y. Cable LLC
P.O. Box 7467

Charlotte NC 28241 7467
Sale Date: 7/20/2010

Previous Owner
Frontier Vision/Adelphia
CBIZ Property Tax Sol. Inc
P.O. Box 2798
Littleton CO
Sale Date: 7/31/2006

Inspection Witnessed By:

X	Date	Date Insp.
No./Date	Description	Date Insp.

Notes:

Washburn

Property Data			Assessment Record						
Neighborhood 1 Neighborhood One			Year	Land	Buildings	Exempt	Total		
Tree Growth Year 0			2012	3,200	1,000	0	4,200		
1ST MORTGAGE 0			2013	4,200	1,000	0	5,200		
2ND MORTGAGE 0			2015	4,200	1,000	0	5,200		
Zone/Land Use 1 Residential			2018	4,200	1,000	0	5,200		
Secondary Zone			2019	6,400	1,000	0	7,400		
Topography 3 Above Street			2020	6,400	1,000	0	7,400		
1.Level 4.Below St 7.LevelBog			2021	6,400	1,000	0	7,400		
2.Rolling 5.Low 8.			2022	6,400	1,000	0	7,400		
3.Above St 6.Swampy 9.			2023	7,800	1,000	0	8,800		
Utilities			2024	7,800	1,000	0	8,800		
1.Public 4.Dr Well 7.Cesspool									
2.Water 5.Dug Well 8.									
3.Sewer 6.Septic 9.None									
Street 1 Paved									
1.Paved 4.Proposed 7.			Land Data						
2.Semi Imp 5.R/O/W 8.			Front Foot	Type	Effective		Influence		Influence Codes
3.Gravel 6. 9.None					Frontage	Depth	Factor	Code	
TG PLAN YEAR 0			11.Regular Lot					1.Unimproved	
Tif District # 0			12.Delta Triangle					2.Excess Frtg	
Sale Data			13.Nabla Triangle					3.Topography	
Sale Date 7/27/2010			14.Rear Land					4.Size/Shape	
Price 9,457			15.Class I Road					5.Access	
Sale Type 2 Land & Buildings								6.Restriction	
1.Land 4.Mobile 7.C/I L&B			Square Foot	Square Feet				7.Open Space	
2.L & B 5.Other 8.								8.View/Environ	
3.Building 6.C/I Land 9.			16.Class II Road					9.Fract Share	
Financing			17.Municipal Rese					Acres	
1.Convent 4.Seller 7.			18.Munic Sep Lago					30.Utility R O W	
2.FHA/VA 5.Private 8.			19.Gravel Pit					31.Tillable	
3.Assumed 6.Cash 9.Unknown			20.Industrial Bas					32.Pasture	
Validity 1 Arms Length Sale								33.Orchard	
1.Valid 4.Split 7.Renovate			Fract. Acre	Acres/Sites				34.Softwood F&O	
2.Related 5.Partial 8.Other				21.Developed Pave	22	0.50	100	%	0
3.Distress 6.Exempt 9.			22.Undev Paved (F					36.Hardwood F&O	
Verified 5 Public Record			23.Developed Grav					37.Softwood TG	
1.Buyer 4.Agent 7.Family								38.Mixed Wood TG	
2.Seller 5.Pub Rec 8.Other			Acres					39.Hardwood TG	
3.Lender 6.MLS 9.			24.Undev Gravel (40.Wasteland	
			25.Comm Base Pave					41.Open Space	
			26.Comm Base Grav					42.Mobile Home Si	
			27.Backlot					43.Condo Site	
			28.Rear Land	Total Acreage		0.50		44.Lot Improvemen	
			29.Pavement					45.Subdivision Lo	
								46.Heavy Ind Sit	

Washburn

Map Lot 001-004A

Account 485

Location WASHBURN ROAD

Card 1 Of 1 9/04/2024

Building Style 0	SF Bsmt Living 0	Layout 0
1.Conv. 5.Garrison 9.Gambrel	Fin Bsmt Grade 0 0	1.Typical 4. 7.
2.Ranch 6.Salt Box 10.Other	OPEN 5 OPTIONAL 0	2.Inadeq 5. 8.
3.R Ranch 7.Contemp 11.Split	Heat Type 100% 0	3.Poor 6. 9.
4.Cape 8.Log 12.	1.HWB 5.FWA 9.No Heat	Attic 0
Dwelling Units 0	2.HWCI 6.GravWA 10.	1.1/4 Fin 4.Full Fin 7.
Other Units 0	3.H Pump 7.Electric 11.	2.1/2 Fin 5.F/Stair 8.
Stories 0	4.Steam 8.F/Wall 12.	3.3/4 Fin 6. 9.None
1.1 4.1.5 7.	Cool Type 0% 9 None	Insulation 0
2.2 5.1.75 8.	1.Refrig 4.W&C Air 7.	1.Full 4.Minimal 7.
3.3 6.2.5 9.	2.Evapor 5. 8.	2.Heavy 5.Partial 8.
Exterior Walls 0	3.H Pump 6. 9.None	3.Capped 6. 9.None
1.Wood 5.Stucco 9.T-111	Kitchen Style 0	Unfinished % 0%
2.Vin/Al 6.Brick 10.Other	1.Modern 4.Obsolete 7.	Grade & Factor 0 0%
3.Compos. 7.Stone 11.	2.Typical 5. 8.	1.E Grade 4.B Grade 7.
4.Asbestos 8.Concrete 12.	3.Old Type 6. 9.None	2.D Grade 5.A Grade 8.SC Grade
Roof Surface 0	Bath(s) Style 0	3.C Grade 6.AA Grade 9.Same
1.Asphalt 4.Composit 7.	1.Modern 4.Obsolete 7.	SQFT (Footprint) 0
2.Slate 5.Wood 8.	2.Typical 5. 8.	Condition 0
3.Metal 6.Other 9.	3.Old Type 6. 9.None	1.Poor 4.Avg 7.V G
SF Masonry Trim 0	# Rooms 0	2.Fair 5.Avg+ 8.Exc
OPEN-3-CUSTOM 0	# Bedrooms 0	3.Avg- 6.Good 9.Same
OPEN-4-CUSTOM 0	# Full Baths 0	Phys. % Good 0%
Year Built 0	# Half Baths 0	Funct. % Good 100%
Year Remodeled 0	# Addn Fixtures 0	Functional Code 9 None
Foundation 0	# Fireplaces 0	1.Incomp 4.Delap 7.No Power
1.Concrete 4.Wood 7.		2.O-Built 5.Bsmt 8.LongTerm
2.C Block 5.Slab 8.		3.Damage 6.Common 9.None
3.Br/Stone 6.Piers 9.		Econ. % Good 100%
Basement 0		Economic Code None
1.1/4 Bmt 4.Full Bmt 7.		0.None 3.No Power 7.
2.1/2 Bmt 5.None 8.		1.Location 4.Generate 8.
3.3/4 Bmt 6. 9.None		2.Encroach 9.None 9.
Bsmt Gar # Cars 0		Entrance Code 5 Estimated
Wet Basement 0		1.Interior 4.Vacant 7.
1.Dry 4. 7.		2.Refusal 5.Estimate 8.
2.Damp 5. 8.		3.Informed 6.Reviewed 9.
3.Wet 6. 9.		Information Code 5 Estimate
		1.Owner 4.Agent 7.
		2.Relative 5.Estimate 8.
		3.Tenant 6.Other 9.

Date Inspected 7/25/2018

Additions, Outbuildings & Improvements

Type	Year	Units	Grade	Cond	Phys.	Funct.	Sound Value
234 Telephone Bldg	1980				%	%	1,000
					%	%	
					%	%	
					%	%	
					%	%	
					%	%	
					%	%	
					%	%	
					%	%	
					%	%	
					%	%	

10.0'

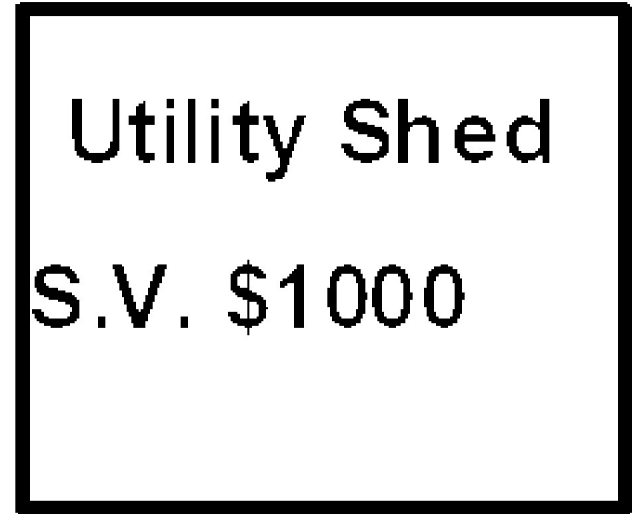

12.0'



TOWERS NORTH, INC.
P.O. BOX 596
BANGOR ME 04402

B3720P1

Inspection Witnessed By:

No./Date	Description	Date Insp.
X		

Notes:

Washburn

Property Data			Assessment Record						
Neighborhood 1 Neighborhood One			Year	Land	Buildings	Exempt	Total		
Tree Growth Year 0			2012	3,200	0	0	3,200		
1ST MORTGAGE 0			2013	4,200	0	0	4,200		
2ND MORTGAGE 0			2015	4,200	0	0	4,200		
Zone/Land Use 1 Residential			2018	4,200	0	0	4,200		
Secondary Zone			2019	6,400	0	0	6,400		
Topography 2 Rolling			2020	6,400	0	0	6,400		
1.Level 4.Below St 7.LevelBog			2021	6,400	0	0	6,400		
2.Rolling 5.Low 8.			2022	6,400	0	0	6,400		
3.Above St 6.Swampy 9.			2023	7,800	0	0	7,800		
Utilities			2024	7,800	0	0	7,800		
1.Public 4.Dr Well 7.Cesspool									
2.Water 5.Dug Well 8.									
3.Sewer 6.Septic 9.None									
Street 1 Paved									
1.Paved 4.Proposed 7.									
2.Semi Imp 5.R/O/W 8.									
3.Gravel 6. 9.None									
TG PLAN YEAR 0									
Tif District # 0									
Sale Data			Land Data						
Sale Date 10/09/2002			Front Foot	Type	Effective		Influence		Influence Codes
Price					Frontage	Depth	Factor	Code	
Sale Type 1 Land Only			11.Regular Lot					1.Unimproved	
1.Land 4.Mobile 7.C/I L&B			12.Delta Triangle			%		2.Excess Frtg	
2.L & B 5.Other 8.			13.Nabla Triangle			%		3.Topography	
3.Building 6.C/I Land 9.			14.Rear Land			%		4.Size/Shape	
Financing			15.Class I Road			%		5.Access	
1.Convent 4.Seller 7.						%		6.Restriction	
2.FHA/VA 5.Private 8.						%		7.Open Space	
3.Assumed 6.Cash 9.Unknown						%		8.View/Environ	
Validity 1 Arms Length Sale			Square Foot	Square Feet				9.Fract Share	
1.Valid 4.Split 7.Renovate			16.Class II Road			%		30.Utility R O W	
2.Related 5.Partial 8.Other			17.Municipal Rese			%		31.Tillable	
3.Distress 6.Exempt 9.			18.Munic Sep Lago			%		32.Pasture	
Verified 5 Public Record			19.Gravel Pit			%		33.Orchard	
1.Buyer 4.Agent 7.Family			20.Industrial Bas			%		34.Softwood F&O	
2.Seller 5.Pub Rec 8.Other			Fract. Acre	Acres/Sites				35.Mixed Wood F&O	
3.Lender 6.MLS 9.			21.Developed Pave	22	0.50	100	%	0	36.Hardwood F&O
			22.Undev Paved (F				%		37.Softwood TG
			23.Developed Grav				%		38.Mixed Wood TG
			Acres				%		39.Hardwood TG
			24.Undev Gravel (%		40.Wasteland
			25.Comm Base Pave				%		41.Open Space
			26.Comm Base Grav				%		42.Mobile Home Si
			27.Backlot				%		43.Condo Site
			28.Rear Land				%		44.Lot Improvemen
			29.Pavement				%		45.Subdivision Lo
			Total Acreage		0.50				46.Heavy Ind Sit

Washburn

Map Lot 001-004B

Account 922

Location WASHBURN ROAD

Card 1 Of 1 9/04/2024

Building Style 0	SF Bsmt Living 0	Layout 0
1.Conv. 5.Garrison 9.Gambrel	Fin Bsmt Grade 0 0	1.Typical 4. 7.
2.Ranch 6.Salt Box 10.Other	OPEN 5 OPTIONAL 0	2.Inadeq 5. 8.
3.R Ranch 7.Contemp 11.Split	Heat Type 100% 0	3.Poor 6. 9.
4.Cape 8.Log 12.	1.HWBB 5.FWA 9.No Heat	Attic 0
Dwelling Units 0	2.HWCI 6.GravWA 10.	1.1/4 Fin 4.Full Fin 7.
Other Units 0	3.H Pump 7.Electric 11.	2.1/2 Fin 5.F/Stair 8.
Stories 0	4.Steam 8.F/Wall 12.	3.3/4 Fin 6. 9.None
1.1 4.1.5 7.	Cool Type 0% 9 None	Insulation 0
2.2 5.1.75 8.	1.Refrig 4.W&C Air 7.	1.Full 4.Minimal 7.
3.3 6.2.5 9.	2.Evapor 5. 8.	2.Heavy 5.Partial 8.
Exterior Walls 0	3.H Pump 6. 9.None	3.Capped 6. 9.None
1.Wood 5.Stucco 9.T-111	Kitchen Style 0	Unfinished % 0%
2.Vin/Al 6.Brick 10.Other	1.Modern 4.Obsolete 7.	Grade & Factor 0 0%
3.Compos. 7.Stone 11.	2.Typical 5. 8.	1.E Grade 4.B Grade 7.
4.Asbestos 8.Concrete 12.	3.Old Type 6. 9.None	2.D Grade 5.A Grade 8.SC Grade
Roof Surface 0	Bath(s) Style 0	3.C Grade 6.AA Grade 9.Same
1.Asphalt 4.Composit 7.	1.Modern 4.Obsolete 7.	SQFT (Footprint) 0
2.Slate 5.Wood 8.	2.Typical 5. 8.	Condition 0
3.Metal 6.Other 9.	3.Old Type 6. 9.None	1.Poor 4.Avg 7.V G
SF Masonry Trim 0	# Rooms 0	2.Fair 5.Avg+ 8.Exc
OPEN-3-CUSTOM 0	# Bedrooms 0	3.Avg- 6.Good 9.Same
OPEN-4-CUSTOM 0	# Full Baths 0	Phys. % Good 0%
Year Built 0	# Half Baths 0	Funct. % Good 100%
Year Remodeled 0	# Addn Fixtures 0	Functional Code 9 None
Foundation 0	# Fireplaces 0	1.Incomp 4.Delap 7.No Power
1.Concrete 4.Wood 7.		2.O-Built 5.Bsmt 8.LongTerm
2.C Block 5.Slab 8.		3.Damage 6.Common 9.None
3.Br/Stone 6.Piers 9.		Econ. % Good 100%
Basement 0		Economic Code None
1.1/4 Bmt 4.Full Bmt 7.		0.None 3.No Power 7.
2.1/2 Bmt 5.None 8.		1.Location 4.Generate 8.
3.3/4 Bmt 6. 9.None		2.Encroach 9.None 9.
Bsmt Gar # Cars 0		Entrance Code 0
Wet Basement 0		1.Interior 4.Vacant 7.
1.Dry 4. 7.		2.Refusal 5.Estimate 8.
2.Damp 5. 8.	3.Informed 6.Reviewed 9.	
3.Wet 6. 9.	Information Code 0	
		1.Owner 4.Agent 7.
		2.Relative 5.Estimate 8.
		3.Tenant 6.Other 9.

Date Inspected

Additions, Outbuildings & Improvements								
Type	Year	Units	Grade	Cond	Phys.	Funct.	Sound Value	
					%	%		1.One Story Fram
					%	%		2.Two Story Fram
					%	%		3.Three Story Fr
					%	%		4.1 & 1/2 Story
					%	%		5.1 & 3/4 Story
					%	%		6.2 & 1/2 Story
					%	%		21.Open Frame Por
					%	%		22.Encl Frame Por
					%	%		23.Frame Garage
					%	%		24.Frame Shed
					%	%		25.Frame Bay Wind
					%	%		26.1SFr Overhang
					%	%		27.Unfin Basement
					%	%		28.Unfinished Att
					%	%		29.Finished Attic

WHITE FARMS INC.
311 CROSS ROAD
WASHBURN ME 04786

B3432P77

Inspection Witnessed By:

No./Date	Description	Date Insp.
X		

Notes:

Washburn

Property Data			Assessment Record						
Neighborhood 1 Neighborhood One			Year	Land	Buildings	Exempt	Total		
Tree Growth Year 0			2012	18,500	0	0	18,500		
1ST MORTGAGE 0			2013	24,000	0	0	24,000		
2ND MORTGAGE 0			2015	24,000	0	0	24,000		
Zone/Land Use 1 Residential			2018	24,000	0	0	24,000		
Secondary Zone			2019	53,800	0	0	53,800		
Topography 2 Rolling			2020	53,800	0	0	53,800		
1.Level 4.Below St 7.LevelBog			2021	53,800	0	0	53,800		
2.Rolling 5.Low 8.			2022	53,800	0	0	53,800		
3.Above St 6.Swampy 9.			2023	56,300	0	0	56,300		
Utilities			2024	56,300	0	0	56,300		
1.Public 4.Dr Well 7.Cesspool									
2.Water 5.Dug Well 8.									
3.Sewer 6.Septic 9.None									
Street 1 Paved									
1.Paved 4.Proposed 7.									
2.Semi Imp 5.R/O/W 8.									
3.Gravel 6. 9.None									
TG PLAN YEAR 0									
Tif District # 0									
Sale Data			Land Data						
Sale Date 9/05/2000			Front Foot	Type	Effective		Influence		Influence Codes
Price 24,000					Frontage	Depth	Factor	Code	
Sale Type 1 Land Only			11.Regular Lot					1.Unimproved	
1.Land 4.Mobile 7.C/I L&B			12.Delta Triangle					2.Excess Frtg	
2.L & B 5.Other 8.			13.Nabla Triangle					3.Topography	
3.Building 6.C/I Land 9.			14.Rear Land					4.Size/Shape	
Financing			15.Class I Road					5.Access	
1.Convent 4.Seller 7.								6.Restriction	
2.FHA/VA 5.Private 8.								7.Open Space	
3.Assumed 6.Cash 9.Unknown								8.View/Environ	
Validity 1 Arms Length Sale								9.Fract Share	
1.Valid 4.Split 7.Renovate			Square Foot	Square Feet				Acres	
2.Related 5.Partial 8.Other			16.Class II Road					30.Utility R O W	
3.Distress 6.Exempt 9.			17.Municipal Rese					31.Tillable	
Verified 5 Public Record			18.Munic Sep Lago					32.Pasture	
1.Buyer 4.Agent 7.Family			19.Gravel Pit					33.Orchard	
2.Seller 5.Pub Rec 8.Other			20.Industrial Bas					34.Softwood F&O	
3.Lender 6.MLS 9.			Fract. Acre	Acres/Sites				35.Mixed Wood F&O	
			21.Developed Pave	22	1.00	100	%	0	
			22.Undev Paved (F	28	5.67	100	%	0	
			23.Developed Grav	31	42.00	100	%	0	
			Acres						
			24.Undev Gravel (%	
			25.Comm Base Pave					%	
			26.Comm Base Grav					%	
			27.Backlot					%	
			28.Rear Land					%	
			29.Pavement					%	
			Total Acreage			48.67			
								44.Lot Improvemen	
								45.Subdivision Lo	
								46.Heavy Ind Sit	

Washburn

Map Lot 001-005

Account 1025

Location WASHBURN ROAD

Card 1 Of 1 9/04/2024

Building Style 0	SF Bsmt Living 0	Layout 0
1.Conv. 5.Garrison 9.Gambrel	Fin Bsmt Grade 0 0	1.Typical 4. 7.
2.Ranch 6.Salt Box 10.Other	OPEN 5 OPTIONAL 0	2.Inadeq 5. 8.
3.R Ranch 7.Contemp 11.Split	Heat Type 100% 0	3.Poor 6. 9.
4.Cape 8.Log 12.	1.HWBB 5.FWA 9.No Heat	Attic 0
Dwelling Units 0	2.HWCI 6.GravWA 10.	1.1/4 Fin 4.Full Fin 7.
Other Units 0	3.H Pump 7.Electric 11.	2.1/2 Fin 5.FI/Stair 8.
Stories 0	4.Steam 8.FI/Wall 12.	3.3/4 Fin 6. 9.None
1.1 4.1.5 7.	Cool Type 0% 9 None	Insulation 0
2.2 5.1.75 8.	1.Refrig 4.W&C Air 7.	1.Full 4.Minimal 7.
3.3 6.2.5 9.	2.Evapor 5. 8.	2.Heavy 5.Partial 8.
Exterior Walls 0	3.H Pump 6. 9.None	3.Capped 6. 9.None
1.Wood 5.Stucco 9.T-111	Kitchen Style 0	Unfinished % 0%
2.Vin/Al 6.Brick 10.Other	1.Modern 4.Obsolete 7.	Grade & Factor 0 0%
3.Compos. 7.Stone 11.	2.Typical 5. 8.	1.E Grade 4.B Grade 7.
4.Asbestos 8.Concrete 12.	3.Old Type 6. 9.None	2.D Grade 5.A Grade 8.SC Grade
Roof Surface 0	Bath(s) Style 0	3.C Grade 6.AA Grade 9.Same
1.Asphalt 4.Composit 7.	1.Modern 4.Obsolete 7.	SQFT (Footprint) 0
2.Slate 5.Wood 8.	2.Typical 5. 8.	Condition 0
3.Metal 6.Other 9.	3.Old Type 6. 9.None	1.Poor 4.Avg 7.V G
SF Masonry Trim 0	# Rooms 0	2.Fair 5.Avg+ 8.Exc
OPEN-3-CUSTOM 0	# Bedrooms 0	3.Avg- 6.Good 9.Same
OPEN-4-CUSTOM 0	# Full Baths 0	Phys. % Good 0%
Year Built 0	# Half Baths 0	Funct. % Good 100%
Year Remodeled 0	# Addn Fixtures 0	Functional Code 9 None
Foundation 0	# Fireplaces 0	1.Incomp 4.Delap 7.No Power
1.Concrete 4.Wood 7.		2.O-Built 5.Bsmt 8.LongTerm
2.C Block 5.Slab 8.		3.Damage 6.Common 9.None
3.Br/Stone 6.Piers 9.		Econ. % Good 100%
Basement 0		Economic Code None
1.1/4 Bmt 4.Full Bmt 7.		0.None 3.No Power 7.
2.1/2 Bmt 5.None 8.		1.Location 4.Generate 8.
3.3/4 Bmt 6. 9.None		2.Encroach 9.None 9.
Bsmt Gar # Cars 0		Entrance Code 0
Wet Basement 0		1.Interior 4.Vacant 7.
1.Dry 4. 7.		2.Refusal 5.Estimate 8.
2.Damp 5. 8.	3.Informed 6.Reviewed 9.	
3.Wet 6. 9.	Information Code 0	
		1.Owner 4.Agent 7.
		2.Relative 5.Estimate 8.
		3.Tenant 6.Other 9.

Date Inspected

Additions, Outbuildings & Improvements								
Type	Year	Units	Grade	Cond	Phys.	Funct.	Sound Value	
					%	%		1.One Story Fram
					%	%		2.Two Story Fram
					%	%		3.Three Story Fr
					%	%		4.1 & 1/2 Story
					%	%		5.1 & 3/4 Story
					%	%		6.2 & 1/2 Story
					%	%		21.Open Frame Por
					%	%		22.Encl Frame Por
					%	%		23.Frame Garage
					%	%		24.Frame Shed
					%	%		25.Frame Bay Wind
					%	%		26.1SFr Overhang
					%	%		27.Unfin Basement
					%	%		28.Unfinished Att
					%	%		29.Finished Attic

Washburn

Map Lot 001-005A

Account 1080

Location 963 WASHBURN ROAD

Card 1 Of 1 9/04/2024

Building Style 2 Ranch	SF Bsmt Living 0	Layout 1 Typical
1.Conv. 5.Garrison 9.Gambrel	Fin Bsmt Grade 0 0	1.Typical 4. 7.
2.Ranch 6.Salt Box 10.Other	OPEN 5 OPTIONAL 0	2.Inadeq 5. 8.
3.R Ranch 7.Contemp 11.Split	Heat Type 100% 1 Hot Water BB	3.Poor 6. 9.
4.Cape 8.Log 12.	1.HWB 5.FWA 9.No Heat	Attic 9 None
Dwelling Units 1	2.HWCI 6.GravWA 10.	1.1/4 Fin 4.Full Fin 7.
Other Units 0	3.H Pump 7.Electric 11.	2.1/2 Fin 5.F/Stair 8.
Stories 1 One Story	4.Steam 8.F/Wall 12.	3.3/4 Fin 6. 9.None
1.1 4.1.5 7.	Cool Type 0% 9 None	Insulation 1 Full
2.2 5.1.75 8.	1.Refrig 4.W&C Air 7.	1.Full 4.Minimal 7.
3.3 6.2.5 9.	2.Evapor 5. 8.	2.Heavy 5.Partial 8.
Exterior Walls 2 Vinyl/Aluminum	3.H Pump 6. 9.None	3.Capped 6. 9.None
1.Wood 5.Stucco 9.T-111	Kitchen Style 2 Typical	Unfinished % 0%
2.Vin/Al 6.Brick 10.Other	1.Modern 4.Obsolete 7.	Grade & Factor 3 Average 100%
3.Compos. 7.Stone 11.	2.Typical 5. 8.	1.E Grade 4.B Grade 7.
4.Asbestos 8.Concrete 12.	3.Old Type 6. 9.None	2.D Grade 5.A Grade 8.SC Grade
Roof Surface 3 Sheet Metal	Bath(s) Style 2 Typical Bath(s)	3.C Grade 6.AA Grade 9.Same
1.Asphalt 4.Composit 7.	1.Modern 4.Obsolete 7.	SQFT (Footprint) 1500
2.Slate 5.Wood 8.	2.Typical 5. 8.	Condition 5 Above Average
3.Metal 6.Other 9.	3.Old Type 6. 9.None	1.Poor 4.Avg 7.V G
SF Masonry Trim 0	# Rooms 5	2.Fair 5.Avg+ 8.Exc
OPEN-3-CUSTOM 0	# Bedrooms 2	3.Avg- 6.Good 9.Same
OPEN-4-CUSTOM 0	# Full Baths 1	Phys. % Good 0%
Year Built 2003	# Half Baths 1	Funct. % Good 100%
Year Remodeled 0	# Addn Fixtures 0	Functional Code 9 None
Foundation 1 Concrete	# Fireplaces 0	1.Incomp 4.Delap 7.No Power
1.Concrete 4.Wood 7.	 <p>TRIO Software <small>A Division of Harris Computer Systems</small></p>	2.O-Built 5.Bsmt 8.LongTerm
2.C Block 5.Slab 8.		3.Damage 6.Common 9.None
3.Br/Stone 6.Piers 9.		Econ. % Good 100%
Basement 4 Full Basement		Economic Code None
1.1/4 Bmt 4.Full Bmt 7.		0.None 3.No Power 7.
2.1/2 Bmt 5.None 8.		1.Location 4.Generate 8.
3.3/4 Bmt 6. 9.None		2.Encroach 9.None 9.
Bsmt Gar # Cars 0		Entrance Code 1 Interior Inspect
Wet Basement 2 Damp Basement		1.Interior 4.Vacant 7.
1.Dry 4. 7.		2.Refusal 5.Estimate 8.
2.Damp 5. 8.	3.Informed 6.Reviewed 9.	
3.Wet 6. 9.	Information Code 1 Owner	
	1.Owner 4.Agent 7.	
	2.Relative 5.Estimate 8.	
	3.Tenant 6.Other 9.	

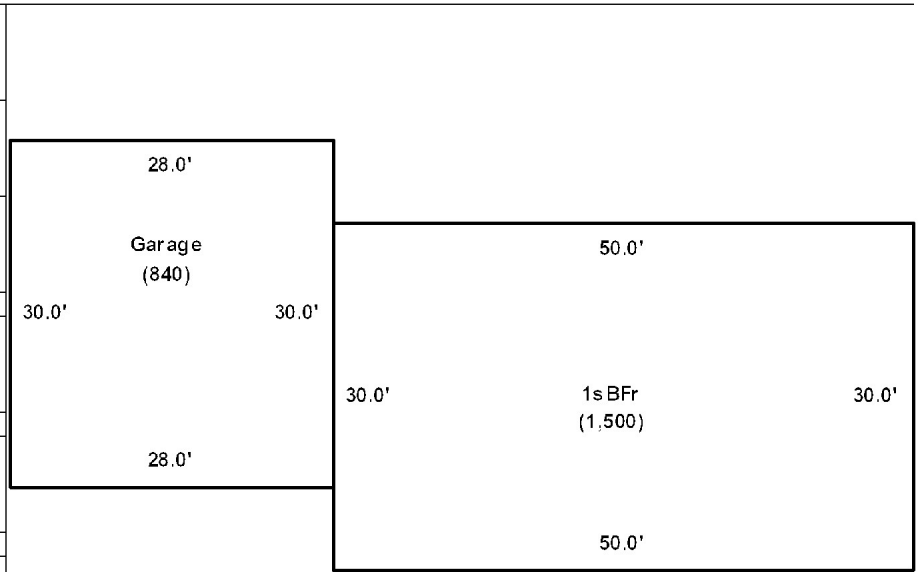

Date Inspected 7/25/2018

Additions, Outbuildings & Improvements

Type	Year	Units	Grade	Cond	Phys.	Funct.	Sound Value
23 Frame Garage	0	840	9 100	9	0 %	85 %	
					%	%	
					%	%	
					%	%	
					%	%	
					%	%	
					%	%	
					%	%	
					%	%	
					%	%	
					%	%	



Washburn

Map Lot 001-007

Account 523

Location 953 WASHBURN ROAD

Card 1 Of 1 9/04/2024

Building Style 2 Ranch	SF Bsmt Living 0	Layout 1 Typical
1.Conv. 5.Garrison 9.Gambrel	Fin Bsmt Grade 0 0	1.Typical 4. 7.
2.Ranch 6.Salt Box 10.Other	OPEN 5 OPTIONAL 0	2.Inadeq 5. 8.
3.R Ranch 7.Contemp 11.Split	Heat Type 100% 5 Forced Warm Air	3.Poor 6. 9.
4.Cape 8.Log 12.	1.HWBB 5.FWA 9.No Heat	Attic 9 None
Dwelling Units 1	2.HWCI 6.GravWA 10.	1.1/4 Fin 4.Full Fin 7.
Other Units 0	3.H Pump 7.Electric 11.	2.1/2 Fin 5.F/Stair 8.
Stories 1 One Story	4.Steam 8.F/Wall 12.	3.3/4 Fin 6. 9.None
1.1 4.1.5 7.	Cool Type 0% 9 None	Insulation 1 Full
2.2 5.1.75 8.	1.Refrig 4.W&C Air 7.	1.Full 4.Minimal 7.
3.3 6.2.5 9.	2.Evapor 5. 8.	2.Heavy 5.Partial 8.
Exterior Walls 4 Asbestos Siding	3.H Pump 6. 9.None	3.Capped 6. 9.None
1.Wood 5.Stucco 9.T-111	Kitchen Style 2 Typical	Unfinished % 0%
2.Vin/Al 6.Brick 10.Other	1.Modern 4.Obsolete 7.	Grade & Factor 3 Average 100%
3.Compos. 7.Stone 11.	2.Typical 5. 8.	1.E Grade 4.B Grade 7.
4.Asbestos 8.Concrete 12.	3.Old Type 6. 9.None	2.D Grade 5.A Grade 8.SC Grade
Roof Surface 1 Asphalt Shingles	Bath(s) Style 2 Typical Bath(s)	3.C Grade 6.AA Grade 9.Same
1.Asphalt 4.Composit 7.	1.Modern 4.Obsolete 7.	SQFT (Footprint) 1092
2.Slate 5.Wood 8.	2.Typical 5. 8.	Condition 6 Good
3.Metal 6.Other 9.	3.Old Type 6. 9.None	1.Poor 4.Avg 7.V G
SF Masonry Trim 0	# Rooms 5	2.Fair 5.Avg+ 8.Exc
OPEN-3-CUSTOM 0	# Bedrooms 2	3.Avg- 6.Good 9.Same
OPEN-4-CUSTOM 0	# Full Baths 1	Phys. % Good 0%
Year Built 1965	# Half Baths 0	Funct. % Good 100%
Year Remodeled 0	# Addn Fixtures 0	Functional Code 9 None
Foundation 1 Concrete	# Fireplaces 0	1.Incomp 4.Delap 7.No Power
1.Concrete 4.Wood 7.	 <p>TRIO Software A Division of Harris Computer Systems</p>	2.O-Built 5.Bsmt 8.LongTerm
2.C Block 5.Slab 8.		3.Damage 6.Common 9.None
3.Br/Stone 6.Piers 9.		Econ. % Good 100%
Basement 4 Full Basement		Economic Code None
1.1/4 Bmt 4.Full Bmt 7.		0.None 3.No Power 7.
2.1/2 Bmt 5.None 8.		1.Location 4.Generate 8.
3.3/4 Bmt 6. 9.None		2.Encroach 9.None 9.
Bsmt Gar # Cars 0		Entrance Code 5 Estimated
Wet Basement 2 Damp Basement		1.Interior 4.Vacant 7.
1.Dry 4. 7.		2.Refusal 5.Estimate 8.
2.Damp 5. 8.	3.Informed 6.Reviewed 9.	
3.Wet 6. 9.	Information Code 5 Estimate	
	1.Owner 4.Agent 7.	
	2.Relative 5.Estimate 8.	
	3.Tenant 6.Other 9.	

8.0'
12.0'
Shed
(96)
S/V \$500

4.0'
6.0'
Shed
(24)
S/V \$100

Above Ground
Pool
No Add

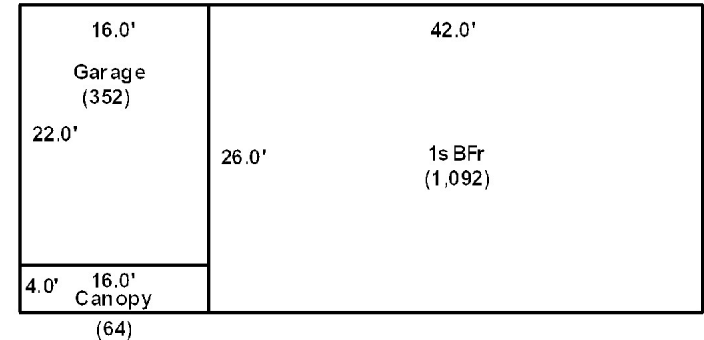

Date Inspected 7/25/2018

Additions, Outbuildings & Improvements

Type	Year	Units	Grade	Cond	Phys.	Funct.	Sound Value
23 Frame Garage	0	352	0 0	0	0 %	80 %	
61 Canopy	0	64	0 0	0	0 %	0 %	
24 Frame Shed	0				%	%	100
24 Frame Shed	0				%	%	500
					%	%	
					%	%	
					%	%	
					%	%	
					%	%	
					%	%	
					%	%	



- 1.One Story Fram
- 2.Two Story Fram
- 3.Three Story Fr
- 4.1 & 1/2 Story
- 5.1 & 3/4 Story
- 6.2 & 1/2 Story
- 21.Open Frame Por
- 22.Encl Frame Por
- 23.Frame Garage
- 24.Frame Shed
- 25.Frame Bay Wind
- 26.1SFr Overhang
- 27.Unfin Basement
- 28.Unfinished Att
- 29.Finished Attic

Washburn

Map Lot 001-008

Account 524

Location 945 WASHBURN ROAD

Card 1

Of 1

9/04/2024

Building Style 2 Ranch 1.Conv. 5.Garrison 9.Gambrel 2.Ranch 6.Salt Box 10.Other 3.R Ranch 7.Contemp 11.Split 4.Cape 8.Log 12. Dwelling Units 1 Other Units 0 Stories 1 One Story 1.1 4.1.5 7. 2.2 5.1.75 8. 3.3 6.2.5 9. Exterior Walls 2 Vinyl/Aluminum 1.Wood 5.Stucco 9.T-111 2.Vin/Al 6.Brick 10.Other 3.Compos. 7.Stone 11. 4.Asbestos 8.Concrete 12. Roof Surface 3 Sheet Metal 1.Asphalt 4.Composit 7. 2.Slate 5.Wood 8. 3.Metal 6.Other 9. SF Masonry Trim 0 OPEN-3-CUSTOM 0 OPEN-4-CUSTOM 0 Year Built 1970 Year Remodeled 0 Foundation 1 Concrete 1.Concrete 4.Wood 7. 2.C Block 5.Slab 8. 3.Br/Stone 6.Piers 9. Basement 4 Full Basement 1.1/4 Bmt 4.Full Bmt 7. 2.1/2 Bmt 5.None 8. 3.3/4 Bmt 6. 9.None Bsmt Gar # Cars 0 Wet Basement 2 Damp Basement 1.Dry 4. 7. 2.Damp 5. 8. 3.Wet 6. 9.	SF Bsmt Living 0 Fin Bsmt Grade 0 0 OPEN 5 OPTIONAL 0 Heat Type 100% 1 Hot Water BB 1.HWB 5.FWA 9.No Heat 2.HWCI 6.GravWA 10. 3.H Pump 7.Electric 11. 4.Steam 8.F/Wall 12. Cool Type 0% 9 None 1.Refrig 4.W&C Air 7. 2.Evapor 5. 8. 3.H Pump 6. 9.None Kitchen Style 2 Typical 1.Modern 4.Obsolete 7. 2.Typical 5. 8. 3.Old Type 6. 9.None Bath(s) Style 2 Typical Bath(s) 1.Modern 4.Obsolete 7. 2.Typical 5. 8. 3.Old Type 6. 9.None # Rooms 5 # Bedrooms 3 # Full Baths 1 # Addn Fixtures 0 # Fireplaces 0	Layout 1 Typical 1.Typical 4. 7. 2.Inadeq 5. 8. 3.Poor 6. 9. Attic 9 None 1.1/4 Fin 4.Full Fin 7. 2.1/2 Fin 5.F/Stair 8. 3.3/4 Fin 6. 9.None Insulation 1 Full 1.Full 4.Minimal 7. 2.Heavy 5.Partial 8. 3.Capped 6. 9.None Unfinished % 0% Grade & Factor 3 Average 100% 1.E Grade 4.B Grade 7. 2.D Grade 5.A Grade 8.SC Grade 3.C Grade 6.AA Grade 9.Same SQFT (Footprint) 1392 Condition 7 Very Good 1.Poor 4.Avg 7.V G 2.Fair 5.Avg+ 8.Exc 3.Avg- 6.Good 9.Same Phys. % Good 0% Funct. % Good 100% Functional Code 9 None 1.Incomp 4.Delap 7.No Power 2.O-Built 5.Bsmt 8.LongTerm 3.Damage 6.Common 9.None Econ. % Good 100% Economic Code None 0.None 3.No Power 7. 1.Location 4.Generate 8. 2.Encroach 9.None 9. Entrance Code 1 Interior Inspect 1.Interior 4.Vacant 7. 2.Refusal 5.Estimate 8. 3.Informed 6.Reviewed 9. Information Code 1 Owner 1.Owner 4.Agent 7. 2.Relative 5.Estimate 8. 3.Tenant 6.Other 9.
---	---	---



Date Inspected 7/25/2018

Additions, Outbuildings & Improvements

Type	Year	Units	Grade	Cond	Phys.	Funct.	Sound Value
23 Frame Garage	0	336	0 0	0	0 %	80 %	
61 Canopy	0	56	0 0	0	0 %	0 %	
62 Patio	0	220	0 0	0	0 %	0 %	
24 Frame Shed	0				%	%	2,500
24 Frame Shed	0				%	%	750
24 Frame Shed	0				%	%	1,000
					%	%	
					%	%	
					%	%	
					%	%	

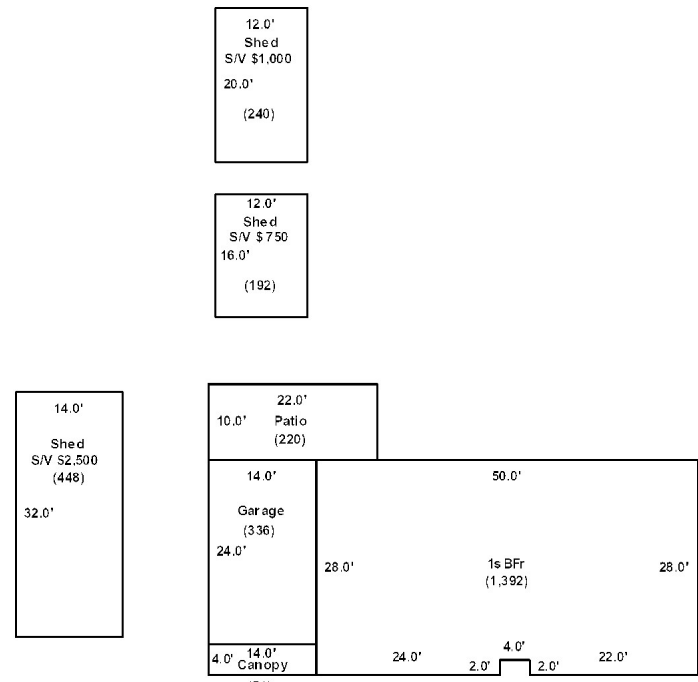

Washburn

Map Lot 001-009

Account 340

Location 941 WASHBURN ROAD

Card 1 Of 1 9/04/2024

Building Style	2 Ranch		SF Bsmt Living	0		Layout	1 Typical		
1.Conv.	5.Garrison	9.Gambrel	Fin Bsmt Grade	0 0		1.Typical	4.	7.	
2.Ranch	6.Salt Box	10.Other	OPEN 5 OPTIONAL	0		2.Inadeq	5.	8.	
3.R Ranch	7.Contemp	11.Split	Heat Type	100% 1 Hot Water BB		3.Poor	6.	9.	
4.Cape	8.Log	12.	1.HWBB	5.FWA	9.No Heat	Attic	9 None		
Dwelling Units	1		2.HWCI	6.GravWA	10.	1.1/4 Fin	4.Full Fin	7.	
Other Units	0		3.H Pump	7.Electric	11.	2.1/2 Fin	5.F/ Stair	8.	
Stories	1 One Story		4.Steam	8.F/ Wall	12.	3.3/4 Fin	6.	9.None	
1.1	4.1.5	7.	Cool Type	100% 3 Heat Pump		Insulation	1 Full		
2.2	5.1.75	8.	1.Refrig	4.W&C Air	7.	1.Full	4.Minimal	7.	
3.3	6.2.5	9.	2.Evapor	5.	8.	2.Heavy	5.Partial	8.	
Exterior Walls	4 Asbestos Siding		3.H Pump	6.	9.None	3.Capped	6.	9.None	
1.Wood	5.Stucco	9.T-111	Kitchen Style	2 Typical		Unfinished %	0%		
2.Vin/Al	6.Brick	10.Other	1.Modern	4.Obsolete	7.	Grade & Factor	3 Average 100%		
3.Compos.	7.Stone	11.	2.Typical	5.	8.	1.E Grade	4.B Grade	7.	
4.Asbestos	8.Concrete	12.	3.Old Type	6.	9.None	2.D Grade	5.A Grade	8.SC Grade	
Roof Surface	1 Asphalt Shingles		Bath(s) Style	2 Typical Bath(s)		3.C Grade	6.AA Grade	9.Same	
1.Asphalt	4.Composit	7.	1.Modern	4.Obsolete	7.	SQFT (Footprint)	1196		
2.Slate	5.Wood	8.	2.Typical	5.	8.	Condition	5 Above Average		
3.Metal	6.Other	9.	3.Old Type	6.	9.None	1.Poor	4.Avg	7.V G	
SF Masonry Trim	0		# Rooms	5		2.Fair	5.Avg+	8.Exc	
OPEN-3-CUSTOM	0		# Bedrooms	3		3.Avg-	6.Good	9.Same	
OPEN-4-CUSTOM	0		# Full Baths	1		Phys. % Good	0%		
Year Built	1987		# Half Baths	0		Funct. % Good	100%		
Year Remodeled	0		# Addn Fixtures	0		Functional Code	9 None		
Foundation	1 Concrete		# Fireplaces	0		1.Incomp	4.Delap	7.No Power	
1.Concrete	4.Wood	7.	 <p>TRIO Software A Division of Harris Computer Systems</p>	2.O-Built	5.Bsmt	8.LongTerm	Economic Code	None	
2.C Block	5.Slab	8.		3.Damage	6.Common	9.None	0.None	3.No Power	7.
3.Br/Stone	6.Piers	9.		Econ. % Good	100%		1.Location	4.Generate	8.
Basement	4 Full Basement			Entrance Code	1 Interior Inspect		2.Encroach	9.None	9.
1.1/4 Bmt	4.Full Bmt	7.		1.Interior	4.Vacant	7.	Information Code	1 Owner	
2.1/2 Bmt	5.None	8.		2.Refusal	5.Estimate	8.	1.Owner	4.Agent	7.
3.3/4 Bmt	6.	9.None		3.Informed	6.Reviewed	9.	2.Relative	5.Estimate	8.
Bsmt Gar # Cars	0			Information Code	1 Owner		3.Tenant	6.Other	9.
Wet Basement	2 Damp Basement			1.Owner	4.Agent	7.			
1.Dry	4.	7.		2.Relative	5.Estimate	8.			
2.Damp	5.	8.	3.Tenant	6.Other	9.				
3.Wet	6.	9.							

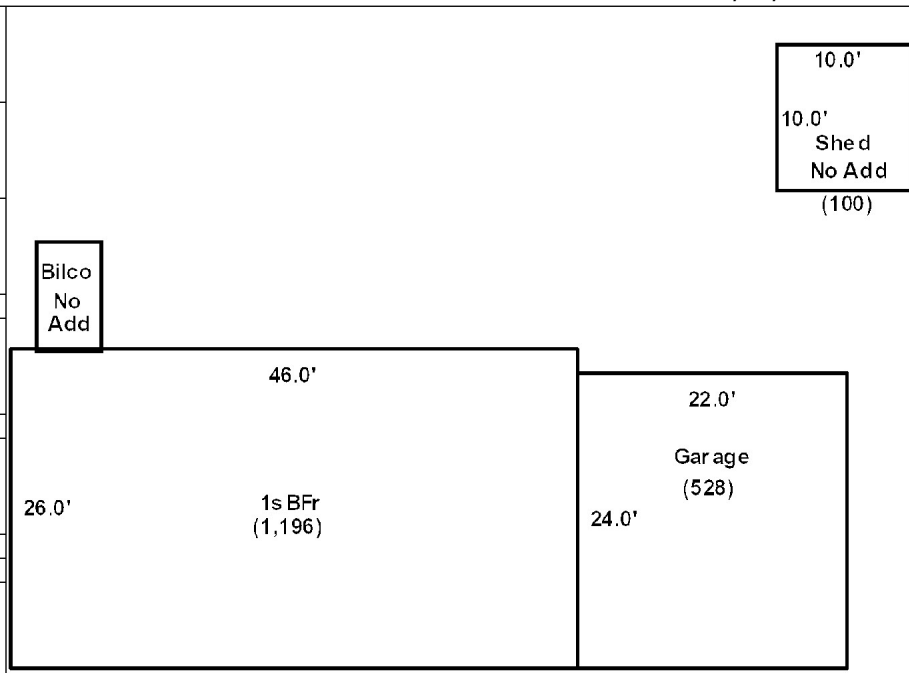

Date Inspected 7/25/2018

Additions, Outbuildings & Improvements

Type	Year	Units	Grade	Cond	Phys.	Funct.	Sound Value
23 Frame Garage	0	528	0 0	0	0 %	80 %	
					%	%	
					%	%	
					%	%	
					%	%	
					%	%	
					%	%	
					%	%	
					%	%	
					%	%	



- 1.One Story Fram
- 2.Two Story Fram
- 3.Three Story Fr
- 4.1 & 1/2 Story
- 5.1 & 3/4 Story
- 6.2 & 1/2 Story
- 21.Open Frame Por
- 22.Encl Frame Por
- 23.Frame Garage
- 24.Frame Shed
- 25.Frame Bay Wind
- 26.1SFr Overhang
- 27.Unfin Basement
- 28.Unfinished Att
- 29.Finished Attic

Washburn

Map Lot 001-012

Account 1027

Location WASHBURN ROAD

Card 1 Of 1 9/04/2024

Building Style 0	SF Bsmt Living 0	Layout 0
1.Conv. 5.Garrison 9.Gambrel	Fin Bsmt Grade 0 0	1.Typical 4. 7.
2.Ranch 6.Salt Box 10.Other	OPEN 5 OPTIONAL 0	2.Inadeq 5. 8.
3.R Ranch 7.Contemp 11.Split	Heat Type 100% 0	3.Poor 6. 9.
4.Cape 8.Log 12.	1.HWBB 5.FWA 9.No Heat	Attic 0
Dwelling Units 0	2.HWCI 6.GravWA 10.	1.1/4 Fin 4.Full Fin 7.
Other Units 0	3.H Pump 7.Electric 11.	2.1/2 Fin 5.FI/Stair 8.
Stories 0	4.Steam 8.FI/Wall 12.	3.3/4 Fin 6. 9.None
1.1 4.1.5 7.	Cool Type 0% 9 None	Insulation 0
2.2 5.1.75 8.	1.Refrig 4.W&C Air 7.	1.Full 4.Minimal 7.
3.3 6.2.5 9.	2.Evapor 5. 8.	2.Heavy 5.Partial 8.
Exterior Walls 0	3.H Pump 6. 9.None	3.Capped 6. 9.None
1.Wood 5.Stucco 9.T-111	Kitchen Style 0	Unfinished % 0%
2.Vin/Al 6.Brick 10.Other	1.Modern 4.Obsolete 7.	Grade & Factor 0 0%
3.Compos. 7.Stone 11.	2.Typical 5. 8.	1.E Grade 4.B Grade 7.
4.Asbestos 8.Concrete 12.	3.Old Type 6. 9.None	2.D Grade 5.A Grade 8.SC Grade
Roof Surface 0	Bath(s) Style 0	3.C Grade 6.AA Grade 9.Same
1.Asphalt 4.Composit 7.	1.Modern 4.Obsolete 7.	SQFT (Footprint) 0
2.Slate 5.Wood 8.	2.Typical 5. 8.	Condition 0
3.Metal 6.Other 9.	3.Old Type 6. 9.None	1.Poor 4.Avg 7.V G
SF Masonry Trim 0	# Rooms 0	2.Fair 5.Avg+ 8.Exc
OPEN-3-CUSTOM 0	# Bedrooms 0	3.Avg- 6.Good 9.Same
OPEN-4-CUSTOM 0	# Full Baths 0	Phys. % Good 0%
Year Built 0	# Half Baths 0	Funct. % Good 100%
Year Remodeled 0	# Addn Fixtures 0	Functional Code 9 None
Foundation 0	# Fireplaces 0	1.Incomp 4.Delap 7.No Power
1.Concrete 4.Wood 7.		2.O-Built 5.Bsmt 8.LongTerm
2.C Block 5.Slab 8.		3.Damage 6.Common 9.None
3.Br/Stone 6.Piers 9.		Econ. % Good 100%
Basement 0		Economic Code None
1.1/4 Bmt 4.Full Bmt 7.		0.None 3.No Power 7.
2.1/2 Bmt 5.None 8.		1.Location 4.Generate 8.
3.3/4 Bmt 6. 9.None		2.Encroach 9.None 9.
Bsmt Gar # Cars 0		Entrance Code 0
Wet Basement 0		1.Interior 4.Vacant 7.
1.Dry 4. 7.		2.Refusal 5.Estimate 8.
2.Damp 5. 8.	3.Informed 6.Reviewed 9.	
3.Wet 6. 9.	Information Code 0	
	1.Owner 4.Agent 7.	
	2.Relative 5.Estimate 8.	
	3.Tenant 6.Other 9.	

Date Inspected

Additions, Outbuildings & Improvements								
Type	Year	Units	Grade	Cond	Phys.	Funct.	Sound Value	
					%	%		1.One Story Fram
					%	%		2.Two Story Fram
					%	%		3.Three Story Fr
					%	%		4.1 & 1/2 Story
					%	%		5.1 & 3/4 Story
					%	%		6.2 & 1/2 Story
					%	%		21.Open Frame Por
					%	%		22.Encl Frame Por
					%	%		23.Frame Garage
					%	%		24.Frame Shed
					%	%		25.Frame Bay Wind
					%	%		26.1SFr Overhang
					%	%		27.Unfin Basement
					%	%		28.Unfinished Att
					%	%		29.Finished Attic

Washburn

Map Lot 001-013

Account 636

Location 915 WASHBURN ROAD

Card 1

Of 1

9/04/2024

Building Style	2 Ranch			SF Bsmt Living	0			Layout	1 Typical		
1.Conv.	5.Garrison	9.Gambrel		Fin Bsmt Grade	0 0			1.Typical	4.	7.	
2.Ranch	6.Salt Box	10.Other		OPEN 5 OPTIONAL	0			2.Inadeq	5.	8.	
3.R Ranch	7.Contemp	11.Split		Heat Type	100% 1 Hot Water BB			3.Poor	6.	9.	
4.Cape	8.Log	12.		1.HWBB	5.FWA	9.No Heat	Attic	9 None			
Dwelling Units	1			2.HWCI	6.GravWA	10.	1.1/4 Fin	4.Full Fin	7.		
Other Units	0			3.H Pump	7.Electric	11.	2.1/2 Fin	5.FI/Stair	8.		
Stories	1 One Story			4.Steam	8.FI/Wall	12.	3.3/4 Fin	6.	9.None		
1.1	4.1.5	7.		Cool Type	100% 3 Heat Pump			Insulation	1 Full		
2.2	5.1.75	8.		1.Refrig	4.W&C Air	7.	1.Full	4.Minimal	7.		
3.3	6.2.5	9.		2.Evapor	5.	8.	2.Heavy	5.Partial	8.		
Exterior Walls	2 Vinyl/Aluminum			3.H Pump	6.	9.None	3.Capped	6.	9.None		
1.Wood	5.Stucco	9.T-111		Kitchen Style	2 Typical			Unfinished %	0%		
2.Vin/Al	6.Brick	10.Other		1.Modern	4.Obsolete	7.	Grade & Factor	3 Average 105%			
3.Compos.	7.Stone	11.		2.Typical	5.	8.	1.E Grade	4.B Grade	7.		
4.Asbestos	8.Concrete	12.		3.Old Type	6.	9.None	2.D Grade	5.A Grade	8.SC Grade		
Roof Surface	1 Asphalt Shingles			Bath(s) Style	2 Typical Bath(s)			3.C Grade	6.AA Grade	9.Same	
1.Asphalt	4.Composit	7.		1.Modern	4.Obsolete	7.	SQFT (Footprint)	1215			
2.Slate	5.Wood	8.		2.Typical	5.	8.	Condition	6 Good			
3.Metal	6.Other	9.		3.Old Type	6.	9.None	1.Poor	4.Avg	7.V G		
SF Masonry Trim	0			# Rooms	5			2.Fair	5.Avg+	8.Exc	
OPEN-3-CUSTOM	0			# Bedrooms	3			3.Avg-	6.Good	9.Same	
OPEN-4-CUSTOM	0			# Full Baths	1			Phys. % Good	0%		
Year Built	1968			# Half Baths	0			Funct. % Good	100%		
Year Remodeled	0			# Addn Fixtures	0			Functional Code	9 None		
Foundation	1 Concrete			# Fireplaces	1			1.Incomp	4.Delap	7.No Power	
1.Concrete	4.Wood	7.		 <p>TRIO Software <small>A Division of Harris Computer Systems</small></p>	2.O-Built	5.Bsmt	8.LongTerm	Econ. % Good	100%		
2.C Block	5.Slab	8.			3.Damage	6.Common	9.None	Economic Code	None		
3.Br/Stone	6.Piers	9.			1.None	3.No Power	7.	0.None	3.No Power	7.	
Basement	4 Full Basement				1.Location	4.Generate	8.	1.Location	4.Generate	8.	
1.1/4 Bmt	4.Full Bmt	7.			2.Encroach	9.None	9.	2.Encroach	9.None	9.	
2.1/2 Bmt	5.None	8.			Entrance Code	1 Interior Inspect			1.Interior	4.Vacant	7.
3.3/4 Bmt	6.	9.None			2.Refusal	5.Estimate	8.	2.Refusal	5.Estimate	8.	
Bsmt Gar # Cars	0				3.Informed	6.Reviewed	9.	3.Informed	6.Reviewed	9.	
Wet Basement	3 Wet Basement				Information Code	1 Owner			1.Owner	4.Agent	7.
1.Dry	4.	7.			2.Relative	5.Estimate	8.	2.Relative	5.Estimate	8.	
2.Damp	5.	8.		3.Tenant	6.Other	9.	3.Tenant	6.Other	9.		
3.Wet	6.	9.									

14.0'
Shed
S/V \$2,000
20.0'

(280)

18.0'
Patio
(360)
20.0'

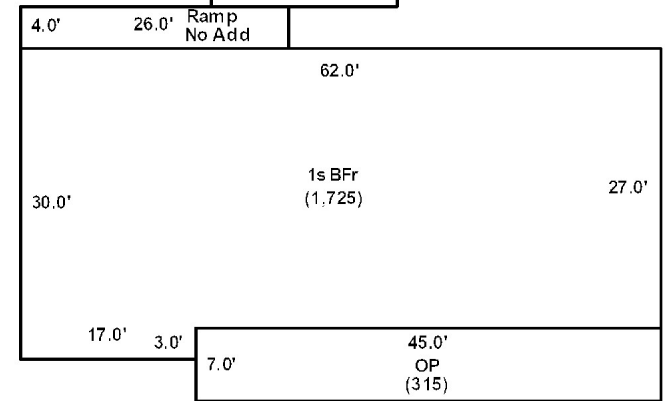

Date Inspected 9/08/2018

Additions, Outbuildings & Improvements

Type	Year	Units	Grade	Cond	Phys.	Funct.	Sound Value
21 Open Frame	2015	315	3 110	4	0 %	100 %	
62 Patio	2015	360	3 110	4	0 %	100 %	
24 Frame Shed	0				%	%	2,000
24 Frame Shed	0				%	%	1,000
23 Frame Garage	1968	510	3 100	4	0 %	80 %	
					%	%	
					%	%	
					%	%	
					%	%	
					%	%	
					%	%	



Washburn

Map Lot 001-014

Account 1134

Location WASHBURN ROAD

Card 1 Of 1 9/04/2024

Building Style 0	SF Bsmt Living 0	Layout 0
1.Conv. 5.Garrison 9.Gambrel	Fin Bsmt Grade 0 0	1.Typical 4. 7.
2.Ranch 6.Salt Box 10.Other	OPEN 5 OPTIONAL 0	2.Inadeq 5. 8.
3.R Ranch 7.Contemp 11.Split	Heat Type 100% 0	3.Poor 6. 9.
4.Cape 8.Log 12.	1.HWBB 5.FWA 9.No Heat	Attic 0
Dwelling Units 0	2.HWCI 6.GravWA 10.	1.1/4 Fin 4.Full Fin 7.
Other Units 0	3.H Pump 7.Electric 11.	2.1/2 Fin 5.F/Stair 8.
Stories 0	4.Steam 8.F/Wall 12.	3.3/4 Fin 6. 9.None
1.1 4.1.5 7.	Cool Type 0% 9 None	Insulation 0
2.2 5.1.75 8.	1.Refrig 4.W&C Air 7.	1.Full 4.Minimal 7.
3.3 6.2.5 9.	2.Evapor 5. 8.	2.Heavy 5.Partial 8.
Exterior Walls 0	3.H Pump 6. 9.None	3.Capped 6. 9.None
1.Wood 5.Stucco 9.T-111	Kitchen Style 0	Unfinished % 0%
2.Vin/Al 6.Brick 10.Other	1.Modern 4.Obsolete 7.	Grade & Factor 0 0%
3.Compos. 7.Stone 11.	2.Typical 5. 8.	1.E Grade 4.B Grade 7.
4.Asbestos 8.Concrete 12.	3.Old Type 6. 9.None	2.D Grade 5.A Grade 8.SC Grade
Roof Surface 0	Bath(s) Style 0	3.C Grade 6.AA Grade 9.Same
1.Asphalt 4.Composit 7.	1.Modern 4.Obsolete 7.	SQFT (Footprint) 0
2.Slate 5.Wood 8.	2.Typical 5. 8.	Condition 0
3.Metal 6.Other 9.	3.Old Type 6. 9.None	1.Poor 4.Avg 7.V G
SF Masonry Trim 0	# Rooms 0	2.Fair 5.Avg+ 8.Exc
OPEN-3-CUSTOM 0	# Bedrooms 0	3.Avg- 6.Good 9.Same
OPEN-4-CUSTOM 0	# Full Baths 0	Phys. % Good 0%
Year Built 0	# Half Baths 0	Funct. % Good 100%
Year Remodeled 0	# Addn Fixtures 0	Functional Code 9 None
Foundation 0	# Fireplaces 0	1.Incomp 4.Delap 7.No Power
1.Concrete 4.Wood 7.	 <p>TRIO Software A Division of Harris Computer Systems</p>	2.O-Built 5.Bsmt 8.LongTerm
2.C Block 5.Slab 8.		3.Damage 6.Common 9.None
3.Br/Stone 6.Piers 9.		Econ. % Good 100%
Basement 0		Economic Code None
1.1/4 Bmt 4.Full Bmt 7.		0.None 3.No Power 7.
2.1/2 Bmt 5.None 8.		1.Location 4.Generate 8.
3.3/4 Bmt 6. 9.None		2.Encroach 9.None 9.
Bsmt Gar # Cars 0		Entrance Code 0
Wet Basement 0		1.Interior 4.Vacant 7.
1.Dry 4. 7.		2.Refusal 5.Estimate 8.
2.Damp 5. 8.	3.Informed 6.Reviewed 9.	
3.Wet 6. 9.	Information Code 0	
		1.Owner 4.Agent 7.
		2.Relative 5.Estimate 8.
		3.Tenant 6.Other 9.

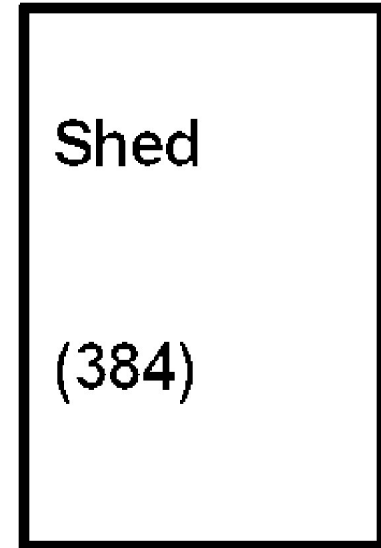

24'

Shed

(384)

16'

Date Inspected

Additions, Outbuildings & Improvements

Type	Year	Units	Grade	Cond	Phys.	Funct.	Sound Value
24 Frame Shed	2023	384	5 100	4	0 %	100 %	
					%	%	
					%	%	
					%	%	
					%	%	
					%	%	
					%	%	
					%	%	
					%	%	
					%	%	
					%	%	

- 1.One Story Fram
- 2.Two Story Fram
- 3.Three Story Fr
- 4.1 & 1/2 Story
- 5.1 & 3/4 Story
- 6.2 & 1/2 Story
- 21.Open Frame Por
- 22.Encl Frame Por
- 23.Frame Garage
- 24.Frame Shed
- 25.Frame Bay Wind
- 26.1SFr Overhang
- 27.Unfin Basement
- 28.Unfinished Att
- 29.Finished Attic

WHITE FARMS INC.
311 CROSS ROAD
WASHBURN ME 04786

			Property Data			Assessment Record							
			Neighborhood	1 Neighborhood One		Year	Land	Buildings	Exempt	Total			
			Tree Growth Year		0	2012	40,800	0	0	40,800			
			1ST MORTGAGE		0	2013	53,000	0	0	53,000			
			2ND MORTGAGE		0	2015	53,000	0	0	53,000			
			Zone/Land Use		1 Residential			2018	53,000	0	0	53,000	
			Secondary Zone			2019	108,000	0	0	108,000			
			Topography		2 Rolling			2020	108,000	0	0	108,000	
			1.Level		4.Below St	7.LevelBog	2021	108,000	0	0	108,000		
			2.Rolling		5.Low	8.	2022	108,000	0	0	108,000		
			3.Above St		6.Swampy	9.	2023	111,400	0	0	111,400		
			Utilities				2024	111,400	0	0	111,400		
			1.Public		4.Dr Well	7.Cesspool							
			2.Water		5.Dug Well	8.							
			3.Sewer		6.Septic	9.None							
			Street		1 Paved								
			1.Paved		4.Proposed	7.	Land Data						
			2.Semi Imp		5.R/O/W	8.							
			3.Gravel		6.	9.None	Front Foot						
			TG PLAN YEAR		0								
			Tif District #		0			Type					
			Sale Data			Effective				Influence		Influence Codes	
			Sale Date										
			Price					Square Foot				Acres	
			Sale Type		1 Land Only								
			1.Land		4.Mobile	7.C/I L&B	Fract. Acre				Acres		
			2.L & B		5.Other	8.							22
			3.Building		6.C/I Land	9.	Acres				Acres		
			Financing										28
			1.Convent		4.Seller	7.	Acres				Acres		
			2.FHA/VA		5.Private	8.							31
			3.Assumed		6.Cash	9.Unknown	Acres				Acres		
			Validity										
			1.Valid		4.Split	7.Renovate	Acres				Acres		
			2.Related		5.Partial	8.Other							
			3.Distress		6.Exempt	9.	Acres				Acres		
			Verified										
			1.Buyer		4.Agent	7.Family	Acres				Acres		
			2.Seller		5.Pub Rec	8.Other							
			3.Lender		6.MLS	9.	Acres				Acres		
								Acres				Acres	
								Acres				Acres	
								Acres				Acres	
								Acres				Acres	
								Acres				Acres	
								Acres				Acres	
								Acres				Acres	
								Acres				Acres	
								Acres				Acres	
								Acres				Acres	
								Acres				Acres	
								Acres				Acres	
								Acres				Acres	
								Acres				Acres	
								Acres				Acres	
								Acres				Acres	
								Acres				Acres	
								Acres				Acres	
								Acres				Acres	
								Acres				Acres	
								Acres				Acres	
								Acres				Acres	
								Acres				Acres	
								Acres				Acres	
								Acres				Acres	
								Acres				Acres	
								Acres				Acres	
								Acres				Acres	
								Acres				Acres	
								Acres				Acres	
								Acres				Acres	
								Acres				Acres	
								Acres				Acres	
								Acres				Acres	
								Acres				Acres	
								Acres				Acres	
								Acres				Acres	
								Acres				Acres	
								Acres				Acres	
								Acres				Acres	
								Acres				Acres	
								Acres				Acres	
								Acres				Acres	
								Acres				Acres	
								Acres				Acres	
								Acres				Acres	
								Acres				Acres	
								Acres				Acres	
								Acres				Acres	
								Acres				Acres	
								Acres				Acres	
								Acres				Acres	
								Acres				Acres	
								Acres				Acres	
								Acres				Acres	
								Acres				Acres	
								Acres				Acres	
								Acres				Acres	
								Acres				Acres	
								Acres				Acres	
								Acres				Acres	
								Acres				Acres	
								Acres				Acres	
								Acres				Acres	
								Acres				Acres	
								Acres				Acres	
								Acres				Acres	
								Acres				Acres	
								Acres				Acres	
								Acres				Acres	
								Acres				Acres	

Washburn

Map Lot 001-015

Account 1021

Location WASHBURN ROAD

Card 1 Of 1 9/04/2024

Building Style 0	SF Bsmt Living 0	Layout 0
1.Conv. 5.Garrison 9.Gambrel	Fin Bsmt Grade 0 0	1.Typical 4. 7.
2.Ranch 6.Salt Box 10.Other	OPEN 5 OPTIONAL 0	2.Inadeq 5. 8.
3.R Ranch 7.Contemp 11.Split	Heat Type 100% 0	3.Poor 6. 9.
4.Cape 8.Log 12.	1.HWBB 5.FWA 9.No Heat	Attic 0
Dwelling Units 0	2.HWCI 6.GravWA 10.	1.1/4 Fin 4.Full Fin 7.
Other Units 0	3.H Pump 7.Electric 11.	2.1/2 Fin 5.FI/Stair 8.
Stories 0	4.Steam 8.FI/Wall 12.	3.3/4 Fin 6. 9.None
1.1 4.1.5 7.	Cool Type 0% 9 None	Insulation 0
2.2 5.1.75 8.	1.Refrig 4.W&C Air 7.	1.Full 4.Minimal 7.
3.3 6.2.5 9.	2.Evapor 5. 8.	2.Heavy 5.Partial 8.
Exterior Walls 0	3.H Pump 6. 9.None	3.Capped 6. 9.None
1.Wood 5.Stucco 9.T-111	Kitchen Style 0	Unfinished % 0%
2.Vin/Al 6.Brick 10.Other	1.Modern 4.Obsolete 7.	Grade & Factor 0 0%
3.Compos. 7.Stone 11.	2.Typical 5. 8.	1.E Grade 4.B Grade 7.
4.Asbestos 8.Concrete 12.	3.Old Type 6. 9.None	2.D Grade 5.A Grade 8.SC Grade
Roof Surface 0	Bath(s) Style 0	3.C Grade 6.AA Grade 9.Same
1.Asphalt 4.Composit 7.	1.Modern 4.Obsolete 7.	SQFT (Footprint) 0
2.Slate 5.Wood 8.	2.Typical 5. 8.	Condition 0
3.Metal 6.Other 9.	3.Old Type 6. 9.None	1.Poor 4.Avg 7.V G
SF Masonry Trim 0	# Rooms 0	2.Fair 5.Avg+ 8.Exc
OPEN-3-CUSTOM 0	# Bedrooms 0	3.Avg- 6.Good 9.Same
OPEN-4-CUSTOM 0	# Full Baths 0	Phys. % Good 0%
Year Built 0	# Half Baths 0	Funct. % Good 100%
Year Remodeled 0	# Addn Fixtures 0	Functional Code 9 None
Foundation 0	# Fireplaces 0	1.Incomp 4.Delap 7.No Power
1.Concrete 4.Wood 7.		2.O-Built 5.Bsmt 8.LongTerm
2.C Block 5.Slab 8.		3.Damage 6.Common 9.None
3.Br/Stone 6.Piers 9.		Econ. % Good 100%
Basement 0		Economic Code None
1.1/4 Bmt 4.Full Bmt 7.		0.None 3.No Power 7.
2.1/2 Bmt 5.None 8.		1.Location 4.Generate 8.
3.3/4 Bmt 6. 9.None		2.Encroach 9.None 9.
Bsmt Gar # Cars 0		Entrance Code 0
Wet Basement 0		1.Interior 4.Vacant 7.
1.Dry 4. 7.		2.Refusal 5.Estimate 8.
2.Damp 5. 8.	3.Informed 6.Reviewed 9.	
3.Wet 6. 9.	Information Code 0	
	1.Owner 4.Agent 7.	
	2.Relative 5.Estimate 8.	
	3.Tenant 6.Other 9.	

Date Inspected

Additions, Outbuildings & Improvements								
Type	Year	Units	Grade	Cond	Phys.	Funct.	Sound Value	
					%	%		1.One Story Fram
					%	%		2.Two Story Fram
					%	%		3.Three Story Fr
					%	%		4.1 & 1/2 Story
					%	%		5.1 & 3/4 Story
					%	%		6.2 & 1/2 Story
					%	%		21.Open Frame Por
					%	%		22.Encl Frame Por
					%	%		23.Frame Garage
					%	%		24.Frame Shed
					%	%		25.Frame Bay Wind
					%	%		26.1SFr Overhang
					%	%		27.Unfin Basement
					%	%		28.Unfinished Att
					%	%		29.Finished Attic

Washburn

Map Lot 001-016

Account 864

Location 852 WASHBURN ROAD

Card 1

Of 1

9/04/2024

Building Style 2 Ranch	SF Bsmt Living 0	Layout 1 Typical
1.Conv. 5.Garrison 9.Gambrel	Fin Bsmt Grade 0 0	1.Typical 4. 7.
2.Ranch 6.Salt Box 10.Other	OPEN 5 OPTIONAL 0	2.Inadeq 5. 8.
3.R Ranch 7.Contemp 11.Split	Heat Type 100% 1 Hot Water BB	3.Poor 6. 9.
4.Cape 8.Log 12.	1.HWBB 5.FWA 9.No Heat	Attic 9 None
Dwelling Units 1	2.HWCI 6.GravWA 10.	1.1/4 Fin 4.Full Fin 7.
Other Units 0	3.H Pump 7.Electric 11.	2.1/2 Fin 5.FI/Stair 8.
Stories 1 One Story	4.Steam 8.FI/Wall 12.	3.3/4 Fin 6. 9.None
1.1 4.1.5 7.	Cool Type 100% 2 Evaporative	Insulation 1 Full
2.2 5.1.75 8.	1.Refrig 4.W&C Air 7.	1.Full 4.Minimal 7.
3.3 6.2.5 9.	2.Evapor 5. 8.	2.Heavy 5.Partial 8.
Exterior Walls 2 Vinyl/Aluminum	3.H Pump 6. 9.None	3.Capped 6. 9.None
1.Wood 5.Stucco 9.T-111	Kitchen Style 2 Typical	Unfinished % 0%
2.Vin/Al 6.Brick 10.Other	1.Modern 4.Obsolete 7.	Grade & Factor 3 Average 105%
3.Compos. 7.Stone 11.	2.Typical 5. 8.	1.E Grade 4.B Grade 7.
4.Asbestos 8.Concrete 12.	3.Old Type 6. 9.None	2.D Grade 5.A Grade 8.SC Grade
Roof Surface 1 Asphalt Shingles	Bath(s) Style 2 Typical Bath(s)	3.C Grade 6.AA Grade 9.Same
1.Asphalt 4.Composit 7.	1.Modern 4.Obsolete 7.	SQFT (Footprint) 1378
2.Slate 5.Wood 8.	2.Typical 5. 8.	Condition 6 Good
3.Metal 6.Other 9.	3.Old Type 6. 9.None	1.Poor 4.Avg 7.V G
SF Masonry Trim 0	# Rooms 6	2.Fair 5.Avg+ 8.Exc
OPEN-3-CUSTOM 0	# Bedrooms 3	3.Avg- 6.Good 9.Same
OPEN-4-CUSTOM 0	# Full Baths 1	Phys. % Good 0%
Year Built 1970	# Half Baths 2	Funct. % Good 100%
Year Remodeled 0	# Addn Fixtures 0	Functional Code 9 None
Foundation 1 Concrete	# Fireplaces 0	1.Incomp 4.Delap 7.No Power
1.Concrete 4.Wood 7.		2.O-Built 5.Bsmt 8.LongTerm
2.C Block 5.Slab 8.		3.Damage 6.Common 9.None
3.Br/Stone 6.Piers 9.		Econ. % Good 100%
Basement 4 Full Basement		Economic Code None
1.1/4 Bmt 4.Full Bmt 7.		0.None 3.No Power 7.
2.1/2 Bmt 5.None 8.		1.Location 4.Generate 8.
3.3/4 Bmt 6. 9.None		2.Encroach 9.None 9.
Bsmt Gar # Cars 0		Entrance Code 3 Information Only
Wet Basement 1 Dry Basement		1.Interior 4.Vacant 7.
1.Dry 4. 7.		2.Refusal 5.Estimate 8.
2.Damp 5. 8.	3.Informed 6.Reviewed 9.	
3.Wet 6. 9.	Information Code 1 Owner	
		1.Owner 4.Agent 7.
		2.Relative 5.Estimate 8.
		3.Tenant 6.Other 9.

Date Inspected 7/28/2018

Additions, Outbuildings & Improvements

Type	Year	Units	Grade	Cond	Phys.	Funct.	Sound Value
21 Open Frame	1990	21	0 0	0	0 %	0 %	
20 1 Story/Bsmt	1990	140	0 0	0	0 %	0 %	
21 Open Frame	1990	21	0 0	0	0 %	0 %	
23 Frame Garage	1990	560	9 100	9	0 %	80 %	
27 Unfin Basement	1990	560	0 0	0	0 %	0 %	
26 1SFr Overhang	0	106	0 0	0	0 %	0 %	
					%	%	
					%	%	
					%	%	
					%	%	
					%	%	

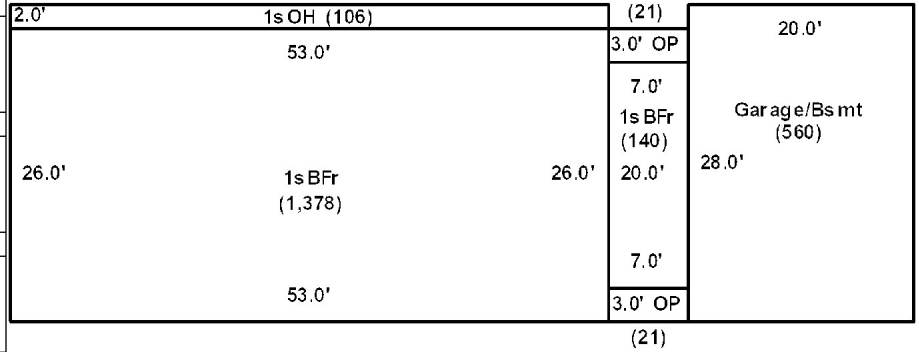

Washburn

Map Lot 001-017A

Account 191

Location 856 WASHBURN ROAD

Card 1

Of 1

9/04/2024

Building Style	2 Ranch			SF Bsmt Living	0			Layout	1 Typical										
1.Conv.	5.Garrison	9.Gambrel		Fin Bsmt Grade	0 0			1.Typical	4.	7.									
2.Ranch	6.Salt Box	10.Other		OPEN 5 OPTIONAL	0			2.Inadeq	5.	8.									
3.R Ranch	7.Contemp	11.Split		Heat Type	100% 1 Hot Water BB			3.Poor	6.	9.									
4.Cape	8.Log	12.		1.HWB	5.FWA	9.No Heat		Attic 9 None											
Dwelling Units	1			2.HWCI	6.GravWA	10.		1.1/4 Fin	4.Full Fin	7.									
Other Units	0			3.H Pump	7.Electric	11.		2.1/2 Fin	5.F/Stair	8.									
Stories	1 One Story			4.Steam	8.F/Wall	12.		3.3/4 Fin	6.	9.None									
1.1	4.1.5	7.		Cool Type	0% 9 None			Insulation 1 Full											
2.2	5.1.75	8.		1.Refrig	4.W&C Air	7.		1.Full	4.Minimal	7.									
3.3	6.2.5	9.		2.Evapor	5.	8.		2.Heavy	5.Partial	8.									
Exterior Walls	2 Vinyl/Aluminum			3.H Pump	6.	9.None		3.Capped	6.	9.None									
1.Wood	5.Stucco	9.T-111		Kitchen Style	2 Typical			Unfinished % 0%											
2.Vin/Al	6.Brick	10.Other		1.Modern	4.Obsolete	7.		Grade & Factor 3 Average 105%											
3.Compos.	7.Stone	11.		2.Typical	5.	8.		1.E Grade	4.B Grade	7.									
4.Asbestos	8.Concrete	12.		3.Old Type	6.	9.None		2.D Grade	5.A Grade	8.SC Grade									
Roof Surface	1 Asphalt Shingles			Bath(s) Style	2 Typical Bath(s)			3.C Grade 6.AA Grade 9.Same											
1.Asphalt	4.Composit	7.		1.Modern	4.Obsolete	7.		SQFT (Footprint) 1888											
2.Slate	5.Wood	8.		2.Typical	5.	8.		Condition 7 Very Good											
3.Metal	6.Other	9.		3.Old Type	6.	9.None		1.Poor	4.Avg	7.V G									
SF Masonry Trim	0			# Rooms	5			2.Fair	5.Avg+	8.Exc									
OPEN-3-CUSTOM	0			# Bedrooms	3			3.Avg-	6.Good	9.Same									
OPEN-4-CUSTOM	0			# Full Baths	2			Phys. % Good 0%											
Year Built	1988			# Half Baths	0			Funct. % Good 100%											
Year Remodeled	2017			# Addn Fixtures	0			Functional Code 9 None											
Foundation	1 Concrete			# Fireplaces	0			1.Incomp	4.Delap	7.No Power									
1.Concrete	4.Wood	7.									2.O-Built	5.Bsmt	8.LongTerm						
2.C Block	5.Slab	8.									Econ. % Good 100%			3.Damage	6.Common	9.None			
3.Br/Stone	6.Piers	9.									Economic Code None			0.None 3.No Power 7.					
Basement	4 Full Basement										1 Location 4.Generate 8.			2.Encroach 9.None 9.					
1.1/4 Bmt	4.Full Bmt	7.									Entrance Code 1 Interior Inspect			1.Interior 4.Vacant 7.					
2.1/2 Bmt	5.None	8.									2.Refusal 5.Estimate 8.			3.Informed 6.Reviewed 9.					
3.3/4 Bmt	6.	9.None									Information Code 1 Owner			1.Owner 4.Agent 7.					
Bsmt Gar # Cars	0										2.Relative 5.Estimate 8.			3.Tenant 6.Other 9.					
Wet Basement	1 Dry Basement																		
1.Dry	4.	7.																	
2.Damp	5.	8.																	
3.Wet	6.	9.																	

Date Inspected 7/28/2018

Additions, Outbuildings & Improvements

Type	Year	Units	Grade	Cond	Phys.	Funct.	Sound Value
23 Frame Garage	1988	768	3 100	5	0 %	100 %	
24 Frame Shed	0				%	%	250
					%	%	
					%	%	
					%	%	
					%	%	
					%	%	
					%	%	
					%	%	
					%	%	
					%	%	
					%	%	

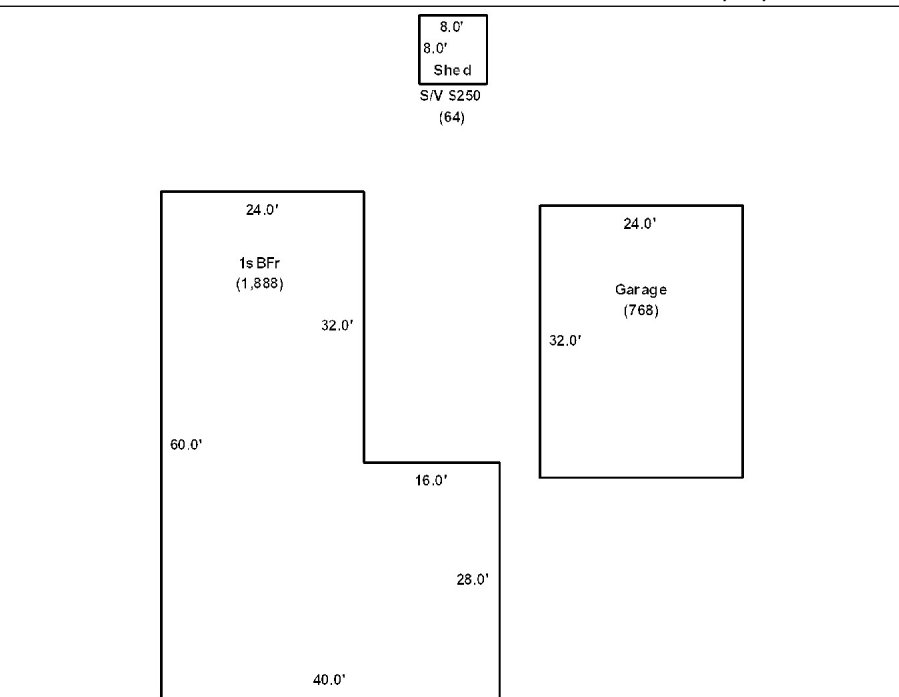

COASTAL MAINE LLC
255 US HWY 1
COLUMBIA ME 04623

B5215P134 B6403P20

Previous Owner
NORTHERN NEW ENGLAND TELEPHONE OPERATIONS LLC
P.O. BOX 1659

BANGOR ME 04402 1659
Sale Date: 7/30/2013

Inspection Witnessed By:

X Date

No./Date	Description	Date Insp.

Notes:

Washburn

Property Data			Assessment Record						
Neighborhood 1 Neighborhood One			Year	Land	Buildings	Exempt	Total		
Tree Growth Year 0			2012	2,400	0	0	2,400		
1ST MORTGAGE 0			2013	3,100	0	0	3,100		
2ND MORTGAGE 0			2015	3,100	0	0	3,100		
Zone/Land Use 1 Residential			2018	3,100	0	0	3,100		
Secondary Zone			2019	4,800	0	0	4,800		
Topography 2 Rolling			2020	4,800	0	0	4,800		
1.Level 4.Below St 7.LevelBog			2021	4,800	0	0	4,800		
2.Rolling 5.Low 8.			2022	4,800	0	0	4,800		
3.Above St 6.Swampy 9.			2023	5,800	0	0	5,800		
Utilities			2024	5,800	0	0	5,800		
1.Public 4.Dr Well 7.Cesspool									
2.Water 5.Dug Well 8.									
3.Sewer 6.Septic 9.None									
Street 1 Paved									
1.Paved 4.Proposed 7.			Land Data						
2.Semi Imp 5.R/O/W 8.			Front Foot	Type	Effective		Influence		Influence Codes
3.Gravel 6. 9.None					Frontage	Depth	Factor	Code	
TG PLAN YEAR 0			11.Regular Lot					1.Unimproved	
Tif District # 0			12.Delta Triangle					2.Excess Frtg	
Sale Data			13.Nabla Triangle					3.Topography	
Sale Date 8/01/2013			14.Rear Land					4.Size/Shape	
Price 449			15.Class I Road					5.Access	
Sale Type 1 Land Only								6.Restriction	
1.Land 4.Mobile 7.C/I L&B			Square Foot	Square Feet				7.Open Space	
2.L & B 5.Other 8.								8.View/Environ	
3.Building 6.C/I Land 9.			16.Class II Road					9.Fract Share	
Financing			17.Municipal Rese					Acres	
1.Convent 4.Seller 7.			18.Munic Sep Lago					30.Utility R O W	
2.FHA/VA 5.Private 8.			19.Gravel Pit					31.Tillable	
3.Assumed 6.Cash 9.Unknown			20.Industrial Bas					32.Pasture	
Validity 1 Arms Length Sale								33.Orchard	
1.Valid 4.Split 7.Renovate			Fract. Acre	Acreege/Sites				34.Softwood F&O	
2.Related 5.Partial 8.Other			21.Developed Pave	22	0.28	100	%	0	35.Mixed Wood F&O
3.Distress 6.Exempt 9.			22.Undev Paved (F						36.Hardwood F&O
Verified 5 Public Record			23.Developed Grav						37.Softwood TG
1.Buyer 4.Agent 7.Family			Acres						38.Mixed Wood TG
2.Seller 5.Pub Rec 8.Other			24.Undev Gravel (39.Hardwood TG
3.Lender 6.MLS 9.			25.Comm Base Pave						40.Wasteland
			26.Comm Base Grav						41.Open Space
			27.Backlot						42.Mobile Home Si
			28.Rear Land	Total Acreage			0.28		43.Condo Site
			29.Pavement						44.Lot Improvemen
									45.Subdivision Lo
									46.Heavy Ind Sit

Washburn

Map Lot 001-017B

Account 785

Location WASHBURN ROAD

Card 1 Of 1 9/04/2024

Building Style 0	SF Bsmt Living 0	Layout 0
1.Conv. 5.Garrison 9.Gambrel	Fin Bsmt Grade 0 0	1.Typical 4. 7.
2.Ranch 6.Salt Box 10.Other	OPEN 5 OPTIONAL 0	2.Inadeq 5. 8.
3.R Ranch 7.Contemp 11.Split	Heat Type 100% 0	3.Poor 6. 9.
4.Cape 8.Log 12.	1.HWBB 5.FWA 9.No Heat	Attic 0
Dwelling Units 0	2.HWCI 6.GravWA 10.	1.1/4 Fin 4.Full Fin 7.
Other Units 0	3.H Pump 7.Electric 11.	2.1/2 Fin 5.FI/Stair 8.
Stories 0	4.Steam 8.FI/Wall 12.	3.3/4 Fin 6. 9.None
1.1 4.1.5 7.	Cool Type 0% 9 None	Insulation 0
2.2 5.1.75 8.	1.Refrig 4.W&C Air 7.	1.Full 4.Minimal 7.
3.3 6.2.5 9.	2.Evapor 5. 8.	2.Heavy 5.Partial 8.
Exterior Walls 0	3.H Pump 6. 9.None	3.Capped 6. 9.None
1.Wood 5.Stucco 9.T-111	Kitchen Style 0	Unfinished % 0%
2.Vin/Al 6.Brick 10.Other	1.Modern 4.Obsolete 7.	Grade & Factor 0 0%
3.Compos. 7.Stone 11.	2.Typical 5. 8.	1.E Grade 4.B Grade 7.
4.Asbestos 8.Concrete 12.	3.Old Type 6. 9.None	2.D Grade 5.A Grade 8.SC Grade
Roof Surface 0	Bath(s) Style 0	3.C Grade 6.AA Grade 9.Same
1.Asphalt 4.Composit 7.	1.Modern 4.Obsolete 7.	SQFT (Footprint) 0
2.Slate 5.Wood 8.	2.Typical 5. 8.	Condition 0
3.Metal 6.Other 9.	3.Old Type 6. 9.None	1.Poor 4.Avg 7.V G
SF Masonry Trim 0	# Rooms 0	2.Fair 5.Avg+ 8.Exc
OPEN-3-CUSTOM 0	# Bedrooms 0	3.Avg- 6.Good 9.Same
OPEN-4-CUSTOM 0	# Full Baths 0	Phys. % Good 0%
Year Built 0	# Half Baths 0	Funct. % Good 100%
Year Remodeled 0	# Addn Fixtures 0	Functional Code 9 None
Foundation 0	# Fireplaces 0	1.Incomp 4.Delap 7.No Power
1.Concrete 4.Wood 7.		2.O-Built 5.Bsmt 8.LongTerm
2.C Block 5.Slab 8.		3.Damage 6.Common 9.None
3.Br/Stone 6.Piers 9.		Econ. % Good 100%
Basement 0		Economic Code None
1.1/4 Bmt 4.Full Bmt 7.		0.None 3.No Power 7.
2.1/2 Bmt 5.None 8.		1.Location 4.Generate 8.
3.3/4 Bmt 6. 9.None		2.Encroach 9.None 9.
Bsmt Gar # Cars 0		Entrance Code 0
Wet Basement 0		1.Interior 4.Vacant 7.
1.Dry 4. 7.		2.Refusal 5.Estimate 8.
2.Damp 5. 8.	3.Informed 6.Reviewed 9.	
3.Wet 6. 9.	Information Code 0	
		1.Owner 4.Agent 7.
		2.Relative 5.Estimate 8.
		3.Tenant 6.Other 9.

Date Inspected

Additions, Outbuildings & Improvements

Type	Year	Units	Grade	Cond	Phys.	Funct.	Sound Value
					%	%	1.One Story Fram
					%	%	2.Two Story Fram
					%	%	3.Three Story Fr
					%	%	4.1 & 1/2 Story
					%	%	5.1 & 3/4 Story
					%	%	6.2 & 1/2 Story
					%	%	21.Open Frame Por
					%	%	22.Encl Frame Por
					%	%	23.Frame Garage
					%	%	24.Frame Shed
					%	%	25.Frame Bay Wind
					%	%	26.1SFr Overhang
					%	%	27.Unfin Basement
					%	%	28.Unfinished Att
					%	%	29.Finished Attic

SHAW, MIKE
888 Washburn Road
Washburn ME 04786

B3695P33

Inspection Witnessed By:

X	Date
No./Date	Description
	Date Insp.

Notes:
 *-20% for attached shed, -25% for A(unfin)Shed for delap, bsmt under dwelling is crumbling -5% fncl. during reval.
 -10% off baselot for shared dug well with lot 17-A.
 **Asphalt driveway breaking up-No Add

Washburn

Property Data			Assessment Record						
Neighborhood 1 Neighborhood One			Year	Land	Buildings	Exempt	Total		
Tree Growth Year 0			2012	8,500	30,900	8,800	30,600		
1ST MORTGAGE 0			2013	11,000	30,900	0	41,900		
2ND MORTGAGE 0			2015	11,000	30,900	0	41,900		
Zone/Land Use 1 Residential			2018	11,000	30,900	0	41,900		
Secondary Zone			2019	16,800	37,100	0	53,900		
Topography 1 Level			2020	16,800	37,100	0	53,900		
1.Level 4.Below St 7.LevelBog			2022	16,800	39,000	0	55,800		
2.Rolling 5.Low 8.			2023	22,100	46,400	0	68,500		
3.Above St 6.Swampy 9.			2024	22,100	46,400	25,000	43,500		
Utilities 5 Dug Well 6 Septic System									
1.Public 4.Dr Well 7.Cesspool									
2.Water 5.Dug Well 8.									
3.Sewer 6.Septic 9.None									
Street 1 Paved									
1.Paved 4.Proposed 7.									
2.Semi Imp 5.R/O/W 8.									
3.Gravel 6. 9.None									
TG PLAN YEAR 0									
Tif District # 0									
Sale Data			Land Data						
Sale Date 8/13/2002			Front Foot	Type	Effective		Influence		Influence Codes
Price 25,000					Frontage	Depth	Factor	Code	
Sale Type 2 Land & Buildings			11.Regular Lot					1.Unimproved	
1.Land 4.Mobile 7.C/I L&B			12.Delta Triangle					2.Excess Frtg	
2.L & B 5.Other 8.			13.Nabla Triangle					3.Topography	
3.Building 6.C/I Land 9.			14.Rear Land					4.Size/Shape	
Financing			15.Class I Road					5.Access	
1.Convent 4.Seller 7.								6.Restriction	
2.FHA/VA 5.Private 8.								7.Open Space	
3.Assumed 6.Cash 9.Unknown								8.View/Environ	
Validity 3 Distressed Sale								9.Fract Share	
1.Valid 4.Split 7.Renovate			Square Foot	Square Feet				Acres	
2.Related 5.Partial 8.Other			16.Class II Road					30.Utility R O W	
3.Distress 6.Exempt 9.			17.Municipal Rese					31.Tillable	
Verified 5 Public Record			18.Munic Sep Lago					32.Pasture	
1.Buyer 4.Agent 7.Family			19.Gravel Pit					33.Orchard	
2.Seller 5.Pub Rec 8.Other			20.Industrial Bas					34.Softwood F&O	
3.Lender 6.MLS 9.								35.Mixed Wood F&O	
			Fract. Acre	Acres/Sites				36.Hardwood F&O	
			21.Developed Pave	21	1.00	90	% 0	37.Softwood TG	
			22.Undev Paved (F	28	3.90	100	% 0	38.Mixed Wood TG	
			23.Developed Grav					39.Hardwood TG	
			Acres					40.Wasteland	
			24.Undev Gravel (41.Open Space	
			25.Comm Base Pave					42.Mobile Home Si	
			26.Comm Base Grav					43.Condo Site	
			27.Backlot					44.Lot Improvemen	
			28.Rear Land					45.Subdivision Lo	
			29.Pavement					46.Heavy Ind Sit	
			Total Acreage		4.90				

Washburn

Map Lot 001-017C

Account 831

Location 888 WASHBURN ROAD

Card 1 Of 1 9/04/2024

Building Style	1 Conventional			SF Bsmt Living	0			Layout	1 Typical		
1.Conv.	5.Garrison	9.Gambrel		Fin Bsmt Grade	0 0			1.Typical	4.	7.	
2.Ranch	6.Salt Box	10.Other		OPEN 5 OPTIONAL	0			2.Inadeq	5.	8.	
3.R Ranch	7.Contemp	11.Split		Heat Type	100% 5 Forced Warm Air			3.Pool	6.	9.	
4.Cape	8.Log	12.		1.HWBB	5.FWA	9.No Heat	Attic	9 None			
Dwelling Units	1			2.HWCI	6.GravWA	10.	1.1/4 Fin	4.Full Fin	7.		
Other Units	0			3.H Pump	7.Electric	11.	2.1/2 Fin	5.FI/Stair	8.		
Stories	4 One & 1/2 Story			4.Steam	8.FI/Wall	12.	3.3/4 Fin	6.	9.None		
1.1	4.1.5	7.		Cool Type	0% 9 None			Insulation	4 Minimal		
2.2	5.1.75	8.		1.Refrig	4.W&C Air	7.	1.Full	4.Minimal	7.		
3.3	6.2.5	9.		2.Evapor	5.	8.	2.Heavy	5.Partial	8.		
Exterior Walls	1 Wood Siding			3.H Pump	6.	9.None	3.Capped	6.	9.None		
1.Wood	5.Stucco	9.T-111		Kitchen Style	3 Old Style			Unfinished %	0%		
2.Vin/Al	6.Brick	10.Other		1.Modern	4.Obsolete	7.	Grade & Factor	2 Fair 110%			
3.Compos.	7.Stone	11.		2.Typical	5.	8.	1.E Grade	4.B Grade	7.		
4.Asbestos	8.Concrete	12.		3.Old Type	6.	9.None	2.D Grade	5.A Grade	8.SC Grade		
Roof Surface	3 Sheet Metal			Bath(s) Style	3 Old Style			3.C Grade	6.AA Grade	9.Same	
1.Asphalt	4.Composit	7.		1.Modern	4.Obsolete	7.	SQFT (Footprint)	1036			
2.Slate	5.Wood	8.		2.Typical	5.	8.	Condition	3 Below Average			
3.Metal	6.Other	9.		3.Old Type	6.	9.None	1.Poor	4.Avg	7.V G		
SF Masonry Trim	0			# Rooms	8			2.Fair	5.Avg+	8.Exc	
OPEN-3-CUSTOM	0			# Bedrooms	3			3.Avg-	6.Good	9.Same	
OPEN-4-CUSTOM	0			# Full Baths	1			Phys. % Good	0%		
Year Built	1900			# Half Baths	1			Funct. % Good	95%		
Year Remodeled	0			# Addn Fixtures	0			Functional Code	4 Delapidation		
Foundation	3 Brick &/or Stone			# Fireplaces	1			1.Incomp	4.Delap	7.No Power	
1.Concrete	4.Wood	7.		 <p>TRIO Software <i>A Division of Harris Computer Systems</i></p>	2.O-Built	5.Bsmt	8.LongTerm				
2.C Block	5.Slab	8.			3.Damage	6.Common	9.None				
3.Br/Stone	6.Piers	9.			Econ. % Good	100%					
Basement	3 3/4 Basement				Economic Code	None					
1.1/4 Bmt	4.Full Bmt	7.			0.None	3.No Power	7.				
2.1/2 Bmt	5.None	8.			1.Location	4.Generate	8.				
3.3/4 Bmt	6.	9.None			2.Encroach	9.None	9.				
Bsmt Gar # Cars	0				Entrance Code	5 Estimated					
Wet Basement	3 Wet Basement				1.Interior	4.Vacant	7.				
1.Dry	4.	7.			2.Refusal	5.Estimate	8.				
2.Damp	5.	8.		3.Informed	6.Reviewed	9.					
3.Wet	6.	9.		Information Code	5 Estimate						
				1.Owner	4.Agent	7.					
				2.Relative	5.Estimate	8.					
				3.Tenant	6.Other	9.					

Date Inspected 7/28/2018

Additions, Outbuildings & Improvements

Type	Year	Units	Grade	Cond	Phys.	Funct.	Sound Value
24 Frame Shed	0	252	2 100	3	0 %	80 %	
24 Frame Shed	0	520	2 100	2	0 %	75 %	
28 Unfinished Attic	0	520	2 100	2	0 %	100 %	
					%	%	
					%	%	
					%	%	
					%	%	
					%	%	
					%	%	
					%	%	
					%	%	

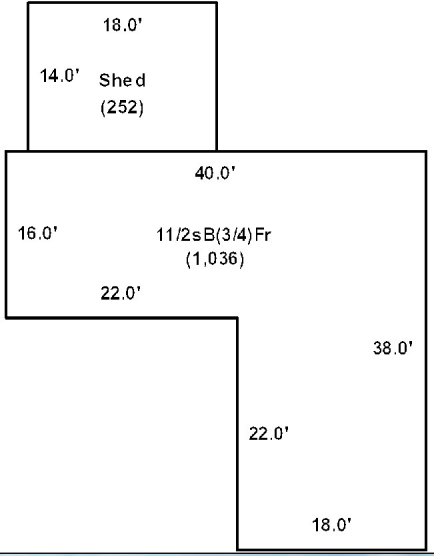
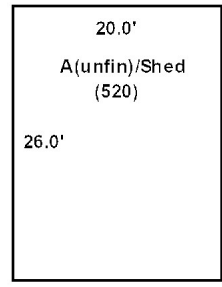

Washburn

Map Lot 001-017D

Account 528

Location 910 WASHBURN ROAD

Card 1 Of 1 9/04/2024

Building Style	2 Ranch		SF Bsmt Living	500		Layout	1 Typical							
1.Conv.	5.Garrison	9.Gambrel	Fin Bsmt Grade	9 100		1.Typical	4.	7.						
2.Ranch	6.Salt Box	10.Other	OPEN 5 OPTIONAL	0		2.Inadeq	5.	8.						
3.R Ranch	7.Contemp	11.Split	Heat Type	100% 1 Hot Water BB		3.Poor	6.	9.						
4.Cape	8.Log	12.	1.HWB	5.FWA	9.No Heat	Attic	9 None							
Dwelling Units	1		2.HWCI	6.GravWA	10.	1.1/4 Fin	4.Full Fin	7.						
Other Units	0		3.H Pump	7.Electric	11.	2.1/2 Fin	5.FI/Stair	8.						
Stories	1 One Story		4.Steam	8.FI/Wall	12.	3.3/4 Fin	6.	9.None						
1.1	4.1.5	7.	Cool Type	0% 9 None		Insulation	1 Full							
2.2	5.1.75	8.	1.Refrig	4.W&C Air	7.	1.Full	4.Minimal	7.						
3.3	6.2.5	9.	2.Evapor	5.	8.	2.Heavy	5.Partial	8.						
Exterior Walls	2 Vinyl/Aluminum		3.H Pump	6.	9.None	3.Capped	6.	9.None						
1.Wood	5.Stucco	9.T-111	Kitchen Style	2 Typical		Unfinished %	0%							
2.Vin/Al	6.Brick	10.Other	1.Modern	4.Obsolete	7.	Grade & Factor	3 Average 110%							
3.Compos.	7.Stone	11.	2.Typical	5.	8.	1.E Grade	4.B Grade	7.						
4.Asbestos	8.Concrete	12.	3.Old Type	6.	9.None	2.D Grade	5.A Grade	8.SC Grade						
Roof Surface	1 Asphalt Shingles		Bath(s) Style	2 Typical Bath(s)		3.C Grade	6.AA Grade	9.Same						
1.Asphalt	4.Composit	7.	1.Modern	4.Obsolete	7.	SQFT (Footprint)	1764							
2.Slate	5.Wood	8.	2.Typical	5.	8.	Condition	5 Above Average							
3.Metal	6.Other	9.	3.Old Type	6.	9.None	1.Poor	4.Avg	7.V G						
SF Masonry Trim	0		# Rooms	7		2.Fair	5.Avg+	8.Exc						
OPEN-3-CUSTOM	0		# Bedrooms	3		3.Avg-	6.Good	9.Same						
OPEN-4-CUSTOM	0		# Full Baths	2		Phys. % Good	0%							
Year Built	2005		# Half Baths	0		Funct. % Good	100%							
Year Remodeled	0		# Addn Fixtures	0		Functional Code	9 None							
Foundation	1 Concrete		# Fireplaces	0		1.Incomp	4.Delap	7.No Power						
1.Concrete	4.Wood	7.							2.O-Built	5.Bsmt	8.LongTerm			
2.C Block	5.Slab	8.							Econ. % Good	100%		3.Damage	6.Common	9.None
3.Br/Stone	6.Piers	9.							Economic Code	None		0.None	3.No Power	7.
Basement	4 Full Basement								1.Location	4.Generate	8.	1.Encroach	9.None	9.
1.1/4 Bmt	4.Full Bmt	7.							Entrance Code	5 Estimated		1.Interior	4.Vacant	7.
2.1/2 Bmt	5.None	8.							2.Refusal	5.Estimate	8.	2.Informed	6.Reviewed	9.
3.3/4 Bmt	6.	9.None							Information Code	5 Estimate		1.Owner	4.Agent	7.
Bsmt Gar # Cars	0								2.Relative	5.Estimate	8.	3.Tenant	6.Other	9.
Wet Basement	1 Dry Basement													
1.Dry	4.	7.												
2.Damp	5.	8.												
3.Wet	6.	9.												

12.0'
Shed
S/V \$1,500
20.0'

(240)

12.0'
8.0' Shed
(96)
S/V \$750

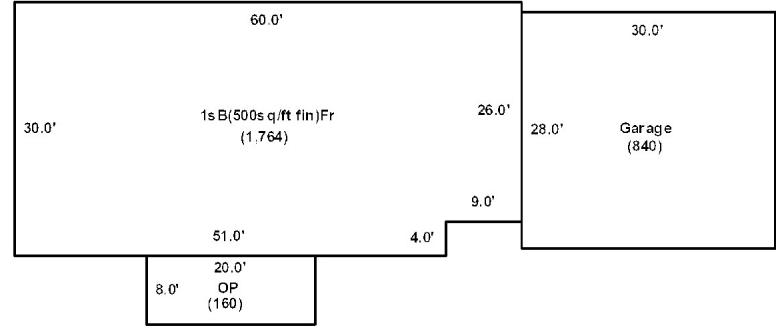

Date Inspected 7/28/2018

Additions, Outbuildings & Improvements

Type	Year	Units	Grade	Cond	Phys.	Funct.	Sound Value
23 Frame Garage	0	840	0 0	0	0 %	85 %	
21 Open Frame	2010	160	0 0	0	0 %	0 %	
24 Frame Shed	0				%	%	1,500
24 Frame Shed	0				%	%	750
					%	%	
					%	%	
					%	%	
					%	%	
					%	%	
					%	%	
					%	%	



- 1.One Story Fram
- 2.Two Story Fram
- 3.Three Story Fr
- 4.1 & 1/2 Story
- 5.1 & 3/4 Story
- 6.2 & 1/2 Story
- 21.Open Frame Por
- 22.Encl Frame Por
- 23.Frame Garage
- 24.Frame Shed
- 25.Frame Bay Wind
- 26.1SFr Overhang
- 27.Unfin Basement
- 28.Unfinished Att
- 29.Finished Attic

IRELAND, TINA
BUBAR, RICHARD
94 WEST RIDGE ROAD
EASTON ME 04740

B5759P86

Previous Owner
GRIVOIS, KEITH J.
GRIVOIS, MARINA
542 MORRISON FARM ROAD
MARIAVILLE ME 04605
Sale Date: 3/23/2018

Previous Owner
Eldredge, Edgar F. Jr.
P.O. Box 1461

Buzzards Bay MA 02532
Sale Date: 9/28/2007

Previous Owner
Carmichael, James R.
Carmichael, Karen
P.O. Box 443
Crouseville ME 04738
Sale Date: 1/25/2007

Inspection Witnessed By:

X	Date	Date Insp.
No./Date	Description	Date Insp.

Notes:

Washburn

Property Data			Assessment Record						
Neighborhood 1 Neighborhood One			Year	Land	Buildings	Exempt	Total		
Tree Growth Year 0			2012	6,300	0	0	6,300		
1ST MORTGAGE 0			2013	8,200	0	0	8,200		
2ND MORTGAGE 0			2015	8,200	0	0	8,200		
Zone/Land Use 1 Residential			2018	8,200	0	0	8,200		
Secondary Zone			2019	11,600	0	0	11,600		
Topography 2 Rolling			2020	11,600	0	0	11,600		
1.Level 4.Below St 7.LevelBog			2021	11,600	0	0	11,600		
2.Rolling 5.Low 8.			2022	11,600	0	0	11,600		
3.Above St 6.Swampy 9.			2023	14,000	0	0	14,000		
Utilities			2024	14,000	0	0	14,000		
1.Public 4.Dr Well 7.Cesspool									
2.Water 5.Dug Well 8.									
3.Sewer 6.Septic 9.None									
Street 1 Paved									
1.Paved 4.Proposed 7.			Land Data						
2.Semi Imp 5.R/O/W 8.									
3.Gravel 6. 9.None			Front Foot	Type	Effective		Influence		Influence Codes
TG PLAN YEAR 0			11.Regular Lot		Frontage	Depth	Factor	Code	
Tif District # 0			12.Delta Triangle				%		1.Unimproved
Sale Data			13.Nabla Triangle				%		2.Excess Frtg
Sale Date 3/23/2018			14.Rear Land				%		3.Topography
Price 18,500			15.Class I Road				%		4.Size/Shape
Sale Type 1 Land Only							%		5.Access
1.Land 4.Mobile 7.C/I L&B							%		6.Restriction
2.L & B 5.Other 8.			Square Foot	Square Feet					7.Open Space
3.Building 6.C/I Land 9.			16.Class II Road				%		8.View/Environ
Financing 1 Conventional			17.Municipal Rese				%		9.Fract Share
1.Convent 4.Seller 7.			18.Munic Sep Lago				%		Acres
2.FHA/VA 5.Private 8.			19.Gravel Pit				%		30.Utility R O W
3.Assumed 6.Cash 9.Unknown			20.Industrial Bas				%		31.Tillable
Validity 1 Arms Length Sale							%		32.Pasture
1.Valid 4.Split 7.Renovate			Fract. Acre	Acreege/Sites					33.Orchard
2.Related 5.Partial 8.Other			21.Developed Pave	22	1.00	100	%	0	34.Softwood F&O
3.Distress 6.Exempt 9.			22.Undev Paved (F	28	5.10	100	%	0	35.Mixed Wood F&O
Verified 5 Public Record			23.Developed Grav				%		36.Hardwood F&O
1.Buyer 4.Agent 7.Family			Acres				%		37.Softwood TG
2.Seller 5.Pub Rec 8.Other			24.Undev Gravel (%		38.Mixed Wood TG
3.Lender 6.MLS 9.			25.Comm Base Pave				%		39.Hardwood TG
			26.Comm Base Grav				%		40.Wasteland
			27.Backlot				%		41.Open Space
			28.Rear Land				%		42.Mobile Home Si
			29.Pavement				%		43.Condo Site
			Total Acreage		6.10				44.Lot Improvemen
									45.Subdivision Lo
									46.Heavy Ind Sit

Washburn

Map Lot 001-018

Account 84

Location 860 WASHBURN ROAD

Card 1 Of 1 9/04/2024

Building Style 0	SF Bsmt Living 0	Layout 0
1.Conv. 5.Garrison 9.Gambrel	Fin Bsmt Grade 0 0	1.Typical 4. 7.
2.Ranch 6.Salt Box 10.Other	OPEN 5 OPTIONAL 0	2.Inadeq 5. 8.
3.R Ranch 7.Contemp 11.Split	Heat Type 100% 0	3.Poor 6. 9.
4.Cape 8.Log 12.	1.HWBB 5.FWA 9.No Heat	Attic 0
Dwelling Units 0	2.HWCI 6.GravWA 10.	1.1/4 Fin 4.Full Fin 7.
Other Units 0	3.H Pump 7.Electric 11.	2.1/2 Fin 5.F/Stair 8.
Stories 0	4.Steam 8.F/Wall 12.	3.3/4 Fin 6. 9.None
1.1 4.1.5 7.	Cool Type 0% 9 None	Insulation 0
2.2 5.1.75 8.	1.Refrig 4.W&C Air 7.	1.Full 4.Minimal 7.
3.3 6.2.5 9.	2.Evapor 5. 8.	2.Heavy 5.Partial 8.
Exterior Walls 0	3.H Pump 6. 9.None	3.Capped 6. 9.None
1.Wood 5.Stucco 9.T-111	Kitchen Style 0	Unfinished % 0%
2.Vin/Al 6.Brick 10.Other	1.Modern 4.Obsolete 7.	Grade & Factor 0 0%
3.Compos. 7.Stone 11.	2.Typical 5. 8.	1.E Grade 4.B Grade 7.
4.Asbestos 8.Concrete 12.	3.Old Type 6. 9.None	2.D Grade 5.A Grade 8.SC Grade
Roof Surface 0	Bath(s) Style 0	3.C Grade 6.AA Grade 9.Same
1.Asphalt 4.Composit 7.	1.Modern 4.Obsolete 7.	SQFT (Footprint) 0
2.Slate 5.Wood 8.	2.Typical 5. 8.	Condition 0
3.Metal 6.Other 9.	3.Old Type 6. 9.None	1.Poor 4.Avg 7.V G
SF Masonry Trim 0	# Rooms 0	2.Fair 5.Avg+ 8.Exc
OPEN-3-CUSTOM 0	# Bedrooms 0	3.Avg- 6.Good 9.Same
OPEN-4-CUSTOM 0	# Full Baths 0	Phys. % Good 0%
Year Built 0	# Half Baths 0	Funct. % Good 100%
Year Remodeled 0	# Addn Fixtures 0	Functional Code 9 None
Foundation 0	# Fireplaces 0	1.Incomp 4.Delap 7.No Power
1.Concrete 4.Wood 7.		2.O-Built 5.Bsmt 8.LongTerm
2.C Block 5.Slab 8.		3.Damage 6.Common 9.None
3.Br/Stone 6.Piers 9.		Econ. % Good 100%
Basement 0		Economic Code None
1.1/4 Bmt 4.Full Bmt 7.		0.None 3.No Power 7.
2.1/2 Bmt 5.None 8.		1.Location 4.Generate 8.
3.3/4 Bmt 6. 9.None		2.Encroach 9.None 9.
Bsmt Gar # Cars 0		Entrance Code 0
Wet Basement 0		1.Interior 4.Vacant 7.
1.Dry 4. 7.		2.Refusal 5.Estimate 8.
2.Damp 5. 8.	3.Informed 6.Reviewed 9.	
3.Wet 6. 9.	Information Code 0	
		1.Owner 4.Agent 7.
		2.Relative 5.Estimate 8.
		3.Tenant 6.Other 9.

Date Inspected

Additions, Outbuildings & Improvements								
Type	Year	Units	Grade	Cond	Phys.	Funct.	Sound Value	
					%	%		1.One Story Fram
					%	%		2.Two Story Fram
					%	%		3.Three Story Fr
					%	%		4.1 & 1/2 Story
					%	%		5.1 & 3/4 Story
					%	%		6.2 & 1/2 Story
					%	%		21.Open Frame Por
					%	%		22.Encl Frame Por
					%	%		23.Frame Garage
					%	%		24.Frame Shed
					%	%		25.Frame Bay Wind
					%	%		26.1SFr Overhang
					%	%		27.Unfin Basement
					%	%		28.Unfinished Att
					%	%		29.Finished Attic

GREENLAW, FRANCIS E JR
GREENLAW, MARY T
926 Washburn Road
Washburn ME 04786

B6538P230

Previous Owner
Weiss, Mark
Weiss, Yuly
926 Washburn Road
Washburn ME 04786
Sale Date: 3/12/2024

Previous Owner
BARNES, ALAN J
BARNES, SUE D (McQUAID)
C/O JAMY LYN FLYNN
STAFFORD VA 22556
Sale Date: 9/13/2021

Inspection Witnessed By:

X	Date
No./Date	Description
	Date Insp.

Notes:
*-20% for attached garage during reval.
* J & J Amish shed for 04/01/2024 GSR

Washburn

Property Data			Assessment Record						
Neighborhood 1 Neighborhood One			Year	Land	Buildings	Exempt	Total		
Tree Growth Year 0			2012	7,800	82,900	8,800	81,900		
1ST MORTGAGE 0			2013	10,100	82,900	8,800	84,200		
2ND MORTGAGE 0			2015	10,100	82,900	9,000	84,000		
Zone/Land Use 1 Residential			2018	10,100	82,900	18,400	74,600		
Secondary Zone			2019	17,800	72,100	20,000	69,900		
Topography 2 Rolling			2020	17,800	72,100	25,000	64,900		
1.Level 4.Below St 7.LevelBog			2021	17,800	72,100	0	89,900		
2.Rolling 5.Low 8.			2022	17,800	75,700	0	93,500		
3.Above St 6.Swampy 9.			2023	23,500	90,000	25,000	88,500		
Utilities 4 Drilled Well 6 Septic System			2024	23,500	94,800	0	118,300		
1.Public 4.Dr Well 7.Cesspool									
2.Water 5.Dug Well 8.									
3.Sewer 6.Septic 9.None									
Street 1 Paved									
1.Paved 4.Proposed 7.									
2.Semi Imp 5.R/O/W 8.									
3.Gravel 6. 9.None									
TG PLAN YEAR 0									
Tif District # 0									
Sale Data			Land Data						
Sale Date 3/12/2024			Front Foot	Type	Effective		Influence		Influence Codes
Price 212,500					Frontage	Depth	Factor	Code	
Sale Type 2 Land & Buildings			11.Regular Lot					1.Unimproved	
1.Land 4.Mobile 7.C/I L&B			12.Delta Triangle			%		2.Excess Frtg	
2.L & B 5.Other 8.			13.Nabla Triangle			%		3.Topography	
3.Building 6.C/I Land 9.			14.Rear Land			%		4.Size/Shape	
Financing 1 Conventional			15.Class I Road			%		5.Access	
1.Convent 4.Seller 7.						%		6.Restriction	
2.FHA/VA 5.Private 8.						%		7.Open Space	
3.Assumed 6.Cash 9.Unknown						%		8.View/Environ	
Validity 1 Arms Length Sale						%		9.Fract Share	
1.Valid 4.Split 7.Renovate			Square Foot	Square Feet				Acres	
2.Related 5.Partial 8.Other			16.Class II Road			%		30.Utility R O W	
3.Distress 6.Exempt 9.			17.Municipal Rese			%		31.Tillable	
Verified 5 Public Record			18.Munic Sep Lago			%		32.Pasture	
1.Buyer 4.Agent 7.Family			19.Gravel Pit			%		33.Orchard	
2.Seller 5.Pub Rec 8.Other			20.Industrial Bas			%		34.Softwood F&O	
3.Lender 6.MLS 9.						%		35.Mixed Wood F&O	
			Fract. Acre	Acres/Sites				36.Hardwood F&O	
			21.Developed Pave	21	1.00	100	% 0	37.Softwood TG	
			22.Undev Paved (F	28	2.60	100	% 0	38.Mixed Wood TG	
			23.Developed Grav				%	39.Hardwood TG	
			Acres				%	40.Wasteland	
			24.Undev Gravel (%	41.Open Space	
			25.Comm Base Pave				%	42.Mobile Home Si	
			26.Comm Base Grav				%	43.Condo Site	
			27.Backlot				%	44.Lot Improvemen	
			28.Rear Land				%	45.Subdivision Lo	
			29.Pavement				%	46.Heavy Ind Sit	
			Total Acreage		3.60				

SULLIVAN, RAYMOND A
SULLIVAN, WILENA A
936 WASHBURN ROAD
WASHBURN ME 04786

B5425P42 B5987P22

Previous Owner
AEGERTER, DENO L.
3753 Salmons Blackjack Road

Franklin KY 42134
Sale Date: 2/01/2020

Inspection Witnessed By:

X	Date
No./Date	Description
	Date Insp.

Notes:
* Added deck for 2021. 4-7-2021 ED
*-10% for 1/2 attached garage during reval.

Washburn

Property Data			Assessment Record						
Neighborhood 1 Neighborhood One			Year	Land	Buildings	Exempt	Total		
Tree Growth Year 0			2012	8,000	98,000	8,800	97,200		
1ST MORTGAGE 0			2013	10,400	98,000	8,800	99,600		
2ND MORTGAGE 0			2015	10,400	98,000	9,000	99,400		
Zone/Land Use 1 Residential			2018	10,400	98,000	0	108,400		
Secondary Zone			2019	18,000	94,900	0	112,900		
Topography 2 Rolling			2020	18,000	94,900	25,000	87,900		
1.Level 4.Below St 7.LevelBog			2021	18,000	97,400	25,000	90,400		
2.Rolling 5.Low 8.			2022	18,000	102,300	25,000	95,300		
3.Above St 6.Swampy 9.			2023	23,700	121,800	25,000	120,500		
Utilities 4 Drilled Well 6 Septic System			2024	23,700	121,800	25,000	120,500		
1.Public 4.Dr Well 7.Cesspool									
2.Water 5.Dug Well 8.									
3.Sewer 6.Septic 9.None									
Street 1 Paved									
1.Paved 4.Proposed 7.									
2.Semi Imp 5.R/O/W 8.									
3.Gravel 6. 9.None									
TG PLAN YEAR 0									
Tif District # 0									
Sale Data			Land Data						
Sale Date 2/01/2020			Front Foot	Type	Effective		Influence		Influence Codes
Price 150,000					Frontage	Depth	Factor	Code	
Sale Type 2 Land & Buildings			11.Regular Lot					1.Unimproved	
1.Land 4.Mobile 7.C/I L&B			12.Delta Triangle					2.Excess Frtg	
2.L & B 5.Other 8.			13.Nabla Triangle					3.Topography	
3.Building 6.C/I Land 9.			14.Rear Land					4.Size/Shape	
Financing 1 Conventional			15.Class I Road					5.Access	
1.Convent 4.Seller 7.								6.Restriction	
2.FHA/VA 5.Private 8.								7.Open Space	
3.Assumed 6.Cash 9.Unknown								8.View/Environ	
Validity 1 Arms Length Sale								9.Fract Share	
1.Valid 4.Split 7.Renovate			Square Foot	Square Feet				Acres	
2.Related 5.Partial 8.Other			16.Class II Road					30.Utility R O W	
3.Distress 6.Exempt 9.			17.Municipal Rese					31.Tillable	
Verified 5 Public Record			18.Munic Sep Lago					32.Pasture	
1.Buyer 4.Agent 7.Family			19.Gravel Pit					33.Orchard	
2.Seller 5.Pub Rec 8.Other			20.Industrial Bas					34.Softwood F&O	
3.Lender 6.MLS 9.								35.Mixed Wood F&O	
			Fract. Acre	Acres/Sites				36.Hardwood F&O	
			21.Developed Pave	21	1.00	100	%	0	
			22.Undev Paved (F	28	2.96	100	%	0	
			23.Developed Grav						
			Acres						
			24.Undev Gravel (
			25.Comm Base Pave						
			26.Comm Base Grav						
			27.Backlot						
			28.Rear Land						
			29.Pavement						
			Total Acreage		3.96				
								44.Lot Improvemen	
								45.Subdivision Lo	
								46.Heavy Ind Sit	

Washburn

Map Lot 001-020

Account 1072

Location 936 WASHBURN ROAD

Card 1

Of 1

9/04/2024

Building Style	2 Ranch		SF Bsmt Living	400		Layout	1 Typical							
1.Conv.	5.Garrison	9.Gambrel	Fin Bsmt Grade	9 100		1.Typical	4.	7.						
2.Ranch	6.Salt Box	10.Other	OPEN 5 OPTIONAL	0		2.Inadeq	5.	8.						
3.R Ranch	7.Contemp	11.Split	Heat Type	100% 1 Hot Water BB		3.Poor	6.	9.						
4.Cape	8.Log	12.	1.HWBB	5.FWA	9.No Heat	Attic	9 None							
Dwelling Units	1		2.HWCI	6.GravWA	10.	1.1/4 Fin	4.Full Fin	7.						
Other Units	0		3.H Pump	7.Electric	11.	2.1/2 Fin	5.FI/Stair	8.						
Stories	1 One Story		4.Steam	8.FI/Wall	12.	3.3/4 Fin	6.	9.None						
1.1	4.1.5	7.	Cool Type	0% 9 None		Insulation	1 Full							
2.2	5.1.75	8.	1.Refrig	4.W&C Air	7.	1.Full	4.Minimal	7.						
3.3	6.2.5	9.	2.Evapor	5.	8.	2.Heavy	5.Partial	8.						
Exterior Walls	2 Vinyl/Aluminum		3.H Pump	6.	9.None	3.Capped	6.	9.None						
1.Wood	5.Stucco	9.T-111	Kitchen Style	2 Typical		Unfinished %	0%							
2.Vin/Al	6.Brick	10.Other	1.Modern	4.Obsolete	7.	Grade & Factor	3 Average 110%							
3.Compos.	7.Stone	11.	2.Typical	5.	8.	1.E Grade	4.B Grade	7.						
4.Asbestos	8.Concrete	12.	3.Old Type	6.	9.None	2.D Grade	5.A Grade	8.SC Grade						
Roof Surface	1 Asphalt Shingles		Bath(s) Style	2 Typical Bath(s)		3.C Grade	6.AA Grade	9.Same						
1.Asphalt	4.Composit	7.	1.Modern	4.Obsolete	7.	SQFT (Footprint)	1512							
2.Slate	5.Wood	8.	2.Typical	5.	8.	Condition	5 Above Average							
3.Metal	6.Other	9.	3.Old Type	6.	9.None	1.Poor	4.Avg	7.V G						
SF Masonry Trim	0		# Rooms	6		2.Fair	5.Avg+	8.Exc						
OPEN-3-CUSTOM	0		# Bedrooms	2		3.Avg-	6.Good	9.Same						
OPEN-4-CUSTOM	0		# Full Baths	2		Phys. % Good	0%							
Year Built	2004		# Half Baths	0		Funct. % Good	100%							
Year Remodeled	0		# Addn Fixtures	0		Functional Code	9 None							
Foundation	1 Concrete		# Fireplaces	0		1.Incomp	4.Delap	7.No Power						
1.Concrete	4.Wood	7.							2.O-Built	5.Bsmt	8.LongTerm			
2.C Block	5.Slab	8.							Economic Code	None		3.Damage	6.Common	9.None
3.Br/Stone	6.Piers	9.							0.None	3.No Power	7.	Econ. % Good	100%	
Basement	4 Full Basement								1.Location	4.Generate	8.	Entrance Code	5 Estimated	
1.1/4 Bmt	4.Full Bmt	7.							2.Encroach	9.None	9.	1.Interior	4.Vacant	7.
2.1/2 Bmt	5.None	8.							Information Code	5 Estimate		2.Refusal	5.Estimate	8.
3.3/4 Bmt	6.	9.None							1.Owner	4.Agent	7.	3.Informed	6.Reviewed	9.
Bsmt Gar # Cars	0								2.Relative	5.Estimate	8.	Information Code	5 Estimate	
Wet Basement	1 Dry Basement								3.Tenant	6.Other	9.	1.Owner	4.Agent	7.
1.Dry	4.	7.												
2.Damp	5.	8.												
3.Wet	6.	9.												

Date Inspected 7/28/2018

Additions, Outbuildings & Improvements

Type	Year	Units	Grade	Cond	Phys.	Funct.	Sound Value	
23 Frame Garage	0	728	0 0	0	0 %	90 %		1.One Story Fram
68 Wood Deck	2005	80	0 0	0	0 %	0 %		2.Two Story Fram
68 Wood Deck	2020	320	3 110	4	0 %	100 %		3.Three Story Fr
					%	%		4.1 & 1/2 Story
					%	%		5.1 & 3/4 Story
					%	%		6.2 & 1/2 Story
					%	%		21.Open Frame Por
					%	%		22.Encl Frame Por
					%	%		23.Frame Garage
					%	%		24.Frame Shed
					%	%		25.Frame Bay Wind
					%	%		26.1SFr Overhang
					%	%		27.Unfin Basement
					%	%		28.Unfinished Att
					%	%		29.Finished Attic

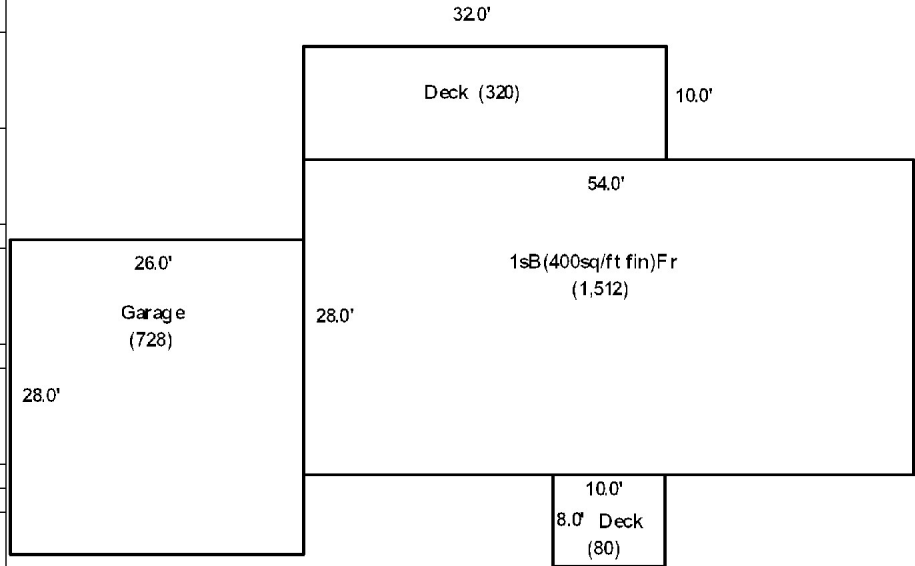

Washburn

Map Lot 001-021

Account 588

Location WASHBURN ROAD

Card 1 Of 1 9/04/2024

Building Style 0	SF Bsmt Living 0	Layout 0
1.Conv. 5.Garrison 9.Gambrel	Fin Bsmt Grade 0 0	1.Typical 4. 7.
2.Ranch 6.Salt Box 10.Other	OPEN 5 OPTIONAL 0	2.Inadeq 5. 8.
3.R Ranch 7.Contemp 11.Split	Heat Type 100% 0	3.Poor 6. 9.
4.Cape 8.Log 12.	1.HWBB 5.FWA 9.No Heat	Attic 0
Dwelling Units 0	2.HWCI 6.GravWA 10.	1.1/4 Fin 4.Full Fin 7.
Other Units 0	3.H Pump 7.Electric 11.	2.1/2 Fin 5.FI/Stair 8.
Stories 0	4.Steam 8.FI/Wall 12.	3.3/4 Fin 6. 9.None
1.1 4.1.5 7.	Cool Type 0% 9 None	Insulation 0
2.2 5.1.75 8.	1.Refrig 4.W&C Air 7.	1.Full 4.Minimal 7.
3.3 6.2.5 9.	2.Evapor 5. 8.	2.Heavy 5.Partial 8.
Exterior Walls 0	3.H Pump 6. 9.None	3.Capped 6. 9.None
1.Wood 5.Stucco 9.T-111	Kitchen Style 0	Unfinished % 0%
2.Vin/Al 6.Brick 10.Other	1.Modern 4.Obsolete 7.	Grade & Factor 0 0%
3.Compos. 7.Stone 11.	2.Typical 5. 8.	1.E Grade 4.B Grade 7.
4.Asbestos 8.Concrete 12.	3.Old Type 6. 9.None	2.D Grade 5.A Grade 8.SC Grade
Roof Surface 0	Bath(s) Style 0	3.C Grade 6.AA Grade 9.Same
1.Asphalt 4.Composit 7.	1.Modern 4.Obsolete 7.	SQFT (Footprint) 0
2.Slate 5.Wood 8.	2.Typical 5. 8.	Condition 0
3.Metal 6.Other 9.	3.Old Type 6. 9.None	1.Poor 4.Avg 7.V G
SF Masonry Trim 0	# Rooms 0	2.Fair 5.Avg+ 8.Exc
OPEN-3-CUSTOM 0	# Bedrooms 0	3.Avg- 6.Good 9.Same
OPEN-4-CUSTOM 0	# Full Baths 0	Phys. % Good 0%
Year Built 0	# Half Baths 0	Funct. % Good 100%
Year Remodeled 0	# Addn Fixtures 0	Functional Code 9 None
Foundation 0	# Fireplaces 0	1.Incomp 4.Delap 7.No Power
1.Concrete 4.Wood 7.		2.O-Built 5.Bsmt 8.LongTerm
2.C Block 5.Slab 8.		3.Damage 6.Common 9.None
3.Br/Stone 6.Piers 9.		Econ. % Good 100%
Basement 0		Economic Code None
1.1/4 Bmt 4.Full Bmt 7.		0.None 3.No Power 7.
2.1/2 Bmt 5.None 8.		1.Location 4.Generate 8.
3.3/4 Bmt 6. 9.None		2.Encroach 9.None 9.
Bsmt Gar # Cars 0		Entrance Code 0
Wet Basement 0		1.Interior 4.Vacant 7.
1.Dry 4. 7.		2.Refusal 5.Estimate 8.
2.Damp 5. 8.	3.Informed 6.Reviewed 9.	
3.Wet 6. 9.	Information Code 0	
		1.Owner 4.Agent 7.
		2.Relative 5.Estimate 8.
		3.Tenant 6.Other 9.

Date Inspected

Additions, Outbuildings & Improvements

Type	Year	Units	Grade	Cond	Phys.	Funct.	Sound Value
					%	%	1.One Story Fram
					%	%	2.Two Story Fram
					%	%	3.Three Story Fr
					%	%	4.1 & 1/2 Story
					%	%	5.1 & 3/4 Story
					%	%	6.2 & 1/2 Story
					%	%	21.Open Frame Por
					%	%	22.Encl Frame Por
					%	%	23.Frame Garage
					%	%	24.Frame Shed
					%	%	25.Frame Bay Wind
					%	%	26.1SFr Overhang
					%	%	27.Unfin Basement
					%	%	28.Unfinished Att
					%	%	29.Finished Attic

TUTTLE, JODY C
1095 STATE ROAD #2
MAPLETON ME 04757

B2261P207 B3645P41 B4640P283 B4640P295

Inspection Witnessed By:

X		Date
No./Date	Description	Date Insp.

Notes:
* -20% for attached garage.

Washburn

Property Data			Assessment Record							
Neighborhood 1 Neighborhood One			Year	Land	Buildings	Exempt	Total			
Tree Growth Year 0			2012	20,800	75,500	0	96,300			
1ST MORTGAGE 0			2013	27,100	76,300	0	103,400			
2ND MORTGAGE 0			2015	27,100	76,300	0	103,400			
Zone/Land Use 1 Residential			2018	27,100	76,300	0	103,400			
Secondary Zone			2019	27,200	120,100	0	147,300			
Topography 4 Below Street			2020	27,200	120,100	0	147,300			
1.Level 4.Below St 7.LevelBog			2022	27,200	126,100	0	153,300			
2.Rolling 5.Low 8.			2023	36,700	150,000	0	186,700			
3.Above St 6.Swampy 9.			2024	36,700	150,000	0	186,700			
Utilities 4 Drilled Well 3 Public Sewer										
1.Public 4.Dr Well 7.Cesspool										
2.Water 5.Dug Well 8.										
3.Sewer 6.Septic 9.None										
Street 1 Paved										
1.Paved 4.Proposed 7.										
2.Semi Imp 5.R/O/W 8.										
3.Gravel 6. 9.None										
TG PLAN YEAR 0										
Tif District # 0										
Sale Data			Land Data							
Sale Date			Front Foot	Type	Effective		Influence		Influence Codes	
Price					Frontage	Depth	Factor	Code		
Sale Type					11.Regular Lot					1.Unimproved
1.Land 4.Mobile 7.C/I L&B					12.Delta Triangle					2.Excess Frtg
2.L & B 5.Other 8.					13.Nabla Triangle					3.Topography
3.Building 6.C/I Land 9.			14.Rear Land				4.Size/Shape			
Financing			15.Class I Road				5.Access			
1.Convent 4.Seller 7.			Square Foot	Square Feet				6.Restriction		
2.FHA/VA 5.Private 8.				16.Class II Road				7.Open Space		
3.Assumed 6.Cash 9.Unknown				17.Municipal Rese				8.View/Environ		
Validity				18.Munic Sep Lago				9.Fract Share		
1.Valid 4.Split 7.Renovate				19.Gravel Pit				Acres		
2.Related 5.Partial 8.Other			20.Industrial Bas				30.Utility R O W			
3.Distress 6.Exempt 9.			Fract. Acre	Acreage/Sites				31.Tillable		
Verified				21.Developed Pave	21	1.00	100 %	0	32.Pasture	
1.Buyer 4.Agent 7.Family				22.Undev Paved (F	28	6.30	100 %	0	33.Orchard	
2.Seller 5.Pub Rec 8.Other				23.Developed Grav	44	1.00	100 %	0	34.Softwood F&O	
3.Lender 6.MLS 9.				24.Undev Gravel (35.Mixed Wood F&O	
			25.Comm Base Pave					36.Hardwood F&O		
			26.Comm Base Grav					37.Softwood TG		
			27.Backlot					38.Mixed Wood TG		
			28.Rear Land					39.Hardwood TG		
			29.Pavement					40.Wasteland		
			Total Acreage		7.30			41.Open Space		
								42.Mobile Home Si		
								43.Condo Site		
								44.Lot Improvemen		
								45.Subdivision Lo		
								46.Heavy Ind Sit		

Washburn

Map Lot 001-022

Account 982

Location 954 WASHBURN ROAD

Card 1 Of 1 9/04/2024

Building Style	8 Log Home		SF Bsmt Living	0		Layout	1 Typical		
1.Conv.	5.Garrison	9.Gambrel	Fin Bsmt Grade	0 0		1.Typical	4.	7.	
2.Ranch	6.Salt Box	10.Other	OPEN 5 OPTIONAL	0		2.Inadeq	5.	8.	
3.R Ranch	7.Contemp	11.Split	Heat Type	100% 8 Floor/Wall Unit		3.Poor	6.	9.	
4.Cape	8.Log	12.	1.HWBB	5.FWA	9.No Heat	Attic	2 1/2 Finished		
Dwelling Units	1		2.HWCI	6.GravWA	10.	1.1/4 Fin	4.Full Fin	7.	
Other Units	0		3.H Pump	7.Electric	11.	2.1/2 Fin	5.F/Stair	8.	
Stories	1 One Story		4.Steam	8.F/Wall	12.	3.3/4 Fin	6.	9.None	
1.1	4.1.5	7.	Cool Type	0% 9 None		Insulation	1 Full		
2.2	5.1.75	8.	1.Refrig	4.W&C Air	7.	1.Full	4.Minimal	7.	
3.3	6.2.5	9.	2.Evapor	5.	8.	2.Heavy	5.Partial	8.	
Exterior Walls	1 Wood Siding		3.H Pump	6.	9.None	3.Capped	6.	9.None	
1.Wood	5.Stucco	9.T-111	Kitchen Style	2 Typical		Unfinished %	0%		
2.Vin/Al	6.Brick	10.Other	1.Modern	4.Obsolete	7.	Grade & Factor	3 Average 105%		
3.Compos.	7.Stone	11.	2.Typical	5.	8.	1.E Grade	4.B Grade	7.	
4.Asbestos	8.Concrete	12.	3.Old Type	6.	9.None	2.D Grade	5.A Grade	8.SC Grade	
Roof Surface	3 Sheet Metal		Bath(s) Style	2 Typical Bath(s)		3.C Grade	6.AA Grade	9.Same	
1.Asphalt	4.Composit	7.	1.Modern	4.Obsolete	7.	SQFT (Footprint)	616		
2.Slate	5.Wood	8.	2.Typical	5.	8.	Condition	4 Average		
3.Metal	6.Other	9.	3.Old Type	6.	9.None	1.Poor	4.Avg	7.V G	
SF Masonry Trim	0		# Rooms	3		2.Fair	5.Avg+	8.Exc	
OPEN-3-CUSTOM	0		# Bedrooms	2		3.Avg-	6.Good	9.Same	
OPEN-4-CUSTOM	0		# Full Baths	1		Phys. % Good	0%		
Year Built	2003		# Half Baths	0		Funct. % Good	100%		
Year Remodeled	0		# Addn Fixtures	0		Functional Code	9 None		
Foundation	2 Concrete Block		# Fireplaces	0		1.Incomp	4.Delap	7.No Power	
1.Concrete	4.Wood	7.	 <p>TRIO Software A Division of Harris Computer Systems</p>	2.O-Built	5.Bsmt	8.LongTerm	Economic Code	None	
2.C Block	5.Slab	8.		3.Damage	6.Common	9.None	0.None	3.No Power	7.
3.Br/Stone	6.Piers	9.		Econ. % Good	100%		1.Location	4.Generate	8.
Basement	9 No Basement			Entrance Code	3 Information Only		2.Encroach	9.None	9.
1.1/4 Bmt	4.Full Bmt	7.		1.Interior	4.Vacant	7.	Information Code	2 Relative	
2.1/2 Bmt	5.None	8.		2.Refusal	5.Estimate	8.	1.Owner	4.Agent	7.
3.3/4 Bmt	6.	9.None		3.Informed	6.Reviewed	9.	2.Relative	5.Estimate	8.
Bsmt Gar # Cars	0			Information Code	2 Relative		3.Tenant	6.Other	9.
Wet Basement	9 No Basement			1.Own	4.Agent	7.			
1.Dry	4.	7.		2.Rel	5.Est	8.			
2.Damp	5.	8.	3.Ten	6.Oth	9.				
3.Wet	6.	9.							

Date Inspected 7/28/2018

Additions, Outbuildings & Improvements

Type	Year	Units	Grade	Cond	Phys.	Funct.	Sound Value
24 Frame Shed	0				%	%	200
8 Cottage	0	576	0 0	0	0 %	0 %	
22 Encl Frame Porch	2003	160	0 0	0	0 %	0 %	
28 Unfinished Attic	0	144	0 0	0	0 %	0 %	
68 Wood Deck	2003	220	3 100	4	0 %	100 %	
23 Frame Garage	2004	1200	4 100	4	0 %	80 %	
1 One Story Frame	2004	600	3 90	4	0 %	100 %	
28 Unfinished Attic	2004	600	3 90	4	0 %	100 %	
24 Frame Shed	0				%	%	400
					%	%	

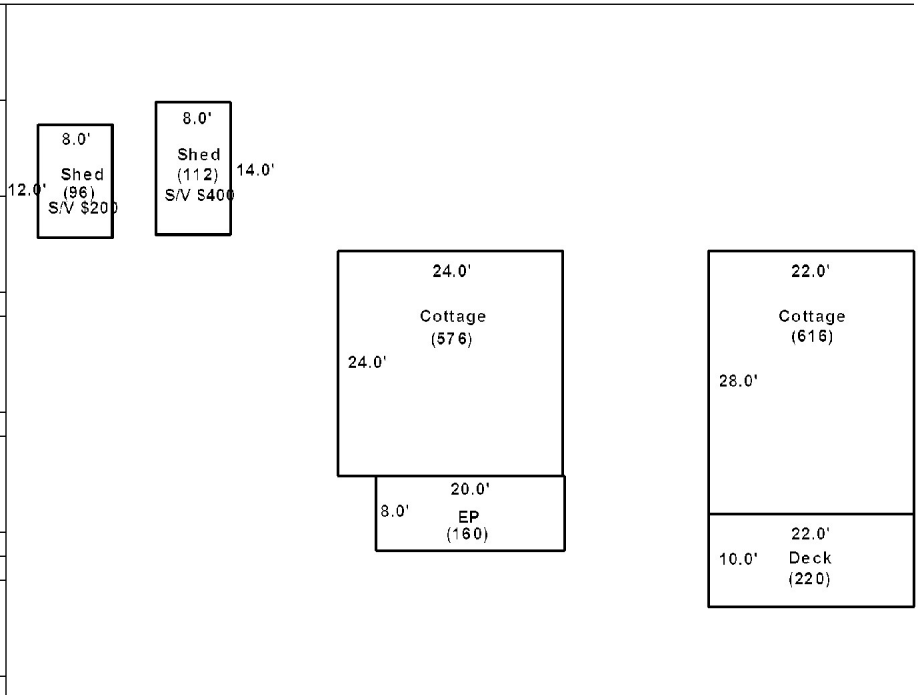

WASHBURN WATER & SEWER DISTRICT
22 HILT STREET
WASHBURN ME 04786

B4729P314

Inspection Witnessed By:

No./Date	Description	Date Insp.
X		

Notes:

Washburn

Property Data			Assessment Record						
Neighborhood 1 Neighborhood One			Year	Land	Buildings	Exempt	Total		
Tree Growth Year 0			2012	0	60,000	60,000	0		
1ST MORTGAGE 0			2013	0	60,000	60,000	0		
2ND MORTGAGE 0			2015	0	60,000	60,000	0		
Zone/Land Use 2 Commercial			2018	0	60,000	60,000	0		
Secondary Zone			2019	0	3,700	3,700	0		
Topography 1 Level			2020	0	3,700	3,700	0		
1.Level 4.Below St 7.LevelBog			2021	0	3,700	3,700	0		
2.Rolling 5.Low 8.			2022	0	3,900	3,900	0		
3.Above St 6.Swampy 9.			2023	0	4,600	4,600	0		
Utilities			2024	0	4,600	4,600	0		
1.Public 4.Dr Well 7.Cesspool									
2.Water 5.Dug Well 8.									
3.Sewer 6.Septic 9.None									
Street 1 Paved									
1.Paved 4.Proposed 7.									
2.Semi Imp 5.R/O/W 8.									
3.Gravel 6. 9.None									
TG PLAN YEAR 0									
Tif District # 0									
Sale Data			Land Data						
Sale Date 7/13/2009			Front Foot	Type	Effective		Influence		Influence Codes
Price					Frontage	Depth	Factor	Code	
Sale Type 5 Other			11.Regular Lot					1.Unimproved	
1.Land 4.Mobile 7.C/I L&B			12.Delta Triangle					2.Excess Frtg	
2.L & B 5.Other 8.			13.Nabla Triangle					3.Topography	
3.Building 6.C/I Land 9.			14.Rear Land					4.Size/Shape	
Financing			15.Class I Road					5.Access	
1.Convent 4.Seller 7.								6.Restriction	
2.FHA/VA 5.Private 8.								7.Open Space	
3.Assumed 6.Cash 9.Unknown								8.View/Environ	
Validity 2 Related Parties								9.Fract Share	
1.Valid 4.Split 7.Renovate			Square Foot	Square Feet				Acres	
2.Related 5.Partial 8.Other			16.Class II Road					30.Utility R O W	
3.Distress 6.Exempt 9.			17.Municipal Rese					31.Tillable	
Verified 5 Public Record			18.Munic Sep Lago					32.Pasture	
1.Buyer 4.Agent 7.Family			19.Gravel Pit					33.Orchard	
2.Seller 5.Pub Rec 8.Other			20.Industrial Bas					34.Softwood F&O	
3.Lender 6.MLS 9.								35.Mixed Wood F&O	
			Fract. Acre	Acreege/Sites				36.Hardwood F&O	
			21.Developed Pave					37.Softwood TG	
			22.Undev Paved (F					38.Mixed Wood TG	
			23.Developed Grav					39.Hardwood TG	
			Acres					40.Wasteland	
			24.Undev Gravel (41.Open Space	
			25.Comm Base Pave					42.Mobile Home Si	
			26.Comm Base Grav					43.Condo Site	
			27.Backlot					44.Lot Improvemen	
			28.Rear Land					45.Subdivision Lo	
			29.Pavement					46.Heavy Ind Sit	
			Total Acreage		0.00				

TUTTLE, JODY C
1095 STATE ROAD #2
MAPLETON ME 04757

B4640P295

Inspection Witnessed By:

X	Date	Date Insp.
No./Date	Description	Date Insp.

Notes:
*No Road Frontage-Narrow River front parcel-Excess rates only

Washburn

Property Data			Assessment Record						
Neighborhood 1 Neighborhood One			Year	Land	Buildings	Exempt	Total		
Tree Growth Year 0			2012	1,400	0	0	1,400		
1ST MORTGAGE 0			2013	1,800	0	0	1,800		
2ND MORTGAGE 0			2015	1,800	0	0	1,800		
Zone/Land Use 1 Residential			2018	1,800	0	0	1,800		
Secondary Zone			2019	2,700	0	0	2,700		
Topography 2 Rolling			2020	2,700	0	0	2,700		
1.Level 4.Below St 7.LevelBog			2021	2,700	0	0	2,700		
2.Rolling 5.Low 8.			2022	2,700	0	0	2,700		
3.Above St 6.Swampy 9.			2023	3,100	0	0	3,100		
Utilities			2024	3,100	0	0	3,100		
1.Public 4.Dr Well 7.Cesspool									
2.Water 5.Dug Well 8.									
3.Sewer 6.Septic 9.None									
Street 1 Paved									
1.Paved 4.Proposed 7.			Land Data						
2.Semi Imp 5.R/O/W 8.									
3.Gravel 6. 9.None			Front Foot	Type	Effective		Influence		Influence Codes
TG PLAN YEAR 0			11.Regular Lot		Frontage	Depth	Factor	Code	
Tif District # 0			12.Delta Triangle				%		1.Unimproved
Sale Data			13.Nabla Triangle				%		2.Excess Frtg
Sale Date 4/12/2002			14.Rear Land				%		3.Topography
Price			15.Class I Road				%		4.Size/Shape
Sale Type 1 Land Only							%		5.Access
1.Land 4.Mobile 7.C/I L&B							%		6.Restriction
2.L & B 5.Other 8.			Square Foot	Square Feet					7.Open Space
3.Building 6.C/I Land 9.			16.Class II Road				%		8.View/Environ
Financing 1 Conventional			17.Municipal Rese				%		9.Fract Share
1.Convent 4.Seller 7.			18.Munic Sep Lago				%		Acres
2.FHA/VA 5.Private 8.			19.Gravel Pit				%		30.Utility R O W
3.Assumed 6.Cash 9.Unknown			20.Industrial Bas				%		31.Tillable
Validity 2 Related Parties							%		32.Pasture
1.Valid 4.Split 7.Renovate			Fract. Acre	Acreege/Sites					33.Orchard
2.Related 5.Partial 8.Other			21.Developed Pave	28	5.40	100	%	0	34.Softwood F&O
3.Distress 6.Exempt 9.			22.Undev Paved (F				%		35.Mixed Wood F&O
Verified 5 Public Record			23.Developed Grav				%		36.Hardwood F&O
1.Buyer 4.Agent 7.Family			Acres				%		37.Softwood TG
2.Seller 5.Pub Rec 8.Other			24.Undev Gravel (%		38.Mixed Wood TG
3.Lender 6.MLS 9.			25.Comm Base Pave				%		39.Hardwood TG
			26.Comm Base Grav				%		40.Wasteland
			27.Backlot				%		41.Open Space
			28.Rear Land				%		42.Mobile Home Si
			29.Pavement				%		43.Condo Site
			Total Acreage		5.40				44.Lot Improvemen
									45.Subdivision Lo
									46.Heavy Ind Sit

Washburn

Map Lot 001-023

Account 983

Location 954 WASHBURN ROAD

Card 1 Of 1 9/04/2024

Building Style 0	SF Bsmt Living 0	Layout 0
1.Conv. 5.Garrison 9.Gambrel	Fin Bsmt Grade 0 0	1.Typical 4. 7.
2.Ranch 6.Salt Box 10.Other	OPEN 5 OPTIONAL 0	2.Inadeq 5. 8.
3.R Ranch 7.Contemp 11.Split	Heat Type 100% 0	3.Poor 6. 9.
4.Cape 8.Log 12.	1.HWBB 5.FWA 9.No Heat	Attic 0
Dwelling Units 0	2.HWCI 6.GravWA 10.	1.1/4 Fin 4.Full Fin 7.
Other Units 0	3.H Pump 7.Electric 11.	2.1/2 Fin 5.FI/Stair 8.
Stories 0	4.Steam 8.FI/Wall 12.	3.3/4 Fin 6. 9.None
1.1 4.1.5 7.	Cool Type 0% 9 None	Insulation 0
2.2 5.1.75 8.	1.Refrig 4.W&C Air 7.	1.Full 4.Minimal 7.
3.3 6.2.5 9.	2.Evapor 5. 8.	2.Heavy 5.Partial 8.
Exterior Walls 0	3.H Pump 6. 9.None	3.Capped 6. 9.None
1.Wood 5.Stucco 9.T-111	Kitchen Style 0	Unfinished % 0%
2.Vin/Al 6.Brick 10.Other	1.Modern 4.Obsolete 7.	Grade & Factor 0 0%
3.Compos. 7.Stone 11.	2.Typical 5. 8.	1.E Grade 4.B Grade 7.
4.Asbestos 8.Concrete 12.	3.Old Type 6. 9.None	2.D Grade 5.A Grade 8.SC Grade
Roof Surface 0	Bath(s) Style 0	3.C Grade 6.AA Grade 9.Same
1.Asphalt 4.Composit 7.	1.Modern 4.Obsolete 7.	SQFT (Footprint) 0
2.Slate 5.Wood 8.	2.Typical 5. 8.	Condition 0
3.Metal 6.Other 9.	3.Old Type 6. 9.None	1.Poor 4.Avg 7.V G
SF Masonry Trim 0	# Rooms 0	2.Fair 5.Avg+ 8.Exc
OPEN-3-CUSTOM 0	# Bedrooms 0	3.Avg- 6.Good 9.Same
OPEN-4-CUSTOM 0	# Full Baths 0	Phys. % Good 0%
Year Built 0	# Half Baths 0	Funct. % Good 100%
Year Remodeled 0	# Addn Fixtures 0	Functional Code 9 None
Foundation 0	# Fireplaces 0	1.Incomp 4.Delap 7.No Power
1.Concrete 4.Wood 7.		2.O-Built 5.Bsmt 8.LongTerm
2.C Block 5.Slab 8.		3.Damage 6.Common 9.None
3.Br/Stone 6.Piers 9.		Econ. % Good 100%
Basement 0		Economic Code None
1.1/4 Bmt 4.Full Bmt 7.		0.None 3.No Power 7.
2.1/2 Bmt 5.None 8.		1.Location 4.Generate 8.
3.3/4 Bmt 6. 9.None		2.Encroach 9.None 9.
Bsmt Gar # Cars 0		Entrance Code 0
Wet Basement 0		1.Interior 4.Vacant 7.
1.Dry 4. 7.		2.Refusal 5.Estimate 8.
2.Damp 5. 8.	3.Informed 6.Reviewed 9.	
3.Wet 6. 9.	Information Code 0	
	1.Owner 4.Agent 7.	
	2.Relative 5.Estimate 8.	
	3.Tenant 6.Other 9.	

Date Inspected

Additions, Outbuildings & Improvements

Type	Year	Units	Grade	Cond	Phys.	Funct.	Sound Value
					%	%	1.One Story Fram
					%	%	2.Two Story Fram
					%	%	3.Three Story Fr
					%	%	4.1 & 1/2 Story
					%	%	5.1 & 3/4 Story
					%	%	6.2 & 1/2 Story
					%	%	21.Open Frame Por
					%	%	22.Encl Frame Por
					%	%	23.Frame Garage
					%	%	24.Frame Shed
					%	%	25.Frame Bay Wind
					%	%	26.1SFr Overhang
					%	%	27.Unfin Basement
					%	%	28.Unfinished Att
					%	%	29.Finished Attic

